

Scale: 1" = 20'

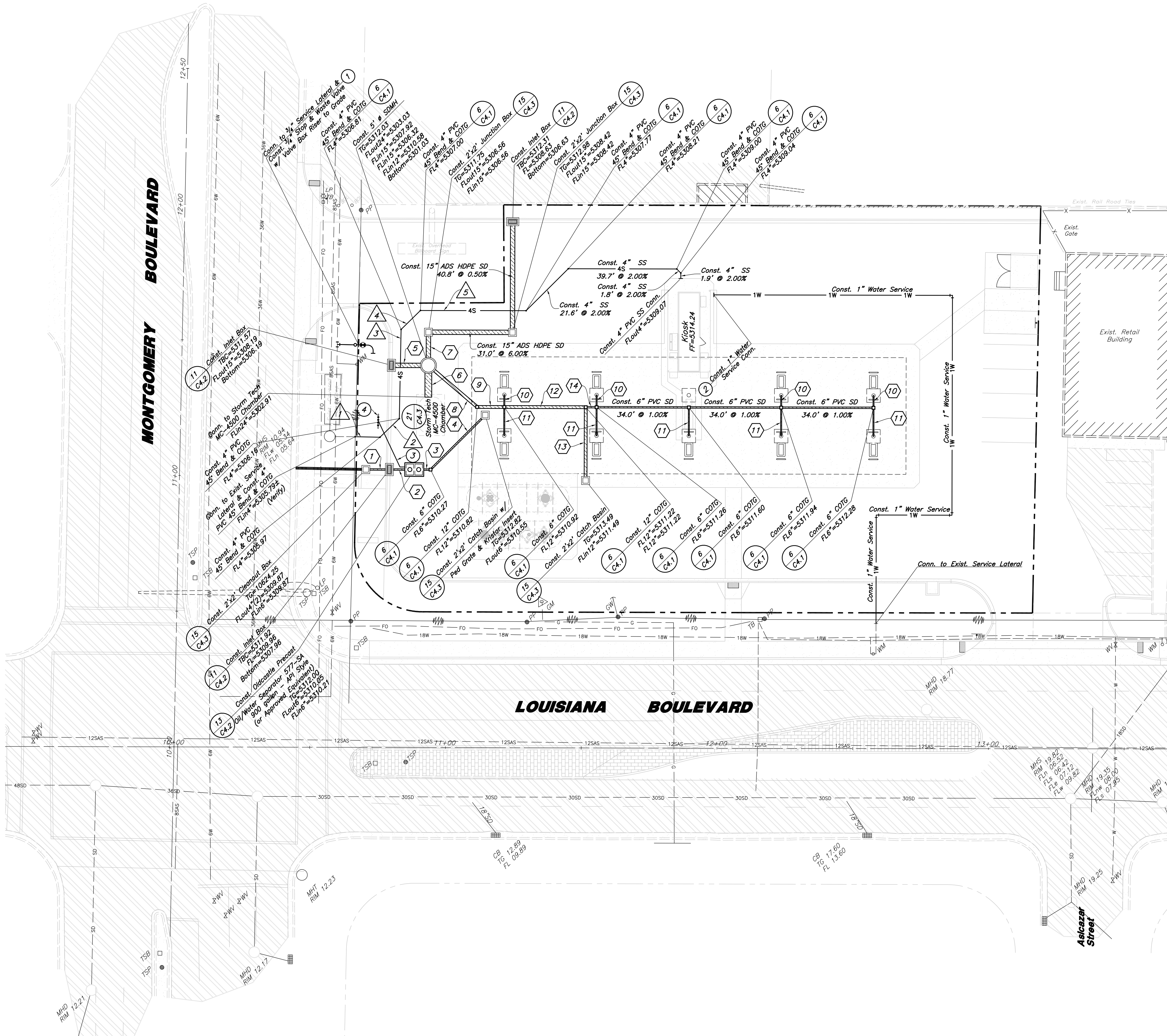

Storm Drain Keynotes

- 1 Const. 6" PVC SD
8.7' @ 1.00%
- 2 Const. 6" PVC SD
9.2' @ 1.00%
- 3 Const. 6" PVC SD
6.0' @ 1.00%
- 4 Const. 6" PVC SD
28.4' @ 1.00%
- 5 Const. 15" RCP SD
13.6' @ 2.00%
- 6 Const. 24" ADS HDPE SD
11.7' @ 1.00%
- 7 Const. 15" RCP SD
12.2' @ 2.00%
- 8 Const. 12" PVC SD
23.6' @ 1.00%
- 9 Const. 12" PVC SD
4.5' @ 1.00%
- 10 Const. 4" PVC SD
10.5' @ 2.00%
- 11 Const. 4" PVC SD
30.0' @ 1.00%
- 12 Const. 12" PVC SD
27.0' @ 1.00%
- 13 Const. 6" PVC SD
4.0' @ 1.00%

General Utility Notes:

1. All sewer and water facilities shall be constructed per local jurisdiction standards and specifications. Contractor is responsible to obtain standards and specifications.
2. Coordinate all utility connections to building with plumbing plans and building contractor.
3. Verify depth and location of all existing utilities prior to constructing any new utility lines. Notify Civil Engineer of any discrepancies or conflicts prior to any connections being made.
4. All catch basin and inlet box grates are to be bicycle proof.
5. Refer to the site electrical plan for details and locations of electrical lines, transformers and light poles.
6. Gas lines, telephone lines, and cable TV lines are not a part of these plans.
7. Water meters are to be installed per city standards and specifications. It will be the contractor's responsibility to install all items required.
8. Water lines, valves, fire hydrants, fittings etc. are to be constructed as shown. Contractor is responsible, at no cost to the owner, to construct any vertical adjustments necessary to clear sewer, storm drain, or other utilities as necessary including valve boxes and hydrant spools to proper grade.
9. Contractor shall install a 12" concrete collar around all manholes, valves, catch basins, cleanouts & any other structures located within the asphalt.

Utility Piping Materials:

All piping to be installed per manufacturers recommendations. Refer to project specifications for more detailed information regarding materials, installation, etc.

Culinary Service Laterals

1. Pipe material as shown on utility plan view and/or to meet city standards.

Water Main Lines and Fire Lines

1. Pipe material as shown on utility plan view and/or to meet city standards.

Sanitary Sewer Lines

1. All sewer piping to be Polyvinyl Chloride (PVC) sewer pipe, ASTM D3034, Type PSM, SDR 35

Storm Drain Lines

1. 12" pipes or smaller - Polyvinyl Chloride (PVC) sewer pipe, ASTM D3034, Type PSM, SDR 35
2. 15" pipes or larger - ADS High Density Polyethylene (HDPE) AASHTO M 294, Types with Smooth Interior or Equal as Approved.

Utility Construction Keynotes

- 1 Contractor shall furnish & install 3/4" Mueller Orisetal Mark II stop & waste valve with 3/4" compression x male end adaptor fittings, 2-1/2" cast iron curb service box with screw type extension shaft to grade and lid marked "irrigation." Contractor shall provide owner with pentagon head bolt wrench for maintenance access. Stub 5" minimum 3/4" SDR-9 class 200 polyethylene irrigation pipe for irrigation connection (See Irrigation Plan). Mark stub end with 2"x4" painted "purple."
- 2 Furnish & install 1" polyethylene (PE) water pipe AWWA C901, PE 340B, SDR-9 (200 PSI) to within 5' of Kiosk.
- 3 Const. 2" Black Steel Vent Pipe Provide Continuous Positive Slope Towards Surface
- 4 Const. Vent Riser

Storm Drain Note:

All Storm Drainage Pipe Lengths and Slopes are from Center of Box to Center of Box.

CAUTION :

The locations and/or elevations of existing utilities as shown on these plans are based on records of the various utility companies and, where possible, measurements taken in the field. The information is not to be relied on as being exact or complete.

New Mexico One Call, Inc.

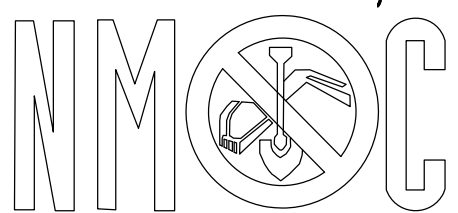

Smith's
FOOD & DRUG STORES

#485
Albuquerque, NM

ANDERSON WAHLEN & ASSOCIATES
Great Basin Engineering South
2010 North Redwood Road, Salt Lake City, Utah 84116
801.521.8529 - AWAengineering.net

Utility Plan
Smith's #485 Fuel Center
6941 Montgomery Blvd.
Albuquerque, NM



22 Aug, 2014

SHEET NO.

C3.1