

Enlarged Kiosk Detail
Scale: 1" = 10'

Legend



Grading Construction Notes

1. Warp Concrete to Eliminate Waterway Trough in Final 5 Linear Feet.
2. Const. "Keystone" Retaining Wall. Contractor to Provide Design Submittal Stamped by New Mexico Licensed Professional Engineer for Approval to Engineer of Record Prior to Construction.
3. Const. Open-Face Curb & Gutter.

Tank Installation Notes:

1. Contractor shall verify that a minimum of 1% slope is provided on all vapor recovery lines from the MPD to the tanks.
2. The bottom and all four sides of tank hole are to be lined with Armos DEF 4545 or equivalent filter fabric.
3. All adjoining filter fabric panel seams are to be overlapped a minimum of 24".
4. All filter fabric is to be properly anchored to prevent movement while backfilling tank hole.

Filter Fabric Notes:

1. The bottom and all four sides of tank hole are to be lined with Armos DEF 4545 or equivalent filter fabric.
2. All adjoining filter fabric panel seams are to be overlapped a minimum of 24".
3. All filter fabric is to be properly anchored to prevent movement while backfilling tank hole.

NOTE:
See Plans by Madison Industries for Footing Depth.

Tank Depth of Bury Calculations			
DESCRIPTION	FURTHEST ISLAND	LOWEST ISLAND	
1. Elevation at Top of Island	5315.41	5313.56	
2. Min. Slope of Piping = (L) x 1/8" per foot			
Where L1 = 215 ft., L2 = 60 ft.	2.2	0.6	ft
3. Dispenser Island			
Concrete Drive Slab			
Pipe Cover			
Pipe Diameter	2.75	2.75	ft
Tank Connection			
Total			
4. Grade Differential = (#2 + #3)	4.95	3.35	ft
5. Top of Tanks = (#1 - #4)	5310.46	5310.21	ft
6. Top of Tanks = Lowest Calculated Elevation		5310.21	
Check Min. / Max. Burial Depth		4.0' Min. / 7.0' Max.	
7. Lowest Elevation of Slab Above Tank		5312.85	
8. Depth of Bury = (#7 - #6)		2.64	ft
NOTE: If #8 < 4.5 ft., Set Top of Tanks at (#7 - 4.5 ft.) = 5308.35			
If #8 > 7 ft., Contact Owner for Certification of Burial Depth with Tank			
		5308.35	

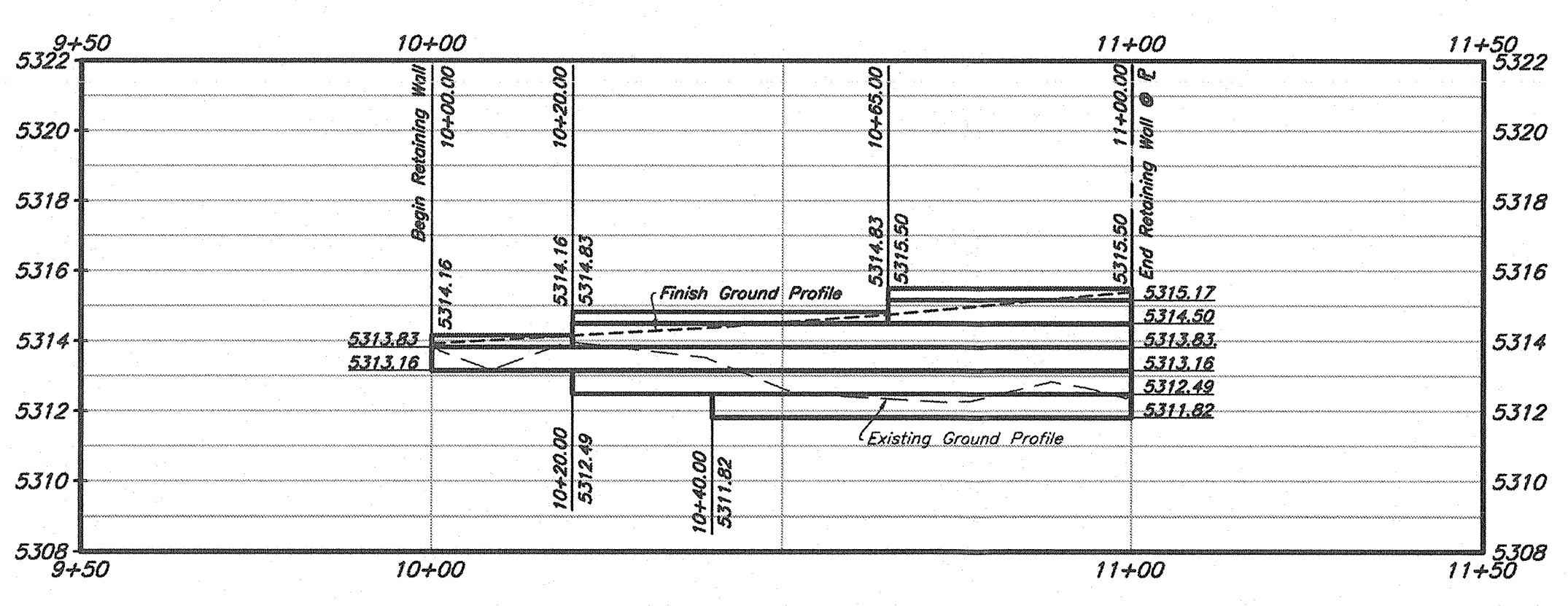

1 Keystone Retaining Wall Profile
Hor. Scale: 1" = 20'
Vert. Scale: 1" = 4'

DRAINAGE CERTIFICATION WITH SURVEY WORK BY PROFESSIONAL SURVEYOR
DRAINAGE CERTIFICATION
I, David G. Anderson, NMPE 20167, of the firm Anderson Wahlen & Associates, hereby certify that this project has been graded and will drain in substantial compliance with and in accordance with the design intent of the approved plan dated 10-22-14. The record information edited onto the original design document has been obtained by Andrew S. Medina, NMPS 12345, of the firm Sandia Land Surveying, LLC. I further verify that I have reviewed the site improvements and personnel under my direct supervision have observed the project site on 4-09-15 and have determined by visual observation that the survey data provided is representative of actual site conditions and is true and correct to the best of my knowledge and belief. This documentation is submitted in support of a request for Final Occupancy Permit.
(Describe any exceptions and/or qualifications here in a separate paragraph.)
None
(Describe any deficiencies and/or corrections required here in a separate paragraph.)
None
The record information presented hereon is not necessarily complete and intended only to verify substantial compliance of the grading and drainage aspects of this project. Those relying on this record document are advised to obtain independent verification of its accuracy before using it for any other purpose.

David G. Anderson, NMPE 20167
(seal)
Date 5-11-15
Professional Engineer
NEW MEXICO
20167

New Mexico One Call, Inc.
NMOC
Professional Resources for Damage Prevention
1-800-321-ALERT

ADA Note:
Contractor must maintain a running slope on Accessible routes no steeper than 5.0% (1:20). The cross slope for Accessible routes must be no steeper than 2.0% (1:50). All Accessible routes must have a minimum clear width of 36". If Grades on plans do not meet this requirement notify Consultant immediately.
The Client, Contractor and Subcontractor should immediately notify the Consultant of any conditions of the project that they believe do not comply with the current state of the ADA (ICC/ANSI A117.1-Latest Edition) and/or FWA.

General Grading Notes:

1. All grading shall be in accordance with the project geotechnical report.
2. Cut slopes shall be no steeper than 3 horizontal to 1 vertical.
3. Fill slopes shall be no steeper than 3 horizontal to 1 vertical.
4. Fills shall be compacted per the recommendations of the geotechnical report prepared for the project and shall be certified by the Owner's Special Inspection.
5. Areas to receive fill shall be properly prepared and approved by the Owner's Special Inspection prior to placing fill.
6. Fills shall be banded into competent material as per specifications and geotechnical report.
7. All trench backfill shall be tested and certified by the Owner's Special Inspection.
8. The Owner's Special Inspection shall perform periodic inspections and submit a complete report and map upon completion of the rough grading.
9. The final compaction report and certification from the Owner's Special Inspection shall contain the type of field testing performed. Each test shall be identified with the method of obtaining the in-place density, whether sand cone or drive ring and shall be so noted for each test. Sufficient maximum density determinations shall be performed to verify the accuracy of the maximum density curves used by the field technician.
10. Dust shall be controlled by watering.
11. The location and protection of all utilities is the responsibility of the permittee.
12. Approved protective measures and temporary drainage provisions must be used to protect adjoining properties during the grading process.
13. All public roadways must be cleared daily of all dirt, mud and debris deposited on them as a result of the grading operation. Cleaning is to be done to the satisfaction of the City Engineer.
14. The site shall be cleared and grubbed of all vegetation and deleterious matter prior to grading.
15. The contractor shall provide shoring in accordance with OSHA requirements for trench walls.
16. Aggregate base shall be compacted per the geotechnical report prepared for the project.
17. The recommendations in the following Geotechnical Engineering Report by Kleinfield are included in the requirements of grading and site Preparation. The report is titled "Geotechnical Engineering Report Proposed Smith's Food and Drug Fuel Center Retail Store #485 Montgomery Boulevard & Louisiana Boulevard Albuquerque, New Mexico." Project No.: 00135338.000A Dated: July 29, 2014
18. As part of the construction documents, owner has provided contractor with a topographic survey performed by manual or aerial means. Such survey was prepared for project design purposes and is provided to the contractor as a courtesy. It is expressly understood that such survey may not accurately reflect existing topographic conditions.
19. If Contractor observes evidence of hazardous materials or contaminated soils he shall immediately contact the project engineer to provide notification and obtain direction before proceeding with disturbance of solid materials or contaminated soil.
20. Contractor will be responsible to phase the construction development so that storm water improvements and storm water facilities including detention or retention improvement facilities are constructed and functional prior to an offsite storm water release and take necessary construction precautions so that no offsite flooding will occur.
21. Importing fill material from an off-site location without prior written approval from the Owner's Project Manager is strictly prohibited. Identification of offsite borrow locations and material must be coordinated and documented with the SWPPP. The Owner's Special Inspection shall verify the suitability of all off-site material. This includes an analysis to insure that no environmental contamination is present. If any material is brought on site without prior written approval of the Owner's Project Manager, the Contractor will bear all costs associated with removing the material, testing for contamination, monitoring the clean-up operation, disposal in an approved landfill, and certifying that the Owner's site is environmentally clean. If requested, the Owner's Project Manager or the Owner's Special Inspection must be granted unfettered access to any and all borrow sites.

Curb and Gutter Construction Notes:

1. Open face gutter shall be constructed where drainage is directed away from curb.
2. Open face gutter locations are indicated by shading and notes on the grading plan.
3. It is the responsibility of the surveyor to adjust top of asphalt grades to top of curb grades at the time of construction staking.
4. Refer to the typical details for a standard and open face curb and gutter for dimensions.
5. Transitions from open face to standard curb and gutter are to be smooth. Hand form these areas if necessary.

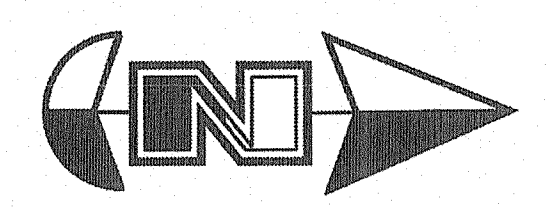

Scale: 1" = 20'



REV	DATE	DESCRIPTION
1	11/21/2014	Addendum 1
2	11/03/2014	Rev Set

Designed by: KR
Drafted by: AM
Client Name:
Smith's Food & Drug
smc485-GR-As-Built

ANDERSON WAHLEN & ASSOCIATES
Great Basin Engineering South
2010 North Redwood Road, Salt Lake City, Utah 84116
801 521-8529 - AWEngineering.net

Grading Plan
Smith's #485 Fuel Center
6941 Montgomery Blvd.
Albuquerque, NM

22 Aug. 2014
SHEET NO.
C2.1

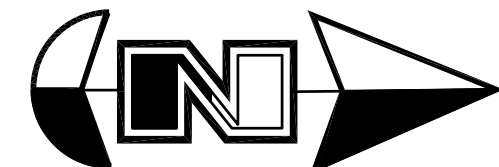
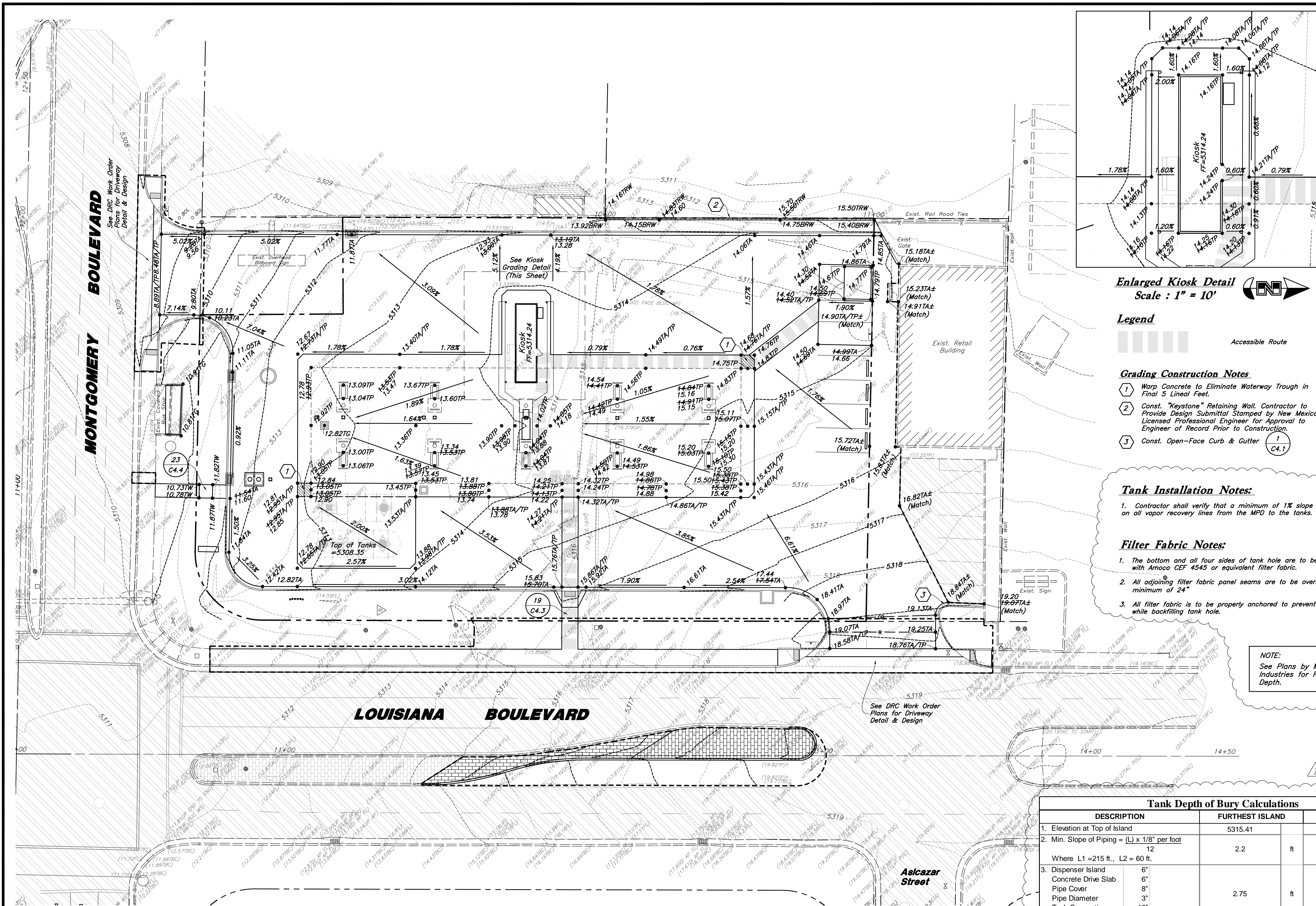

Scale: 1" = 20'



General Grading Notes:

1. All grading shall be in accordance with the project geotechnical report.
2. Cut slopes shall be no steeper than 3 horizontal to 1 vertical.
3. Fill slopes shall be no steeper than 3 horizontal to 1 vertical.
4. Fills shall be compacted per the recommendations of the geotechnical report prepared for the project and shall be certified by the Owner's Special Inspection.
5. Areas to receive fill shall be properly prepared and approved by the Owner's Special Inspection prior to placing fill.
6. Fills shall be benched into competent material as per specifications and geotechnical report.
7. All trench backfill shall be tested and certified by the Owner's Special Inspection.
8. The Owner's Special Inspection shall perform periodic inspections and submit a complete report and map upon completion of the rough grading.
9. The final compaction report and certification from the Owner's Special Inspection shall contain the type of field testing performed. Each test shall be identified with the method of obtaining the in-place density, whether sand cone or drive ring and shall be so noted for each test. Sufficient maximum density determinations shall be performed to verify the accuracy of the maximum density curves used by the field technician.
10. Dust shall be controlled by watering.
11. The location and protection of all utilities is the responsibility of the permittee.
12. Approved protective measures and temporary drainage provisions must be used to protect adjoining properties during the grading process.
13. All public roadways must be cleared daily of all dirt, mud and debris deposited on them as a result of the grading operation. Cleaning is to be done to the satisfaction of the City Engineer.
14. The site shall be cleared and grubbed of all vegetation and deleterious matter prior to grading.
15. The contractor shall provide shoring in accordance with OSHA requirements for trench walls.
16. Aggregate base shall be compacted per the geotechnical report prepared for the project.
17. The recommendations in the following Geotechnical Engineering Report by Kleinfelder are included in the requirements of grading and site preparation. The Report is titled "Geotechnical Engineering Report Proposed Smith's Food and Drug Fuel Center Retail Store #485 Montgomery Boulevard & Louisiana Boulevard Albuquerque, New Mexico." Project No.: 00135339.000A Dated: July 29, 2014
18. As part of the construction documents, owner has provided contractor with a topographic survey performed by manual or aerial means. Such survey was prepared for project design purposes and is provided to the contractor as a courtesy. It is expressly understood that such survey may not accurately reflect existing topographic conditions.
19. If Contractor observes evidence of hazardous materials or contaminated soils he shall immediately contact the project engineer to provide notification and obtain direction before proceeding with disturbance of solid materials or contaminated soil.
20. Contractor will be responsible to phase the construction development so that storm water improvements and storm water facilities including detention or retention improvement facilities are constructed and functional prior to an offsite storm water release and take necessary construction precautions so that no offsite flooding will occur.
21. Importing fill material from an off-site location without prior written approval from the Owner's Project Manager is strictly prohibited. Identification of offsite borrow locations and material must be coordinated and documented with the SWPPP. The Owner's Special Inspection shall verify the suitability of all off-site material. This includes an analysis to insure that no environmental contamination is present. If any material is brought on site without prior written approval of the Owner's Project Manager, the Contractor will bear all costs associated with removing the material, testing for contamination, monitoring the clean-up operation, disposal in an approved landfill, and certifying that the Owner's site is environmentally clean. If requested, the Owner's Project Manager or the Owner's Special Inspection must be granted unfettered access to any and all borrow sites.

Curb and Gutter Construction Notes:

1. Open face gutter shall be constructed where drainage is directed away from curb.
2. Open face gutter locations are indicated by shading and notes on the grading plan.
3. It is the responsibility of the surveyor to adjust top of asphalt grades to top of curb grades at the time of construction staking.
4. Refer to the typical details for a standard and open face curb and gutter for dimensions.
5. Transitions from open face to standard curb and gutter are to be smooth. Hand form these areas if necessary.

Enlarged Kiosk Detail
Scale: 1" = 10'

Legend

Accessible Route

Grading Construction Notes

1. Warp Concrete to Eliminate Waterway Trough in Final 5 Linear Feet.
2. Const. "Keystone" Retaining Wall. Contractor to Provide Design Submittal Stamped by New Mexico Licensed Professional Engineer for Approval to Engineer of Record Prior to Construction.
3. Const. Open-Face Curb & Gutter

Tank Installation Notes:

1. Contractor shall verify that a minimum of 1% slope is provided on all vapor recovery lines from the MPD to the tanks.

Filter Fabric Notes:

1. The bottom and all four sides of tank hole are to be lined with Amoco CEF 4545 or equivalent filter fabric.
2. All adjoining filter fabric panel seams are to be overlapped a minimum of 24"
3. All filter fabric is to be properly anchored to prevent movement while backfilling tank hole.

NOTE:
See Plans by Madison Industries for Footing Depth.

Tank Depth of Bury Calculations

DESCRIPTION	FURTHEST ISLAND	LOWEST ISLAND
1. Elevation at Top of Island	5315.41	5313.56
2. Min. Slope of Piping = (L) x 1/8" per foot Where L1 = 215 ft., L2 = 60 ft.	2.2	0.6
3. Dispenser Island Concrete Drive Slab Pipe Cover Pipe Diameter Tank Connection Total	2.75	2.75
4. Grade Differential = (#2 + #3)	4.95	3.35
5. Top of Tanks = (#1 - #4)	5310.46	5310.21
6. Top of Tanks = Lowest Calculated Elevation		5310.21
Check Min. / Max. Burial Depth		4.0" Min. / 7.0" Max.
7. Lowest Elevation of Slab Above Tank		5312.85
8. Depth of Bury = (#7 - #6)		2.64
NOTE: If #8 < 4.5 ft., Set Top of Tanks at (#7 - 4.5 ft.) = 5308.35 If #8 > 7 ft., Contact Owner for Certification of Burial Depth with Tank		5308.35

DRAINAGE CERTIFICATION WITH SURVEY WORK BY PROFESSIONAL SURVEYOR
DRAINAGE CERTIFICATION
I, David G. Anderson, NMPE 20167, of the firm Anderson Wahlen & Associates, hereby verify that this project has been graded and will drain in substantial compliance with and in accordance with the design intent of the approved plan dated 10-22-14. The record information edited onto the original design document has been obtained by Andrew S. Medina, NMPS 12649, of the firm Sandia Land Surveying, LLC. I further verify that I have reviewed the site improvements and personnel under my direct supervision have observed the project site on 4-09-15 and have determined by visual observation that the survey data provided is representative of actual site conditions and is true and correct to the best of my knowledge and belief. This documentation is submitted in support of a request for Final Occupancy Permit.
(Describe any exceptions and/or qualifications here in a separate paragraph)
None
(Describe any deficiencies and/or corrections required here in a separate paragraph)
None
The record information presented hereon is not necessarily complete and intended only to verify substantial compliance of the grading and drainage aspects of this project. Those relying on this record document are advised to obtain independent verification of its accuracy before using it for any other purpose.

David G. Anderson, NMPE 20167
(seal)

Date



New Mexico One Call, Inc.
Professional Resources for Damage Prevention
1-800-321-ALERT

ADA Note:
Contractor must maintain a running slope on Accessible routes no steeper than 5.0% (1:20). The cross slope for Accessible routes must be no steeper than 2.0% (1:50). All Accessible routes must have a minimum clear width of 36". If Grades on plans do not meet this requirement notify Consultant immediately.
The Client, Contractor and Subcontractor should immediately notify the Consultant of any conditions of the project that they believe do not comply with the current state of the ADA (ICC/ANSI A117.1-Latest Edition) and/or FHAA.

Smith's
FOOD & DRUG STORES
#485
Albuquerque, NM

Grading Plan

Smith's #485 Fuel Center
6941 Montgomery Blvd.
Albuquerque, NM

22 Aug, 2014

SHEET NO.

C2.1

ANDERSON WAHLEN & ASSOCIATES
Great Basin Engineering South
2010 North Redwood Road, Salt Lake City, Utah 84116
801.521.8529 - AWAengineering.net

Designed by: KR
Drafted by: AM
Client Name:
Smith's Food & Drug
smc485-GR-As-Built

REV	DATE	DESCRIPTION
1	11/21/2014	Adendum 1
1	11/20/2014	Bid Set

CITY OF ALBUQUERQUE



May 13, 2015

Kirk Randall, PE
Anderson Wahlen & Associates
2010 North Redwood Rd.
Salt Lake City, UT 84116

**Re: Smith's Fuel Center #485
6941 Montgomery Blvd NE
Request Permanent C.O. - Accepted
Engineer's Stamp dated: 11-3-14 (F18D057)
Certification dated: 5-11-15**

Dear Mr. Randall,

Based on the Certification received 5/12/2015, the above named fuel center is acceptable for release of Certificate of Occupancy by Hydrology.

PO Box 1293

If you have any questions, you can contact me at 924-3695 or Rudy Rael at 924-3977.

Albuquerque

Sincerely,

New Mexico 87103

Rita Harmon, P.E.
Principal Engineer, Hydrology
Planning Department

www.cabq.gov

C: RR/RH
email