

Site Data
Total Site Area = 35,475 s.f. (0.814 ac.)
Kiosk Area = 240 s.f.
Canopy Area = 6,880 s.f.
Parking Required = 1 stalls
Parking Provided = 4 stalls + 1 Accessible Stall
+ 1 Motorcycle Stall = 6 Total

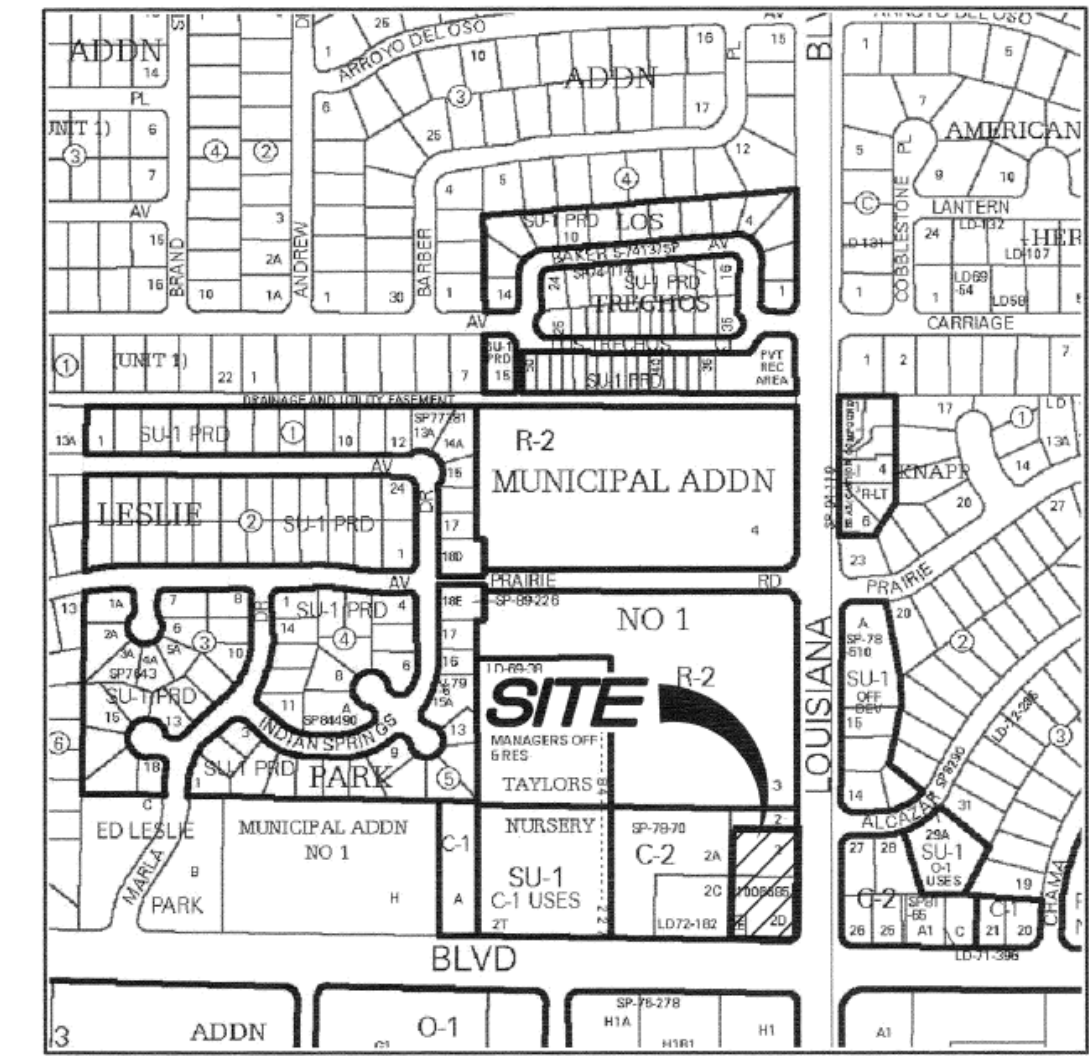

Vicinity Map
Zone Atlas Page F-18
6941 Montgomery Blvd.
Albuquerque, NM
Not to Scale

- Site Construction Notes**
- General Contractor to Supply, Assemble and Install 4'x2' Outside Wood Storage Shed.
 - Install roof penetration in kiosk and weather proof for speaker/camera wire installation.
 - All concrete slabs shall be cleaned and sealed by Owner. Contractor shall coordinate with the Owner provided Contractor (White Mountain, Mike Letts 801-547-9278 or Romac Services 801-759-7315).
 - Provide caulking and painting as necessary to touch up exterior panels of the kiosk.
 - Provide a water tight seal between the kiosk foundation and canopy slab.
 - 3' x 8' Merchandiser
 - Paint all bollards and island forms with Contractor supplied Sherwin Williams Industrial Enamel B54Z Series Paint.
 - Install a diesel tee, plug, and fittings in the MPD sumps of the islands with diesel.
 - Construct 6" Thick Concrete Canopy Drive Slab (See Arch. Plans)
 - Construct 8" Thick Concrete Tank Pad w/ Rebar Reinforcing. (See Arch. Plans for Section)
 - Contractor Shall Construct Dispenser Islands w/ Bollard Protection and Install Fuel Dispenser (See Arch. Plans) (Typ)
 - Overhead Canopy System Supplied and Installed by others. General Contractor to install Footings, Conduits, & Conductors per Drawings by Madison Industries
 - Retail Merchandisers
 - General Contractor to Const. Floor and Foundation then Place Prefabricated Kiosk (See Arch. Plans)
 - Const. Remote Tank Vent Riser Modified for Separator Vent. (See Arch. Plans)
 - Const. 4'x4'x6" Concrete Pad for Air
 - Const. Asphalt Paving
 - Const. 18" Concrete Curb and Gutter
 - General Contractor to Install Mechanical Equipment Screen (Provided by Others)
 - Connect & Match Existing Grade
 - Dumpster Enclosure
 - Provide Smooth Clean Edge, Sawcut Asphalt if Needed
 - Street Improvements; See Work Order #791982 Plans
 - Exist. Retaining Wall
 - Pedestrian Warning Zone Striping (See Arch. Plans)
 - Const. 6' Wide Conc. Paved ADA Crosswalk
 - Const. 4" Paint Stripe (Color: White)
 - Exist. Lot Lines to be Vacated by Platting Action DRB Project #1010174, 14DRB-70263
 - Landscape (See Landscape Plan)
 - Const. 4" Paint Stripe (Color: Yellow)
 - Const. 5' Waterway
 - Pylon Sign by Separate Permit
 - Const. ADA Accessible Striping per MUTCD & ICC/ANSI A117.1 (Latest Editions)
 - Const. ADA Accessible Ramp per MUTCD & ICC/ANSI A117.1 (Latest Edition)
 - Const. ADA Accessible Sign per MUTCD & ICC/ANSI A117.1 (Latest Editions)
 - Const. Conc. Sidewalk
 - Const. Truncated Domes per ICC/ANSI A117.1-2003 (Latest Addition)
 - Const. 7" Thick Conc. Paving
 - Const. (2) 6" Steps
 - Const. "Keystone" Retaining Wall. Contractor to Provide Design Submittal Stamped by New Mexico Licensed Professional Engineer for Approval to Engineer of Record Prior to Construction.

Legal Description
Tracts 2-D and 2-E Municipal Addition No. 1 And A Portion of Tract 2 Of The Replat of Tract "g" Of The Replat of Municipal Addition No. 1 Situate Within Section 36 Township 11 North, Range 3 East New Mexico Principal Meridian City Of Albuquerque, New Mexico

- Legend**
- Proposed Building
 - Proposed Curb & Gutter
 - Proposed Asphalt
 - Proposed Concrete
 - Existing Improvements
 - Existing Asphalt
 - Existing Concrete
 - Existing Building
 - Existing Power Pole
 - Existing Power Pole w/ Guy

- General Site Notes:**
- Stalls designated as Accessible will require a painted Accessible symbol and sign. (See Details)
 - Fire lane markings and signs to be installed as directed by the Fire Marshal.
 - Aisle markings, directional arrows and stop bars will be painted at each driveway as shown on the plans.
 - All dimensions are to back of curb unless otherwise noted.
 - Const. curb transition at all points where curb abuts sidewalk, see detail.
 - Landscape and signing will not interfere with clear sight requirements. Therefore, signs, walls, trees, and shrubbery between 3 and 8 feet tall (as measured from the gutter pan) will not be acceptable in this area.

Survey Control Note:
The contractor or surveyor shall be responsible for following the National Society of Professional Surveyors (NSPS) model standards for any surveying or construction layout to be completed using Anderson Wahlen and Associates ALTA Surveys or Anderson Wahlen and Associates construction improvement plans. Prior to proceeding with construction staking, the surveyor shall be responsible for verifying horizontal control from the survey monuments and for verifying any additional control points shown on an ALTA survey, improvement plan, or on electronic data provided by Anderson Wahlen and Associates. The surveyor shall also use the benchmarks as shown on the plan, and verify them against no less than three existing hard improvement elevations included on these plans or on electronic data provided by Anderson Wahlen and Associates. If any discrepancies are encountered, the surveyor shall immediately notify the engineer and resolve the discrepancies before proceeding with any construction staking.

PRIVATE ENGINEER'S NOTICE TO CONTRACTORS
The Contractor agrees that he shall assume sole and complete responsibility for job site conditions during the course of construction of this project, including safety of all persons and property; that this requirement shall apply continuously and not be limited to normal working hours; and that the contractor shall defend, indemnify, and hold the owner and the engineer harmless from any and all liability, real or alleged, in connection with the performance of work on this project, excepting for liability arising from the sole negligence of the owner or the engineer.

ADA Note:
Contractor must maintain a running slope on Accessible routes no steeper than 5.0% (1:20). The cross slope for Accessible routes must be no steeper than 2.0% (1:50). All Accessible routes must have a minimum clear width of 36". If Grades on plans do not meet this requirement notify Consultant immediately.
The Client, Contractor and Subcontractor should immediately notify the Consultant of any conditions of the project that they believe do not comply with the current state of the ADA (ICC/ANSI A117.1-Latest Edition) and/or FHAA.

Smith's
FOOD & DRUG STORES
#485
Albuquerque, NM

Anderson Wahlen & Associates
Great Basin Engineering South
2010 North Redwood Road, Salt Lake City, Utah 84116
801.521.8529 - AWAengineering.net

Traffic Circulation / Site Plan
Smith's #485 Fuel Center
6941 Montgomery Blvd.
Albuquerque, NM

22 Aug, 2014
SHEET NO.
C1.1