

SITE NOTES

1. ALL WORK AND MATERIALS SHALL COMPLY WITH ALL CITY/COUNTY REGULATIONS AND CODES AND O.S.H.A. STANDARDS.
2. CONTRACTOR SHALL REFER TO THE ARCHITECTURAL/MEP PLANS FOR SITE LIGHTING & ELECTRICAL PLAN.
3. REFERENCE ARCHITECTURAL PLANS FOR DUMPSTER ENCLOSURE DETAILS.
4. SITE BOUNDARY, TOPOGRAPHY, UTILITY AND ROAD INFORMATION TAKEN FROM A SURVEY BY PRECISION SURVEY, INC. DATED SEPTEMBER 2023.
5. ALL PROPOSED PAVING IN CITY R.O.W. AND EASEMENTS TO CONFORM TO CITY OF ALBUQUERQUE STANDARDS.
6. REFER TO ALTA SURVEY BY PRECISION SURVEY IN SEPTEMBER 2023 FOR PROPERTY LINE DIMENSIONS.
7. ALL WORK IN COORS BLVD NW AND ST JOSEPH'S DRIVE NW SHOWN FOR REFERENCE ONLY, TO BE DESIGNED, PERMITTED, AND CONSTRUCTED BY OTHERS.
8. CONTRACTOR IS RESPONSIBLE FOR REPLACING SIDEWALK IN THE ROW THAT IS DAMAGED AS A RESULT OF ONSITE CONSTRUCTION ACTIVITIES.

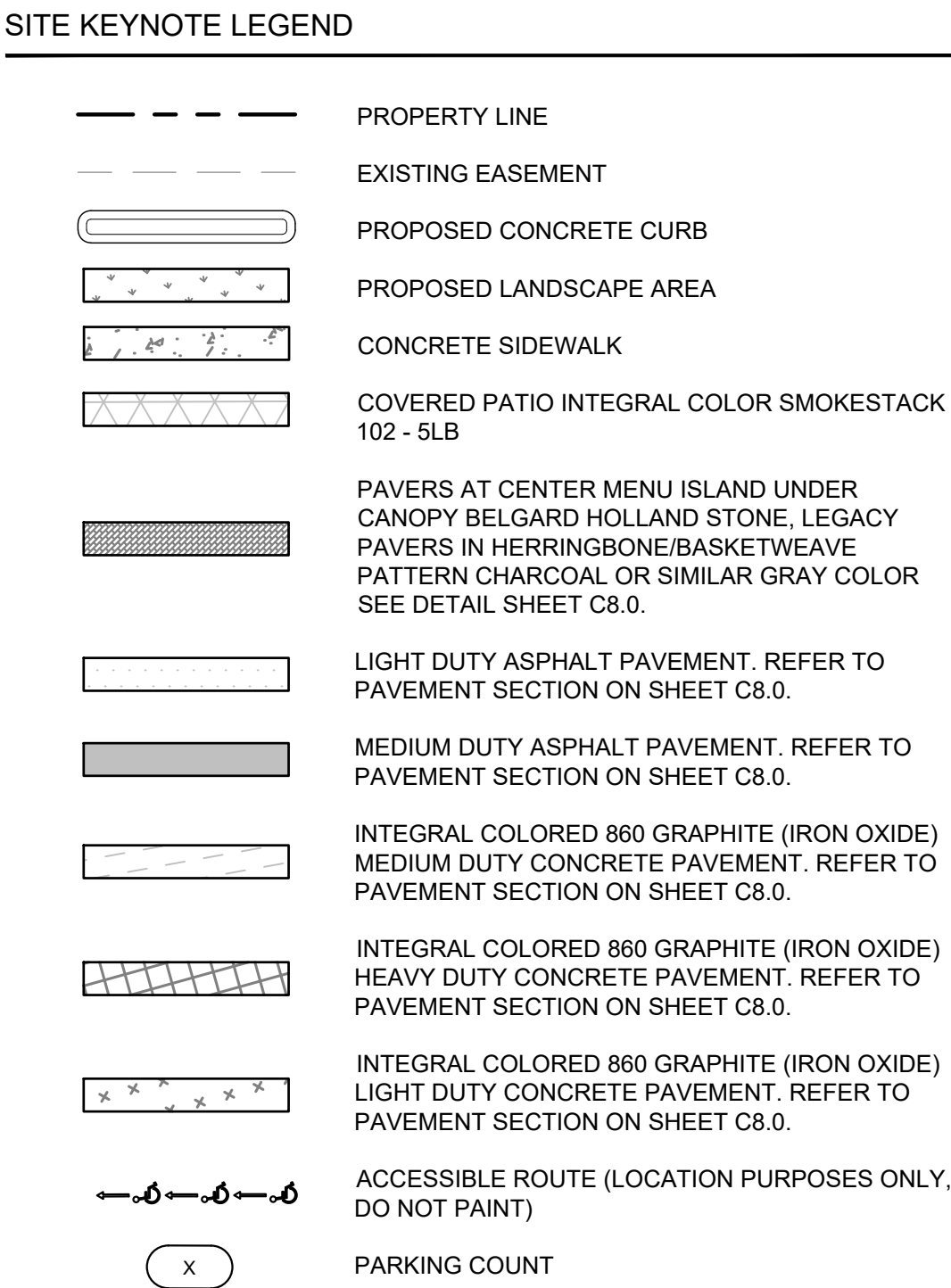

KEYNOTE LEGEND	
(A1)	PROPOSED CONCRETE CURB
(A2)	PROPOSED CURB AND GUTTER
(A3)	PROPOSED VALLEY GUTTER
(B)	PROPOSED MULTI-TENANT PYLON SIGN
(C)	PROPOSED RECYCLING/TRASH DUMPSTER LOCATION, REFER TO ARCH.
(D)	PROPOSED SITE SIGN, REFER TO SIGNAGE AND STRIPING PLAN FOR MORE DETAIL.
(E)	PROPOSED DIRECTIONAL PAVEMENT MARKING, REFER TO SIGNAGE AND STRIPING PLAN FOR MORE DETAIL.
(F)	PROPOSED CURB RAMP AND TRUNCATED DOMES
(G)	PROPOSED CONCRETE SIDEWALK
(H)	PROPOSED BOLLARD
(I)	PROPOSED LANDSCAPE AREA
(J)	PROPOSED ACCESSIBLE PARKING STALL, REFER TO SIGNAGE AND STRIPING PLAN FOR MORE DETAIL.
(K)	PROPOSED DRIVE THRU CANOPY, REFER TO ARCH PLANS.
(L)	PROPOSED DRIVE THRU ORDER BOARD, REFER TO ARCH PLANS.
(M)	PROPOSED WHEEL STOPS
(N)	PROPOSED PAVEMENT STRIPING, REFER TO SIGNAGE AND STRIPING PLAN FOR MORE DETAIL.
(O)	PROPOSED COVERED PATIO INTEGRAL COLOR SMOKESTACK 102 - SLB
(P)	PROPOSED LIGHT DUTY ASPHALT PAVEMENT
(Q)	PROPOSED MEDIUM DUTY ASPHALT PAVEMENT
(R)	PROPOSED INTEGRAL COLORED 860 GRAPHITE (IRON OXIDE) LIGHT DUTY CONCRETE PAVEMENT
(S)	PROPOSED INTEGRAL COLORED 860 GRAPHITE (IRON OXIDE) HEAVY DUTY CONCRETE PAVEMENT
(T)	PROPOSED INVERTED-U STYLE BIKE RACK



SHEET NUMBER		C5.0	
PROPOSED RAISING CANE'S RESTAURANT AND DRIVE-THRU		ST. JOSEPHS DR. NW & COORS BLVD NW	
SITE KEYNOTE PLAN		ZONE ATLAS PAGE G-11-Z ALBUQUERQUE; NMI 87120	
KHA PROJECT 090042013		DATE 4/18/2024	
SCALE AS SHOWN		DESIGNED BY SP	
DRAWN BY		CHECKED BY LW	
© 2024 KIMLEY-HORN AND ASSOCIATES, INC. 1201 3RD AVE, SUITE 2800, SEATTLE, WA 98101 PHONE: 206-607-2800 WWW.KIMLEY-HORN.COM		Kimley»Horn	
ELIZABETH ANNE WILLIOT NEW MEXICO 28862 PROFESSIONAL ENGINEER 04/18/2024			
		No.	
		REVISIONS	
		DATE	
		BY	

Plotted By: Willmnd, Ltz, Sheet Set: C1156 Albuquerque NM Sheet Set, Layout: DIMENSIONAL CONTROL, April 18, 2024, 04:41:42pm, K:\SEA, C:\156A_DS\09042013 - C1156 - Coors & St. Josephs, Albuquerque NM\CAD\Plots\Sheets\C-SITE KEYNOTE PLAN.dwg, This document, together with the concepts and designs presented herein, as an instrument of service, is intended only for the specific purpose and client for which it was prepared. Reuse of and improper reliance on this document without written author

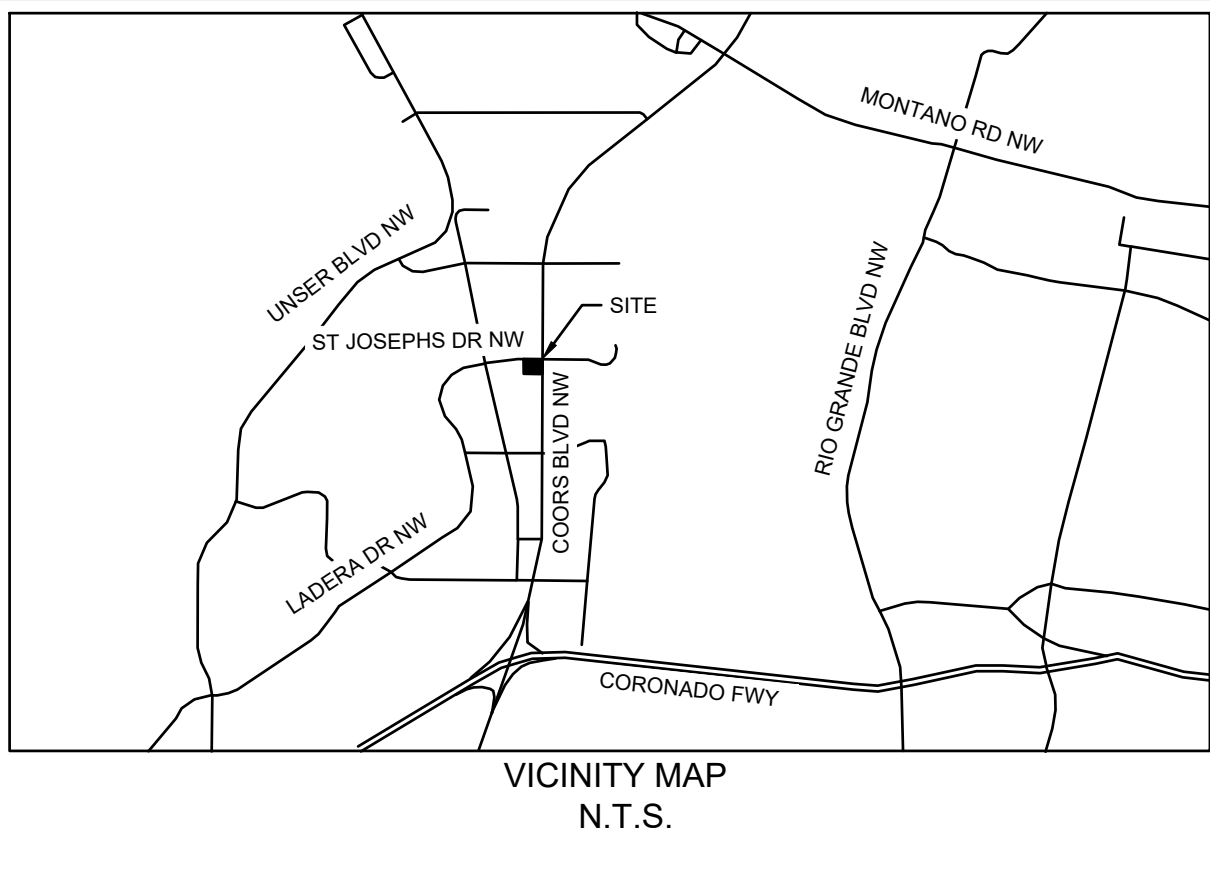
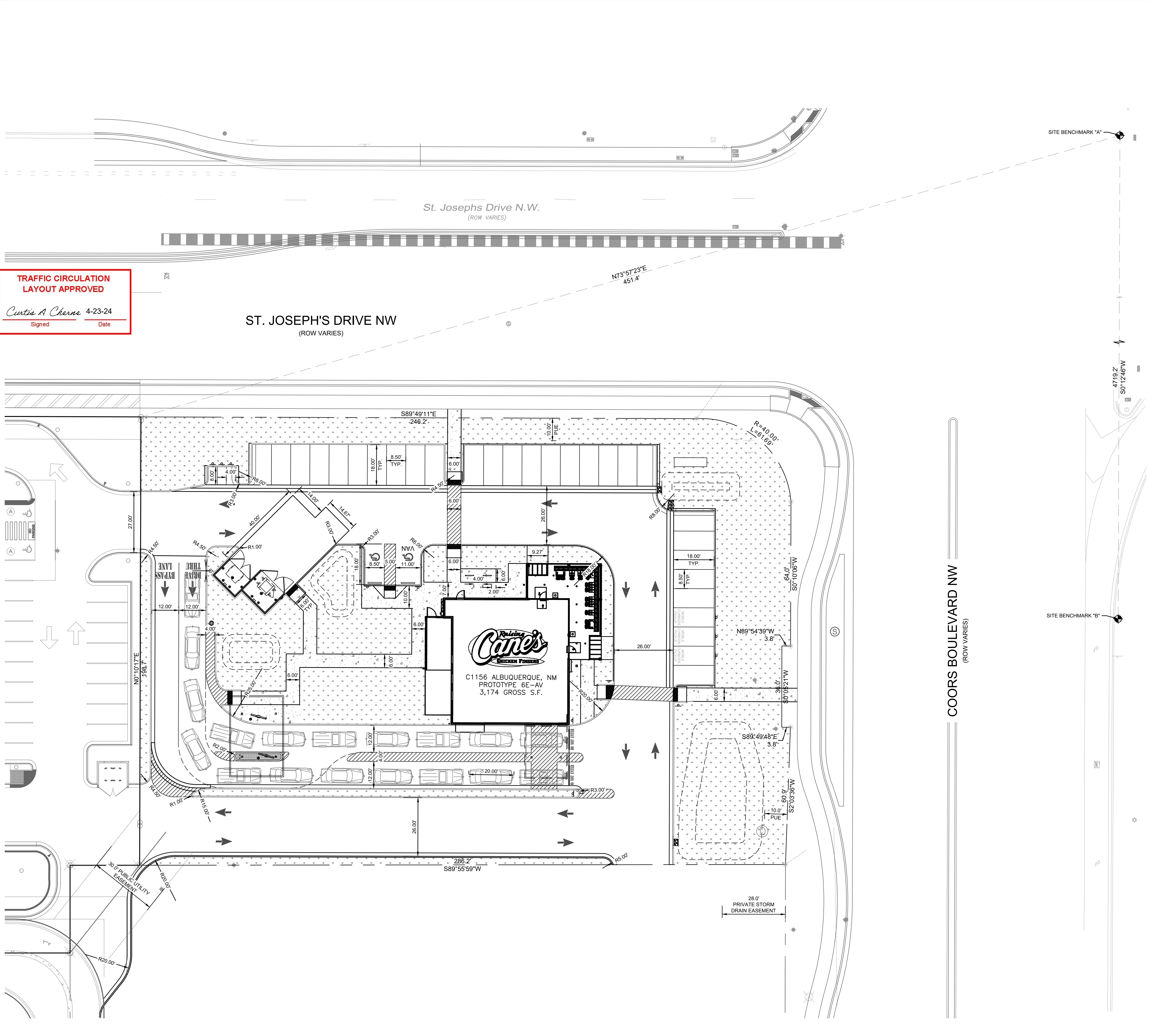

DIMENSIONAL CONTROL LEGEND

- PROPERTY LINE
- EXISTING EASEMENT
- PROPOSED CONCRETE CURB
- PROPOSED LANDSCAPE AREA
- CONCRETE SIDEWALK
- SITE BENCHMARK

SITE BENCHMARK NOTES

- ◆ SITE BENCHMARK "A"**
A.G.R.S. MONUMENT "8_G11" STANDARD N.G.S. BRASS DISK (FOUND IN PLACE)
NEW MEXICO STATE PLANE COORDINATES (CENTRAL ZONE - N.A.D. 1983)
N = 1502236.625 US SURVEY FEET
E = 1505431.887 US SURVEY FEET
PUBLISHED EL = 5116.009 US SURVEY FEET (NAVD 1988)
GROUND TO GRID FACTOR = 0.999680082
DELTA ALPHA ANGLE = -0°15'35.17"
- ◆ SITE BENCHMARK "B"**
A.G.R.S. MONUMENT "12_H11" STANDARD N.G.S. BRASS DISK (FOUND IN PLACE)
NEW MEXICO STATE PLANE COORDINATES (CENTRAL ZONE - N.A.D. 1983)
N = 1497519.02 US SURVEY FEET
E = 1505414.361 US SURVEY FEET
PUBLISHED EL = 5104.854 US SURVEY FEET (NAVD 1988)
GROUND TO GRID FACTOR = 0.999680622
DELTA ALPHA ANGLE = -0°15'34.84"



KHA PROJECT 090042013				DATE 4/18/2024				SCALE AS SHOWN				DESIGNED BY SP				DRAWN BY SP				CHECKED BY LW			
DIMENSIONAL CONTROL PLAN																							
PROPOSED RAISING CANE'S RESTAURANT AND DRIVE-THRU																							
SHEET NUMBER C5.1																							
ZONE ATLAS PAGE G-11-Z ALBUQUERQUE, NM 87120																							
ST JOSEPHS DR. NW & COORS BLVD NW																							
BY DATE																							
REVISIONS																							
No.																							

Kimley»Horn

© 2024 KIMLEY-HORN AND ASSOCIATES, INC.
1201 3RD AVE, SUITE 2800, SEATTLE, WA 98101
PHONE: 206-607-2600
WWW.KIMLEY-HORN.COM

ELIZABETH ANNE WILLYOT
NEW MEXICO
28862
Professional Engineer
04/18/2024

Plotted By: Wilfred, L.P. Sheet Set: C1156 Albuquerque NM Sheet Set Layout: SIGN.1 April 18, 2024 04:42:03pm K:\SEA Civil\SEA_0509042 - Raising Cane's\09042013 - C1156 - Coors & St. Josephs, Albuquerque NM\CAD\PlanSheets\C-SIGNAGE AND STRIPING.dwg
This document, together with the concepts and designs presented herein, is an instrument of service, as intended only for the specific purpose and client for which it was prepared. Reuse of and improper reliance on this document without written authorization and adaptation by Kimley-Horn and Associates, Inc. shall be without liability to Kimley-Horn and Associates, Inc.

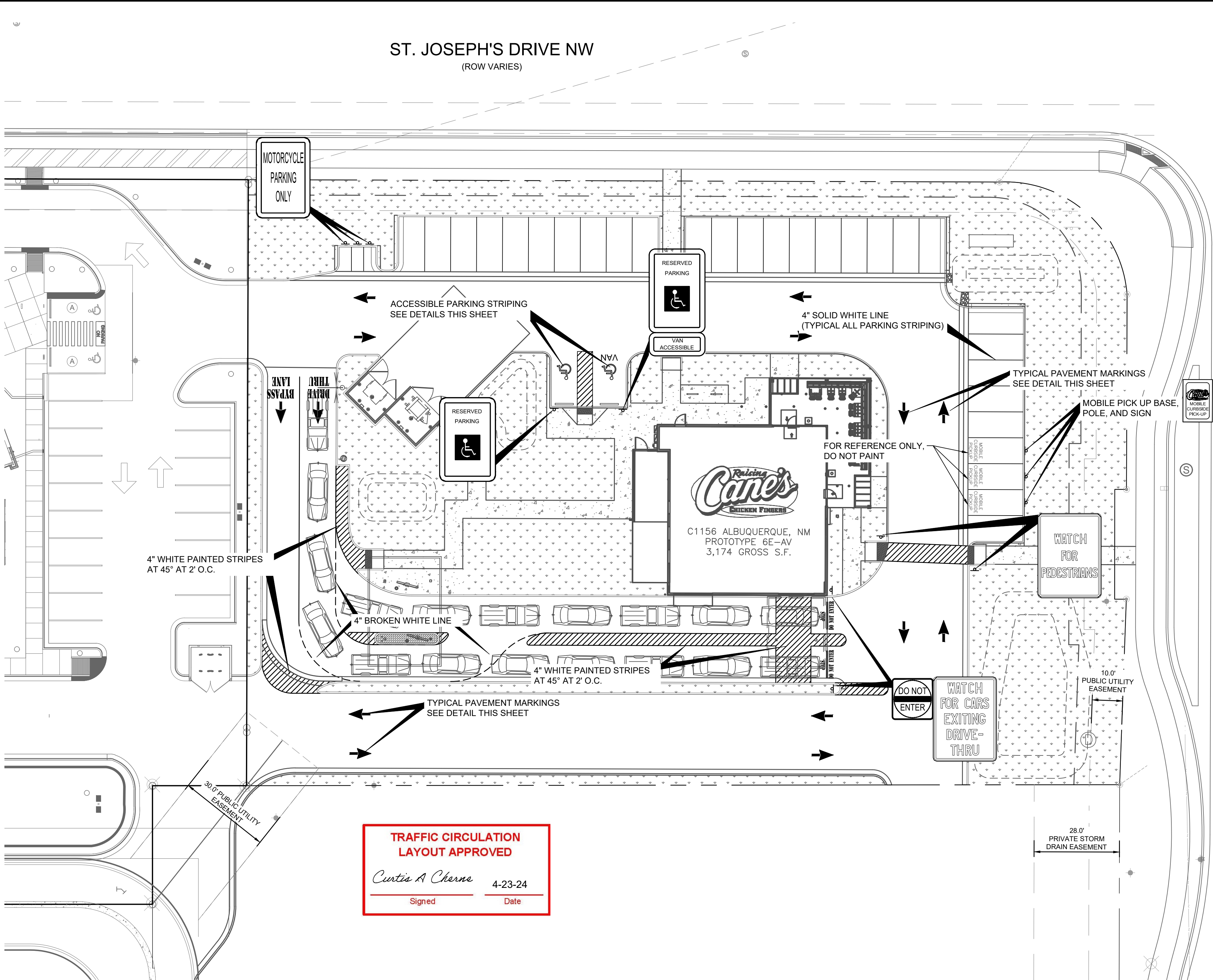

**TRAFFIC CIRCULATION
LAYOUT APPROVED**

Curtis A. Cherna 4-23-24
Signed Date



MOTORCYCLE PARKING SIGNAGE
N.T.S.

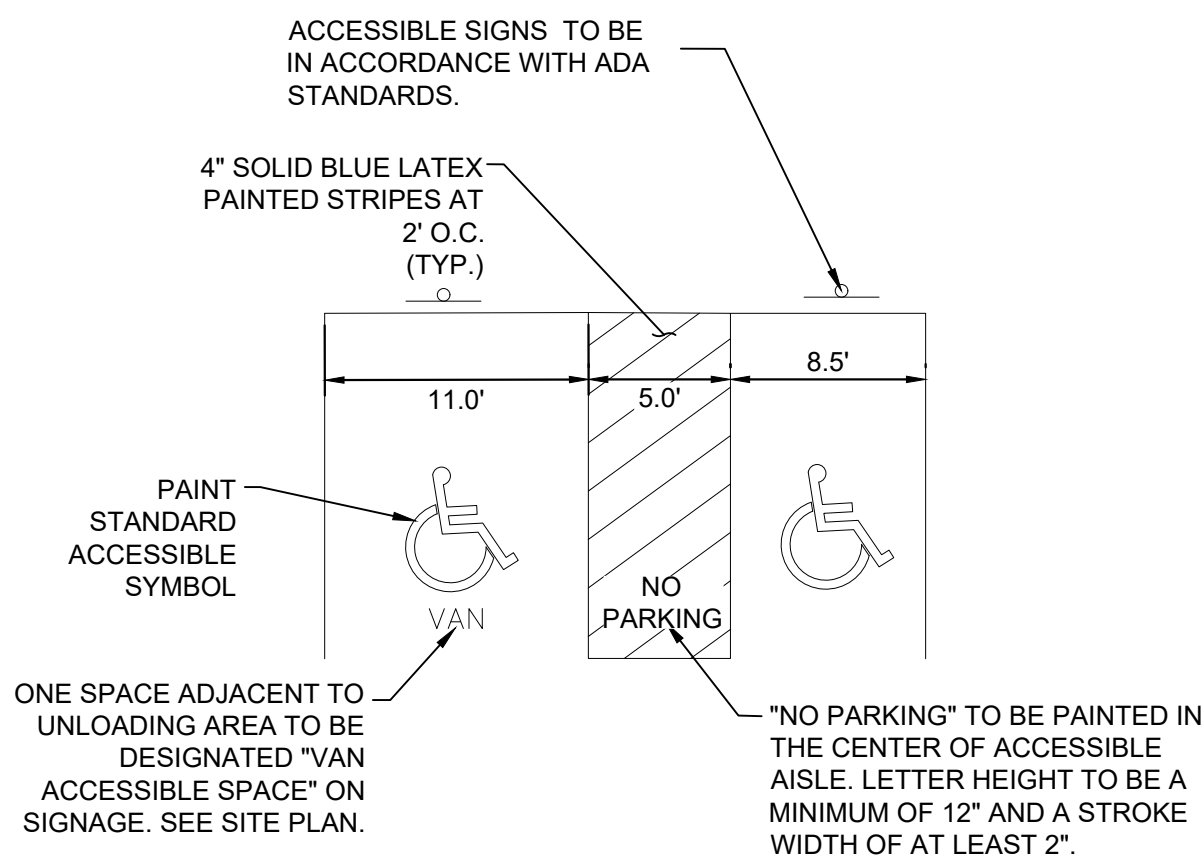
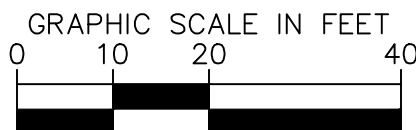
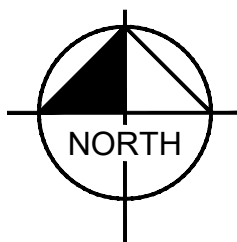

- NOTES:
- DIMENSIONS MAY VARY REFER TO SITE GEOMETRICS PLAN.
 - SIGNAGE AND MARKINGS TO BE IN ACCORDANCE WITH FEDERAL, STATE AND LOCAL REGULATIONS.

ACCESSIBLE PARKING DETAIL
N.T.S.

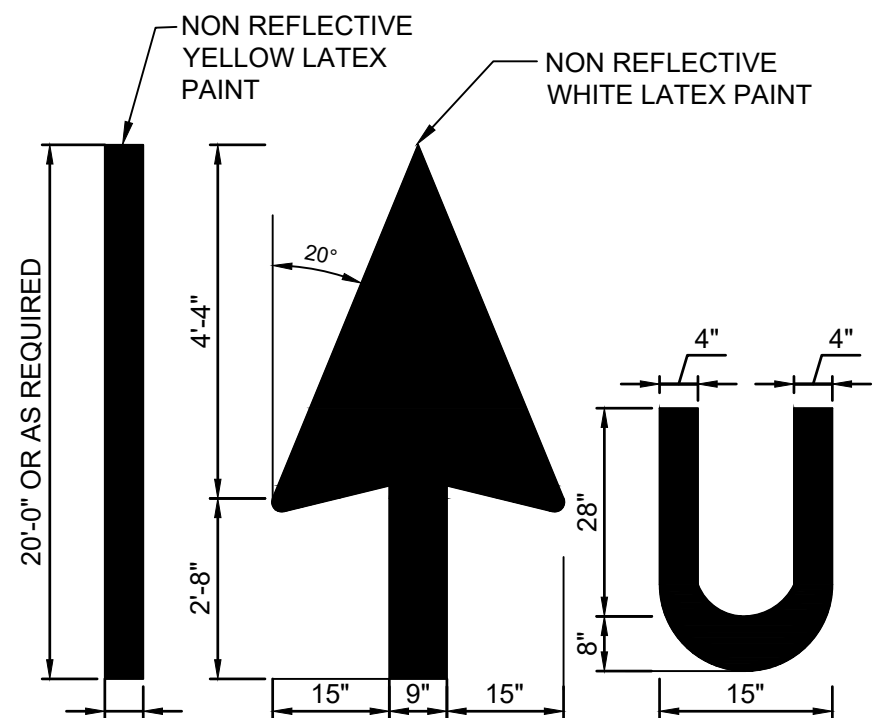

TYPICAL PAVEMENT MARKINGS
N.T.S.

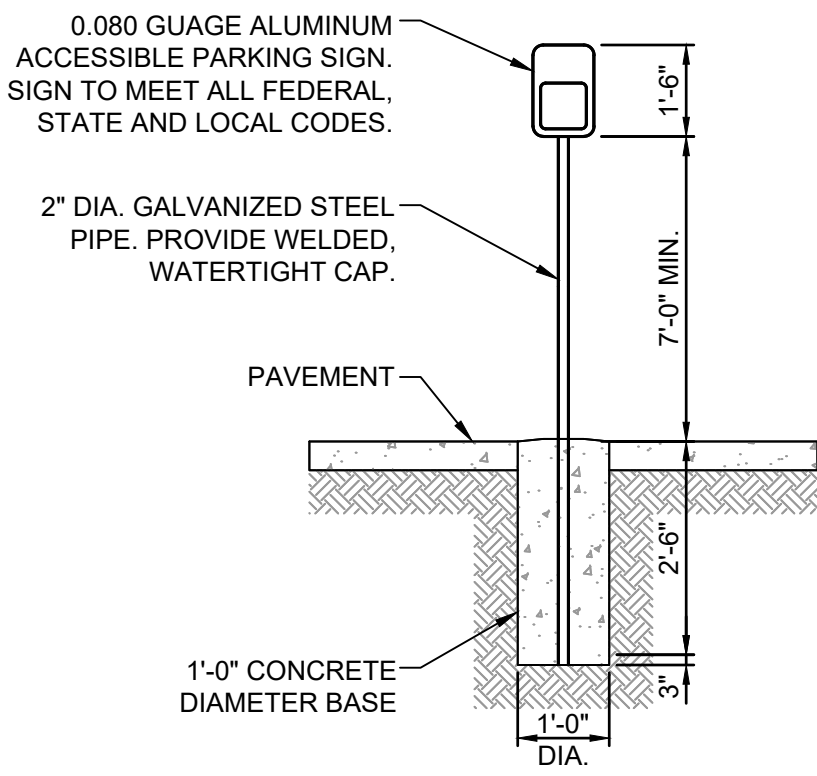

"ACCESSIBLE PARKING" SIGN POST DETAIL
N.T.S.

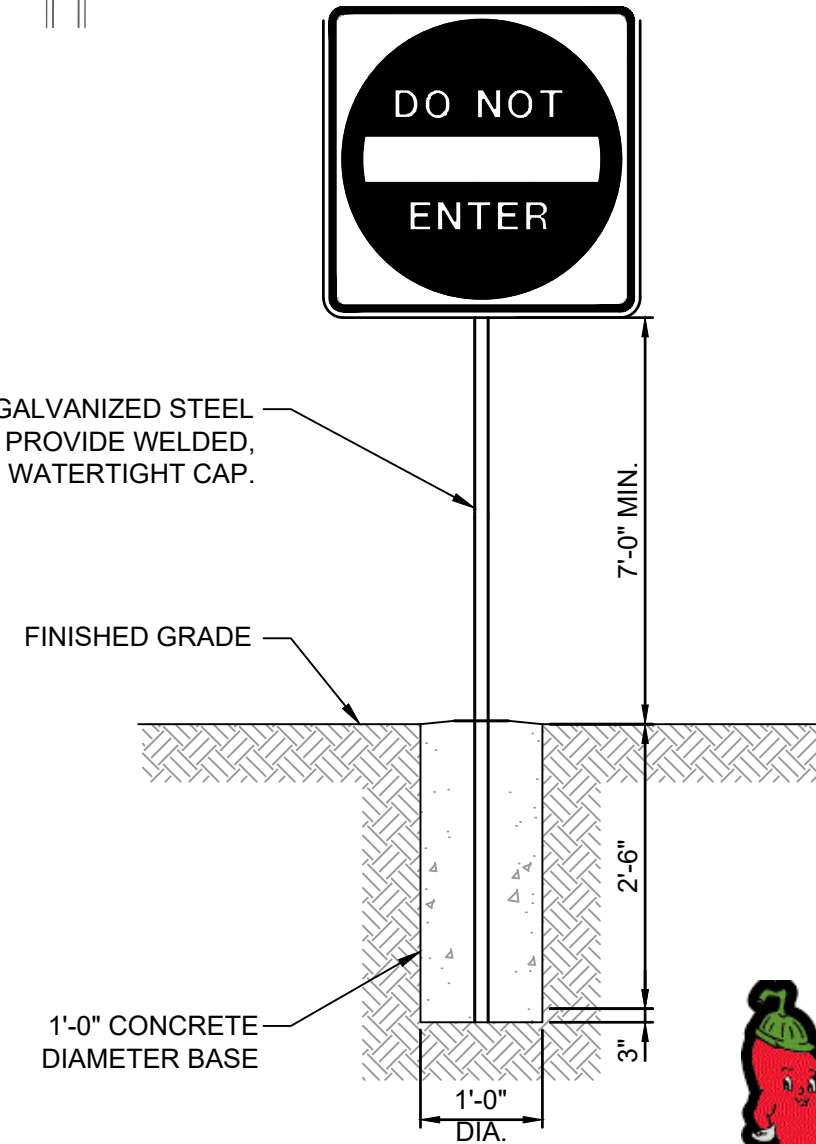

SIGN POST DETAIL
N.T.S.

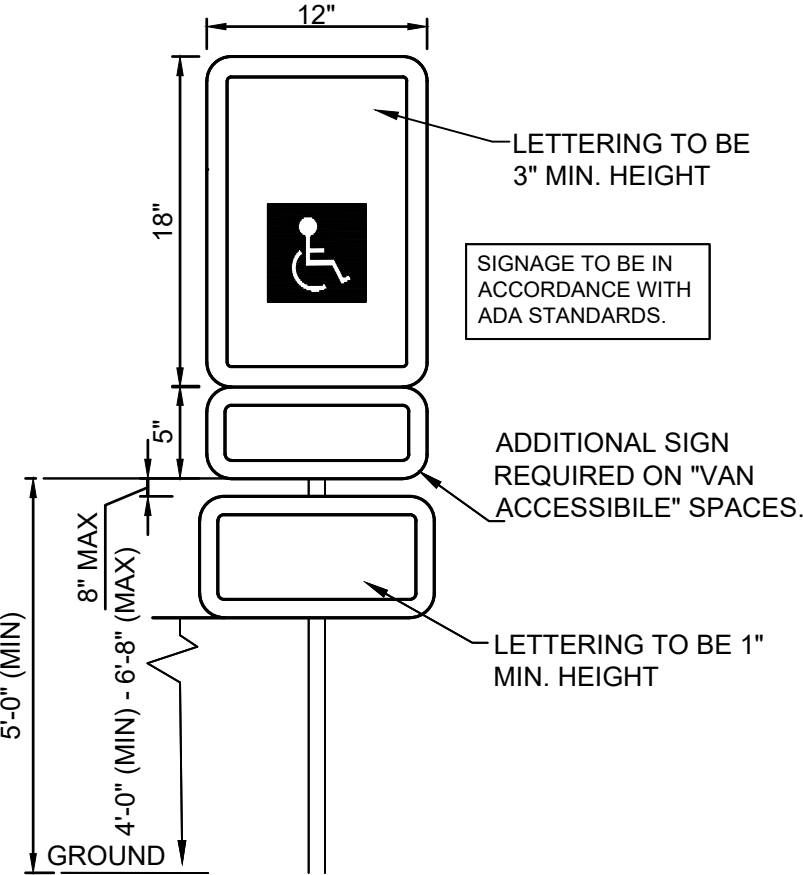

ADA SIGN DETAIL
N.T.S.

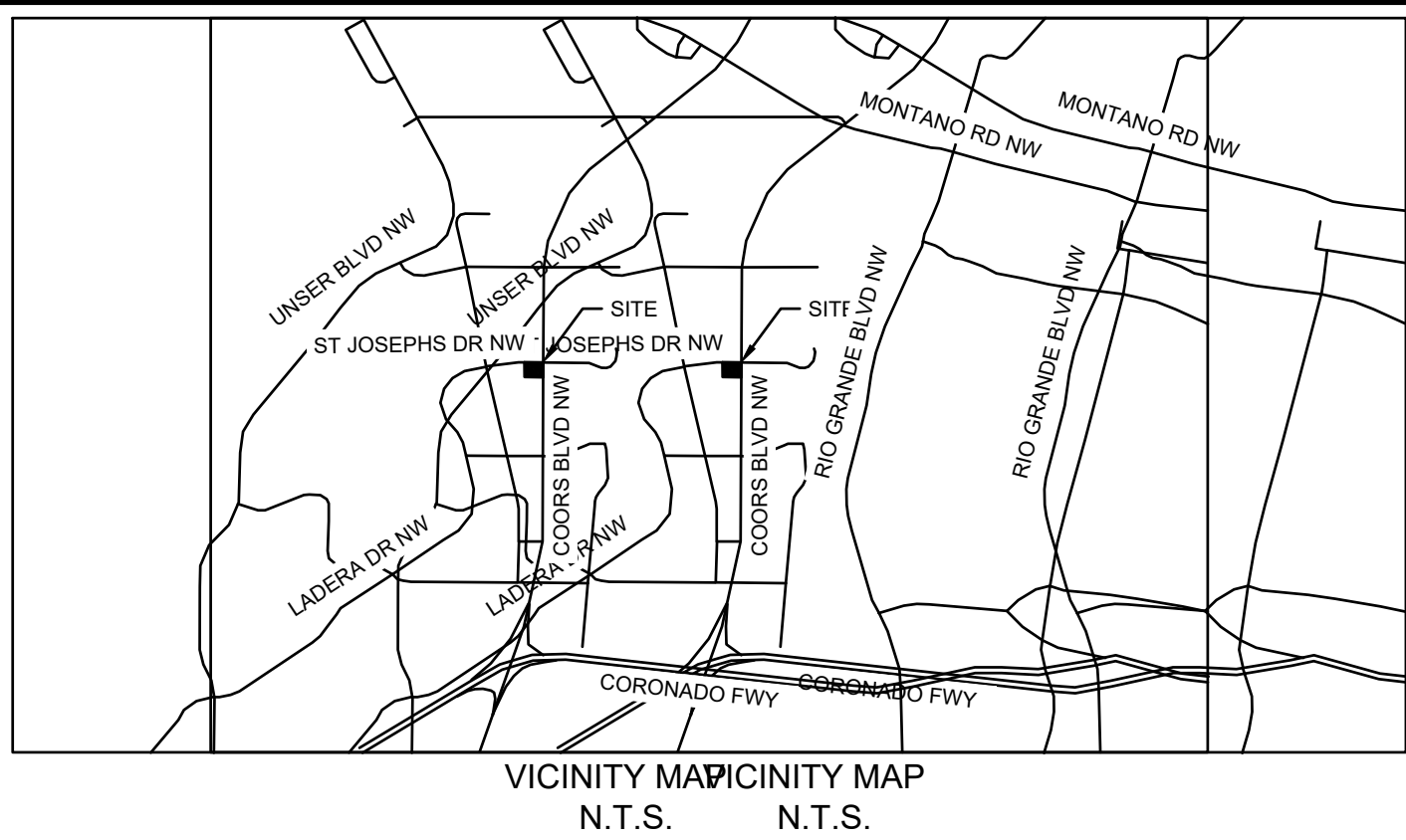
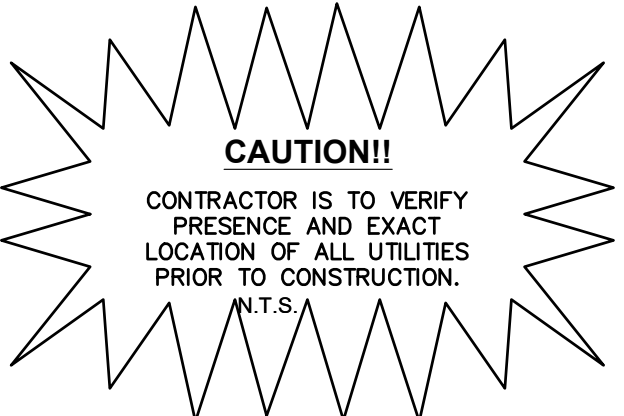

VICINITY MAP
N.T.S.

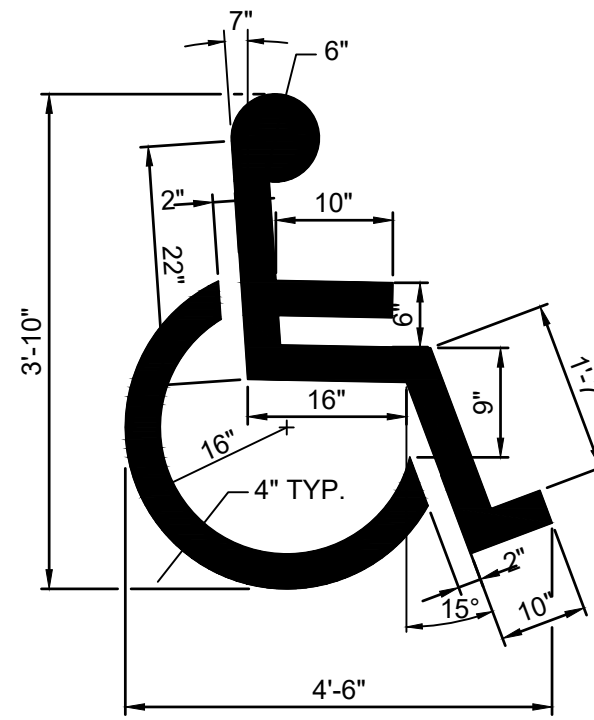
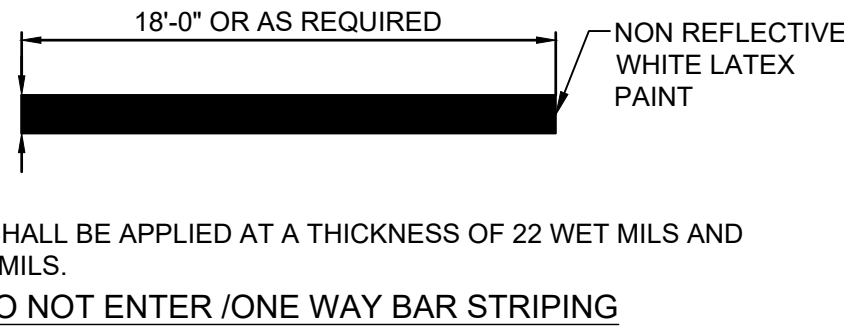

ACCESSIBLE PARKING SYMBOL DETAIL
N.T.S.

NO.	REVISIONS	DATE	BY

Kimley»Horn

© 2024 KIMLEY-HORN AND ASSOCIATES, INC.
1201 3RD AVE. SUITE 2800, SEATTLE, WA 98101
PHONE: 206-607-2800
WWW.KIMLEY-HORN.COM

ELIZABETH ANNE WILKOT
NEW MEXICO
28862
Professional Engineer
04/18/2024

KHA PROJECT	09042013	DATE	4/18/2024	SCALE	AS SHOWN	DESIGNED BY	SP	DRAWN BY	SP	CHECKED BY	LW
-------------	----------	------	-----------	-------	----------	-------------	----	----------	----	------------	----

SIGNAGE AND STRIPING PLAN

**PROPOSED RAISING CANE'S
RESTAURANT AND DRIVE-THRU**

ST JOSEPHS DR. NW
& COORS BLVD NW

ZONE ATLAS PAGE G-11-Z
ALBUQUERQUE, NM 87120

SHEET NUMBER
C5.2

Plotted By: Wilmet Lir, Sheet Set: C1156 Albuquerque NM Sheet Set, Layout: DETAILS 1, April 18, 2024, 04:42:04pm, K:\SEA, Civil\SEA, DS\090042 - Raising Cane's\090042\13 - C1156 - Coors & St. Josephs, Albuquerque NM\CAD\PlanSheets\C-DETAILS.dwg
This document, together with the concepts and designs presented herein, as an instrument of service, is intended only for the specific purpose and client for which it was prepared. Reuse of and improper reliance on this document without written authorization and adaptation by Kimley-Horn and Associates, Inc. shall be without liability to Kimley-Horn and Associates, Inc.

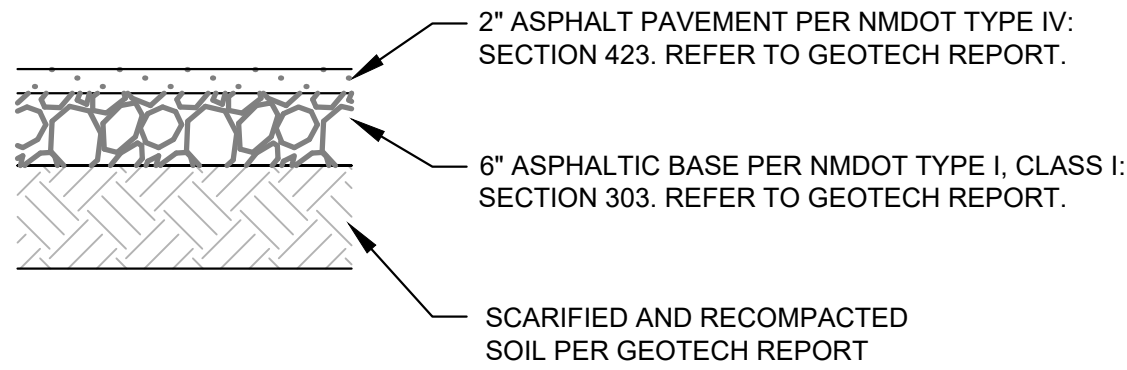

LIGHT DUTY ASPHALT PAVEMENT SECTION

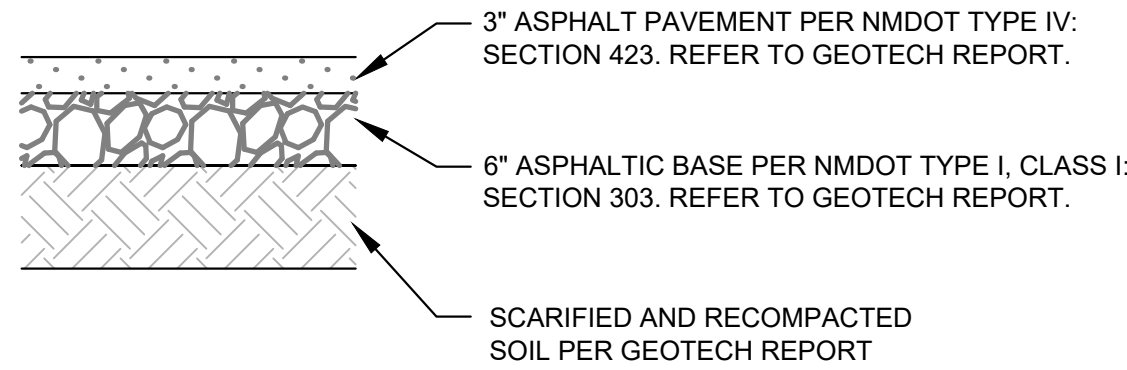

MEDIUM DUTY ASPHALT PAVEMENT SECTION

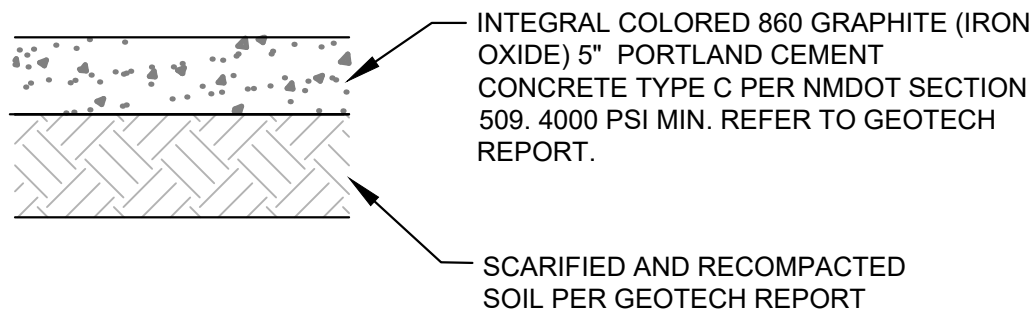

INTEGRAL COLORED
LIGHT DUTY CONCRETE PAVEMENT SECTION

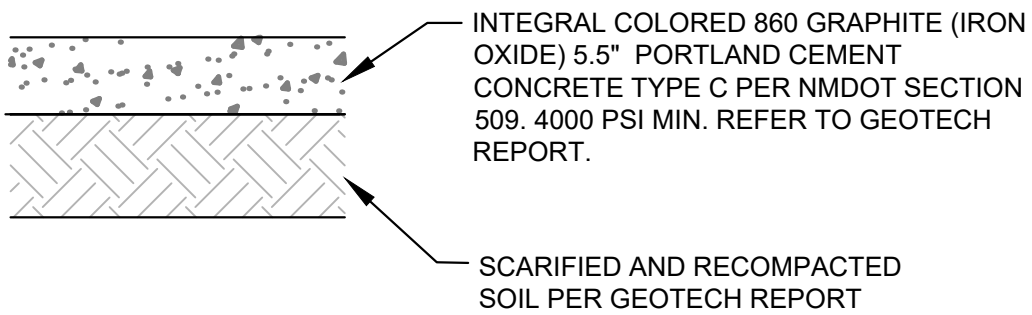

INTEGRAL COLORED
MEDIUM DUTY CONCRETE PAVEMENT SECTION

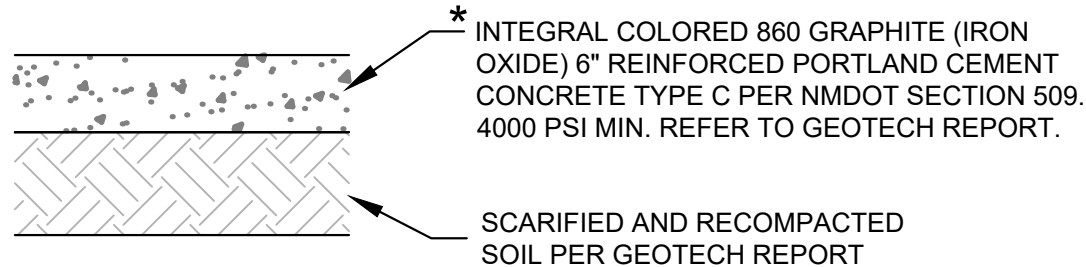

* CONCRETE FOR RIGID PAVEMENT SHOULD HAVE A MINIMUM 28-DAY COMPRESSIVE STRENGTH OF 4,000 PSI AND BE PLACED WITH A MAXIMUM SLUMP OF 4 INCHES.

INTEGRAL COLORED
DUMPSTER PAD CONCRETE PAVEMENT SECTION

MANUFACTURER: BELGARD
PHONE: 877-235-4273
WEB: WWW.BELGARD.COM

PRODUCT: HOLLAND STONE LEGACY
COLOR: CHARCOAL OR APPROVED EQUAL
SIZE: 3 15/16" x 7 7/8" x 2 3/8"

PATTERN: HERRINGBONE

NOTES:
1. PAVEMENT JOINTS TO BE BUTT TIGHT
2. BROOM SWEEP JOINTS WITH POLYMERIC SAND.

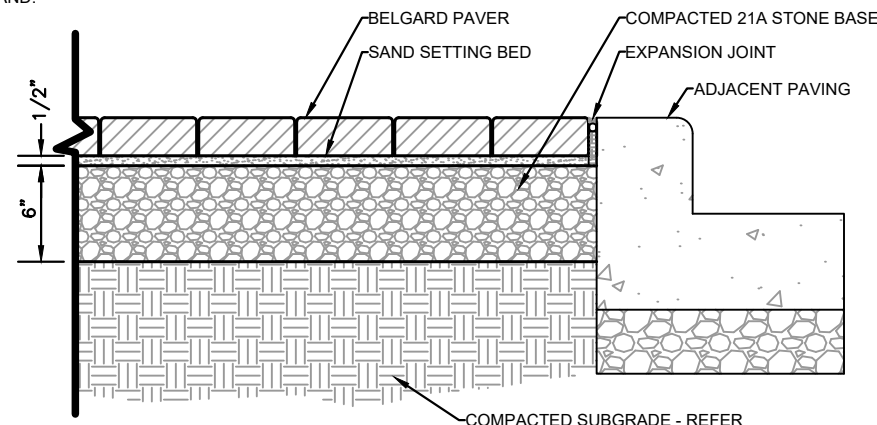

UNIT PAVERS DETAIL

N.T.S.

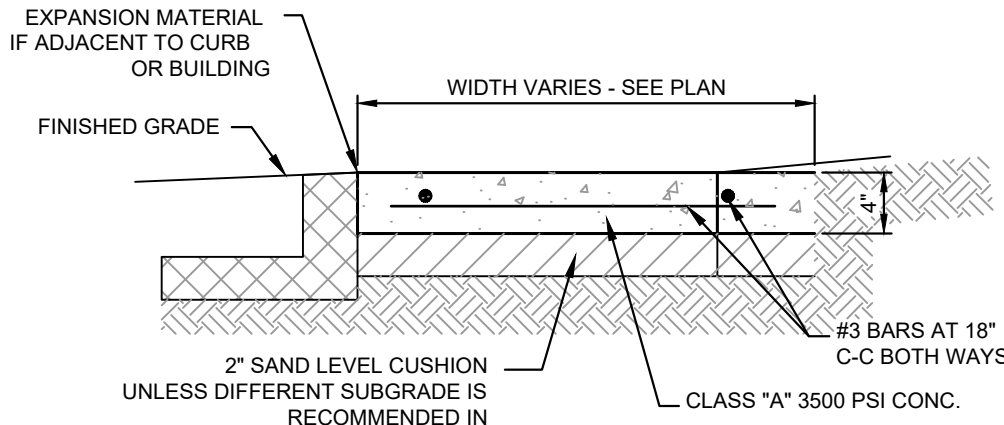

- NOTES:
1. PROVIDE BITUMINOUS EXPANSION MATERIAL WHERE WALK ABUTS EXISTING IMPROVEMENTS AND AT ALL CHANGES IN GRADE.
 2. SPACE CONTROL JOINT UNIFORMLY AT INTERVALS EQUAL TO THE WALK WIDTH OR AS SHOWN ON ARCHITECTURAL PLANS.
 3. PLACE PREMOLED EXPANSION JOINT MATERIAL AROUND ALL STRUCTURES IN NEW WALK ALONGSIDE ALL ADJACENT BUILDINGS AND ABUTTING STRUCTURES TO THE NEW CONCRETE SIDEWALK.
 4. SEAL EXPANSION & CONTRACTION JOINTS WITH AN APPROVED TYPE SEALANT.
 5. SIDEWALK PAVEMENT WHERE PATIO FURNITURE IS TO BE PLACED MUST BE 4000 PSI.

NOTE:
REFER TO GEOTECH REPORT FOR FURTHER INFORMATION.

CONCRETE SIDEWALK DETAIL

N.T.S.

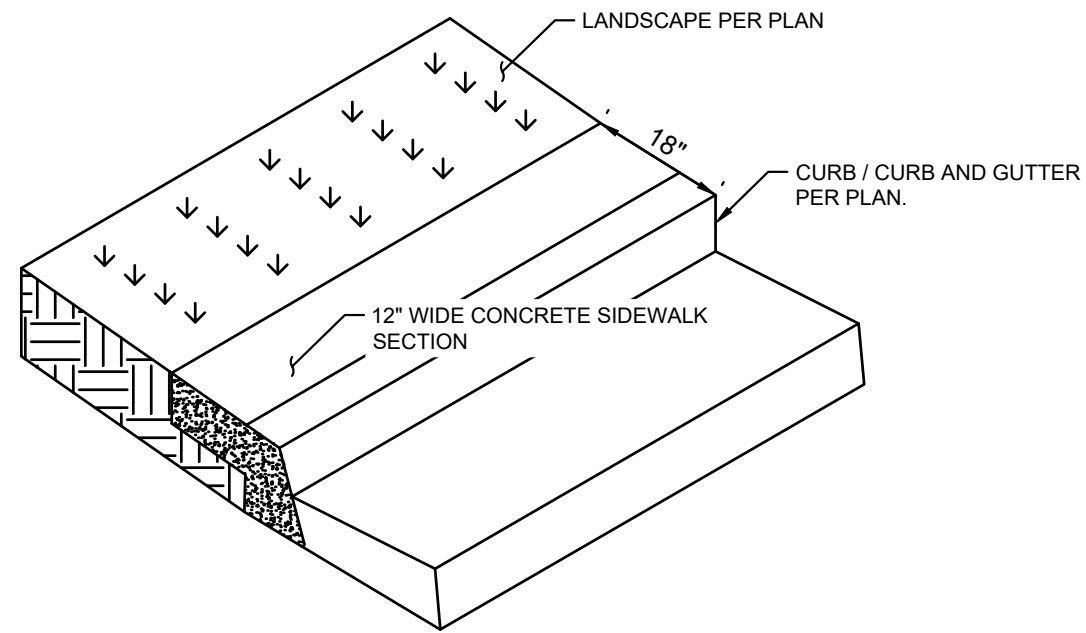

18" WALK-OFF CURB DETAIL

N.T.S.

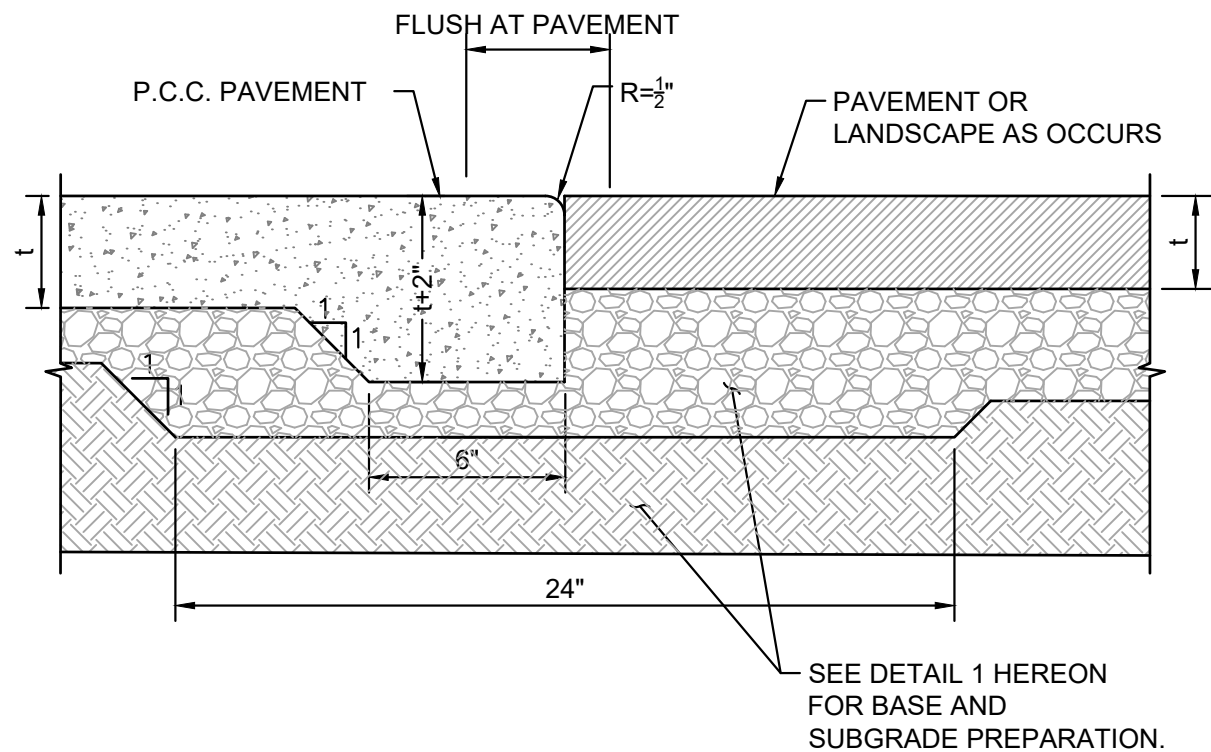

NOTES:

1. APPROVED BONDING AGENT SHALL BE APPLIED AT CONSTRUCTION JOINT.
2. SEE DETAIL 1 FOR PAVEMENT SECTION AND THICKNESS (I).
3. DETAIL APPLIES AT ALL SIDEWALK EDGE CONDITIONS AND PAVEMENT TRANSITIONS

THICKENED EDGE DETAIL

N.T.S.

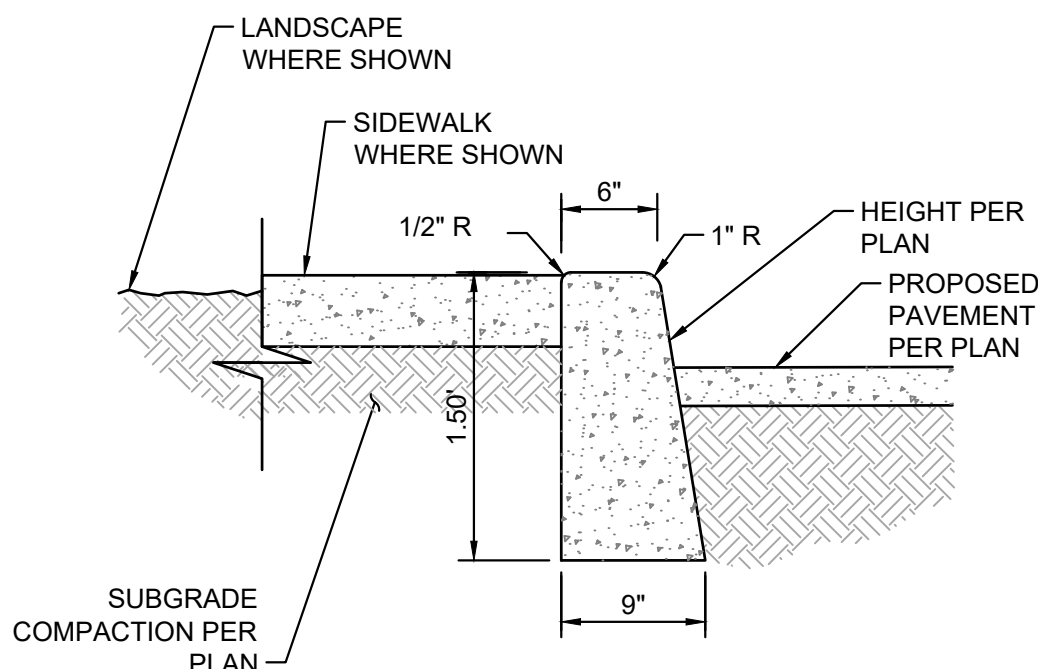

NOTES:

1. CONCRETE SHALL BE 2500 PSI.
2. ISOLATION JOINTS SHALL BE PLACED ONLY AS SPECIFIED
3. CONTRACTION JOINTS CONSISTING OF 1" DEEP SCORES SHALL BE PLACED AT 15' INTERVALS O.C.
4. WHERE A WALK IS ADJACENT TO THE CURB THE JOINTS SHALL ALIGN WITH JOINTS IN THE WALK.

CONCRETE CURB DETAIL

N.T.S.

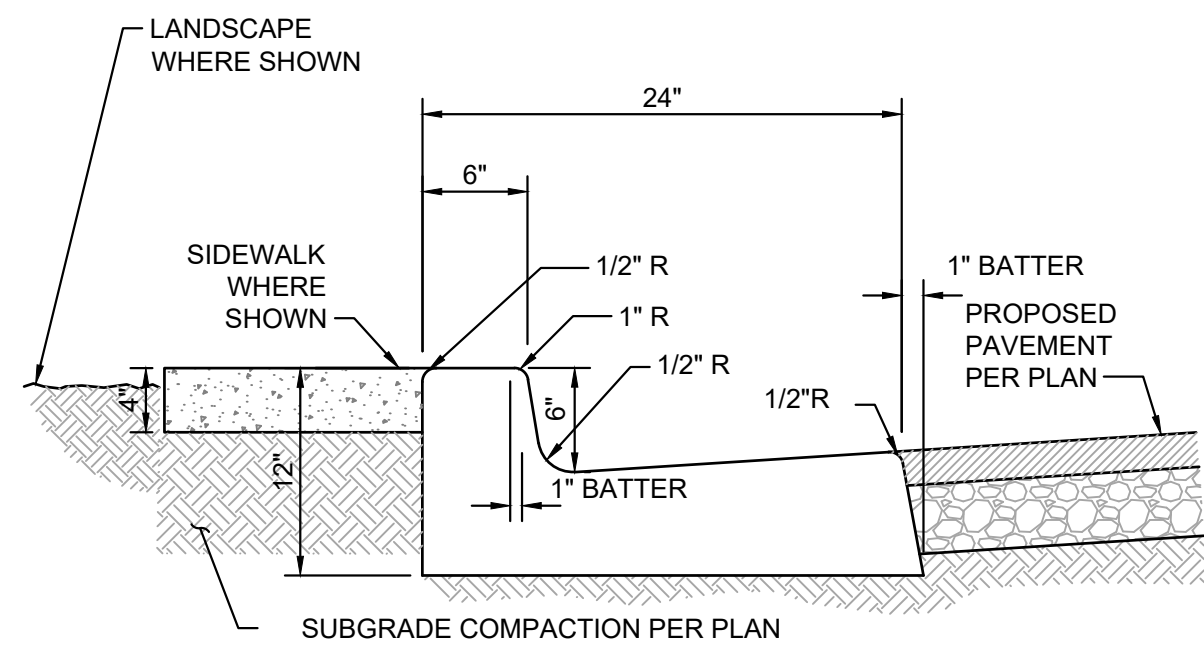

NOTES:

1. CONCRETE SHALL BE 2500 PSI.
2. ISOLATION JOINTS SHALL BE PLACED ONLY AS SPECIFIED
3. CONTRACTION JOINTS CONSISTING OF 1" DEEP SCORES SHALL BE PLACED AT 15' INTERVALS O.C.
4. WHERE A WALK IS ADJACENT TO THE CURB THE JOINTS SHALL ALIGN WITH JOINTS IN THE WALK.

CONCRETE CURB & GUTTER DETAIL

N.T.S.

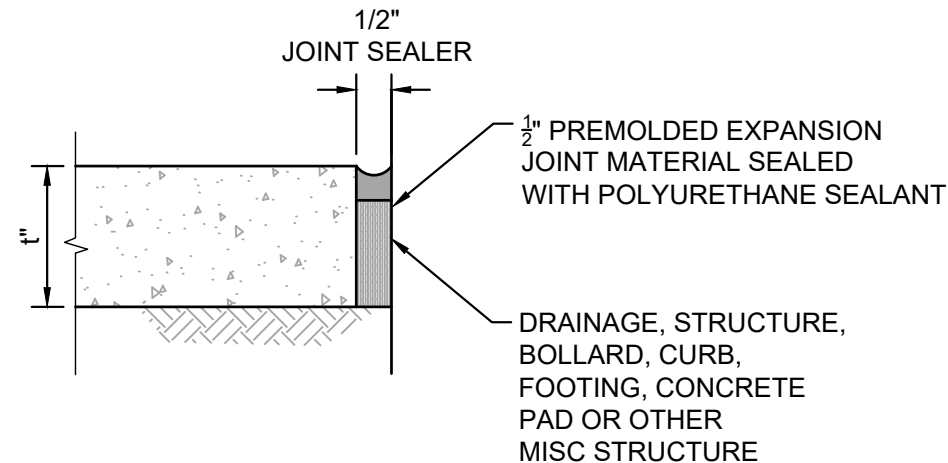

ISOLATION JOINT AT STRUCTURE DETAIL

N.T.S.

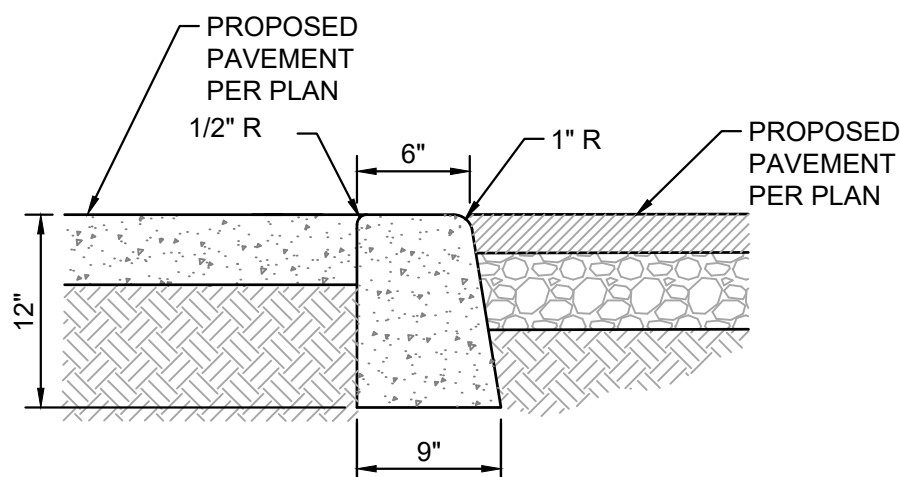

0" CONCRETE CURB DETAIL

N.T.S.

NOTES:

1. CONCRETE SHALL BE 2500 PSI.
2. ISOLATION JOINTS SHALL BE PLACED ONLY AS SPECIFIED
3. CONTRACTION JOINTS CONSISTING OF 1" DEEP SCORES SHALL BE PLACED AT 15' INTERVALS O.C.
4. WHERE A WALK IS ADJACENT TO THE CURB THE JOINTS SHALL ALIGN WITH JOINTS IN THE WALK.



NO.	REVISIONS	DATE	BY

Kimley»Horn

© 2024 KIMLEY-HORN AND ASSOCIATES, INC.
1201 3RD AVE, SUITE 2800, SEATTLE, WA 98101
PHONE: 206-607-2800
WWW.KIMLEY-HORN.COM

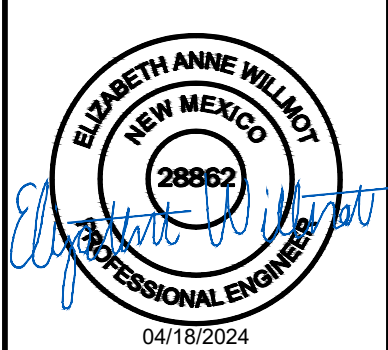

KHA PROJECT	DATE	SCALE	AS SHOWN	DESIGNED BY	SP	DRAWN BY	SP	CHECKED BY	LW
090042013	4/17/2024								

CONSTRUCTION DETAILS

**PROPOSED RAISING CANE'S
RESTAURANT AND DRIVE-THRU**

ST JOSEPHS DR. NW
& COORS BLVD NW

ZONE ATLAS PAGE G-11-Z
ALBUQUERQUE, NM 87120

SHEET NUMBER
C8.0

Plotted By: Wilmet, Liz Sheet Set: C1156 Albuquerque NM Sheet Set Layout: DETAILS 2 April 18, 2024 04:42:06pm K:\SEA, Civil\SEA_DS\090042 - Raising Cane\0900420213 - C1156 - Coors & St. Josephs, Albuquerque NM\CAD\PlanSheets\C-DETAILS.dwg
This document, together with the concepts and designs presented herein, as an instrument of service, is intended only for the specific purpose and client for which it was prepared. Reuse of and improper reliance on this document without written authorization and adaptation by Kimley-Horn and Associates, Inc. shall be without liability to Kimley-Horn and Associates, Inc.

TRAFFIC CIRCULATION
LAYOUT APPROVED

Curtis A Cherne

Signed

4-23-24

Date

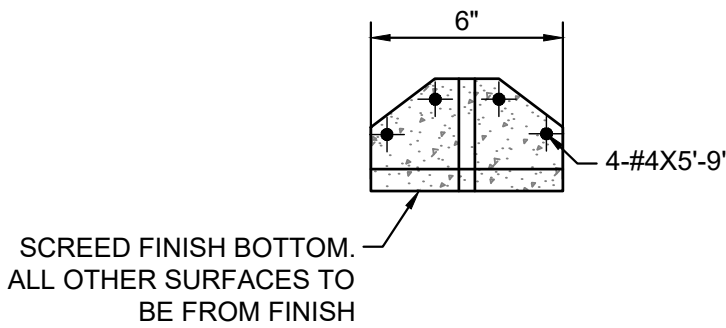
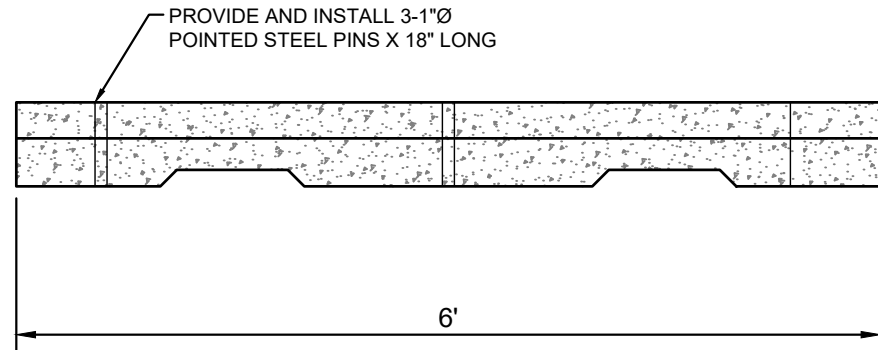

PRECAST WHEELSTOP DETAIL
N.T.S.

DETAIL A-PARALLEL CURB RAMP

DETAIL B-PARALLEL CURB RAMP

DETAIL C-PARALLEL CURB RAMP

GENERAL NOTES

CONSTRUCTION NOTES

REVISIONS

CITY OF ALBUQUERQUE

1. RUNNING SLOPE OF A CURB RAMP SHALL NOT REQUIRE THE RAMP LENGTH TO EXCEED 15 FEET TO AVOID CHANGING THE SLOPE INDEFINITELY WHEN CONNECTING TO STEEP GRADES. WHEN APPLYING THE 15-FOOT MAXIMUM LENGTH, THE RUNNING SLOPE OF THE CURB RAMP SHALL BE EXTENDED AS FLAT AS THE MAXIMUM EXTENT AS FEASIBLE.

2. SEE COA STD. DWG. 2446 FOR DETECTABLE WARNING DEVICE DETAILS.

3. TURNING SPACE SHALL HAVE MAXIMUM CROSS SLOPE AND LONGITUDINAL SLOPE OF 2.0% (PREFERRED SLOPE OF 1.5%). TURNING SPACE SHALL BE 5.0 FT BY 5.0 FT AT THE TOP OF THE CURB RAMP.

4. GRADE BREAKS AT THE TOP AND BOTTOM OF CURB RAMP RUNS SHALL BE PERPENDICULAR TO THE DIRECTION OF THE RAMP RUN. GRADE BREAKS SHALL NOT BE PERMITTED ON THE SURFACE OF RAMP RUNS AND TURNING SPACE. SURFACE SLOPES THAT MEET AT GRADE BREAKS SHALL BE FLUSH.

5. COUNTER SLOPE OF THE GUTTER OR STREET AT THE FOOT OF A CURB RAMP, RUN OR TURNING SPACE SHALL BE .5% MAX.

6. FLARED SIDES ARE TO HAVE A SLOPE OF 10% MAX, MEASURED PARALLEL TO THE BACK OF THE CURB.

7. 2% MAXIMUM CROSS-SLOPE. 1.5% PREFERRED CROSS-SLOPE.

8. FILLET SHARP CURVES EXPOSED TO TRAFFIC TO 6" MINIMUM RADII.

1. DEVIATIONS FROM THESE STANDARDS SHALL BE SUBMITTED TO THE CITY ENGINEER AND/OR CITY TRAFFIC ENGINEER FOR APPROVAL PRIOR TO CONSTRUCTION.

2. SUBGRADE UNDER SIDEWALKS AND DRIVEPADS SHALL BE COMPACTED IN ACCORDANCE WITH SECTION 301.

3. FOR SIDEWALKS LESS THAN 6'0" WIDE ON ACCESSIBLE ROUTE, PASSING SPACE AT LEAST 6'0" X 6'0" SHALL BE PROVIDED AT LEAST EVERY 200 FT.

4. GRATINGS LOCATED IN WALKING SURFACE SHALL HAVE SPACES NO GREATER THAN 1/2" WIDE IN DIRECTION OF TRAVEL. IF OPENINGS ARE ELONGATED, LONG DIMENSION SHALL BE PLACED PERPENDICULAR TO DIRECTION OF TRAVEL.

5. ALONG THE ACCESSIBLE ROUTE, CHANGES IN LEVEL BETWEEN 1/4" AND 1/2" SHALL BE BEVELED WITH A SLOPE NO GREATER THAN 2% (V). CHANGES IN LEVEL GREATER THAN 1/2" REQUIRE A RAMP.

6. PROVIDE A MINIMUM SIDEWALK WIDTH OF 4' AROUND OBSTACLES FOR ADA ACCESS.

7. SEE COA STD DWG 2425A AND 2425B FOR DRIVEPAD DETAILS.

1. SLOPE 2% MAX. 1.5% PREFERRED SLOPE.

2. 5' MIN. SIDEWALK WIDTH. SIDEWALK WIDTH SHALL BE IN ACCORDANCE WITH CHAPTER 23 OF DEVELOPMENT PROCESS MANUAL. ALSO SEE COA STD. DWG. 2414 FOR LANDSCAPE BUFFER.

3. SETBACK TO BE DETERMINED BY AVAILABLE RIGHT-OF-WAY. SEE CHAPTER 7 OF DEVELOPMENT PROCESS MANUAL. ALSO SEE COA STD. DWG. 2414 FOR LANDSCAPE BUFFER.

4. SEE DRIVEPAD DETAILS, DWG. 2425A AND 2425B.

5. WALKWAY VARIABLE (4' MINIMUM).

6. PROPERTY LINE.

7. 1/2" EXPANSION JOINTS WHERE SIDEWALK OR DRIVEPAD ABUTS BUILDINGS, FENCES, WALLS OR OTHER IMMOVABLE OBJECTS.

8. HEADER CURB OR INTEGRAL CURB AS REQUIRED TO MEET GRADE AT BACK OF SIDEWALK. SEE STD. DWG. 2415.

9. CONTRACTION JOINTS.

10. FOR CURB ACCESS RAMPS, SEE DWGS. 2440 THROUGH 2445.

11. CHECK DIMENSION FROM BOTH PROPERTY LINE AND FLOW LINE. USE IN AREAS WHERE DRIVEPAD IS FARTHEST FROM INTERSECTION.

12. RAMP AS REQUIRED TO MEET DRIVEPAD GRADE.

13. 8.3% MAX. SLOPE. 7% PREFERRED SLOPE.

14. ADA ACCESSIBLE PATHWAY. 2% MAX. CROSS-SLOPE. 1.5% PREFERRED CROSS-SLOPE.

REVISIONS

CITY OF ALBUQUERQUE

PAVING

PARALLEL AND DIAGONAL CURB RAMPS

DWG. 2443

JUNE 2019

PLAN CURB TYPE SIDEWALK

SECTION A-A

PLAN OFFSET TYPE SIDEWALK

SECTION B-B

GENERAL NOTES

CONSTRUCTION NOTES

REVISIONS

CITY OF ALBUQUERQUE

1. DEVIATIONS FROM THESE STANDARDS SHALL BE SUBMITTED TO THE CITY ENGINEER AND/OR CITY TRAFFIC ENGINEER FOR APPROVAL PRIOR TO CONSTRUCTION.

2. SUBGRADE UNDER SIDEWALKS AND DRIVEPADS SHALL BE COMPACTED IN ACCORDANCE WITH SECTION 301.

3. FOR SIDEWALKS LESS THAN 6'0" WIDE ON ACCESSIBLE ROUTE, PASSING SPACE AT LEAST 6'0" X 6'0" SHALL BE PROVIDED AT LEAST EVERY 200 FT.

4. GRATINGS LOCATED IN WALKING SURFACE SHALL HAVE SPACES NO GREATER THAN 1/2" WIDE IN DIRECTION OF TRAVEL. IF OPENINGS ARE ELONGATED, LONG DIMENSION SHALL BE PLACED PERPENDICULAR TO DIRECTION OF TRAVEL.

5. ALONG THE ACCESSIBLE ROUTE, CHANGES IN LEVEL BETWEEN 1/4" AND 1/2" SHALL BE BEVELED WITH A SLOPE NO GREATER THAN 2% (V). CHANGES IN LEVEL GREATER THAN 1/2" REQUIRE A RAMP.

6. PROVIDE A MINIMUM SIDEWALK WIDTH OF 4' AROUND OBSTACLES FOR ADA ACCESS.

7. SEE COA STD DWG 2425A AND 2425B FOR DRIVEPAD DETAILS.

1. SLOPE 2% MAX. 1.5% PREFERRED SLOPE.

2. 5' MIN. SIDEWALK WIDTH. SIDEWALK WIDTH SHALL BE IN ACCORDANCE WITH CHAPTER 23 OF DEVELOPMENT PROCESS MANUAL. ALSO SEE COA STD. DWG. 2414 FOR LANDSCAPE BUFFER.

3. SETBACK TO BE DETERMINED BY AVAILABLE RIGHT-OF-WAY. SEE CHAPTER 7 OF DEVELOPMENT PROCESS MANUAL. ALSO SEE COA STD. DWG. 2414 FOR LANDSCAPE BUFFER.

4. SEE DRIVEPAD DETAILS, DWG. 2425A AND 2425B.

5. WALKWAY VARIABLE (4' MINIMUM).

6. PROPERTY LINE.

7. 1/2" EXPANSION JOINTS WHERE SIDEWALK OR DRIVEPAD ABUTS BUILDINGS, FENCES, WALLS OR OTHER IMMOVABLE OBJECTS.

8. HEADER CURB OR INTEGRAL CURB AS REQUIRED TO MEET GRADE AT BACK OF SIDEWALK. SEE STD. DWG. 2415.

9. CONTRACTION JOINTS.

10. FOR CURB ACCESS RAMPS, SEE DWGS. 2440 THROUGH 2445.

11. CHECK DIMENSION FROM BOTH PROPERTY LINE AND FLOW LINE. USE IN AREAS WHERE DRIVEPAD IS FARTHEST FROM INTERSECTION.

12. RAMP AS REQUIRED TO MEET DRIVEPAD GRADE.

13. 8.3% MAX. SLOPE. 7% PREFERRED SLOPE.

14. ADA ACCESSIBLE PATHWAY. 2% MAX. CROSS-SLOPE. 1.5% PREFERRED CROSS-SLOPE.

REVISIONS

CITY OF ALBUQUERQUE

PAVING

SIDEWALK DETAILS

DWG. 2430

JUNE 2019

BOLLARD DETAIL
N.T.S.

Kimley»Horn

© 2024 KIMLEY-HORN AND ASSOCIATES, INC.
1201 3RD AVE, SUITE 2800, SEATTLE, WA 98101
PHONE: 206-607-2800
WWW.KIMLEY-HORN.COM

ELIZABETH ANNE WILLOTT
28862
Professional Engineer
04/18/2024

KHA PROJECT
090042013

DATE
4/17/2024

SCALE
AS SHOWN

DESIGNED BY
SP

DRAWN BY
SP

CHECKED BY
LW

CONSTRUCTION
DETAILS

PROPOSED RAISING CANE'S
RESTAURANT AND DRIVE-THRU

ST JOSEPHS DR. NW
& COORS BLVD NW

ZONE ATLAS PAGE G-11-Z
ALBUQUERQUE, NM 87120

SHEET NUMBER
C8.1

REVISIONS

DATE

BY