

SITE NOTES

1. ALL WORK AND MATERIALS SHALL COMPLY WITH ALL CITY/COUNTY REGULATIONS AND CODES AND O.S.H.A. STANDARDS.
2. CONTRACTOR SHALL REFER TO THE ARCHITECTURAL/MEP PLANS FOR SITE LIGHTING & ELECTRICAL PLAN.
3. REFERENCE ARCHITECTURAL PLANS FOR DUMPSTER ENCLOSURE DETAILS.
4. SITE BOUNDARY, TOPOGRAPHY, UTILITY AND ROAD INFORMATION TAKEN FROM A SURVEY BY PRECISION SURVEY, INC. DATED SEPTEMBER 2023.
5. ALL PROPOSED PAVING IN CITY R.O.W. AND EASEMENTS TO CONFORM TO CITY OF ALBUQUERQUE STANDARDS.
6. REFER TO ALTA SURVEY BY PRECISION SURVEY IN SEPTEMBER 2023 FOR PROPERTY LINE DIMENSIONS.
7. ALL WORK IN COORS BLVD NW AND ST JOSEPH'S DRIVE NW SHOWN FOR REFERENCE ONLY, TO BE DESIGNED, PERMITTED, AND CONSTRUCTED BY OTHERS.

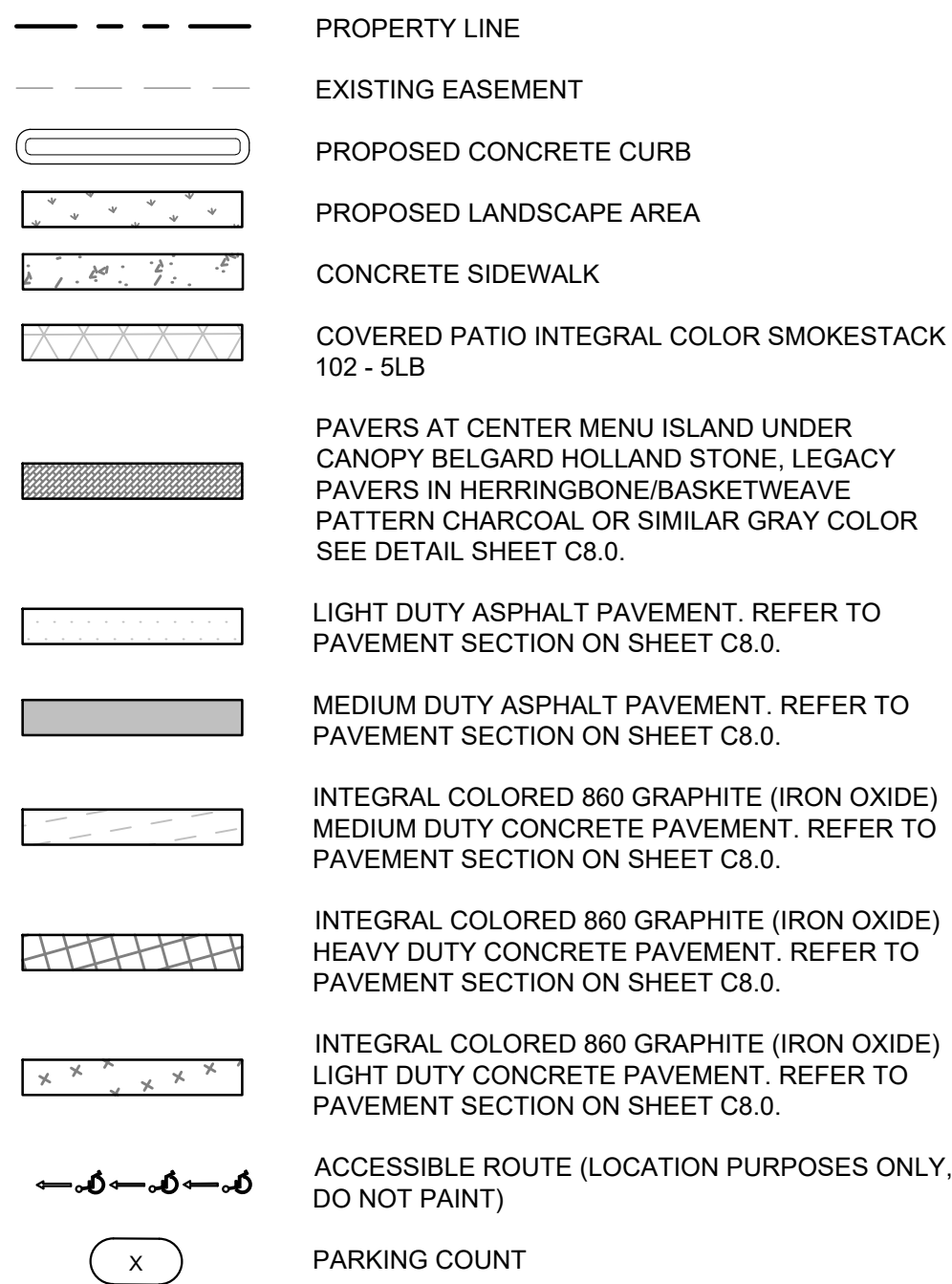

KEYNOTE LEGEND	
(A1)	PROPOSED INTEGRAL CURB
(A2)	PROPOSED CURB AND GUTTER
(B)	PROPOSED CANE'S MONUMENT SIGN LOCATION, REFER TO ARCH. (HEIGHT = X)
(C)	PROPOSED RECYCLING/TRASH DUMPSTER LOCATION, REFER TO ARCH.
(D)	PROPOSED SITE SIGN, REFER TO SIGNAGE AND STRIPING PLAN FOR MORE DETAIL.
(E)	PROPOSED DIRECTIONAL PAVEMENT MARKING, REFER TO SIGNAGE AND STRIPING PLAN FOR MORE DETAIL.
(F)	PROPOSED CURB RAMP AND NAIL TRUNCATED DOMES
(G)	PROPOSED CONCRETE SIDEWALK
(H)	PROPOSED BOLLARD
(I)	PROPOSED LANDSCAPE AREA
(J)	PROPOSED ACCESSIBLE PARKING STALL, REFER TO SIGNAGE AND STRIPING PLAN FOR MORE DETAIL.
(K)	PROPOSED DRIVE THRU CANOPY, REFER TO ARCH PLANS.
(L)	PROPOSED DRIVE THRU ORDER BOARD, REFER TO ARCH PLANS.
(M)	PROPOSED WHEEL STOPS
(N)	PROPOSED PAVEMENT STRIPING
(O)	PROPOSED COVERED PATIO INTEGRAL COLOR SMOKESTACK 102 - 5LB
(P)	PROPOSED LIGHT DUTY ASPHALT PAVEMENT
(Q)	PROPOSED MEDIUM DUTY ASPHALT PAVEMENT
(R)	PROPOSED INTEGRAL COLORED 860 GRAPHITE (IRON OXIDE) LIGHT DUTY CONCRETE PAVEMENT
(S)	PROPOSED INTEGRAL COLORED 860 GRAPHITE (IRON OXIDE) HEAVY DUTY CONCRETE PAVEMENT
(T)	PROPOSED BIKE RACK

[illegible]

Kimley»»Horn

© 2024 KIMLEY-HORN AND ASSOCIATES, INC.
1201 3RD AVE, SUITE 2800, SEATTLE, WA 98101
PHONE: 206-407-2800
WWW.KIMLEY-HORN.COM



KHA PROJECT 090042013	DATE 3/20/2024	SCALE AS SHOWN	DESIGNED BY PR	DRAWN BY PR	CHECKED BY LW
--------------------------	-------------------	-------------------	-------------------	----------------	------------------

SITE KEYNOTE PLAN

PROPOSED RAISING CANE'S
RESTAURANT AND DRIVE-THRU

ST JOSEPHS DR. NW
& COORS BLVD NW

SHEET NUMBER
C5.0

Plotted By: Profile, Sydney Sheet Set: PUT NAME HERE Layout: HC 1, March 20, 2024 06:11:48pm K:\SEA_Civil\SEA_DS\0504032 - Raising Cane's\0504032-13 - C1156 - Coors & St. Josephs, Albuquerque\0504032-13 - C1156 - Coors & St. Josephs, Albuquerque\PlanSheets\C-SIGNAGE AND STRIPING.dwg This document, together with the concepts and designs presented herein, as an instrument of service, is intended only for the specific purpose and client for which it was prepared. Reuse of and improper reliance on this document without written authorization and adaptation by Kimley-Horn and Associates, Inc. shall be without liability to Kimley-Horn and Associates, Inc.

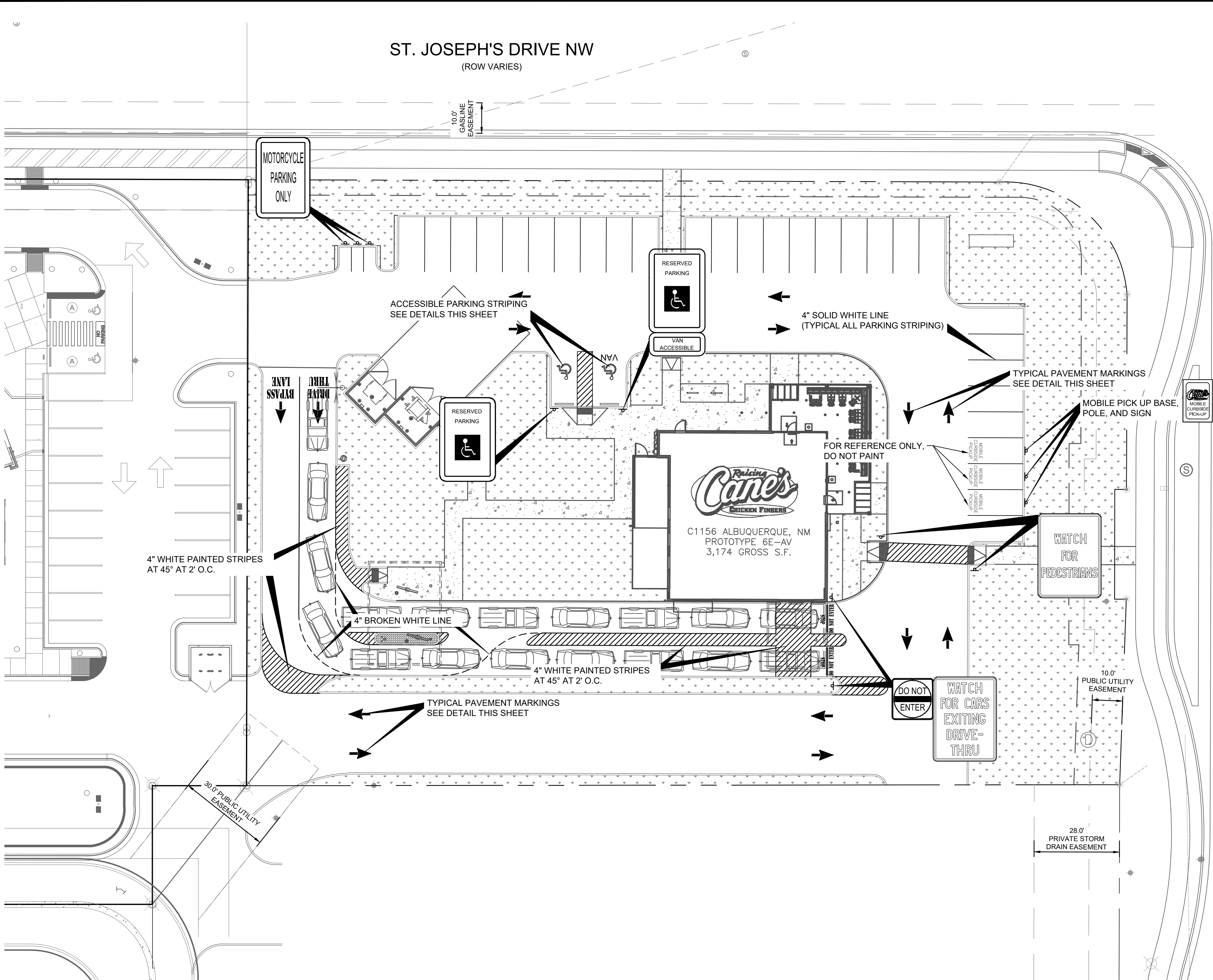

MOTORCYCLE PARKING SIGNAGE
N.T.S.

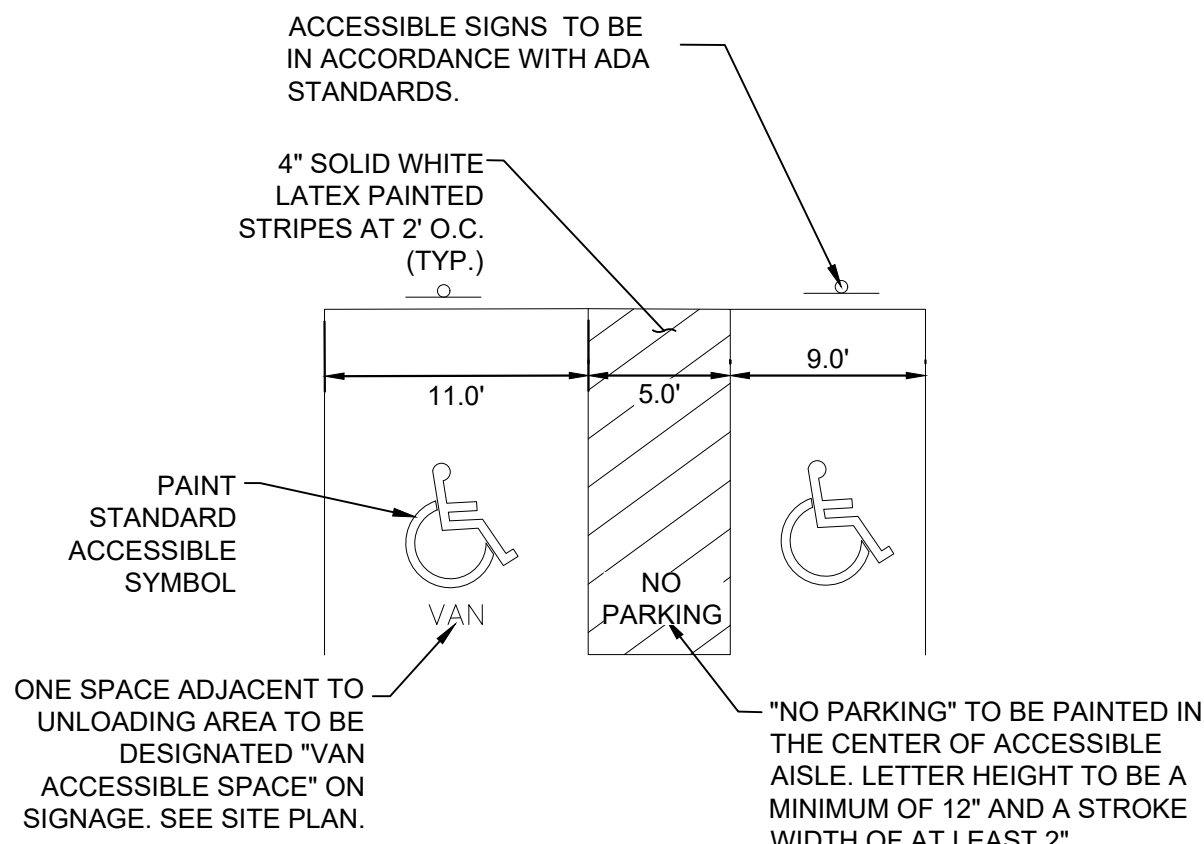
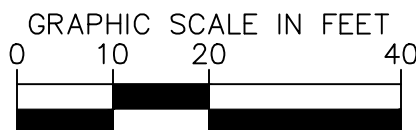
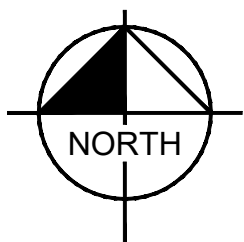

- NOTES:
- DIMENSIONS MAY VARY REFER TO SITE GEOMETRICS PLAN.
 - SIGNAGE AND MARKINGS TO BE IN ACCORDANCE WITH FEDERAL, STATE AND LOCAL REGULATIONS.

ACCESSIBLE PARKING DETAIL
N.T.S.

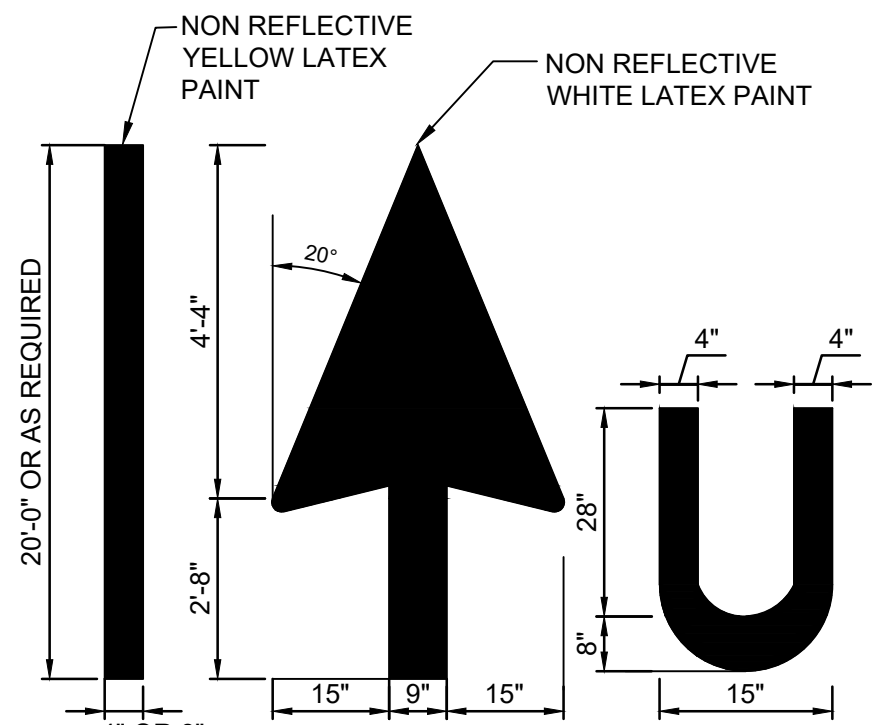

- NOTE:
- PAINT SHALL BE APPLIED AT A THICKNESS OF 22 WET MILS AND 15 DRY MILS.

TYPICAL PAVEMENT MARKINGS
N.T.S.

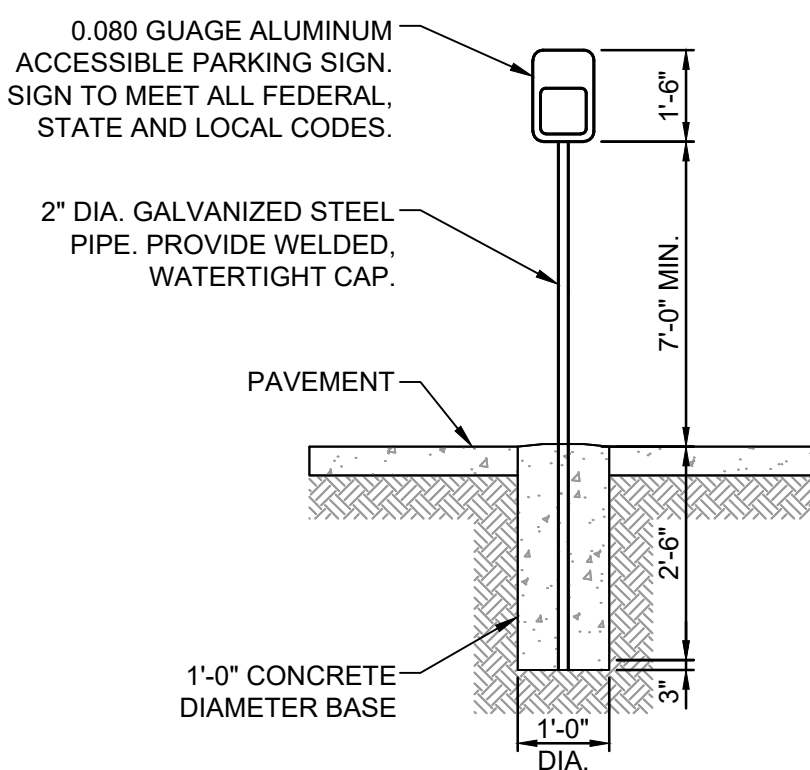

\"ACCESSIBLE PARKING\" SIGN POST DETAIL
N.T.S.

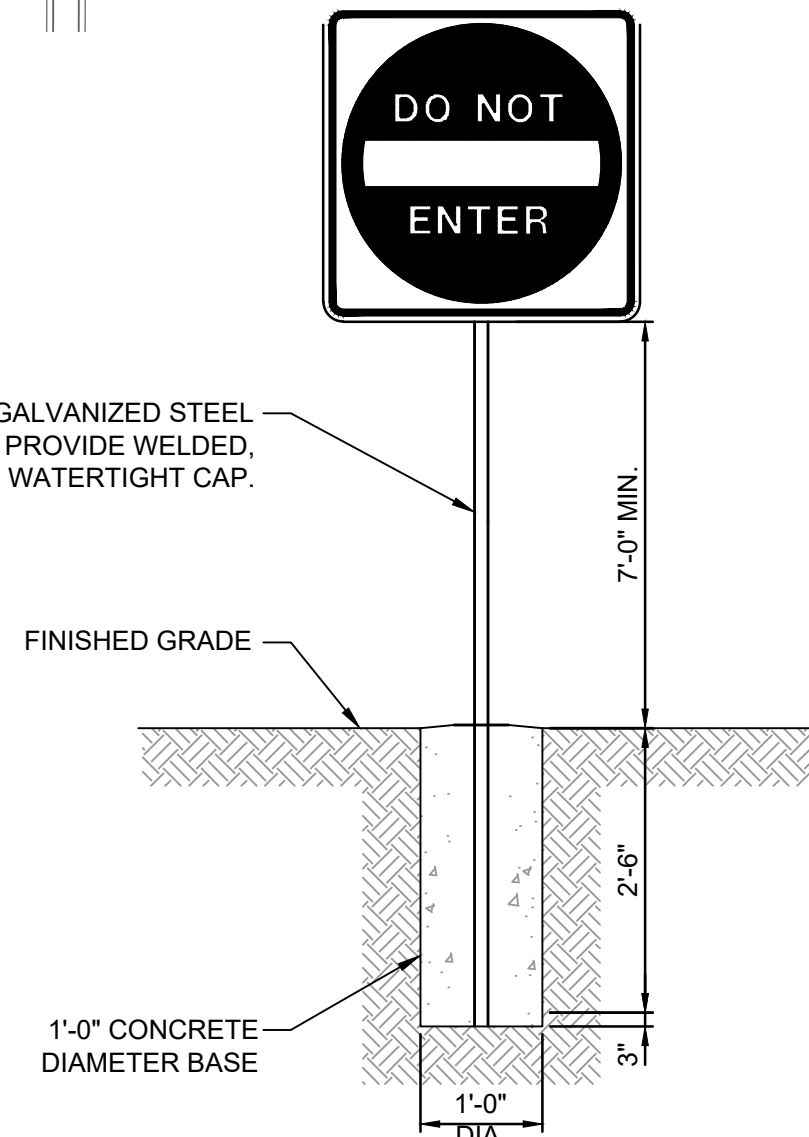

SIGN POST DETAIL

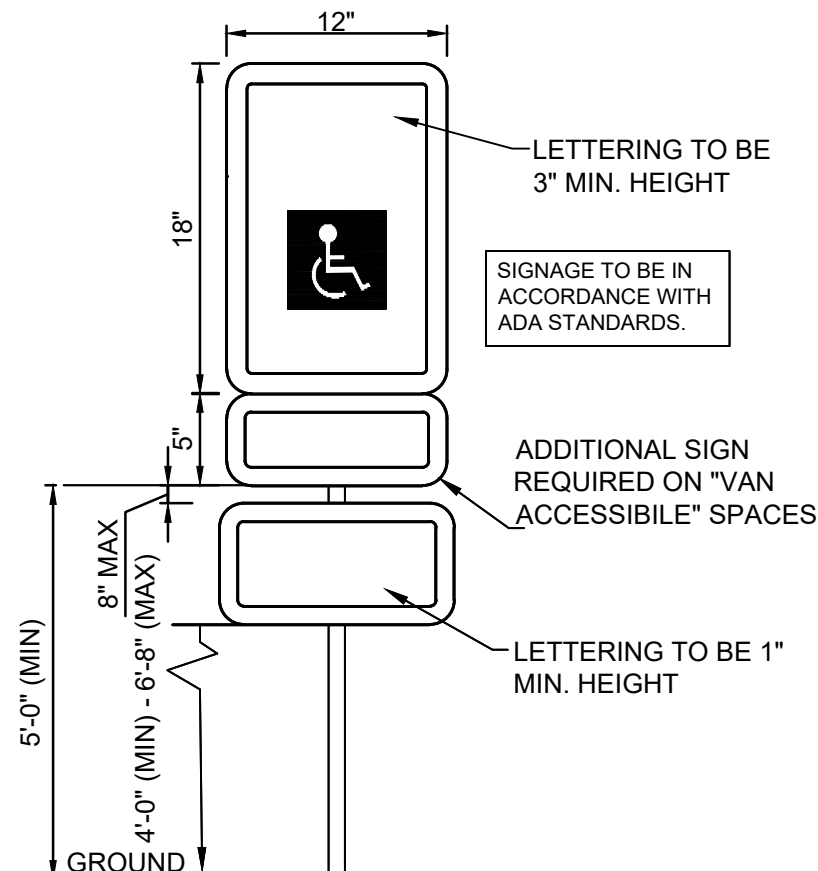

ADA SIGN DETAIL
N.T.S.

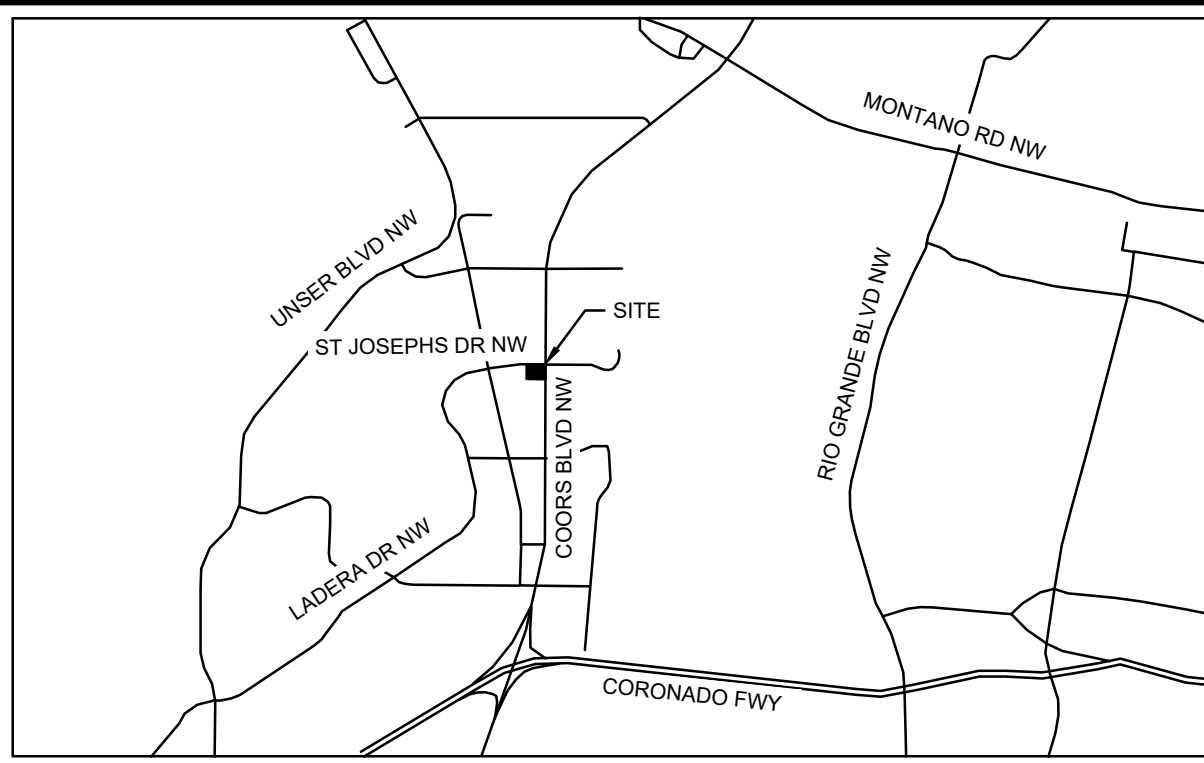

VICINITY MAP
N.T.S.



STANDARD PARKING LOT SIGNS
N.T.S.

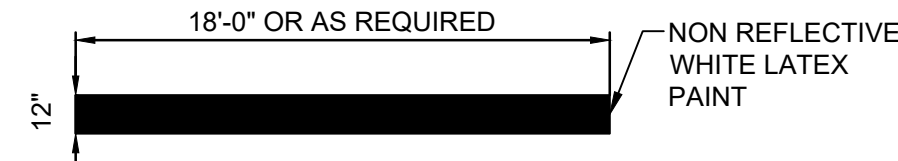

- NOTE:
- PAINT SHALL BE APPLIED AT A THICKNESS OF 22 WET MILS AND 15 DRY MILS.

DO NOT ENTER / ONE WAY BAR STRIPING

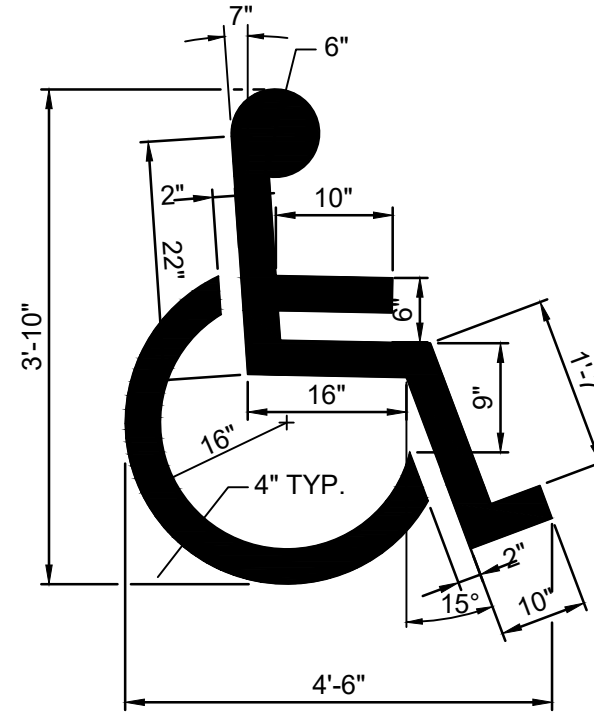

- NOTE:
- ALL TRAFFIC MARKINGS TO BE WHITE LATEX AS PER DIMENSIONS SHOWN.

ACCESSIBLE PARKING SYMBOL DETAIL
N.T.S.

REVISIONS		DATE	BY
No.			

Kimley»Horn

© 2024 KIMLEY-HORN AND ASSOCIATES, INC.
1201 3RD AVE, SUITE 2800, SEATTLE, WA 98101
PHONE: 206-607-2800
WWW.KIMLEY-HORN.COM



KHA PROJECT	090042013	DATE	3/20/2024	SCALE	AS SHOWN	DESIGNED BY	PR	DRAWN BY	PR	CHECKED BY	LW
-------------	-----------	------	-----------	-------	----------	-------------	----	----------	----	------------	----

SIGNAGE AND STRIPING PLAN

PROPOSED RAISING CANE'S RESTAURANT AND DRIVE-THRU

ST JOSEPHS DR. NW & COORS BLVD NW

ZONE ATLAS PAGE G-11-Z ALBUQUERQUE, NM 87120

SHEET NUMBER
C5.2

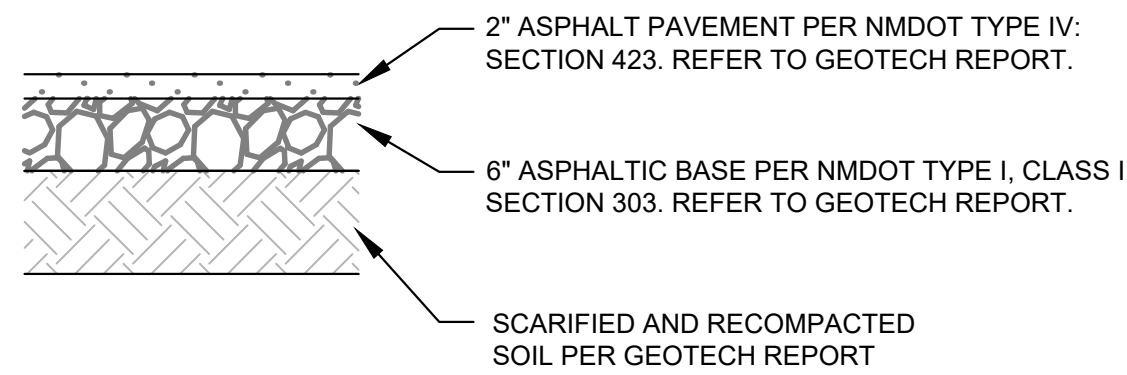

LIGHT DUTY ASPHALT PAVEMENT SECTION

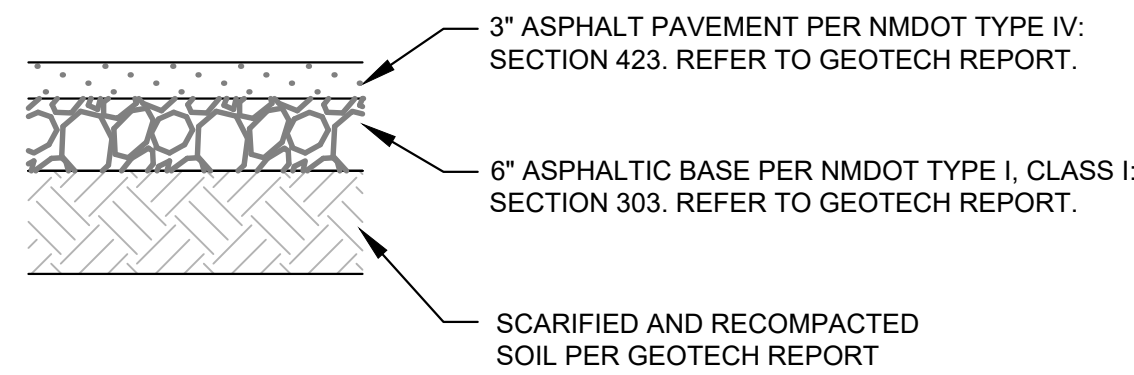

MEDIUM DUTY ASPHALT PAVEMENT SECTION

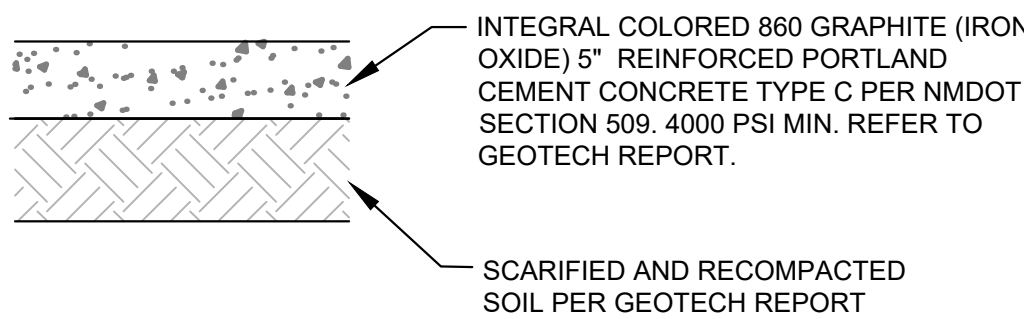

INTEGRAL COLORED
LIGHT DUTY CONCRETE PAVEMENT SECTION

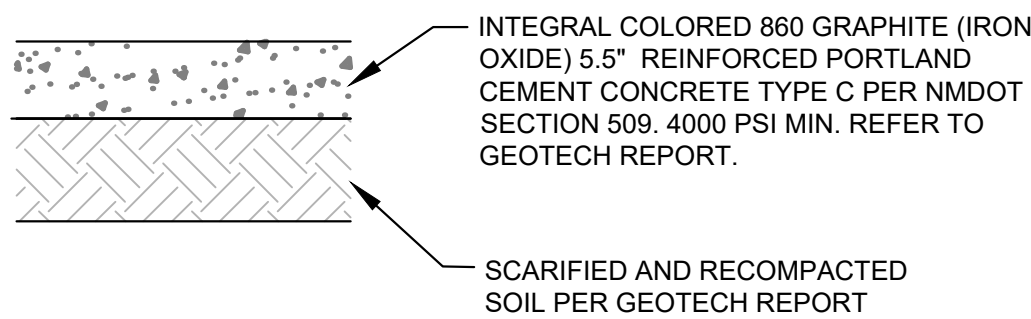

INTEGRAL COLORED
MEDIUM DUTY CONCRETE PAVEMENT SECTION

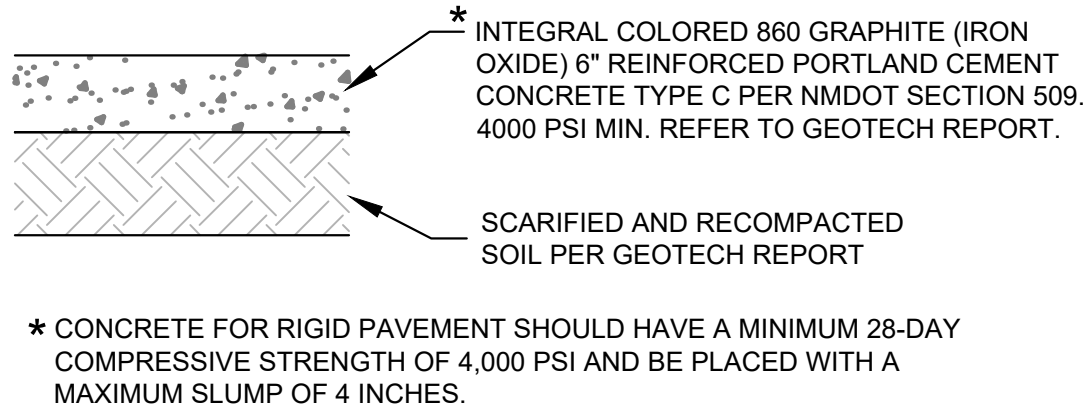

INTEGRAL COLORED
DUMPSTER PAD CONCRETE PAVEMENT SECTION

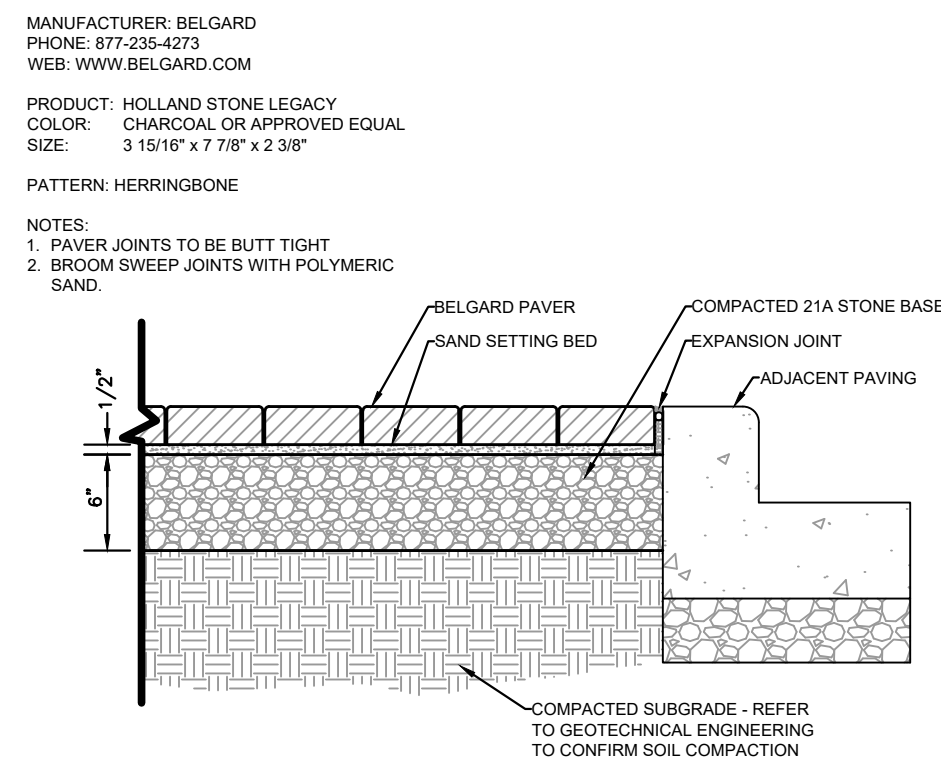

UNIT PAVERS DETAIL

N.T.S.

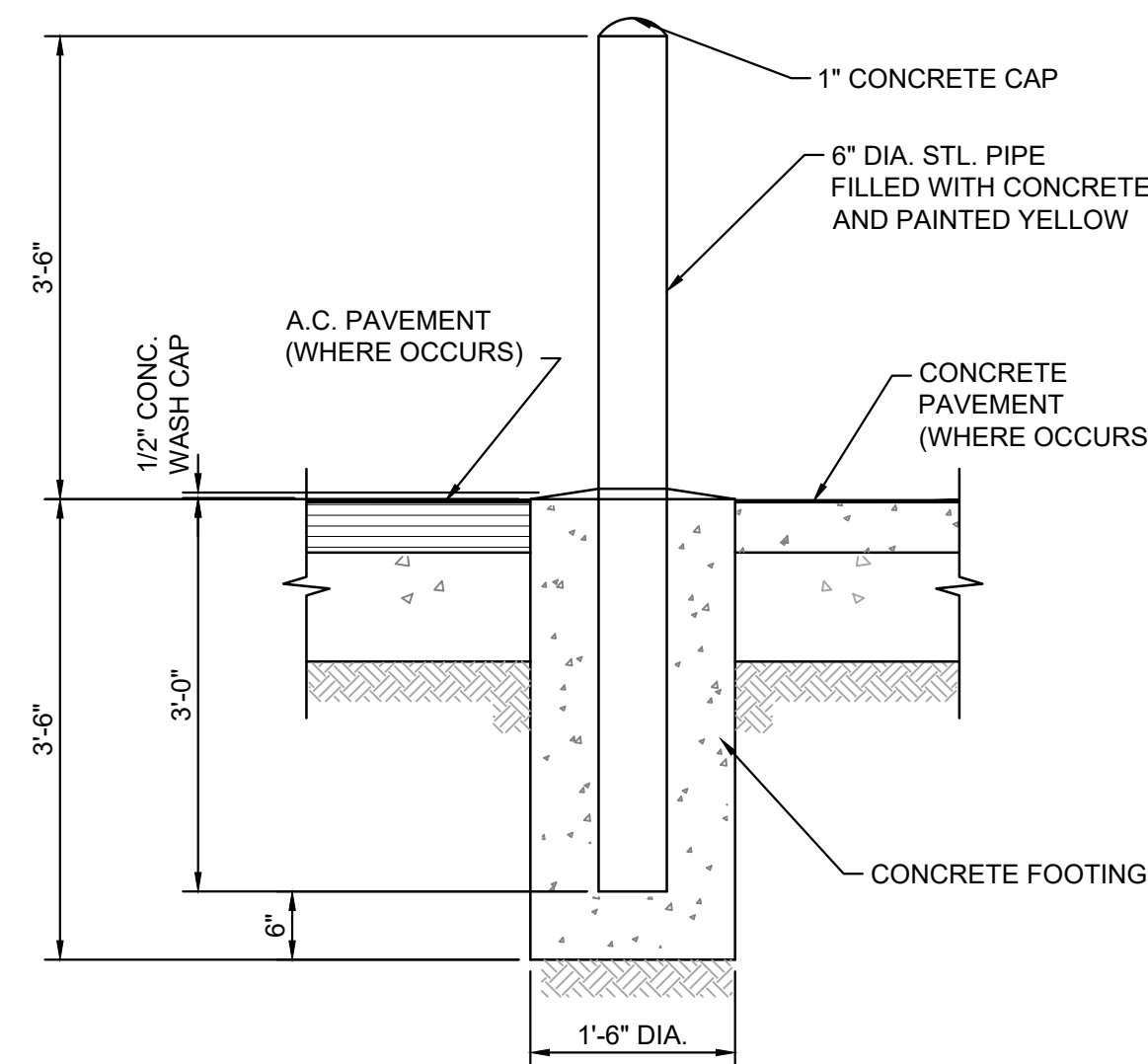

BOLLARD DETAIL
N.T.S.

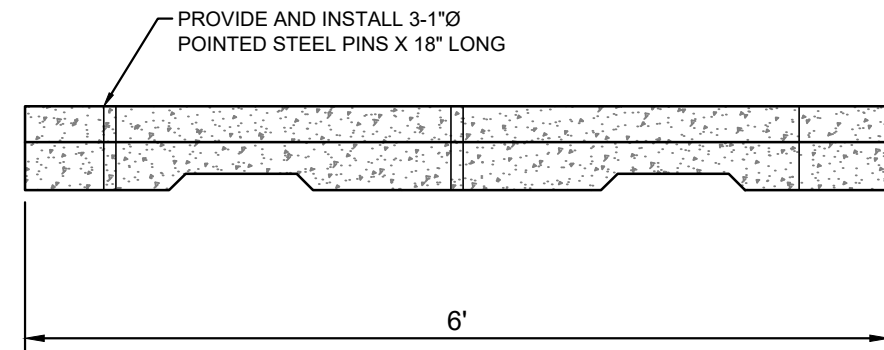

6' WIDE PRECAST WHEEL STOP
N.T.S.

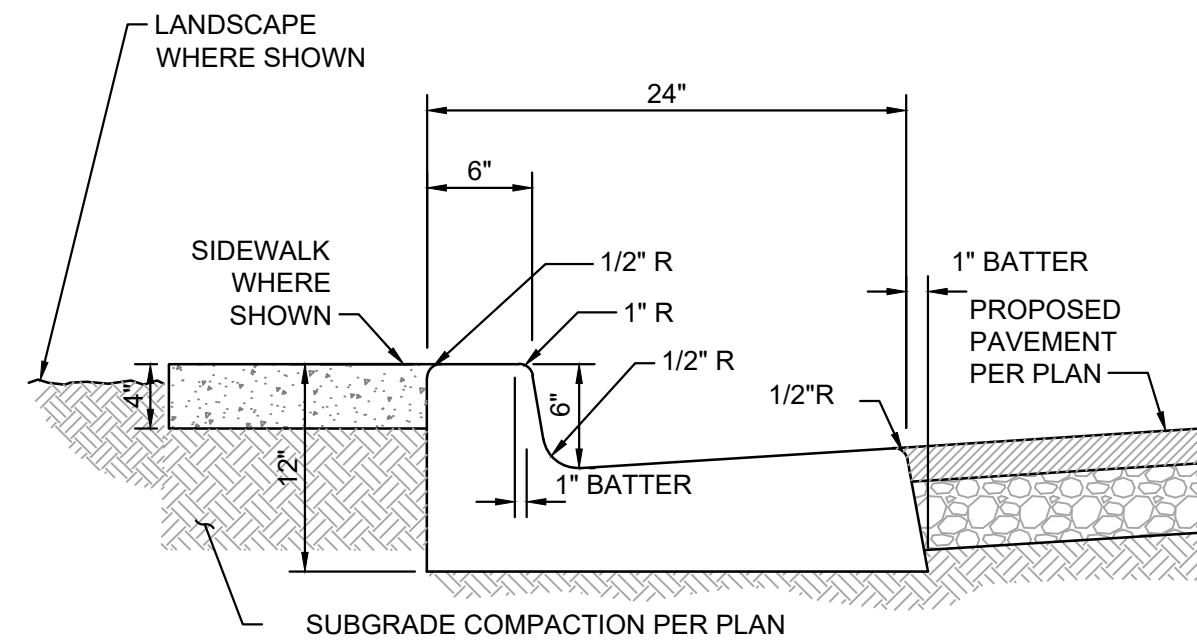
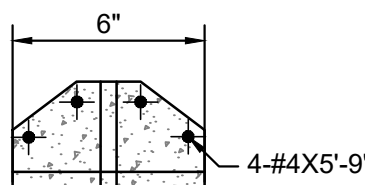

CONCRETE CURB & GUTTER
N.T.S.

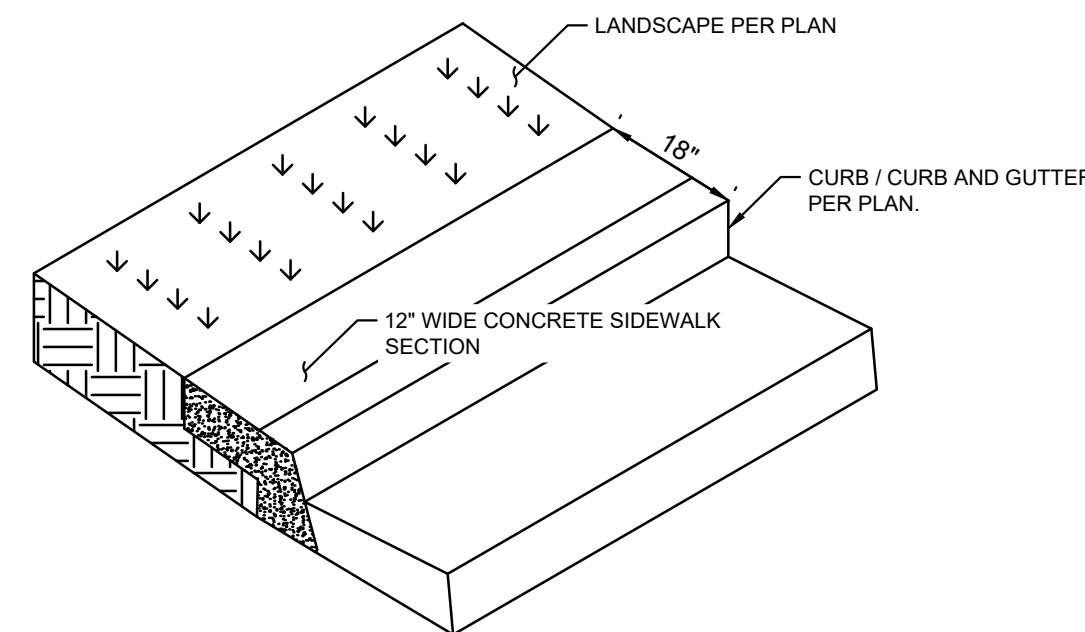

18" WALK-OFF CURB DETAIL
N.T.S.

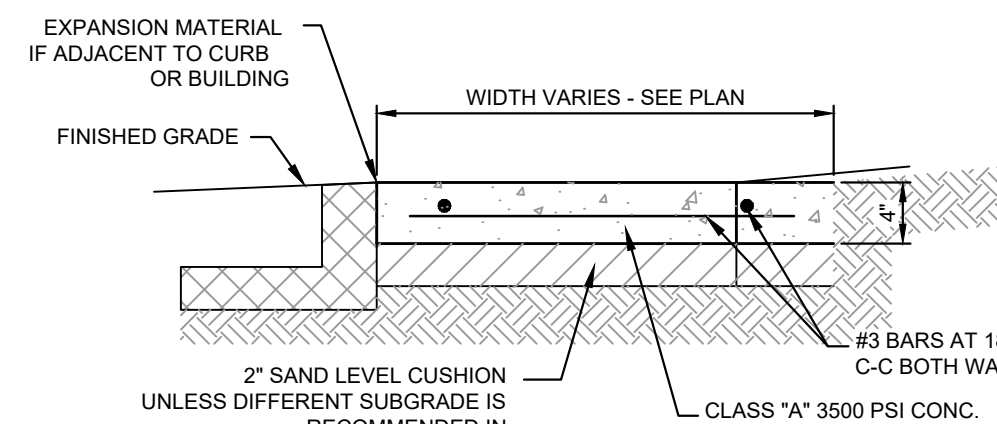
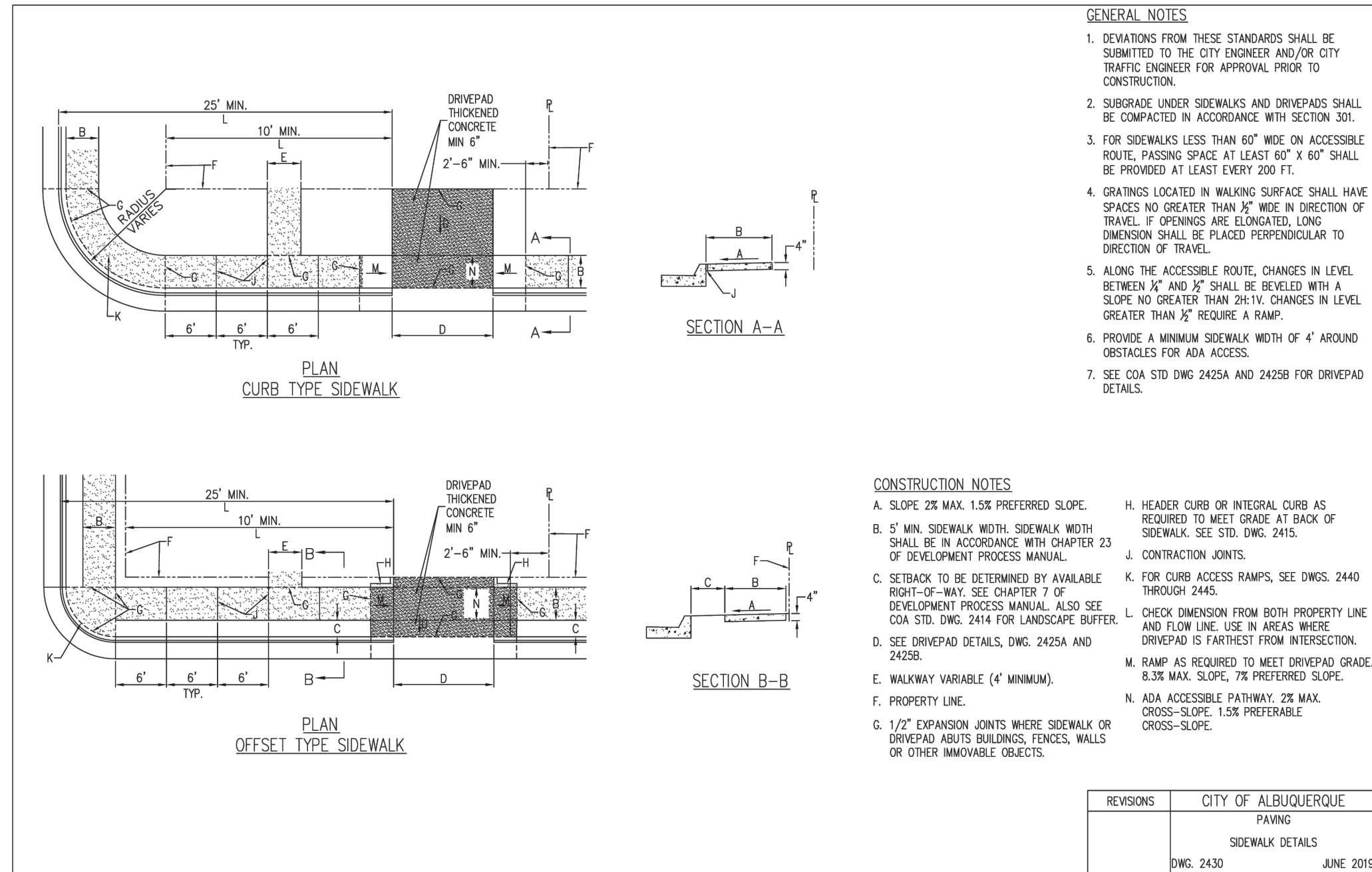
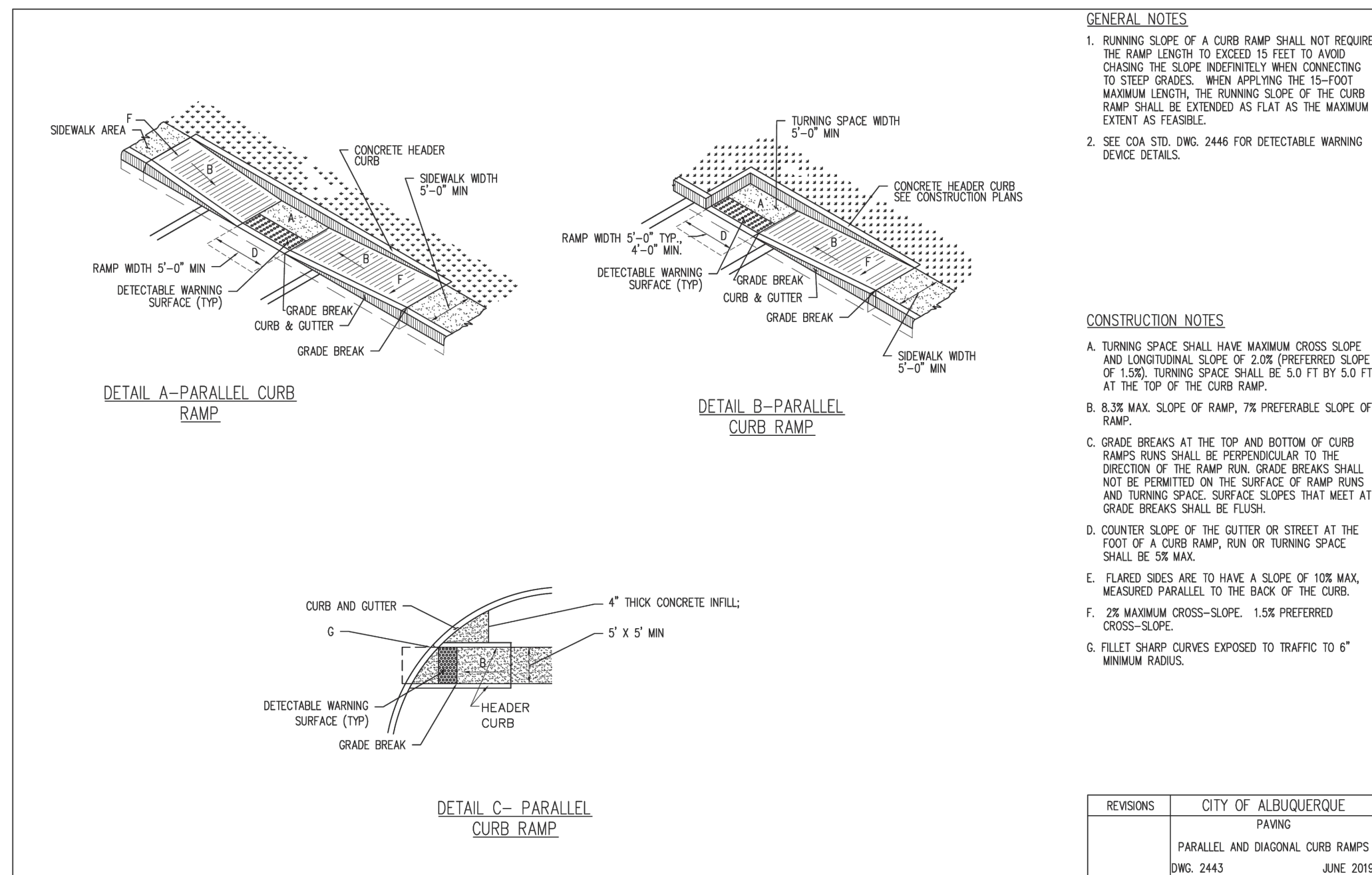

CONCRETE SIDEWALK DETAIL
N.T.S.