

CITY OF ALBUQUERQUE

Planning Department
Alan Varela, Director



Mayor Timothy M. Keller

September 22, 2022

David Alter, P.E.
ENSIGN
45 W 10000 S, Suite 500
Sandy, UT 84070

Re: Chick-fil-A/ Addition
4001 Coors Blvd. NW
Traffic Circulation Layout
Engineer's Stamp 08-25-2022 (G11-D069C)

Dear Mr. Alter,

The TCL submittal received 09-02-2022 is approved for Building Permit by Transportation. A copy of the stamped and signed plan will be needed for each of the building permit plans. Please keep the original to be used for certification of the site for final C.O. for Transportation.

When the site construction is completed and an inspection for Certificate of Occupancy (C.O.) is requested, use the original City stamped approved TCL for certification. Redline any minor changes and adjustments that were made in the field. A NM registered architect or engineer must stamp, sign, and date the certification TCL along with indicating that the development was built in "substantial compliance" with the TCL. Submit this certification, the TCL, and a completed Drainage and Transportation Information Sheet to front counter personnel for log in and evaluation by Transportation.

Once verification of certification is completed and approved, notification will be made to Building Safety to issue Final C.O. To confirm that a final C.O. has been issued, call Building Safety at 924-3690.

Sincerely,

Ernest Armijo, P.E.
Principal Engineer, Planning Dept.
Development Review Services

C: CO Clerk, File



City of Albuquerque

Planning Department

Development & Building Services Division

DRAINAGE AND TRANSPORTATION INFORMATION SHEET (REV 10/2018)

Project Title: _____ **Building Permit #:** _____ **Hydrology File #:** _____

DRB#: _____ **EPC#:** _____ **Work Order#:** _____

Legal Description: _____

City Address: _____

Applicant: _____ **Contact:** _____

Address: _____

Phone#: _____ **Fax#:** _____ **E-mail:** _____

Other Contact: _____ **Contact:** _____

Address: _____

Phone#: _____ **Fax#:** _____ **E-mail:** _____

TYPE OF DEVELOPMENT: _____ PLAT (# of lots) _____ RESIDENCE _____ DRB SITE _____ ADMIN SITE

IS THIS A RESUBMITTAL? _____ Yes _____ No

DEPARTMENT: _____ TRAFFIC/TRANSPORTATION _____ HYDROLOGY/DRAINAGE

Check all that Apply:

TYPE OF SUBMITTAL:

- _____ ENGINEER/ARCHITECT CERTIFICATION
- _____ PAD CERTIFICATION
- _____ CONCEPTUAL G & D PLAN
- _____ GRADING PLAN
- _____ DRAINAGE MASTER PLAN
- _____ DRAINAGE REPORT
- _____ FLOODPLAIN DEVELOPMENT PERMIT APPLIC
- _____ ELEVATION CERTIFICATE
- _____ CLOMR/LOMR
- _____ TRAFFIC CIRCULATION LAYOUT (TCL)
- _____ TRAFFIC IMPACT STUDY (TIS)
- _____ OTHER (SPECIFY) _____
- _____ PRE-DESIGN MEETING?

TYPE OF APPROVAL/ACCEPTANCE SOUGHT:

- _____ BUILDING PERMIT APPROVAL
- _____ CERTIFICATE OF OCCUPANCY
- _____ PRELIMINARY PLAT APPROVAL
- _____ SITE PLAN FOR SUB'D APPROVAL
- _____ SITE PLAN FOR BLDG. PERMIT APPROVAL
- _____ FINAL PLAT APPROVAL
- _____ SIA/ RELEASE OF FINANCIAL GUARANTEE
- _____ FOUNDATION PERMIT APPROVAL
- _____ GRADING PERMIT APPROVAL
- _____ SO-19 APPROVAL
- _____ PAVING PERMIT APPROVAL
- _____ GRADING/ PAD CERTIFICATION
- _____ WORK ORDER APPROVAL
- _____ CLOMR/LOMR
- _____ FLOODPLAIN DEVELOPMENT PERMIT
- _____ OTHER (SPECIFY) _____

DATE SUBMITTED: _____ **By:** _____

COA STAFF:

ELECTRONIC SUBMITTAL RECEIVED: _____

FEE PAID: _____

PASSENGER CAR

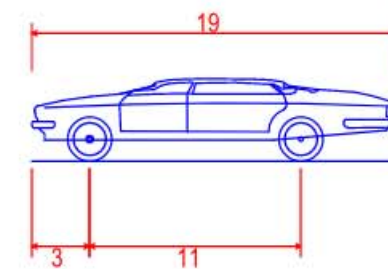

P - Passenger Car
Overall Length
7.000ft
Overall Width
4.300ft
Overall Body Height
1.115ft
Min Body Ground Clearance
6.000ft
Track Width
4.00s
Lock-to-lock time
31.60°
Max Steering Angle (Virtual)

19.000ft
7.000ft
4.300ft
1.115ft
6.000ft
4.00s
31.60°

VICINITY MAP



Chick-fil-A

5200 Buffington Rd.
Atlanta Georgia,
30349-2998

Revisions:

Mark Date By
△

Mark Date By
△

Mark Date By
△

Seal



SALT LAKE CITY
45 W. 10000 S., Suite 500
Sandy, UT 84070
Phone: 801.255.0529
Fax: 801.255.4449

WWW.ENSIGNENG.COM

STORE

CHICK-FIL-A
FSU #04107
COORS BLVD.

COORS BLVD NW & ST.
JOSEPHS DR NW
ALBUQUERQUE, NM
87120

SHEET TITLE
TRAFFIC
CIRCULATION
LAYOUT

VERSION:
ISSUE DATE:

Job No. : 11274

Store : 04107

Date : 8/24/22

Drawn By : MM

Checked By: DJ

Sheet

C II

DELIVERY TRUCK

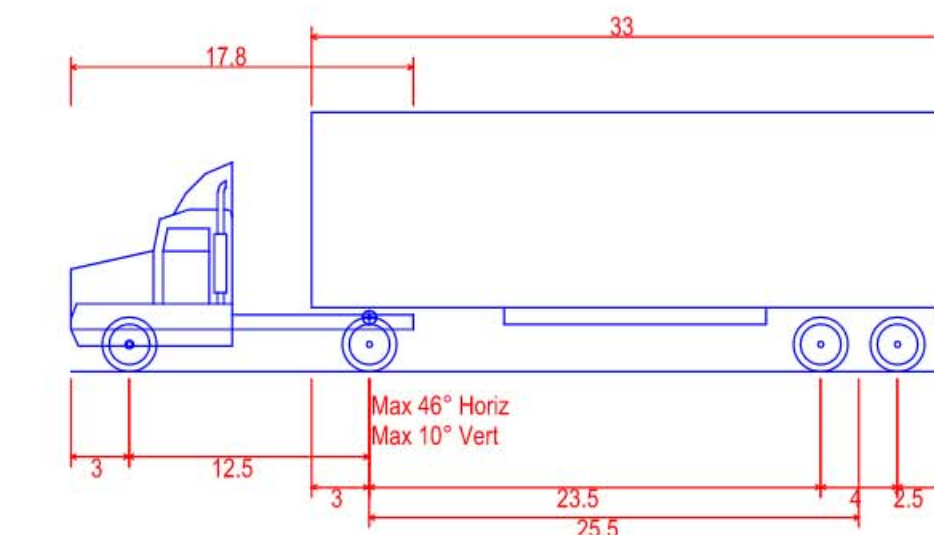

WB-40 - Intermediate Semi-Trailer
Overall Length
8.000ft
Overall Width
13.500ft
Overall Body Height
1.334ft
Min Body Ground Clearance
8.000ft
Track Width
4.00s
Lock-to-lock time
20.30°
Max Steering Angle (Virtual)

45.499ft
8.000ft
13.500ft
1.334ft
8.000ft
4.00s
20.30°

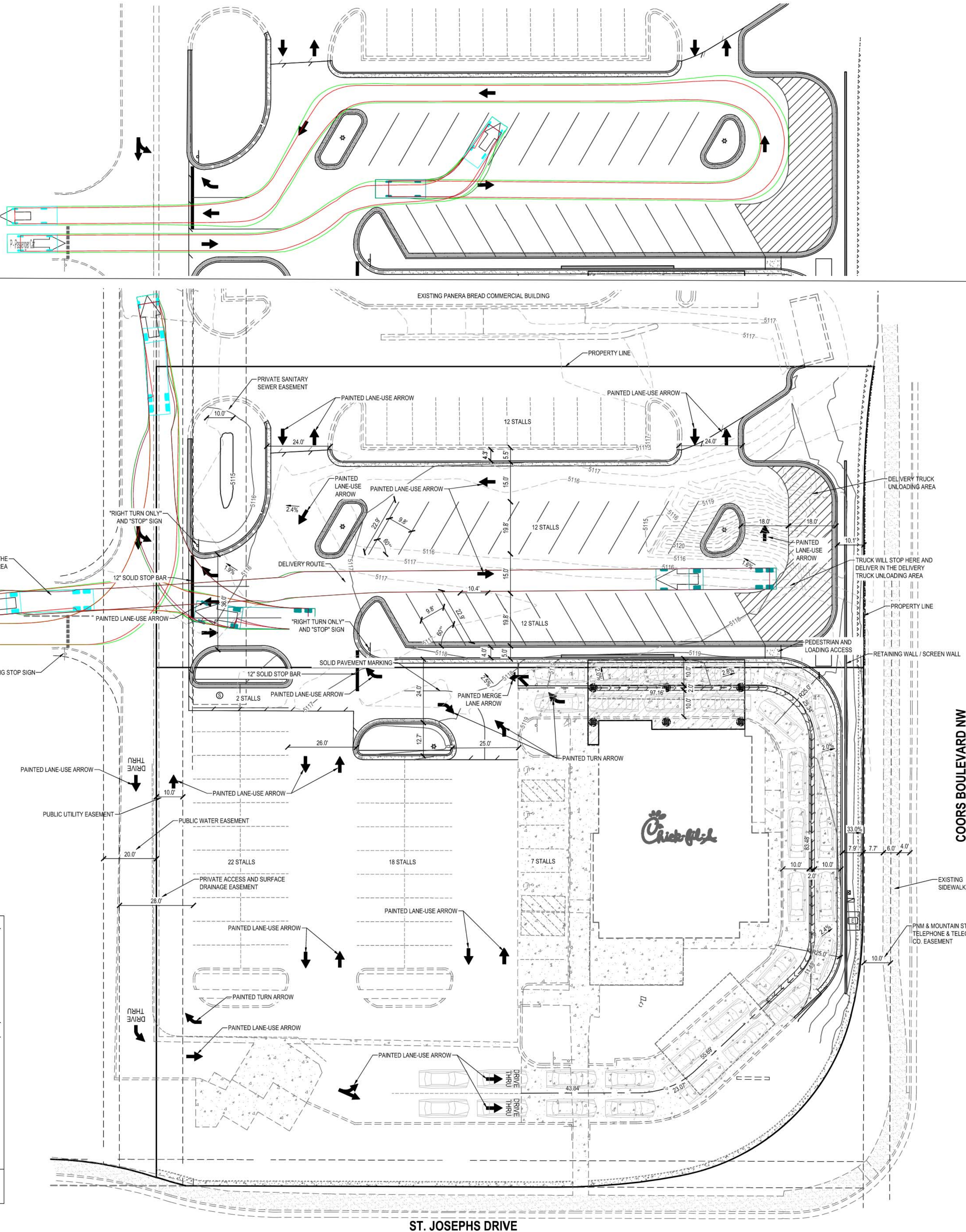
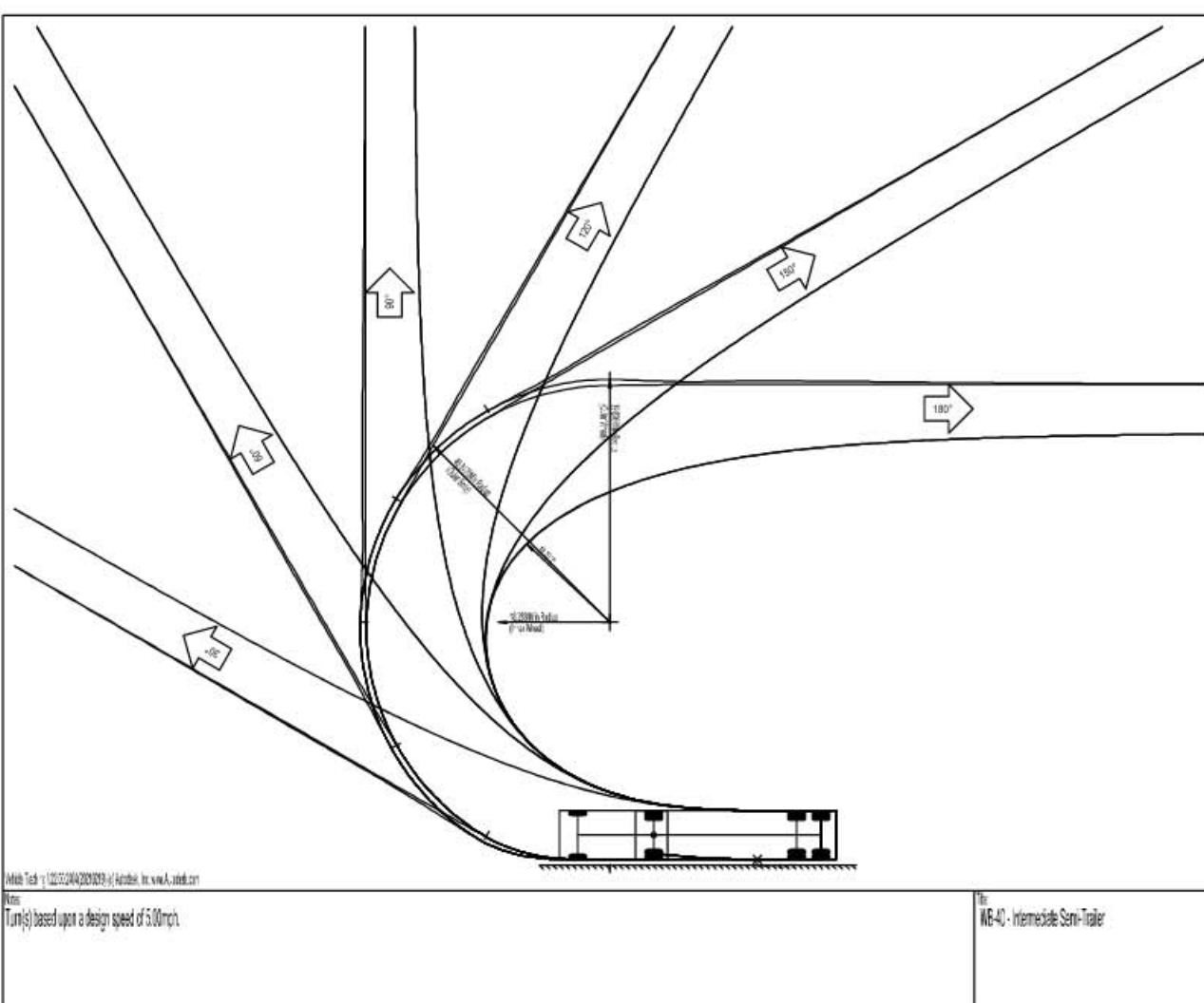

PARKING DATA TABLE	
EXISTING STALLS TO BE REMOVED	4
PROPOSED STALLS	26
EXISTING STALLS (TO REMAIN)	44
EXISTING ADA STALLS (TO REMAIN)	3
TOTAL STALLS	73

TRAFFIC CIRCULATION
LAYOUT APPROVED

Ernest Armijo
Signed

9/22/2022
Date

LEGEND

- EXISTING BOLLARD
- PROPOSED BOLLARD
- EXISTING SIGN
- PROPOSED SIGN
- EXISTING FLAG POLE
- EXISTING EDGE OF ASPHALT
- PROPOSED EDGE OF ASPHALT
- EXISTING STRIPING
- PROPOSED STRIPING
- EXISTING WALL
- PROPOSED ASPHALT
- EXISTING CURB AND GUTTER
- PROPOSED CURB AND GUTTER
- PROPOSED REVERSE PAN CURB AND GUTTER
- TRANSITION TO REVERSE PAN CURB
- EXISTING CONCRETE
- PROPOSED CONCRETE
- EXISTING BUILDING
- EXISTING MONUMENT SIGN

