

EROSION CONTROL NOTES:

1. CONTRACTOR IS RESPONSIBLE FOR OBTAINING A TOPSOIL DISTURBANCE PERMIT PRIOR TO BEGINNING WORK.
2. CONTRACTOR IS RESPONSIBLE FOR MAINTAINING RUN-OFF ON SITE DURING CONSTRUCTION.
3. CONTRACTOR IS RESPONSIBLE FOR CLEANING ALL SEDIMENT THAT GETS INTO EXISTING RIGHT-OF-WAY.
4. REPAIR OF DAMAGED FACILITIES AND CLEANUP OF SEDIMENT ACCUMULATIONS ON ADJACENT PROPERTIES AND IN PUBLIC FACILITIES IS THE RESPONSIBILITY OF THE CONTRACTOR.
5. ALL EXPOSED EARTH SURFACES MUST BE PROTECTED FROM WIND AND WATER EROSION PRIOR TO FINAL ACCEPTANCE OF ANY PROJECT.

put
cols on plan
check flow?
narrative
Survey benchmark & survey mds



CAUTION:
EXISTING UTILITIES ARE NOT SHOWN.
IT SHALL BE THE SOLE RESPONSIBILITY OF THE CONTRACTOR TO CONDUCT ALL NECESSARY FIELD INVESTIGATIONS PRIOR TO ANY EXCAVATION TO DETERMINE THE ACTUAL LOCATION OF UTILITIES & OTHER IMPROVEMENTS.

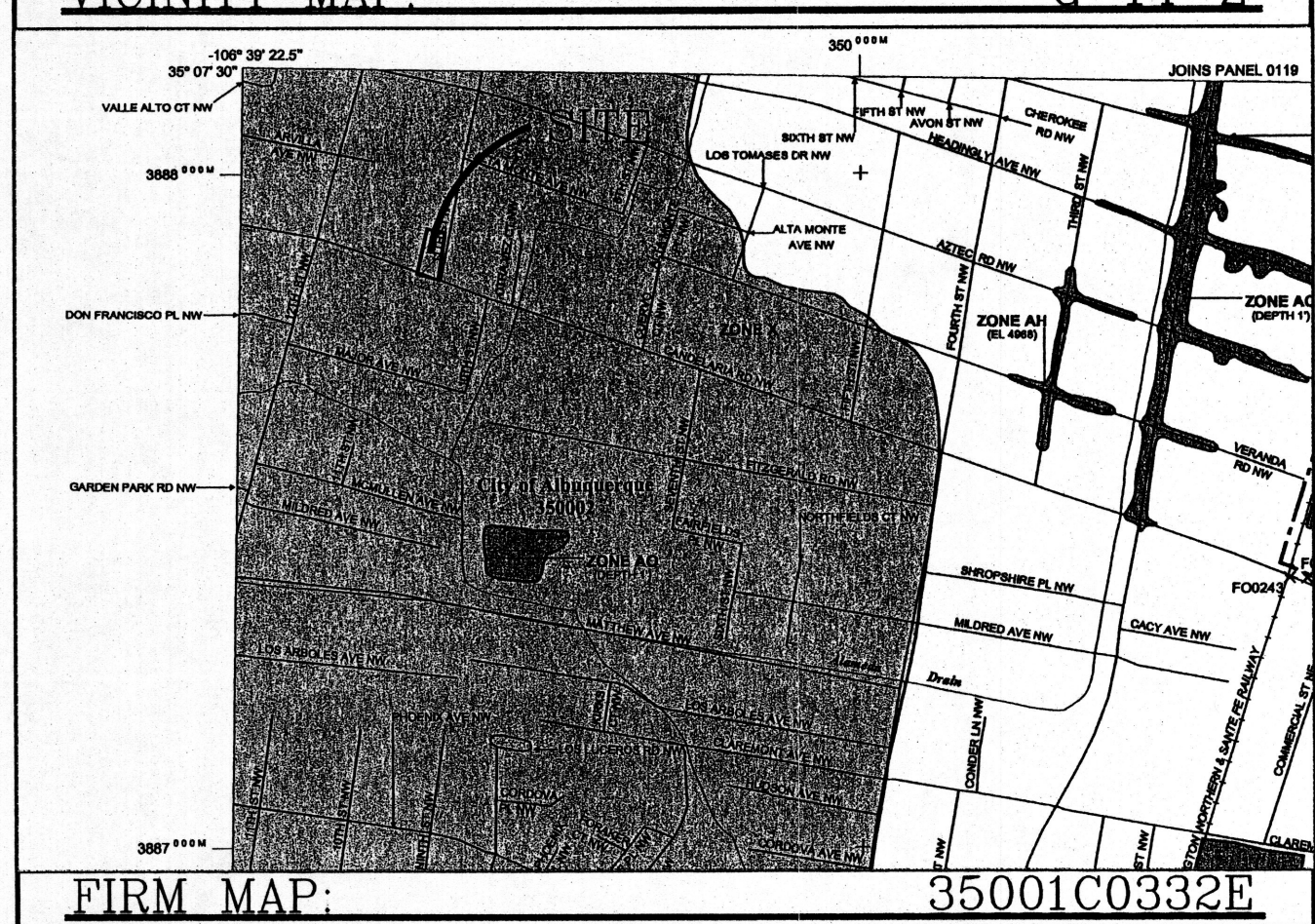
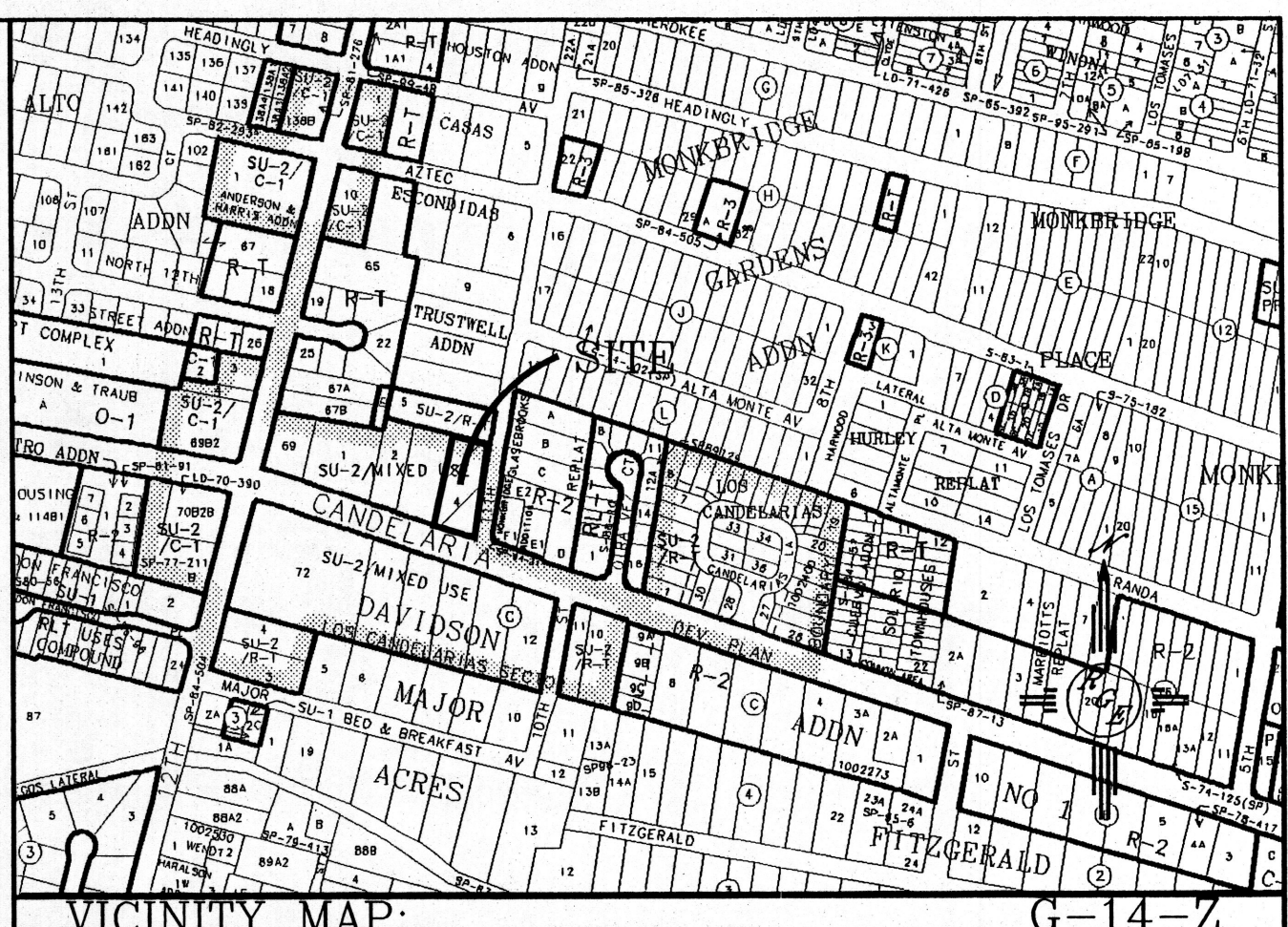
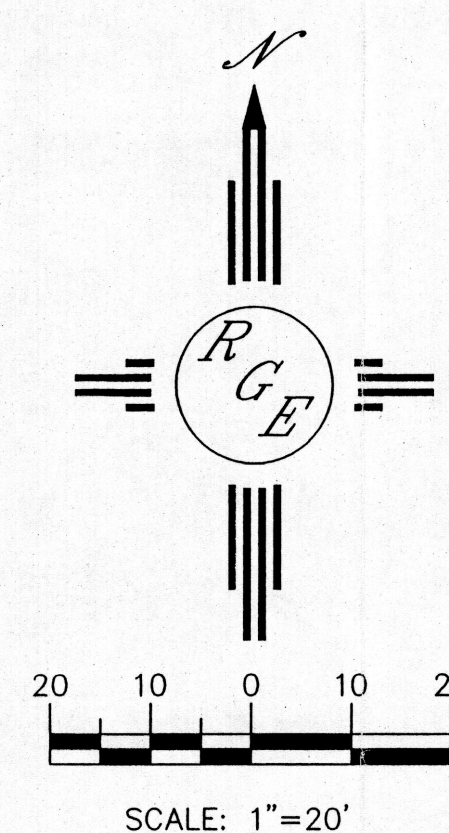

LEGAL DESCRIPTION:
LOTS 4A-4D, TRUSWELL ADDITION

- NOTES:
1. ALL SPOT ELEVATIONS REPRESENT FLOWLINE ELEVATION UNLESS OTHERWISE NOTED.
2. ALL GRADING AND BACKFILLING SHALL BE DONE GEOTECHNICAL REPORT IF REQUIRED.

LEGEND	
— 5111 —	EXISTING CONTOUR
— 5110 —	EXISTING INDEX CONTOUR
— 5111 —	PROPOSED CONTOUR
— 5110 —	PROPOSED INDEX CONTOUR
—	SLOPE TIE
x 5048.25	EXISTING SPOT ELEVATION
x 5048.25	PROPOSED SPOT ELEVATION
—	PROPOSED CSU PERMIT AREA
—	CENTERLINE
—	RIGHT-OF-WAY

ENGINEER'S SEAL

DAVID SOULE
P.E. #14522

TRUSWELL
DUPLEXES
GRADING AND
DRAINAGE PLAN

Rio Grande
Engineering
1608 CENTRAL AVENUE
SUITE 201
ALBUQUERQUE, NM 87106
(505) 872-0999

DRAWN
BY WCWJ

DATE
2-17-09

2903-LAYOUT-2-13-09

SHEET #

JOB #
2903

RECEIVED
FEB 27 2009
HYDROLOGY