

CITY OF ALBUQUERQUE

Planning Department
Brennon Williams, Director



Mayor Timothy M. Keller

November 15, 2019

Ronald Bohannon, P.E.
Tierra West, LLC
5571 Midway Park Place NE
Albuquerque, NM, 87109

**RE: Maverik Fuel Center
3737 Princeton Drive NE
Temporary C.O. - Accepted
Engineer's Certification Date: 11/12/19
Engineer's Stamp Date: 01/17/19
Hydrology File: G16D029**

Dear Mr. Bohannon:

Based on the Certification received 11/13/19 and site visit on 11/15/19, this certification is approved in support of Temporary Release of Occupancy by Hydrology. The following comment needs to be addressed prior to acceptance for Permanent C.O. of the above referenced project:

PO Box 1293

Albuquerque

NM 87103

www.cabq.gov

1. The sidewalk culvert near the dumpster needs the steel plate installed.

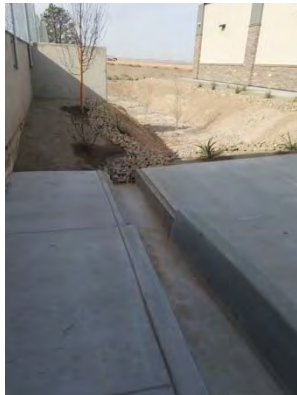

If you have any questions, please contact me at 924-3995 or rbrissette@cabq.gov.

Sincerely,

Renée C. Brissette

Renée C. Brissette, P.E. CFM
Senior Engineer, Hydrology
Planning Department



City of Albuquerque

Planning Department
Development & Building Services Division

DRAINAGE AND TRANSPORTATION INFORMATION SHEET (REV 6/2018)

Project Title: Maverik- Comanche/Princeton **Building Permit #:** _____ **Hydrology File #:** G16D029

DRB#: _____ **EPC#:** _____ **Work Order#:** _____

Legal Description: _____

City Address: 3737 Princeton Dr Ne Albuquerque, NM 87107

Applicant: Tierra West, LLC **Contact:** Richard Stevenson

Address: 5571 Midway Park Pl NE Albuquerque NM 87109

Phone#: 505-858-3100 **Fax#:** 505-858-1118 **E-mail:** rstevenson@tierrawestllc.com

Other Contact: _____ **Contact:** _____

Address: _____

Phone#: _____ **Fax#:** _____ **E-mail:** _____

TYPE OF DEVELOPMENT: _____ PLAT (# of lots) _____ RESIDENCE _____ DRB SITE ☒ ADMIN SITE

IS THIS A RESUBMITTAL? _____ Yes ☒ No

DEPARTMENT _____ TRANSPORTATION ☒ HYDROLOGY/DRAINAGE

Check all that Apply:

TYPE OF SUBMITTAL:

- ☒ ENGINEER/ARCHITECT CERTIFICATION
- ☐ PAD CERTIFICATION
- ☐ CONCEPTUAL G & D PLAN
- ☐ GRADING PLAN
- ☐ DRAINAGE REPORT
- ☐ DRAINAGE MASTER PLAN
- ☐ FLOODPLAIN DEVELOPMENT PERMIT APPLIC
- ☐ ELEVATION CERTIFICATE
- ☐ CLOMR/LOMR
- ☐ TRAFFIC CIRCULATION LAYOUT (TCL)
- ☐ TRAFFIC IMPACT STUDY (TIS)
- ☐ STREET LIGHT LAYOUT
- ☐ OTHER (SPECIFY) _____
- ☐ PRE-DESIGN MEETING?

TYPE OF APPROVAL/ACCEPTANCE SOUGHT:

- ☐ BUILDING PERMIT APPROVAL
- ☒ CERTIFICATE OF OCCUPANCY
- ☐ PRELIMINARY PLAT APPROVAL
- ☐ SITE PLAN FOR SUB'D APPROVAL
- ☐ SITE PLAN FOR BLDG. PERMIT APPROVAL
- ☐ FINAL PLAT APPROVAL
- ☐ SIA/ RELEASE OF FINANCIAL GUARANTEE
- ☐ FOUNDATION PERMIT APPROVAL
- ☐ GRADING PERMIT APPROVAL
- ☐ SO-19 APPROVAL
- ☐ PAVING PERMIT APPROVAL
- ☐ GRADING/ PAD CERTIFICATION
- ☐ WORK ORDER APPROVAL
- ☐ CLOMR/LOMR
- ☐ FLOODPLAIN DEVELOPMENT PERMIT
- ☐ OTHER (SPECIFY) _____

DATE SUBMITTED: 11/12/2019 **By:** Richard Stevenson

COA STAFF:

ELECTRONIC SUBMITTAL RECEIVED: _____

FEE PAID: _____

INTERSTATE 25

COMANCHE RD

A.G.R.S. MONUMENT "FFFFF"
STANDARD AMATEUR BRASS DISC
(FOUND IN PLACE)
NEW MEXICO STATE PLANE COORDINATES
(CENTRAL ZONE-N.A.D. 1983)
N=1500580.875 US SURVEY FEET
E=1532003.285 US SURVEY FEET
PUBLISHED EL=N/A US SURVEY FEET (NAVD 1988)
GROUND TO GRID FACTOR=0.999672747
DELTA ALPHA ANGLE=-012'30.96"

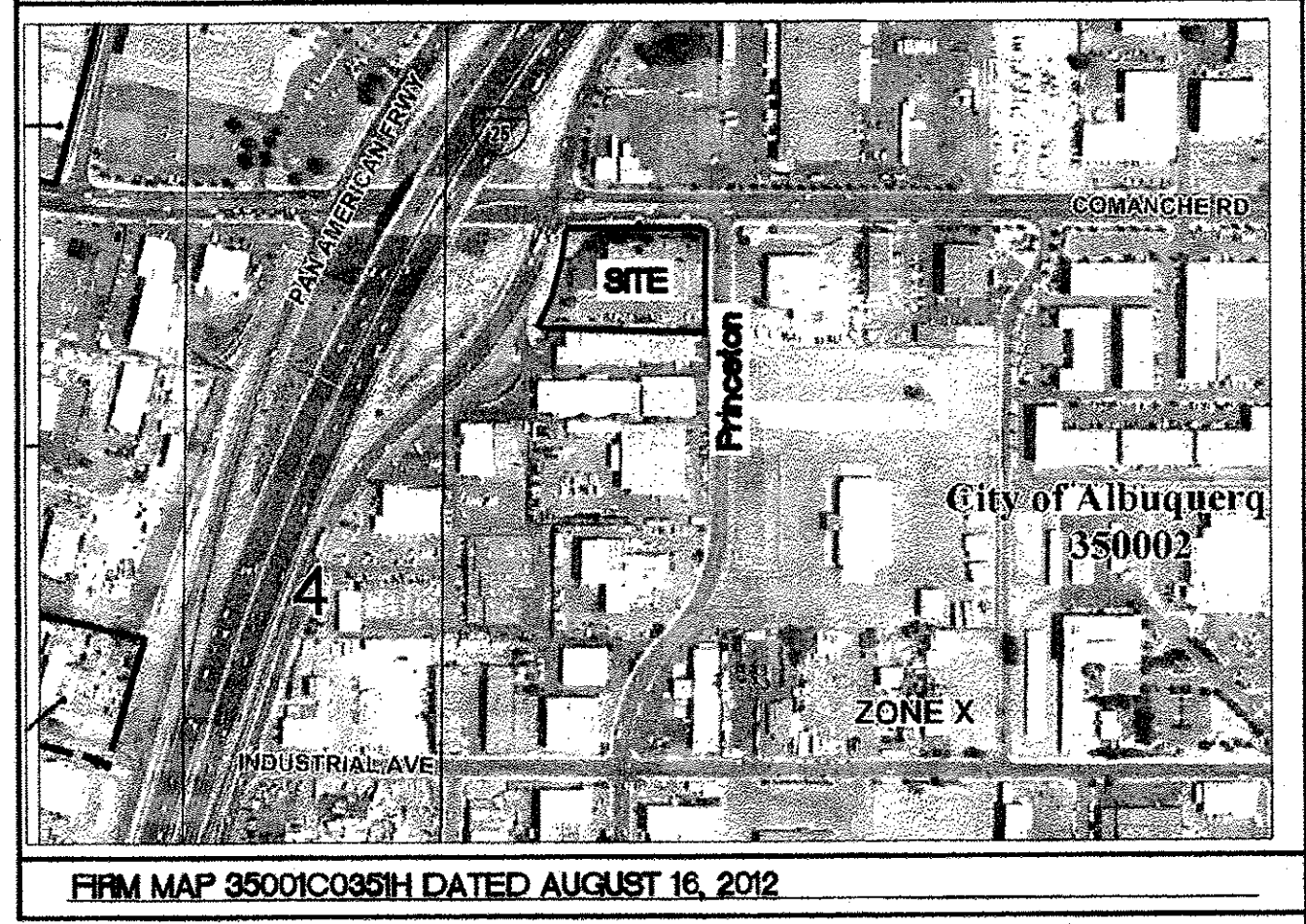
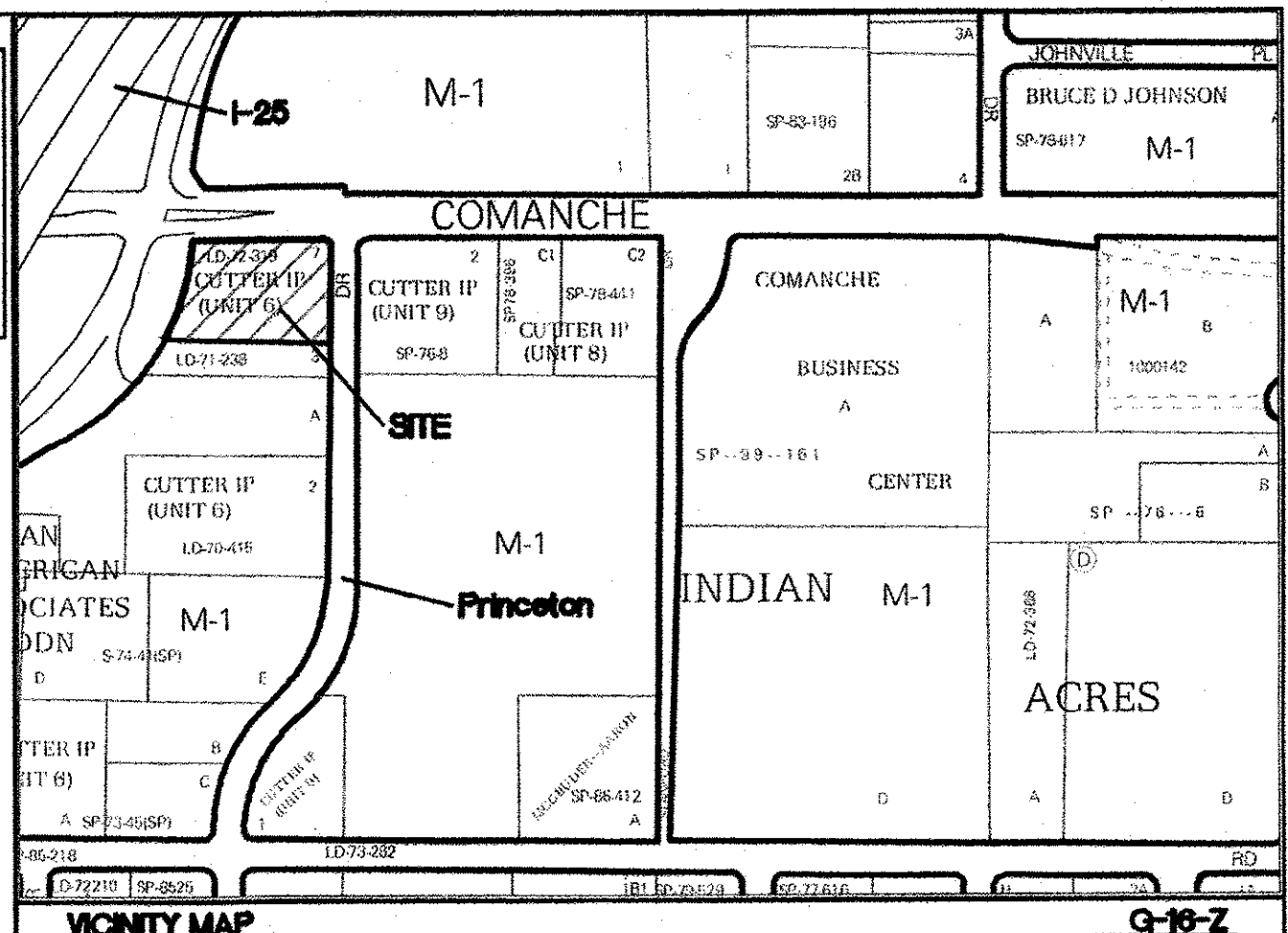

- LEGEND**
- CURB & GUTTER
 - BOUNDARY LINE
 - EASEMENT
 - SIDEWALK
 - CONTOUR MAJOR
 - CONTOUR MINOR
 - SPOT ELEVATION
 - FLOW ARROW
 - EXISTING CURB & GUTTER
 - EXISTING CONTOUR MAJOR
 - EXISTING CONTOUR MINOR
 - EXISTING SPOT ELEVATION
 - WATER BLOCK
 - ACCESSIBLE PATH
 - OVERFLOW RIPRAP/CONCRETE WEIR 2.0'W, 0.5'H, 3:1 SIDES
 - CLEANOUT

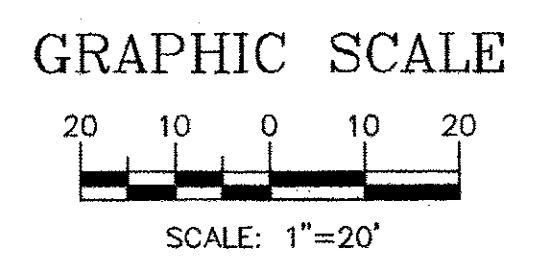
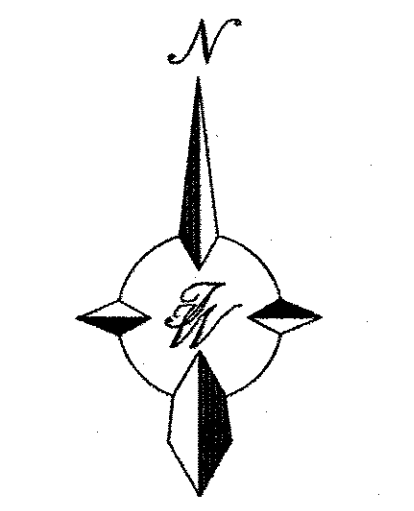

- NOTICE TO CONTRACTORS**
- AN EXCAVATION/CONSTRUCTION PERMIT WILL BE REQUIRED BEFORE BEGINNING ANY WORK WITHIN CITY RIGHT-OF-WAY.
 - ALL WORK DETAILED ON THESE PLANS TO BE PERFORMED, EXCEPT AS OTHERWISE STATED OR PROVIDED HEREON, SHALL BE CONSTRUCTED IN ACCORDANCE WITH CITY OF ALBUQUERQUE INTERIM STANDARD SPECIFICATIONS FOR PUBLIC WORKS CONSTRUCTION, 1985.
 - TWO WORKING DAYS PRIOR TO ANY EXCAVATION, THE CONTRACTOR MUST CONTACT NEW MEXICO ONE CALL, DIAL "811" OR (505) 260-1990 FOR THE LOCATION OF EXISTING UTILITIES.
 - PRIOR TO CONSTRUCTION, THE CONTRACTOR SHALL EXCAVATE AND VERIFY THE HORIZONTAL AND VERTICAL LOCATIONS OF ALL CONNECTIONS. SHOULD A CONFLICT EXIST, THE CONTRACTOR SHALL NOTIFY THE ENGINEER SO THAT THE CONFLICT CAN BE RESOLVED WITH A MINIMUM AMOUNT OF DELAY.
 - BACKFILL COMPACTION SHALL BE ACCORDING TO TRAFFIC/STREET USE.
 - MAINTENANCE OF THESE FACILITIES SHALL BE THE RESPONSIBILITY OF THE OWNER OF THE PROPERTY SERVED.
 - WORK ON ARTERIAL STREETS SHALL BE PERFORMED ON A 24-HOUR BASIS.
 - CONTRACTOR MUST CONTACT JASON RODRIGUEZ AT 235-8016 AND CONSTRUCTION COORDINATION AT 924-3416 TO SCHEDULE AN INSPECTION.

- EROSION CONTROL NOTES**
- CONTRACTOR IS RESPONSIBLE FOR OBTAINING A TOPSOIL DISTURBANCE PERMIT PRIOR TO BEGINNING WORK.
 - CONTRACTOR IS RESPONSIBLE FOR MAINTAINING RUN-OFF ON SITE DURING CONSTRUCTION.
 - CONTRACTOR IS RESPONSIBLE FOR CLEANING ALL SEDIMENT THAT GETS INTO EXISTING RIGHT-OF-WAY.
 - REPAIR OF DAMAGED FACILITIES AND CLEANUP OF SEDIMENT ACCUMULATIONS ON ADJACENT PROPERTIES AND IN PUBLIC FACILITIES IS THE RESPONSIBILITY OF THE CONTRACTOR.
 - ALL EXPOSED EARTH SURFACES MUST BE PROTECTED FROM WIND AND WATER EROSION PRIOR TO FINAL (CITY) ACCEPTANCE OF ANY PROJECT.

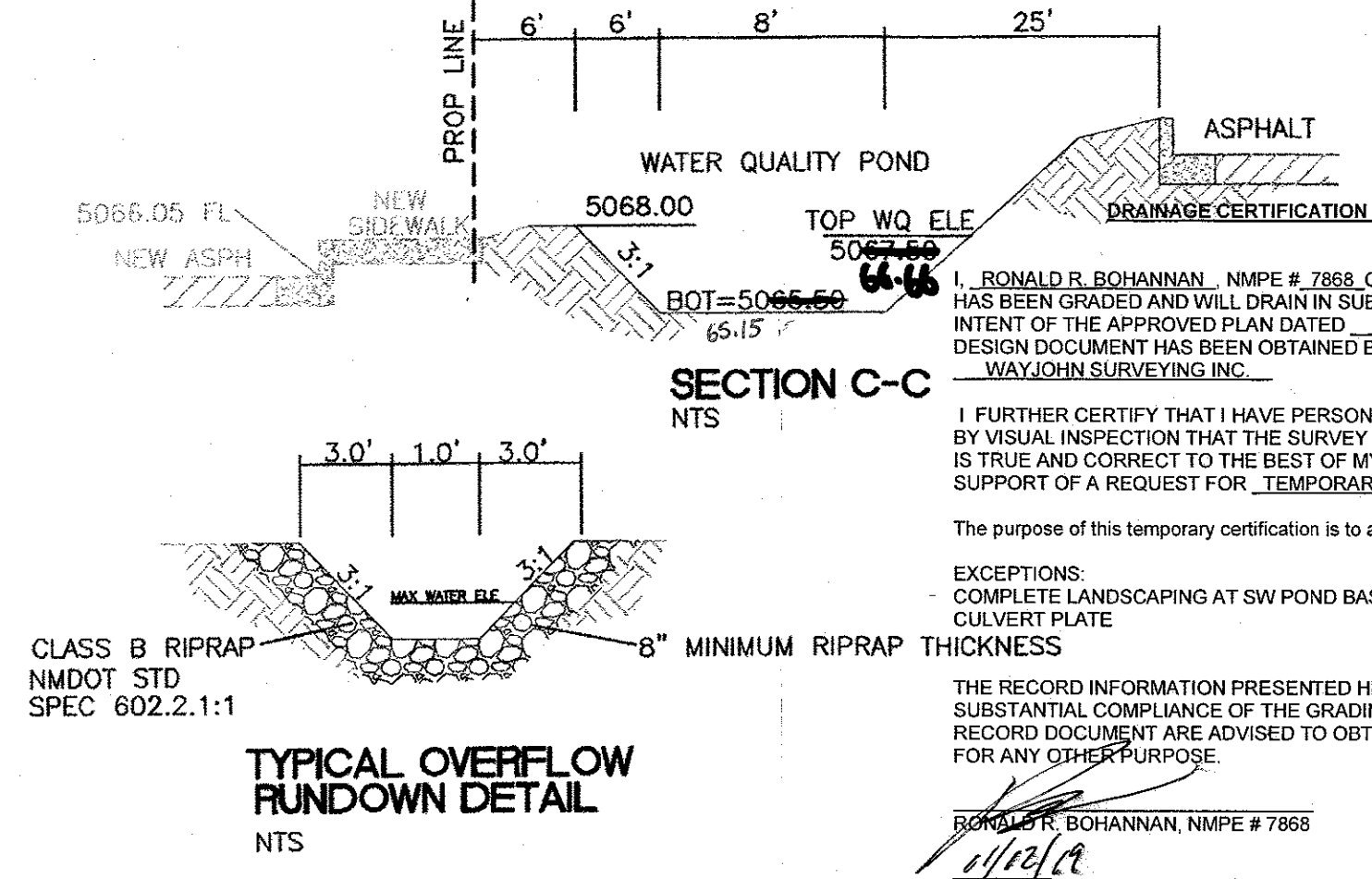
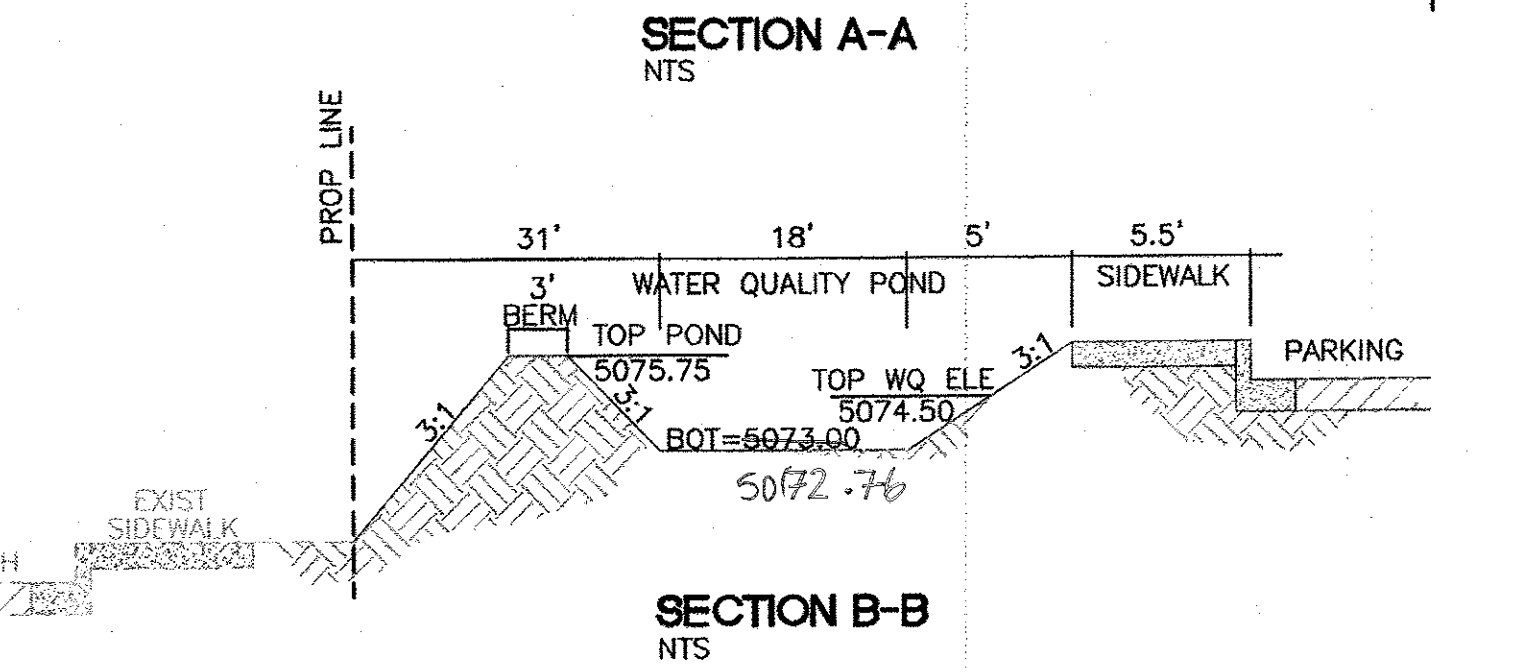
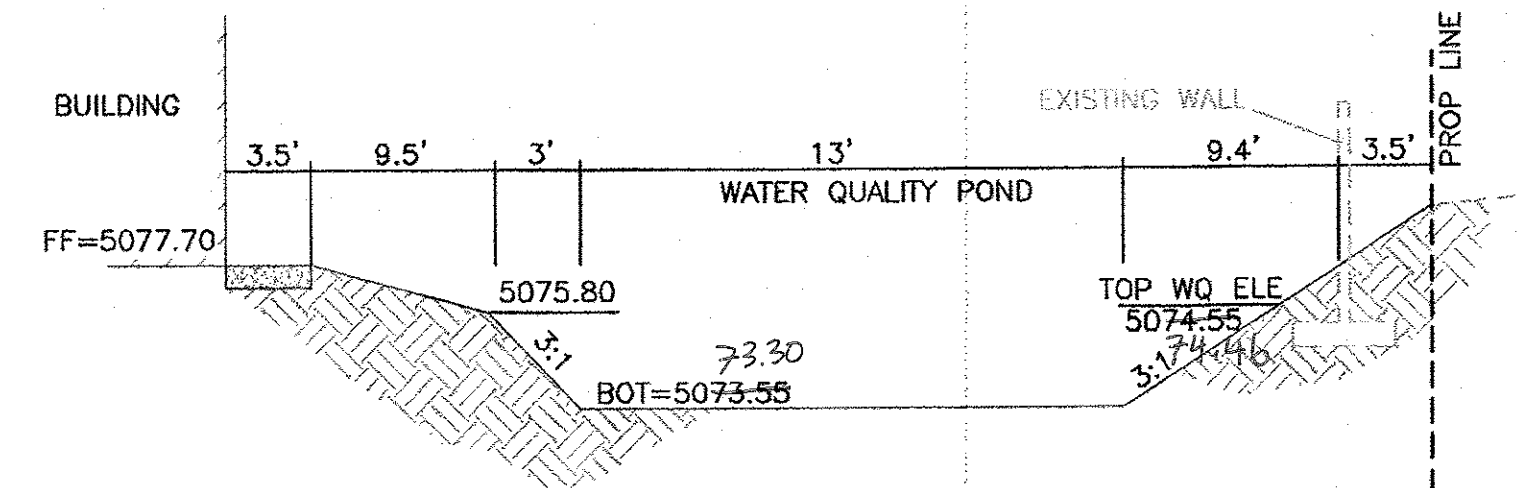

TYPICAL OVERFLOW RUNDOWN DETAIL

NTS

CLASS B RIPRAP NMDOT STD SPEC 602.2.1.1

8" MINIMUM RIPRAP THICKNESS

CAUTION:

ALL EXISTING UTILITIES SHOWN WERE OBTAINED FROM RESEARCH, AS-BUILTS, SURVEYS OR INFORMATION PROVIDED BY OTHERS. IT SHALL BE THE SOLE RESPONSIBILITY OF THE CONTRACTOR TO CONDUCT ALL NECESSARY FIELD INVESTIGATIONS PRIOR TO AND INCLUDING ANY EXCAVATION, TO DETERMINE THE ACTUAL LOCATION OF UTILITIES AND OTHER IMPROVEMENTS, PRIOR TO STARTING THE WORK. ANY CHANGES FROM THIS PLAN SHALL BE COORDINATED WITH AND APPROVED BY THE ENGINEER.

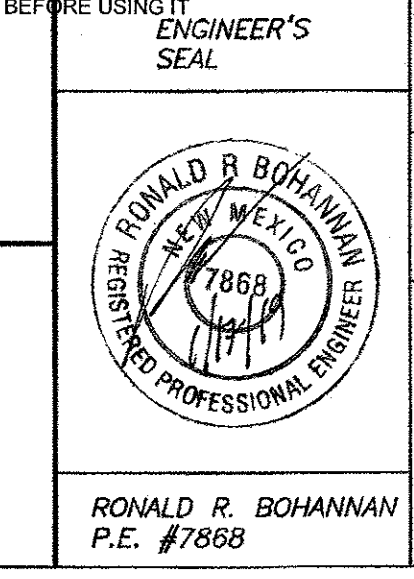
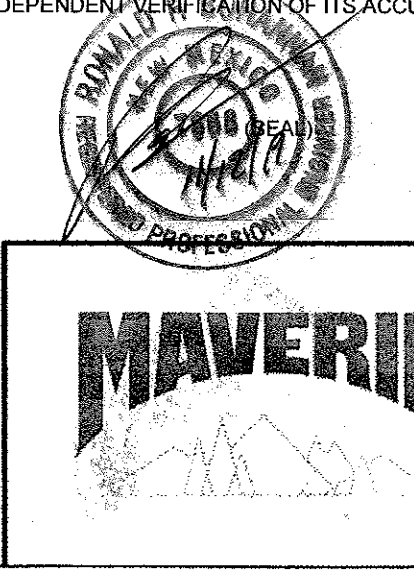

MAVERIK INC. STORE 3737 PRINCETON DR. NE	DRAWN BY BF
GRADING PLAN	DATE 1-17-19
TIERRA WEST, LLC 5571 MIDWAY PARK PL NE ALBUQUERQUE, NEW MEXICO 87109 (505) 858-3100 www.tierrawestllc.com	DRAWING 2018039-GR
	SHEET # C2
	JOB # 2018039