

**EROSION AND SEDIMENT CONTROL PLAN**  
TOTAL SITE ACRES 6.8 ACRES  
TOTAL DISTURBED AREA 6.8 ACRES  
REFER TO ESC 101 FOR EROSION AND SEDIMENT CONTROL PLAN, ZONE ATLAS LOCATOR. REFER TO SITE SWPPP FOR ADDITIONAL COMPLIANCE REQUIREMENTS. REFER TO THE ESC BMP DETAILS FOR INSTALLATION, INSPECTION AND MAINTENANCE REQUIREMENTS.

RECEIVING BODY - RIO GRANDE  
(NM-2105.50) LOCATED ~ 6.2  
MILES TO THE NORTH

- SWPPP LEGEND**
- PERMITTED / DISTURBED AREA
  - PERIMETER BMP (WIND / SILT FENCE)
  - INLET PROTECTION
  - CWA (TBD)
  - VTC
  - SANITARY TOILETS (TBD)
  - CONSTRUCTION TRAILER (TBD)
  - DUMPSTER (TBD)
  - SEDIMENT TRAPS- (MONITOR FOR MAINTENANCE)
  - FLOW DIRECTION

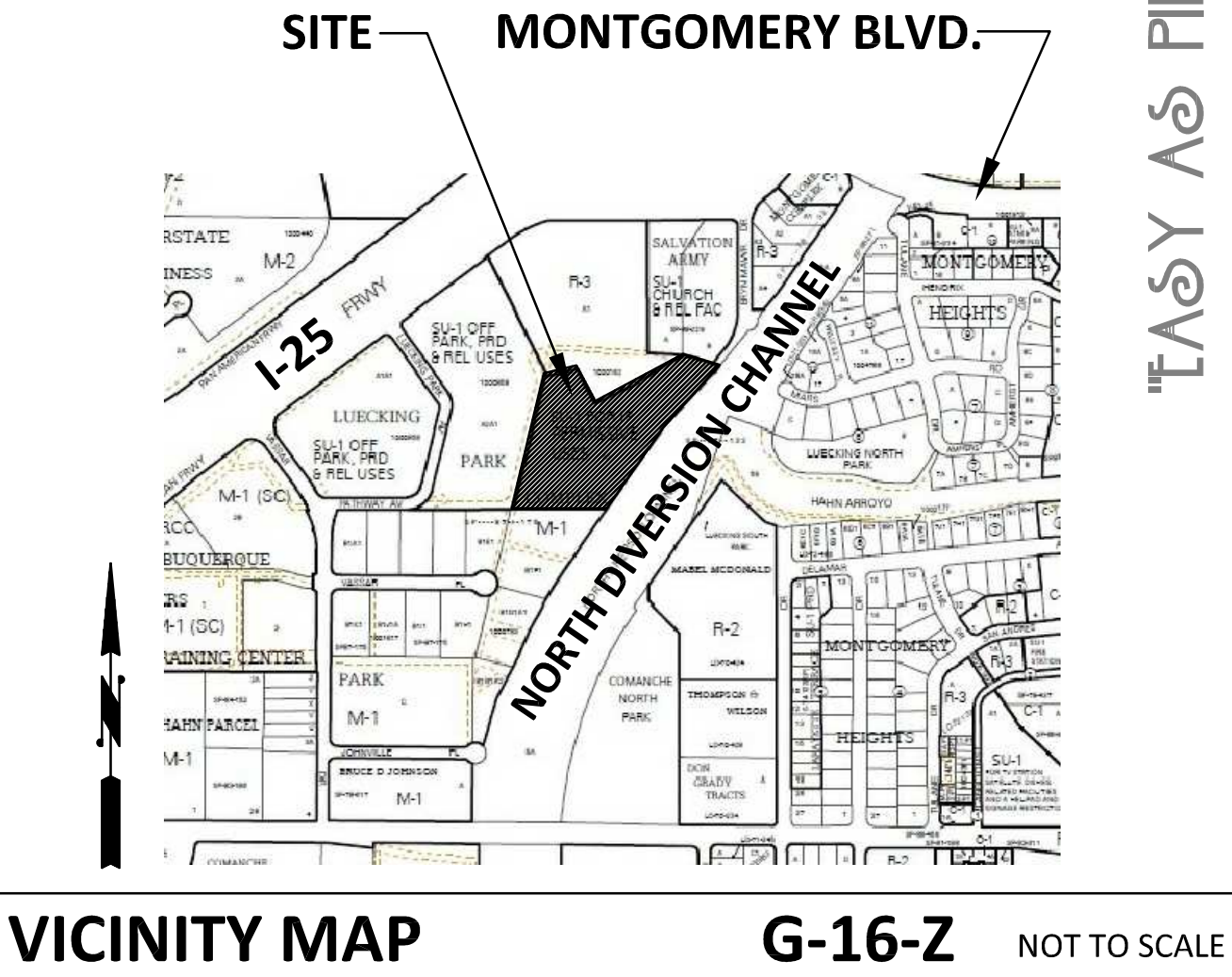

**JEEBS & ZUZU, LLC**  
ARCHITECTS & CONTRACTORS  
MAKING HOUSE CALLS

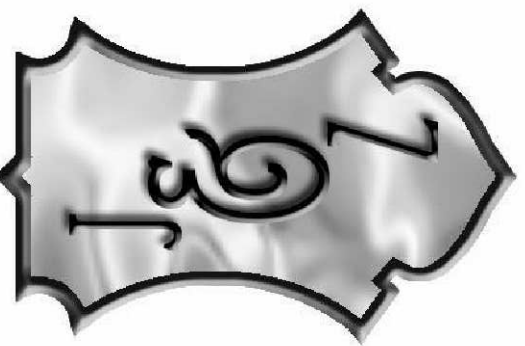

job no: 16-022  
drawn: BL  
checked: SMM  
date: Oct. 27, 2016

- LEGEND**
- EXISTING CONSTRUCTION
  - NEW CONTOUR
  - FF=4969.21 EXISTING BUILDING FINISH FLOOR ELEV
  - 36.5 NEW SPOT ELEVATION
  - NEW CONSTRUCTION
  - RD ROOF DRAIN
  - RETAINING WALL
  - TRW TOP OF RETAINING WALL
  - BW BOTTOM OF WALL

**EROSION CONTROL/ENVIRONMENTAL PROTECTION/STORM WATER POLLUTION PREVENTION PLAN**

**WATER AND WASTEWATER GENERAL NOTES**

1. THE CONTRACTOR SHALL BE RESPONSIBLE FOR FULFILLING ALL NECESSARY NATIONAL POLLUTANT DISCHARGE ELIMINATION SYSTEM (NPDES) REQUIREMENTS INCLUDING, BUT NOT LIMITED TO, OBTAINING AN NPDES PERMIT PRIOR TO CONSTRUCTION, FILLING OUT THE NOTICE OF INTENT (NOI) APPLICATION, AND FILLING OUT THE NOTICE OF TERMINATION (NOT) APPLICATION. THE CONTRACTOR SHALL ALSO BE RESPONSIBLE FOR THE IMPLEMENTATION OF AND INSPECTION REPORTS FOR THE STORM WATER POLLUTION PREVENTION PLAN (SWPPP). THE CONTRACTOR SHALL SUBMIT THE SWPPP WITH THE PROPOSED CONSTRUCTION STAGING AREA AND TEMPORARY SANITARY FACILITIES CLEARLY SHOWN. ANY CHECK DAMS, SILT FENCES, OR OTHER BEST MANAGEMENT PRACTICES (BMPs) THAT ARE REQUIRED IN THE APPROVED SWPPP SHALL BE INCLUDED IN AND ARE INCIDENTAL TO THE SWPPP BID AMOUNT.
2. THE CONTRACTOR SHALL MAINTAIN A COPY OF THE APPROVED SWPPP ON-SITE AT ALL TIMES, AND SHALL COMPLY WITH THE REQUIREMENTS INDICATED ON THAT PLAN.
3. THE CONTRACTOR SHALL CONFORM TO ALL CITY, COUNTY, STATE AND FEDERAL DUST AND EROSION CONTROL REGULATIONS. THE CONTRACTOR SHALL PREPARE AND OBTAIN ANY NECESSARY DUST OR EROSION CONTROL PERMITS FROM THE REGULATORY AGENCIES.
5. THE CONTRACTOR SHALL IMPLEMENT THE APPROVED SWPPP AND ENSURE THAT NO SOIL ERODES FROM THE SITE INTO PUBLIC RIGHT-OF-WAY OR ONTO PRIVATE PROPERTY.
6. THE CONTRACTOR SHALL MITIGATE EROSION OF TEMPORARY OR PERMANENT DIRT SWALES BY INSTALLING BMPs IDENTIFIED IN THE APPROVED SWPPP IN THE SWALES PERPENDICULAR TO THE DIRECTION OF FLOW, AND AT INTERVALS AS SPECIFIED IN THE SWPPP.
7. CONSTRUCTION AREAS SHALL BE WATERED FOR DUST CONTROL IN COMPLIANCE WITH GOVERNMENT ORDINANCES. THE CONTRACTOR SHALL BE RESPONSIBLE FOR LOCATING AND SUPPLYING WATER AS REQUIRED. WATERING, AS REQUIRED FOR CONSTRUCTION AND DUST CONTROL, SHALL BE CONSIDERED INCIDENTAL TO CONSTRUCTION AND NO MEASUREMENT OR PAYMENT SHALL BE MADE THEREFOR.
8. ANY AREAS DISTURBED BY CONSTRUCTION AND NOT COVERED BY LANDSCAPING OR AN IMPERVIOUS SURFACE SHALL BE REVEGETATED WITH NATIVE GRASS SEEDING. WHEN CONSTRUCTION ACTIVITIES CEASE AND EARTH DISTURBING ACTIVITIES WILL NOT RESUME WITHIN 14 DAYS, STABILIZATION MEASURES MUST BE INITIATED, UNLESS INDICATED OTHERWISE ON THESE PLANS OR ON THE LANDSCAPING PLAN. NATIVE GRASS SEEDING SHALL BE SEEDING PER SECTION 1012 OF THE NEW MEXICO STANDARD SPECIFICATIONS FOR PUBLIC WORKS CONSTRUCTION, APWA NM CHARTER, LATEST EDITION.
9. ALL WASTE PRODUCTS FROM THE CONSTRUCTION SITE, INCLUDING ITEMS DESIGNATED FOR REMOVAL, CONSTRUCTION WASTE, CONSTRUCTION EQUIPMENT WASTE PRODUCTS (OIL, GAS, TIRES, ETC.) GARBAGE, GRUBBING, EXCESS CUT MATERIAL, VEGETATIVE DEBRIS, ETC. SHALL BE APPROPRIATELY DISPOSED OF OFF-SITE AT NO ADDITIONAL COST TO THE OWNER. IT SHALL BE THE CONTRACTOR'S RESPONSIBILITY TO OBTAIN PERMITS REQUIRED TO HAUL OR DISPOSE OF WASTE PRODUCTS. IT SHALL BE THE CONTRACTOR'S RESPONSIBILITY TO ENSURE THAT THE WASTE DISPOSAL SITE COMPLIES WITH GOVERNMENT REGULATIONS REGARDING THE ENVIRONMENT, ENDANGERED SPECIES, AND ARCHAEOLOGICAL RESOURCES.
10. THE CONTRACTOR SHALL BE RESPONSIBLE FOR THE CLEANUP AND REPORTING OF SPILLS OF HAZARDOUS MATERIALS ASSOCIATED WITH THE CONSTRUCTION SITE. HAZARDOUS MATERIALS INCLUDE GASOLINE, DIESEL FUEL, MOTOR OIL, SOLVENTS, CHEMICALS, PAINTS, ETC. WHICH MAY BE A THREAT TO THE ENVIRONMENT. THE CONTRACTOR SHALL REPORT THE DISCOVERY OF PAST OR PRESENT SPILLS TO THE NEW MEXICO ENVIRONMENT DEPARTMENT EMERGENCY RESPONSE TEAM AT 505-827-8329.
11. THE CONTRACTOR SHALL COMPLY WITH ALL APPLICABLE REGULATIONS CONCERNING SURFACE AND UNDERGROUND WATER. CONTACT WITH SURFACE WATER BY CONSTRUCTION EQUIPMENT AND PERSONNEL SHALL BE MINIMIZED. EQUIPMENT MAINTENANCE AND REFUELING OPERATIONS SHALL BE PERFORMED IN AN ENVIRONMENTALLY SAFE MANNER IN COMPLIANCE WITH GOVERNMENT REGULATIONS.
12. THE CONTRACTOR SHALL COMPLY WITH ALL APPLICABLE REGULATIONS CONCERNING CONSTRUCTION NOISE AND HOURS OF OPERATION.
13. WHERE STORM INLETS ARE SUSCEPTIBLE TO INFLOW OF SILT OR DEBRIS FROM CONSTRUCTION ACTIVITIES, PROTECTION SHALL BE PROVIDED ON THEIR UPSTREAM SIDE UTILIZING BMPs IDENTIFIED IN THE APPROVED SWPPP.

**GRADING AND DRAINAGE PLAN**

1" = 30'

0 30' 60'



GREEN GLOBE ENVIRONMENTAL, LLC  
8505 PASEO ALAMEDA, ALBUQUERQUE NM  
505-301-0059  
D. TULL 11-22-16 REV 3.0-30-6

ARROYO VISTA APARTMENTS  
EROSION AND SEDIMENT  
CONTROL PLAN

sheet  
**ESC 101**

4201 BRYN MAWR DR. NE  
ALBUQUERQUE NM, 87107