

CITY OF ALBUQUERQUE

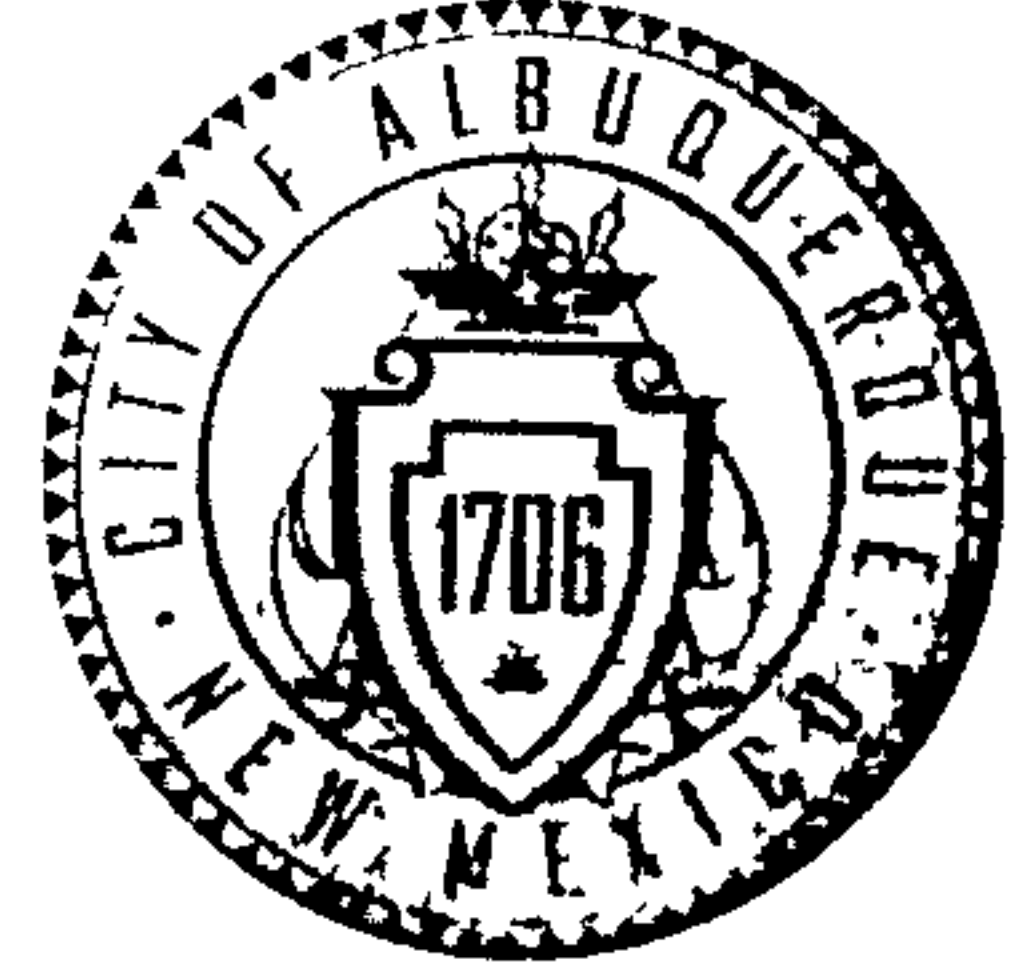

February 6, 2009

Suzanne Busch, P.E.
8209 Sprenger Dr NE
Albuquerque, NM 87109

**Re: St. Andrew Presbyterian Church Sidewalk Culvert Plan
Engineer's Stamp dated 2-4-09 (G18/D009)**

Dear Ms. Busch,

Based upon the information provided in your submittal received 2-4-09, the above referenced plan is approved for SO-19 Permit.

A separate permit (SO 19) is required for construction within City ROW. A copy of this approval letter must be on hand when applying for the excavation/barricading permit.

The sidewalk culvert must be inspected and accepted. Please contact Duane Schmitz, 235-8016, to schedule an inspection.

If you have any questions, you can contact me at 924-3695.

Sincerely,

Curtis A. Cherne, P.E.
Senior Engineer, Planning Dept.
Development and Building Services

Copy: Antoinette Baldonado, Excavation and Barricading
Duane Schmitz, Street/Storm Drain Maintenance

PO Box 1293

Albuquerque

NM 87103

www.cabq.gov

DRAINAGE AND TRANSPORTATION INFORMATION SHEET

(REV 12/2005)

PROJECT TITLE: St Andrew Sidewalk Culvert ZONE MAP: G-18/D009
 DRB#: N/A EPC#: N/A WORK ORDER#: N/A

LEGAL DESCRIPTION:

CITY ADDRESS: 5301 Ponderosa

ENGINEERING FIRM: Mary S. Busch

ADDRESS: 8209 Sprenger NE

CITY, STATE: Albuquerque, NM

CONTACT: Suzanne Busch

PHONE: 821-4304

ZIP CODE: 87109

OWNER: St. Andrew Presbyterian Church

ADDRESS: 5301 Ponderosa NE

CITY, STATE: Albuquerque NM

CONTACT: Bill Stanley

PHONE: 821-4304

ZIP CODE: 87110

ARCHITECT: N/A

ADDRESS: _____

CITY, STATE: _____

CONTACT: _____

PHONE: _____

ZIP CODE: _____

SURVEYOR: N/A

ADDRESS: _____

CITY, STATE: _____

CONTACT: _____

PHONE: _____

ZIP CODE: _____

CONTRACTOR: To be determined

ADDRESS: _____

CITY, STATE: _____

CONTACT: _____

PHONE: _____

ZIP CODE: _____

TYPE OF SUBMITTAL:

- ☐ DRAINAGE REPORT
- ☒ DRAINAGE PLAN 1st SUBMITTAL
- ☐ DRAINAGE PLAN RESUBMITTAL
- ☐ CONCEPTUAL G & D PLAN
- ☐ GRADING PLAN
- ☐ EROSION CONTROL PLAN
- ☐ ENGINEER'S CERT (HYDROLOGY)
- ☐ CLOMR/LOMR
- ☐ TRAFFIC CIRCULATION LAYOUT
- ☐ ENGINEER'S CERT (TCL)
- ☐ ENGINEER'S CERT (DRB SITE PLAN)
- ☐ OTHER (SPECIFY) _____

CHECK TYPE OF APPROVAL SOUGHT:

- ☐ SIA/FINANCIAL GUARANTEE RELEASE
- ☐ PRELIMINARY PLAT APPROVAL
- ☐ S. DEV. PLAN FOR SUB'D APPROVAL
- ☐ S. DEV. FOR BLDG. PERMIT APPROVAL
- ☐ SECTOR PLAN APPROVAL
- ☐ FINAL PLAT APPROVAL
- ☐ FOUNDATION PERMIT APPROVAL
- ☐ BUILDING PERMIT APPROVAL
- ☐ CERTIFICATE OF OCCUPANCY (PERM)
- ☐ CERTIFICATE OF OCCUPANCY (TEMP)
- ☐ GRADING PERMIT APPROVAL
- ☐ PAVING PERMIT APPROVAL
- ☐ WORK ORDER APPROVAL
- ☒ OTHER (SPECIFY) SO-19

WAS A PRE-DESIGN CONFERENCE ATTENDED:

- ☒ YES
- ☐ NO
- ☐ COPY PROVIDED

DATE SUBMITTED: 2/4/09

BY: Suzanne Busch

Requests for approvals of Site Development Plans and/or Subdivision Plats shall be accompanied by a drainage submittal. The particular nature, location, and scope to the proposed development defines the degree of drainage detail. One or more of the following levels of submittal may be required based on the following:

1. **Conceptual Grading and Drainage Plan:** Required for approval of Site Development Plans greater than five (5) acres and Sector Plans.
2. **Drainage Plans:** Required for building permits, grading permits, paving permits and site plans less than five (5) acres.
3. **Drainage Report:** Required for subdivision containing more than ten (10) lots or constituting five (5) acres or more.

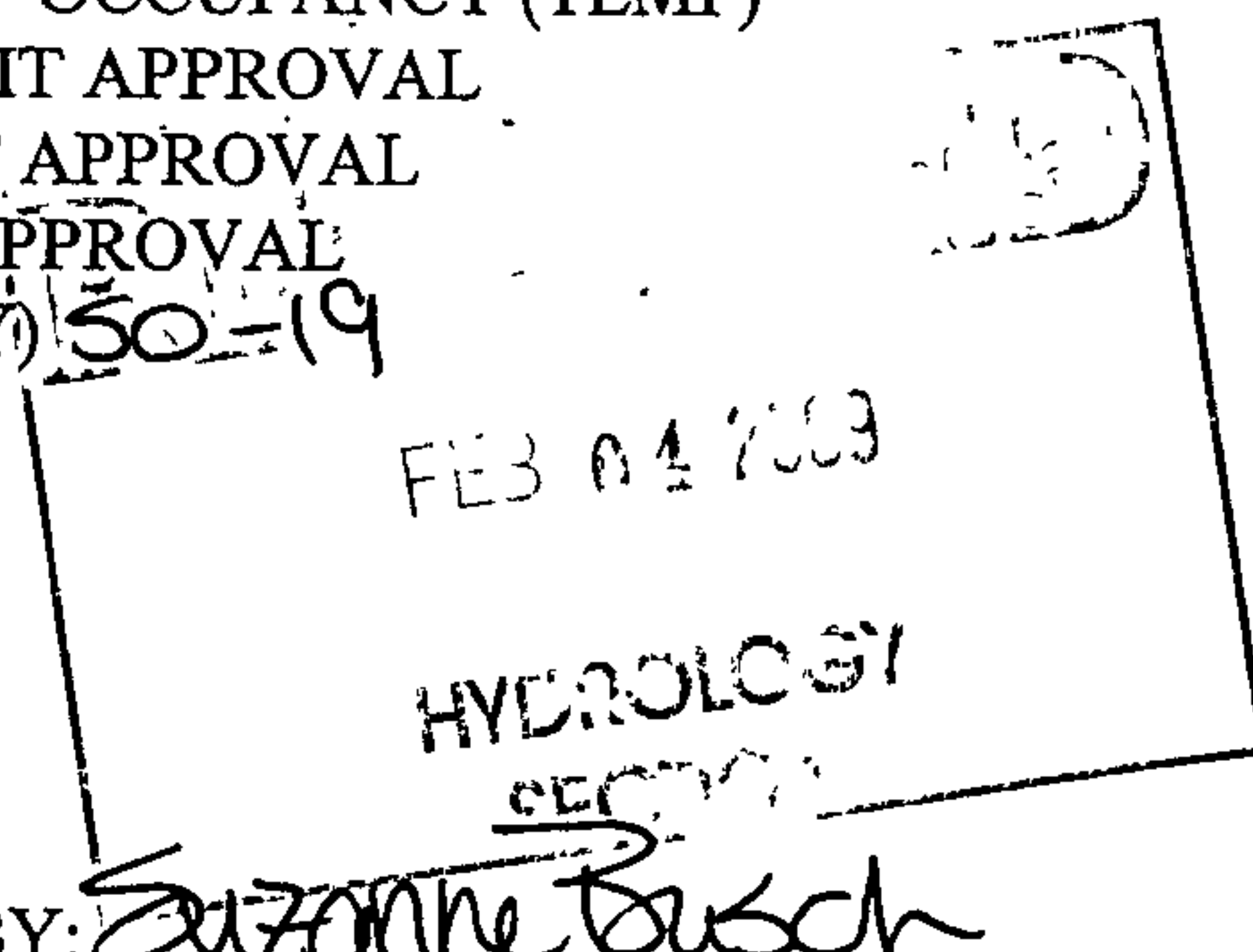

Mary Suzanne Busch, P.E.
8209 Sprenger Dr. NE
Albuquerque, NM 87109

February 4, 2009

Mr. Curtis Cherne, P.E.
City of Albuquerque
P.O. Box 1293
Albuquerque, NM 87103

Re: St. Andrew Presbyterian Church
5301 Ponderosa NE

Dear Mr. Cherne:

Attached please find a drawing for replacing a sidewalk pipe with a City approved sidewalk culvert at the referenced address. The pipe was installed approximately five years ago and is undersized for the site flow. My calculations are shown using the weir equation which rendered the most conservative flow.

We would like to construct the improvement using the SO-19 procedure. Please let me know if you require additional information.

Sincerely,

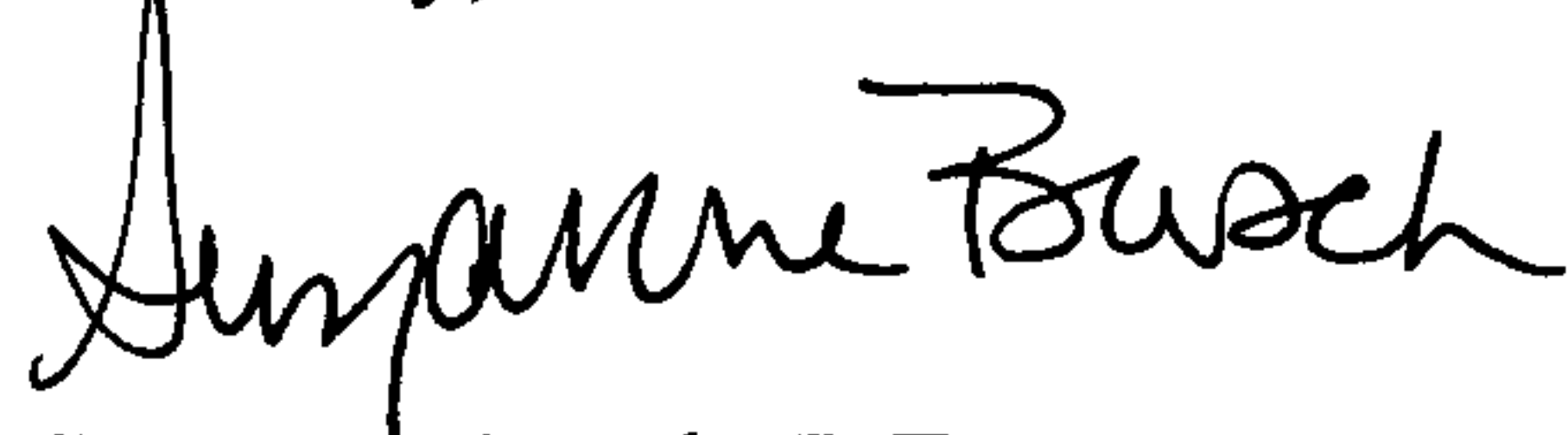

Suzanne Busch, P.E.

Cc: William Stanley, St. Andrew Presbyterian Church
Sally Aber, St. Andrew Presbyterian Church

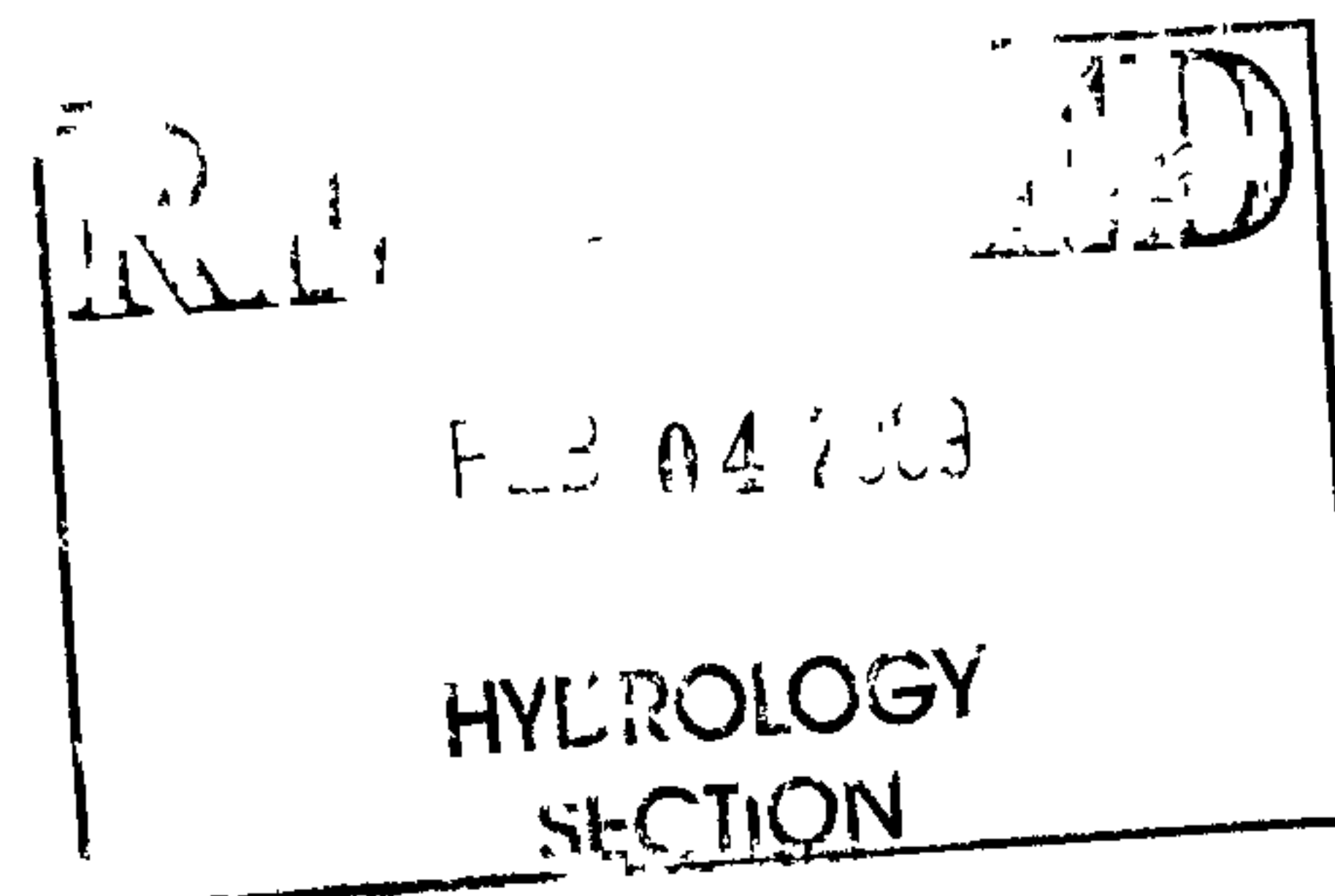

5301 Ponderosa NE

Area

$$A_{\text{drn}} = 0.41 \text{ acre}$$

$$A_{\text{paved}} = 0.29 \text{ acre}$$

$$\text{Peak Discharge} = 2.60(0.41) + 5.02(0.29) = 2.53 \text{ cfs}$$

$$\text{Weir } Q = CLH^{3/2}$$

$$C = 2.7$$

$$H = 7 \text{ inches } H^{3/2} = 0.45$$

$$2.53 = 2.7(L)(0.45) \rightarrow L = 2.08 \text{ ft Use a 2 ft sidewalk culvert}$$

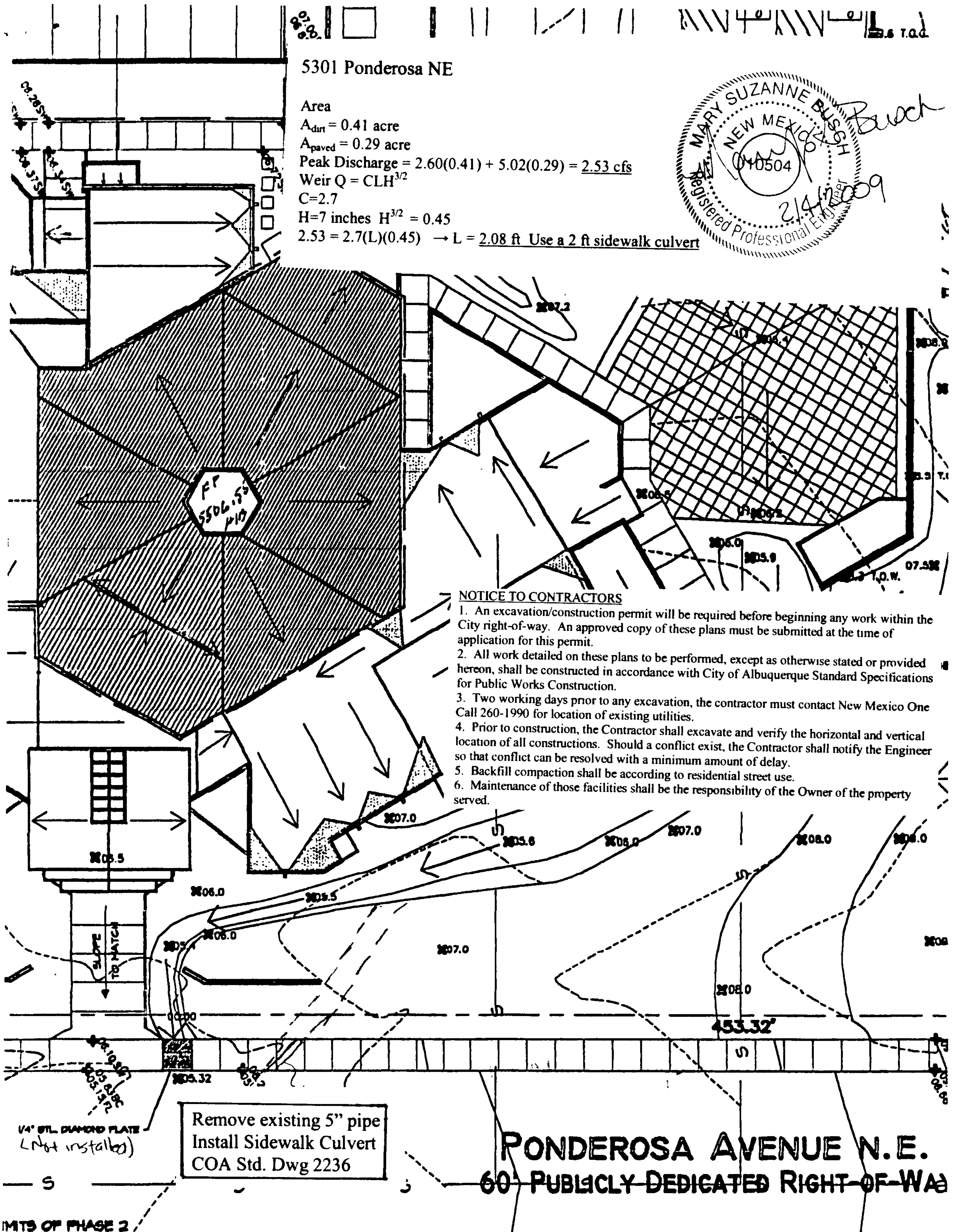
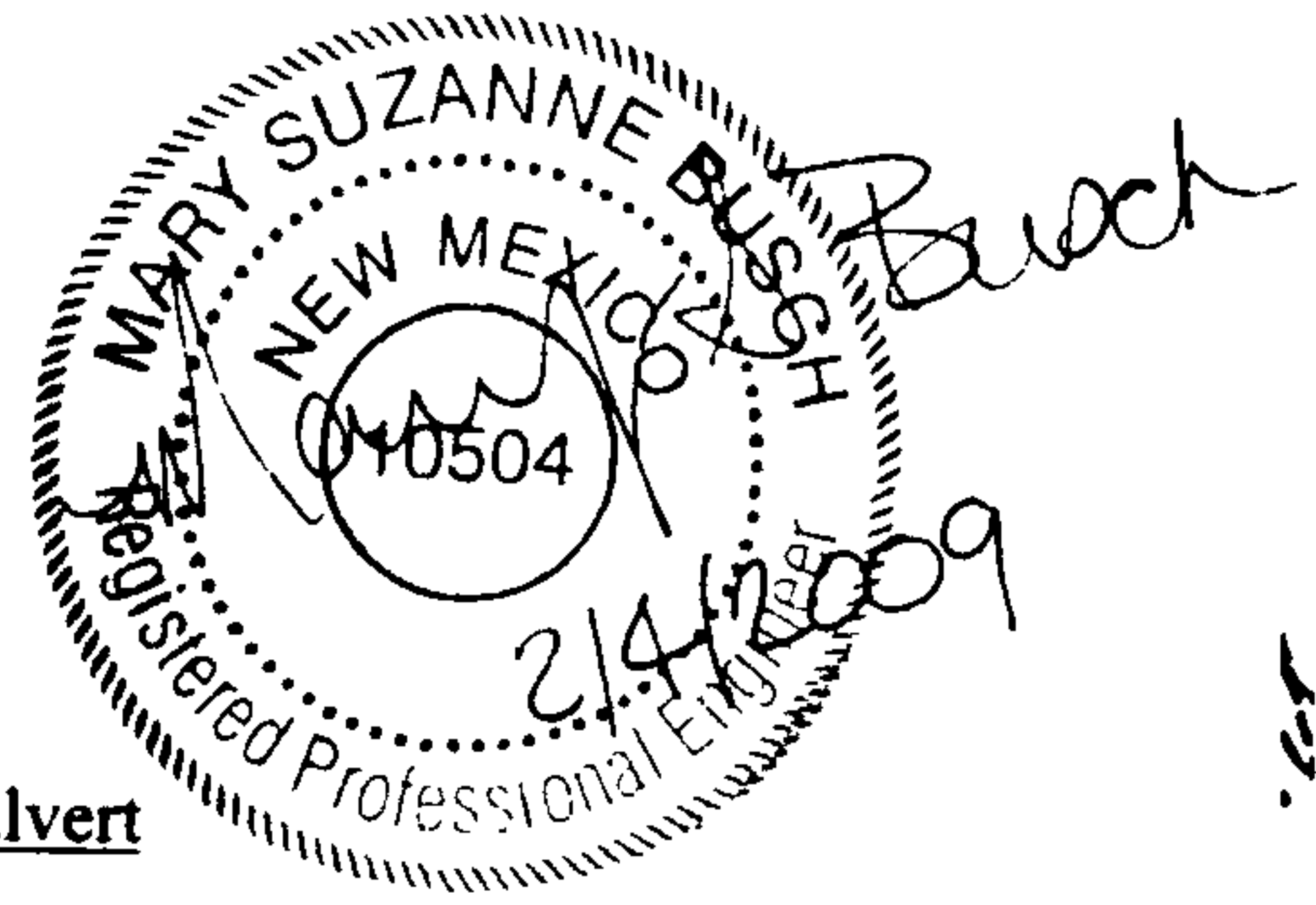

NOTICE TO CONTRACTORS

1. An excavation/construction permit will be required before beginning any work within the City right-of-way. An approved copy of these plans must be submitted at the time of application for this permit.
2. All work detailed on these plans to be performed, except as otherwise stated or provided hereon, shall be constructed in accordance with City of Albuquerque Standard Specifications for Public Works Construction.
3. Two working days prior to any excavation, the contractor must contact New Mexico One Call 260-1990 for location of existing utilities.
4. Prior to construction, the Contractor shall excavate and verify the horizontal and vertical location of all constructions. Should a conflict exist, the Contractor shall notify the Engineer so that conflict can be resolved with a minimum amount of delay.
5. Backfill compaction shall be according to residential street use.
6. Maintenance of those facilities shall be the responsibility of the Owner of the property served.

Remove existing 5" pipe
Install Sidewalk Culvert
COA Std. Dwg 2236

PONDEROSA AVENUE N.E.
60' PUBLICLY DEDICATED RIGHT-OF-WAY



City of Albuquerque

P.O. BOX 1293 ALBUQUERQUE, NEW MEXICO 87103

August 14, 2003

Harold Bennett, PE
Bennett Engineering
8601 Washington NE
Albuquerque, NM 87113

G-18/D9

Re: St. Andrew Church Grading and Drainage Plan
Engineer's Stamp dated 7-28-03 (G18/D9)

Dear Mr. Bennett,

Based upon the information provided in your submittal dated 7-29-03, the above referenced plan is approved for Building Permit and SO#19 Permit. Please attach a copy of this approved plan to the construction sets prior to sign-off by Hydrology.

There were many comments that were not addressed (off-site flows, quantification of runoff, applicable SO19 notes, etc) but I approved this plan because it is in an area where the construction plan isn't as critical to downstream facilities. I hope your next submittal is more professional and follows the DPM better.

A separate permit is required for construction within City R/W. A copy of this approval letter must be on hand when applying for the excavation permit. This project requires a National Pollutant Discharge Elimination System (NPDES) permit. Refer to the attachment that is provided with this letter for details. If you have any questions please feel free to call the Public Works Hydrology section at 768-3654 (Charles Caruso) or 768-3645 (Brian Wolfe).

Also, prior to Certificate of Occupancy release, Engineer Certification per the DPM checklist will be required.

If you have any questions, you can contact me at 924-3986.

Sincerely,

Bradley L. Bingham, PE
Sr. Engineer, Planning Dept.
Development and Building Services

C: file
perm Lyon

BRAD

DRAINAGE AND TRANSPORTATION INFORMATION SHEET
(REV. 1/28/2003rd)

G-18/D9

PROJECT TITLE: St. Andrew Church ZONE MAP/DRG. FILE #: G-18
DRB #: _____ EPC#: _____ WORK ORDER#: _____

LEGAL DESCRIPTION: Port. Lot 1, Blk. 29 Altamont Addition
CITY ADDRESS: 5301 PONDICLOSA N.E.

ENGINEERING FIRM: BEANET
ADDRESS: _____
CITY, STATE: _____

CONTACT: HAROLD BEANET
PHONE: 250-4121
ZIP CODE: _____

OWNER: St. A. PIESBY Church
ADDRESS: _____
CITY, STATE: _____

CONTACT: _____
PHONE: _____
ZIP CODE: _____

ARCHITECT: KDC
ADDRESS: 2601 WASHINGTON N.E.
CITY, STATE: ALB. 87113

CONTACT: John Klee
PHONE: _____
ZIP CODE: 830-3637

SURVEYOR: _____
ADDRESS: _____
CITY, STATE: _____

CONTACT: _____
PHONE: _____
ZIP CODE: _____

CONTRACTOR: _____
ADDRESS: _____
CITY, STATE: _____

CONTACT: _____
PHONE: _____
ZIP CODE: _____

CHECK TYPE OF SUBMITTAL:

- ☐ DRAINAGE REPORT
☒ DRAINAGE PLAN 1st SUBMITTAL, *REQUIRES TCL or equal*
☐ DRAINAGE PLAN RESUBMITTAL
☐ CONCEPTUAL GRADING & DRAINAGE PLAN
☐ GRADING PLAN
☐ EROSION CONTROL PLAN
☐ ENGINEER'S CERTIFICATION (HYDROLOGY)
☐ CLOMR/LOMR
☐ TRAFFIC CIRCULATION LAYOUT (TCL)
☐ ENGINEERS CERTIFICATION (TCL)
☐ ENGINEERS CERTIFICATION (DRB APPR. SITE PLAN)
☐ OTHER

CHECK TYPE OF APPROVAL SOUGHT:

- ☐ SIA / FINANCIAL GUARANTEE RELEASE
☐ PRELIMINARY PLAT APPROVAL
☐ S. DEV. PLAN FOR SUB'D. APPROVAL
☐ S. DEV. PLAN FOR BLDG. PERMIT APPROVAL
☐ SECTOR PLAN APPROVAL
☐ FINAL PLAT APPROVAL
☐ FOUNDATION PERMIT APPROVAL
☒ BUILDING PERMIT APPROVAL
☐ CERTIFICATE OF OCCUPANCY (PERM.)
☐ CERTIFICATE OF OCCUPANCY (TEMP.)
☐ GRADING PERMIT APPROVAL
☐ PAVING PERMIT APPROVAL
☐ WORK ORDER APPROVAL
☐ OTHER (SPECIFY)

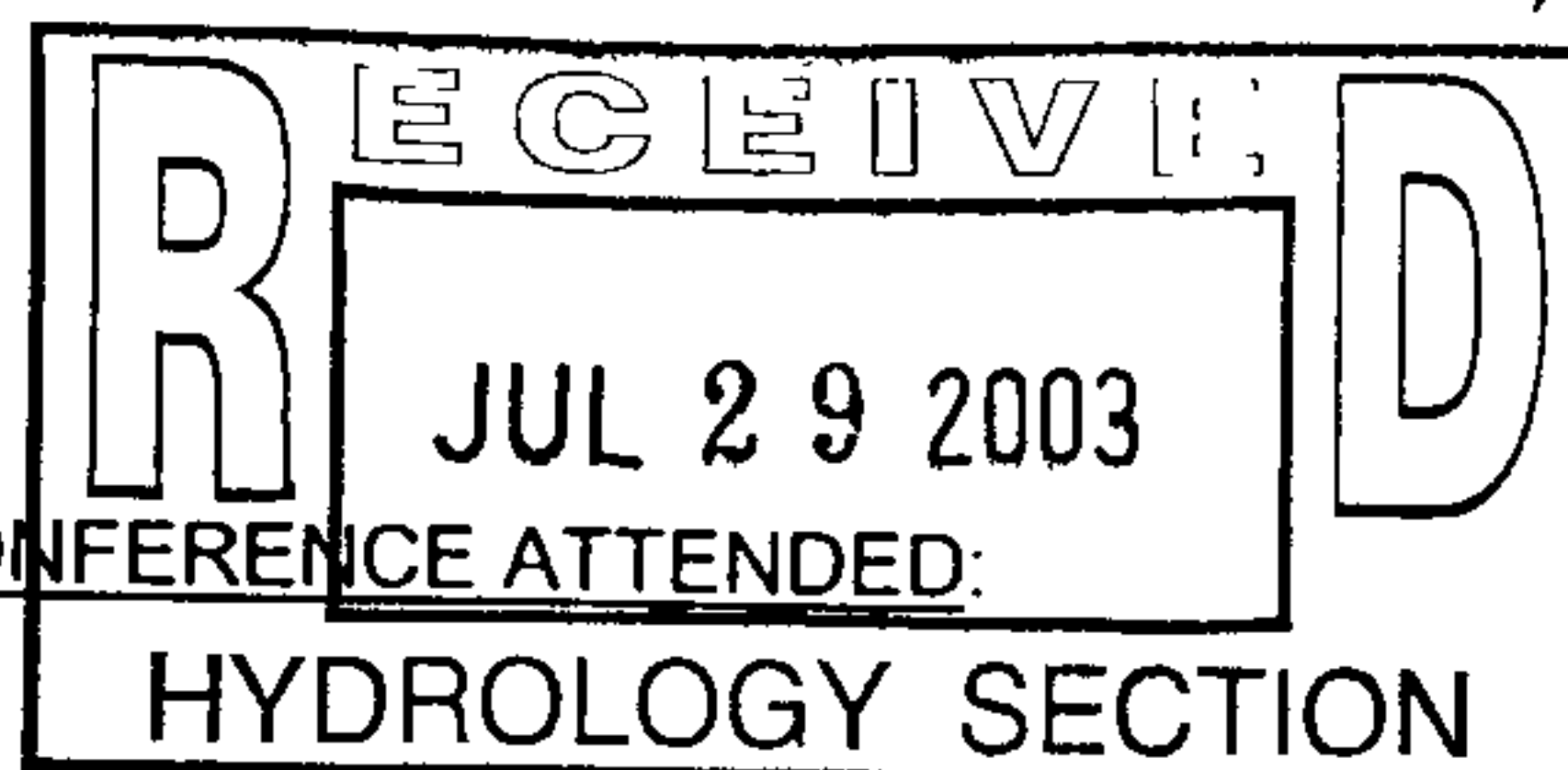

WAS A PRE-DESIGN CONFERENCE ATTENDED:

- ☐ YES
☐ NO
☐ COPY PROVIDED

DATE SUBMITTED: 7/29/03 BY: [Signature]

Requests for approvals of Site Development Plans and/or Subdivision Plats shall be accompanied by a drainage submittal. The particular nature, location and scope of the proposed development defines the degree of drainage detail. One or more of the following levels of submittal may be required based on the following:

1. **Conceptual Grading and Drainage Plan:** Required for approval of Site Development Plans greater than five (5) acres and Sector Plans.
2. **Drainage Plans:** Required for building permits, grading permits, paving permits and site plans less than five (5) acres.
3. **Drainage Report:** Required for subdivisions containing more than ten (10) lots or constituting five (5) acres or more.



City of Albuquerque

P.O. BOX 1293 ALBUQUERQUE, NEW MEXICO 87103

***Planning Department
Transportation Development Services Section***

June 19, 2003

Harold Bennett, PE
8601 Washington NE
Albuquerque, NM
87113

Re: Traffic Circulation Layout (TCL) Submittal for Building Permit Approval for
St. Andrew Presbyterian Church [G-18/D9]
Engineer's Stamp Dated 6-06-03

Dear Mr. Bennett:

The TCL submittal dated June 9, 2003 is approved with the conditions as follows (1) The keyway is shortened to 5ft per our standards and (2) the "share your care building" is clearly indicated. This plan is stamped and signed as approved. Two copies will be required: one for each of the building permit plans and the original to be kept by you to be used for certification of the site for final C.O. for Transportation.

If a temporary CO is needed then a copy of the original TCL that was stamped as approved by the City which includes a statement that identifies the outstanding items that need to be constructed or the items that have not been built in "substantial compliance". This statement requires a NM registered architect or engineer stamp to be dated. Submit this TCL with a completed Drainage and Transportation Information Sheet to Hydrology at the Development Services Center of Plaza Del Sol Building.

When the site is completed and a final C.O. is requested, use the original City stamped approved TCL for certification. A NM registered architect or engineer needs stamp and date the certification TCL along with indicating that the development was built in "substantial compliance" with the TCL. Submit this certification TCL with a completed Drainage and Transportation Information Sheet to Hydrology at the Development Services Center of Plaza Del Sol Building.

Once verification of certification is completed and approved, notification will be made to Building Safety to issue Final C.O. To confirm that a final C.O. has been issued, call Building Safety at 924-3306.

Sincerely,

Richard Dourte, PE
Traffic Engineer
Development and Building Services

cc: Hydrology file
file



City of Albuquerque

P.O. BOX 1293 ALBUQUERQUE, NEW MEXICO 87103

June 12, 2003

Harold Bennett, PE
8601 Washington NE
Albuquerque, NM 87113

**RE: St. Andrew Presbyterian Church
Grading and Drainage Plan (G-18/D9)
Engineer's Stamp Dated June 6, 2003**

Dear Mr. Bennett:

Based on the information provided in your submittal received June 9, 2003, the above referenced plan cannot be approved for Building Permit until the following comments are addressed.

- Runoff needs to be directed through a sidewalk culvert into Ponderosa Av. Please submit two copies of the drainage and grading plan for SO#19.
- Please explain your statement for the "Existing Peak Discharge."
- Are there any offsite flows? If so, please quantify.
- Please add a legend to indicate hatching and abbreviations.
- Please give more details on runoff of north parking lot at the hand placed stone location.

If you have any questions please call me at 924-3982.

Sincerely,

Carlos A. Montoya, PE
City Floodplain Administrator



City of Albuquerque

P.O. BOX 1293 ALBUQUERQUE, NEW MEXICO 87103

June 12, 2003

Harold Bennett, PE
8601 Washington NE
Albuquerque, NM 87113

**RE: St. Andrew Presbyterian Church
Grading and Drainage Plan (G-18/D9)
Engineer's Stamp Dated June 6, 2003**

*mark up
given to
Harold*

Dear Mr. Bennett:

Based on the information provided in your submittal received June 9, 2003, the above referenced plan cannot be approved for Building Permit until the following comments are addressed.

- Runoff needs to be directed through a sidewalk culvert into Ponderosa Av. Please submit two copies of the drainage and grading plan for SO#19.
- Please explain your statement for the "Existing Peak Discharge."
- Are there any offsite flows? If so, please quantify.
- Please add a legend to indicate hatching and abbreviations.
- Please give more details on runoff of north parking lot at the hand placed stone location.

If you have any questions please call me at 924-3982.

Sincerely,

Carlos A. Montoya, PE
City Floodplain Administrator

DRAINAGE AND TRANSPORTATION INFORMATION SHEET

(REV. 1/28/2003rd)

PROJECT TITLE: St. Andrew Presby Church ZONE MAP/DRG. FILE #: G-18/D9
DRB #: _____ EPC#: _____ WORK ORDER#: _____

LEGAL DESCRIPTION: _____
CITY ADDRESS: _____

ENGINEERING FIRM: BENNETT, HAROLD
ADDRESS: 8601 WASHINGTON N.E.
CITY, STATE: ALB., 87113

CONTACT: HAROLD BENNETT
PHONE: 266-3038 / 830-3637
ZIP CODE: _____

OWNER: St. Andrew Presby Church
ADDRESS: _____
CITY, STATE: _____

CONTACT: _____
PHONE: _____
ZIP CODE: _____

ARCHITECT: KDC/BILL BUCKLEY
ADDRESS: 8601 WASHINGTON N.E.
CITY, STATE: _____

CONTACT: John Klee
PHONE: 830-3637
ZIP CODE: 87113

SURVEYOR: SURVEYS SOUTHWEST
ADDRESS: _____
CITY, STATE: _____

CONTACT: DM
PHONE: _____
ZIP CODE: _____

CONTRACTOR: INTERSTATE DEVEL.
ADDRESS: 8601 WASHINGTON N.E.
CITY, STATE: _____

CONTACT: TERRY
PHONE: 821-5263
ZIP CODE: 87113

CHECK TYPE OF SUBMITTAL:

- ☒ DRAINAGE REPORT
- ☒ DRAINAGE PLAN 1st SUBMITTAL, *REQUIRES TCL or equal*
- ☐ DRAINAGE PLAN RESUBMITTAL
- ☐ CONCEPTUAL GRADING & DRAINAGE PLAN
- ☐ GRADING PLAN
- ☐ EROSION CONTROL PLAN
- ☐ ENGINEER'S CERTIFICATION (HYDROLOGY)
- ☐ CLOMR/LOMR
- ☒ TRAFFIC CIRCULATION LAYOUT (TCL)
- ☐ ENGINEERS CERTIFICATION (TCL)
- ☐ ENGINEERS CERTIFICATION (DRB APPR. SITE PLAN)
- ☐ OTHER

CHECK TYPE OF APPROVAL SOUGHT:

- ☐ SIA / FINANCIAL GUARANTEE RELEASE
- ☐ PRELIMINARY PLAT APPROVAL
- ☐ S. DEV. PLAN FOR SUB'D. APPROVAL
- ☐ S. DEV. PLAN FOR BLDG. PERMIT APPROVAL
- ☐ SECTOR PLAN APPROVAL
- ☐ FINAL PLAT APPROVAL
- ☐ FOUNDATION PERMIT APPROVAL
- ☒ BUILDING PERMIT APPROVAL
- ☐ CERTIFICATE OF OCCUPANCY (PERM.)
- ☐ CERTIFICATE OF OCCUPANCY (TEMP.)
- ☐ GRADING PERMIT APPROVAL
- ☐ PAVING PERMIT APPROVAL
- ☐ WORK ORDER APPROVAL
- ☐ OTHER (SPECIFY)

WAS A PRE-DESIGN CONFERENCE ATTENDED:

- ☒ YES
- ☐ NO
- ☐ COPY PROVIDED

DATE SUBMITTED: 6/9/03 BY: [Signature]

Requests for approvals of Site Development Plans and/or Subdivision Plats shall be accompanied by a drainage submittal. The particular nature, location and scope of the proposed development defines the degree of drainage detail. One or more of the following levels of submittal may be required based on the following:

1. **Conceptual Grading and Drainage Plan:** Required for approval of Site Development Plans greater than five (5) acres and Sector Plans.
2. **Drainage Plans:** Required for building permits, grading permits, paving permits and site plans less than five (5) acres.
3. **Drainage Report:** Required for subdivisions containing more than ten (10) lots or constituting five (5) acres or more.

ALSO SEE
TCL
SUBMITTAL.

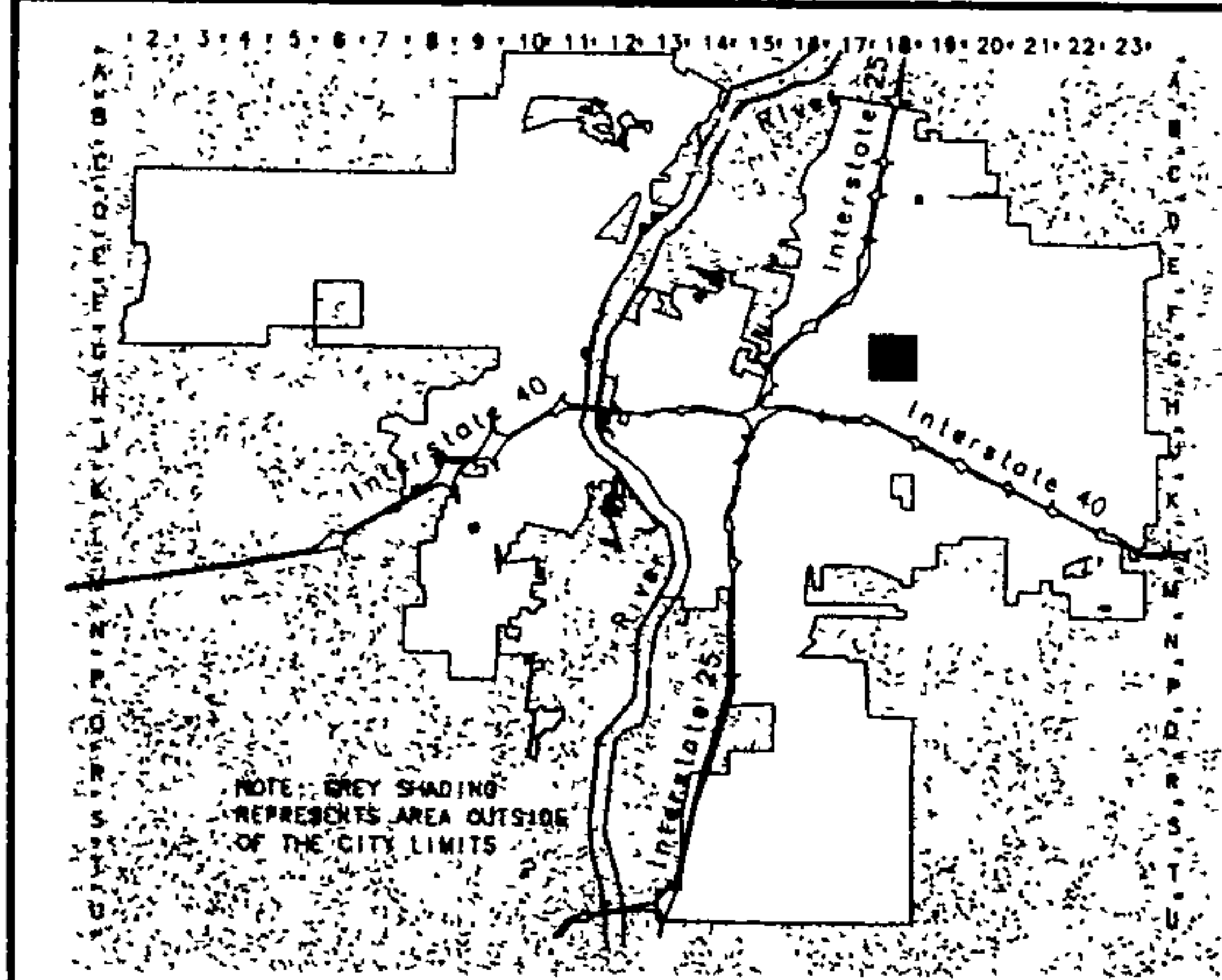
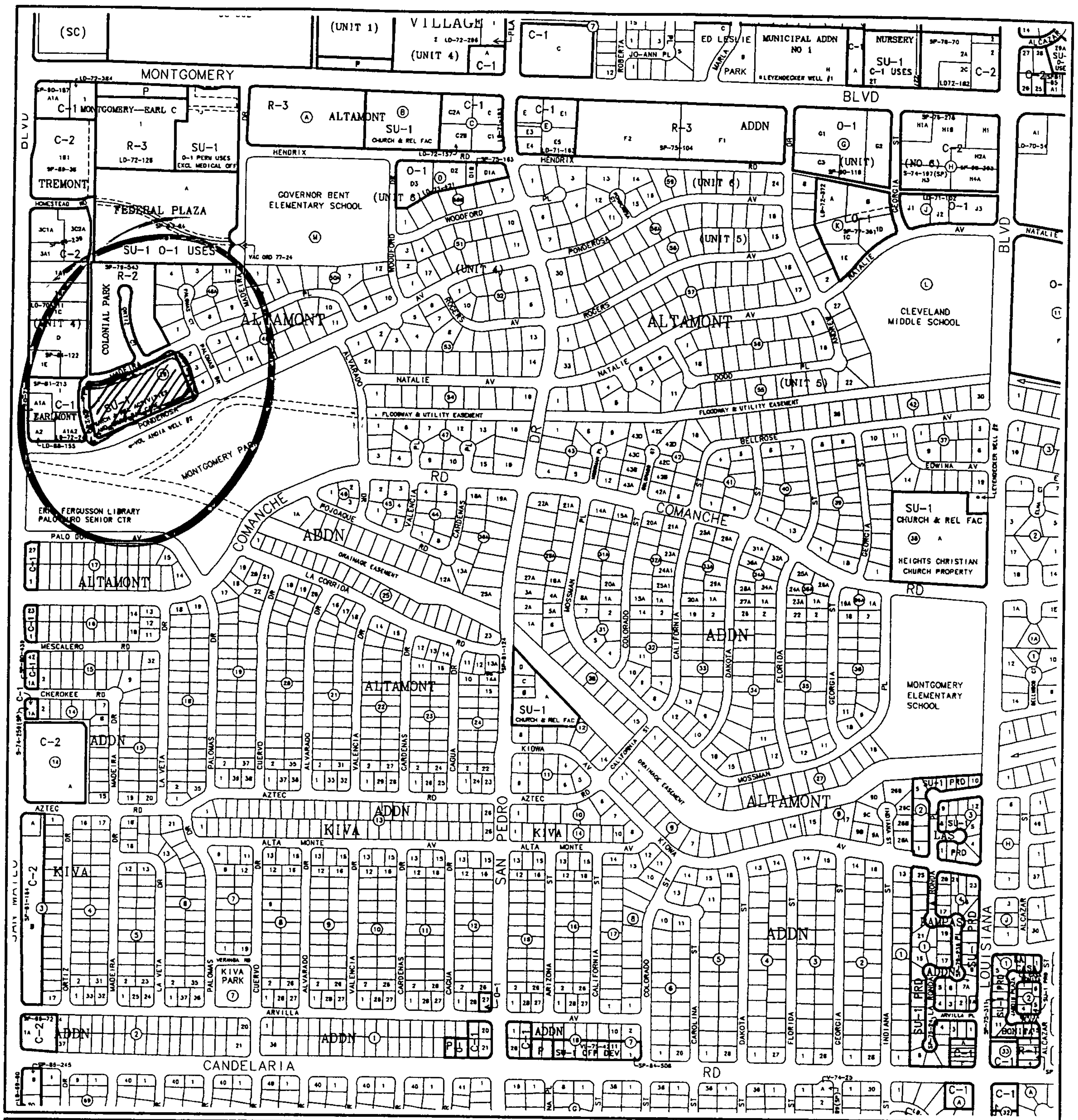

CITY OF
Albuquerque
A Geographic Information System
PLANNING DEPARTMENT
© Copyright 2003

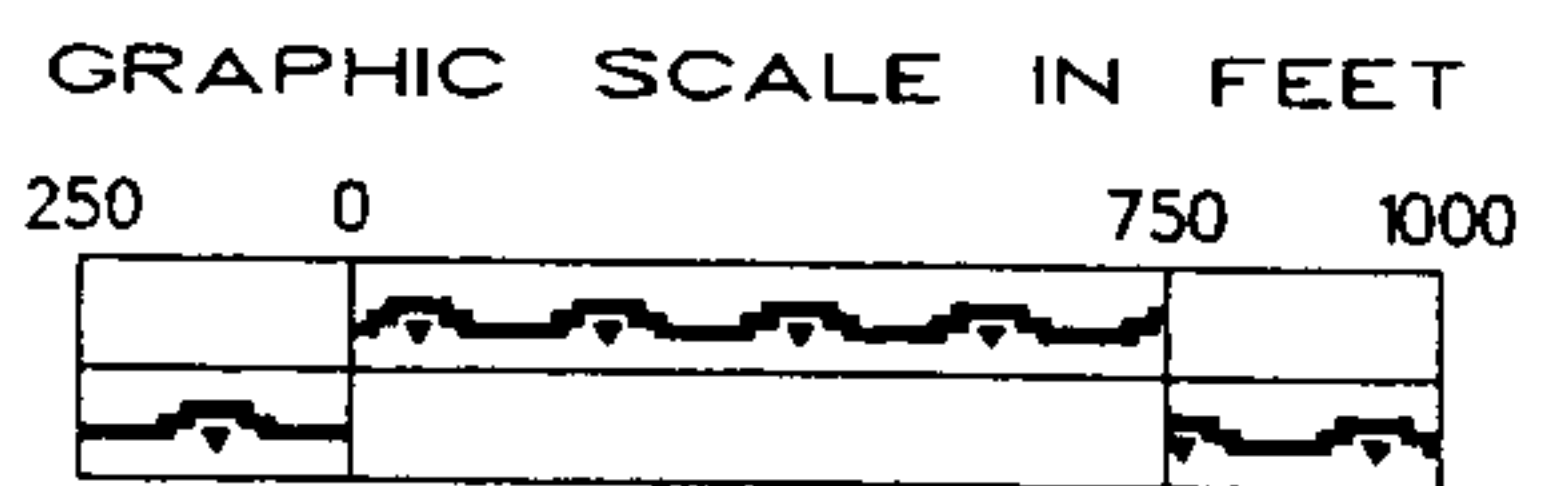

Zone Atlas Page

G-18-Z

Map Amended through January 21, 2003

DRAINAGE AND TRANSPORTATION INFORMATION SHEET
(REV. 1/28/2003rd)

PROJECT TITLE: St. Andrew Presby Church ZONE MAP/DRG. FILE #: G-18/D9
DRB #: _____ EPC#: _____ WORK ORDER#: _____

LEGAL DESCRIPTION: _____
CITY ADDRESS: _____

ENGINEERING FIRM: BENNETT, HAROLD
ADDRESS: 8601 WASHINGTON N.E.
CITY, STATE: ALB., 87113

CONTACT: HAROLD BENNETT
PHONE: 266-3038 / 830-3637
ZIP CODE: _____

OWNER: St. Andrew Presby Church
ADDRESS: _____
CITY, STATE: _____

CONTACT: _____
PHONE: _____
ZIP CODE: _____

ARCHITECT: KDC/BILL BUCKLEY
ADDRESS: 8601 WASHINGTON N.E.
CITY, STATE: _____

CONTACT: John Klee
PHONE: 830-3637
ZIP CODE: 87113

SURVEYOR: SURVEYS SOUTHWEST
ADDRESS: _____
CITY, STATE: _____

CONTACT: DM
PHONE: _____
ZIP CODE: _____

CONTRACTOR: Interstate DEVEL.
ADDRESS: 8601 WASHINGTON N.E.
CITY, STATE: _____

CONTACT: TERRY
PHONE: 821-5263
ZIP CODE: 87113

CHECK TYPE OF SUBMITTAL:

- ☐ DRAINAGE REPORT
- ☒ DRAINAGE PLAN 1st SUBMITTAL, *REQUIRES TCL or equal*
- ☐ DRAINAGE PLAN RESUBMITTAL
- ☐ CONCEPTUAL GRADING & DRAINAGE PLAN
- ☐ GRADING PLAN
- ☐ EROSION CONTROL PLAN
- ☐ ENGINEER'S CERTIFICATION (HYDROLOGY)
- ☐ CLOMR/LOMR
- ☒ TRAFFIC CIRCULATION LAYOUT (TCL)
- ☐ ENGINEERS CERTIFICATION (TCL)
- ☐ ENGINEERS CERTIFICATION (DRB APPR. SITE PLAN)
- ☐ OTHER

CHECK TYPE OF APPROVAL SOUGHT:

- ☐ SIA / FINANCIAL GUARANTEE RELEASE
- ☐ PRELIMINARY PLAT APPROVAL
- ☐ S. DEV. PLAN FOR SUB'D. APPROVAL
- ☐ S. DEV. PLAN FOR BLDG. PERMIT APPROVAL
- ☐ SECTOR PLAN APPROVAL
- ☐ FINAL PLAT APPROVAL
- ☐ FOUNDATION PERMIT APPROVAL
- ☒ BUILDING PERMIT APPROVAL
- ☐ CERTIFICATE OF OCCUPANCY (PERM.)
- ☐ CERTIFICATE OF OCCUPANCY (TEMP.)
- ☐ GRADING PERMIT APPROVAL
- ☐ PAVING PERMIT APPROVAL
- ☐ WORK ORDER APPROVAL
- ☐ OTHER (SPECIFY)

WAS A PRE-DESIGN CONFERENCE ATTENDED:

- ☒ YES
- ☐ NO
- ☐ COPY PROVIDED

DATE SUBMITTED: 6/9/03 BY: [Signature]

Requests for approvals of Site Development Plans and/or Subdivision Plats shall be accompanied by a drainage submittal. The particular nature, location and scope of the proposed development defines the degree of drainage detail. One or more of the following levels of submittal may be required based on the following:

1. **Conceptual Grading and Drainage Plan:** Required for approval of Site Development Plans greater than five (5) acres and Sector Plans.
2. **Drainage Plans:** Required for building permits, grading permits, paving permits and site plans less than five (5) acres.
3. **Drainage Report:** Required for subdivisions containing more than ten (10) lots or constituting five (5) acres or more.