

M:\MSD\14-600-070-01\2_DISCIPLINES\ SHEETS\2_SHEETS - CIVIL\WORK ORDER\EROS.DWG 5/1/2017 12:44 PM

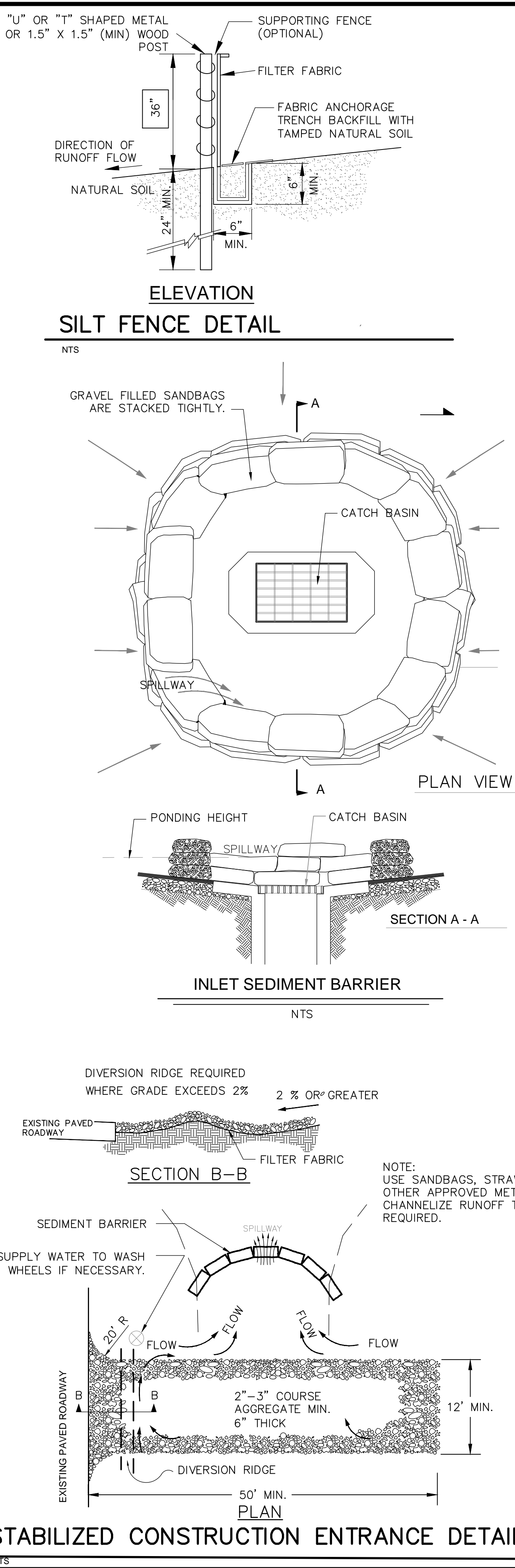
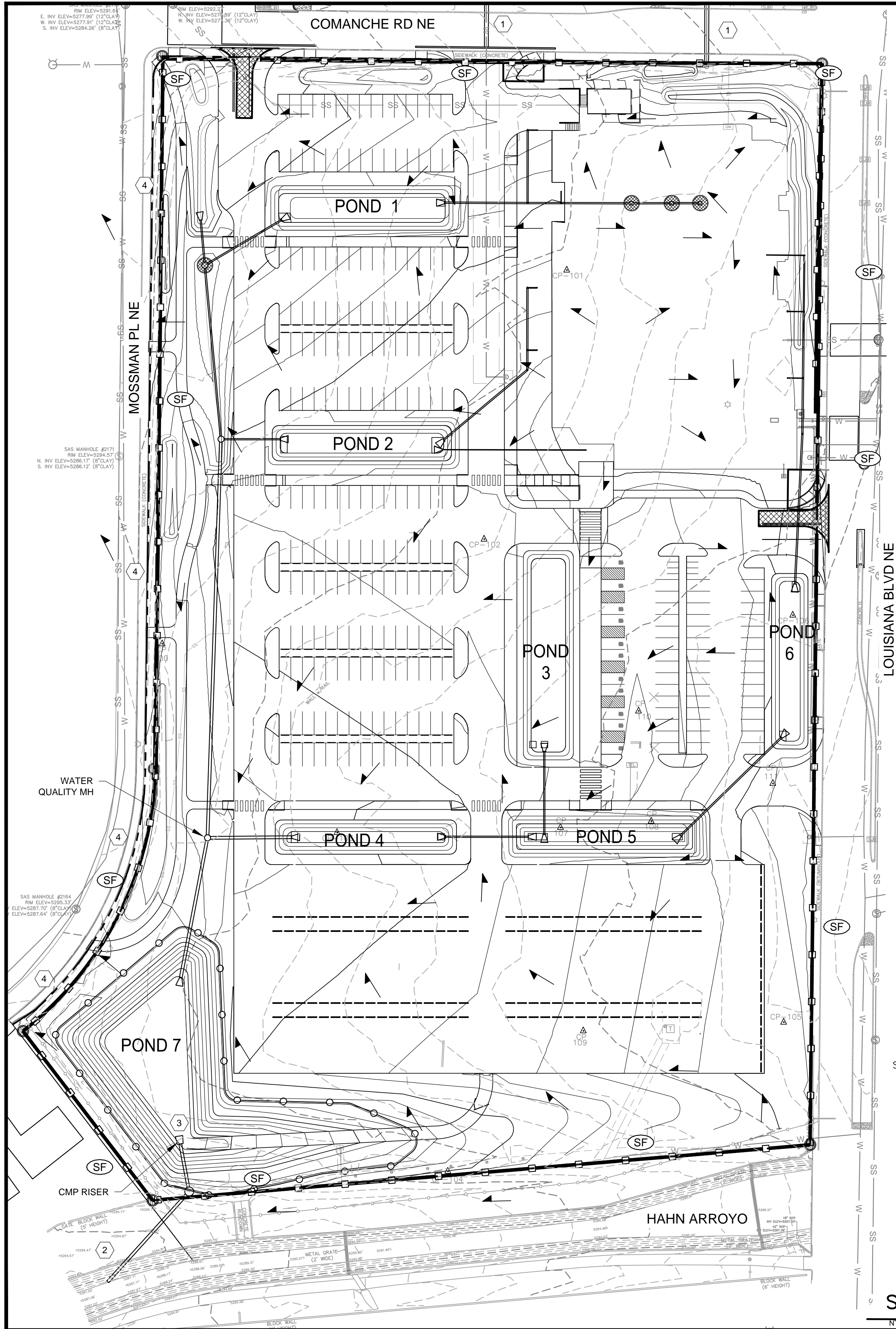

EROSION CONTROL NOTES

1. THE CONTRACTOR SHALL CONFORM TO ALL CITY, COUNTY, STATE AND FEDERAL DUST AND EROSION CONTROL REGULATIONS AND THE NATIONAL POLLUTANT DISCHARGE ELIMINATION SYSTEM (NPDES) REQUIREMENTS.
2. CONTRACTOR SHALL PREPARE AND OBTAIN ANY NECESSARY DUST OR EROSION CONTROL PERMITS FROM REGULATORY AGENCIES.
3. THE CONTRACTOR SHALL PROMPTLY REMOVE ANY MATERIAL EXCAVATED WITHIN THE PUBLIC OR PRIVATE RIGHT-OF-WAY TO KEEP IT FROM WASHING OFF THE PROJECT SITE.
4. CONTRACTOR SHALL ENSURE THAT NO SOIL ERODES FROM THE SITE ONTO OTHER PROPERTY BY CONSTRUCTING TEMPORARY EROSION CONTROL BERMS OR INSTALLING SILT FENCES AT THE PROPERTY LINES.
5. CONTRACTOR SHALL WET THE SOIL AS NEEDED TO PREVENT FROM BLOWING DUST. CONSTRUCTION AREAS SHALL BE WATERED FOR DUST CONTROL IN COMPLIANCE WITH GOVERNMENT ORDINANCES. WATERING, AS REQUIRED FOR CONSTRUCTION AND DUST CONTROL, SHALL BE CONSIDERED INCIDENTAL TO THE CONTRACT AND NO MEASUREMENT OR PAYMENT SHALL BE MADE THEREFOR. THE CONTRACTOR SHALL BE RESPONSIBLE FOR LOCATING AND SUPPLYING WATER AS REQUIRED.
6. ANY AREAS DISTURBED BY CONSTRUCTION AND NOT COVERED BY LANDSCAPING OR ANY IMPERVIOUS SURFACE SHALL BE REVEGETATED WITH NATIVE GRASS SEEDING. WHEN CONSTRUCTION ACTIVITIES CEASE AND EARTH DISTURBING ACTIVITIES WILL NOT RESUME WITHIN 14 DAYS, STABILIZATION MEASURES MUST BE INITIATED. UNLESS INDICATED OTHERWISE ON THESE PLANS OR ON A LANDSCAPE PLAN, SEEDING SHALL BE NATIVE GRASS SEEDING PER SECTION 1012 OF THE APWA STANDARD SPECIFICATIONS FOR PUBLIC WORKS CONSTRUCTION. THIS IS AN INCIDENTAL COST TO THE CONTRACT.
7. ALL WASTE PRODUCTS FROM THE CONSTRUCTION SITE, INCLUDING ITEMS DESIGNATED FOR REMOVAL, CONSTRUCTION WASTE, CONSTRUCTION EQUIPMENT WASTE PRODUCTS (OIL, GAS, TIRES, ETC.) GARBAGE, GRUBBING, EXCESS CUT MATERIAL, VEGETATIVE DEBRIS, ETC. SHALL BE APPROPRIATELY DISPOSED OF OFF-SITE AT NO ADDITIONAL COST TO THE OWNER. IT SHALL BE THE CONTRACTOR'S RESPONSIBILITY TO OBTAIN PERMITS REQUIRED FOR HAUL OR DISPOSAL OF WASTE PRODUCTS. IT SHALL BE THE CONTRACTOR'S RESPONSIBILITY TO ENSURE THAT WASTE DISPOSAL SITES COMPLY WITH GOVERNMENT REGULATIONS REGARDING THE ENVIRONMENT, ENDANGERED SPECIES AND ARCHAEOLOGICAL RESOURCES.
8. THE CONTRACTOR SHALL BE RESPONSIBLE FOR THE CLEANUP AND REPORTING OF SPILLS OF HAZARDOUS MATERIALS ASSOCIATED WITH THE CONSTRUCTION SITE. HAZARDOUS MATERIALS INCLUDE GASOLINE, DIESEL FUEL, MOTOR OIL, SOLVENTS, CHEMICALS, PAINTS, ETC. WHICH MAY BE A THREAT TO THE ENVIRONMENT. THE CONTRACTOR SHALL REPORT THE DISCOVERY OF PAST OR PRESENT SPILLS TO THE NEW MEXICO ENVIRONMENT DEPARTMENT EMERGENCY RESPONSE AT 1-(505)-827-9329.
9. THE CONTRACTOR SHALL COMPLY WITH ALL APPLICABLE REGULATIONS CONCERNING SURFACE AND UNDERGROUND WATER. CONTACT WITH SURFACE WATER BY CONSTRUCTION EQUIPMENT AND PERSONNEL SHALL BE MINIMIZED. EQUIPMENT MAINTENANCE AND REFUELING OPERATIONS SHALL BE PERFORMED IN AN ENVIRONMENTALLY SAFE MANNER IN COMPLIANCE WITH GOVERNMENT REGULATIONS.
10. WHERE STORM INLETS ARE SUSCEPTIBLE TO IN-FLOW OF SILT OR DEBRIS FROM CONSTRUCTION ACTIVITIES, PROTECTION SHALL BE INSTALLED ON INLET UPSTREAM SIDE.
11. DIRT PILE FROM EXCAVATION SHOULD BE PLACED ON THE UPHILL SIDE OF THE UTILITY CUT.
12. WHEN DOING WORK IN THE CITY ROW (E.G. SIDEWALK, DRIVEPADS, UTILITIES, ETC) PREVENT DIRT FROM GETTING INTO THE STREET. IF DIRT IS PRESENT IN THE STREET, THE STREET SHOULD BE SWEEPED AT THE END OF EACH DAY OR DURING THE DAY IF RAIN IS IMMINENT OR IF THE CONTRACTOR INDUCES WATER INTO THE STREET

KEYNOTES

1. EXCAVATED SOIL SHOULD BE PILED ON THE UPHILL SIDE OF THE UTILITY CUT OR A WATTLE/FILTER SOCK CAN BE PLACED AT THE TOE OF THE STOCKPILE.
2. EXCAVATED SOIL SHOULD NOT BE STOCKPILED IN THE CHANNEL.
3. CMP RISER SHALL BE WRAPPED WITH SILT FENCE.
4. WATTLES SHALL BE PLACED ALONG OUTSIDE EDGE OF SIDEWALK.

LEGEND

- (SF) SILT FENCE
- DIRECTION OF FLOW
- CONSTRUCTION ENTRANCE
- EXISTING INDEX CONTOUR
- EXISTING INTERMEDIATE CONTOUR
- PROPOSED INDEX CONTOUR
- PROPOSED INTERMEDIATE CONTOUR
- PROPOSED WATTLE
- INLET PROTECTION

SCALE: 1" = 50'

- NOTES:
1. THE ENTRANCE SHALL BE MAINTAINED IN A CONDITION THAT WILL PREVENT TRACKING OR FLOWING OF SEDIMENT ONTO PUBLIC ROW. THIS MAY REQUIRE TOP DRESSING, REPAIR AND/OR CLEANOUT OF ANY MEASURES USED TO TRAP SEDIMENT. COST TO MAINTAIN ENTRANCE SHALL BE CONSIDERED AS INCIDENTAL COST TO CONTRACT.
 2. WHEN NECESSARY, WHEELS SHALL BE CLEANED PRIOR TO ENTRANCE ONTO PUBLIC RIGHT-OF-WAY.
 3. WHEN WASHING IS REQUIRED, IT SHALL BE DONE ON AN AREA STABILIZED WITH CRUSHED STONE THAT DRAINS INTO AN APPROVED SEDIMENT TRAP OR SEDIMENT BASIN.

WILSON & COMPANY	
CITY OF ALBUQUERQUE	
MUNICIPAL DEVELOPMENT DEPARTMENT	
ENGINEERING DEVELOPMENT DIVISION	
TITLE: MONTGOMERY COMPLEX EROSION CONTROL PLAN	
Design Review Committee	City Engineer Approval
City Project No. 772071	Zone Map No. G-18
Sheet 9	Of 17