

DRAINAGE MANAGEMENT PLAN

PROJECT DESCRIPTION
AS SHOWN BY THE VICINITY MAP, THE SITE IS LOCATED WITHIN A DEVELOPED AREA OF THE CITY WHERE EXISTING STORM DRAIN FACILITIES ARE ADJACENT TO THE SITE (ILLIFF ROAD). THE EXISTING LEGAL DESCRIPTION OF THE PROPERTY IS TRACT 264-A-1 TOWN OF ATRISCO GRANT, UNIT 8.

DRAINAGE DESIGN CRITERIA
THE 100-YEAR, 24-HOUR STORM EVENT WAS UTILIZED TO DETERMINE SITE RUNOFF RATES USING $P(1 \text{ HR}) = 1.58"$, $P(6 \text{ HR}) = 2.04"$ AND $P(24 \text{ HR}) = 2.39"$, OBTAINED FROM THE LATEST NOAA PRECIPITATION ATLAS. THE ON-SITE LAND TREATMENT VALUES USED WERE TYPE B=10 % AND TYPE D=90%.

EXISTING DRAINAGE CONDITION
THE SITE PRESENTLY CONSISTS OF UNDEVELOPED LAND SLOPING PREDOMINANTLY TOWARD THE SOUTH EAST CORNER OF THE SITE. AT THE PRESENT MOST TIME OFF -SITE RUNOFF IS CUT OFF BY I-40 AND COLLECTED IN THE EXISTING WEST I-40 OUTFALL RUNNING, EAST ALONG I-40 ADJACENT TO THE SITE.

DEVELOPED CONDITIONS
THE PROPOSED IMPROVEMENTS CONSIST OF THE STORAGE BUILDING AND FUTURE DEVELOPMENT. THE TOTAL DEVELOPED CONDITIONS FLOW FROM THIS SITE IS 8.05 CFS. THE RUNOFF FROM THE DEVELOPED CONDITIONS IS COLLECTED BY THE SERIES OF STORM INLETS AND FINALLY CONVEYED IN TO THE EXISTING STORM DRAIN ON THE ILLIFF ROAD WITH THE HELP OF NEW STORM DRAINS AS SHOWN IN THE PLAN.

CONCLUSION
THE PROPOSED DRAINAGE SCHEME FOR THIS PROJECT CAN BE READILY IMPLEMENTED THROUGH THE EXECUTION OF DESIGN CONCEPTS AS SHOWN IN THIS PLAN.

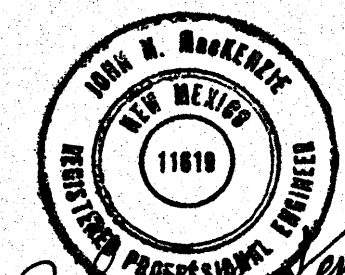

John A. Goodwin
04-04-06

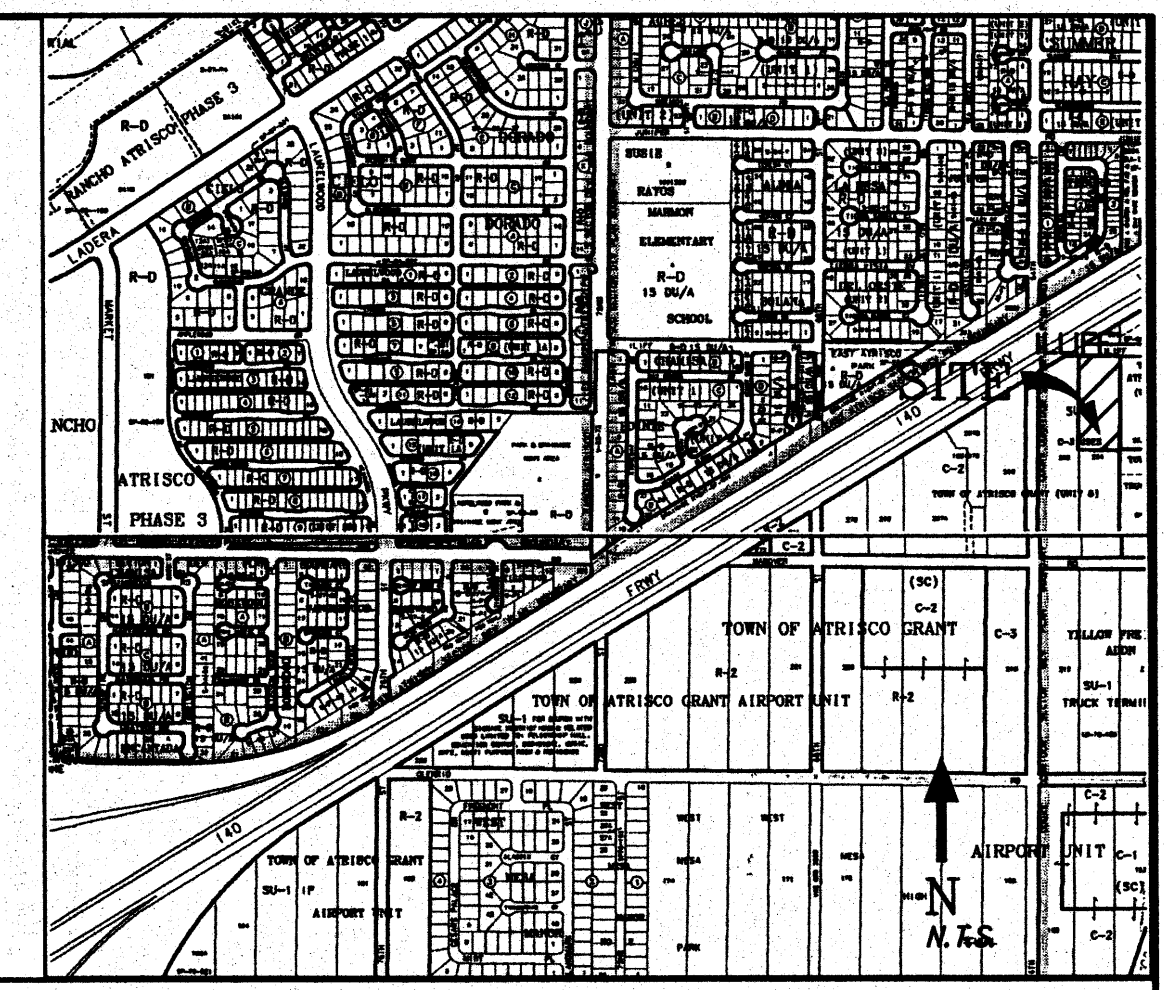
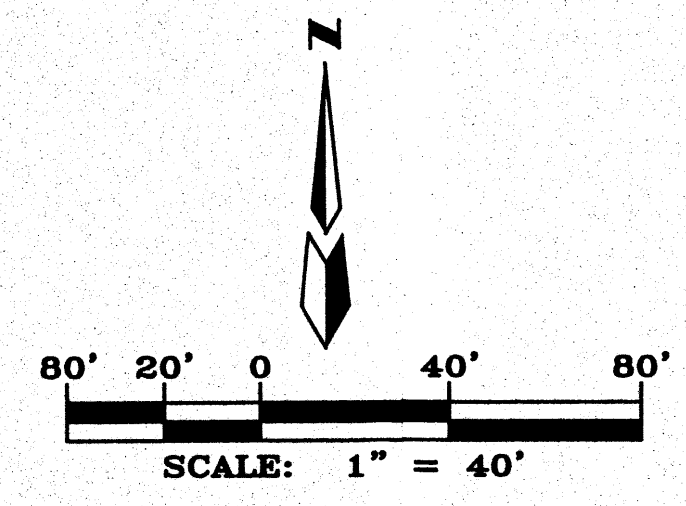

ZONE MAP: H-10-Z
J-10-Z
ACS BENCHMARK

LEGAL DESCRIPTION

TRACT 264-A, TOWN OF ATRISCO GRANT, AIRPORT UNIT.

PROPOSED DRAINAGE PLAN

THE SUBJECT PROPERTY IS LOCATED WITHIN A DEVELOPED AREA OF THE CITY WHERE EXISTING STORM DRAIN FACILITIES ARE ADJACENT TO THE SITE (ILLIFF ROAD). DEVELOPED RUNOFF FROM ON-SITE AREAS WILL BE COLLECTED ON-SITE BY A NEW STORM DRAIN SYSTEM THAT WILL DISCHARGE TO THE EXISTING STORM DRAIN SYSTEM IN ILLIFF ROAD. MOST OFF-SITE RUNOFF AROUND THE SUBJECT PROPERTY IS CUT OFF BY I-40 AND COLLECTED IN THE EXISTING WEST I-40 OUTFALL RUNNING, EAST ALONG I-40 ADJACENT TO THE SITE.

LEGEND

- PROPOSED RETAINING WALL
- PROPERTY LINE
- PROPOSED FLOWLINES SPOT ELEVATION
- EXISTING CONTOUR
- PROPOSED CONTOUR
- PROPOSED WALL SPOT ELEVATION
- FINISHED FLOOR
- EXISTING CURB AND GUTTER
- EXISTING STORM DRAIN
- DRAINAGE BASIN
- PROPOSED STORM DRAIN
- NEW CURB AND GUTTER
- NEW FLOW ARROW
- NEW STORM INLET
- NEW SIDEWALK
- NEW VALLEY GUTTER

ILLIFF ROAD STORAGE

GRADING AND DRAINAGE PLAN

MARK GOODWIN & ASSOCIATES, P.A.
CONSULTING ENGINEERS
P.O. BOX 90606
ALBUQUERQUE, NEW MEXICO 87199
(505)828-2200, FAX (505)797-9539

Designed: JMM Drawn: CAR Checked: DMG SDP-4
Scale: 1" = 30' Date: 11/08/05 Job: A05053