

TRACT 17
LADERA BUSINESS PARK UNIT 2
FILED OCTOBER 11, 2004
BOOK 2004C, PAGE 325

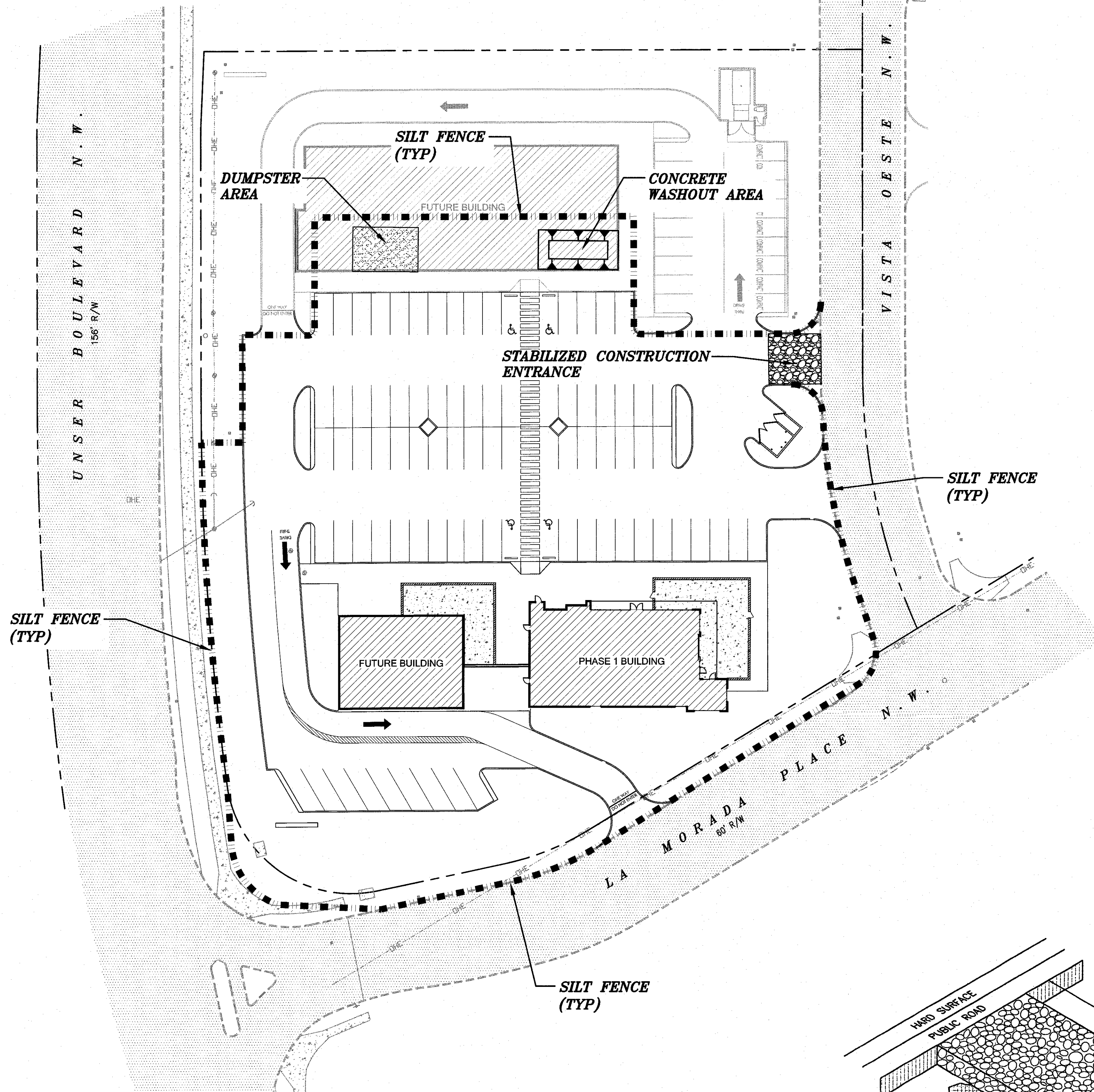

GENERAL NOTES

1. WHEN DOING WORK IN THE CITY ROW (SIDEWALKS, DRIVE PADS, UTILITIES) PREVENT DIRT FROM GETTING INTO THE STREET. IF DIRT IS PRESENT IN THE STREET, THE STREET SHOULD BE SWEEPED EVERY FEW DAYS OR THE SAME DAY IF RAIN IS IMMINENT. ANY TEMPORARY DIRT PILE SHALL BE PLACED ON THE UPSTREAM SIDE OF THE TRENCH.
2. ALL SOIL DISTURBED DURING UTILITY TRENCHING SHOULD BE PLACED ON THE UPSTREAM SIDE OF THE STREET CUT AND THE AREA SWEEPED AFTER THE WORK IS COMPLETED.
3. HAY BALES ARE NOT TO BE USED.
4. SAND BAGS OR GRAVEL BAGS ARE NOT TO BE USED.
5. CONTRACTOR TO CONTACT ONE-CALL AT (505) 260-1990, PRIOR TO BEGINNING CONSTRUCTION.
6. HOME DEPOT SPECIFICATIONS SHALL BE USED FOR ANY WORK ADJACENT TO CARVE OUT PARCEL.
7. MAXIMUM POLE SPACING FOR SILT FENCE SHALL BE 10 FEET EXCEPT AT OUTFALL LOCATIONS WHERE MAXIMUM POLE SPACING SHALL BE 6 FEET.

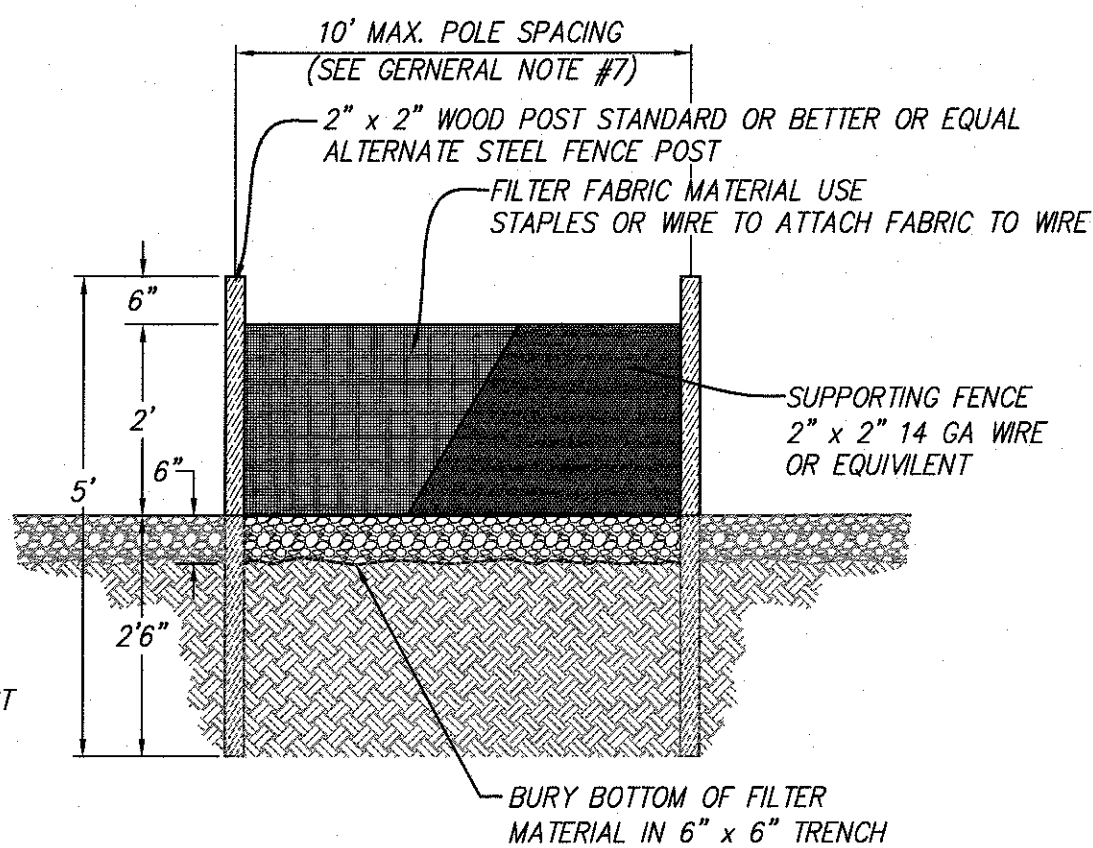
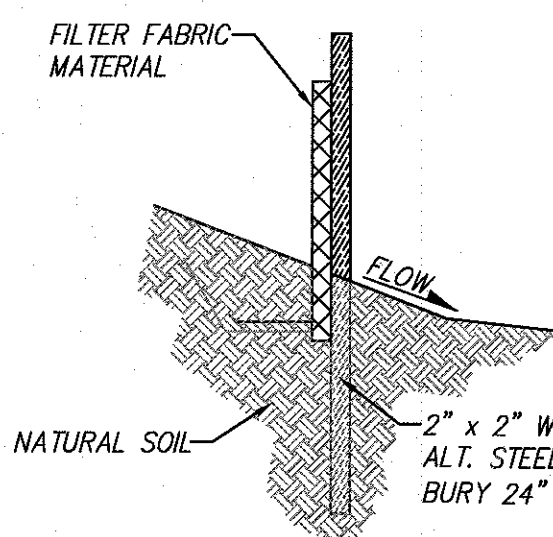

SILT FENCE FOR SEDIMENT CONTROL
N.T.S.

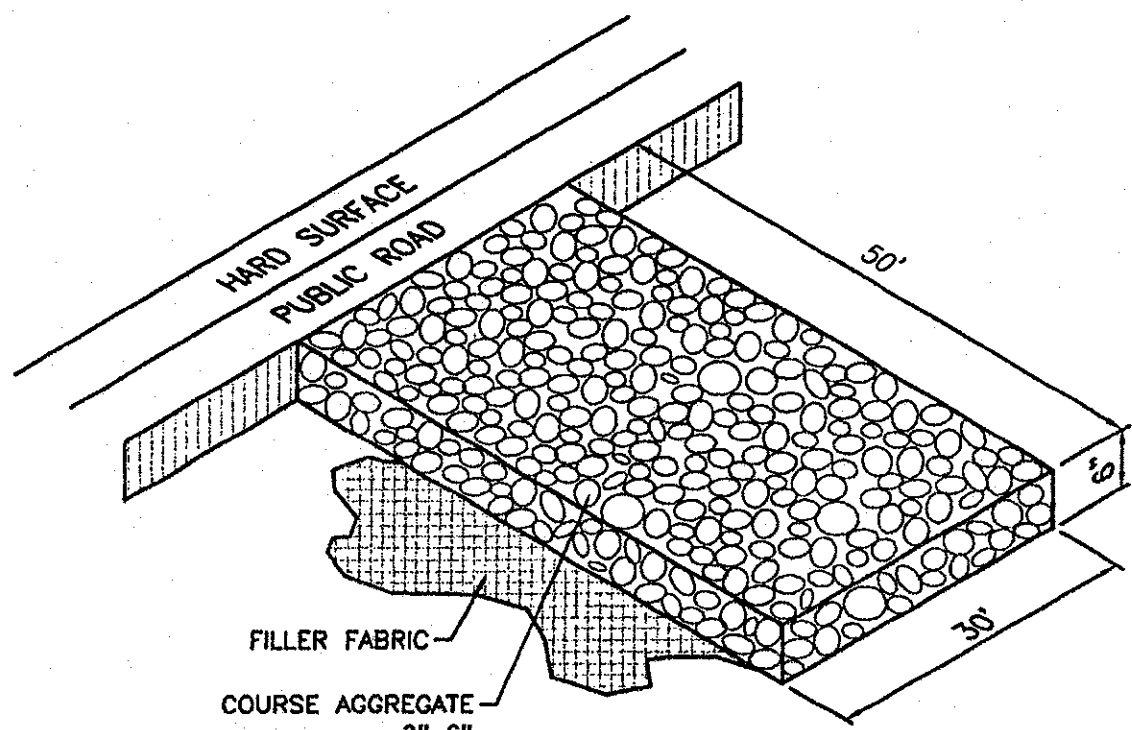

STABILIZED CONSTRUCTION ENTRANCE
N.T.S.

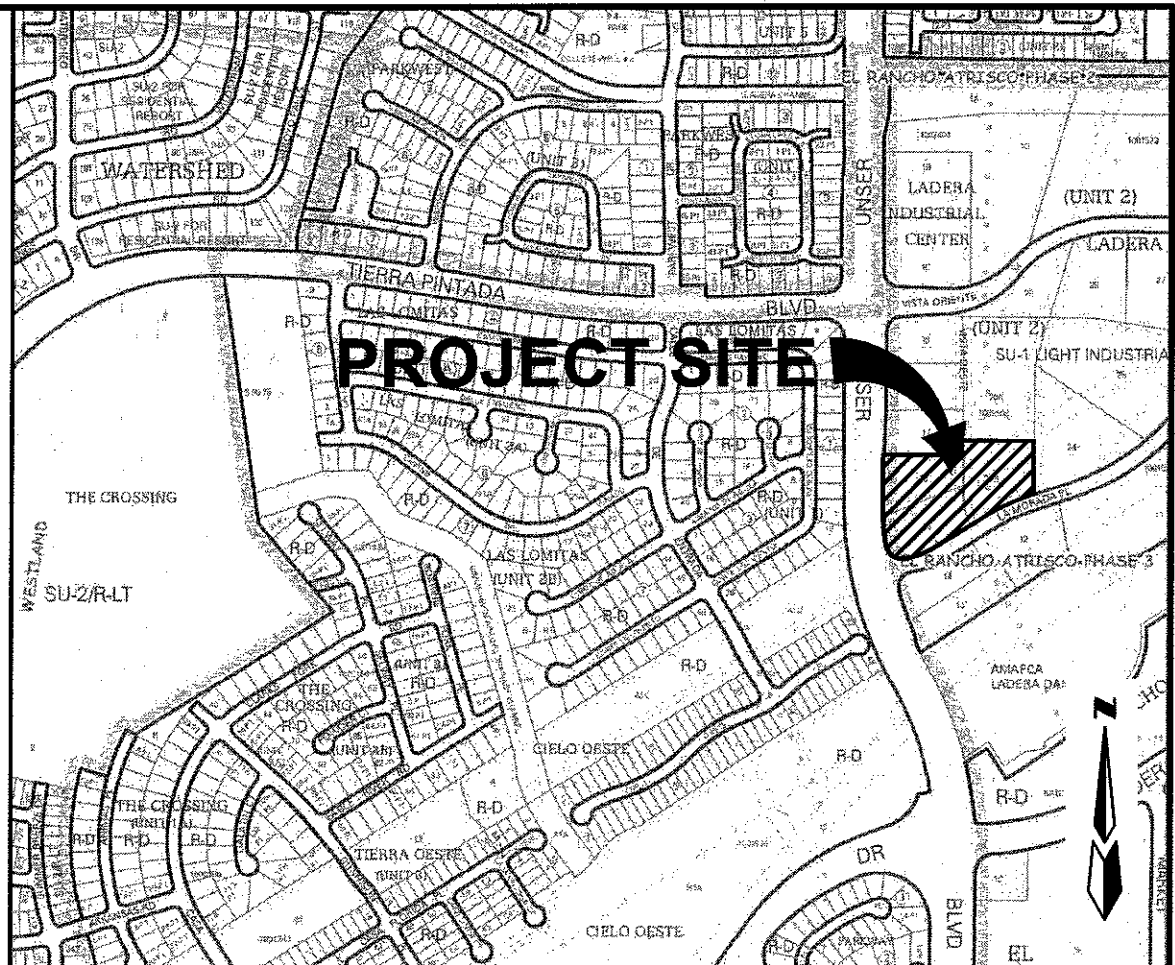

VICINITY MAP ZONE MAP: H-9-Z

LEGEND

- SILT FENCE (TYPICAL)
- CONCRETE WASHOUT AREA
- STABILIZED CONSTRUCTION ENTRANCE
- DUMPSTER AREA

LAS LOMITAS PLAZA - PHASE 1
EROSION & SEDIMENT CONTROL PLAN

dmg MARK GOODWIN & ASSOCIATES, P.A.
CONSULTING ENGINEERS
P.O. BOX 90606
ALBUQUERQUE, NEW MEXICO 87199
(505)828-2200, FAX (505)797-9539

Designed: DMG Drawn: DER Checked: DMG Sheet 3 of 3
Scale: 1" = 1' Date: 9/13/17 Job: A17040

