

ALBUQUERQUE BILINGUAL ACADEMY BASEBALL FIELD

TEMPORARY SEDIMENT AND EROSION CONTROL DRAWINGS

ALBUQUERQUE, BERNALILLO COUNTY, NM

DRAWING INDEX

- 1 COVER SHEET
- 2 PROJECT DETAILS
- 3 GENERAL NOTES
- 4 BEST MANAGEMENT PRACTICES
- 5 BEST MANAGEMENT PRACTICES
- 6 BEST MANAGEMENT PRACTICES
- 7 BEST MANAGEMENT PRACTICES
- 8 TEMPORARY EROSION & SEDIMENT CONTROL PLAN
- 9 FINAL STABILIZATION

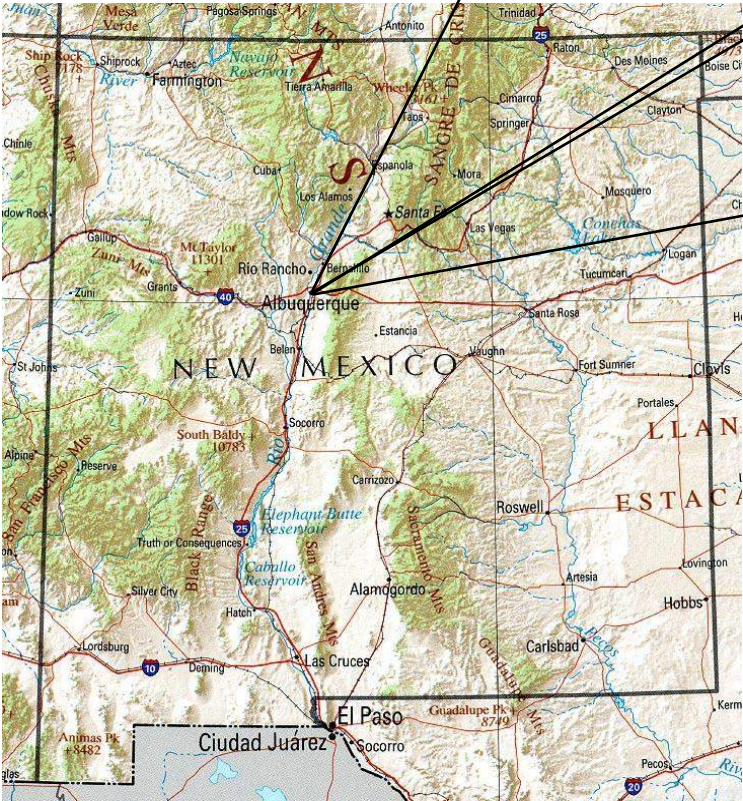
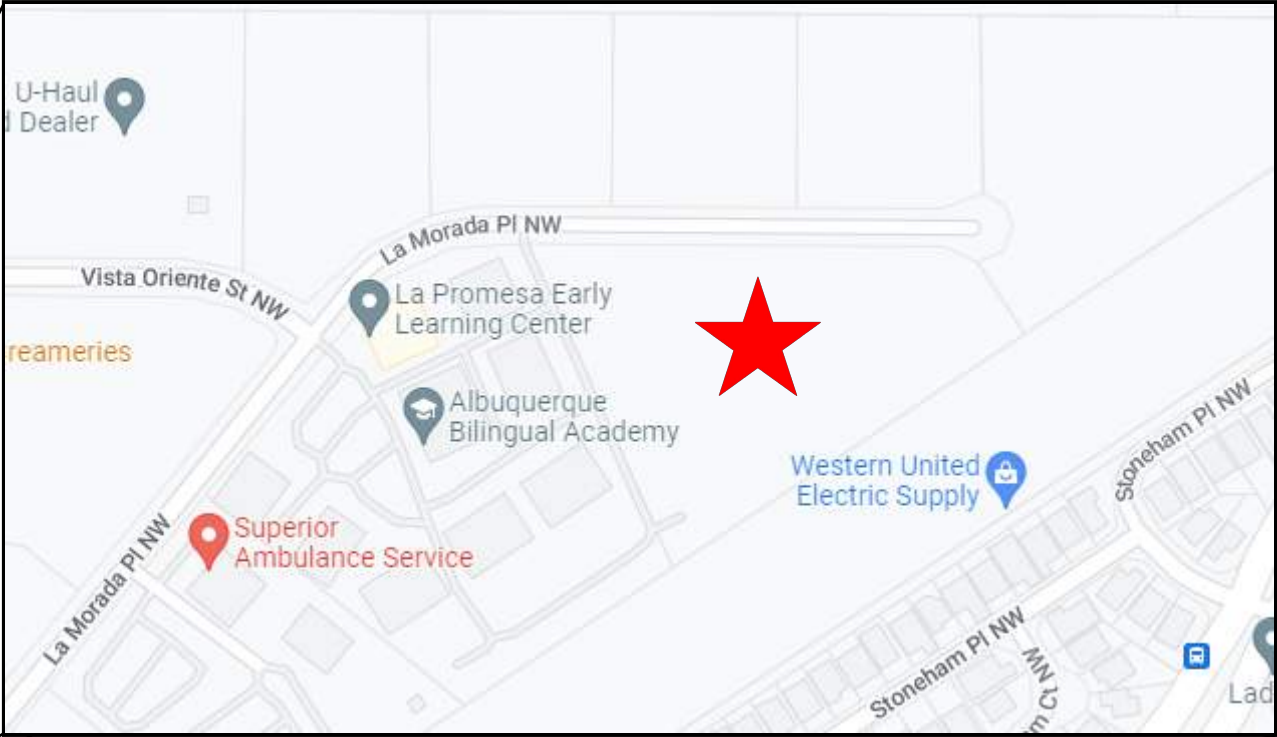

- SWPPP
- Stormwater
- Erosion Control
- Reclamation
- Seeding



REVISION ITEM					DATE

ALBUQUERQUE BILINGUAL
ACADEMY BASEBALL FIELD
ALBUQUERQUE, NM

DESIGNED BY:
K. FETTER, P.E.
DRAWN BY:
S. FETTER

SHEET:
COVER

PROJECT DETAILS

NPDES ID: NMR1004L0, NMR1004L9

ADDRESS: 7400 LA MORADA PL. NW, ALBUQUERQUE, NM 87120

GPS COORDINATES: 35.110750, -106.722843

TOTAL ACREAGE: 5.4

ANTICIPATED DISTURBED ACREAGE: 3.9

FIRST RECEIVING WATERS: LADERA POND, RIO GRANDE

WATERS WITHIN ONE MILE OF PROJECT: LADERA POND, UNNAMED STREAM

IMPAIRED/TIERED WATERS: RIO GRANDE

ENDANGERED SPECIES: CRITERION A

SUPPORT ACTIVITIES: SEE SECTION 3.6 OF SWPPP NARRATIVE

SOIL TYPE: SEE NCRS SOIL REPORT PROVIDED IN SWPPP BINDER

TYPE PRE-CONSTRUCTION COVER: NATIVE VEGETATION >50% DENSITY

STABILIZATION MEASURES AND DEADLINES: SEE SECTION 6.0 OF SWPPP NARRATIVE

REGULATING AUTHORITY: ENVIRONMENTAL PROTECTION AGENCY (EPA)

REGULATING PERMIT: 2022 CONSTRUCTION GENERAL PERMIT

OPERATORS

PROPERTY OWNER:
EARLIER LEARNING SOLUTIONS FOUNDATIONS, INC.
7500 LA MORADA PL. NW
ALBUQUERQUE, NM 87120
CHRIS LONG, SECRETARY
(505) 320-5657

OPERATOR:
ALBUQUERQUE BILINGUAL ACADEMY
7500 LA MORADA PL. NW
ALBUQUERQUE, NM 87120
KYLE HUNT, DIRECTOR OF OPERATIONS
(505) 320-5657

GENERAL CONTRACTOR (GC):
PENDING SELECTION

STORMWATER TEAM

SEE SECTION 2.0 OF THE SWPPP NARRATIVE FOR THE PROJECT'S STORMWATER TEAM, RESPONSIBILITIES AND CONTACT INFORMATION

SEQUENCE OF ACTIVITIES

PHASE I: SITE PREPARATION AND PRE – CONSTRUCTION

- 1.PRIOR TO BEGINNING EARTH DISTURBING ACTIVITIES, THE OPERATOR(S) WILL CLEARLY DEMARCATATE THE LIMITS OF DISTURBANCE WITH STAKES, RIBBONS, CONSTRUCTION FENCING, OR OTHER APPROPRIATE METHOD. THESE DEMARCATIONS SHALL REMAIN VISIBLE FOR THE DURATION OF THE PROJECT.
- 2.THE INITIAL EROSION CONTROL MEASURES SHALL BE INSTALLED PRIOR TO EARTH DISTURBANCE. THE INITIAL CONTROL MEASURES MAY INCLUDE BUT ARE NOT LIMITED TO:
- a. PERIMETER CONTROLS (E.G., SILT FENCE, WATTLES, CONSTRUCTION FENCE)
 - b. VEHICLE TRACKING PAD IF THE SITE ENTERS/EXITS ONTO A PAVED PUBLIC ROADWAY
 - c. NPDES NOTIFICATION POSTING
 - d. DESIGNATED STAGING AREA
 - e. ANCHORED SANILETS
 - f. DUMPSTERS

PHASE II: CONSTRUCTION ACTIVITIES

- 1.THE OPERATORS WILL MINIMIZE THE AREA DISTURBED AS MUCH AS FEASIBLY POSSIBLE.
- 2.ANY DISTURBED AREA IN WHICH CONSTRUCTION ACTIVITIES HAVE TEMPORARILY CEASED SHALL TEMPORARILY STABILIZED USING THE METHODS DESCRIBED IN SECTION 6.4 OF THE SWPPP NARRATIVE. SECTION 6.3 OF THE SWPPP NARRATIVE PROVIDES THE TEMPORARY STABILIZATION DEADLINES.
- 3.THE LOCATION OF SOME BMPS MAY REQUIRE ALTERATION IF DRAINAGE PATTERNS CHANGE DURING CONSTRUCTION. THE OPERATORS SHALL INSTALL ADDITIONAL BMPS OR UPGRADE BMPS IF NECESSARY.
- 4.IF CONCRETE IS USED ONSITE AND CONCRETE TRUCKS ARE UNABLE TO WASHOUT OFFSITE, THE OPERATORS WILL PROVIDE ONE OR MORE DESIGNATED CONCRETE WASHOUT AREAS. THE CONCRETE WASHOUTS MUST BE INSTALLED PRIOR TO CONCRETE USE ONSITE AND REMOVED ONLY AFTER CONCRETE WORK IS COMPLETE.

PHASE III: FINAL STABILIZATION AND CONSTRUCTION COMPLETION

- 1.IF APPLICABLE, REVEGETATION OR LANDSCAPING SHALL BE INITIATED IMMEDIATELY UPON KNOWING WORK IN A DISTURBED AREA HAS PERMANENTLY STOPPED AND THE AREA IS NOT COVERED BY PERMANENT STRUCTURES, UNLESS INFEASIBLE. SECTION 6.4 OF THE SWPPP NARRATIVE DISCUSSES PERMANENT STABILIZATION AND ASSOCIATED DEADLINES.
- 2.THE OPERATORS SHALL REMOVE TEMPORARY BMPS ONLY AFTER FINAL STABILIZATION IS COMPLETE.



					DATE
					REVISION ITEM
					#

ALBUQUERQUE BILINGUAL
ACADEMY BASEBALL FIELD
SWPPP NOTES

DESIGNED BY:
K. FETTER, P.E.
DRAWN BY:
S. FETTER

SHEET:
GENERAL
NOTES

GENERAL NOTES

THE NPDES COMPLIANCE SWPPP DRAWING AND ASSOCIATED DOCUMENTATION IS AND SHALL BE CONSIDERED A LIVING DOCUMENT ALLOWING FOR MODIFICATIONS AS SITE CONDITIONS CHANGE OR DICTATE.

ALL SITE FEATURES (EXISTING/PROPOSED GRADES, EXISTING CONSTRUCTION, FUTURE CONSTRUCTION, ETC.) SHOWN IS PER INFORMATION FROM OTHERS.

MINIMUM REQUIREMENTS TO FURTHER DEVELOP OR MODIFY THIS STORMWATER POLLUTION PREVENTION PLAN (SWPPP) DRAWING SHALL BE BASED ON THE CURRENT EDITION OF THE NEW MEXICO STATE HIGHWAY AND TRANSPORTATION DEPARTMENT (NMSHTD), NPDES LAW AND CITY OF ALBUQUERQUE ORDINANCE § 14-5-2-11.

ALL OPERATORS SHALL SUBMIT A NOTICE OF INTENT (NOI). THE NOI SHALL BE ACTIVE AND POSTED ON THE EPA'S WEBSITE PRIOR TO COMMENCING EARTH DISTURBING ACTIVITIES.

LOCATE TEMPORARY WASHOUT, ANCHORED TOILETS, CONSTRUCTION ENTRANCE AND PARKING, STAGING, REFUELING, TRASH CONTAINMENT AREA TO MINIMIZE SITE DISTURBANCE DURING CONSTRUCTION ACTIVITY.

THE OPERATOR IS REQUIRED TO REGULARLY PERFORM STREET SWEEPING AND CLEAN - UP MEASURES IN THE EVENT OF SEDIMENT TRACK - OUT.

THE FOLLOWING ARE STANDARD EROSION CONTROL REQUIREMENTS PER THE CITY OF ALBUQUERQUE STORMWATER QUALITY DEPARTMENT (MARCH 24, 2021):

ALL EROSION AND SEDIMENT CONTROL (ESC) WORK ON THESE PLANS, EXCEPT AS OTHERWISE STATED OR PROVIDED HEREON SHALL BE PERMITTED, CONSTRUCTED, INSPECTED, AND MAINTAINED IN ACCORDANCE WITH:

THE CITY ORDINANCE § 14-5-2-11, THE ESC ORDINANCE;
THE EPA'S 2017 CONSTRUCTION GENERAL PERMIT (CGP); AND
THE CITY OF ALBUQUERQUE CONSTRUCTION BMP MANUAL

ALL TEMPORARY SEDIMENT AND EROSION CONTROL MEASURES MUST BE INSTALLED PRIOR TO BEGINNING ANY EARTH MOVING ACTIVITIES EXCEPT AS SPECIFIED HEREON IN THE PHASING PLAN. CONSTRUCTION OF EARTHEN BMPS SUCH AS SEDIMENT TRAPS, SEDIMENT BASINS, AND DIVERSION BERMS SHALL BE COMPLETED AND INSPECTED PRIOR TO ANY OTHER CONSTRUCTION OR EARTHWORK. SELF-INSPECTION IS REQUIRED AFTER INSTALLATION OF THE BMPS AND PRIOR TO BEGINNING CONSTRUCTION.

SEE SECTION 3.6 OF THE SWPPP NARRATIVE OR THE CONTRACTOR'S SCHEDULE (TAB II OF SWPPP BINDER) FOR BMP SCHEDULING OR PHASING.

SELF-INSPECTIONS - AT A MINIMUM A ROUTINE COMPLIANCE SELF-INSPECTION IS REQUIRED TO REVIEW THE PROJECT FOR COMPLIANCE WITH THE CONSTRUCTION GENERAL PERMIT ONCE EVERY 14 DAYS AND AFTER ANY PRECIPITATION EVENT OF 1/4 INCH OR GREATER UNTIL THE SITE CONSTRUCTION HAS BEEN COMPLETED AND THE SITE DETERMINED AS STABILIZED BY THE CITY. REPORTS OF THESE INSPECTIONS SHALL BE KEPT BY THE PERSON OR ENTITY AUTHORIZED TO DIRECT THE CONSTRUCTION ACTIVITIES ON THE SITE AND MADE AVAILABLE UPON REQUEST.

CORRECTIVE ACTION REPORTS MUST BE KEPT BY THE PERSON OR ENTITY AUTHORIZED TO DIRECT THE CONSTRUCTION ACTIVITIES ON THE SITE AND MADE AVAILABLE UPON REQUEST.

STABILIZATION REPORTS MUST BE KEPT BY THE PERSON OR ENTITY AUTHORIZED TO DIRECT THE CONSTRUCTION ACTIVITIES ON THE SITE AND MADE AVAILABLE UPON REQUEST. REPORTS SHOULD INCLUDE RECORDS OF WEED REMOVAL PER CITY ORDINANCE (§ 9-8-1), STERILIZATION, SOIL TEST RESULTS AND RECOMMENDATION, MATERIALS AND MANUFACTURER'S SPECIFICATIONS FOR APPLICATION RATES, ESTIMATED FUNCTIONAL LONGEVITY, METHODS OF APPLICATION, INSPECTION AND MAINTENANCE. THE REDUCED SELF-INSPECTION SCHEDULE IN CGP 4.4.1 APPLIES TO STABILIZED AREA AND ANY DAMAGED OR WORN STABILIZATION MUST BE IDENTIFIED IN THE REPORTS ALONG WITH WEED PROBLEMS. CORRECTIVE ACTIONS FOR STABILIZATION SHALL BE DOCUMENTED IN A STABILIZATION REPORT INCLUDING ACTUAL RATES AND DATES OF STABILIZATION, AND THE MATERIALS AND MANUFACTURER'S SPECIFICATIONS USED.

BMPS SHALL BE INSPECTED AND MAINTAINED UNTIL ALL DISTURBED AREAS ARE STABILIZED IN ACCORDANCE WITH THE FINAL STABILIZATION CRITERIA (CGP 2.2.14.B). GENERALLY, ALL DISTURBED AREAS, OTHER THAN STRUCTURES AND IMPERVIOUS SURFACES, MUST HAVE UNIFORM PERENNIAL VEGETATION THAT PROVIDES 70 PERCENT OR MORE OF THE COVER PROVIDED BY NATIVE VEGETATION OR SEED THE DISTURBED AREA AND PROVIDE NON-VEGETATIVE MULCH THAT PROVIDES COVER FOR AT LEAST THREE YEARS WITHOUT ACTIVE MAINTENANCE. FINAL STABILIZATION MUST BE APPROVED BY THE CITY OF ALBUQUERQUE PRIOR TO REMOVAL OF BMPS AND DISCONTINUATION OF INSPECTIONS.



					DATE
					REVISION ITEM
					#

ALBUQUERQUE BILINGUAL
ACADEMY BASEBALL FIELD
SWPPP NOTES





SWPPP
Stormwater
Erosion Control
Reclamation
Seeding

www.e2rc.com | 505.867.4040

DESIGNED BY:
K. FETTER, P.E.
DRAWN BY:
S. FETTER

SHEET:
GENERAL
NOTES

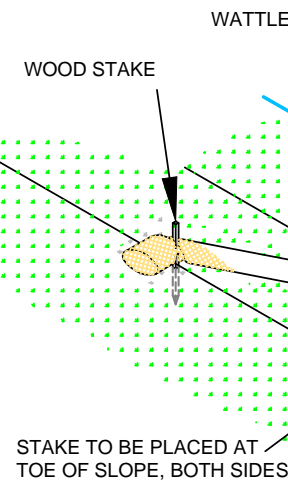

NTS

NTS

VERTICAL SPACING DEPENDENT ON SLOPE GRADIENT.

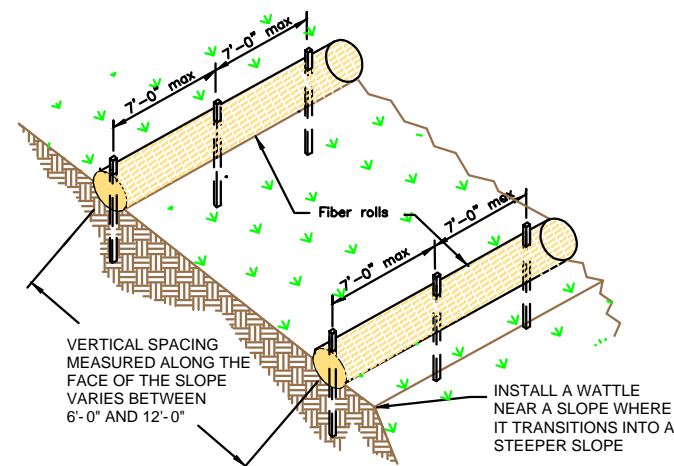

NTS



- SWPPP
- Stormwater
- Erosion Control
- Reclamation
- Seeding

www.e2rc.com | 505.867.4040

[illegible]

ALBUQUERQUE BILINGUAL
ACADEMY BASEBALL FIELD
BMP DETAILS

DESIGNED BY:
K. FETTER, P.E.
DRAWN BY:
S. FETTER

SHEET:

4



ONCE/IF THE SPOILS STOCKPILE IS DEPLETED OR MOVED,
REMOVE THE WATTLES AND REUSE THEM IN THE NEXT
LOCATION.



ONCE THE TRANCH IS BACKFILLED, WATTLES MAY BE REMOVED AND REUSED IN THE NEXT SECTION OF EXCAVATION PROVIDED THEY ARE IN GOOD CONDITION.

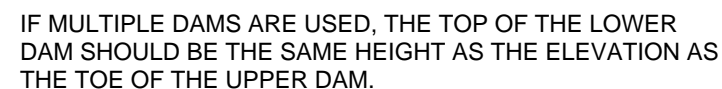

2-3" OF THE WOODEN STAKE SHOULD BE PRESENT ABOVE THE WATTLE.



USE EQUIPMENT TO COMPACT EARTHEN BERM BY ROLLING OVER BERM TO MINIMIZE SPREAD.



www.e2rc.com | 505.867.4040



**ALBUQUERQUE BILINGUAL
ACADEMY BASEBALL FIELD
BMP DETAILS**

SHEET:

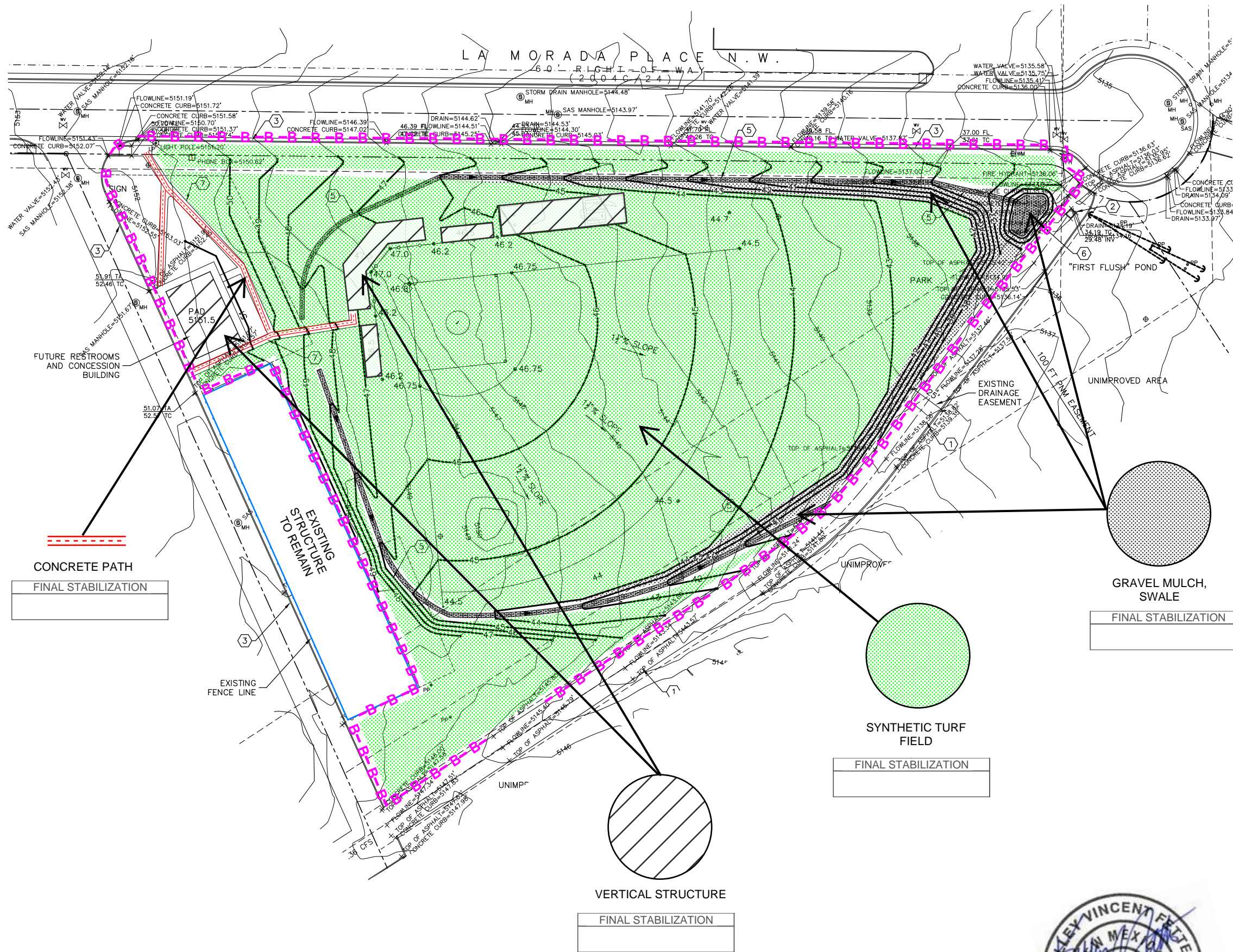

REVISION ITEM				DATE
#				

ALBUQUERQUE BILINGUAL
ACADEMY BASEBALL FIELD
FINAL STABILIZATION

DESIGNED BY:
K. FETTER, P.E.
DRAWN BY:
S. FETTER

SHEET:

9



- SWPPP
- Stormwater
- Erosion Control
- Reclamation
- Seeding