

## Shared Septic Agreement Sawmill Village Subdivision

This Shared Septic Agreement is entered into this 26 day of October, 2013 and effects the property located at 1751 Bellamah NW, Albuquerque, NM 87104, as more specifically identified in Attachment A attached hereto.

Sawmill Community Land Trust ("Owner") hereby grants a perpetual agreement over the area designated as "Outline Boundary of Four Acre Discharge Area" in Attachment A for the purpose of a septic system and discharge of its treated liquid waste for beneficial use into the community storm water detention pond identified in Attachment A as "Detention Pond Area".

The objective of the system is to provide a dependable irrigation source for the Detention Pond Area, providing shade, erosion control, exposure to nature for urban residents, storm water remediation, habitat within the urban corridor, and beauty. This design parameter will conform to all State regulations for the treatment and disposal of sewage. At the same time, it will enhance the quality of life and serve as a model for development in other locations by its wise water use. What had previously been treated as a disposal nuisance will now be applied to beneficial use. As a water conservation technique, there is none more efficient and cost effective than the reuse of "waste" water. This project will set a technological standard for simplicity and versatility.

The system shall be maintained so that it is compliant with all current or future regulations of the New Mexico Environment Department (NMED). An official Maintenance Service Provider and contract will be filed with the NMED.

Modifications to volume or location of discharge shall be made only with written approval of the Owner, the City of Albuquerque Hydrology Department, the City of Albuquerque Environmental Health Department and the NMED.

The Outline Boundary of Four Acre Discharge Area has been delineated to comply with NMED regulations for the discharge of secondary treated effluent not to exceed 2,000 gallons per day.

Semi-annual service reports will be provided to the Owner and NMED District One.

---

Sawmill Community Land Trust  
**Wade Patterson, Executive Director**

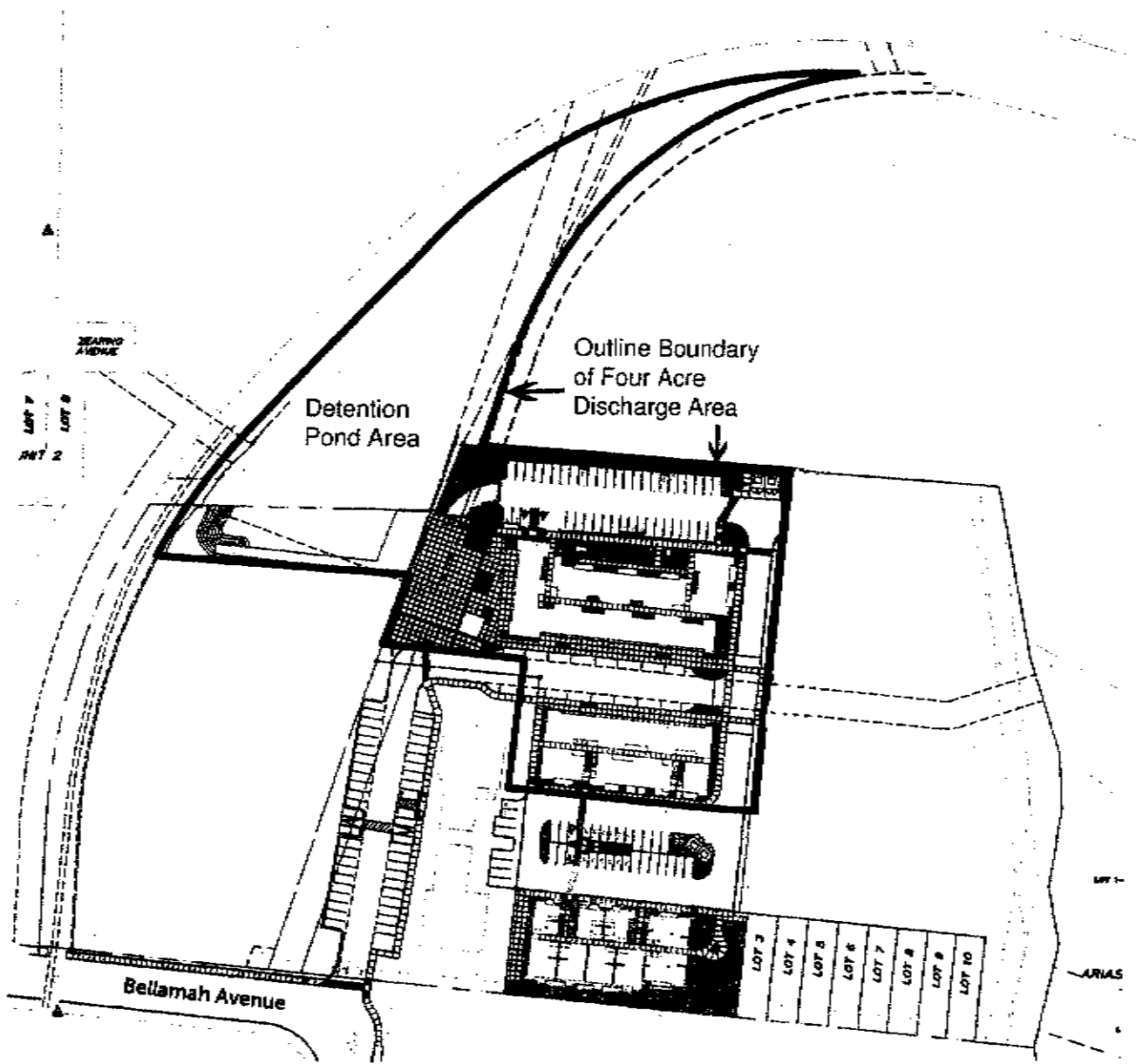

↑N (Not to scale)

*[Signature]*

Wade Patterson, Executive Director SCLT  
Four Acre Discharge Area

