



February 11, 1998

Richard Hall  
Hall Engineering  
1116 2nd St. NW  
Albuquerque, New Mexico 87102

RE: REVISED DRAINAGE PLAN FOR SOUTHWEST SEALS (H16-D123) REVISION  
DATED 2/6/98

Dear Mr. Hall:

Based on the information provided on your February 6, 1998 resubmittal, the above referenced site is approved for Building Permit.

Please attach a copy of this approved plan to the construction sets prior to sign-off by Hydrology.

Also, Engineer Certification per the DPM checklist will be required prior to the release of the Certificate of Occupancy.

If I can be of further assistance, please feel free to contact me at 924-3986.

C: Andrew Garcia

File

Sincerely

  
Bernie J. Montoya CE  
Associate Engineer

Good for You, Albuquerque!



**DRAINAGE INFORMATION SHEET**

PROJECT TITLE: SOUTHWEST SEALS                            ZONE ATLAS/DRNG.FILE#H-16  
LEGAL DESCRIPTION: WESTELRLY PORTION OF TRACT "K" AND PARCEL 10, COLES  
INDUSTRIAL SUBDIVISION NO.2  
CITY ADDRESS: CANDELARIA AT VASSAR

0123

ENGINEERING FIRM: HALL ENGINEERING

CONTACT: MICHAEL MARTINEZ

ADDRESS: 1116 2ND ST. N.W.

PHONE: 848-7822

OWNER:

CONTACT:

ADDRESS:

PHONE:

ARCHITECT:

CONTACT:

ADDRESS:

PHONE:

CONTRACTOR:

CONTACT:

ADDRESS:

PHONE:

**PRE-DESIGN MEETING:**

YES  
 NO  
 COPY OF CONFERENCE RECAP SHEET PROVIDED

DRB NO. \_\_\_\_\_  
EPC NO. \_\_\_\_\_  
PROJ NO. \_\_\_\_\_

**TYPE OF SUBMITTAL:**

DRAINAGE REPORT  
 DRAINAGE PLAN  
 CONCEPTUAL GRADING & DRAINAGE PLAN  
 GRADING PLAN  
 EROSION CONTROL PLAN  
 ENGINEER'S CERTIFICATION

**TYPE OF APPROVAL SOUGHT:**

SKETCH PLAT APPROVAL  
 PRELIM. PLAT APPROVAL  
 SITE DEVELOPMENT PLAN  
 FINAL PLAT APPROVAL  
 BLDG. PERMIT APPROVAL  
 FOUNDATION PERMIT  
 CERT. OF OCCUPANCY  
 ROUGH GRADING PERMIT  
 GRADING/PAVING PERMIT  
 OTHER \_\_\_\_\_ (SPECIFY)

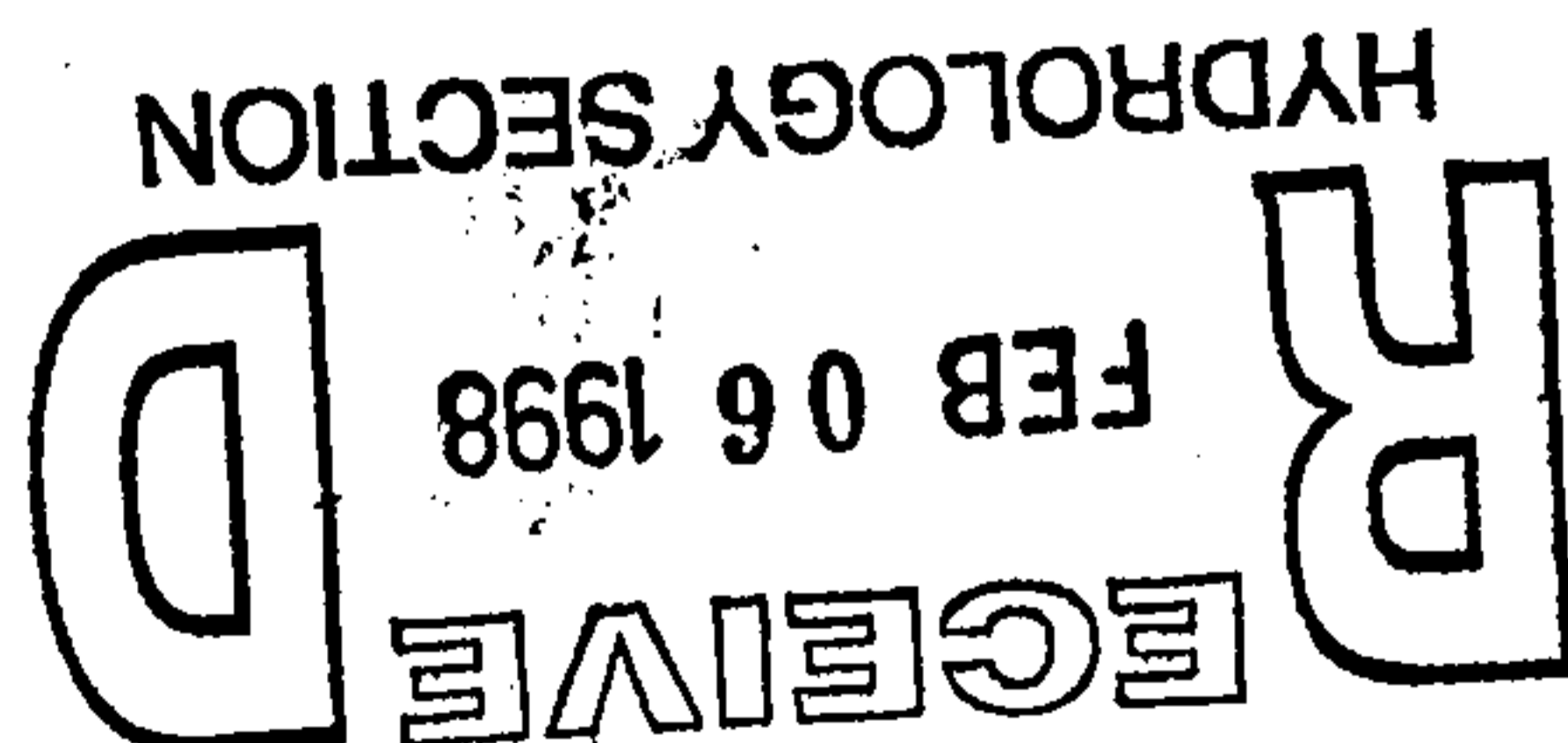

DATE SUBMITTED: FEBRUARY 6, 1998

SUBMITTED BY: MICHAEL MARTINEZ

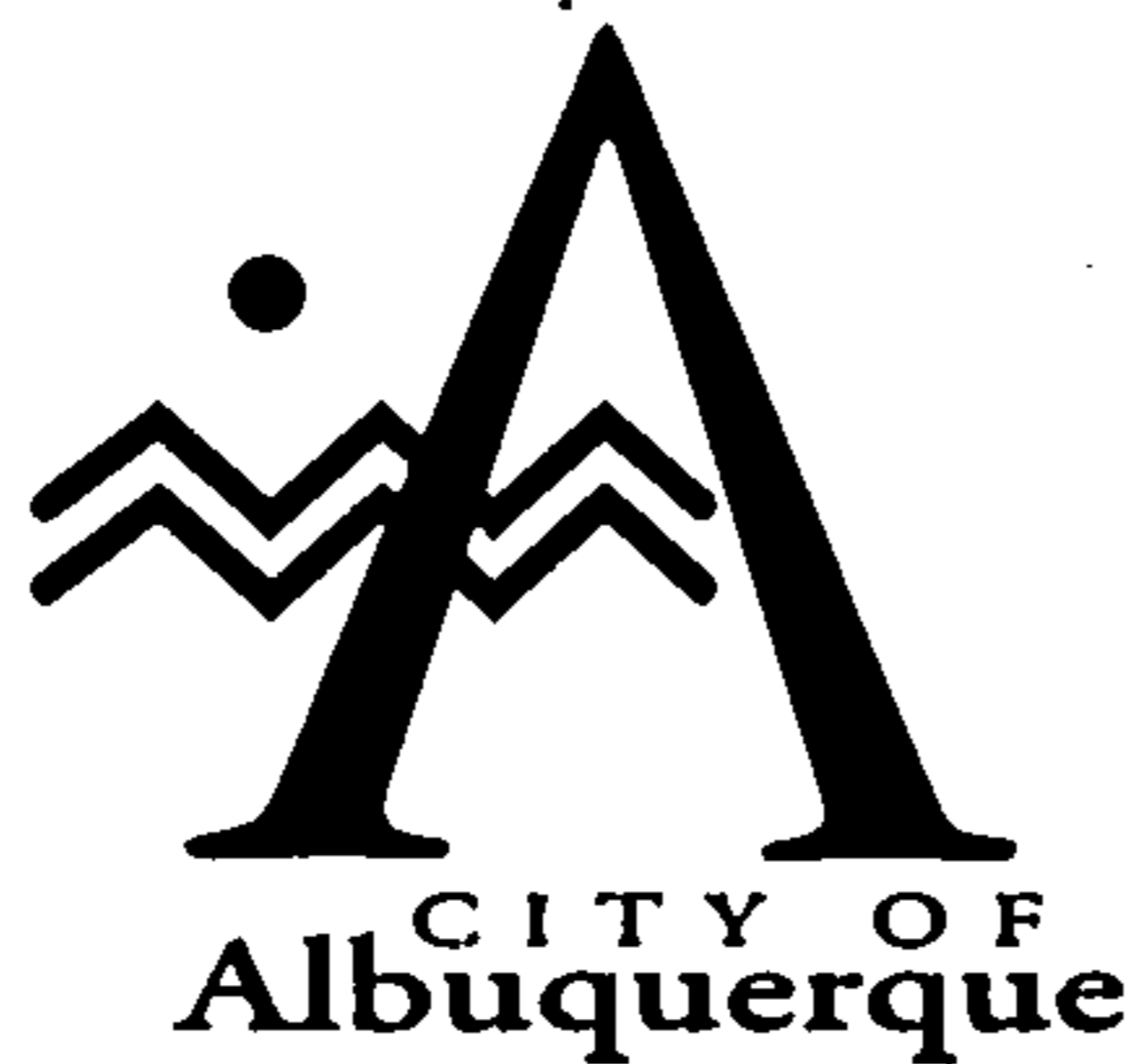

Martin J. Chávez, Mayor  
January 14, 1998

Richard Hall  
Hall Engineering  
1116 2nd St. NW  
Albuquerque, New Mexico 87102

RE: DRAINAGE PLAN FOR AN ADDITION TO SOUTHWEST SEALS (H16-D123)  
ENGINEER'S STAMP DATED 12/5/97

Dear Mr. Hall:

Based on the information provided on your December 16, 1997 submittal, the above referenced site is approved for Building Permit.

Please attach a copy of this approved plan to the construction sets prior to sign-off by Hydrology.

Also, prior to Certificate of Occupancy release, Engineer Certification per the DPM checklist will be required.

If I can be of further assistance, please feel free to contact me at 924-3986.

C: Andrew Garcia

**File**

Sincerely

Bernie J. Montoya CE  
Associate Engineer



**DRAINAGE INFORMATION SHEET**

PROJECT TITLE: SOUTHWEST SEALS                      ZONE ATLAS/DRNG.FILE#H16-D123

LEGAL DESCRIPTION: TRACT "K" AND PARCEL 10, COLES INDUSTRIAL SUBD.

CITY ADDRESS: CANDELARIA ROAD, NE

ENGINEERING FIRM: HALL ENGINEERING

ADDRESS: 6840 2ND ST. N.W.

CONTACT: MICHAEL MARTINEZ

PHONE: 345-1064

OWNER: SOUTHWEST SEAL AND SUPPLY

ADDRESS: 1413 1ST ST NW 87102

CONTACT:

PHONE: 247-0625

ARCHITECT: MASTERWORKS ARCHITECTS

ADDRESS: 516 11TH ST, NW 87102

CONTACT:

PHONE: 242-1866

CONTRACTOR:

ADDRESS:

CONTACT:

PHONE:

**PRE-DESIGN MEETING:**

- YES
- NO
- COPY OF CONFERENCE RECAP SHEET PROVIDED

DRB NO. \_\_\_\_\_  
EPC NO. \_\_\_\_\_  
PROJ NO. \_\_\_\_\_

**TYPE OF SUBMITTAL:**

- DRAINAGE REPORT
- DRAINAGE PLAN
- CONCEPTUAL GRADING & DRAINAGE PLAN
- GRADING PLAN
- EROSION CONTROL PLAN
- ENGINEER'S CERTIFICATION

**TYPE OF APPROVAL SOUGHT:**

- SKETCH PLAT APPROVAL
- PRELIM. PLAT APPROVAL
- SITE DEVELOPMENT PLAN
- FINAL PLAT APPROVAL
- BLDG. PERMIT APPROVAL
- FOUNDATION PERMIT
- CERT. OF OCCUPANCY
- ROUGH GRADING PERMIT
- GRADING/PAVING PERMIT
- OTHER \_\_\_\_\_ (SPECIFY)

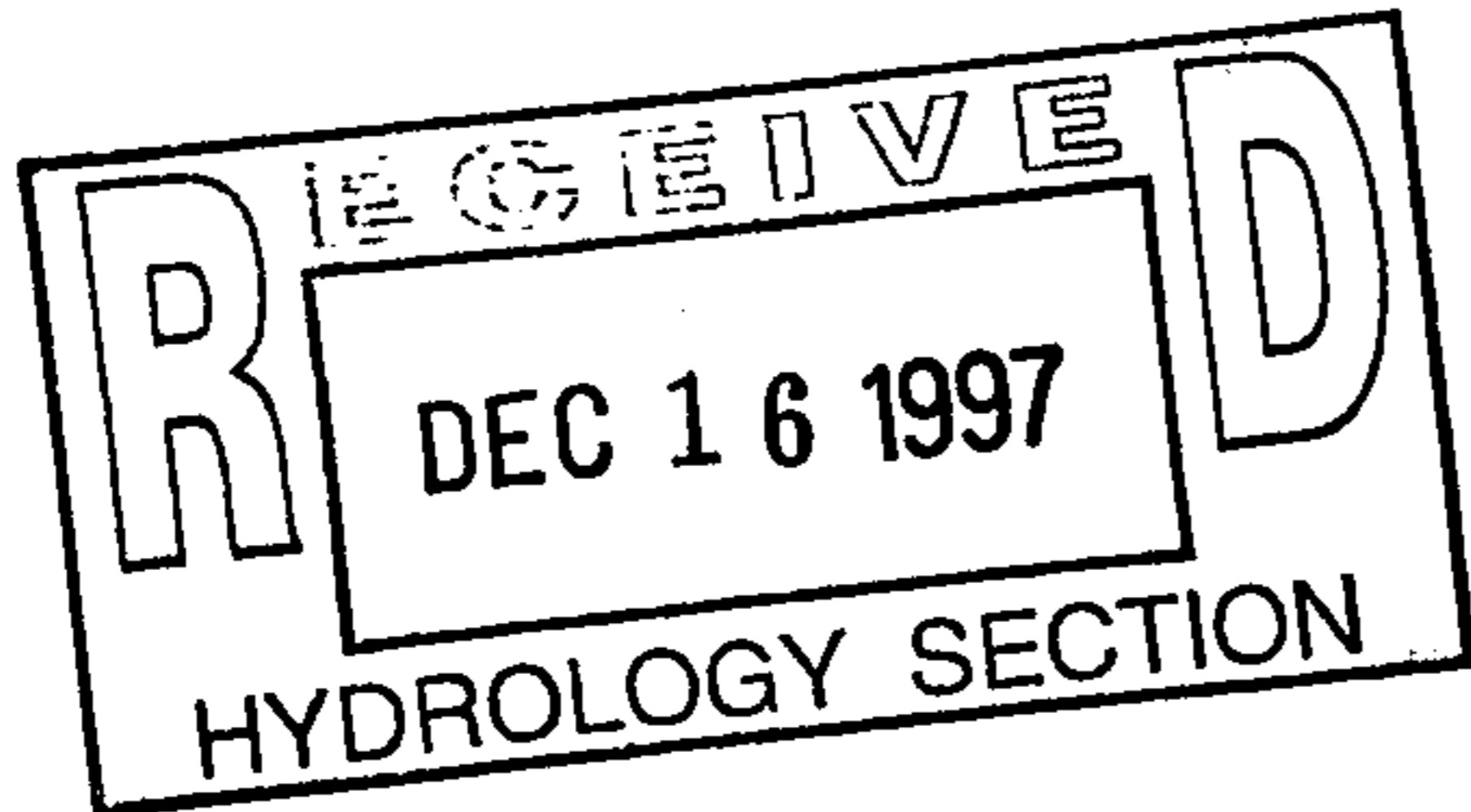

DATE SUBMITTED: DECEMBER 16, 1997

SUBMITTED BY: MICHAEL MARTINEZ

DRAINAGE INFORMATION SHEET

PROJECT TITLE: SOUTHWEST SEALS ZONE ATLAS/DRNG. FILE #: H16/D123

DRB #: EPC #: WORK ORDER #:

LEGAL DESCRIPTION: TRACT "K" AND PARCEL 10, COLES INDUSTRIAL SUBD.

CITY ADDRESS: 2701 CANDELARIA ROAD, NE

ENGINEERING FIRM: HALL ENGINEERING, INC.

CONTACT: RICHARD HALL

ADDRESS: 1116 2ND ST., NW 87102

PHONE: 848-7822 FAX 848-7825

OWNER: SOUTHWEST SEAL & SUPPLY

CONTACT:

ADDRESS: 1413 1ST ST NW 87102

PHONE: 247-0265

ARCHITECT: MASTERWORKS ARCHITECTS

CONTACT:

ADDRESS: 516 11TH ST, NW 87102

PHONE: 242-1866

SURVEYOR:

CONTACT:

ADDRESS:

PHONE:

CONTRACTOR:

CONTACT:

ADDRESS:

PHONE:

TYPE OF SUBMITTAL:

- DRAINAGE REPORT
- DRAINAGE PLAN
- CONCEPTUAL GRADING & DRAINAGE PLAN
- GRADING PLAN
- EROSION CONTROL PLAN
- ENGINEER'S CERTIFICATION
- OTHER

CHECK TYPE OF APPROVAL SOUGHT:

- SKETCH PLAT APPROVAL
- PRELIMINARY PLAT APPROVAL
- S. DEV. PLAN FOR SUB'D. APPROVAL
- S. DEV. PLAN FOR BLDG. PERMIT APPROVAL
- SECTOR PLAN APPROVAL
- FINAL PLAT APPROVAL
- FOUNDATION PERMIT APPROVAL
- BUILDING PERMIT APPROVAL
- CERTIFICATE OF OCCUPANCY APPROVAL
- GRADING PERMIT APPROVAL
- PAVING PERMIT APPROVAL
- S.A.D. DRAINAGE REPORT
- DRAINAGE REQUIREMENTS
- OTHER (SPECIFY)

30 day Temp CO, issued on 11/28/97

PRE-DESIGN MEETING:

- YES
- NO
- COPY PROVIDED

DATE SUBMITTED: NOVEMBER 26, 1997

BY: Richard Hall

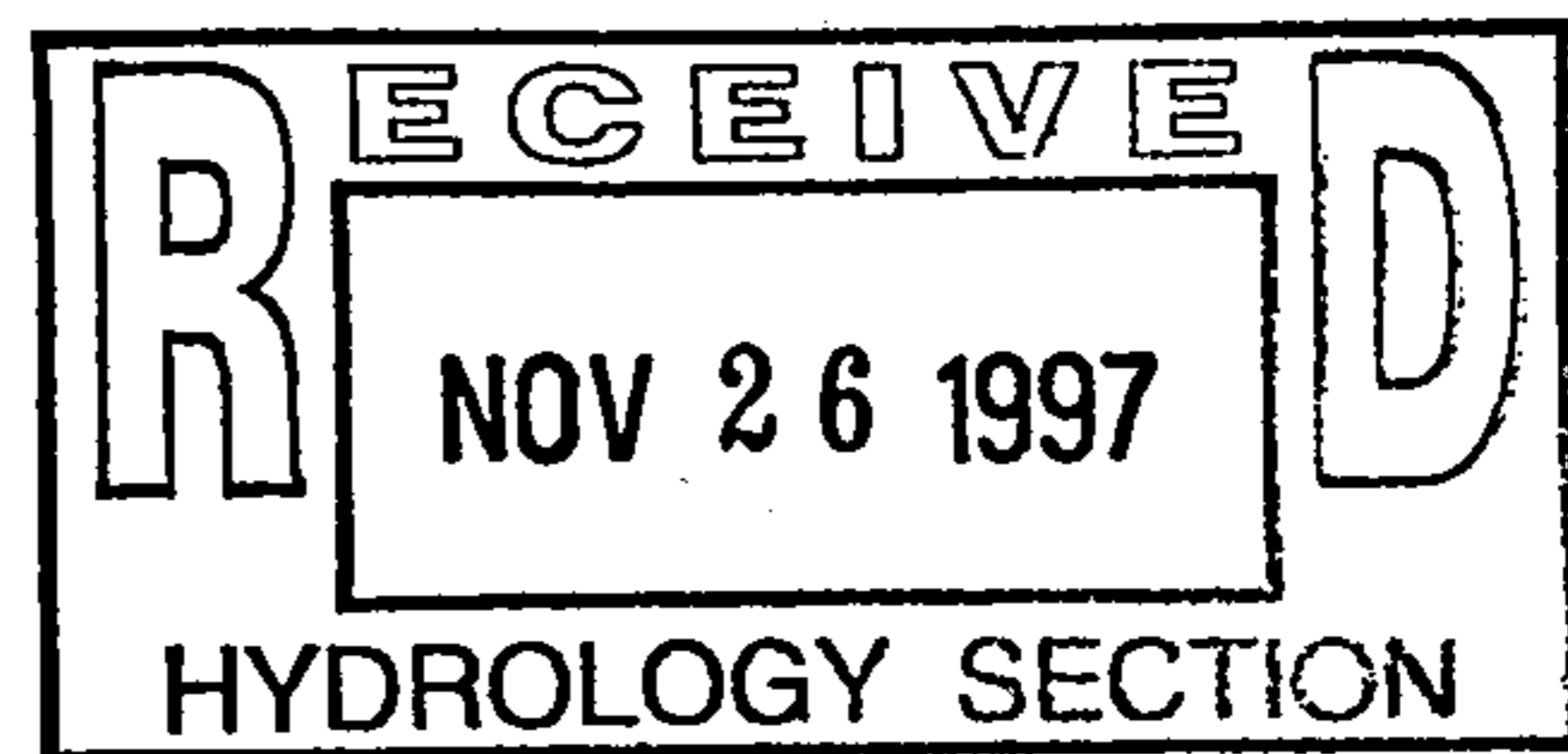



SHEET 2  
S.W. SEALS  
VASSAR  
AS BUILDS

Joaquin Arduelles, Jr.  
ARQUELLES SURVEYING  
2912 SAN YACINTO  
PROFESSIONAL LAND SURVEYOR

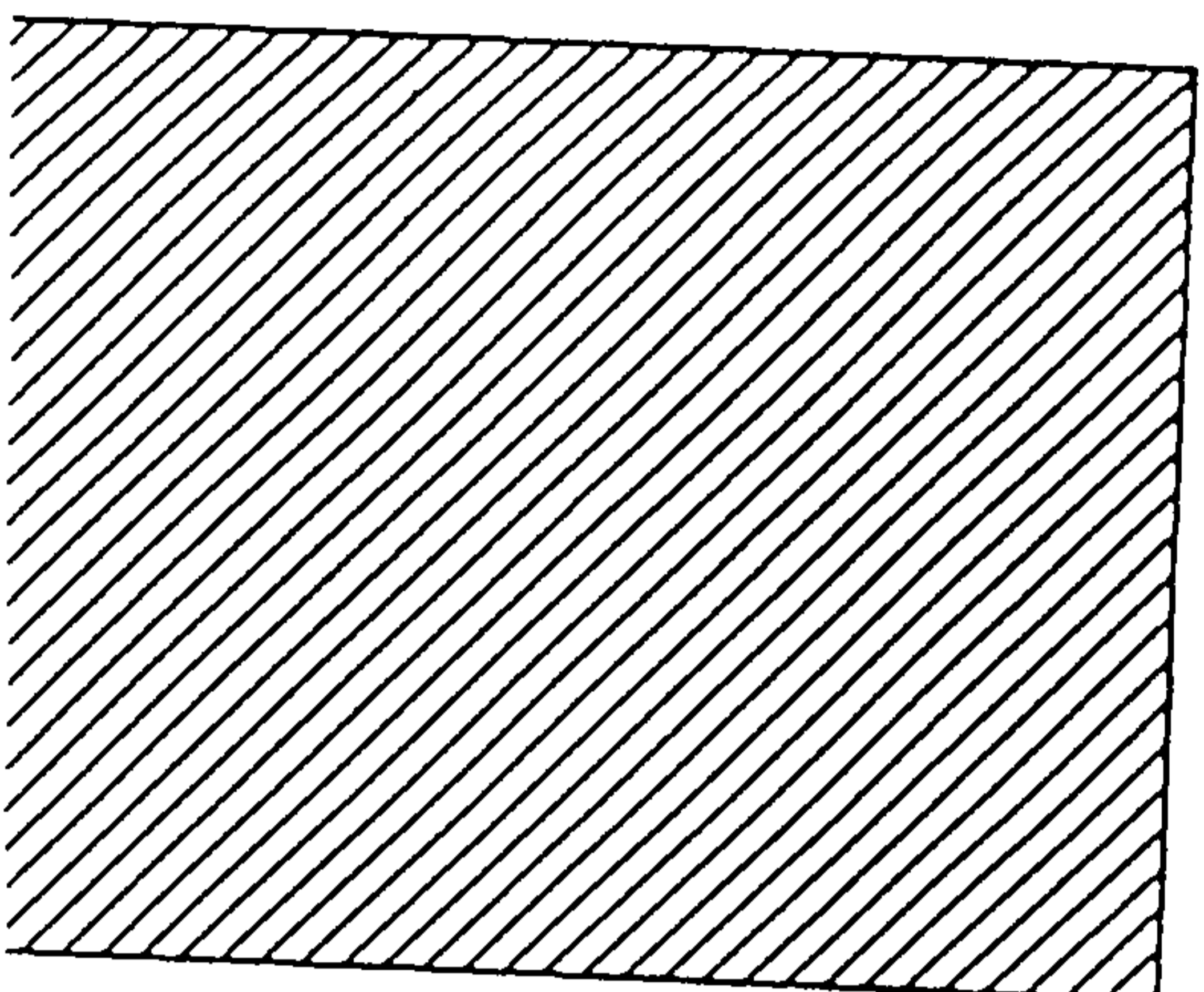
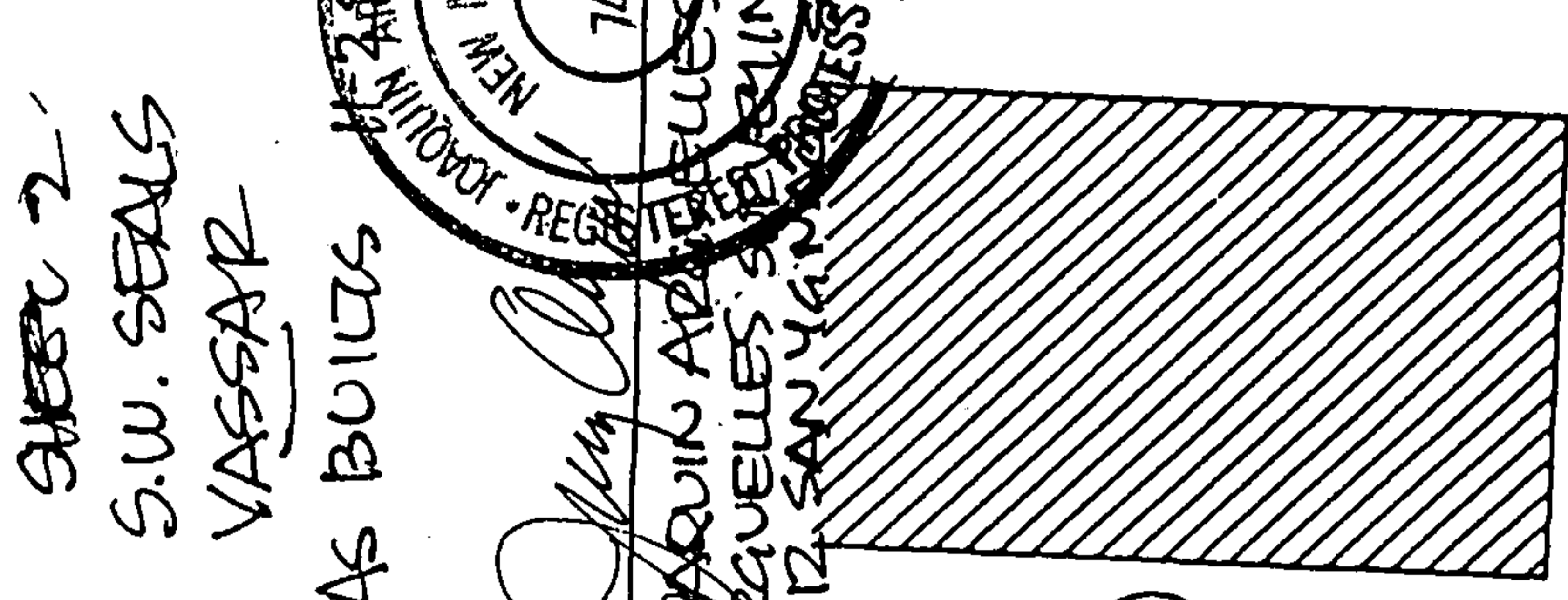

00

NON-CONTRIBUTORY AREA

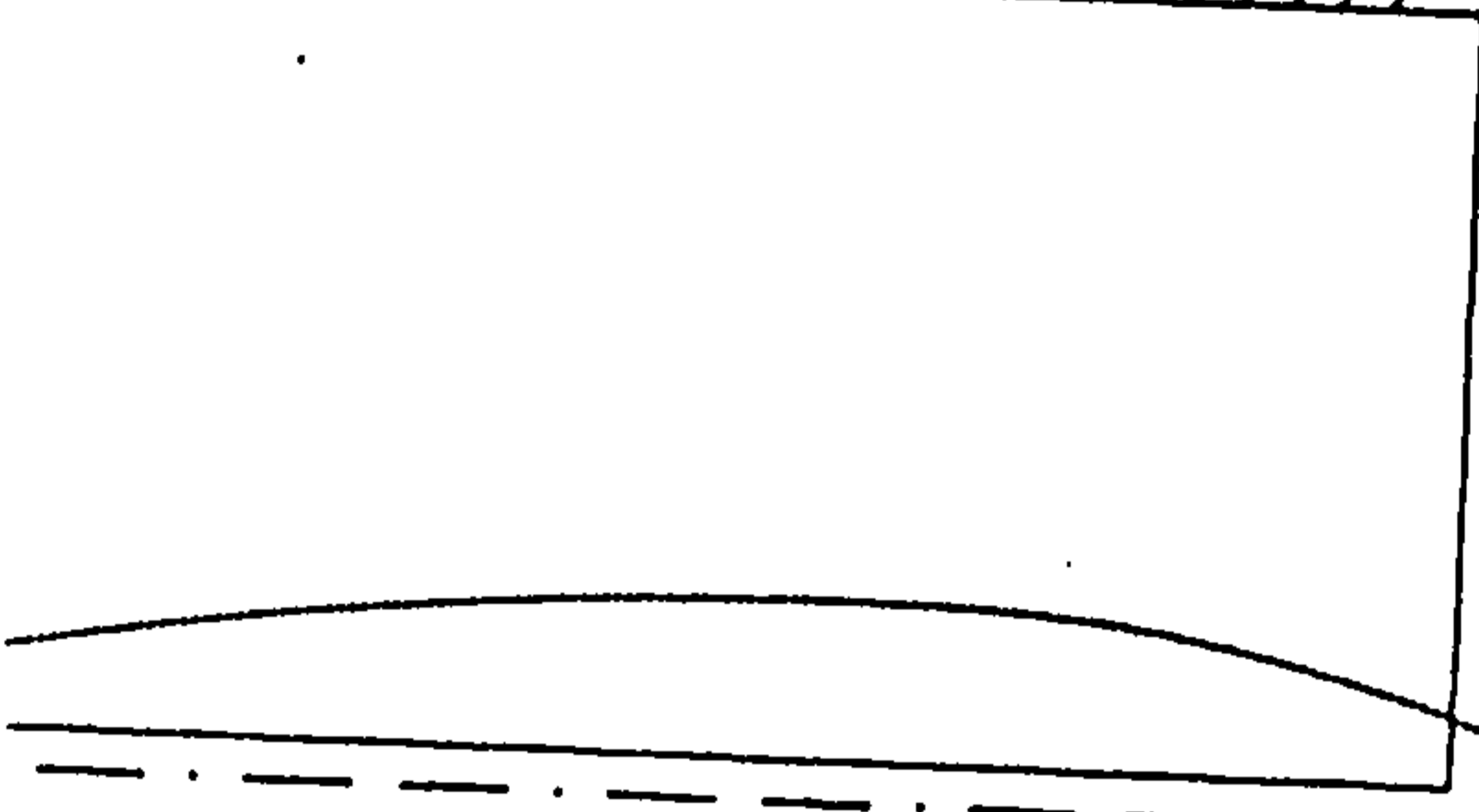

LANDSCAPE BUFFER

172.00'

N 00°30'00" E

S 89°30'00" E 57.00'

6' LANDSCAPE BUFFER

HEADER CURB T.W. 5101.00

5099.75

5099.75

S 00°30'00" W

EDGE OF ASPHALT

DUMPSTER ENCLOSURE

FL 1% SLOPE

(100.10 FS)

(100.12 FS)

(100.34 FS)

(100.24 TC)

(100.26 TC)

(100.30 FS)

5100.50

5100.67 T.C.

5100

5099.50

ROOF DRAINS

COVERED PORCH

COVERED PORCH

SEE SHEET

5099

5099.50

5099.70

175.74'

240.25'

.6' CONC.

INV OUT 98.60

INV IN 98.70

24" CURB CUT

5099.35 T. WALK

NEW 6' CONC. SIDEWALK

NEW 24" CURB CUT

5099.41 T.C.  
5098.96 F.L.

5099.03 T.C.

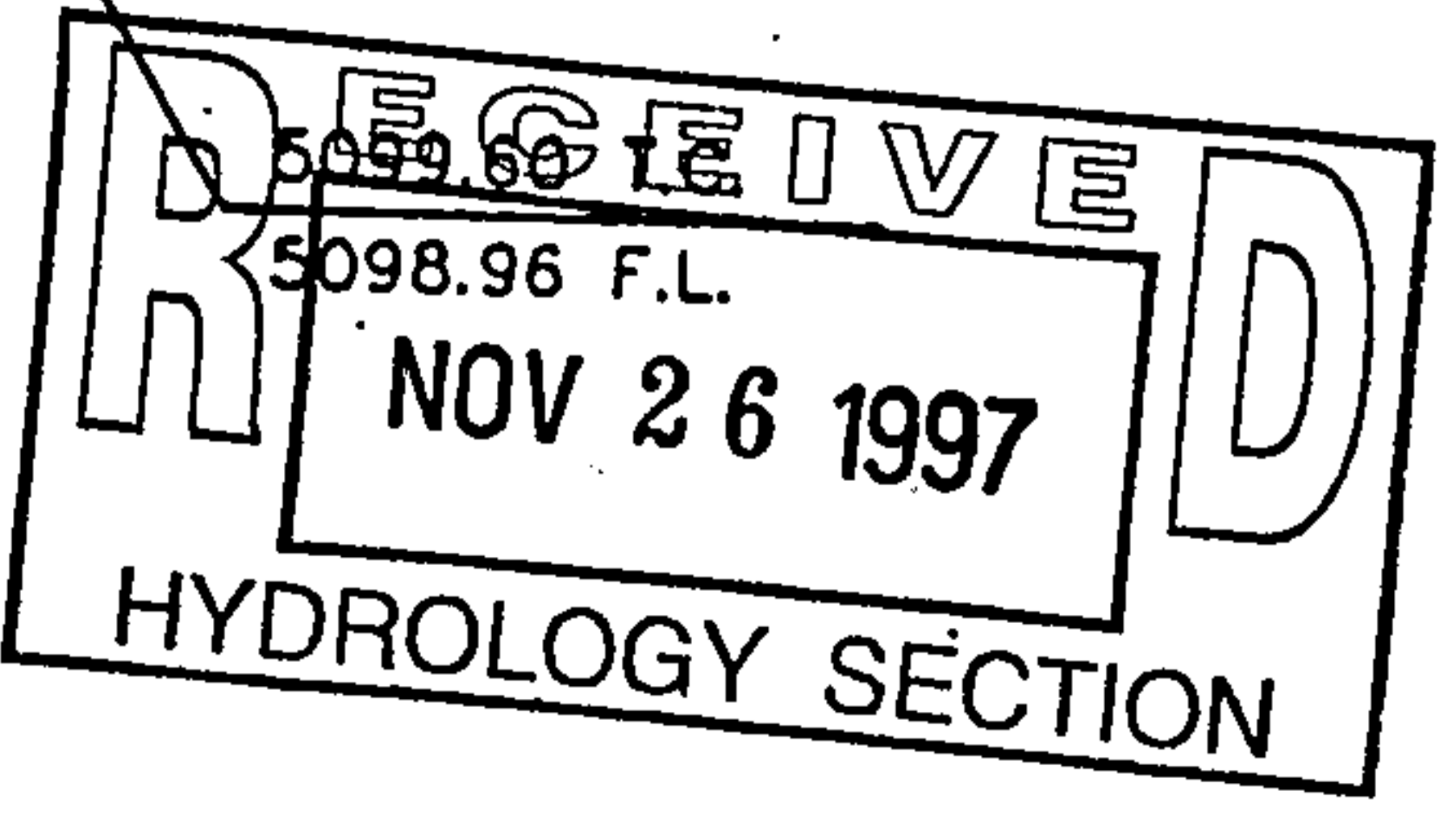



PHONE: 873-3775 OFFICE  
235-1652 MOBILE

5099.60 T.C.  
5098.96 F.L.  
SHEET 1  
S.W. SEALS  
YASSAR

AS BUILT 11.25.97

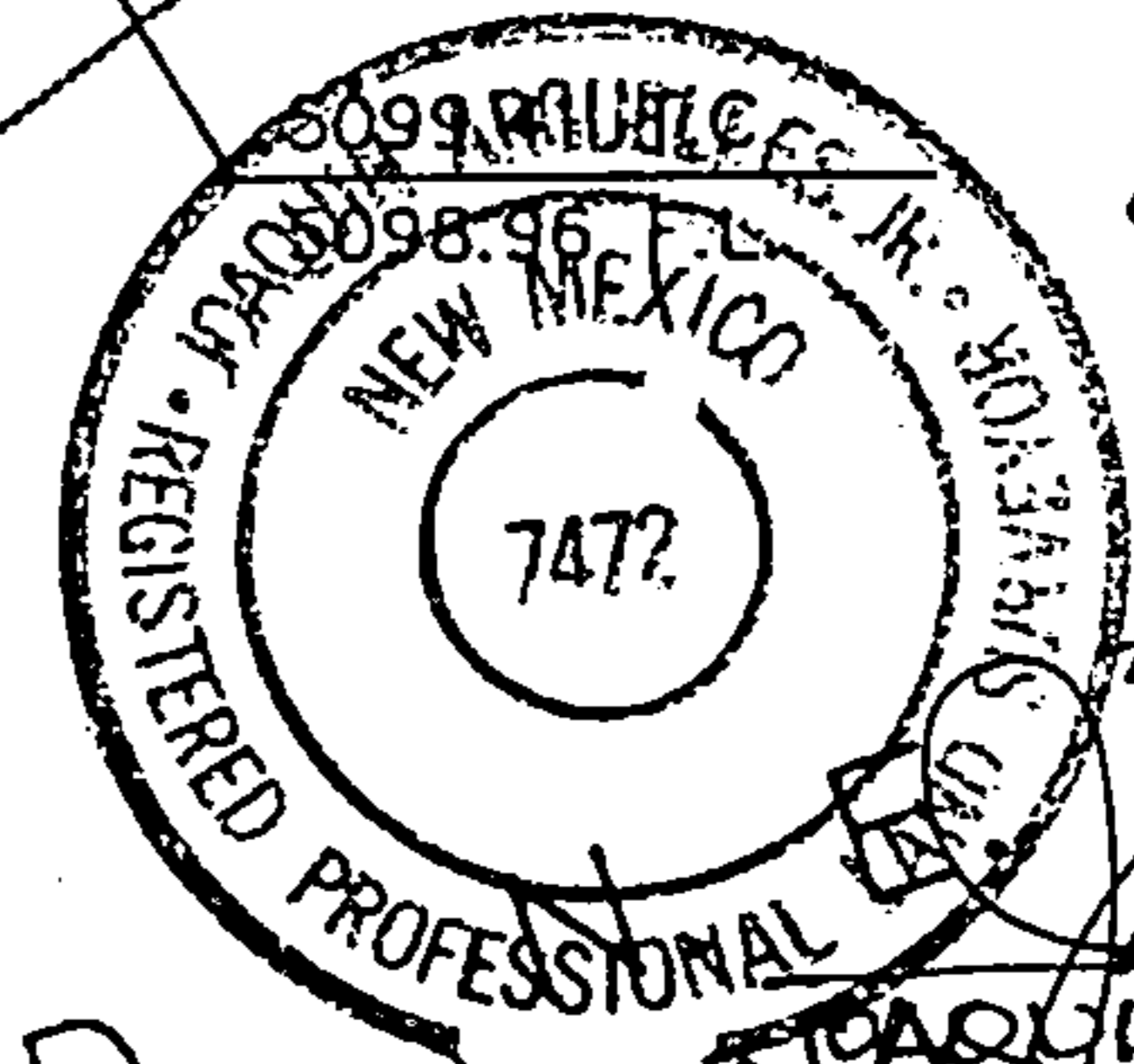

*Joaquin Arcuelles Jr.*  
JOAQUIN ARCUELLES JR. LS 7472  
ARCUELLES SURVEYING  
2912 SAN YANACIO SW

ROAD



SHEET 2  
S.W. SEALS  
VASSAR  
AS BUILTS

Joaquin Argüelles, Jr.  
ARGÜELLES, JR.  
2912 SAN YAN  
PROFESSIONAL LAND SURVEYOR

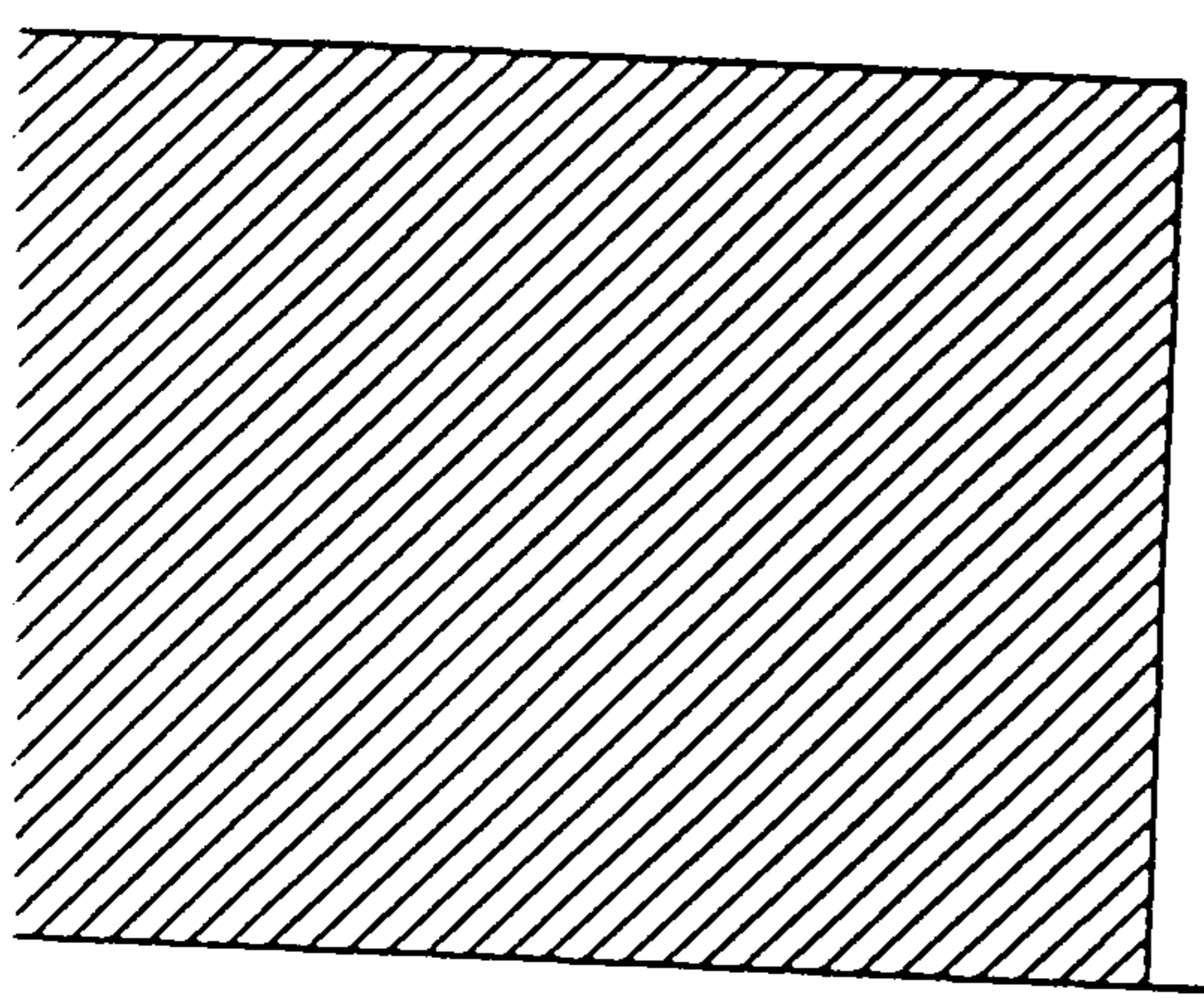

NON-CONTRIBUTORY AREA

00

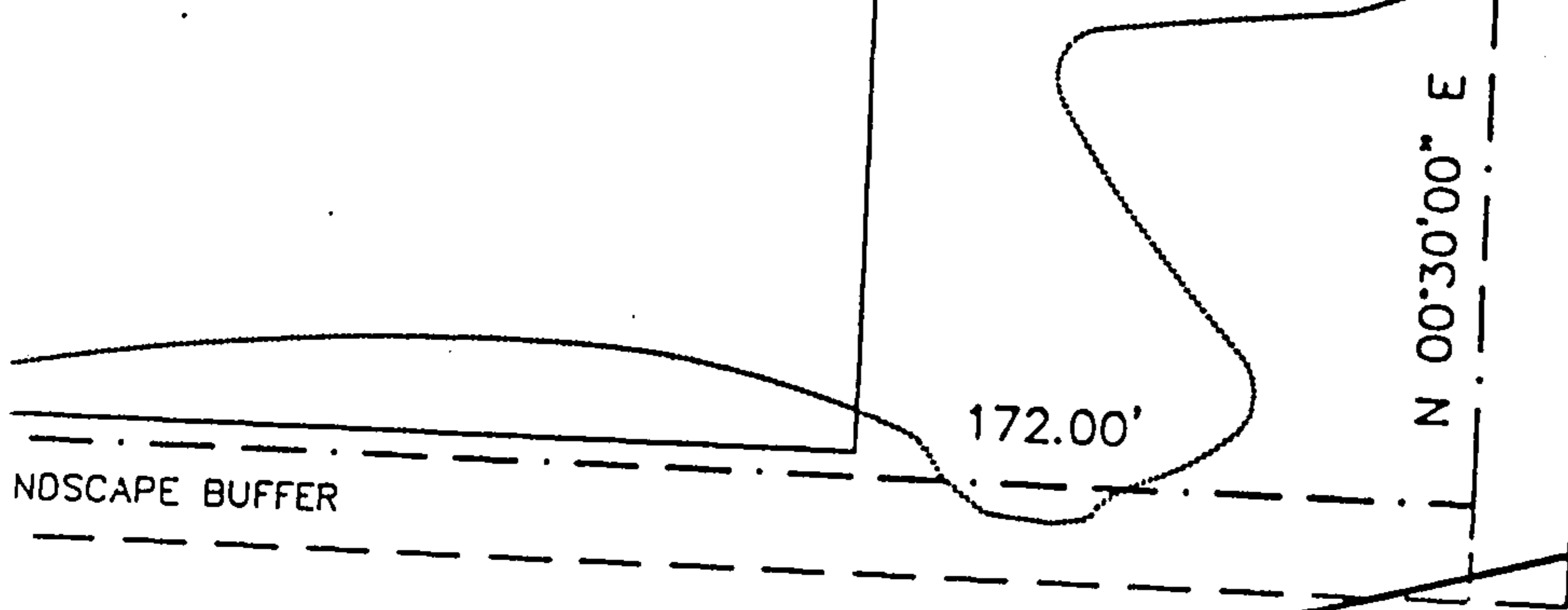

LANDSCAPE BUFFER

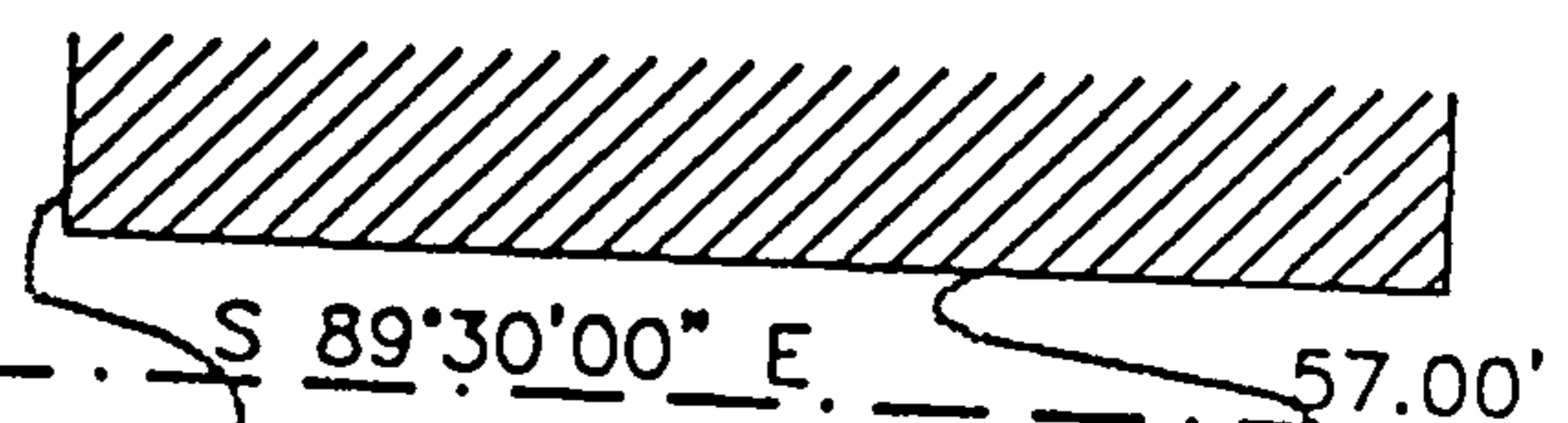

S 89°30'00" E. 57.00'  
6' LANDSCAPE BUFFER  
HEADER CURB T.W. 5101.00

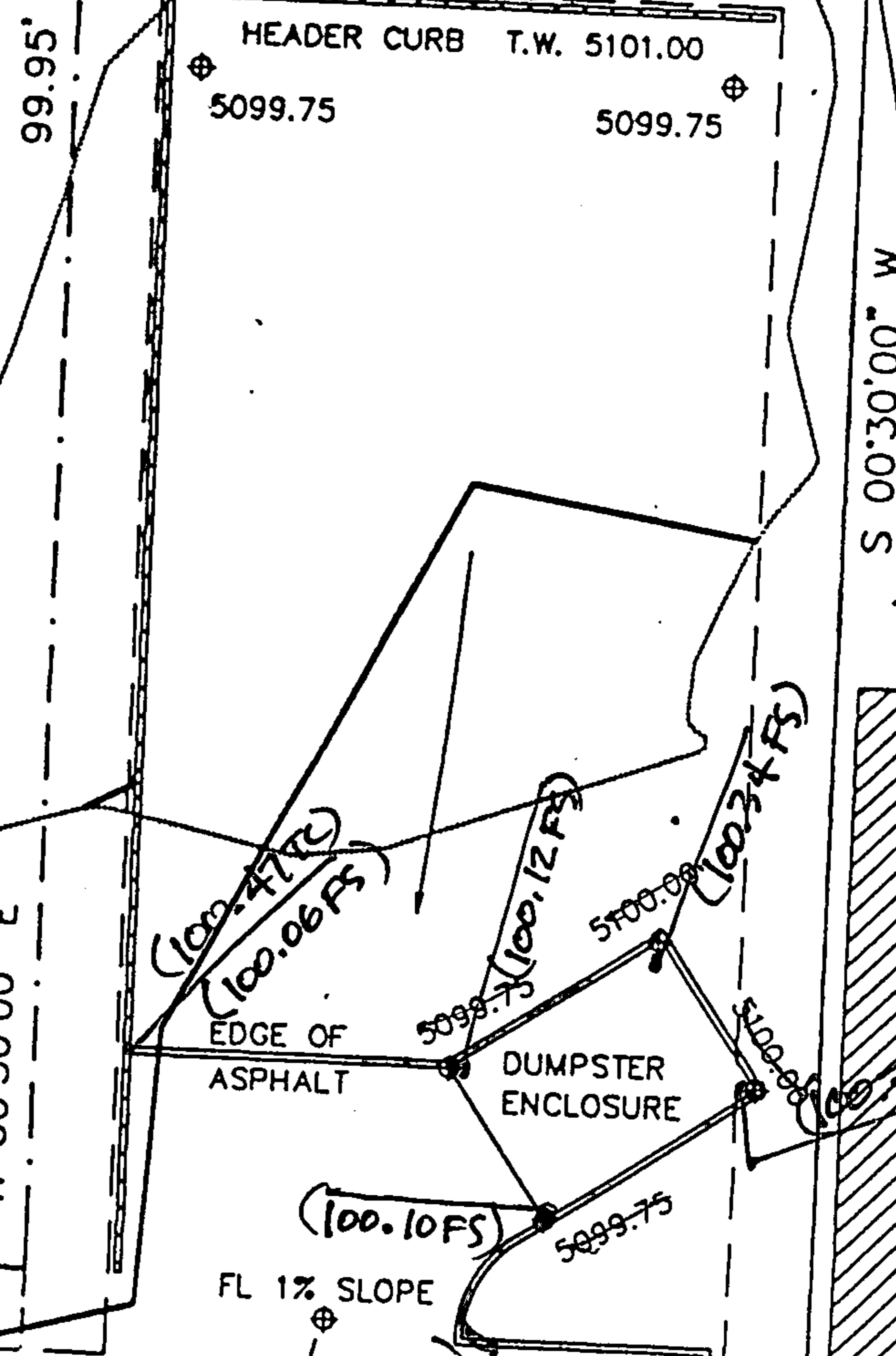

EDGE OF ASPHALT  
DUMPSTER ENCLOSURE

FL 1% SLOPE

S 00°30'00" W

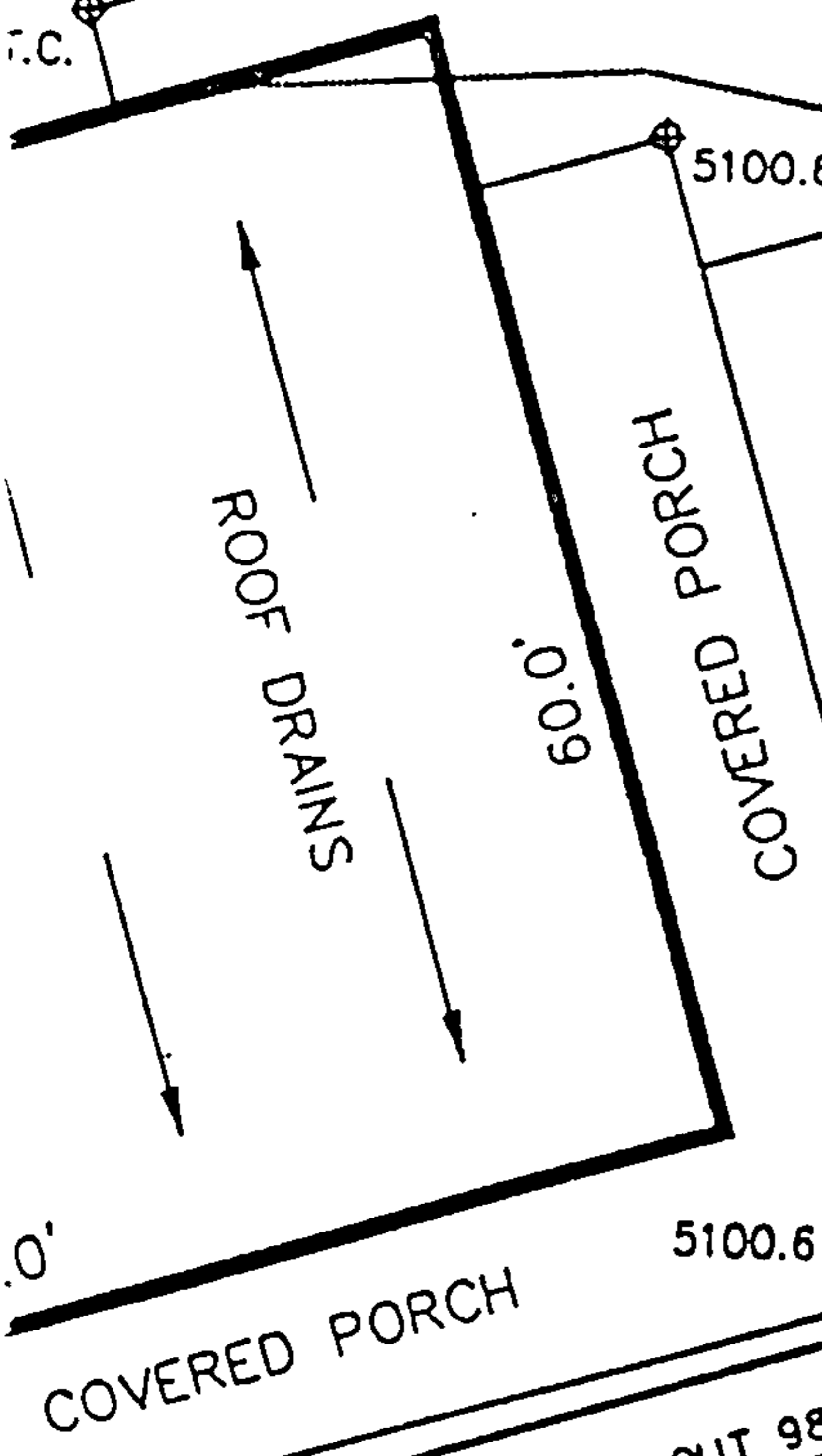
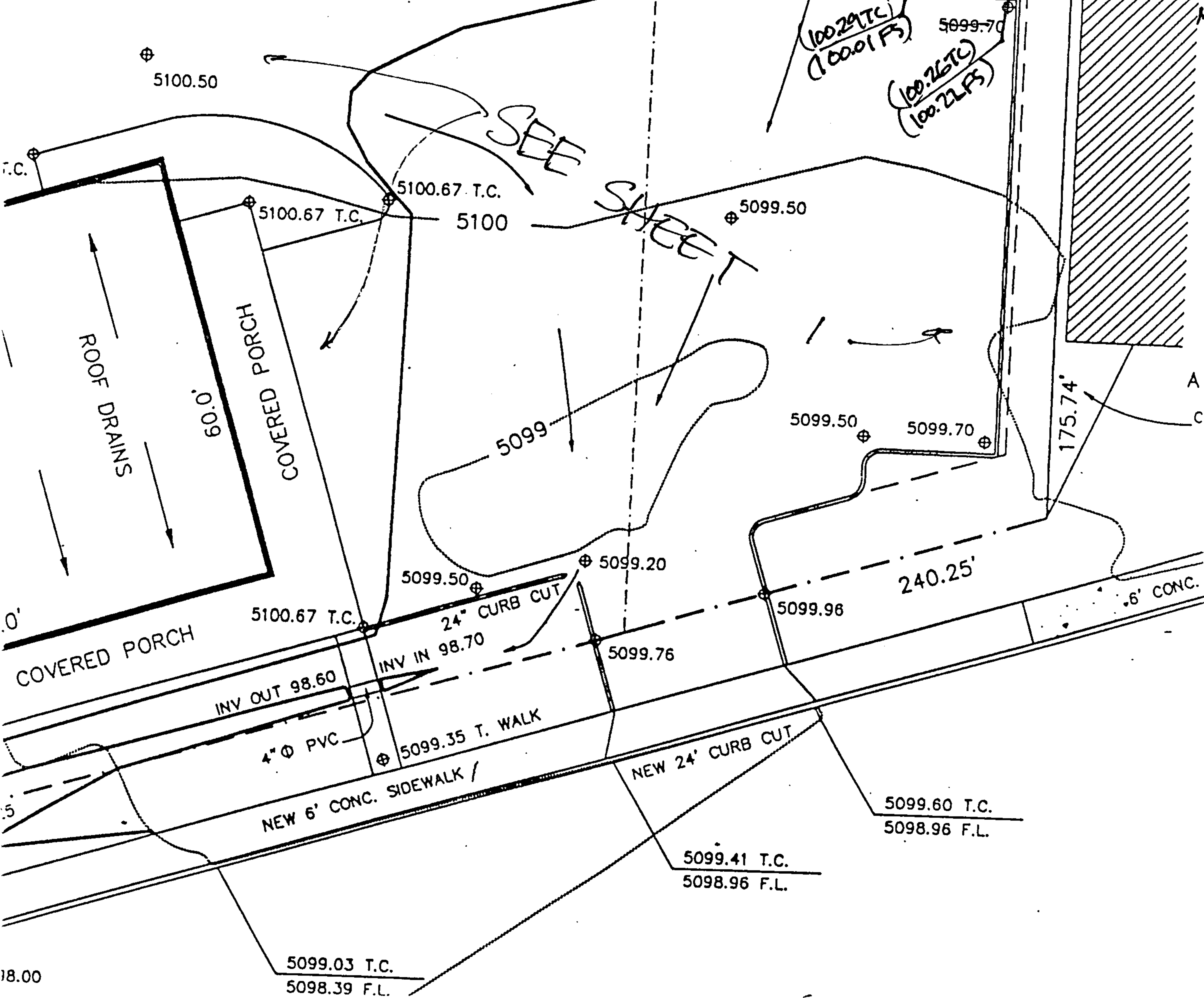

ROOF DRAINS

COVERED PORCH

COVERED PORCH

SEE SHEET

INV OUT 98.60

INV IN 98.70

NEW 6' CONC. SIDEWALK /

NEW 24' CURB CUT

5099.60 T.C.  
5098.96 F.L.

5099.41 T.C.  
5098.96 F.L.

5099.03 T.C.  
5098.39 F.L.

18.00





S 89°30'00" E

172.00'

6' LANDSCAPE BUFFER

FL 1% SLOPE

FL 2% SLOPE

NEW 24' CURB CUT

NEW 6' CONC. SIDEWALK

148.97'

PROPOSED BUILDING  
FF = 5101.00

COVERED PORCH

COVERED PORCH

NEW 6' CONC. SIDEWALK /

NEW 24' CURB CUT

PHONE: 873-3775 OFFICE  
235-1652 MOBILE

5099.60 T.C.  
5098.96 F.L.

SHEET 1  
S.W. SEALS  
YASSAR

AS BUILTS 11-25-97

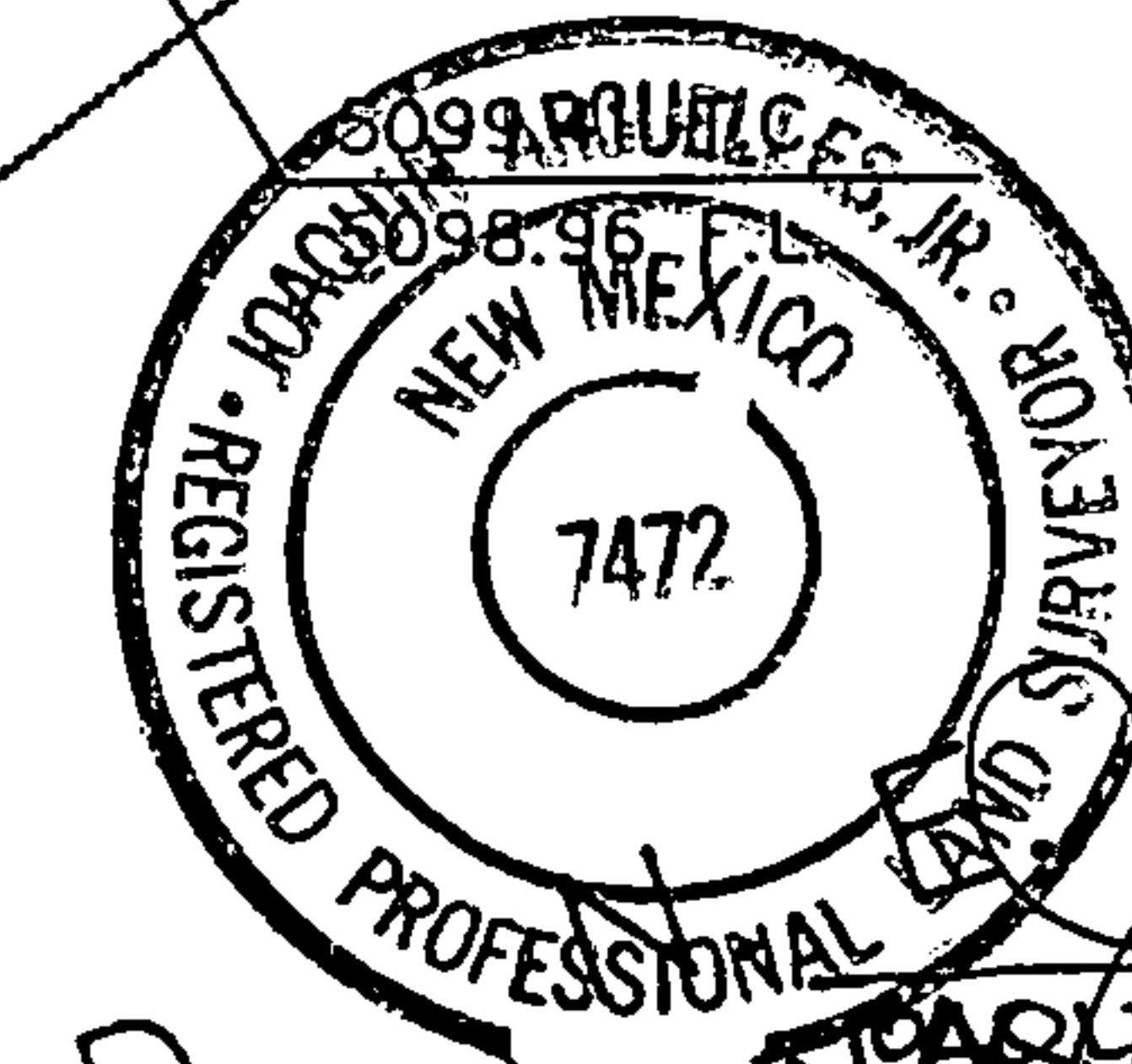

*Joaquin Arcevelles Jr.*  
JOAQUIN ARCEVELLES JR. LS 7472  
ARCEVELLES SURVEYING  
2912 SAN YANACIO BLVD

ROAD

EXISTING ADA CUT

N 00°30'00" E

N 72°46'00" E

OUTLET F.L. 98.00

5099.03 T.C.  
5098.39 F.L.

5098.60 T.C.

-BUILT

A S  
CO  
(



# City of Albuquerque

P.O. BOX 1293 ALBUQUERQUE, NEW MEXICO 87103

December 8, 1997

Richard Hall  
Hall Engineering  
1116 2nd Street NW  
Albuquerque, New Mexico 87102

RE: ENGINEER CERTIFICATION FOR SOUTHWEST SEAL & SUPPLY (H16-D123)  
CERTIFICATION STATEMENT DATED 11/25/97

Dear Mr. Hall:

Based on the information provided on your November 26, 1997 submittal, Engineer Certification for the above referenced site is acceptable.

If I can be of further assistance, please feel free to contact me at 924-3986.

C: Andrew Garcia

File

Sincerely

Bernie J. Montoya CE  
Associate Engineer

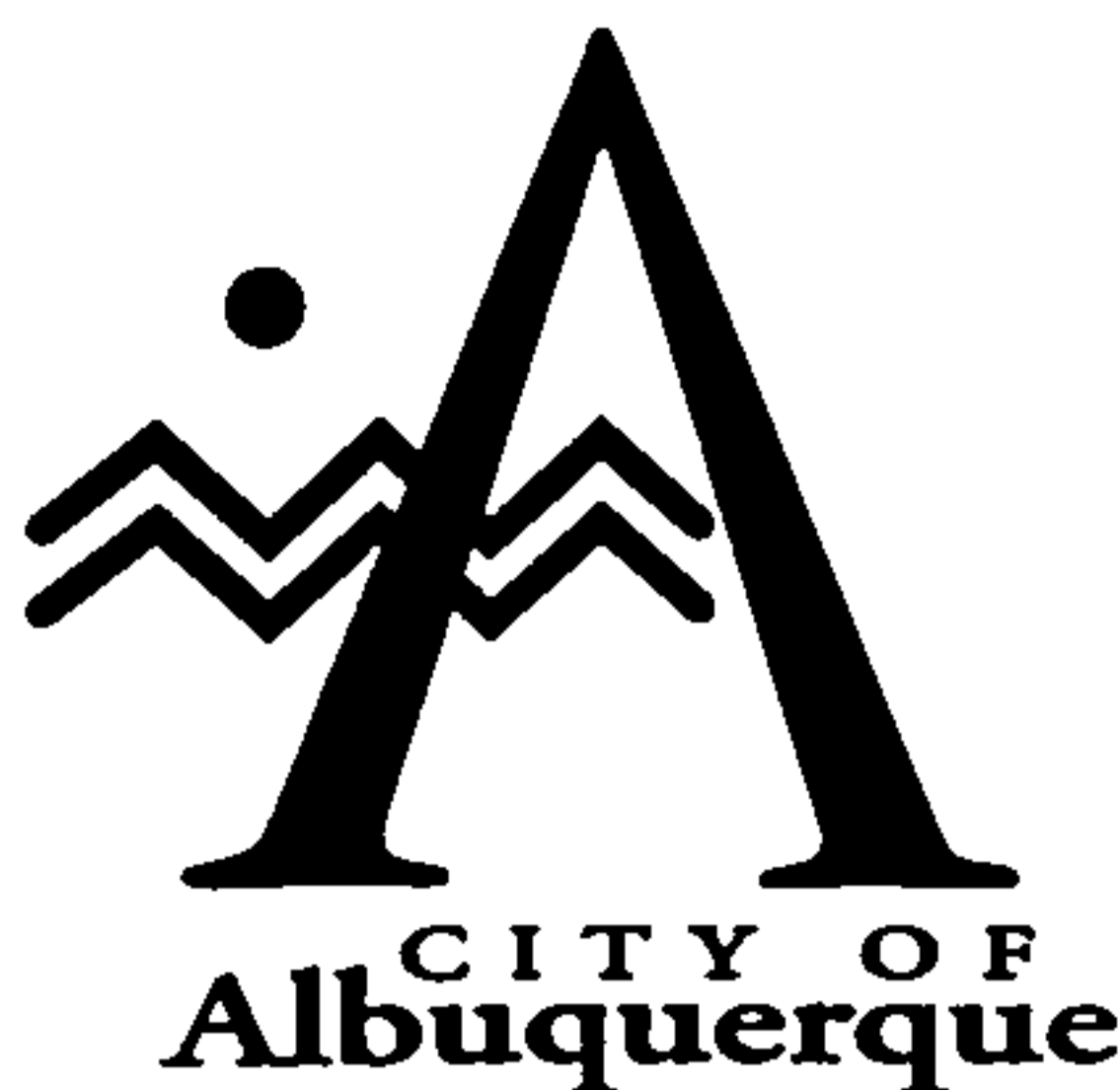

December 18, 1996

Martin J. Chávez, Mayor

Richard Hall  
Hall Engineering  
6840 2nd Street NW  
Albuquerque, NM 87107

**RE: REVISED DRAINAGE PLAN FOR SOUTHWEST SEALS (H16-D123)  
REVISION DATED 11/13/96.**

Dear Mr. Hall:

Based on the information provided on your December 11, 1996 resubmittal, the above referenced site is approved for Building Permit.

Please attach a copy of this approved plan to the construction sets prior to sign-off by Hydrology,

A separate permit is required for construction within City Right-of-Way. A copy of this approval letter must be on hand when applying for the excavation permit.

Prior to Certificate of Occupancy release, Engineer Certification per the D.P.M. guidelines will be required.

If I can be of further assistance, please feel free to contact me at 768-2667.

Sincerely,  
  
Bernie J. Montoya, CE  
Engineering Associate

BJM/dl

c: Andrew Garcia  
Arlene Portillo  
File

Good for You, Albuquerque!



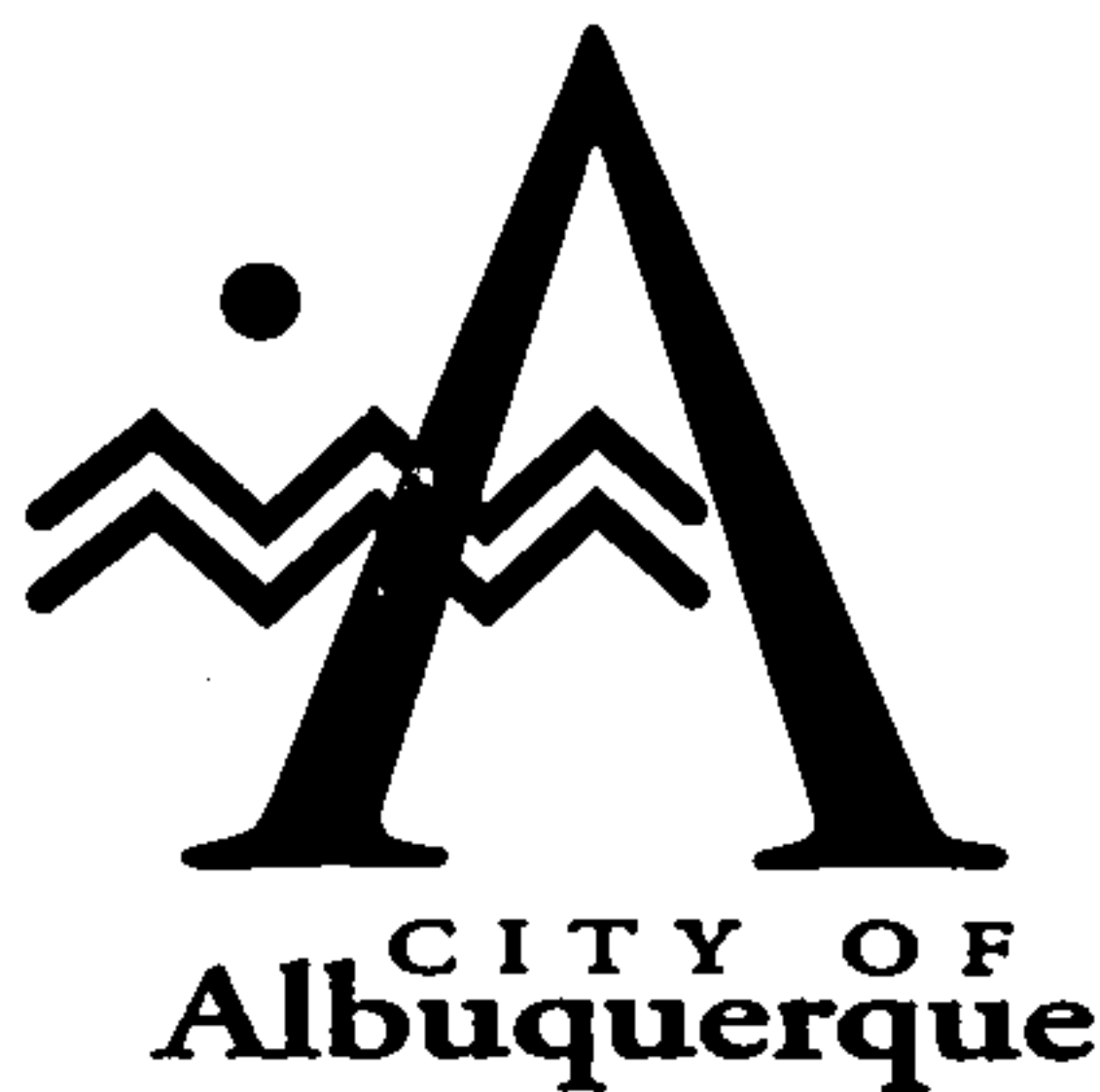

November 20, 1996

Martin J. Chávez, Mayor

Richard Hall  
Hall Engineering  
6840 2nd Street NW  
Albuquerque, NM 87107

**RE: REVISED DRAINAGE PLAN FOR SOUTHWEST SEALS (H16-D123)  
REVISION DATED 11/13/96.**

Dear Mr. Hall:

Based on the information provided on your November 14, 1996 resubmittal, listed are some concerns that will need to be addressed prior to final approval:

- ✓ 1. Sign-off block must have Hydrology instead of traffic. Two copies of plan with resubmittal.
- ✓ 2. Free discharge justification is not adequate. You must identify what systems are in the vicinity of the site and where the run-off will out fall.
3. Recommend that all the roof area be guttered to exit onto the asphalt areas. Your concept is very difficult to build and maintain once you route the developed run-off to the asphalt areas, you can work on setting it out to the street via sidewalk culverts.

If I can be of further assistance, please feel free to contact me at 768-2667.

Sincerely,

Bernie J. Montoya, CE  
Engineering Associate

BJM/dl

c: Andrew Garcia

File



CITY OF ALBUQUERQUE  
PUBLIC WORKS DEPARTMENT  
UTILITY DEVELOPMENT DIVISION/HYDROLOGY SECTION

PRE-DESIGN CONFERENCE

DRAINAGE FILE/ZONE ATLAS PAGE NO.: H-16 DATE: 10-22-96

EPC NO.: \_\_\_\_\_ DRB NO.: \_\_\_\_\_ ZONE: \_\_\_\_\_

SUBJECT: \_\_\_\_\_

STREET ADDRESS: Candelaria & Vassar

LEGAL DESCRIPTION: Tract K & Parcel 10

APPROVAL REQUESTED:  PRELIMINARY PLAT  FINAL PLAT  
 SITE DEVELOPMENT PLAN  BUILDING PERMIT  
 GRADING/PAVING PERMIT  OTHER

ATTENDANCE: <sup>WHO</sup> John P. Curtin <sup>REPRESENTING</sup> C.O.A./P.W.D./Hyd  
Mike Martinez Hall Engineering

FINDINGS:  
FIRM Panel 351 indicates that the site is located in Zone X outside the 500 year flood plain.

Identify any off-site flows.

Downstream path appears to drain west on to Candelaria the south on ~~Claremont~~ Princeton then into inlets at Claremont.

Verify Downstream Capacity. AMD5 AP 101 indicates  $Q_{100} = 94 \text{ cfs}$  & Capacity =  $99 \text{ cfs}$  on Princeton at Candelaria. (Page 1C-2). This is an infill site in a developed neighborhood. Check that immediate area is not adversely effected.

The undersigned agrees that the above findings are summarized accurately and are only subject to change if further investigation reveals that they are not reasonable or that they are based on inaccurate information.

SIGNED: John P. Curtin  
TITLE: CE/Hydrology  
DATE: 10-22-96

SIGNED: [Signature]  
TITLE: E.I.T./Hall Engineering Division  
DATE: 10-22-96

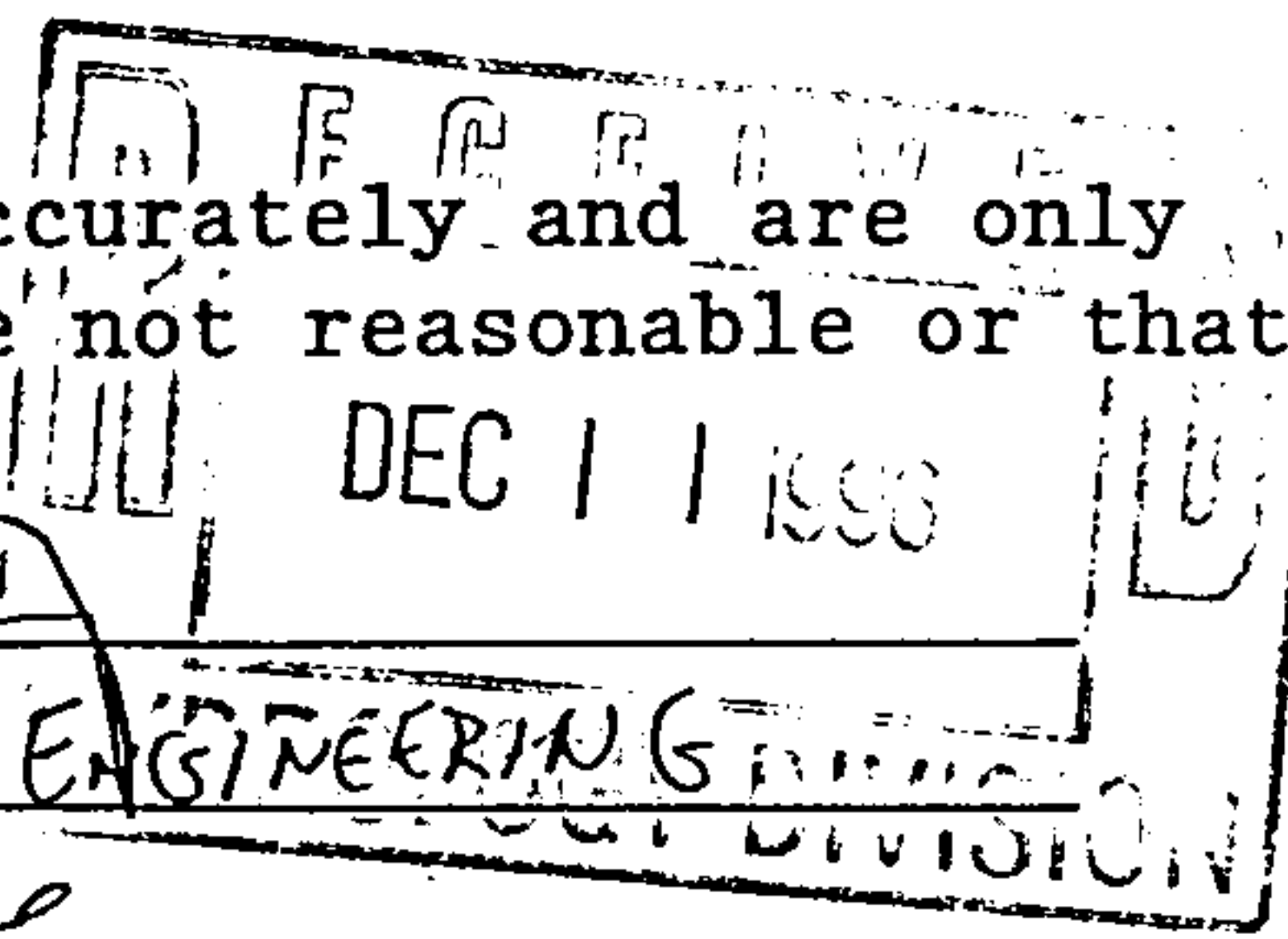

\*\*NOTE\*\* PLEASE PROVIDE A COPY OF THIS PRE-DESIGN FORM WITH THE DRAINAGE SUBMITTAL.

DRAINAGE INFORMATION SHEET

PROJECT TITLE: SOUTHWEST SEALS ZONE ATLAS/DRNG. FILE #: 416-D173  
 LEGAL DESCRIPTION: WESTERLY PORTION OF TRACT "K" AND PARCEL No. 10 OF COLES INDUSTRIAL SUBDIVISION No. 2  
 CITY ADDRESS: CAUDELARIA E VASSAR  
 ENGINEERING FIRM: HALL ENGINEERING CONTACT: MICHAEL MARTINEZ  
 ADDRESS: 6840 SECOND ST. N.W. PHONE: 345-1064  
 OWNER: \_\_\_\_\_ CONTACT: \_\_\_\_\_  
 ADDRESS: \_\_\_\_\_ PHONE: \_\_\_\_\_  
 ARCHITECT: \_\_\_\_\_ CONTACT: \_\_\_\_\_  
 ADDRESS: \_\_\_\_\_ PHONE: \_\_\_\_\_  
 SURVEYOR: HALL ENGINEERING CONTACT: RICHARD HALL  
 ADDRESS: 6840 SECOND ST. N.W. PHONE: 345-1064  
 CONTRACTOR: SADLER SOUTHWEST CONTACT: LOW SADLER  
 ADDRESS: P.O. Box 21640 PHONE: 856-7939

PRE-DESIGN MEETING:

YES  
 NO  
 COPY OF CONFERENCE RECAP SHEET PROVIDED

DRB NO. \_\_\_\_\_  
 EPC NO. \_\_\_\_\_  
 PROJ. NO. \_\_\_\_\_

TYPE OF SUBMITTAL:

DRAINAGE REPORT  
 DRAINAGE PLAN  
 CONCEPTUAL GRADING & DRAINAGE PLAN  
 GRADING PLAN  
 EROSION CONTROL PLAN  
 ENGINEER'S CERTIFICATION

CHECK TYPE OF APPROVAL SOUGHT:

SKETCH PLAT APPROVAL  
 PRELIMINARY PLAT APPROVAL  
 SITE DEVELOPMENT PLAN APPROVAL  
 FINAL PLAT APPROVAL  
 BUILDING PERMIT APPROVAL  
 FOUNDATION PERMIT APPROVAL  
 CERTIFICATE OF OCCUPANCY APPROVAL  
 ROUGH GRADING PERMIT APPROVAL  
 GRADING/PAVING PERMIT APPROVAL  
 OTHER 50-19 (SPECIFY)

DATE SUBMITTED: 12-9-96  
 BY: MICHAEL MARTINEZ

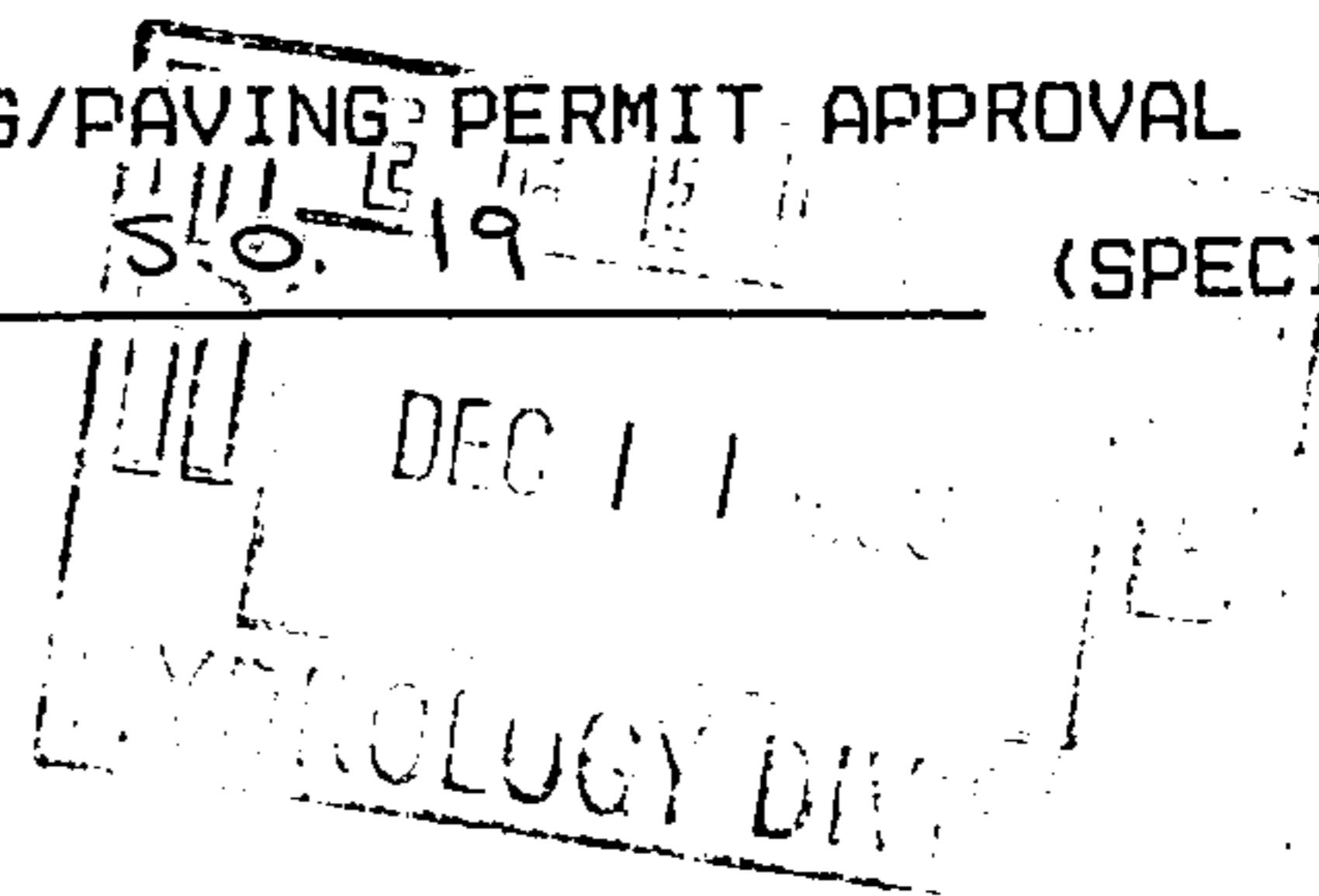

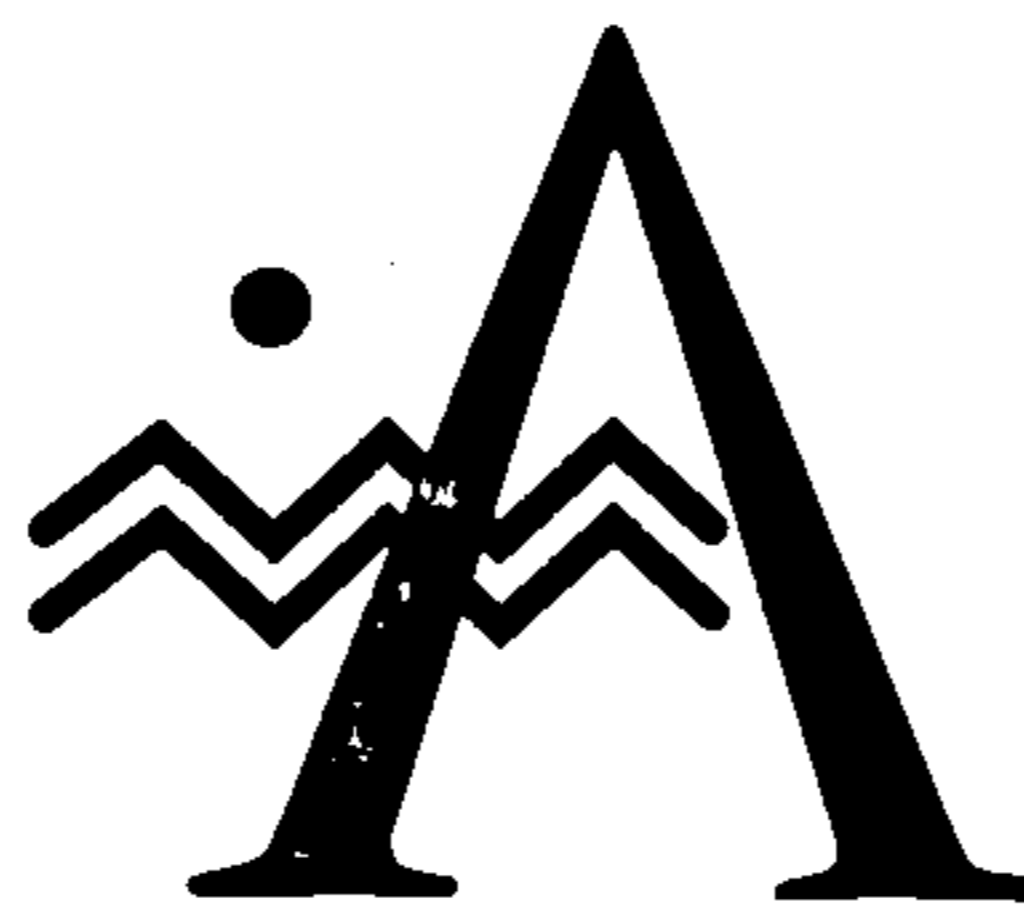

CITY OF  
Albuquerque  
November 5, 1996

Martin J. Chávez, Mayor

Mike Martinez  
Hall Engineering  
6840 2nd Street NW  
Albuquerque, NM 87107

**RE: SOUTHWEST SEALS (H16-D123). GRADING AND DRAINAGE PLAN FOR BUILDING PERMIT APPROVAL. ENGINEER'S STAMP DATED 10-30-96.**

Dear Mr. Martinez:

Based on the information provided on your October 31, 1996 submittal, City Hydrology has the following comments:

1. Please provide a copy of the pre-design form with your submittal.
2. Justify free discharge from this site.
3. Please call out the sidewalk culvert along Candelaria Road.
4. An SO #19 requires the six standard notes found in the DPM section 22.7, page 116. Provide two copies of the plan sheet for SO #19 Permit approval. Also, indicate on the Drainage Information sheet that you are seeking SO #19 Permit approval.
4. All drives require a 1-foot water block. Please provide adequate grades at the drive along Vassar Drive to exhibit the 1-foot water block requirement.

If I can be of further assistance, please feel free to contact me at 768-3622.

Sincerely,

Lisa Ann Manwill  
Engineering Assoc./Hyd.

c: Andrew Garcia  
File

Good for You, Albuquerque!



CITY OF ALBUQUERQUE  
PUBLIC WORKS DEPARTMENT  
UTILITY DEVELOPMENT DIVISION/HYDROLOGY SECTION

PRE-DESIGN CONFERENCE

DRAINAGE FILE/ZONE ATLAS PAGE NO.: H-16 DATE: 10-22-96

EPC NO.: \_\_\_\_\_ DRB NO.: \_\_\_\_\_ ZONE: \_\_\_\_\_

SUBJECT: \_\_\_\_\_

STREET ADDRESS: Candelaria & Vassar

LEGAL DESCRIPTION: Tract K & Parcel 10

APPROVAL REQUESTED:  PRELIMINARY PLAT  FINAL PLAT  
 SITE DEVELOPMENT PLAN  BUILDING PERMIT  
 GRADING/PAVING PERMIT  OTHER

ATTENDANCE: <sup>WHO</sup> John P. Curtin <sup>REPRESENTING</sup> C.O.A./P.W.D./Hyd  
Mike Martinez Hall Engineering

FINDINGS:  
FIRM Panel 351 indicates that the site is located in Zone X outside the 500 year flood plain.

Identify any off-site flows.

Downstream path appears to drain we. on to Candelaria the south on ~~Claremont~~ Princeton then into inlets at Claremont.

Verify Downstream Capacity. AMDS AP 101 indicates  $Q_{100} = 94 \text{ cfs}$  & Capacity =  $99 \text{ cfs}$  @ on Princeton at Candelaria. (Page 1C-2). This is an infill site in a developed neighborhood. Check that immediate area is not adversely effected.

The undersigned agrees that the above findings are summarized accurately and are only subject to change if further investigation reveals that they are not reasonable or that they are based on inaccurate information.

SIGNED: John P. Curtin SIGNED: [Signature]  
TITLE: CE/Hydrology TITLE: E.I./Hall Engineering  
DATE: 10-22-96 DATE: 10-22-96

NOV 14 1996

\*\*NOTE\*\* PLEASE PROVIDE A COPY OF THIS PRE-DESIGN FORM WITH THE DRAINAGE SUBMITTAL.



DRAINAGE INFORMATION SHEET

PROJECT TITLE: SOUTHWEST SEALS ZONE ATLAS/DRNG. FILE #: H-16-D123

LEGAL DESCRIPTION: WESTERLY PORTION OF TRACT "K" AND PARCEL No. 10 OF COLE'S INDUSTRIAL

CITY ADDRESS: INTERSECTION OF CAUDELAIRIA & VASSAR

ENGINEERING FIRM: HALL ENGINEERING CONTACT: MICHAEL MARTINEZ

ADDRESS: 6840 2ND ST. N.W. PHONE: 345-1064

OWNER: \_\_\_\_\_ CONTACT: \_\_\_\_\_

ADDRESS: \_\_\_\_\_ PHONE: \_\_\_\_\_

ARCHITECT: SADLER SOUTHWEST CONTACT: LOU SADLER

ADDRESS: P.O. Box 21640 PHONE: 856-7939

SURVEYOR: LAND LINKS COMPANY CONTACT: DAVID KING

ADDRESS: 8415 WASHINGTON P.E. SUITE B1 PHONE: 856-9899

CONTRACTOR: SADLER SOUTHWEST CONTACT: LOU SADLER

ADDRESS: P.O. Box 21640 PHONE: 856-7939

PRE-DESIGN MEETING:

YES

NO

COPY OF CONFERENCE RECAP SHEET PROVIDED

DRB NO. \_\_\_\_\_

EPC NO. \_\_\_\_\_

PROJ. NO. \_\_\_\_\_

TYPE OF SUBMITTAL:

DRAINAGE REPORT

DRAINAGE PLAN

CONCEPTUAL GRADING & DRAINAGE PLAN

GRADING PLAN

EROSION CONTROL PLAN

ENGINEER'S CERTIFICATION

CHECK TYPE OF APPROVAL SOUGHT:

SKETCH PLAT APPROVAL

PRELIMINARY PLAT APPROVAL

SITE DEVELOPMENT PLAN APPROVAL

FINAL PLAT APPROVAL

BUILDING PERMIT APPROVAL

FOUNDATION PERMIT APPROVAL

CERTIFICATE OF OCCUPANCY APPROVAL

ROUGH GRADING PERMIT APPROVAL

GRADING/PAVING PERMIT APPROVAL

OTHER S.O.M.A.S.G.E. (SPECIFY)

DATE SUBMITTED: 11-11-96

BY: MICHAEL MARTINEZ

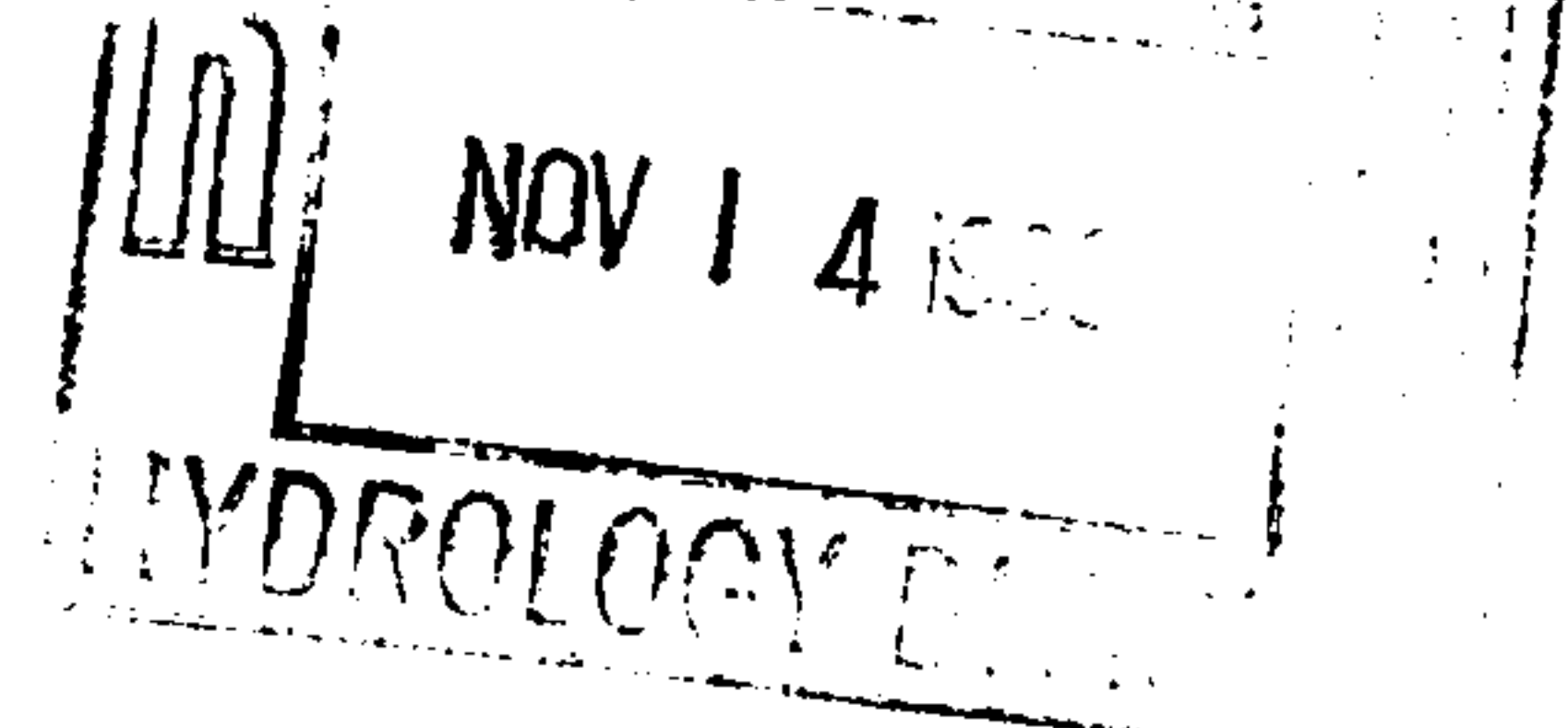

DRAINAGE INFORMATION SHEET

PROJECT TITLE: SOUTHWEST SEALS ZONE ATLAS/DRNG. FILE #: H-116 / 10/123  
LEGAL DESCRIPTION: WESTERLY PORTION OF TRACT "K" AND PARCEL No. 10 OF COLE'S INDUSTRIAL  
CITY ADDRESS: INTERSECTION OF CAWDELARIA E. VASSAR (N.E. CORNER) SUBDIVISION No. 2

ENGINEERING FIRM: HALL ENGINEERING CONTACT: MIKE MARTINEZ  
ADDRESS: 6840 2ND ST. N.W. PHONE: 345-1064

OWNER: \_\_\_\_\_ CONTACT: \_\_\_\_\_  
ADDRESS: \_\_\_\_\_ PHONE: \_\_\_\_\_

ARCHITECT: MASTERWORKS ARCHITECTS INC. CONTACT: \_\_\_\_\_  
ADDRESS: 5116 ELEVENTH ST. N.W. PHONE: 242-1866

SURVEYOR: LAND LINKS COMPANY LTD. CONTACT: DAVID M. KING  
ADDRESS: 8415 WASHINGTON PLACE N.E. SUITE <sup>B1</sup> PHONE: 856-9899

CONTRACTOR: SADLER SOUTHWEST CONTACT: LOU SADLER  
ADDRESS: P.O. BOX 21640 PHONE: 856-7939

PRE-DESIGN MEETING:

YES

NO

COPY OF CONFERENCE RECAP SHEET PROVIDED

DRB NO. \_\_\_\_\_

EPC NO. \_\_\_\_\_

PROJ. NO. \_\_\_\_\_

TYPE OF SUBMITTAL:

DRAINAGE REPORT

DRAINAGE PLAN

CONCEPTUAL GRADING & DRAINAGE PLAN

GRADING PLAN

EROSION CONTROL PLAN

ENGINEER'S CERTIFICATION

CHECK TYPE OF APPROVAL SOUGHT:

SKETCH PLAT APPROVAL

PRELIMINARY PLAT APPROVAL

SITE DEVELOPMENT PLAN APPROVAL

FINAL PLAT APPROVAL

BUILDING PERMIT APPROVAL

FOUNDATION PERMIT APPROVAL

CERTIFICATE OF OCCUPANCY APPROVAL

ROUGH GRADING PERMIT APPROVAL

GRADING/PAVING PERMIT APPROVAL

OTHER \_\_\_\_\_ (SPECIFY)

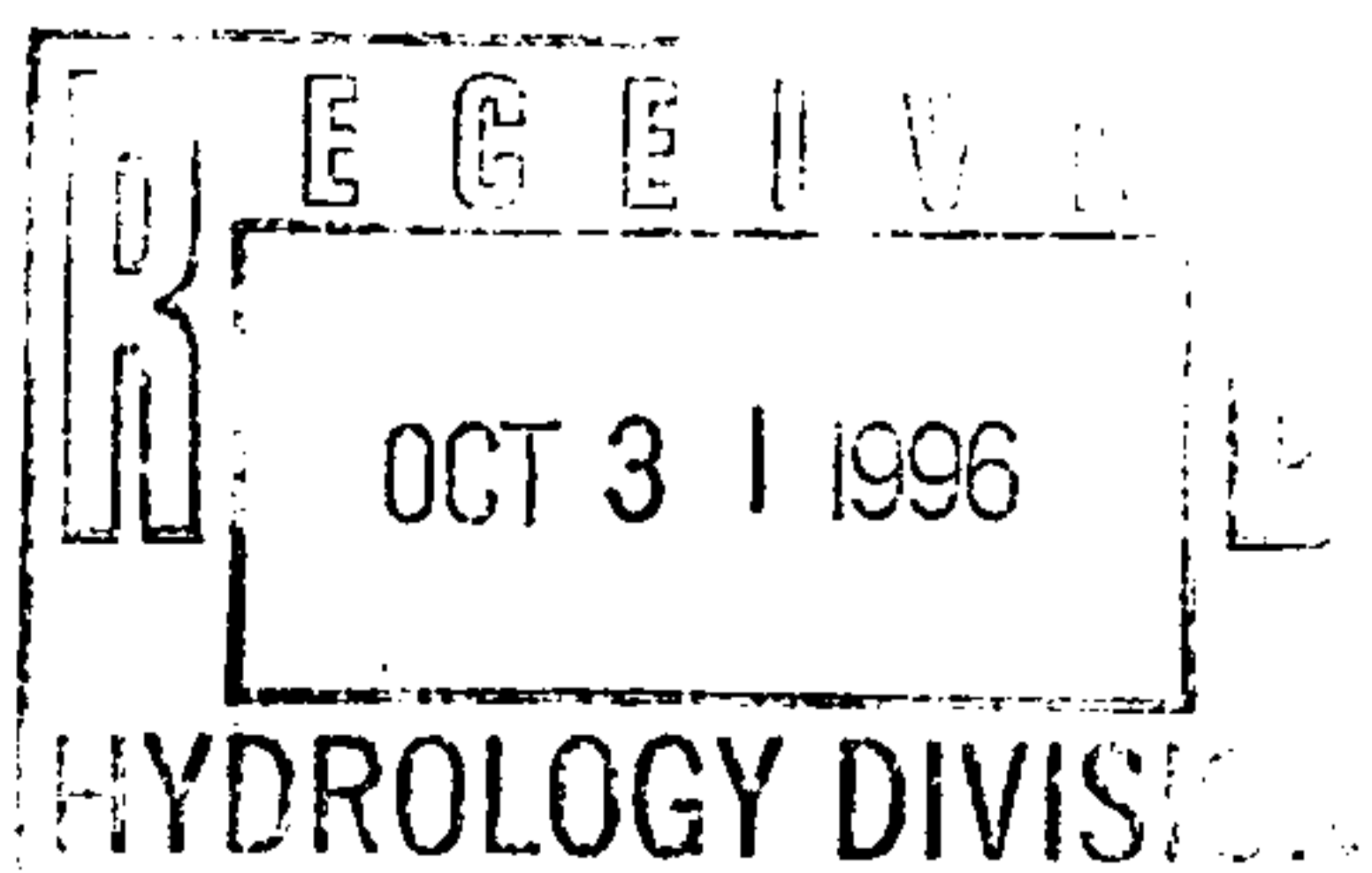

DATE SUBMITTED: 10-30-96

BY: MIKE MARTINEZ