



CITY OF ALBUQUERQUE
MUNICIPAL DEVELOPMENT DEPARTMENT
ENGINEERING DIVISION



HYDROLOGY SECTION PROJ. NO. H17-D DATE: 9/01/83

PLANNING DIVISION NO. _____

CONFERENCE RECAP

SUBJECT: Manant Commercial Center Portion Lot 1 Bk 1
Vidas Subdiv.

WHO

REPRESENTING

ATTENDANCE:

John Armstrong
Joe Pino
Harry Garner

City

FINDINGS:

1. Drainage Plan Appropriate
2. Free Discharge to storm drain in manant or
Prospect.

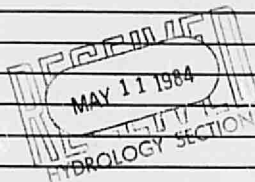

The undersigned agrees that the above findings are summarized accurately and are only subject to change if further investigation reveals that they are not reasonable or that they are based on inaccurate information.

SIGNED:

SIGNED:

TITLE:

TITLE:

DATE:

DATE:

John Armstrong
Hydrology
9/01/83

[Signature]
[Signature]
9/01/83

INFORMATION SHEET

PROJECT TITLE Commercial Center for Elmer Sprout TYPE OF SUBMITTAL _____
 ZONE ATLAS PAGE NO. H-17 - 85 CITY ADDRESS 5000 Menaul N.E.
 LEGAL DESCRIPTION Tract A, Block 1, Vidas Subdivision
 ENGINEERING FIRM J.E. Pino, Consulting Engineer CONTACT Joe Pino
 ADDRESS 8912 Las Camas Rd. N.E. PHONE 292-3721
 OWNER Sproul Enterprises CONTACT Elmer Sproul
 ADDRESS 309 Arno N.E. PHONE 247-6900
 ARCHITECT Garner/Hicks Architects CONTACT Harry Garner
 ADDRESS 112 Second Street S.W. PHONE 243-7492
 SURVEYOR Hall Surveying Co. CONTACT Verlon Hall
 ADDRESS 2625 Pennsylvania N.E. Suite 350 PHONE 884-6200
 CONTRACTOR _____ CONTACT _____
 ADDRESS _____ PHONE _____

PRE-DESIGN MEETING:

☒ YES
☐ NO
☒ COPY OF CONFERENCE RECAP SHEET PROVIDED

PLEASE CHECK TYPE OF APPROVAL EXPECTED WITH THIS SUBMITTAL:

☐ SKETCH PLAT APPROVAL
☐ PRELIMINARY PLAT APPROVAL
☒ SITE DEVELOPMENT PLAN APPROVAL
☐ FINAL PLAT APPROVAL
☒ BUILDING PERMIT APPROVAL
☐ CERTIFICATE OF OCCUPANCY APPROVAL
☐ ROUGH GRADING PERMIT APPROVAL
☐ GRADING/PAVING PERMIT APPROVAL
☐ OTHER _____ (SPECIFY)

DATE SUBMITTED: May 11, 1984

BY: Garner/Hicks Architects



W



City of Albuquerque

P.O. BOX 1293 ALBUQUERQUE, NEW MEXICO 87103

DESIGN HYDROLOGY SECTION
123 Central NW, Albuquerque, NM 87102
(505) 766-7644

June 10, 1984

Mr. Joe Pino
Consulting Engineer
8912 Las Camas Rd. NE

RE: GRADING & DRAINAGE PLAN FOR COMMERCIAL CENTER FOR
ELMER SPROUL (H17-D25) RECEIVED MAY 11, 1984.

Dear Joe,

Please refer to the DPM checklist for requirements regarding the plan to be submitted. This plan is currently incomplete for approval.

Also, please provide the hydraulic calculation for the design of the proposed stormsewer system.

Should you have any questions or comments, please contact me at 766-7644.

Yours truly,

Billy J. Goolsby, PE
City/County Flood Plain Admin.

BJG/cl

MUNICIPAL DEVELOPMENT DEPARTMENT

City Engineer, 4, PE, City Engineer

ENGINEERING DIVISION

Telephone (505) 765-7457

AN EQUAL OPPORTUNITY EMPLOYER

INFORMATION SHEET

PROJECT TITLE COMMERCIAL CENTER FOR ELMER TYPE OF SUBMITTAL DRAINAGE
SPROUL D25
 ZONE ATLAS PAGE NO. 417 CITY ADDRESS 5000 MENAUL N.E.
 LEGAL DESCRIPTION TRACT A BLOCK 1 VIDAS SUBDIVISION
 ENGINEERING FIRM J.E. PINO, CONSULT. ENR CONTACT JOE PINO
 ADDRESS 8912 LAS CAMAS Pk. N.E. PHONE 292-3721
 OWNER SPROUL ENTERPRISES CONTACT ELMER SPROUL
 ADDRESS 309 ALNO N.E. PHONE 247-9900
 ARCHITECT GARNER/HICKS ARCHT CONTACT HALLY GARNER
 ADDRESS 112 SECOND ST. S.W. PHONE 243-7492
 SURVEYOR HALL SURVEYING CO. CONTACT VERLON HALL
 ADDRESS 2625 PENNSYLVANIA ^{SUITE 350} PHONE 829-6200
 CONTRACTOR _____ CONTACT _____
 ADDRESS _____ PHONE _____

PRE-DESIGN MEETING:

☒ YES
☐ NO
☐ COPY OF CONFERENCE RECAP SHEET PROVIDED

PLEASE CHECK TYPE OF APPROVAL EXPECTED WITH THIS SUBMITTAL:

☐ SKETCH PLAT APPROVAL
☐ PRELIMINARY PLAT APPROVAL
☒ SITE DEVELOPMENT PLAN APPROVAL
☐ FINAL PLAT APPROVAL
☒ BUILDING PERMIT APPROVAL
☐ CERTIFICATE OF OCCUPANCY APPROVAL
☐ ROUGH GRADING PERMIT APPROVAL
☐ GRADING/PAVING PERMIT APPROVAL
☐ OTHER _____ (SPECIFY)

DATE SUBMITTED: 6/29/84

BY: GARNER/HICKS ARCH.

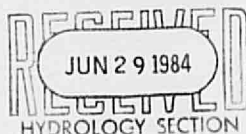



City of Albuquerque

P.O. BOX 1293 ALBUQUERQUE, NEW MEXICO 87103

DESIGN HYDROLOGY SECTION
123 Central NW, Albuquerque, NM 87102
(505) 766-7644

July 24, 1984

Mr. Joe Pino
8912 La Camas Road NE
Albuquerque, NM 87111

REF: REVISED GRADING AND DRAINAGE PLAN FOR COMMERCIAL CENTER @ 5000
MENAU NE (H17-D25) RECEIVED JUNE 29, 1984

Dear Joe:

The above referenced plan, dated June 29, 1984, is approved.

Please attach a copy of this approved plan along with the appropriately approved "Drainage Facilities Within City Right-of-Way" document to the construction set prior to release of the building permit.

If I can be of further assistance, please contact me at 766-7644.

Yours truly,

Billy J. Goolsby, PE
City/County Flood Plain Admin.

BJG:mrk

cc: Greg Olson

MUNICIPAL DEVELOPMENT DEPARTMENT

C. Duane Sheppard, P.E., City Engineer

ENGINEERING DIVISION

Telephone (505) 766-7467

AN EQUAL OPPORTUNITY EMPLOYER

CITY OF ALBUQUERQUE

DRAINAGE FACILITIES WITHIN CITY RIGHT-OF-WAY

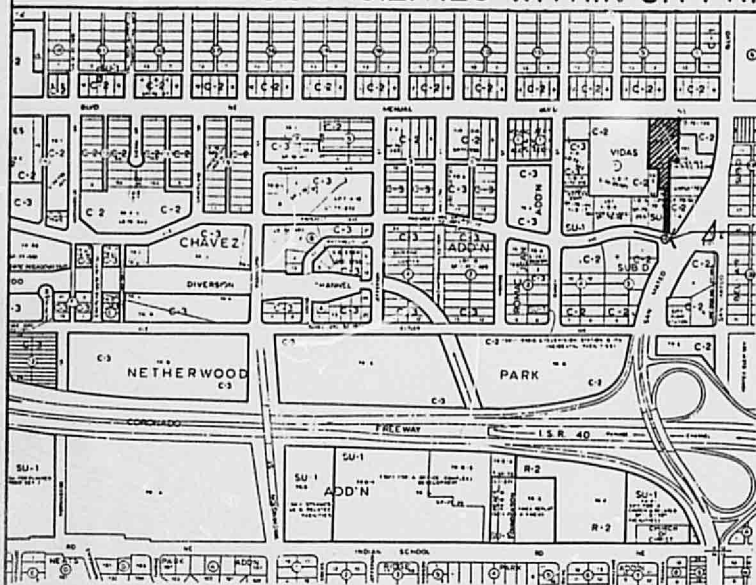

LOCATION MAP

PROJECT LOCATION

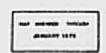
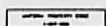

H-17-Z

LEGAL DESCRIPTION: TRACT A, BLOCK 1, VIDAS SUBDIVISION

ADDRESS: 5000 MENAUL N.E.



NOTICE TO CONTRACTOR

An excavation/construction permit will be required before beginning any work within City right-of-way. An approved copy of these plans must be submitted at the time of application for this permit.

2. All work detailed on these plans to be performed, except as otherwise stated or provided hereon, shall be constructed in accordance with Public Works Contract #84-2.
3. Two working days prior to any excavation, contractor must contact Line Locating Service, 765-1234, for location of existing utilities.
4. Prior to construction, the Contractor shall excavate and verify the horizontal and vertical locations of all obstructions. Should a conflict exist, the contractor shall notify the engineer so that the conflict can be resolved with a minimum amount of delay.
5. Backfill compaction shall be according to Residential street use.

D-119

APPROVALS	NAME	DATE	TITLE:
A.C.E./DESIGN	<i>H. C. Lee</i>	8/20/89	COMMERCIAL CENTER FOR ELMER SPROUL 5000 MENAUL N.E.
INSPECTOR			
A.C.E./FIELD			PERMIT NO. SHEET 1 OF 3
			MAP NO. H-17

CITY OF ALBUQUERQUE

DRAINAGE FACILITIES WITHIN CITY RIGHT-OF-WAY

NOTE:

Bench Mark Location

N.M. Highway Commission Brass Cap
N.M.- 367-8

Located in medium of San Mateo,
22' North of Cutler

Elev. = 5204.26'

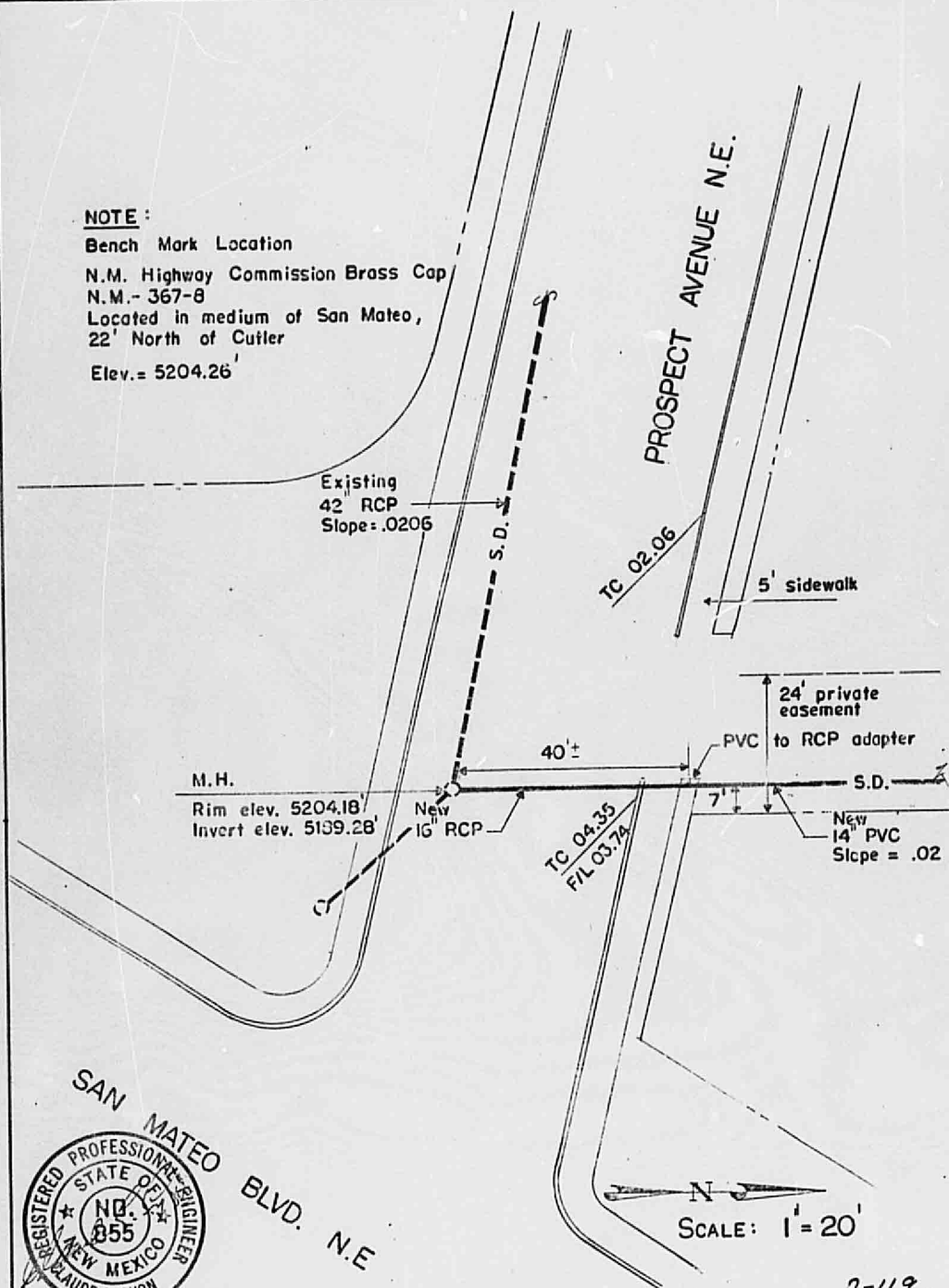

APPROVALS	NAME	DATE	TITLE:
A.C.E./DESIGN	<i>R. H. Olson</i>	8/20/84	COMMERCIAL CENTER FOR ELMER SPROUL 5000 MENAUL N.E.
INSPECTOR			PERMIT NO.
A.C.E./FIELD			SHEET 2 OF 3
			MAP NO. H-17

CITY OF ALBUQUERQUE

DRAINAGE FACILITIES WITHIN CITY RIGHT-OF-WAY

NOTE:

Break manhole to accommodate new pipe size.
Finish pipe and conc. patch flush w/inside face of M.H.

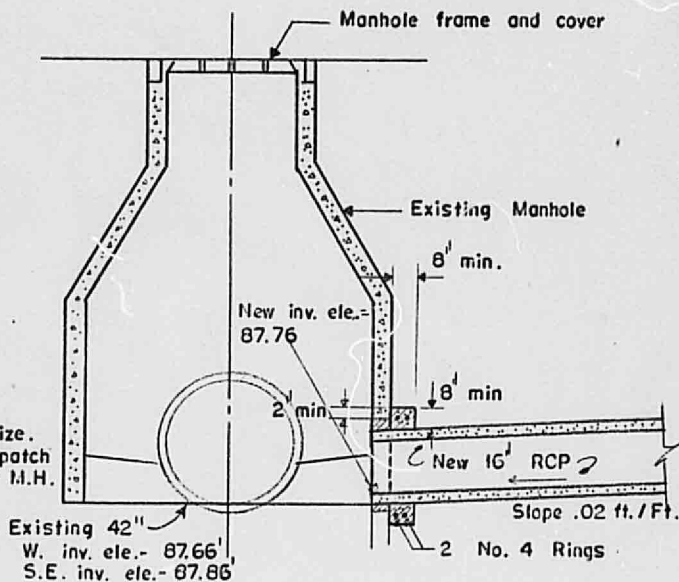

CONNECTION TO EXISTING MANHOLE

NO SCALE



D-119

APPROVALS	NAME	DATE	TITLE:	
A.C.E./DESIGN	<i>KL Olson</i>	8/20/84	COMMERCIAL CENTER FOR ELMER SPROUL 5000 MENAUL N.E.	
INSPECTOR				
A.C.E./FIELD			PERMIT NO. SHEET 3 OF 3	MAP NO. H-17