

CITY OF ALBUQUERQUE

Planning Department
Alan Varela, Director



Mayor Timothy M. Keller

February 5, 2024

John Stapleton, P.E.
Respec
5971 Jefferson St. NE
Albuquerque, NM 8710

**RE: American Home Furniture
Permanent C.O. – Accepted
Engineer's Certification Date: 01/31/24
Engineer's Stamp Date: 03/23/23
Hydrology File: H17D097C**

Dear Mr. Stapleton:

PO Box 1293
Albuquerque
NM 87103
Based on the Certification received 01/31/2024 and site visit on 02/02/2024, this letter serves as a "green tag" from Hydrology Section for a Permanent Certificate of Occupancy to be issued by the Building and Safety Division.

If you have any questions, please contact me at 924-3995 or rbrissette@cabq.gov.

Sincerely,

Renée C. Brissette, P.E. CFM
Senior Engineer, Hydrology
Planning Department

www.cabq.gov



City of Albuquerque

Planning Department
Development & Building Services Division

DRAINAGE AND TRANSPORTATION INFORMATION SHEET (DTIS)

Project Title: _____ Hydrology File # _____

Legal Description: _____

City Address, UPC, OR Parcel: _____

Applicant/Agent: _____ Contact: _____

Address: _____ Phone: _____

Email: _____

Applicant/Owner: _____ Contact: _____

Address: _____ Phone: _____

Email: _____

(Please note that a DFT SITE is one that needs Site Plan Approval & ADMIN SITE is one that does not need it.)

TYPE OF DEVELOPMENT: PLAT (#of lots) _____ RESIDENCE
DFT SITE ADMIN SITE

RE-SUBMITTAL: YES NO

DEPARTMENT: TRANSPORTATION HYDROLOGY/DRAINAGE

Check all that apply under Both the Type of Submittal and the Type of Approval Sought:

TYPE OF SUBMITTAL:

ENGINEER/ARCHITECT CERTIFICATION
PAD CERTIFICATION
CONCEPTUAL G&D PLAN
GRADING & DRAINAGE PLAN
DRAINAGE REPORT
DRAINAGE MASTER PLAN
CLOMR/LOMR
TRAFFIC CIRCULATION LAYOUT (TCL)
ADMINISTRATIVE
TRAFFIC CIRCULATION LAYOUT FOR DFT
APPROVAL
TRAFFIC IMPACT STUDY (TIS)
STREET LIGHT LAYOUT
OTHER (SPECIFY) _____

TYPE OF APPROVAL SOUGHT:

BUILDING PERMIT APPROVAL
CERTIFICATE OF OCCUPANCY
CONCEPTUAL TCL DFT APPROVAL
PRELIMINARY PLAT APPROVAL
FINAL PLAT APPROVAL
SITE PLAN FOR BLDG PERMIT DFT
APPROVAL
SIA/RELEASE OF FINANCIAL GUARANTEE
FOUNDATION PERMIT APPROVAL
GRADING PERMIT APPROVAL
SO-19 APPROVAL
PAVING PERMIT APPROVAL
GRADING PAD CERTIFICATION
WORK ORDER APPROVAL
CLOMR/LOMR
OTHER (SPECIFY) _____

DATE SUBMITTED: _____

GENERAL NOTE

THIS SUBMITTAL IS INTENDED TO UPDATE THE GRADING PLAN DATED 07/05/2021 WHICH WAS APPROVED BY THE ALBUQUERQUE HYDROLOGY SECTION ON 10/1/2021 (H17D097). THIS SHEET PROVIDES GRADING DETAILS SPECIFIC TO THE ADDITION OF A TRUCK DOCK AND EXTENSION OF THE BUILDING ON THE NORTH. THE DRAINAGE REMAINS CONSISTENT WITH THE PREVIOUS APPROVED DRAINAGE REPORT.



AS BUILT CERTIFICATION

I, STEVEN J. SANDOVAL, NEW MEXICO PROFESSIONAL SURVEYOR NO. 12351, DO HEREBY CERTIFY: THAT THIS AS BUILT SURVEY AND THE ACTUAL SURVEY ON THE GROUND UPON WHICH IT IS BASED WERE PERFORMED BY ME OR UNDER MY DIRECT SUPERVISION; THAT THIS SURVEY MEETS THE MINIMUM STANDARDS FOR SURVEYING IN NEW MEXICO, AND THAT IT IS TRUE AND CORRECT TO THE BEST OF MY KNOWLEDGE AND BELIEF.

January 30, 2024

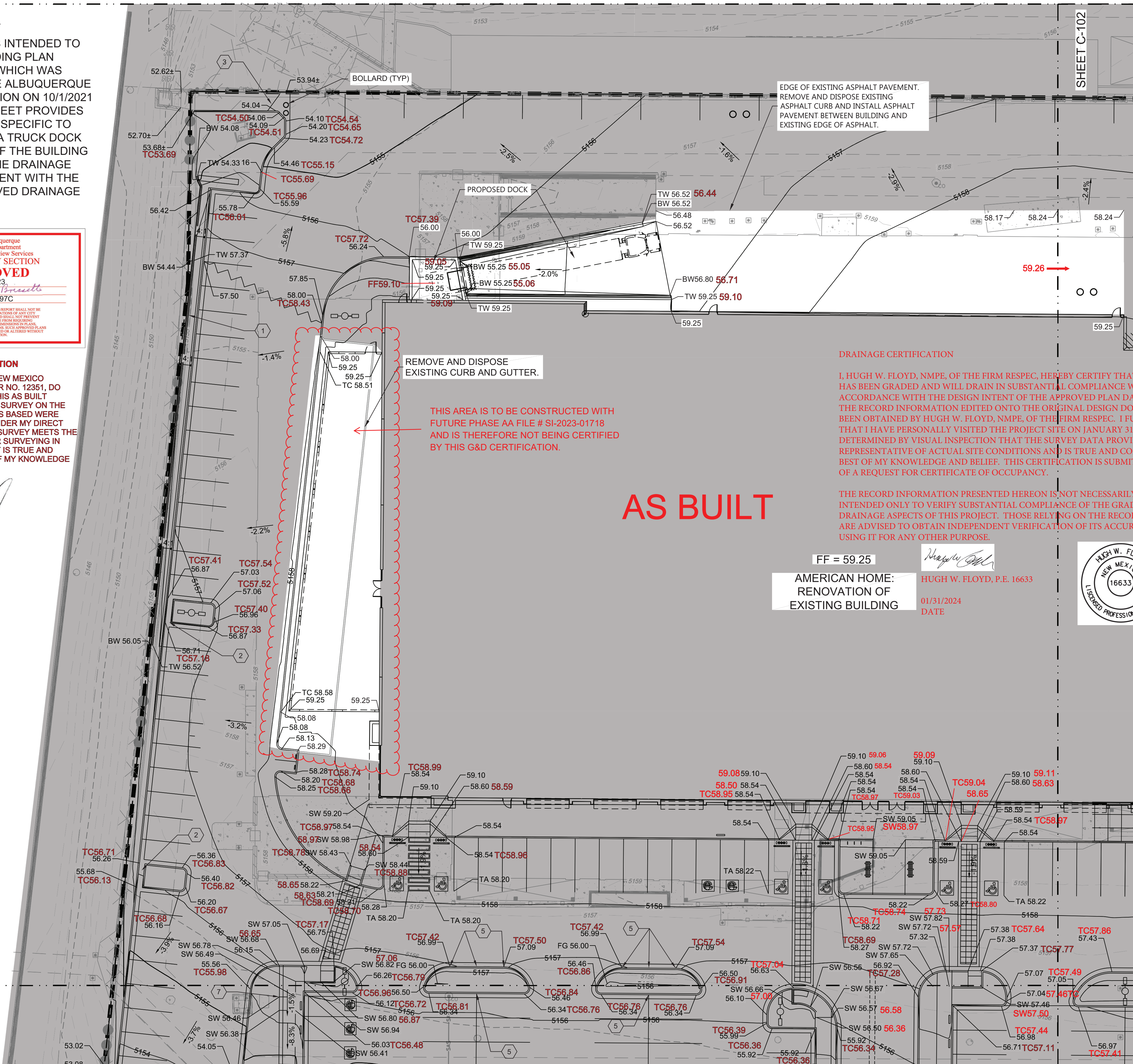

AS BUILT

FF = 59.25
AMERICAN HOME:
RENOVATION OF
EXISTING BUILDING

[Signature]
HUGH W. FLOYD, P.E. 16633
01/31/2024
DATE

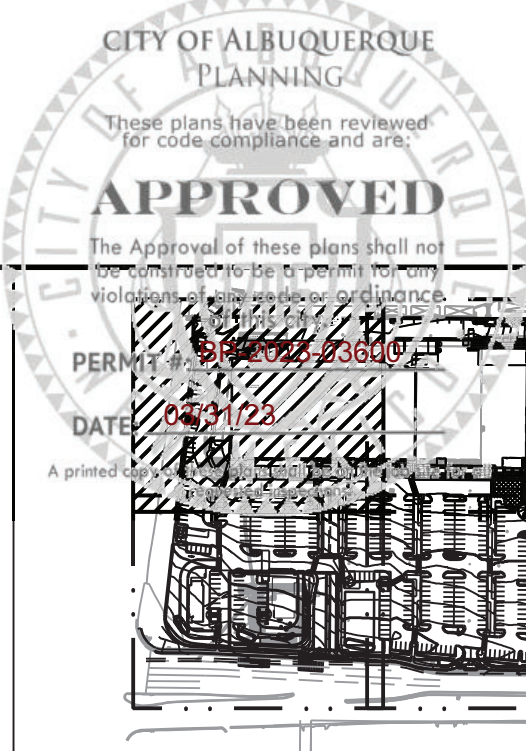

- NOTE:
- THE EXISTING PARKING LOT AND BUILDINGS WILL BE DEMOLISHED UNLESS OTHERWISE SPECIFIED ON THIS PLAN.
 - PROPOSED PUBLIC INFRASTRUCTURE WILL BE INCLUDED ON PUBLIC WORK ORDER.

KEYED NOTES

| I.D.# | DESCRIPTION |
|-------|--|
| 1 | INSTALL CMU RETAINING WALL. SEE DETAIL SHEET C-501. |
| 2 | INSTALL 2' CURB OPENING AND CHANNEL. SEE DETAIL SHEET C-500. |
| 3 | INSTALL CONCRETE DRAINAGE CHANNEL. SEE DETAIL SHEET C-501. |
| 5 | INSTALL 1' CURB OPENING. SEE DETAIL SHEET C-500. |
| 7 | INSTALL HANDRAIL FOR ADA RAMP BOTH SIDES OF RAMP. |

GRADING NOTES

- CONTRACTOR TO FIELD VERIFY LOCATION AND ELEVATION OF ALL EXISTING DRY AND WET UTILITIES PRIOR TO CONSTRUCTION AND NOTIFY ENGINEER OF ANY ISSUES. UTILITY RELOCATION MAY BE REQUIRED.
- FINISH GRADE OF SOIL EDGES ALONG PAVEMENT TO BE 1/2" BELOW EDGE OF PAVEMENT.
- STRIP AND STOCKPILE TOPSOIL FROM GRADING AREAS. USE STOCKPILED TOPSOIL AND IMPORTED TOPSOIL AS NECESSARY FOR SURFACE RESTORATION.
- GRADES SHOWN ARE FINAL SURFACE GRADES AFTER COMPLETION OF SURFACE IMPROVEMENTS AND PLACEMENT OF TOPSOIL.
- GRADE AREAS AT SITE PERIMETER TO MATCH GRADES OF ADJACENT PARCELS.
- REMOVE EXCESS SOIL FROM SITE AND DISPOSE OF PROPERLY IN ACCORDANCE WITH APPLICABLE REGULATIONS.
- PROVIDE TEMPORARY GRADING FEATURES SUCH AS BERMS, SWALES, SUMPS AND BASINS TO MANAGE INTERIM STORM WATER RUNOFF DURING CONSTRUCTION PROCESS. STORM WATER RUNOFF LEAVING THE SITE SHALL MEET ALL FEDERAL, STATE AND LOCAL QUALITY REQUIREMENTS.
- ALL DISTURBED AREAS TO BE RE-SEEDING PER LANDSCAPE PLAN PROVIDED BY OTHERS.
- REFER TO GEOTECHNICAL ENGINEERING SERVICES REPORT PRELIMINARY GEOTECHNICAL ENGINEERING REPORT BY TERRACON CONSULTANTS, INC. DATED FEBRUARY 4, 2021.

LEGEND

| | |
|------------------------|--------------|
| GRADING LIMITS | --- |
| MAJOR CONTOUR | --- 4985 --- |
| MINOR CONTOUR | --- 4985 --- |
| EXISTING MAJOR CONTOUR | --- 4985 --- |
| EXISTING MINOR CONTOUR | --- 4985 --- |
| SLOPE ARROW | 1.5% 5.2% |
| SWALE | --- |
| HIGH POINT | --- |
| MATCHLINE | --- |
| EXISTING DEVELOPMENT | --- |

SPOT ELEVATION SYMBOLS

- ALL SPOT ELEVATIONS ARE AT FLOWLINE UNLESS OTHERWISE NOTED IN THE PLANS.
- 20.00 FLOWLINE
 - 20.00± MATCH EX. GRADE ELEV. (APPROXIMATE)
 - BW 20.00 BOTTOM WALL
 - TW 20.00 TOP WALL
 - SW 20.00 SIDEWALK
 - FG 20.00 FINISHED GROUND
 - BS 20.00 BOTTOM STEP
 - TS 20.00 TOP STEP
 - TA 20.00 TOP ASPHALT

WALL SPOT GRADE LOCATIONS

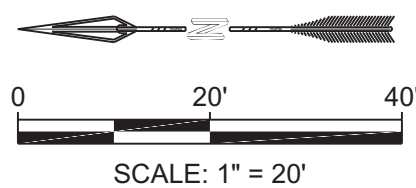

| | | | |
|---|-------------|---------------|-------------------|
| DESIGNED BE | DRAWN BE | CHECKED JS | DATE 3/23/2023 |
| RESPEC 5971 JEFFERSON STREET SUITE 101 ALBUQUERQUE, NM 87109 WWW.RESPEC.COM 505.293.9718 | | | |
| STAMP HUGH W. FLOYD NEW MEXICO 16633 LICENSED PROFESSIONAL ENGINEER 03/23/2023 THIS DRAWING IS INCOMPLETE AND NOT TO BE USED FOR CONSTRUCTION UNLESS IT IS STAMPED, SIGNED AND DATED | | | |
| PROJECT NAME: AMERICAN HOME FURNITURE | | | |
| SHEET TITLE: GRADING PLAN | | | |
| SUBMITTED FOR: CONSTRUCTION | | | |
| SHEET NUMBER: C-101 | | | |