

# CITY OF ALBUQUERQUE

Planning Department  
David S. Campbell, Director

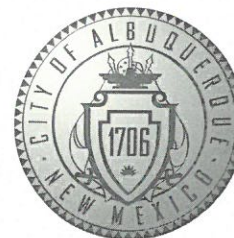

Timothy M. Keller, Mayor

March 29, 2019

Mark Goodwin, PE  
Mark Goodwin & Associates, PA.  
PO Box 90606  
Albuquerque, NM 87199

**Re: Shops @ the 24s**  
**2424 Louisiana Blvd NE – Accepted for Perm. C.O.**  
**Engineer's Stamp dated: 9/11/2018 (H19D001)**  
**Certification date 3/27/2019**

Dear Mr. Goodwin,

Based upon the information provided in the submittal received on 3/27/2019 the application is acceptable for release of Certificate of Occupancy.

PO Box 1293

If you have any questions, please contact me at 924-3986 or e-mail at [jhughes@cabq.gov](mailto:jhughes@cabq.gov).

Albuquerque

Sincerely,

NM 87103

James D. Hughes, P.E.  
Principal Engineer, Hydrology  
Planning Department

[www.cabq.gov](http://www.cabq.gov)

C: Email      Serna, Yvette M.; Fox, Debi; Tena, Victoria C.; Zamora, Renee; Sandoval,  
Darlene M.



# City of Albuquerque

Planning Department  
Development & Building Services Division

## DRAINAGE AND TRANSPORTATION INFORMATION SHEET (REV 6/2018)

**Project Title:** Shops @ The 24's **Building Permit #:** \_\_\_\_\_ **Hydrology File #:** H19D001

**DRB#:** \_\_\_\_\_ **EPC#:** \_\_\_\_\_ **Work Order#:** \_\_\_\_\_

**Legal Description:** Lot 3-A-1, Block C

**City Address:** 2424 Louisiana Blvd NE

**Applicant:** Sun Vista Enterprises **Contact:** Irwin Harms

**Address:** 6801 Jefferson Suite 100, Albuquerque, NM 87109

**Phone#:** 798-9800 **Fax#:** \_\_\_\_\_ **E-mail:** irwin@sunvista.net

**Other Contact:** Mark Goodwin & Associates, PA **Contact:** Cory Pierce

**Address:** PO BOX 90606, Albuquerque, NM 87199

**Phone#:** 828.2200 **Fax#:** \_\_\_\_\_ **E-mail:** cory@goodwinengineers.com

**TYPE OF DEVELOPMENT:** \_\_\_\_\_ PLAT (# of lots) \_\_\_\_\_ RESIDENCE \_\_\_\_\_ DRB SITE X ADMIN SITE

**IS THIS A RESUBMITTAL?** \_\_\_\_\_ Yes X No

**DEPARTMENT** \_\_\_\_\_ TRANSPORTATION X HYDROLOGY/DRAINAGE

Check all that Apply:

### TYPE OF SUBMITTAL:

- X ENGINEER/ARCHITECT CERTIFICATION  
\_\_\_\_ PAD CERTIFICATION  
\_\_\_\_ CONCEPTUAL G & D PLAN  
\_\_\_\_ GRADING PLAN  
\_\_\_\_ DRAINAGE REPORT  
\_\_\_\_ DRAINAGE MASTER PLAN  
\_\_\_\_ FLOODPLAIN DEVELOPMENT PERMIT APPLIC  
\_\_\_\_ ELEVATION CERTIFICATE  
\_\_\_\_ CLOMR/LOMR  
\_\_\_\_ TRAFFIC CIRCULATION LAYOUT (TCL)  
\_\_\_\_ TRAFFIC IMPACT STUDY (TIS)  
\_\_\_\_ STREET LIGHT LAYOUT  
\_\_\_\_ OTHER (SPECIFY) \_\_\_\_\_  
\_\_\_\_ PRE-DESIGN MEETING?

### TYPE OF APPROVAL/ACCEPTANCE SOUGHT:

- X BUILDING PERMIT APPROVAL  
X CERTIFICATE OF OCCUPANCY  
\_\_\_\_ PRELIMINARY PLAT APPROVAL  
\_\_\_\_ SITE PLAN FOR SUB'D APPROVAL  
\_\_\_\_ SITE PLAN FOR BLDG. PERMIT APPROVAL  
\_\_\_\_ FINAL PLAT APPROVAL  
\_\_\_\_ SIA/ RELEASE OF FINANCIAL GUARANTEE  
\_\_\_\_ FOUNDATION PERMIT APPROVAL  
\_\_\_\_ GRADING PERMIT APPROVAL  
\_\_\_\_ SO-19 APPROVAL  
\_\_\_\_ PAVING PERMIT APPROVAL  
\_\_\_\_ GRADING/ PAD CERTIFICATION  
\_\_\_\_ WORK ORDER APPROVAL  
\_\_\_\_ CLOMR/LOMR  
\_\_\_\_ FLOODPLAIN DEVELOPMENT PERMIT  
\_\_\_\_ OTHER (SPECIFY) \_\_\_\_\_

**DATE SUBMITTED:** 3/27/19 **By:** Cory Pierce

COA STAFF:

ELECTRONIC SUBMITTAL RECEIVED: \_\_\_\_\_

FEE PAID: \_\_\_\_\_



LOUISIANA BOULEVARD N.E.

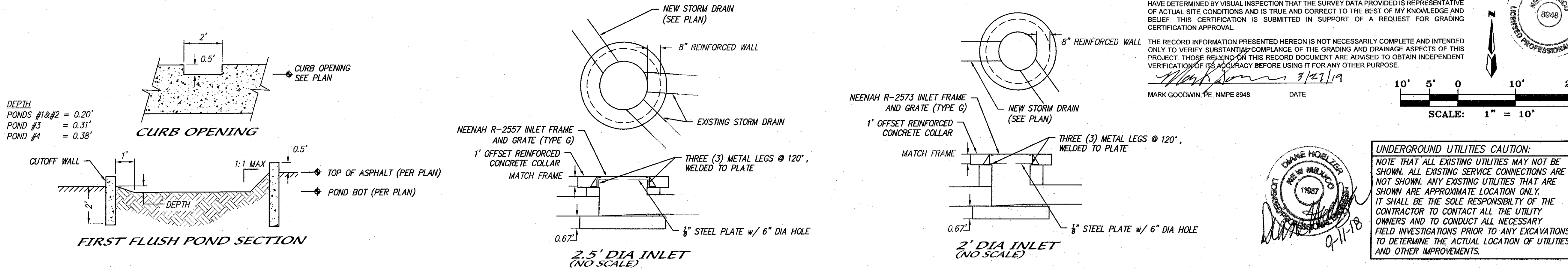
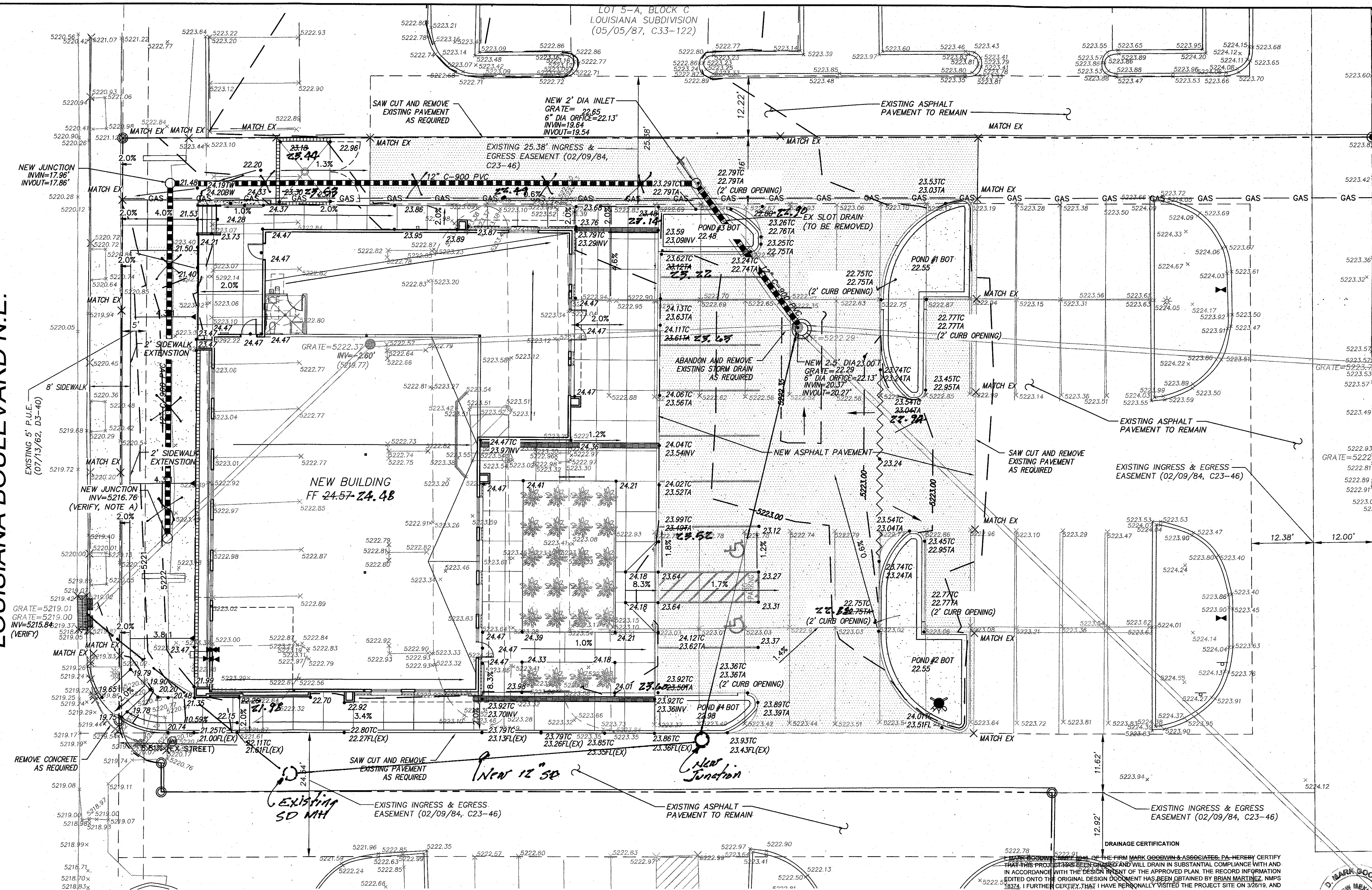

LEGAL DESCRIPTION	
LOT NUMBERED THREE-A-ONE (3-A-1) IN BLOCK LETTERED "C", OF LOUISIANA SUBDIVISION, CITY OF ALBUQUERQUE, NEW MEXICO, AS THE SAME IS SHOWN AND DESIGNATED ON THE SECOND CORRECTION PLAT OF LOT 3-A-1, BLOCK "C" OF SAID SUBDIVISION, FILED IN THE OFFICE OF THE COUNTY CLERK OF BERNALILLO COUNTY, NEW MEXICO, ON JULY 1, 1996, IN PLAT BOOK 96C, PAGE 290.	
ACS BENCHMARK	
BENCHMARK FOR THIS SITE IS BASED ON ELEVATION DATUM NAVD 1988 FROM AGRS MONUMENT "15-H18", PUBLISHED ELEVATION(Feet) = 5303.391 (DATE OF RETRIEVAL: JULY 2007 FOR NON AGRS MONUMENTS)	
ELEVATIONS ARE SHIFTED VERTICALLY 69.07' FROM THIS DATUM	
LEGEND	
	FOUND AND USED MONUMENT AS DESIGNATED
	DENOTES NO. 4 REBAR WITH YELLOW PLASTIC CAP P.S. 11993' SET THIS SURVEY
	FOUND ALUMINUM AGRS MONUMENT AS DESIGNATED
	SET OF PIPES AS DESIGNATED
	EXISTING SERVICE/DROP POLE AS DESIGNATED
	EXISTING UTILITY POLE
	EXISTING ELECTRIC BOX
	EXISTING LIGHT POLE
	EXISTING TRANSFORMER
	EXISTING PULLBOX
	EXISTING TELEPHONE PEDESTAL
	EXISTING IRRIGATION CONTROL VALVE
	EXISTING WATER METER
	EXISTING FIRE HYDRANT
	EXISTING PIV
	EXISTING SANITARY SEWER MANHOLE
	EXISTING CLEANOUT
	EXISTING UNKNOWN MANHOLE
	EXISTING GAS VALVE
	EXISTING SIGN
	EXISTING GAS METER
	EXISTING POND INLET
	EXISTING MEDIAN INLET
	EXISTING CURB INLET
	EXISTING GUARD POST
	EXISTING HANDICAP PARKING SPACE
	EXISTING CURB AND GUTTER
	EXISTING OVERHEAD UTILITY LINE
	EXISTING GAS LINE
	EXISTING TELEPHONE LINE
	NEW SPOT ELEVATION
	NEW TOP OF WALL ELEVATION
	NEW BOTTOM OF WALL ELEVATION
	NEW TOP OF CURB
	NEW TOP OF ASPHALT
	NEW FLOW DIRECTION
	NEW ASPHALT PAVEMENT
	NEW STORM DRAIN
	NEW WALL
	NEW SIDEWALK CULVERT (COA DETAIL 2236)
	PROPOSED CONTOUR LINE

- GENERAL NOTES:
- CONTRACTOR MUST OBTAIN A TOPSOIL DISTURBANCE PERMIT FROM THE ENVIRONMENTAL HEALTH DIVISION PRIOR TO CONSTRUCTION.
  - CITY OF ALBUQUERQUE STANDARD SPECIFICATIONS FOR PUBLIC WORKS CONSTRUCTION, LATEST EDITION SHALL GOVERN ALL WORK.
  - THE CONTRACTOR SHALL CONFORM TO ALL CITY, COUNTY, STATE AND FEDERAL DUST CONTROL MEASURES AND REQUIREMENTS AND WILL BE RESPONSIBLE FOR PREPARING AND OBTAINING ALL NECESSARY APPLICATIONS AND APPROVALS.
  - THE CONTRACTOR SHALL ENSURE THAT NO SOIL ERODES FROM THE LOTS INTO PUBLIC RIGHT-OF-WAY. THIS CAN BE ACHIEVED BY CONSTRUCTING TEMPORARY BERMS AND WETTING THE SOIL TO KEEP IT FROM BLOWING.
  - NO WORK ALLOWED IN THE PUBLIC RIGHT OF WAY WITHOUT AN APPROVED WORK ORDER.
- NOTE:
- CONTRACTOR TO CONFIRM STORM DRAIN CONNECTION INVERT PRIOR TO STORM DRAIN CONSTRUCTION AND NOTIFY ENGINEER. STORM DRAIN LAYOUT IS ASSUMED. STORM DRAIN LAYOUT IS PER LARRY READ & ASSOCIATES 2002 DRAINAGE BASIN MAP
  - BUILDING ROOF TO DRAIN TO THE NORTH AND EAST SIDES.
  - SEE SHEET ASD 101 FOR ITEMS TO BE REMOVED.

SHOPS @ THE 24s  
GRADING & DRAINAGE PLAN

MARK GOODWIN & ASSOCIATES, P.A.  
CONSULTING ENGINEERS  
P.O. BOX 90606  
ALBUQUERQUE, NEW MEXICO 87199  
(505)828-2200, FAX (505)797-9539

Designed: CP/DH	Drawn: DER, CP	Checked: DMG	Sheet CI of 4
Scale: AS SHOWN	Date: 9/7/2018	Job: A18018	

UNDERGROUND UTILITIES CAUTION:  
NOTE THAT ALL EXISTING UTILITIES MAY NOT BE SHOWN. ALL EXISTING SERVICE CONNECTIONS ARE NOT SHOWN. ANY EXISTING UTILITIES THAT ARE SHOWN ARE APPROXIMATE LOCATION ONLY. IT SHALL BE THE SOLE RESPONSIBILITY OF THE CONTRACTOR TO CONTACT ALL THE UTILITY OWNERS AND TO CONDUCT ALL NECESSARY FIELD INVESTIGATIONS PRIOR TO ANY EXCAVATIONS TO DETERMINE THE ACTUAL LOCATION OF UTILITIES AND OTHER IMPROVEMENTS.