

WESTERN COMMERCIAL
SNOW HEIGHTS ADDN

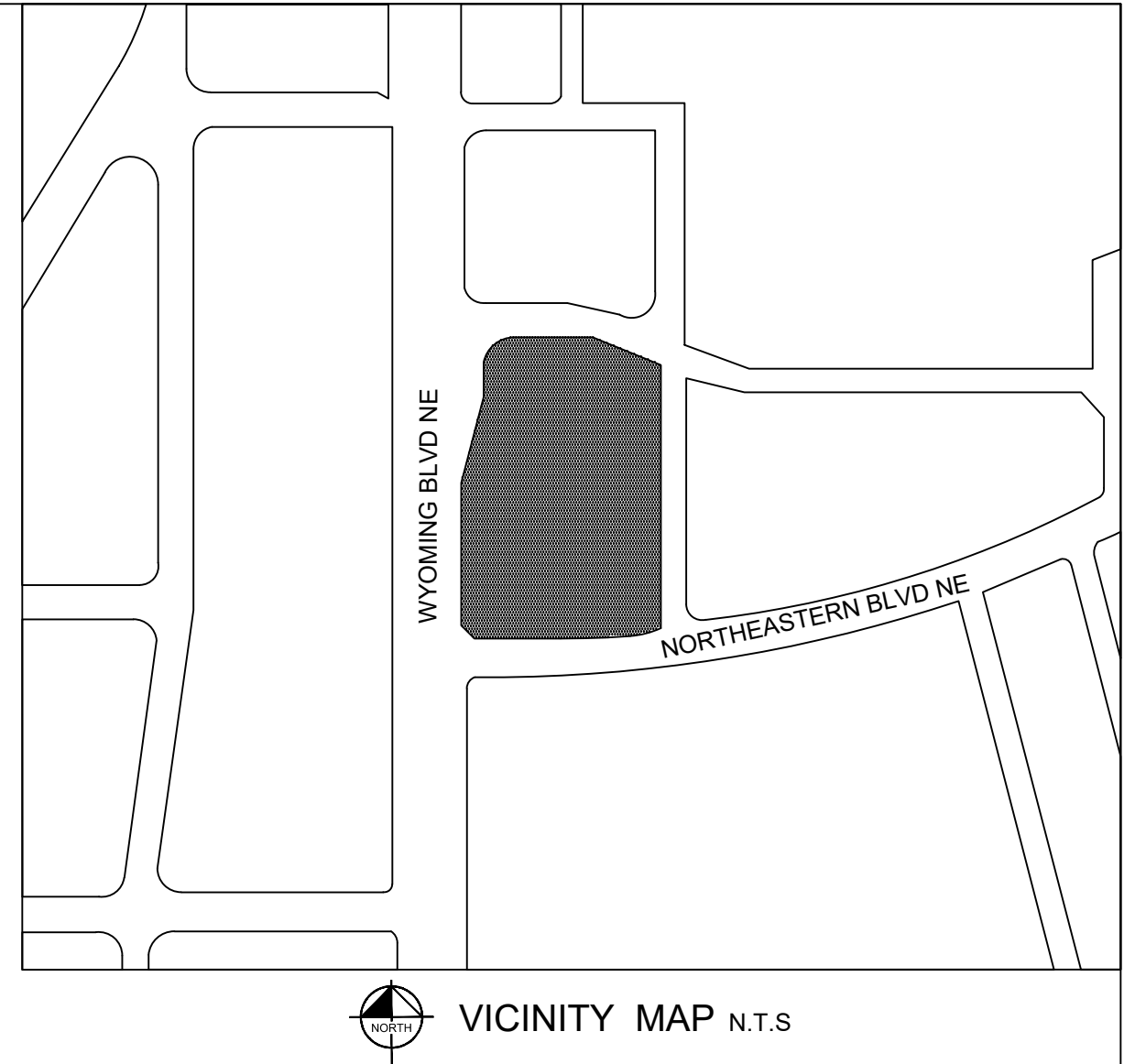
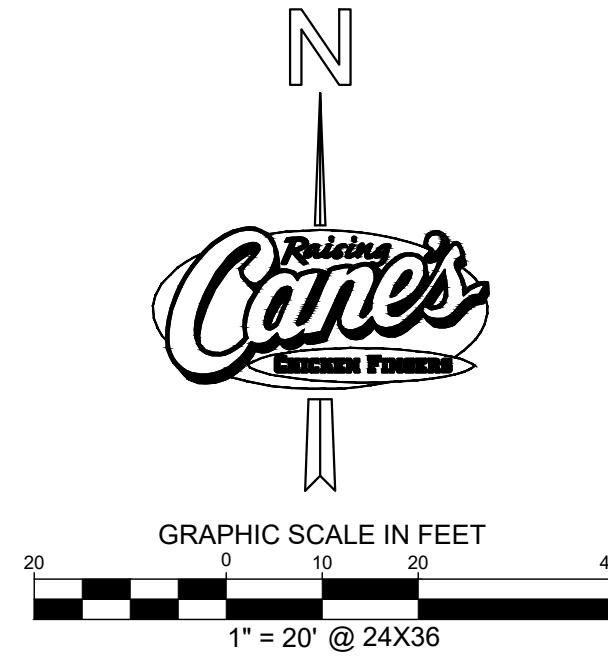

LEGEND

- PROPERTY LINE
- EXISTING CONTOUR
- PROPOSED CONTOUR
- PROPOSED LIMITS OF DISTURBANCE
- PROPOSED RIDGE
- DIRECTION OF OVERLAND FLOW W/ GRADE
- SILT FENCE
- STRAW BALE
- TEMPORARY DRAINAGE SWALE
- OFFSITE TRACKING PREVENTION
- PROPOSED ROCK. CONTRACTOR TO INSTALL PS.1, PS.2, OR PS.3, TO BE APPROVED BY OWNER.
- PROPOSED SEEDING WITH TEMPORARY IRRIGATION PER ALBO SPEC 1012.2.3. CONTRACTOR TO INSTALL PS.1, PS.2, OR PS.3, TO BE APPROVED BY OWNER.
- PROPOSED HAY AND STRAW MULCH PER ALBO SPEC 1012.2.3.2. CONTRACTOR TO INSTALL PS.1, PS.2, OR PS.3, TO BE APPROVED BY OWNER.
- PROPOSED GRATE INLET PROTECTION. SEE DETAIL SHEET.
- TEMPORARY SILT POND
TOTAL DEPTH $\pm 2'$; SILT COLLECTION DEPTH $\pm 0.5'$
SOUTH SIDE SLOPE = 2:1

GENERAL NOTES

- ADD 5000' TO ALL ELEVATIONS SHOWN.
- CONTRACTOR TO VERIFY EXISTING IMPROVEMENTS SHOWN ON THE PLAN.
- CONTRACTOR TO PROTECT IN PLACE, DURING DEMOLITION AND CONSTRUCTION, ALL EXISTING IMPROVEMENTS THAT ARE TO REMAIN AS NOTED ON THE PLAN.
- ANY EXISTING STRUCTURE, IMPROVEMENT OR APPURTENANCE TO REMAIN THAT IS DAMAGED DURING DEMOLITION OR CONSTRUCTION SHALL BE IMMEDIATELY REPAIRED OR REPLACED BY THE CONTRACTOR AT THE CONTRACTOR'S EXPENSE.
- CONTRACTOR SHALL VERIFY AND LOCATE ALL EXISTING UNDERGROUND UTILITIES BEFORE CONSTRUCTION AND PROTECT IN PLACE UNLESS NOTES ON THE PLANS.
- THE CONTRACTOR SHALL EXERCISE CAUTION TECHNIQUES TO PROTECT AND PRESERVE EXISTING PERMANENT SURVEY MONUMENTS. ALL SURVEY MONUMENTS DISTURBED (PROPOSED AND EXISTING) SHALL BE REPLACED AND/OR REHABILITATED IN ACCORDANCE WITH STANDARDS BY A PROFESSIONAL LAND SURVEYOR RETAINED BY THE CONTRACTOR.

EROSION CONTROL SCHEDULE AND PHASING

THE PROJECT SHALL GENERALLY CONFORM TO THE FOLLOWING PHASING SCHEDULE. REFERENCE THE SWPPP BOOK AND NMD GENERAL PERMIT FOR DETAILED REQUIREMENTS.

PHASE 1 - DEMOLITION

- INSTALL PERIMETER BMPs INCLUDING THE CONSTRUCTION ENTRANCE/EXIT, SWPPP SIGNAGE, SILT FENCE, AND ALL OTHER NECESSARY BMPs ACCORDING TO THE LOCATION SHOWN ON THE EROSION CONTROL PLAN. CLEAR ONLY THE MINIMUM AREA REQUIRED TO INSTALL BMPs.
- SET THE PROJECT OFFICE TRAILER AND PREPARE TEMPORARY PARKING AND STORAGE AREAS.
- DENOTE DATES OF BMP INSTALLATION AND MAINTENANCE ON SITE-MAPS.
- BEGIN DEMOLITION AND CLEARING OF THE SITE.
- STABILIZATION OF DISTURBED AREAS MUST BE INITIATED WHENEVER CLEARING, GRADING, OR EARTH DISTURBING ACTIVITIES HAVE CEASED ON ANY PORTION OF THE SITE, OR TEMPORARILY CEASED AND WILL NOT RESUME WITHIN 14 DAYS PER GENERAL PERMIT REQUIREMENTS.

PHASE 2 - GRADING

- ENSURE APPROPRIATE BMPs ARE IN PLACE DOWNSTREAM OF SITE WORK OR WHERE RUNOFF MAY EXIT THE SITE.
- BEGIN GRADING THE SITE.
- SEED AND RE-VEGETATE SLOPES AS AREAS ARE BROUGHT TO GRADE OR STOCKPILES THAT WILL REMAIN INACTIVE FOR 14 DAYS PER GENERAL PERMIT REQUIREMENTS.

PHASE 3 - LANDSCAPING AND DEVELOPMENT

- INSTALL LANDSCAPING PER THE LANDSCAPE PLANS AND DETAILS.
- REMOVE EROSION CONTROL DEVICES WHEN FINAL STABILIZATION IS ACHIEVED PER THE CITY OF ALBUQUERQUE.
- STABILIZE ANY AREAS DISTURBED BY REMOVAL OF BMPs.

SITE DATA

LOT AREA	44,381 SF \pm 1.02 AC
TOTAL DISTURBED AREA	40,060 SF \pm 0.92 AC
PRE-DEVELOPMENT RUNOFF COEFFICIENT	0.91

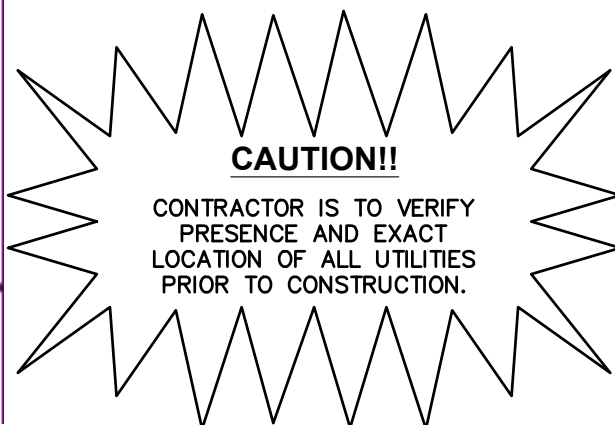

INTERIM CONDITIONS
DEMOLITION AND STABILIZATION
2004 WYOMING BLVD NE
BERNALILLO COUNTY, NEW MEXICO 87112

Engineer's Information:

Kimley»Horn

© 2022 KIMLEY-HORN
AND ASSOCIATES, INC.

13455 Noel Road
Two Galleria Office Tower
Suite 700

Dallas, TX 75240
CONTACT: LAUREN NUFFER, P.E.
(972) 770-1300

LAUREN.NUFFER@KIMLEY-HORN.COM
LIZ.WILLMOT@KIMLEY-HORN.COM
LIZ.WILLMOT@KIMLEY-HORN.COM

Professional of Record:



HYDROLOGY SUBMITTAL

REVISIONS:

1		
2		
3		
4		
5		
6		
7		
8		
9		

Sheet Title:

**EROSION CONTROL
PLAN**

Date: 08.09.2022

Project Number: 069313444

Drawn By: LW/NW

Sheet Number:

C3.0

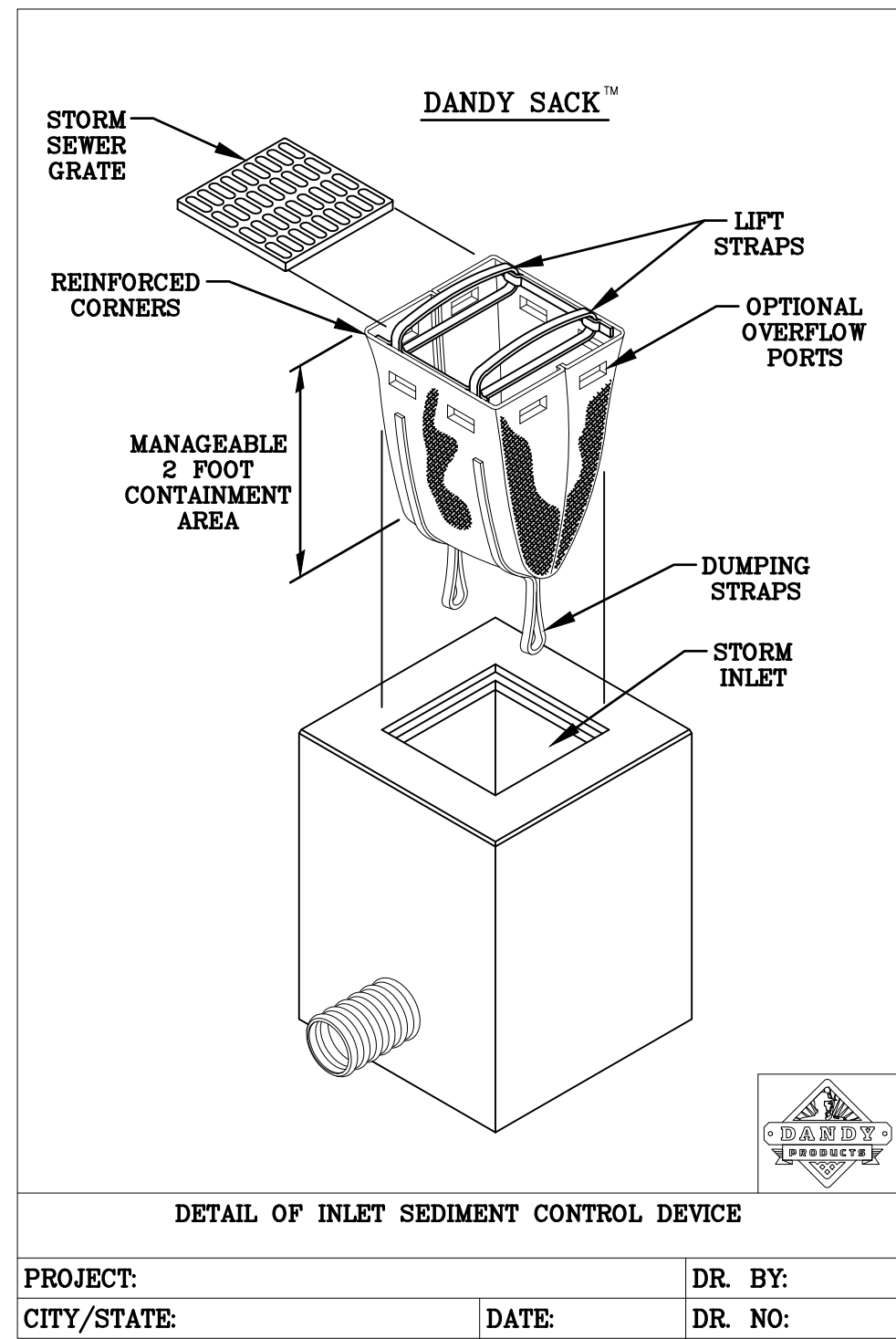
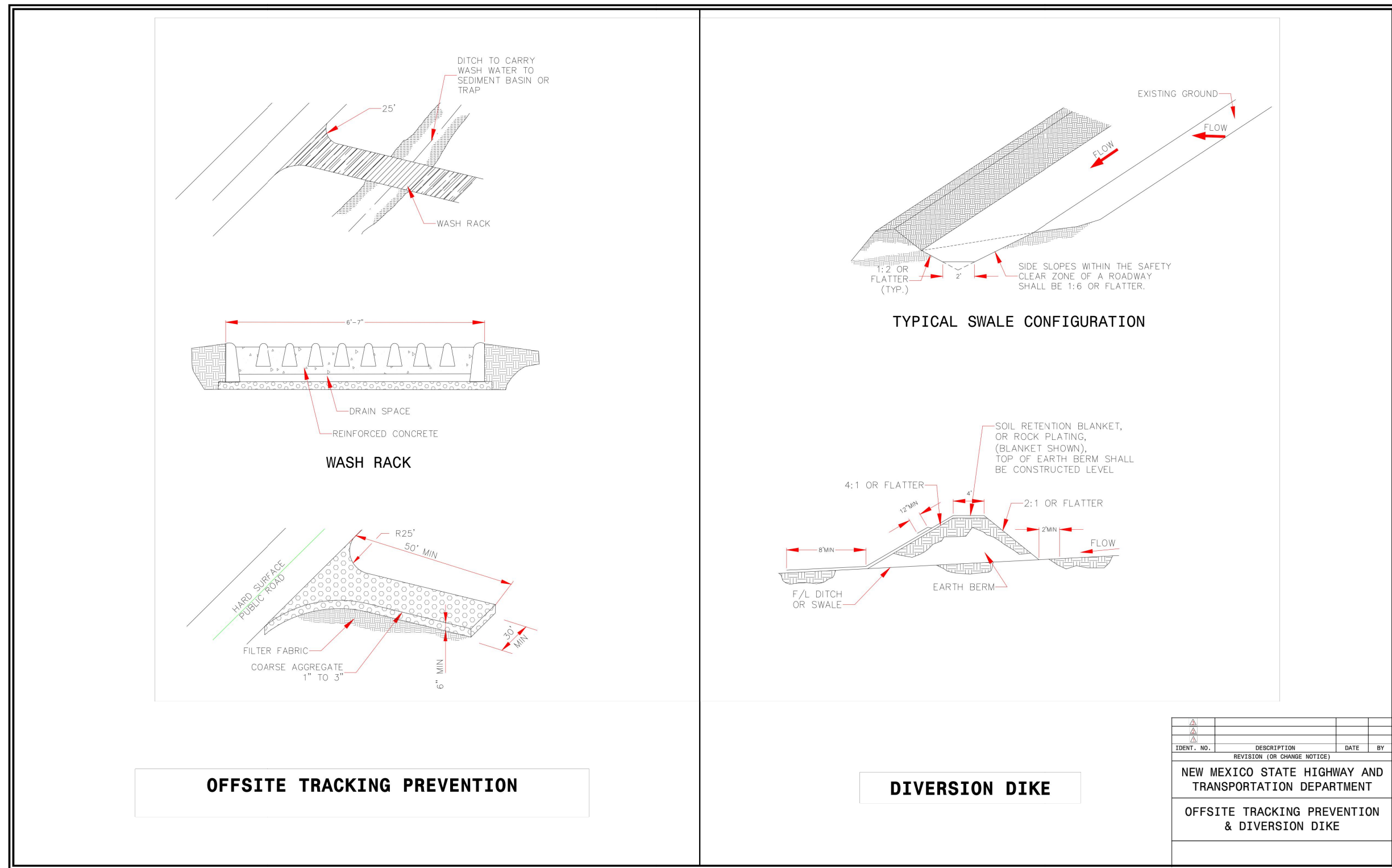
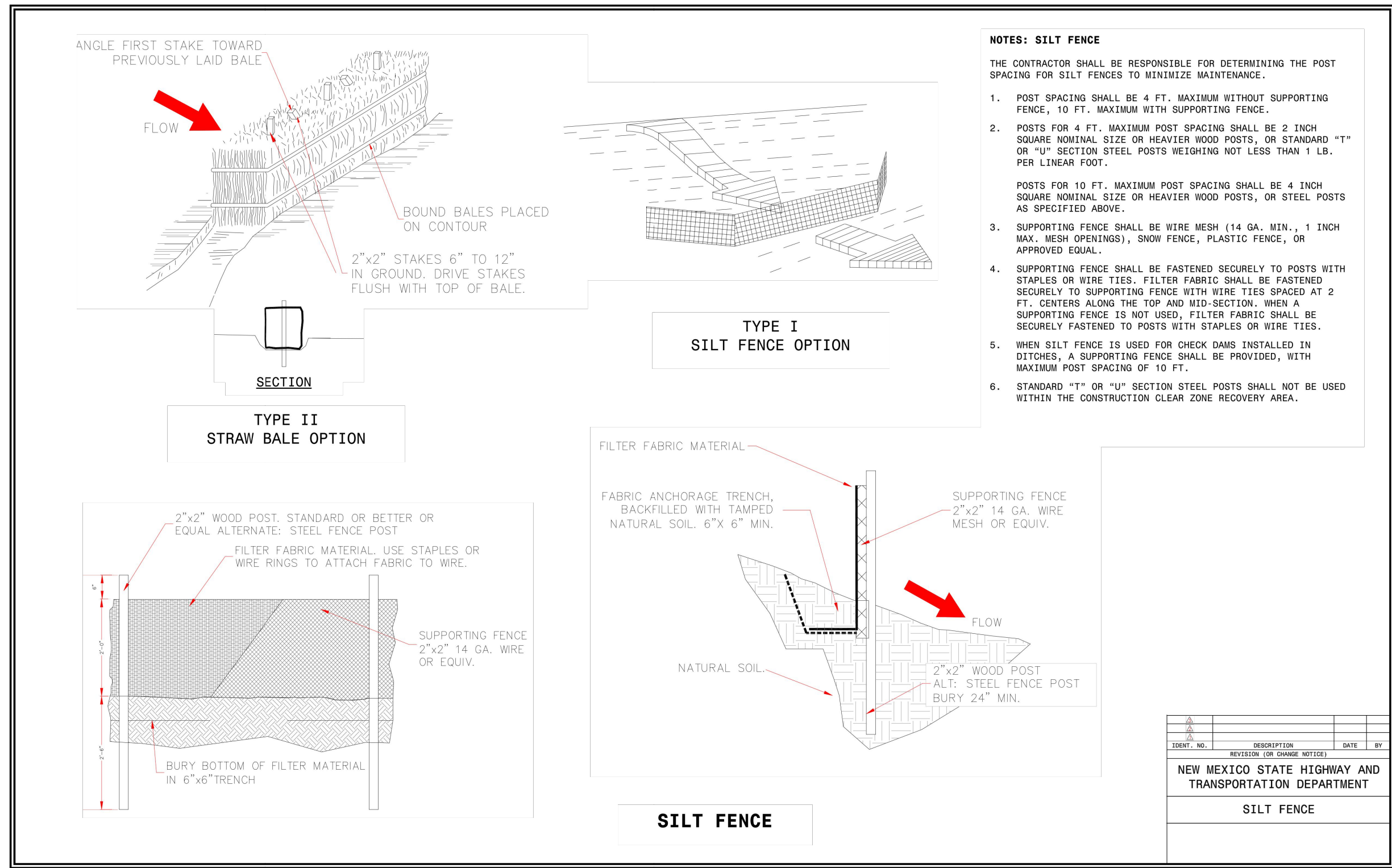

DANDY SACK™ SPECIFICATIONS

NOTE: THE DANDY SACK™ WILL BE MANUFACTURED IN THE U.S.A. FROM A WOVEN MONOFLAMENT FABRIC THAT MEETS OR EXCEEDS THE FOLLOWING SPECIFICATIONS:

REGULAR FLOW DANDY SACK™ (BLACK)

Mechanical Properties	Test Method	Units	MARV
Grab Tensile Strength	ASTM D 4632	kN (lbs)	1.78 (400) x 1.40 (315)
Grab Tensile Elongation	ASTM D 4632	%	15 x 15
Puncture Strength	ASTM D 4833	kN (lbs)	0.67 (150)
Mullen Burst Strength	ASTM D 3786	kPa (psi)	5506 (800)
Trapezoid Tear Strength	ASTM D 4533	kN (lbs)	0.67 (150) x 0.73 (165)
UV Resistance	ASTM D 4355	%	90
Apparent Opening Size	ASTM D 4751	Mm (US Std Sieve)	0.425 (40)
Flow Rate	ASTM D 4491	l/min/m² (gal/min/ft²)	2852 (70)
Permittivity	ASTM D 4491	Sec	0.90

HI-FLOW DANDY SACK™ (SAFETY ORANGE)

Mechanical Properties	Test Method	Units	MARV
Grab Tensile Strength	ASTM D 4632	kN (lbs)	1.62 (360) x 0.89 (200)
Grab Tensile Elongation	ASTM D 4632	%	24 x 10
Puncture Strength	ASTM D 4833	kN (lbs)	0.40 (90)
Mullen Burst Strength	ASTM D 3786	kPa (psi)	3097 (450)
Trapezoid Tear Strength	ASTM D 4533	kN (lbs)	0.51 (115) x 0.33 (75)
UV Resistance	ASTM D 4355	%	90
Apparent Opening Size	ASTM D 4751	Mm (US Std Sieve)	0.425 (40)
Flow Rate	ASTM D 4491	l/min/m² (gal/min/ft²)	5907 (145)
Permittivity	ASTM D 4491	Sec	2.1

*Note: All Dandy Sacks™ can be ordered with our optional oil absorbent pillows

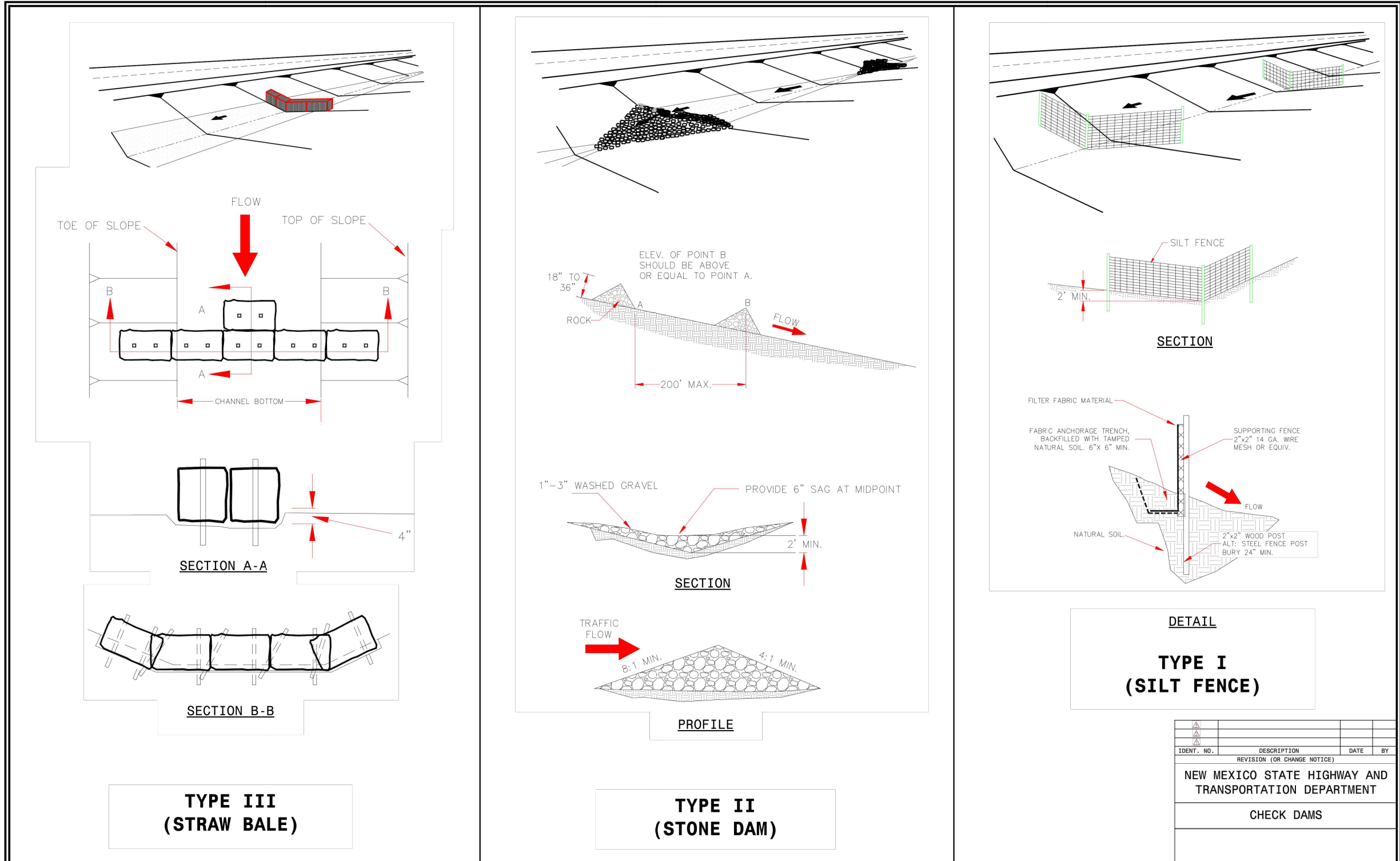

NOTE: CITY OF ALBUQUERQUE DETAILS TAKE PRECEDENCE IN CITY R.O.W. AND EASEMENTS



INTERIM CONDITIONS
DEMOLITION AND STABILIZATION
2004 WYOMING BLVD NE
BERNALILLO COUNTY, NEW MEXICO 87112

Engineer's Information:

Kimley»Horn

© 2022 KIMLEY-HORN AND ASSOCIATES, INC.

13455 Noel Road
Two Galleria Office Tower
Suite 700
Dallas, TX 75240

CONTACT: LAUREN NUFFER, P.E.
(972) 770-1300

LAUREN.NUFFER@KIMLEY-HORN.COM
LIZ.WILLMOT@KIMLEY-HORN.COM

Professional of Record:



HYDROLOGY SUBMITTAL

REVISIONS:

NO.	DESCRIPTION	DATE
1		
2		
3		
4		
5		
6		
7		
8		
9		

Sheet Title:

EROSION CONTROL
DETAILS

Date: 08.09.2022

Project Number: 069313444

Drawn By: LW/NW

Sheet Number:

C3.1