

CITY OF ALBUQUERQUE

Planning Department
Alan Varela, Director



Mayor Timothy M. Keller

July 9, 2024

Adam Harkness, P.E.
Kimley-Horn
6200 South Syracuse Way
Greenwood Village, CO 80111

Re: Eastdale Shopping Center
9450 Candelaria Rd. NE
Traffic Circulation Layout
Engineer's Stamp 06-27-24 (H20-D018)

Dear Mr. Harkness,

The TCL submittal received 06-20-2024 is approved for Building Permit by Transportation. A copy of the stamped and signed plan will be needed for each of the building permit plans. Please keep the original to be used for certification of the site for final C.O. for Transportation.

PO Box 1293

Albuquerque

NM 87103

www.cabq.gov

When the site construction is completed and an inspection for Certificate of Occupancy (C.O.) is requested, use the original City stamped approved TCL for certification. Redline any minor changes and adjustments that were made in the field. A NM registered architect or engineer must stamp, sign, and date the certification TCL along with indicating that the development was built in "substantial compliance" with the TCL. Submit this certification, the TCL, and a completed Drainage and Transportation Information Sheet to front counter personnel for log in and evaluation by Transportation. **AN APPROVED PLAT AND SIDEWALK EASEMENT ARE CONDITIONS OF RELEASING THE FINAL CO.**

Once verification of certification is completed and approved, notification will be made to Building Safety to issue Final C.O. To confirm that a final C.O. has been issued, call Building Safety at 924-3690.

Sincerely,

Ernest Armijo, P.E.
Principal Engineer, Planning Dept.
Development Review Services

C: CO Clerk, File

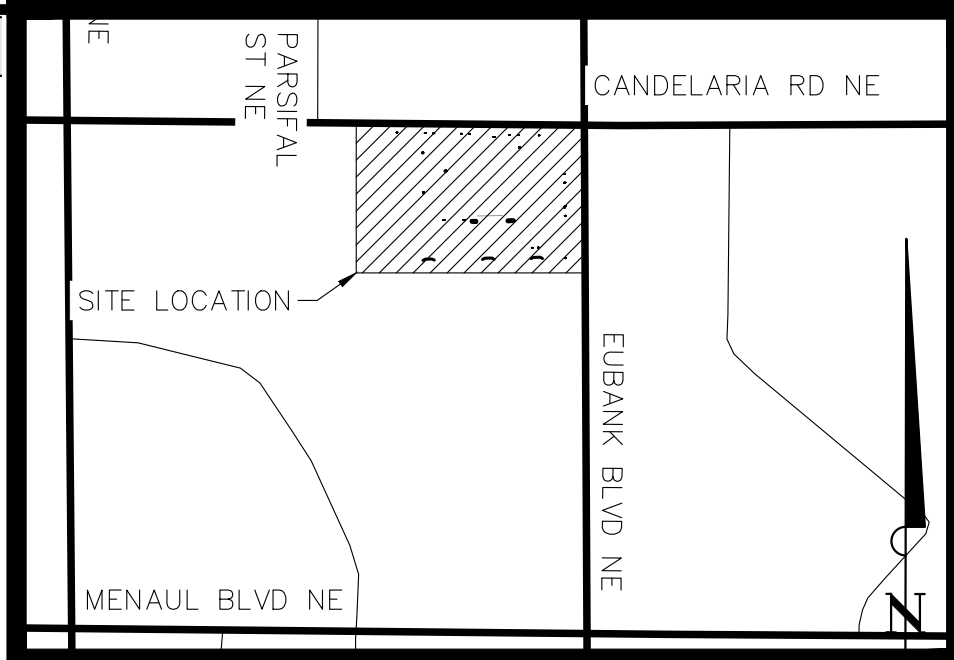
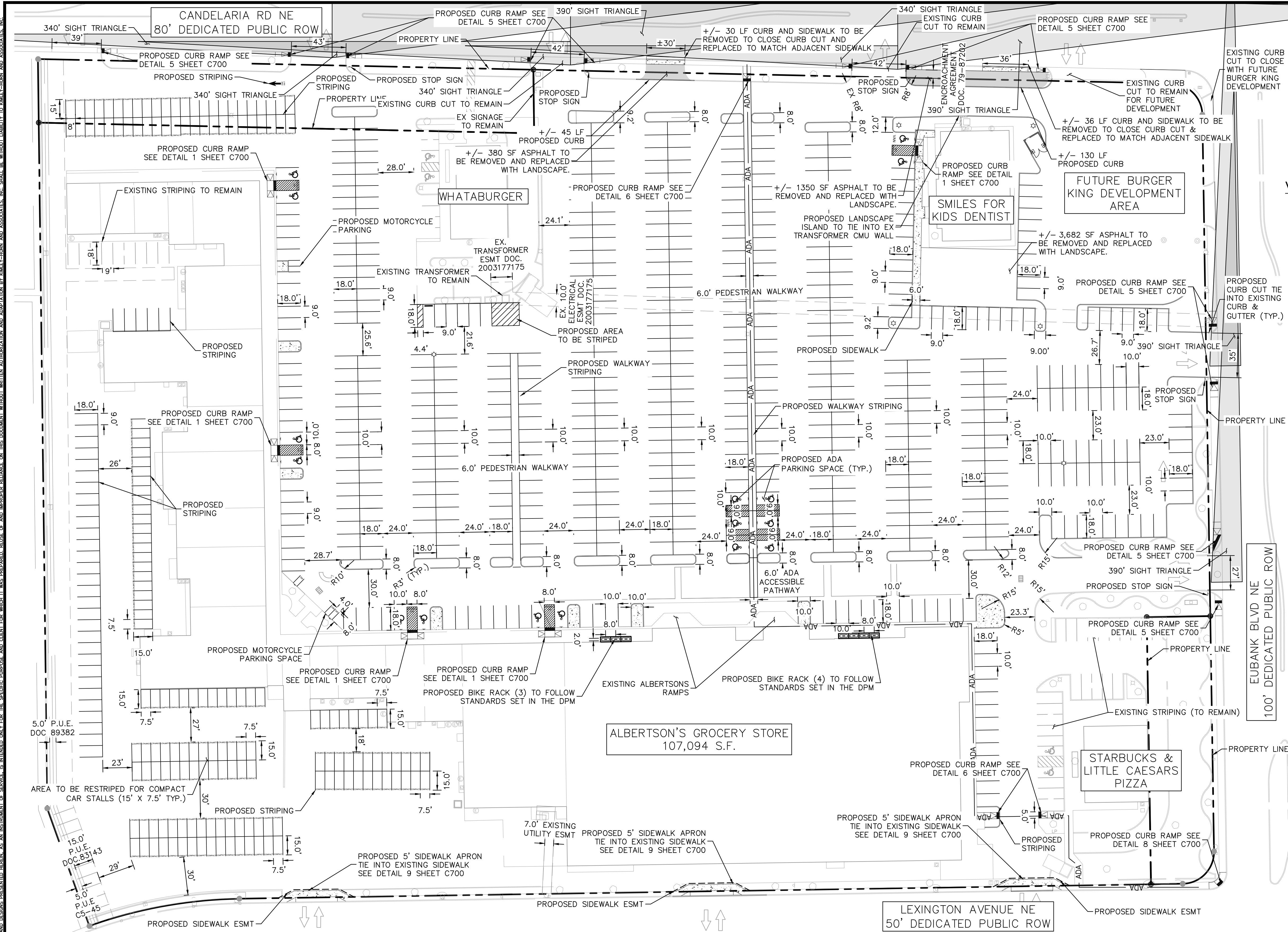

VICINITY MAP - ZONE ATLAS PAGE: H-20-Z

SCALE: 1"=1000'

LEGEND:

- PROPERTY LINE
- ADJACENT SECTION LINE
- EX. UTILITY ESMT
- EX. WROUGHT IRON FENCE
- EX. CHAIN LINK FENCE
- ADA ACCESSIBLE ROUTE
- EX. FIRE HYDRANT/VALVE
- EX. FLAGPOLE
- EX. SITE LIGHT
- PROP. SITE LIGHT
- EX. SIGN
- PROP. 6" VERTICAL CURB PER CITY DETAIL
- PROP. ASPHALT
- PROP. CONCRETE
- PROPOSED SIGN
- PROPOSED BIKE RACK (SEE SHEET C802 FOR DETAILS)
- PROPOSED STRIPING
- COMPACT PARKING SPACE (15' X 7.5' TYP.)

SITE DATA TABLE	
TOTAL EXISTING PARKING	861 SPACES
PARKING REQUIRED	2.3 SPACES / 1,000 S.F. = 246 SPACES
PROPOSED COMPACT PARKING	126 SPACES
PROPOSED TOTAL PARKING	920 SPACES
EXISTING ADA PARKING	19 SPACES
ADA PARKING REQUIRED	9 SPACES
PROPOSED ADA PARKING	16 SPACES
REQUIRED MOTORCYCLE SPACES	5 SPACES
PROPOSED MOTORCYCLE SPACES	5 SPACES
PROPOSED BICYCLE PARKING	12 SPACES (6 RACKS)

DIMENSION NOTES:

- ALL DIMENSIONS ARE TO FACE OF CURB UNLESS OTHERWISE NOTED.
- ALL CURB SHALL BE 6" STANDARD EXCEPT WHERE OTHERWISE NOTED ON PLANS.
- REFERENCE LANDSCAPE PLANS FOR PROPOSED BUFFERS, SCREENING, AND PLANTINGS.
- ALL CURB RETURN RADIUS TO BE 28', 25', 15' OR 2' UNLESS OTHERWISE NOTED.

- LANDSCAPING AND SIGNAGE WILL NOT INTERFERE WITH CLEAR SIGHT REQUIREMENTS. THEREFORE, SIGNS, WALLS, TREES, AND SHRUBBERY BETWEEN 3 AND 8 FEET TALL (AS MEASURED FROM THE GUTTER PAN) WILL NOT BE ACCEPTABLE IN THE CLEAR SIGHT TRIANGLE.
- ALL BROKEN OR CRACKED SIDEWALK MUST BE REPLACED WITH SIDEWALK. A BUILD NOTE MUST BE PROVIDED REFERRING TO THE APPROPRIATE CITY STANDARD DRAWING.
- THE SUBJECT PROPERTY HAS FULL DIRECT ACCESS TO AND FROM CANDELARIA ROAD NE EUBANK BOULEVARD NE AND LEXINGTON AVENUE NE, DEDICATED PUBLIC RIGHTS-OF-WAYS OWNED AND MAINTAINED BY THE CITY OF ALBUQUERQUE.

TRAFFIC CIRCULATION LAYOUT APPROVED

Ernest Arroyo 7/9/2024
Signed Date

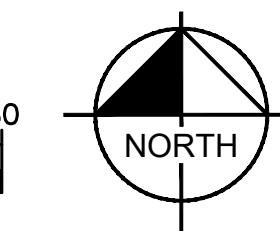
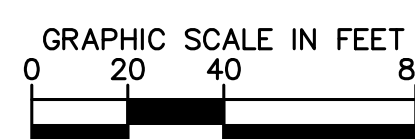

Kimley»Horn

© 2024 KIMLEY-HORN AND ASSOCIATES, INC.
6200 South Syracuse Way, Suite 300
Greenwood, Colorado 80111 (303) 228-2300

EASTDALE SHOPPING CENTER H20-D018

9450 CANDELARIA ROAD NE
ALBUQUERQUE, NM 87112

SITE PLAN



PROJECT NO.
196920000

SHEET
196920000_SP

C200

ACCESSIBLE RAMP DETAIL PER CITY OF
ALBUQUERQUE
NTS

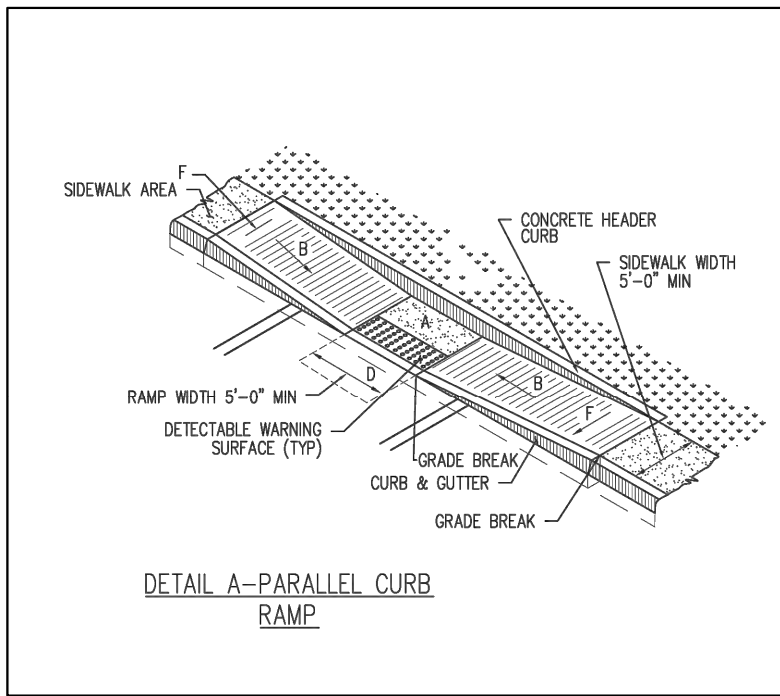

H.C. PARKING OR
VAN ACCESSIBLE SIGN (TYP)

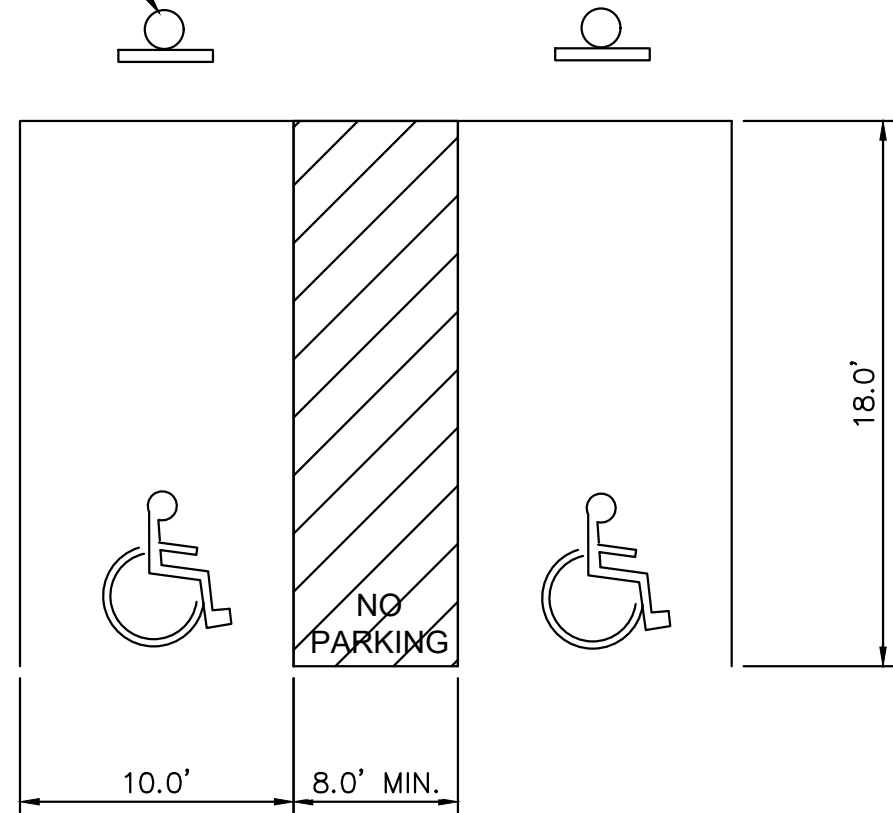

NOTE:
1. THE ADA ACCESS AISLES SHALL HAVE THE WORDS "NO PARKING" IN CAPITAL LETTERS, EACH OF WHICH SHALL BE AT LEAST ONE FOOT HIGH AND AT LEAST TWO INCHES WIDE, PLACED AT THE REAR OF THE PARKING SPACE SO AS TO BE CLOSE TO WHERE AN ADJACENT VEHICLE'S REAR TIRE WOULD BE PLACED. (66-1-4.1. B NMSA 1978).

2 PROPOSED ADA PARKING SPACES

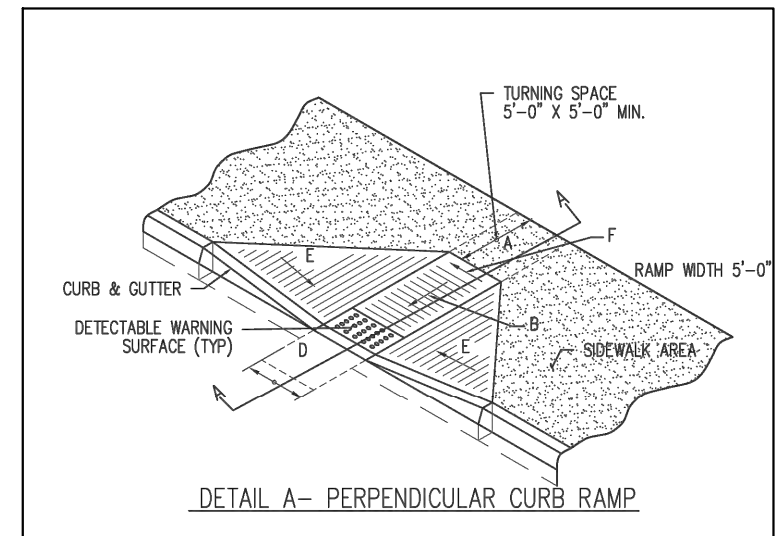

⑥ PERPENDICULAR CURB RAMP DETAIL
PER CITY OF ALBUQUERQUE
NTS

NOTES

2. ENGINEER SHALL PROVIDE ADDITIONAL DETAIL AND DESIGN FOR SITE SPECIFIC CONDITIONS AS NEEDED.
3. SEE DRAWING 2446 FOR DETECTABLE WARNING SURFACE STANDARDS.

CONSTRUCTION NOTES

- C. OFFSET SIDEWALK.
- C. 1/2" EXPANSION JOINT ADJACENT TO EXISTING CONCRETE OR STRUCTURES ON REPLACEMENT WORK.
- D. NOT USED
- E. SLOPE TO BE ADJUSTED TO PROVIDE A UNIFORM TRANSITION BETWEEN SIDEWALK AND DRIVEPAD (NOT TO EXCEED 8.3%, 7% PREFERRED SLOPE).
- F. TOP OF DRIVEPAD.
- G. TOP OF CURB.
- H. PROPERTY LINE, RIGHT-OF-WAY LINE.
- I. 5' MIN SIDEWALK WIDTH.
- J. SLOPE 2% MAX, 1.5% PREFERRED SLOPE.
- K. NOT USED
- M. NOT USED
- N. EXPOSED OUT EDGES SHALL BE GROUND SMOOTH/ROUNDED TO REMOVE SHARP EDGE.
- P. OUTSIDE EDGE OF SIDEWALK.
- Q. SLOPE REQUIRED TO MEET EVEN OR SET BOUNDARY ELEVATIONS (PROPERTY LINE OR BOC, ETC.).
- R. FLARED SIDES ARE TO HAVE 10% MAXIMUM SLOPE.
- S. HEADER CURB AS REQUIRED TO MEET GRADE AT BAC.
- T. LONGITUDINAL SLOPE TO MATCH ROADWAY WITH 8.3% MAX.

9 DRIVEPAD WITH SIDEWALK AT PROPERTY LINE DETAIL
PER CITY OF ALBUQUERQUE
NTS

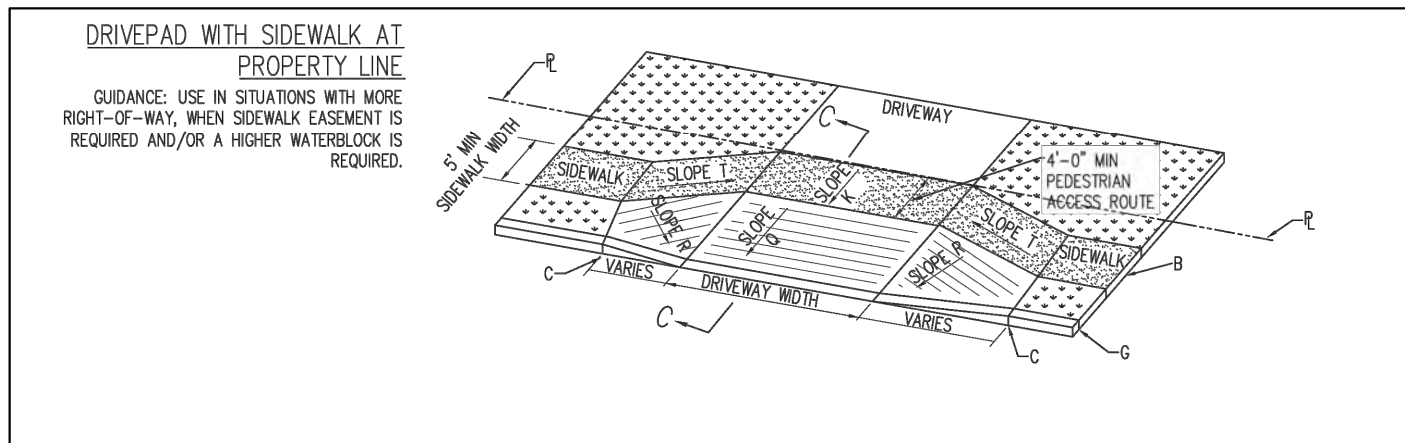

PLACEMENT ON PARALLEL CURB
RAMP DETAIL PER CITY OF
ALBUQUERQUE

NTS

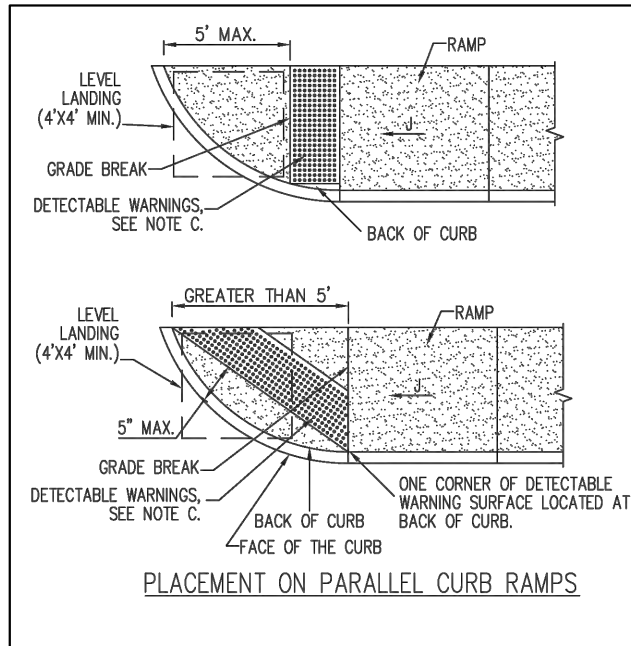

DETAIL A MINIMAL ROW FOR SIDEWALK
AT BACK OF CURB PERPENDICULAR
RAMP PER CITY OF ALBUQUERQUE

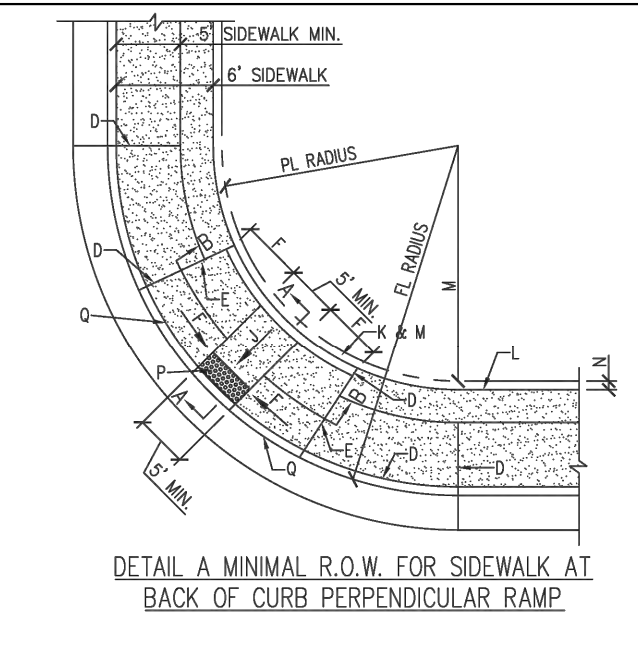

3 ACCESSIBLE PARKING SIGN
NTS

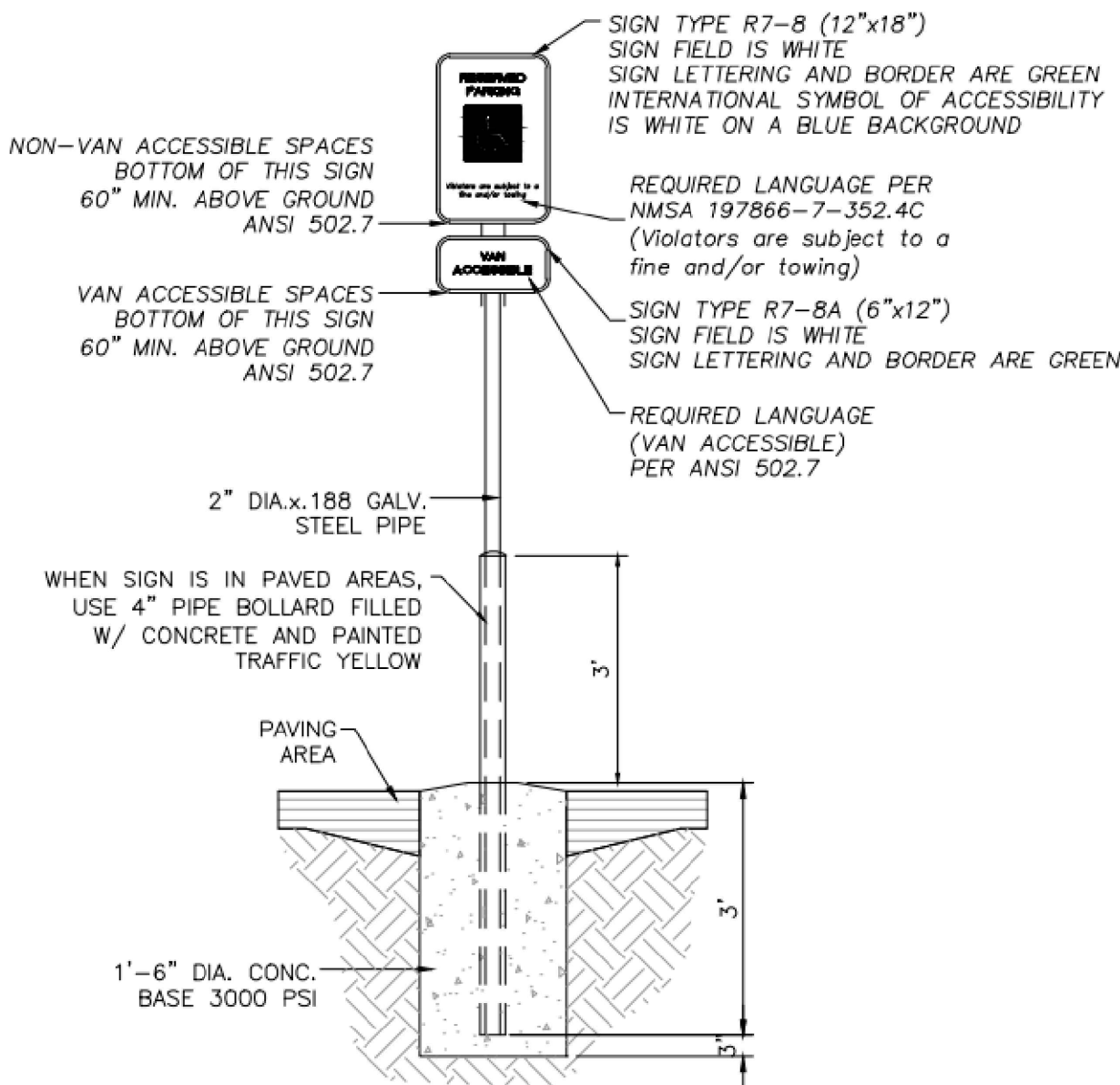

7 PROPOSED MOTORCYCLE PARKING
NTS

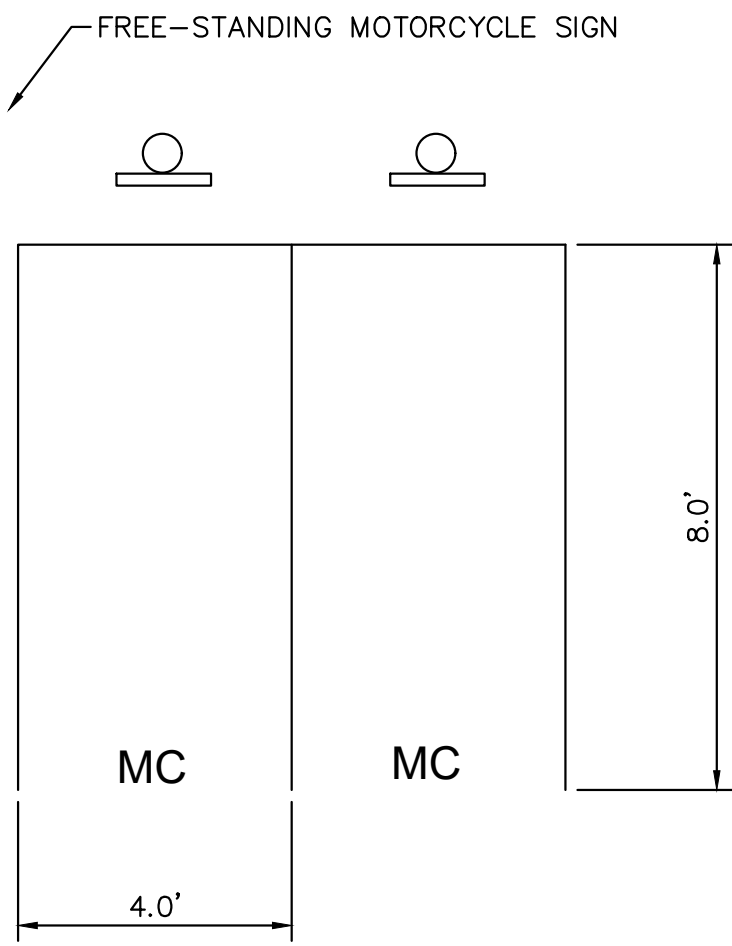

**TRAFFIC CIRCULATION
LAYOUT APPROVED**

Ernest Armijo 7/9/2024

Signed Date

④ POLE MOUNTED LIGHT FIXTURE
NTS

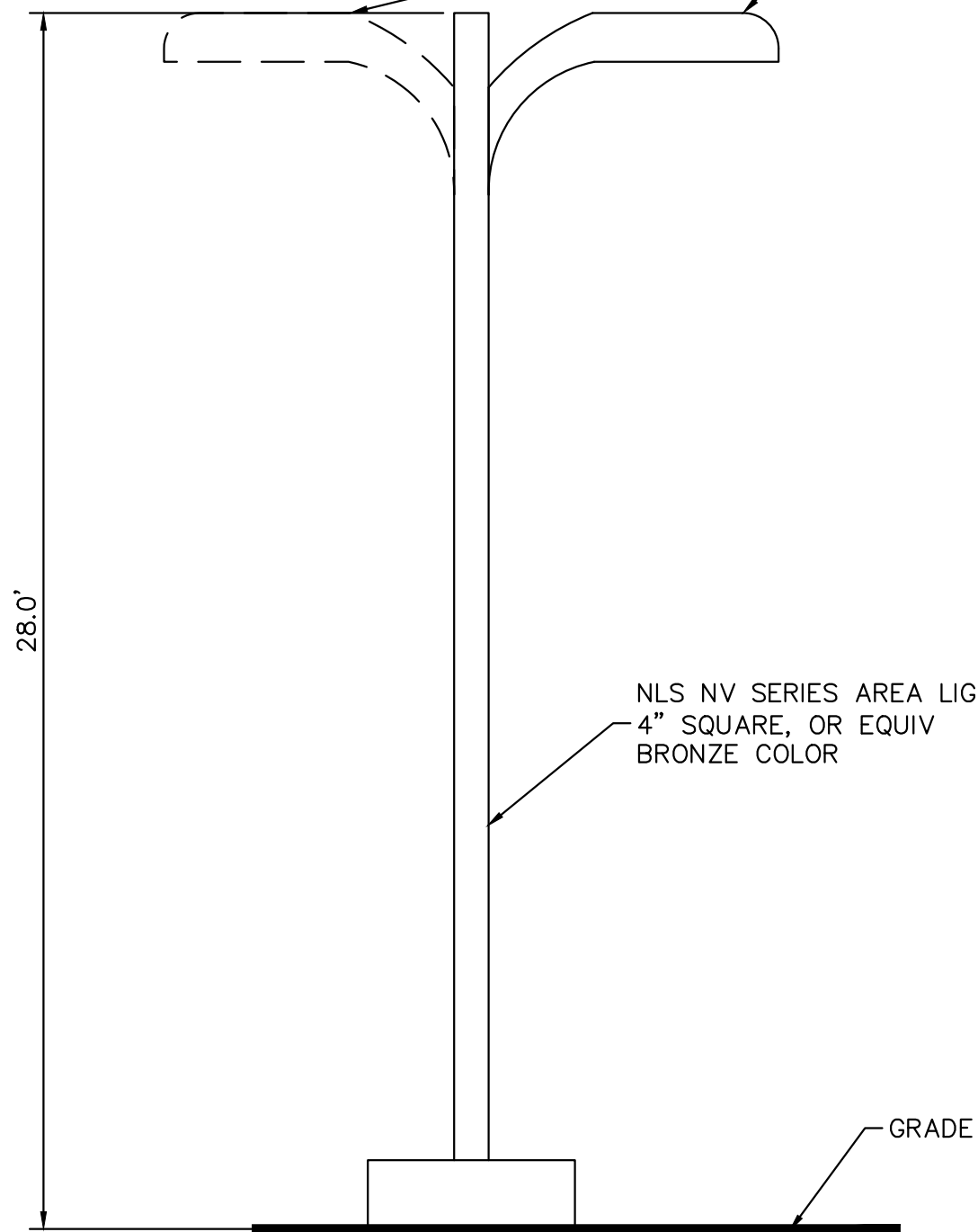

GENERAL NOTES

1. CATCH BASINS ARE NORMALLY TO BE LOCATED AT THE CENTER OF THE RETURN OR AS DIRECTED BY THE CITY ENGINEER.
2. WHEN MOORING ONE QUARTER OF AN INTERSECTION TO IMPROVE ACCESSIBILITY, ADOPT THE REMAINING QUARTERS TO SUCH THAT ALL QUARTERS OF THE INTERSECTION COMPLY WITH ADA (PROMAG) REGULATIONS AS SHOWN ON PLANS.
3. SURFACE TYPING OF CATCH ACCESS RAMPS SHALL BE INDICATED BY HEAVY BROWN LETTERING (300% 200%); TRANSVERSE TO THE SLOPE OF THE RAMP.
4. GUTTER FLOW LINE PROFILE SHALL BE MAINTAINED THROUGHOUT THE RAMP. DRAINAGE CATCH BASIN RAMP STRUCTURES SHALL NOT BE PLACED IN LINE WITH RAMP STRUCTURES.
5. ALL CURBS, SIDEWALK AND RAMP SHALL BE MAINTAINED AT A MINIMUM OF 5'-0" THROUGH ENTIRE RAMP LENGTH.

CONSTRUCTION NOTES

1. ALL SLOPES SHALL BE TO EXCEED 2% ADJACENT TO RAMP; 1.5% PREFERRED.
2. FLUSH WITH RAMP AND GUTTER.
3. CATCH BASIN AND GUTTER (SEE STD. DWG. 2415 - GUTTER AT CATCH ACCESS RAMP).
4. 1/2" EXPANSION JOINT.
5. FASAL LINES - TOP AND BOTTOM OF RAMP.
6. 8" MAX. SLOPE OF RAMP; 7.5% PREFERABLE CROSS-SLOPE.
7. CONSTRUCTION JOINT.
8. VARIES WITH AVAILABLE R.O.M.
9. 2% MAXIMUM CROSS-SLOPE; 1.5% PREFERRED CROSS-SLOPE.
10. HEADER CURB, SEE DWG. 2415C.
11. BACK OF SIDEWALK.
12. BACK OF SIDEWALK SHOULD BE ESTABLISHED 5' TO MAINTAIN 5'-0" MINIMUM SIDEWALK WIDTH (MINIMUM) THROUGHOUT; SEE STD. DWG. 2440 (NOTE) IF A LESS THAN 5'-0" IS AVAILABLE DUE TO UNDESIRABLE OBSTRUCTIONS.
13. 4'-1/2" MAX.
14. DETECTABLE WARNING (SEE STD. DWG. 2446).
15. CATCH TO MATCH SLOPE OF SIDEWALK.

Kimley»»Horn

© 2024 KIMLEY-HORN AND ASSOCIATES, INC.
6200 South Syracuse Way, Suite 300
Greenwood, Colorado 80111 (303) 228-2300

DESIGNED BY: MGK
DRAWN BY: MGK
CHECKED BY: AJH
DATE: 6/27/24

18

9450 CANDELARIA ROAD NE
ALBUQUERQUE, NM 87112

DETAILS

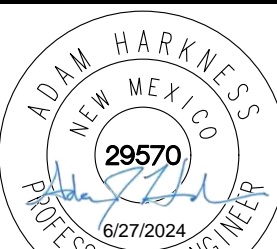

PROJECT NO.
196920000

SHEET
196920000_DT

C700