



ALBUQUERQUE FIRE MARSHAL'S  
DIVISION OFFICE PLANS  
CHECKING DIVISION  
**PERMIT**  
PERMIT NUMBER: FP 22-011322  
APPROVED DATE: 08/29/22  
**APPROVED**

THESE CONSTRUCTION DOCUMENTS WERE REVIEWED AND APPROVED BY THE ALBUQUERQUE FIRE MARSHAL'S OFFICE IN ACCORDANCE WITH THE CITY ORDINANCE, THE INTERNATIONAL FIRE CODE, AND NFPA STANDARDS. THIS PERMIT IS VALID FOR 180 DAYS. FINAL INSPECTION IS REQUIRED.

**FIRE FLOW:** 1500GPM 1 HYDRANT



© 2020 Isaacson & Arfman, Inc.  
This design, calculations, and concepts are owned by and remain the property of Isaacson & Arfman, Inc. and no part thereof shall be utilized by any person, firm, or corporation for any purpose whatsoever except with the written permission of Isaacson & Arfman, Inc.

Engineer

DUTCH BROS COFFEE  
2501 JUAN TABO BLVD NE  
ALBUQUERQUE, NM

DESIGN	ISSUE: DEVELOPMENT
PROJECT NUMBER: IA ###	FILE: -
DRAWN BY: XXX	CHECKED BY: XXX
DATE: XX-XX-XXXX	

SHEET TITLE  
FIRE  
HYDRANT  
LOCATION  
& ACCESS  
PLAN

SHEET NUMBER  
**FIRE 1**

### BUILDING INFORMATION

2501 JUAN TABO BLVD NE  
ALBUQUERQUE, NM

1,000 SQ. FT BUILDING  
15' - 0" BUILDING HEIGHT  
OCCUPANCY GROUP - A-2  
TYPE 2B CONSTRUCTION  
NON-SPRINKLED  
FLOWS = 1,500 GPM = 1 FH

1 EXISTING FIRE HYDRANT NEAR SITE.

BUILDING TO HAVE PREMISE ID SIGN VISIBLE  
FROM JUAN TABO BLVD..

ALL ACCESS ROADS AND FIRE LANES HAVE  
GRADES LESS THAN 10% AND A LOAD  
CAPACITY OF 75,000 POUNDS.

ALL ACCESS ROADS AND FIRE LANES WILL  
ACCOMMODATE A 28' MINIMUM TRUCK  
TURNING RADIUS.

FIRE APPARATUS ROADS SHALL HAVE AN  
UNOBSTRUCTED HEIGHT NOT LESS THAN  
13'-6".

THERE ARE NO OVERHEAD OBSTRUCTIONS  
ON SITE TO PROHIBIT LADDER TRUCK  
OPERATIONS

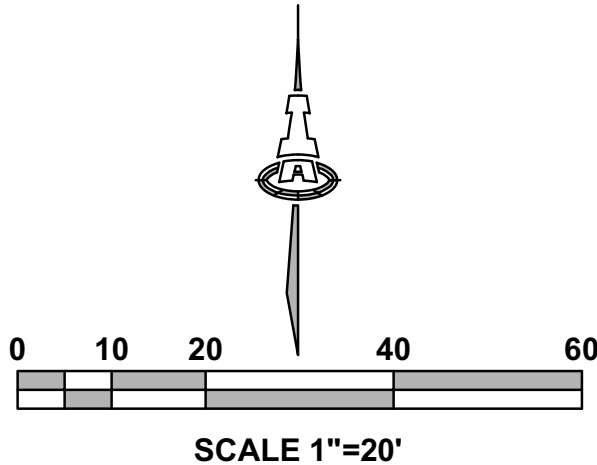

JUAN TABO BLVD

MURIEL ST

PHOENIX AVE

EXISTING  
FH #159

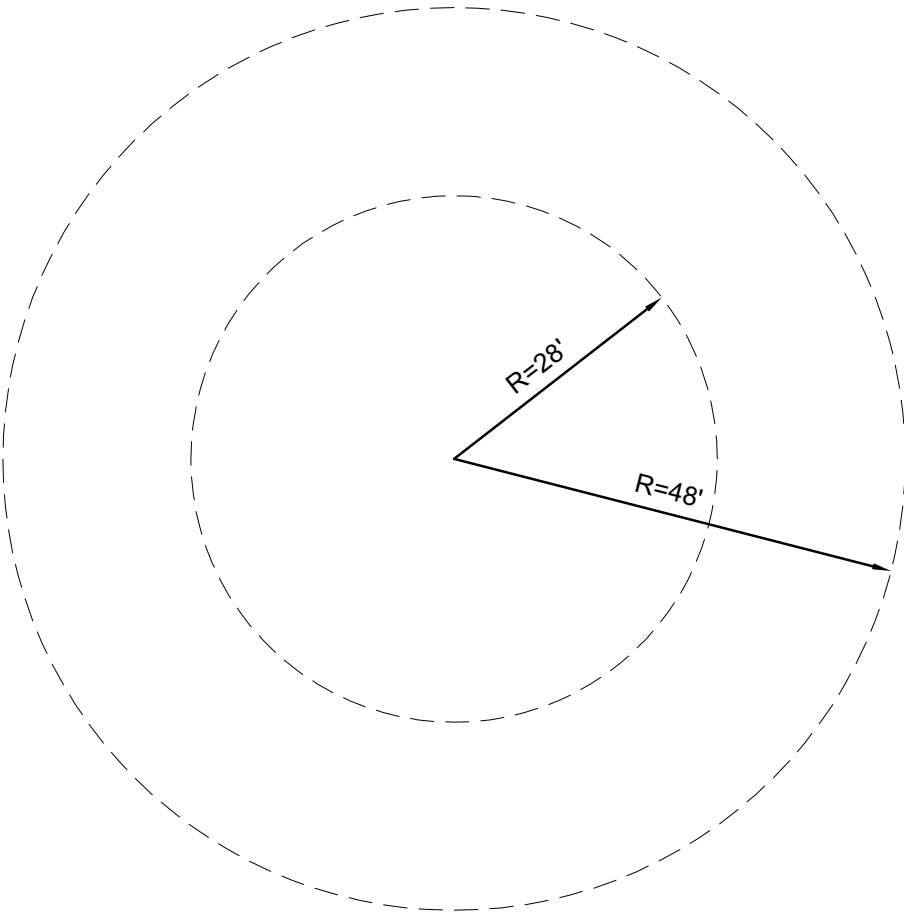
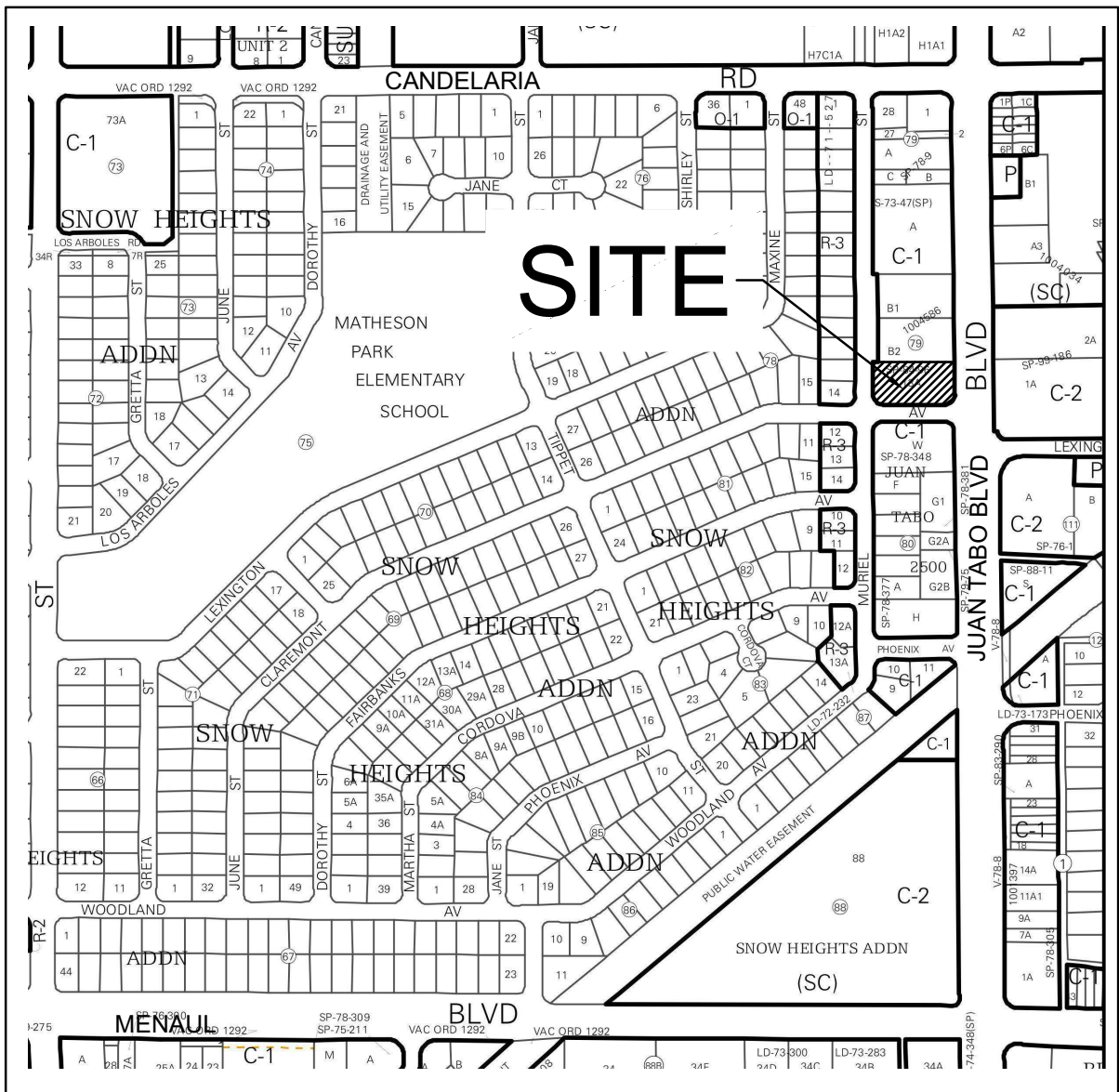
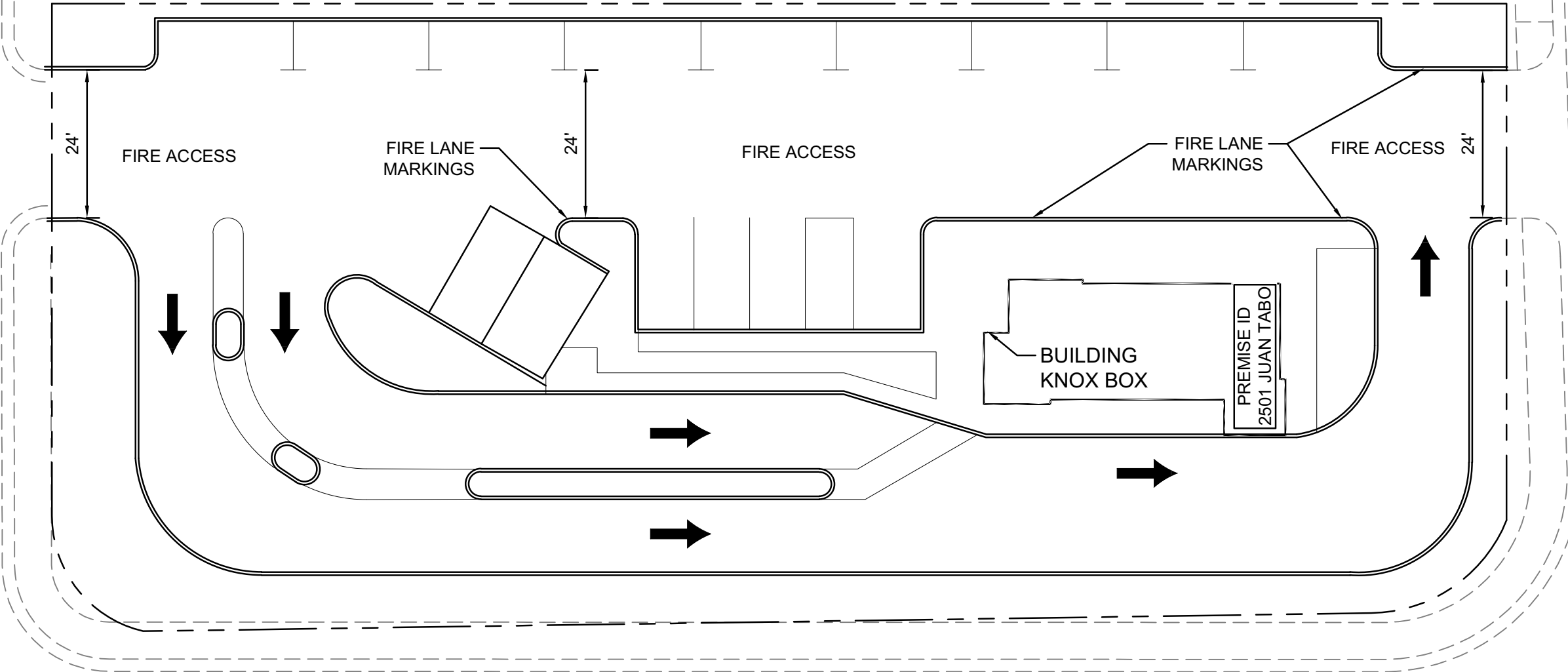

FIRE APPARATUS TURNING RADIUS  
1"=20'