

CITY OF ALBUQUERQUE

Planning Department
David Campbell, Director



Mayor Timothy M. Keller

May 6, 2019

Morey Walker, P.E.
Walker Engineering
905 Camino Sierra Vista
Santa Fe, NM 87505

**RE: Blake's Lotaburger #64
1801 Juan Tabo Blvd. NE
Grading and Drainage Plan
Engineer's Stamp Date: No Stamp Date
Hydrology File: H21D012**

Dear Mr. Walker:

PO Box 1293

Based upon the information provided in your submittal received 04/25/2019, the Grading & Drainage Plan **is not** approved for Building. The following comments need to be addressed for approval of the above referenced project:

Albuquerque

NM 87103

www.cabq.gov

1. Please provide an engineer's stamp date.
2. Please provide all missing information from the Grading Plan Checklist. (c, d, e, & f) Per the DPM Chapter 22 Section 7 - Grading Plan Checklist, the following must be on the Grading Plan.
 - a. Please provide an engineer's stamp with a signature and date.
 - b. Please use 1" = 20' for the scale.
 - c. Please provide a Vicinity Map.
 - d. Please provide the Benchmark information (location, description and elevation) for the survey contour information provided.
 - e. Please provide the FIRM Map and flood plain note with effective date.
 - f. Please provide a legal Description of the property.
3. Please use the procedure for 40 acre and smaller basins as outlined in Chapter 22, Part A of the Development Process Manual (DPM). Please provide both the existing conditions and proposed conditions for the 100 year-6 hour storm event. See Attached pdf (this is a draft of the DPM update). This site is in Precipitation Zone 4.
4. The storm water quality (SWQ) volume for this site is required in order to manage the storm water runoff. Since this is a redevelopment site, the storm water quality volume is calculated based on the 0.48 inch storm. To calculate the required storm water quality volume to be captured, multiply the impervious area by 0.28 inches for the 80th

CITY OF ALBUQUERQUE

Planning Department
David Campbell, Director



Mayor Timothy M. Keller

percentile storm. This required storm water quality volume can be captured within the depressed areas of the landscaping. Please also state the total provided storm water quality volume for the site.

5. Please label each storm water quality pond with the provided SWQ volume.
6. Please provide the weir calculations for the curb cuts per the DPM. A coefficient of 2.7 is typically used for the equation $(6.60) Q = CLH^{2/3}$.
7. As a reminder, if the project total area of disturbance (including the staging area and any work within the adjacent Right-of-Way) is 1 acre or more, then an Erosion and Sediment Control (ESC) Plan and Owner's certified Notice of Intent (NOI) is required to be submitted to the Stormwater Quality Engineer (Curtis Cherne, PE, ccherne@cabq.gov, 924-3420) 14 days prior to any earth disturbance.
8. Also as a reminder, please provide a Drainage Covenant for the proposed detention ponds per Chapter 17 of the DPM prior to Permanent Release of Occupancy. Please submit this on the 4th floor of Plaza de Sol. A \$25 fee will be required.
9. Standard review fee of \$150 will be required at the time of resubmittal.

PO Box 1293

Albuquerque

If you have any questions, please contact me at 924-3995 or rbrissette@cabq.gov.

NM 87103

Sincerely,

www.cabq.gov

Renée C. Brissette, P.E. CFM
Senior Engineer, Hydrology
Planning Department



City of Albuquerque

Planning Department

Development & Building Services Division

DRAINAGE AND TRANSPORTATION INFORMATION SHEET (REV 11/2018)

Project Title: Blake's Lotaburger #64 Building Permit #: _____ Hydrology File #: _____

DRB#: _____ EPC#: _____ Work Order#: _____

Legal Description: _____

City Address: 1801 Juan Tabo Boulevard NE

Applicant: Barbara Felix Architecture + Design Contact: Barbara Felix

Address: 511 Agua Fria Street, Santa Fe, NM 87501

Phone#: 505-820-1555 Fax#: 505-820-1527 E-mail: info@bjfelix.com

Owner: Blake's Lotaburger LLC Contact: Paula Hayden

Address: 3205 Richmond Drive NE, Albuquerque, NM 87107

Phone#: 505-884-2160 Fax#: _____ E-mail: PHayden@lotaburger.com

TYPE OF SUBMITTAL: _____ PLAT (___ # OF LOTS) _____ RESIDENCE _____ DRB SITE ADMIN SITE

IS THIS A RESUBMITTAL?: _____ Yes No

DEPARTMENT: _____ TRAFFIC/ TRANSPORTATION HYDROLOGY/ DRAINAGE

Check all that Apply:

TYPE OF SUBMITTAL:

- ENGINEER/ARCHITECT CERTIFICATION
- PAD CERTIFICATION
- CONCEPTUAL G & D PLAN
- GRADING PLAN
- DRAINAGE MASTER PLAN
- DRAINAGE REPORT
- FLOODPLAIN DEVELOPMENT PERMIT APPLIC
- ELEVATION CERTIFICATE
- CLOMR/LOMR
- TRAFFIC CIRCULATION LAYOUT (TCL)
- TRAFFIC IMPACT STUDY (TIS)
- OTHER (SPECIFY) _____
- PRE-DESIGN MEETING?

TYPE OF APPROVAL/ACCEPTANCE SOUGHT:

- BUILDING PERMIT APPROVAL
- CERTIFICATE OF OCCUPANCY
- PRELIMINARY PLAT APPROVAL
- SITE PLAN FOR SUB'D APPROVAL
- SITE PLAN FOR BLDG. PERMIT APPROVAL
- FINAL PLAT APPROVAL
- SIA/ RELEASE OF FINANCIAL GUARANTEE
- FOUNDATION PERMIT APPROVAL
- GRADING PERMIT APPROVAL
- SO-19 APPROVAL
- PAVING PERMIT APPROVAL
- GRADING/ PAD CERTIFICATION
- WORK ORDER APPROVAL
- CLOMR/LOMR
- FLOODPLAIN DEVELOPMENT PERMIT
- OTHER (SPECIFY) _____

DATE SUBMITTED: April 24, 2019 By: Barbara Felix Architecture + Design

COA STAFF: _____

ELECTRONIC SUBMITTAL RECEIVED: _____

FEE PAID: _____

STAKING NOTE

INFORMATION SHOWN IS FOR GRADING AND DRAINAGE ONLY AND IS NOT TO BE USED FOR STAKING PURPOSES. SEE SITE PLAN FOR ACTUAL LOCATION OF IMPROVEMENTS.

TOPOGRAPHY NOTE

ALL EXISTING TOPOGRAPHIC SURVEY DATA SHOWN ON THESE PLANS HAS BEEN OBTAINED AND CERTIFIED BY OTHERS. WALKER ENGINEERING HAS UNDERTAKEN NO FIELD VERIFICATION OF THIS TOPOGRAPHY INFORMATION, AND MAKES NO REPRESENTATION PERTAINING THERETO, AND ASSUMES NO RESPONSIBILITY OR LIABILITY THEREOF OF THIS TOPOGRAPHY. WALKER ENGINEERING RESPONSIBILITY IS LIMITED TO THE ENGINEERING ANALYSIS THAT UTILIZES THE TOPOGRAPHY SURVEY.

SNOWHEIGHTS BOULEVARD N.E.

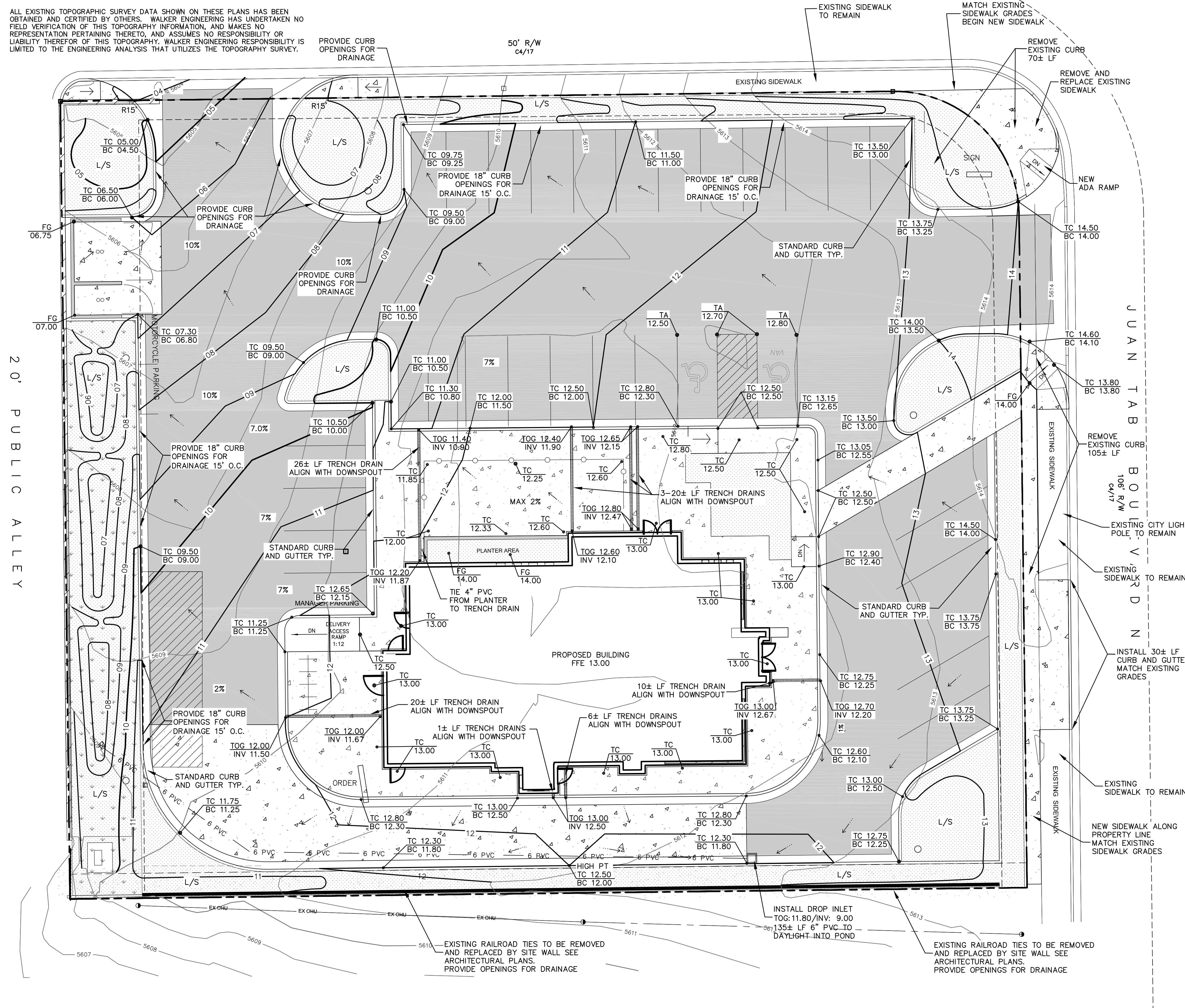

Civil Engineering • Water Resources
Traffic Engineering

W•E

Walker Engineering
905 Camino Sierra Vista
Santa Fe, NM 87505

505-820-7980
FAX 505-820-3539
E-MAIL civil@walkerengineering.net

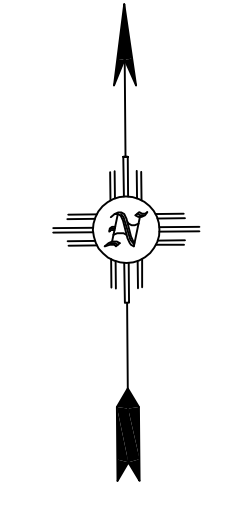
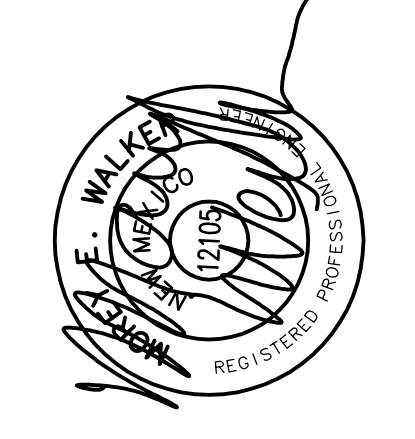

SCALE: 1" = 10'
10' 0 10'
CONTOUR INTERVAL = ONE FOOT (1')

Walker Engineering
905 Camino Sierra Vista
Santa Fe, NM 87501

Stormwater Drainage Calculations
Project: Blake's Lotaburger #64
Juan Tabo, Albuquerque NM

Project No: 18-150
Date: 10/30/2018

Developable Area: 0.70 Acres
30576.00 Sq Ft

Description	Area (SF)	Area (Ac.)	C	C*A
Existing Impervious	26675.00	0.61	0.95	0.582
Undeveloped/Landscape	3901.00	0.09	0.55	0.049
Composite	30576.00	0.09	0.90	0.631

Description	Area (SF)	Area (Ac.)	C	C*A
Additional Roof/Asphalt	-6657.00	-0.15	0.95	-0.15
Undeveloped/Landscape	37233.00	0.85	0.55	0.47
Composite	30576.00	0.70	0.46	0.32

Description	C*A	Rainfall (in/hr)	Discharge (cfs)
Present Land Use	0.63	7.3	4.61
Proposed Land Use	0.32	7.3	2.37
Difference	-0.31	0.00	-2.23

There is no additional impervious area, therefore there is no increase in runoff from this site.

LEGEND

- 60 ——— EXISTING CONTOURS
- 65.0 ——— DESIGN CONTOURS
- - - - - SITE BOUNDARY
- FG 40.50 — PROPOSED SPOT ELEVATION
- FG ——— FIELD GRADE
- TA ——— TOP OF ASPHALT
- TC/BC ——— TOP OF CURB/BOTTOM OF CURB
- L/S ——— LANDSCAPE AREA
- ← ——— WATER FLOW DIRECTION
- FFE ——— FINISHED PAD
- ——— NEW ASPHALT
- ——— NEW CONCRETE

BLAKE'S
LOTABURGER #64
1801 JUAN TABO BLVD. NE
ALBUQUERQUE, NM 87112

ISSUED		DESCRIPTION
MARK	DATE	

PROJECT NO.	FILE NAME	DRAWN BY	CHECKED BY

Sheet Name
GRADING AND DRAINAGE PLAN

Sheet No.
C1

SHEET NO. ___ OF ___ SHEETS