

THE DETAIL SHOWN HEREON IS TAKEN FROM THE EROSION AND SEDIMENT CONTROL PLAN DATED 11-18-2016, AND APPROVED 12-01-2016. THE REFERENCED PLAN IS 36"x48", AND SUPPORTS BOTH PRIVATE BUILDING PERMIT AND PUBLIC WORK ORDER CONSTRUCTION FOR THE COMMON OWNER. THE DETAILS SHOWN HEREON COVER THE PORTION OF WORK OUTSIDE THE GENERAL CONTRACTOR'S LIMITS.

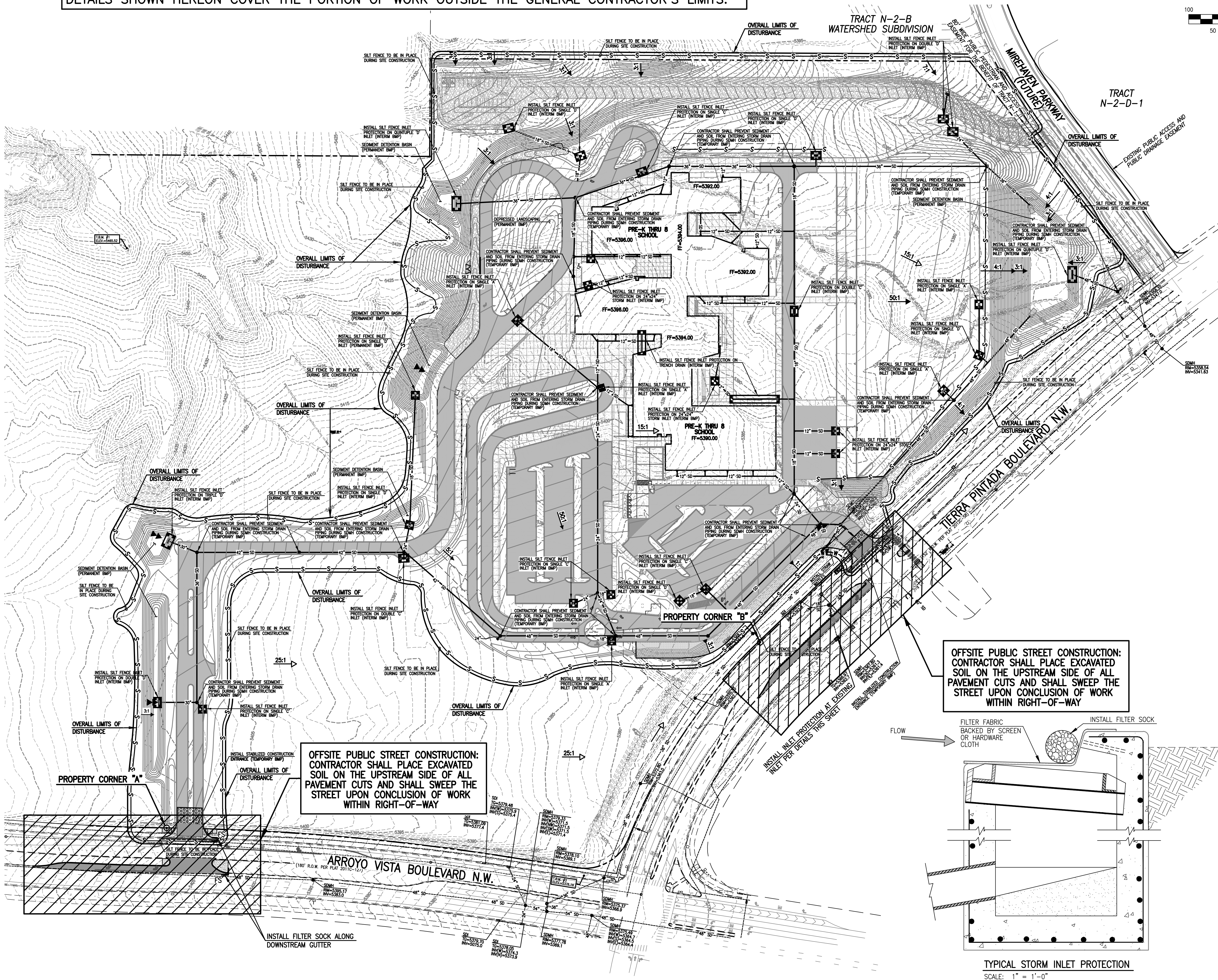

EROSION CONTROL LEGEND:

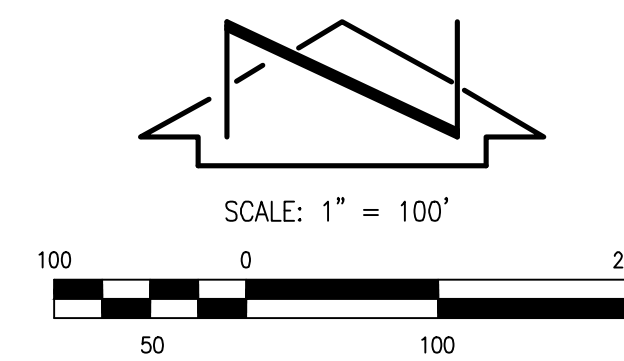
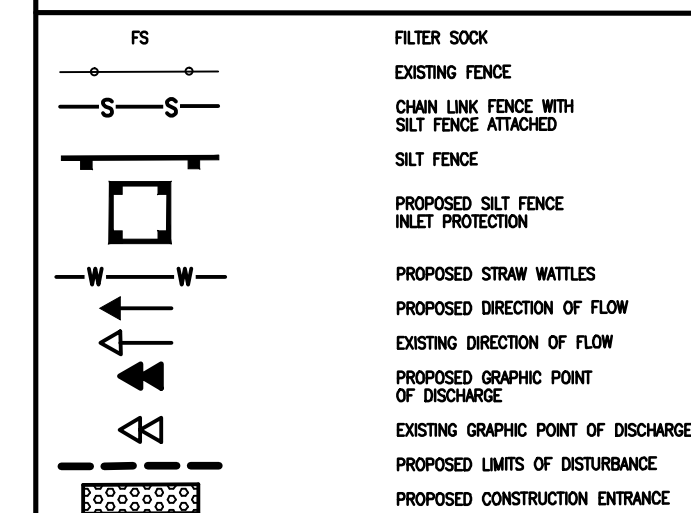

EROSION AND SEDIMENT CONTROL MEASURES:

1. THE CONTRACTOR SHALL ENSURE THAT NO SOIL ERODES INTO PUBLIC RIGHT-OF-WAY OR ONTO PRIVATE PROPERTY.
2. THE CONTRACTOR SHALL PROMPTLY CLEAN UP ANY MATERIAL EXCAVATED WITHIN THE PUBLIC RIGHT-OF-WAY SO THAT THE EXCAVATED MATERIAL IS NOT SUSCEPTIBLE TO BEING WASHED DOWN THE STREET.
3. SPOILS FROM THE PROJECT SHALL NOT BE DEPOSITED OR STORED IN THE STREET OR ROADWAY.
4. SPOILS SHALL BE STAGED ON THE UPSTREAM SIDE OF TRENCHES WHEN BEING REMOVED.
5. THE CONTRACTOR SHALL CLEAN AND REMOVE ALL FLUTING DUST, SOIL AND DEBRIS RESULTING FROM THIS PROJECT FROM THE STREET AT THE END OF EACH DAY.
6. CONTRACTOR SHALL LEAVE THE AREA IMMEDIATELY BEHIND THE CURB DEPRESSED TO CONTAIN RUNOFF FLOWS AND SEDIMENT.
7. CONCRETE TRUCKS SHALL BE SENT BACK TO THE PLANT FOR WASHING; THE WASHING OF CONCRETE TRUCKS SHALL NOT BE PERMITTED WITHIN THE PUBLIC RIGHT-OF-WAY.
8. WHEN APPLICABLE, CONTRACTOR SHALL SECURE "TOPSOIL DISTURBANCE PERMIT" FROM THE CITY AND/OR FILE A NOTICE OF INTENT (NOI) WITH THE EPA PRIOR TO BEGINNING CONSTRUCTION.
9. UNLESS FINAL STABILIZATION IS OTHERWISE PROVIDED FOR, ANY AREAS OF EXCESS DISTURBANCE (TRAFFIC ACCESS, STORAGE YARD, EXCAVATED MATERIAL, ETC.) SHALL BE RE-SEEDING ACCORDING TO CITY OF ALBUQUERQUE SPECIFICATION 1012 "MISCELLANEOUS SEEDING". THIS WILL BE CONSIDERED INCIDENTAL TO CONSTRUCTION, WHEREFORE, NO SEPARATE PAYMENT WILL BE MADE.
10. PROTECT EXISTING STORM DRAIN FACILITIES FROM SEDIMENT AS REQUIRED.
11. UTILITY TRENCH EXCAVATION SPOILS SHALL BE PLACED ON THE UPHILL SIDE OF THE TRENCH.

BENCHMARKS

PROJECT BENCHMARK
USGAS SURVEY CONTROL BRASS DISC, STAMPED "REWARD 1969", SET IN A CONCRETE POST 0.3 FEET ABOVE GROUND APPROXIMATELY 600 FEET NORTHWEST OF THE I-40 AND 98TH STREET N.W. INTERCHANGE. ELEVATION = 5318.688 FEET (NAVD 1988)

TEMPORARY BENCHMARK #1 (T.B.M.)
A 1/2" REBAR WITH CAP STAMPED "HMCOS CONTROL NMP5 11184" SET IN DIRT JUST SOUTH OF A JUNCTION OF FOUR DIRT ROADS NEAR THE NORTHERN BOUNDARY, AS SHOWN HEREON. ELEVATION = 5462.52 FEET (NAVD 1988)

TEMPORARY BENCHMARK #2 (T.B.M.)
A 1/2" REBAR WITH CAP STAMPED "HMCOS CONTROL NMP5 11184" SET IN DIRT AT THE NORTHWEST INTERSECTION OF ARROYO VISTA BLVD. NW AND TIERRA PINADA BLVD. NW, AS SHOWN HEREON. ELEVATION = 5464.66 FEET (NAVD 1988)

TEMPORARY BENCHMARK #3 (T.B.M.)
A 1/2" REBAR WITH CAP STAMPED "HMCOS CONTROL NMP5 11184" SET IN DIRT AT THE NORTHWEST INTERSECTION OF ARROYO VISTA BLVD. NW AND TIERRA PINADA BLVD. NW, AS SHOWN HEREON. ELEVATION = 5376.19 FEET (NAVD 1988)

LEGEND

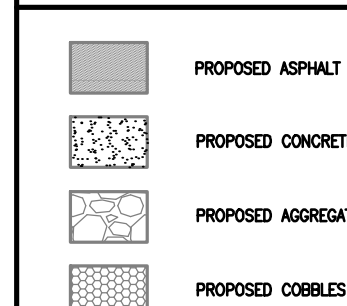

SURVEY NOTE:

THIS IS NOT A BOUNDARY SURVEY; DATA IS SHOWN FOR ORIENTATION ONLY. THE BOUNDARY, TOPOGRAPHIC & UTILITY SURVEY INFORMATION DEPICTED BY THIS PLAN IS BASED UPON THE BOUNDARY, TOPOGRAPHIC AND UTILITY SURVEY PREPARED BY HIGH MESA CONSULTING GROUP, NMP5 11184, DATED 01/06/2016 (2014.181.9).

HIGH MESA Consulting Group
Engineers, Surveyors & Sustainable Utility Consultants
6010-B Midway Park Blvd. NE • Albuquerque, New Mexico 87109
Phone: 505.345.4250 • Fax: 505.345.4254 • www.highmesacg.com

2016.181.2

CITY OF ALBUQUERQUE PUBLIC WORKS DEPARTMENT ENGINEERING DEVELOPMENT GROUP	
TITLE: EROSION AND SEDIMENT CONTROL PLAN APS NW K TO 8 SCHOOL PUBLIC STREET IMPROVEMENTS	
Design Review Committee	City Engineer Approval
City Project No. 655785	Zone Map No. H-7/8, J-7/8
Sheet 3A	Of 21