

The map is a detailed site plan for the APS Community Stadium. The central feature is the 'SITE', a large rectangular area with diagonal hatching. To the north of the site is the 'PETROGLYPH NATIONAL MONUMENT'. To the west is 'WESTLAND NORTH', which includes a 'SU2 FOR FGA' (Future Growth Area) and a 'WATERSHED' area. To the east is another 'WATERSHED' area. To the south is the 'NORTHWEST AREA ESCAPEMENT PLAN VIEW' and 'SU2 FOR TOWN CENTER VILLAGE'. A road labeled 'ARROYO VISTA BLVD. NW' runs along the bottom of the site. The map also shows various other areas, including 'SU2 FOR FGA' and 'SU2 FOR TOWN CENTER VILLAGE'. A north arrow and a scale bar are located in the top left corner. The map is divided into several sections by colored lines, and various labels and numbers are scattered throughout.

THIS PLAN ADDRESSES GENERAL AND SPECIFIC MEASURES FOR CONSTRUCTION PHASE EROSION, SEDIMENT AND DUST CONTROL. IT IS INTENDED TO COMPLEMENT THE PROJECT SPECIFIC STORM WATER POLLUTION AND PREVENTION PLAN (SWPPP) PREPARED FOR THIS PROJECT. THE CONTRACTOR SHALL OBTAIN ALL REQUIRED PERMITS BEFORE BEGINNING CONSTRUCTION.

3. THE CONTRACTOR SHALL INSTALL ALL PERIMETER BMPs BEFORE BEGINNING CONSTRUCTION.

4. REFER TO THE PROJECT SPECIFIC SWPPP PREPARED BY THE GENERAL CONTRACTOR FOR PROJECT SPECIFIC PHASING AND INFORMATION. THIS PROJECT SHALL FOLLOW THE PHASING AND PHASES TO MINIMIZE THE EXTENT AND DURATION OF SURFACE DISTURBANCE.

5. REFER TO THE GRADING AND DRAINAGE PLAN PREPARED BY HIGH MEAS CONSULTING GROUP, DATED 11-17-2016.

6. THE CONTRACTOR SHALL INSURE THAT NO SOIL EXPOSES FROM THE SITE INTO PUBLIC RIGHT-OF-WAY OR PRIVATE PROPERTY.

7. THE CONTRACTOR SHALL PROMPTLY CLEAN ANY MATERIAL EXPOSED WITHIN THE PUBLIC RIGHT-OF-WAY SO THAT THE EXCAVATED MATERIAL IS NOT SUSCEPTIBLE TO BEING WASHED DOWN THE STREET.

8. THE CONTRACTOR SHALL CLEAN AND REMOVE ALL FUGITIVE DUST, SOIL AND DEBRIS RESULTING FROM THIS PROJECT FROM THE ADJACENT STREETS AT THE END OF EACH DAY.

9. THE CONTRACTOR SHALL IMPLEMENT AND MAINTAIN ALL GOOD HOUSEKEEPING MEASURES OUTLINED IN THE SWPPP INCLUDING, BUT NOT LIMITED TO, THE FOLLOWING:

10. THE CONTRACTOR SHALL PROMPTLY REMOVE SEDIMENT ACCUMULATION FROM SILT FENCES AND OTHER STRUCTURAL BMPs WITHIN 48 HOURS OF A RAINFALL EVENT.

11. THE CONTRACTOR SHALL IMPLEMENT OTHER STRUCTURAL EROSION CONTROL MEASURES AS REQUIRED TO COMPLY WITH THE EROSION AND SEDIMENT CONTROL PLAN AND SWPPP. THESE MEASURES MAY INCLUDE BUT ARE NOT LIMITED TO SILT FENCES, EARTHEN DICES, DRAINAGE DIVERSIONS, SEDIMENT TRAPS, CHECK DAMS, SUBSURFACE DRAINS, PIPE SLOPE DRAINS, LEVEL SPREADERS, STORM WATER RETENTION TANKS, CHECK DAMS AND TEMPORARY OR PERMANENT SEDIMENT DETENTION BASINS. THE FOLLOWING MEASURES ARE PROVIDED FOR THIS PROJECT:

- a. PERIMETER SILT FENCE
- b. INTERIOR SILT FENCE
- c. MATS
- d. ONSITE SILT PROTECTION
- e. INTERIM SEDIMENT DETENTION BASINS
- f. GRAVEL MULCH
- g. INTERIM REVEGETATION
- h. SOIL STABILIZER OR TACKIFIER

12. CONCRETE TRUCKS SHALL BE REQUIRED TO OFF-LOAD PLANT MATERIAL TRACKING OF SEDIMENT AND DUST GENERATION.

13. CONCRETE TRUCKS SHALL BE REQUIRED TO BACK TO THE PLANT FOR WASHING. THE WASHING OF CONCRETE TRUCKS SHALL NOT BE PERMITTED ON THIS SITE UNLESS OTHERWISE PROVIDED FOR BY THIS PLAN. IF PROVIDED FOR BY THIS PLAN, CONCRETE TRUCKS MAY ONLY WASH OUT IN A DESIGNATED AND LINED WASHOUT FACILITY.

14. ALL WATER STORED ON SITE FOR THIS PROJECT ARE CONSIDERED PART OF THE PROJECT AND THEREFORE SUBJECT TO THE REQUIREMENTS OF THE EROSION AND SEDIMENT CONTROL PLAN AND SWPPP.

15. UPON COMPLETION OF MASS GRADING, ALL DISTURBED AREAS SHALL BE STABILIZED WITH PERMANENT CONSTRUCTION, LANDSCAPING, VEGETATION AND/OR GRAVEL MULCH. SILT PERMITS CAN BE REMOVED UPON SUCCESSFUL ESTABLISHMENT OF VEGETATION.

16. THROUGHOUT THE DURATION OF THIS PROJECT, CONTRACTOR SHALL IMPLEMENT, MAINTAIN AND INSPECT ALL BMPs, KEEPING RECORDS OF EACH INSPECTION IN ACCORDANCE WITH THE SWPPP, AND KEEP RECORDS OF THE INSTALLATION MAINTENANCE, AND REMOVAL OF EACH BMP.

17. THE CONTRACTOR SHALL PROMPTLY REMOVE ANY MATERIAL EXPOSED WITHIN THE PUBLIC RIGHT-OF-WAY SO THAT THE EXCAVATED MATERIAL IS NOT SUSCEPTIBLE TO BEING WASHED DOWN THE STREET.

18. THOSE PORTIONS OF THE COMPLETED PROJECT NOT STABILIZED WITH PERMANENT CONSTRUCTION OR FORMAL LANDSCAPING SHALL BE STABILIZED WITH NATIVE GRASS SEEDING FOR SANDY SOILS PER THE SEED MIX SPECIFIED HEREON AND SPECIFICATIONS CONTAINED WITHIN THE SWPPP.

19. FINAL STABILIZATION OF THE PROJECT SITE WILL CONSIST OF THE FOLLOWING MEASURES:

- a. PERMANENT BUILDING CONSTRUCTION
- b. PERMANENT PAVING
- c. FORMAL LANDSCAPING
- d. GRAVEL MULCH
- e. NATIVE GRASS VEGETATION

20. TOTAL SITE AREA = 109,927 AC± (BASED ON A BOUNDARY, TOPOGRAPHIC AND UTILITY SURVEY, 2014/1819, DATED 01/08/2016 PREPARED BY HIGH MEAS CONSULTING GROUP)

21. TOTAL DISTURBED AREA = 3.84 AC±

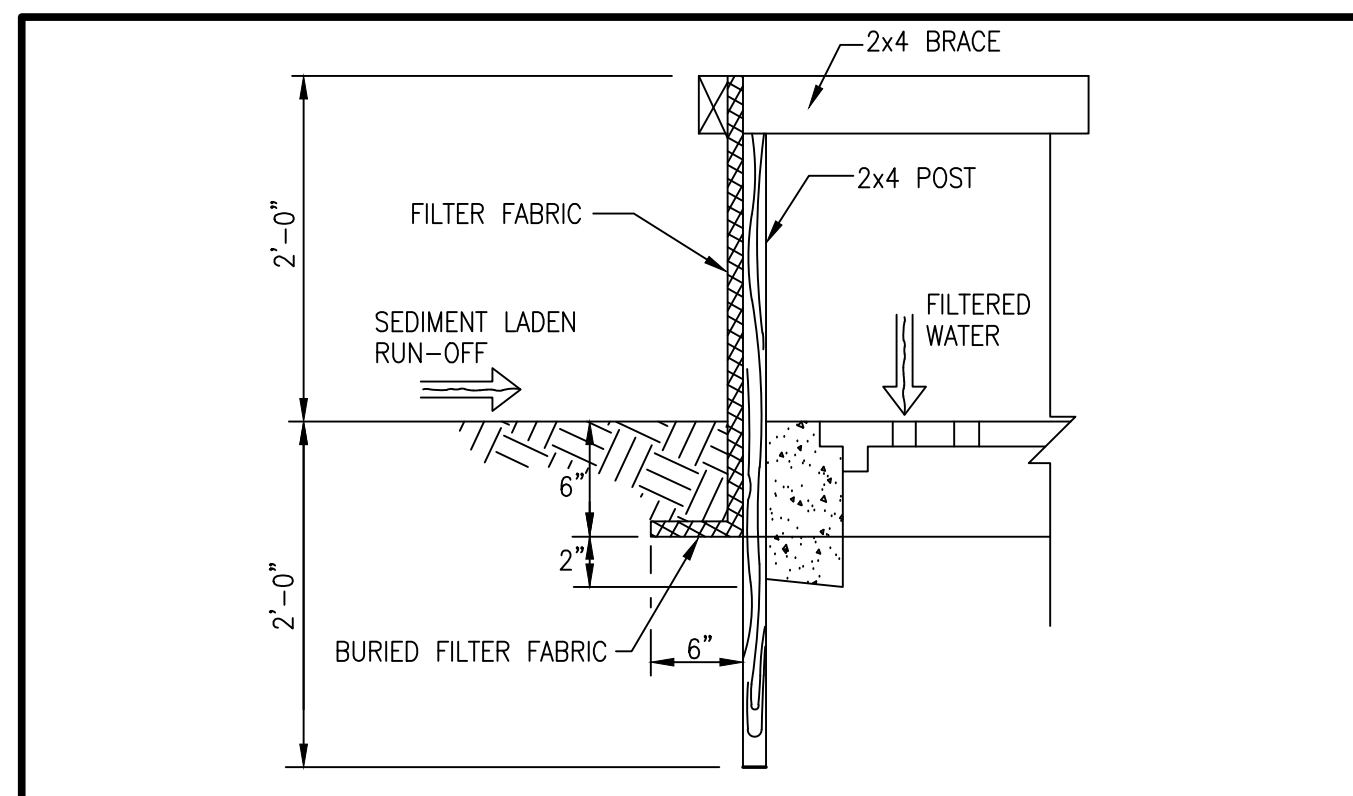
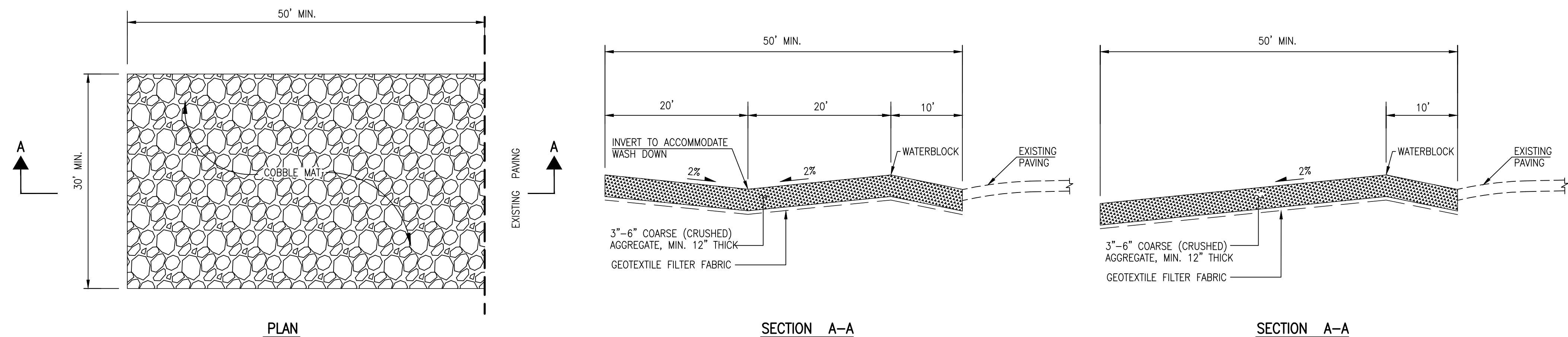

ESC-501