

# CITY OF ALBUQUERQUE



June 20, 2018

Graeme Means, PE  
High Mesa Consulting Group  
6010-B Midway Park Blvd NE  
Albuquerque, NM 87109

**Re: NW K Thru 8 Prototype School (Tres Volcanes)  
9601 Tierra Pintada Blvd NW  
60-Day Temporary Certificate of Occupancy- Transportation Development  
Transportation Development Final Inspection  
Engineer's/Architect's Stamp dated 11-17-16 (J08-D003A)  
Certification dated 06-08-18**

Dear Mr. Means

Based upon the information provided in your submittal received 6-08-18, Transportation Development has no objection to the issuance of a 60-day Temporary Certificate of Occupancy. This letter serves as a "green tag" from Transportation Development for a 60-day Temporary Certificate of Occupancy to be issued by the Building and Safety Division.

Prior to the issuance of a permanent Certificate of Occupancy, the following items must be addressed:

1. Close out of work order.
2. Please remove all construction equipment and debris from site.

Once corrections are complete resubmit acceptable package along with fully completed Drainage Transportation Information Sheet to front counter personnel for log in and evaluation by Transportation. For digital submittal and minor comments and/or repairs, please submit photos to [PLNDRS@cabq.gov](mailto:PLNDRS@cabq.gov) prior to submittal. If you have any questions, please contact me at (505) 924-3981.

Sincerely,

  
Ernie Gomez  
Plan Checker, Transportation & Hydrology  
Development Review Services

Racquel M. Michel, P.E.  
Traffic Engineer, Planning Dept.  
Development Review Services

eg via: email  
C: CO Clerk, File







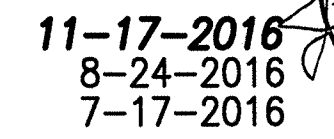
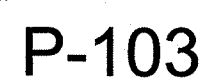



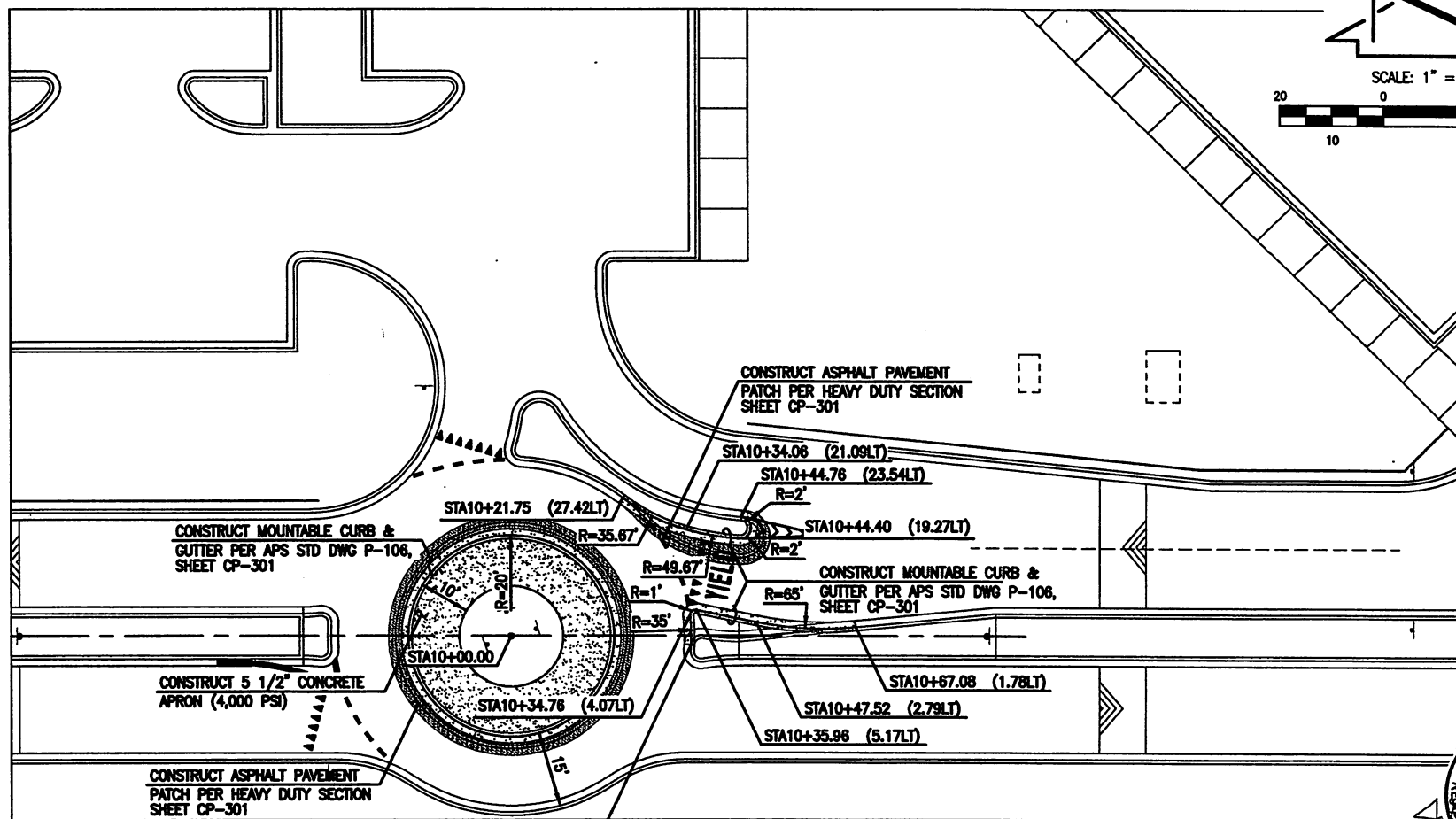

File Path: \\highmesa\projects\2015\20150551\_SKC-028.DWG Plot Date: 03-20-2018  
 File Name: 20150551\_SKC-028.DWG Plot Time: 1:26 pm

03-20-2018



2015.055.1

ROUNDABOUT MODIFICATIONS  
IMPROVEMENTS PLAN

SKC-028

DRAWN BY: J.Y.R.  
 REVIEWED BY: GM  
 DATE ISSUED: 03-20-2018  
 PROJECT NO.:

REFER TO

CP-102

**HIGH MESA Consulting Group**  
 Engineers, Surveyors & Information Utility Consultants

6010-B Midway Park Blvd. NE • Albuquerque, New Mexico 87109  
 Phone: 505.345.4250 • Fax: 505.345.4254 • www.highmesacg.com

NW K THRU 8 PROTOTYPE SCHOOL  
ALBUQUERQUE PUBLIC SCHOOLS







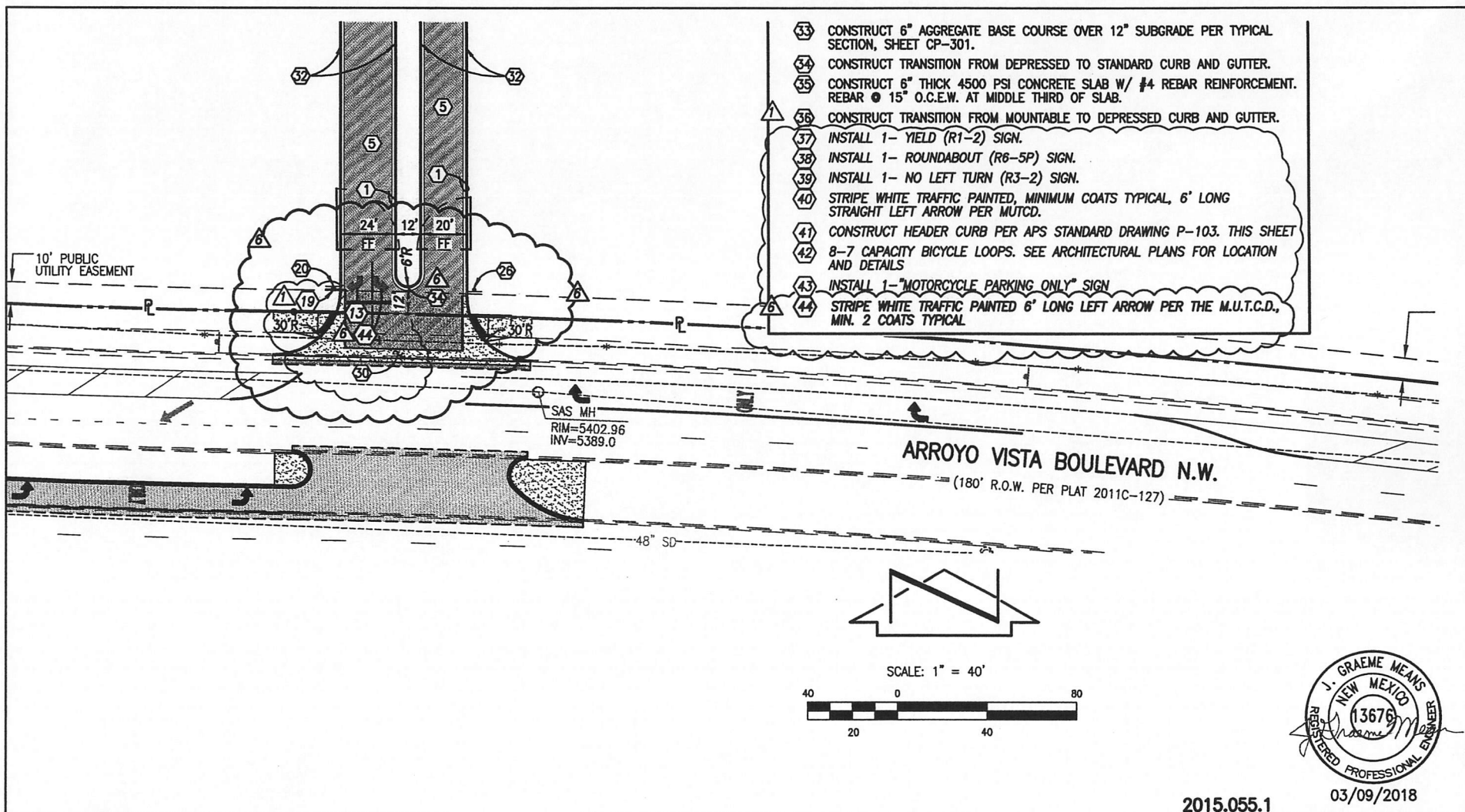

2015.055.1

03/09/2018

**HIGH MESA Consulting Group**  
Engineers, Surveyors & Architects Utility Consultants

6010-B Midway Park Blvd. NE • Albuquerque, New Mexico 87109  
Phone: 505.345.4250 • Fax: 505.345.4254 • www.highmesacg.com

NW K THRU 8 PROTOTYPE SCHOOL  
ALBUQUERQUE PUBLIC SCHOOLS

ARROYO VISTA  
ENTRANCE REVISION

SKC-031

DRAWN BY: SCC	REFER TO
REVIEWED BY: GM	
DATE ISSUED: 03-09-2018	CP-102
PROJECT NO:	





# City of Albuquerque

Planning Department

Development & Building Services Division

## DRAINAGE AND TRANSPORTATION INFORMATION SHEET (REV 09/2015)

Project Title: NW K THRU 8 PROTOTYPE SCHOOL (Tres Volcanes) Building Permit #: T201691974 City Drainage #: J08D003A  
 DRB#: \_\_\_\_\_ EPC#: \_\_\_\_\_ Work Order#: \_\_\_\_\_  
 Legal Description: Tract N-1, Watershed Subdivision, Albuquerque, NM  
 City Address: 9601 Tierra Pintada Blvd NW, Albuquerque, NM 87120

Engineering Firm: High Mesa Consulting Group Contact: Graeme Means  
 Address: 6010-B Midway Park Blvd. NE Albuquerque, NM 87109  
 Phone#: 505-345-4250 Fax#: 505-345-4254 E-mail: gmeans@highmesacg.com

Owner: Albuquerque Public Schools Contact: David Ritchey  
 Address: 915 Oak Street SE, Albuquerque, NM 87106  
 Phone#: 505-848-8876 Fax#: 505-246-9020 E-mail: ritchey\_d@aps.edu

Architect: Jon Anderson Architecture Contact: James Lucero  
 Address: 912 Roma Ave NW, Albuquerque, NM 87102  
 Phone#: 505-764-8306 Fax#: 505-764-2879 E-mail: james@jonandersonarchitect.com

Other Contact: \_\_\_\_\_ Contact: \_\_\_\_\_  
 Address: \_\_\_\_\_  
 Phone#: \_\_\_\_\_ Fax#: \_\_\_\_\_ E-mail: \_\_\_\_\_

Check all that Apply:

### DEPARTMENT:

☐ HYDROLOGY/ DRAINAGE  
☒ TRAFFIC/ TRANSPORTATION  
☐ MS4/ EROSION & SEDIMENT CONTROL

### TYPE OF SUBMITTAL:

☐ ENGINEER/ ARCHITECT CERTIFICATION  
☐ CONCEPTUAL G & D PLAN  
☐ GRADING PLAN  
☐ DRAINAGE MASTER PLAN  
☐ DRAINAGE REPORT  
☐ CLOMR/LOMR  
☒ TRAFFIC CIRCULATION LAYOUT (TCL)  
☐ TRAFFIC IMPACT STUDY (TIS)  
☐ EROSION & SEDIMENT CONTROL PLAN (ESC)  
☐ OTHER (SPECIFY) \_\_\_\_\_

IS THIS A RESUBMITTAL?: ☐ Yes ☒ No

### CHECK TYPE OF APPROVAL/ACCEPTANCE SOUGHT:

☒ BUILDING PERMIT APPROVAL  
☐ CERTIFICATE OF OCCUPANCY  
☐ PRELIMINARY PLAT APPROVAL  
☐ SITE PLAN FOR SUB'D APPROVAL  
☐ SITE PLAN FOR BLDG. PERMIT APPROVAL  
☐ FINAL PLAT APPROVAL  
☐ SIA/ RELEASE OF FINANCIAL GUARANTEE  
☐ FOUNDATION PERMIT APPROVAL  
☐ GRADING PERMIT APPROVAL  
☐ SO-19 APPROVAL  
☐ PAVING PERMIT APPROVAL  
☐ GRADING/ PAD CERTIFICATION  
☐ WORK ORDER APPROVAL  
☐ CLOMR/LOMR  
☐ PRE-DESIGN MEETING  
☐ OTHER (SPECIFY) \_\_\_\_\_

DATE SUBMITTED: 06/07/18 By: James Lucero; Project Architect

COA STAFF: \_\_\_\_\_ ELECTRONIC SUBMITTAL RECEIVED: \_\_\_\_\_



J O N A N D E R S O N A R C H I T E C T U R E  
9 1 2 R O M A A V E N U E N O R T H W E S T  
A L B U Q U E R Q U E N E W M E X I C O 8 7 1 0 2  
5 0 5 7 6 4 8 3 0 6 F A X 5 0 5 7 6 4 2 8 7 9

June 8, 2018

Racquel Michel, Traffic Engineer  
City of Albuquerque Planning Department  
Development and Building Services  
Plaza del Sol, 600 Second Street NW  
Albuquerque, NM 87102

**Re: Tres Volcanes Community Collaborative School** (Formerly Northwest K-8)  
9601 Tierra Pintada Blvd NW, Albuquerque, NM 87120  
Permit: **T201691974**

Ms. Michel,

Per your request, I have visited the above referenced site to visually observe the status of the site improvements to verify the work was in substantial compliance with the approved TCL Plan dated 11.18.16.

It appears that all work described on this drawing has been accomplished and is in compliance with the Traffic Circulation Layout on the approved TCL submittal.

This letter of Certification has been prepared to satisfy the requirements of the City of Albuquerque Transportation Department. If you should have any questions or comments concerning this letter or the above information, please do not hesitate to call.

Sincerely,

  
Jon Anderson, FAIA





# CITY OF ALBUQUERQUE



December 8, 2016

High Mesa Consulting Group  
J. Graeme Means  
6010-B Midway Park Blvd NE  
Albuquerque, NM 87109

**Re:** NW K thru 8 Prototype School  
**9601 Tierra Pintada Blvd NW**  
**Traffic Circulation Layout**  
Engineer's Stamp 11-17-16 (J08D003A)

Dear Mr. Means,

The TCL submittal received 11-18-16 is conditionally approved for Building Permit. Prior to final C.O. release from Transportation the work order requirements along Tierra Pintada Blvd NW, Arroyo Vista Blvd NW and Mirehaven Parkway NW must be completed. A copy of the stamped and signed plan will be needed for each of the building permit plans. Please keep the original to be used for certification of the site for final C.O. for Transportation.

PO Box 1293

Albuquerque

New Mexico 87103

[www.cabq.gov](http://www.cabq.gov)

When the site construction is completed and a Certificate of Occupancy (C.O.) is requested, use the original City stamped approved TCL for certification. Redline any minor changes and adjustments that were made in the field. A NM registered architect or engineer must stamp, sign, and date the certification TCL along with indicating that the development was built in "substantial compliance" with the TCL. Submit this certification TCL with a completed Drainage and Transportation Information Sheet to front counter personnel for log in and evaluation by Transportation.

Once verification of certification is completed and approved, notification will be made to Building Safety to issue Final C.O. To confirm that a final C.O. has been issued, call Building Safety at 924-3690.

Sincerely,

Racquel M. Michel, P.E.  
Traffic Engineer, Planning Dept.  
Development Review Services

mao via: email  
C: File