

NOTES:

LEGAL DESCRIPTION:
TRACT 185-A AND A PORTION OF TRACTS 182
THRU 184 TOWN OF ATRISCO GRANT AIRPORT
UNIT, CITY OF ALBUQUERQUE, BERNALILLO
COUNTY, NEW MEXICO

SITE AREA: 8.86 ACRES

FLOOD ZONE: PER FEMA MAP 35001C0326H, THE SITE FALLS
WITHIN FLOODZONE X DESIGNATED AS AREAS
OUTSIDE THE 0.2-PERCENT-ANNUAL-CHANCE
FLOODPLAIN

CONTOURS: BERNALILLO COUNTY CONTOURS, 2' INTERVAL

PER THE WEST MESA DIVERSION PROJECT, OFFSITE FLOWS FROM
NMDOT RIGHT-OF-WAY SHALL BE DIVERTED TO THE 2-48" CMP
CULVERTS AT THE NORTHWEST CORNER OF THE SITE. SEE DRAINAGE
MAP THIS SHEET FROM THE WEST MESA DIVERSION PROJECT
DRAINAGE ANALYSIS BY SMITH ENGINEERING CO., MAY 1997.

THE PORTION OF THE OFFSITE BASIN CONTRIBUTING TO THE
SURFACE FLOW ADJACENT TO THE SITE IS SHOWN ON THE NMDOT
BASIN MAP BELOW.

THERE IS A DEFINED DRAINAGE PATH SOUTH OF THE SITE. THIS
DRAINAGE PATH ENDS AT THE SOUTH END OF THE SITE, AND FLOWS
ENTER THE PROPERTY. A SWALE WILL BE GRADED ALONG THE
WEST PROPERTY LINE TO DIRECT THE OFFSITE FLOWS TO THE
EXISTING DRAINAGE SWALE IN THE NMDOT EASEMENT AT THE
NORTHWEST CORNER OF THE SITE. NMDOT DID NOT APPROVE
GRADING WITHIN THE NMDOT RIGHT-OF-WAY.

NMDOT DRNG
EASEMENT

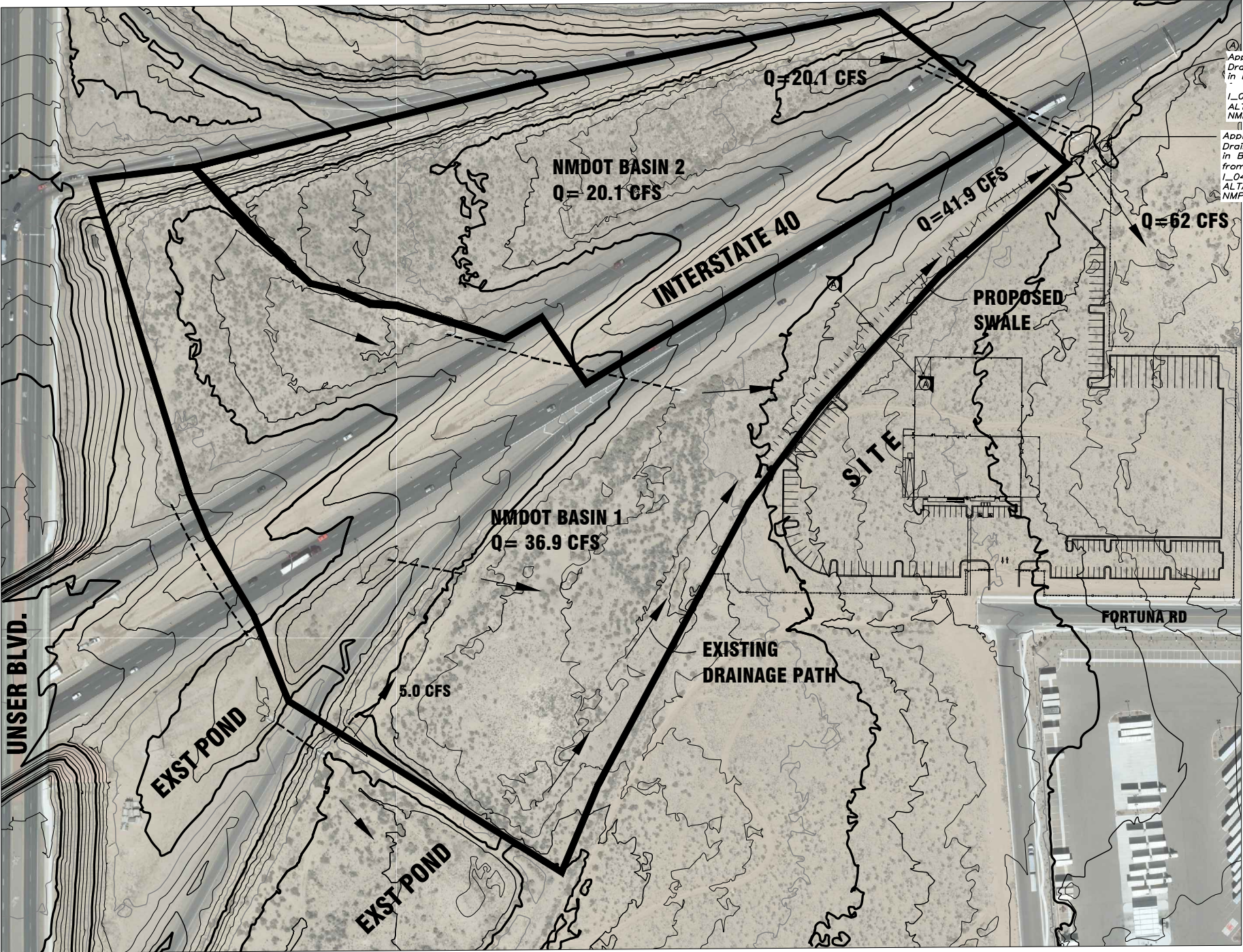

Approximate location of NMSHD
Drainage Easement Filed 05/07/96
in Book 96-12, Page 9864 Scaled
from NMSHC R/W Map Project
I_040-3(28)148 and as shown on
ALTA Survey by Will Plottner,
NMPS 14271, dated December, 2007.

Approximate location of NMSHD
Drainage Easement Filed 05/07/96
in Book 96-12, Page 9867 Scaled
from NMSHC R/W Map Project
I_040-3(28)148 and as shown on
ALTA Survey by Will Plottner,
NMPS 14271, dated December, 2007.

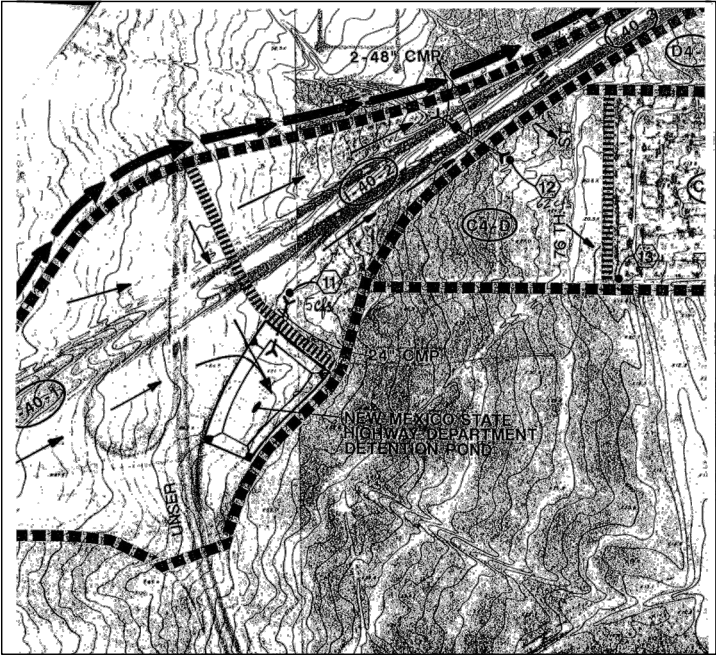

DRAINAGE MAP FROM WEST MESA DIVERSION PROJECT
DRAINAGE ANALYSIS BY SMITH ENGINEERING CO., MAY 1997

BASIN NO.	1	DESCRIPTION	BASIN DRAINING TO NMDOT EASEMENT
Area of basin flows =	780637 SF		17.9 Ac.
The following calculations are based on Treatment areas as shown in table to the right			
Sub-basin Weighted Excess Precipitation (see formula above)			LAND TREATMENT
Weighted E =			A = 75%
Sub-basin Volume of Runoff (see formula above)			B = 0%
V ₅₀₀ =			C = 0%
Sub-basin Peak Discharge Rate: (see formula above)			D = 25%
Q _p =			
Q _p =			36.9 cfs
BASIN NO.	2	DESCRIPTION	BASIN DRAINING TO CULVERT & NMDOT EASEMENT
Area of basin flows =	424720 SF		9.8 Ac.
The following calculations are based on Treatment areas as shown in table to the right			
Sub-basin Weighted Excess Precipitation (see formula above)			LAND TREATMENT
Weighted E =			A = 75%
Sub-basin Volume of Runoff (see formula above)			B = 0%
V ₅₀₀ =			C = 0%
Sub-basin Peak Discharge Rate: (see formula above)			D = 25%
Q _p =			20.1 cfs

DRAINAGE CALCULATIONS FOR OFFSITE NMDOT BASINS
LAND TREATMENTS FROM WEST MESA DIVERSION PROJECT DRAINAGE ANALYSIS

Channel Report

Hydroflow Express Extension for AutoCAD® Civil 3D® 2013 by Autodesk, Inc. Friday, Apr 5 2013

DEFLECTION SWALE ADJACENT TO NMDOT RIGHT-OF-WAY

Triangular	= 25.00, 2.00	Highlighted	= 0.80
Side Slopes (z:1)	= 1.00	Depth (ft)	= 41.90
Total Depth (ft)		Area (sqft)	= 8.64
Invert Elev (ft)	= 100.00	Velocity (ft/s)	= 4.85
Slope (%)	= 1.50	Wetted Perim (ft)	= 21.80
N-Value	= 0.020	Crit Depth, Yc (ft)	= 0.91
Calculations		Top Width (ft)	= 21.60
Compute by:	Known Q	EGL (ft)	= 1.17
Known Q (cfs)	= 41.90		

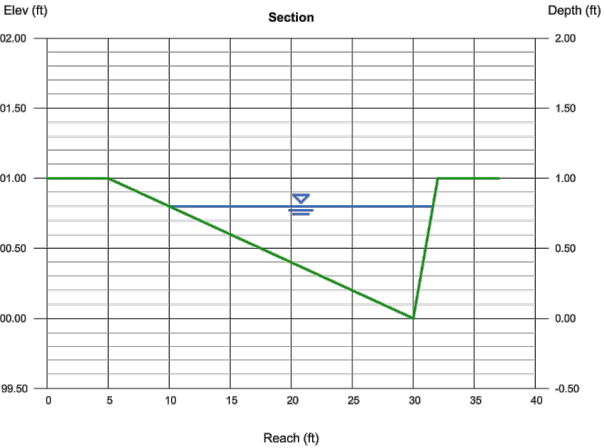

DIVERSION SWALE

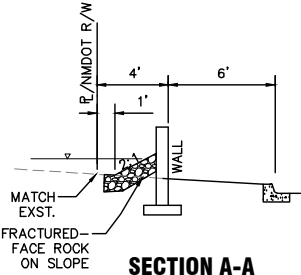

ISAACSON & ARFMAN, P.A.
Consulting Engineering Associates
128 Monroe Street N.E.
Albuquerque, New Mexico 87108
Ph: 505-268-8828 www.isacnll.com

1941 C-701 NMDOT EXH.dwg Apr 05,2013

This design, calculations, and concepts are owned by and remain the property of Isaacson & Arfman, P.A. and no part thereof shall be utilized by any person, firm or corporation for any purpose whatsoever except with the written permission of Isaacson & Arfman, P.A. ©

INLAND KENWORTH
FORTUNA WEST OF 76TH STREET

OFFSITE NMDOT DRAINAGE BASIN

Date:	4/5/13	No.:	Revision:	Date:	Job No.:
Drawn By:	ANW				PAGE
Old By:					SH. OF