

CITY OF ALBUQUERQUE

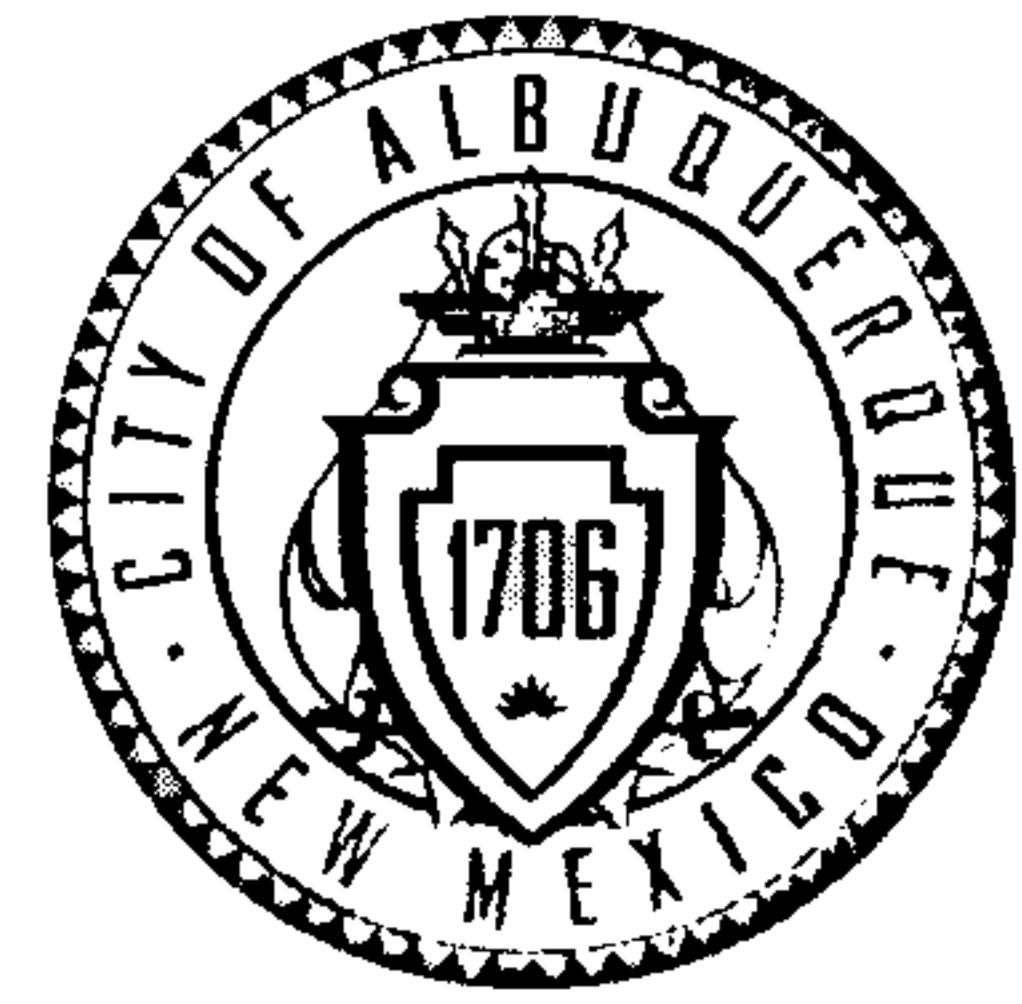

July 28, 2016

J. Graeme Means, PE
High Mesa Consulting Group
6010 -B Midway Park Blvd NE
Albuquerque, NM 87109

**Re: Reginald Chavez Elementary School
2700 Mountain Rd NW
Request Permanent C.O. - Accepted
Engineer's Stamp dated: 11/5/2014 (J12D009)
Certification dated: 7-26-16**

Dear Mr. Graeme,

PO Box 1293

Based on the Certification received 7/26/2016, the site is acceptable for release of Certificate of Occupancy by Hydrology.

Albuquerque

If you have any questions, you can contact me at 924-3695 or Totten Elliott at 924-3982.

New Mexico 87103 Sincerely,

www.cabq.gov

Rita Harmon, P.E.
Senior Engineer, Planning Dept.
Development Review Services

TE/RH

C: email,

Cordova, Camille C.; Miranda, Rachel; Sandoval, Darlene M.;
Lois Blocker

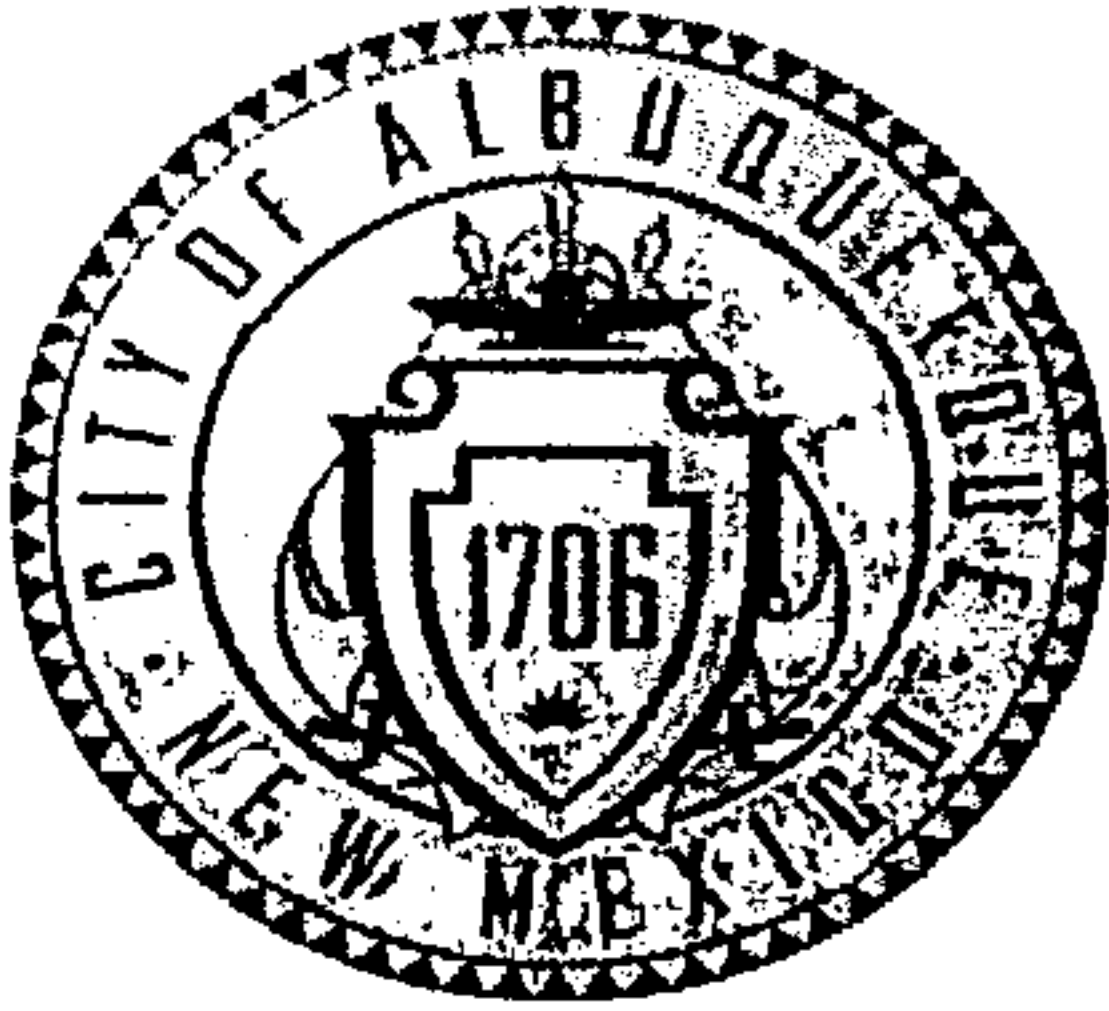

City of Albuquerque

Planning Department

Development & Building Services Division

DRAINAGE AND TRANSPORTATION INFORMATION SHEET (REV 09/2015)

Project Title: Reginald Chavez Elementary School Building Permit #: _____ City Drainage #: J-12 D009
 DRB#: _____ EPC#: _____ Work Order#: _____
 Legal Description: Unplatted Lands of Albuquerque Public Schools known as Reginald Chavez Elementary School
 City Address: 2700 Mountain Road NW

Engineering Firm: High Mesa Consulting Group Contact: Graeme Means #13676
 Address: 6010-B Midway Park Blvd NE, Albuquerque NM 87109
 Phone#: 505-345-4250 Fax#: 505-345-4254 E-mail: gmeans@highmesecg.com

Owner: Albuquerque Public Schools Contact: Myron Johnson
 Address: 915 Oak Street SE, Albuquerque NM, 87106
 Phone#: 848-8811 Fax#: _____ E-mail: johnson_my@aps.edu

Architect: Cherry See Reames Architects Contact: Marie Holloway
 Address: 220-A Gold Ave SW, Albuquerque NM 87102
 Phone#: 842-1278 Fax#: 766-9269 E-mail: msholloway@cherryseereames.com

Other Contact: _____ Contact: _____
 Address: _____
 Phone#: _____ Fax#: _____ E-mail: _____

Check all that Apply:

DEPARTMENT:

☒ HYDROLOGY/ DRAINAGE
☐ TRAFFIC/ TRANSPORTATION
☐ MS4/ EROSION & SEDIMENT CONTROL

TYPE OF SUBMITTAL:

☒ ENGINEER/ ARCHITECT CERTIFICATION
☐ CONCEPTUAL G & D PLAN
☒ GRADING PLAN
☐ DRAINAGE MASTER PLAN
☒ DRAINAGE REPORT
☐ CLOMR/LOMR
☐ TRAFFIC CIRCULATION LAYOUT (TCL)
☐ TRAFFIC IMPACT STUDY (TIS)
☐ EROSION & SEDIMENT CONTROL PLAN (ESC)
☐ OTHER (SPECIFY) _____

IS THIS A RESUBMITTAL?: ☐ Yes ☒ No

DATE SUBMITTED: 07-26-2016 By: Justin Schara

CHECK TYPE OF APPROVAL/ACCEPTANCE SOUGHT:

☐ BUILDING PERMIT APPROVAL
☒ CERTIFICATE OF OCCUPANCY

☐ PRELIMINARY PLAT APPROVAL
☐ SITE PLAN FOR SUB'D APPROVAL
☐ SITE PLAN FOR BLDG. PERMIT APPROVAL
☐ FINAL PLAT APPROVAL
☐ SIA/ RELEASE OF FINANCIAL GUARANTEE
☐ FOUNDATION PERMIT APPROVAL
☐ GRADING PERMIT APPROVAL
☐ SO-19 APPROVAL
☐ PAVING PERMIT APPROVAL
☐ GRADING/ PAD CERTIFICATION
☐ WORK ORDER APPROVAL
☐ CLOMR/LOMR

☐ PRE-DESIGN MEETING
☐ OTHER (SPECIFY) _____

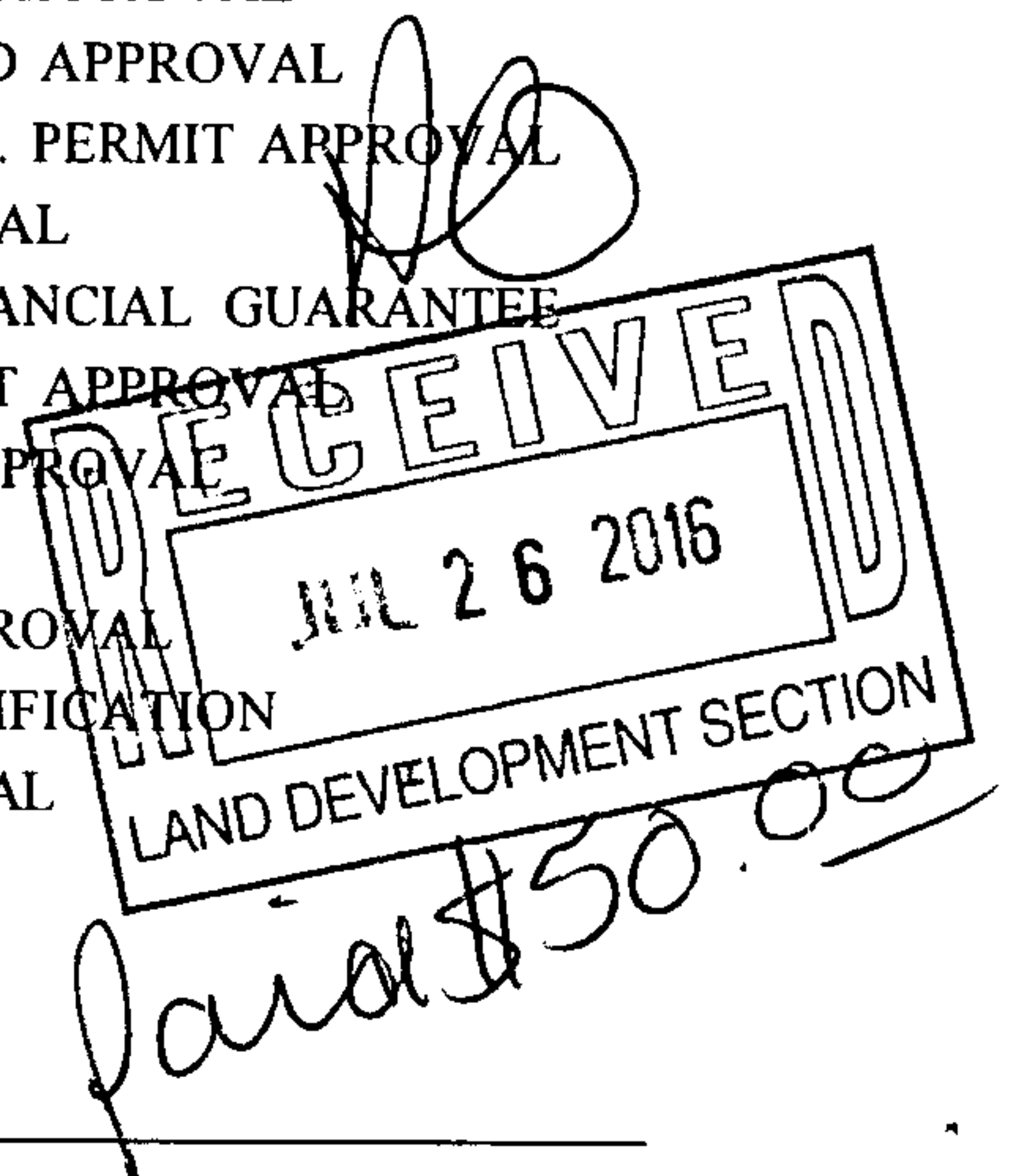

COA STAFF: _____ ELECTRONIC SUBMITTAL RECEIVED: _____

CITY OF ALBUQUERQUE

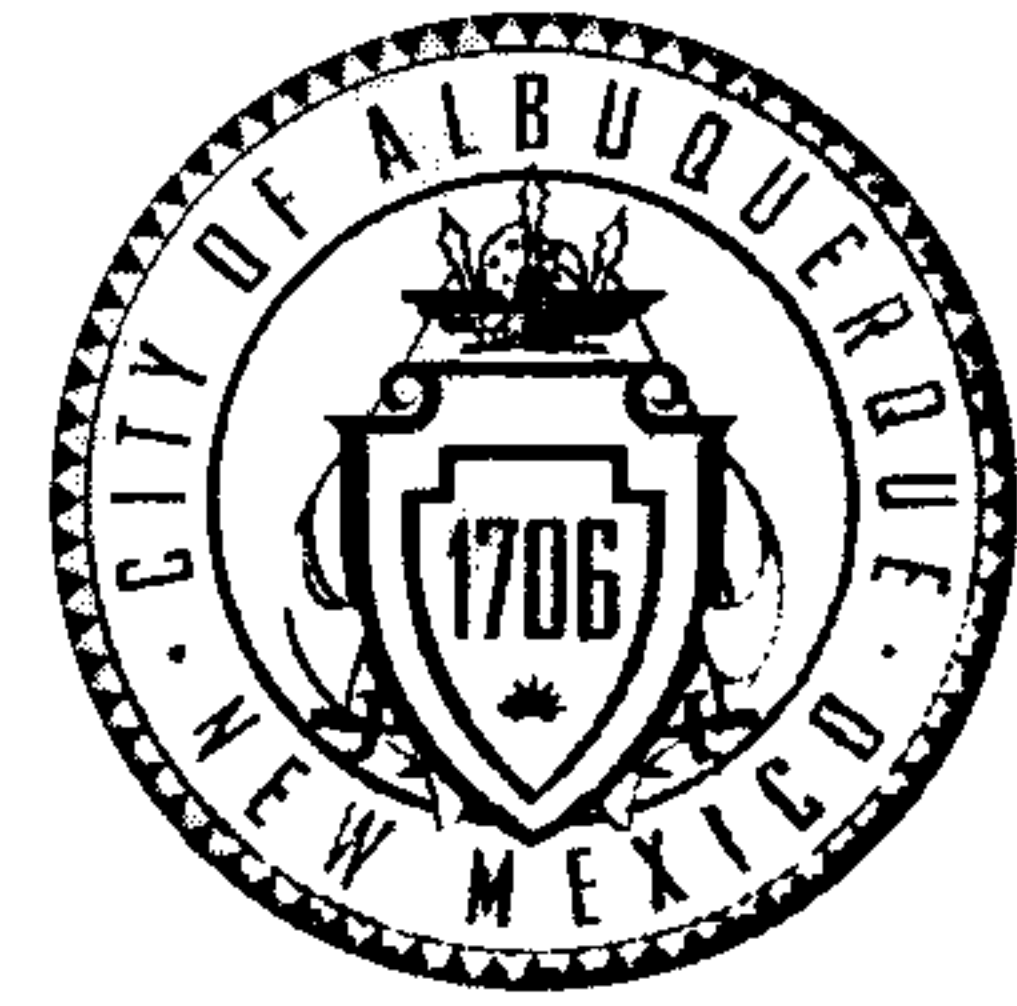

June 4, 2015

Jeffrey Mortensen, PE
High Mesa Consulting Group
6010 -B Midway Park Blvd NE
Albuquerque, NM 87109

**Re: Reginald Chavez ES Portables
2700 Mountain Rd NW
Engineer's Stamp dated: 8/4/2014 (J12D009)
Certification dated: 5-29-15**

Dear Mr. Mortensen,

Based on the Certification received 6/2/2015, the site is acceptable for release of Certificate of Occupancy by Hydrology.

PO Box 1293
H

If you have any questions, you can contact me at 924-3999 or Rudy Rael at 924-3977.

Albuquerque

New Mexico 87103

www.cabq.gov

Sincerely,

Shahab Biazar, P.E.
City Engineer, Planning Dept.
Development and Review Services

C: RR/SB
CO Clerk
email

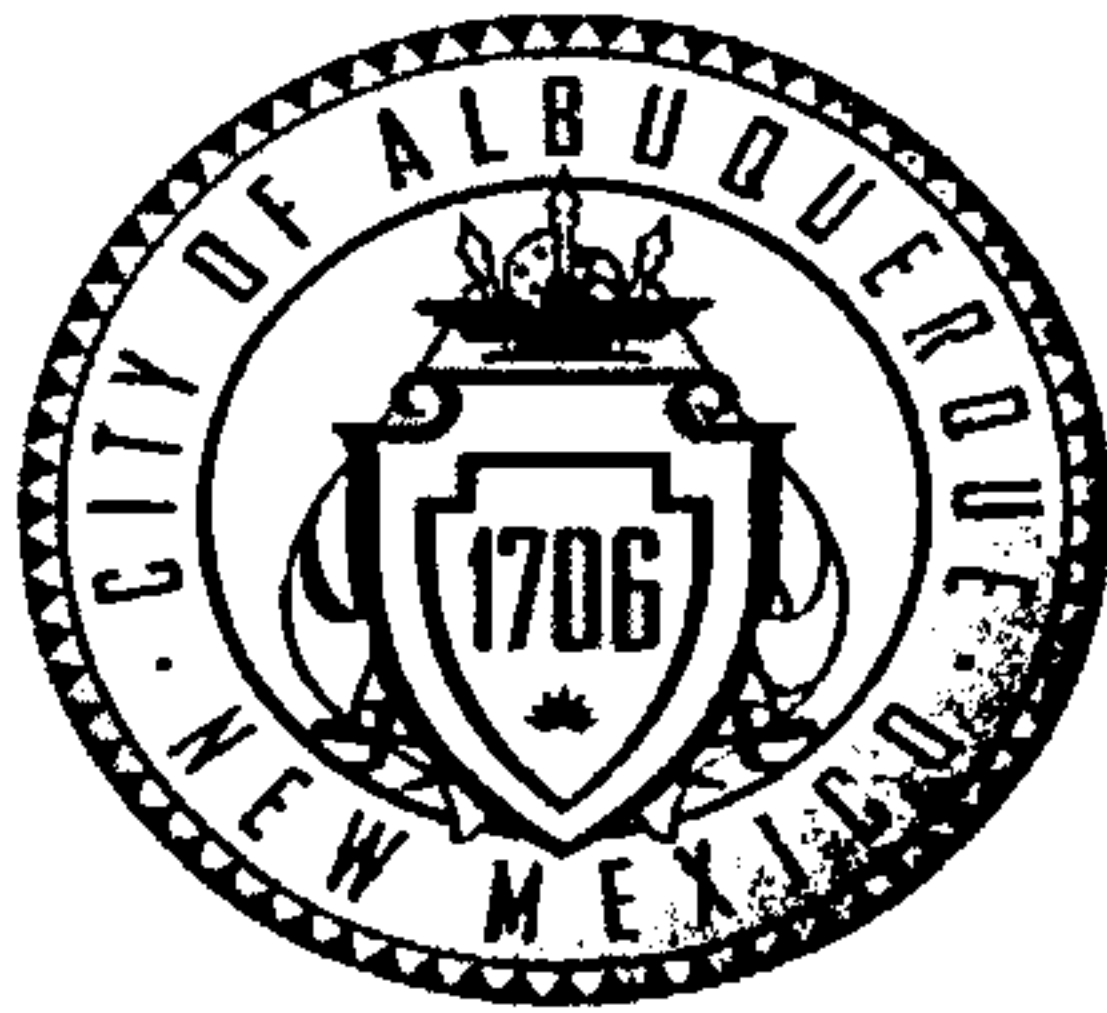

City of Albuquerque

Planning Department

Development & Building Services Division

DRAINAGE AND TRANSPORTATION INFORMATION SHEET

(REV 02/2013)

Project Title: REGINALD CHAVEZ ES PORTABLES Building Permit #: _____ City Drainage #: J12/D009

DRB#: _____ EPC#: _____ Work Order#: _____

Legal Description: UNPLATTED LANDS OF APS KNOWN AS REGINALD CHAVEZ ELEM SCHOOL

City Address: 2700 MOUNTAIN ROAD NW

Engineering Firm: High Mesa Consulting Group Contact: Jeffrey Mortensen #8547

Address: 6010-B Midway Park Blvd NE, Albuquerque NM 87109

Phone#: 505-345-4250 Fax#: 505-345-4254 E-mail: jmortensen@highmesacg.com

Owner: ALBUQUERQUE PUBLIC SCHOOLS Contact: SAL WAR

Address: 915 OAK STREET SE, 87106

Phone#: 975-5965 Fax#: _____ E-mail: war@aps.edu

Architect: n/a Contact: _____

Address: _____

Phone#: _____ Fax#: _____ E-mail: _____

Surveyor: High Mesa Consulting Group Contact: Chuck Cala NMPS#11184

Address: 6010-B Midway Park Blvd NE, Albuquerque NM 87109

Phone#: 505-345-4250 Fax#: 505-345-4254 E-mail: ccala@highmesacg.com

Contractor: APS ON-CALL CONTRACTORS Contact: _____

Address: _____

Phone#: _____ Fax#: _____ E-mail: _____

TYPE OF SUBMITTAL:

- ☐ DRAINAGE REPORT (DMP)
- ☐ DRAINAGE PLAN 1st SUBMITTAL
- ☐ DRAINAGE PLAN RESUBMITTAL
- ☐ CONCEPTUAL G & D PLAN
- ☐ GRADING PLAN
- ☐ EROSION & SEDIMENT CONTROL PLAN (ESC)
- ☒ ENGINEER'S CERT (HYDROLOGY)
- ☐ CLOMR/LOMR
- ☐ TRAFFIC CIRCULATION LAYOUT (TCL)
- ☐ ENGINEER'S CERT (TCL)
- ☐ ENGINEER'S CERT (DRB SITE PLAN)
- ☐ ENGINEER'S CERT (ESC)
- ☐ SO-19
- ☐ OTHER (SPECIFY) _____

CHECK TYPE OF APPROVAL/ACCEPTANCE SOUGHT:

- ☐ SIA/FINANCIAL GUARANTEE RELEASE
- ☐ PRELIMINARY PLAT APPROVAL
- ☐ S. DEV. PLAN FOR SUB'D APPROVAL
- ☐ S. DEV. FOR BLDG. PERMIT APPROVAL
- ☐ SECTOR PLAN APPROVAL
- ☐ FINAL PLAT APPROVAL
- ☒ CERTIFICATE OF OCCUPANCY (PERM)
- ☐ CERTIFICATE OF OCCUPANCY (TCL TEMP)
- ☐ FOUNDATION PERMIT APPROVAL
- ☐ BUILDING PERMIT APPROVAL
- ☐ GRADING PERMIT APPROVAL
- ☐ PAVING PERMIT APPROVAL
- ☐ WORK ORDER APPROVAL
- ☐ GRADING CERTIFICATION
- ☐ SO-19 APPROVAL
- ☐ ESC PERMIT APPROVAL
- ☐ ESC CERT. ACCEPTANCE
- ☐ OTHER (DMP) _____

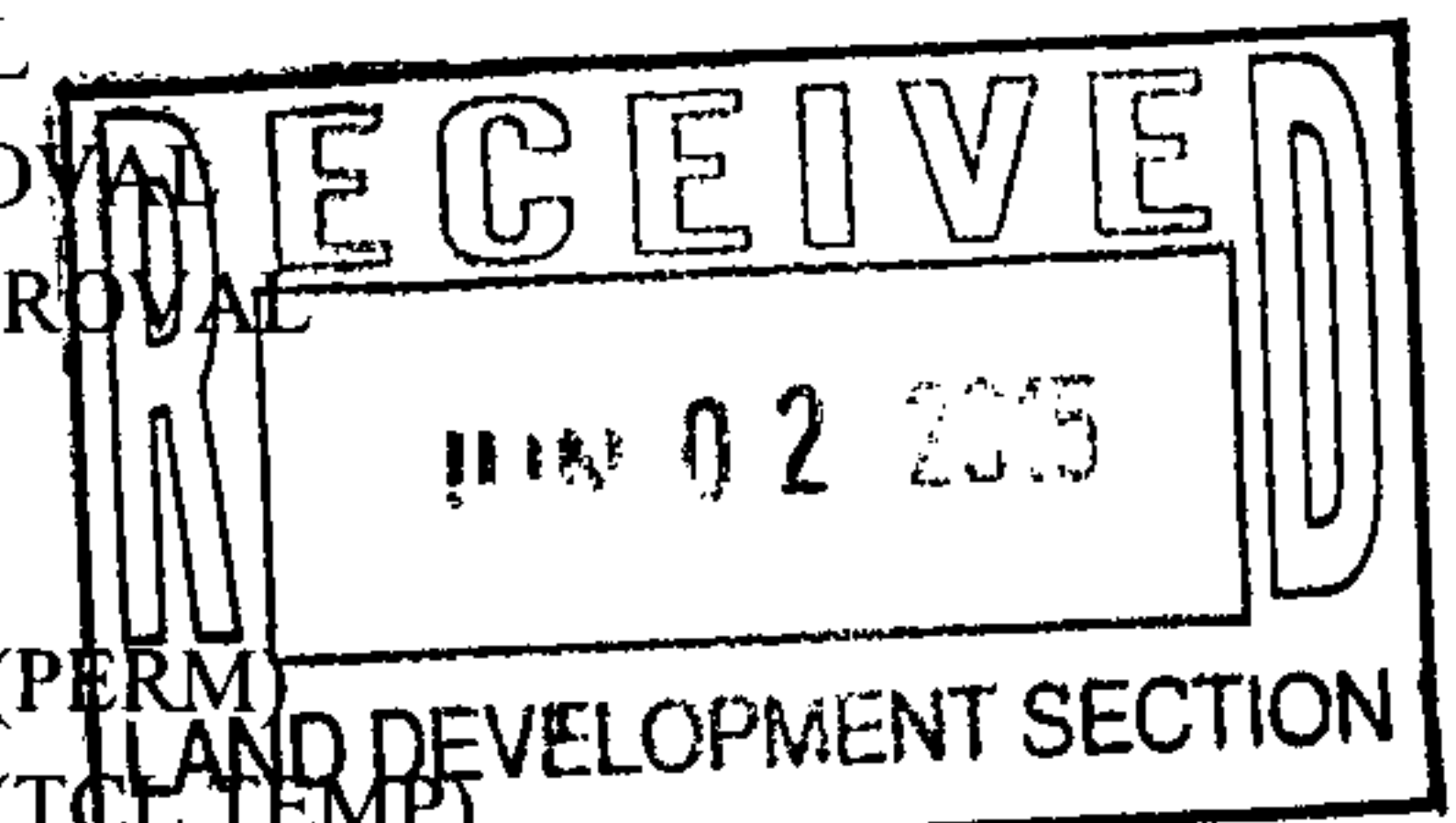

WAS A PRE-DESIGN CONFERENCE ATTENDED: ☒ Yes ☐ No ☒ Copy Provided

DATE SUBMITTED: 06-02-2015 By: Jeff Mortensen (HMCG 2013.184.8)

Requests for approvals of Site Development Plans and/or Subdivision Plats shall be accompanied by a drainage submittal. The particular nature, location, and scope to the proposed development defines the degree of drainage detail. One or more of the following levels of submittal may be required based on the following:

1. **Conceptual Grading and Drainage Plan:** Required for approval of Site Development Plans greater than five (5) acres and Sector Plans
2. **Drainage Plans:** Required for building permits, grading permits, paving permits and site plans less than five (5) acres
3. **Drainage Report:** Required for subdivision containing more than ten (10) lots or constituting five (5) acres or more
4. **Erosion and Sediment Control Plan:** Required for any new development and redevelopment site with 1-acre or more of land disturbing area, including project less than 1-acre than are part of a larger common plan of development

Jeffrey Mortensen

From: Jeffrey Mortensen
Sent: Tuesday, June 02, 2015 12:08 PM
To: 'plndrs@cabq.gov'
Subject: REGINALD CHAVEZ PORTABLES CERT
Attachments: CERT 1 OF 1.pdf; CERT 2 OF 14.pdf; CERT 3 OF 14.pdf; CERT 5B OF 14.pdf; CERT 6A OF 14.pdf; CERT 6B OF 14.pdf; CERT 7 OF 14.pdf; CERT 11 OF 14.pdf

Attached are the following sheets:

1 of 1
2 of 14
3 of 14
5B of 14
6A of 14
6B of 14
7 of 14
11 of 14

Formal submittal will be made later today



Jeffrey G. Mortensen, P.E.
Chairman

6010-B Midway Park Blvd. NE
Albuquerque, NM 87109
www.highmesacg.com

Phone: 505.345.4250
Fax: 505.345.4254
jmortensen@highmesacg.com

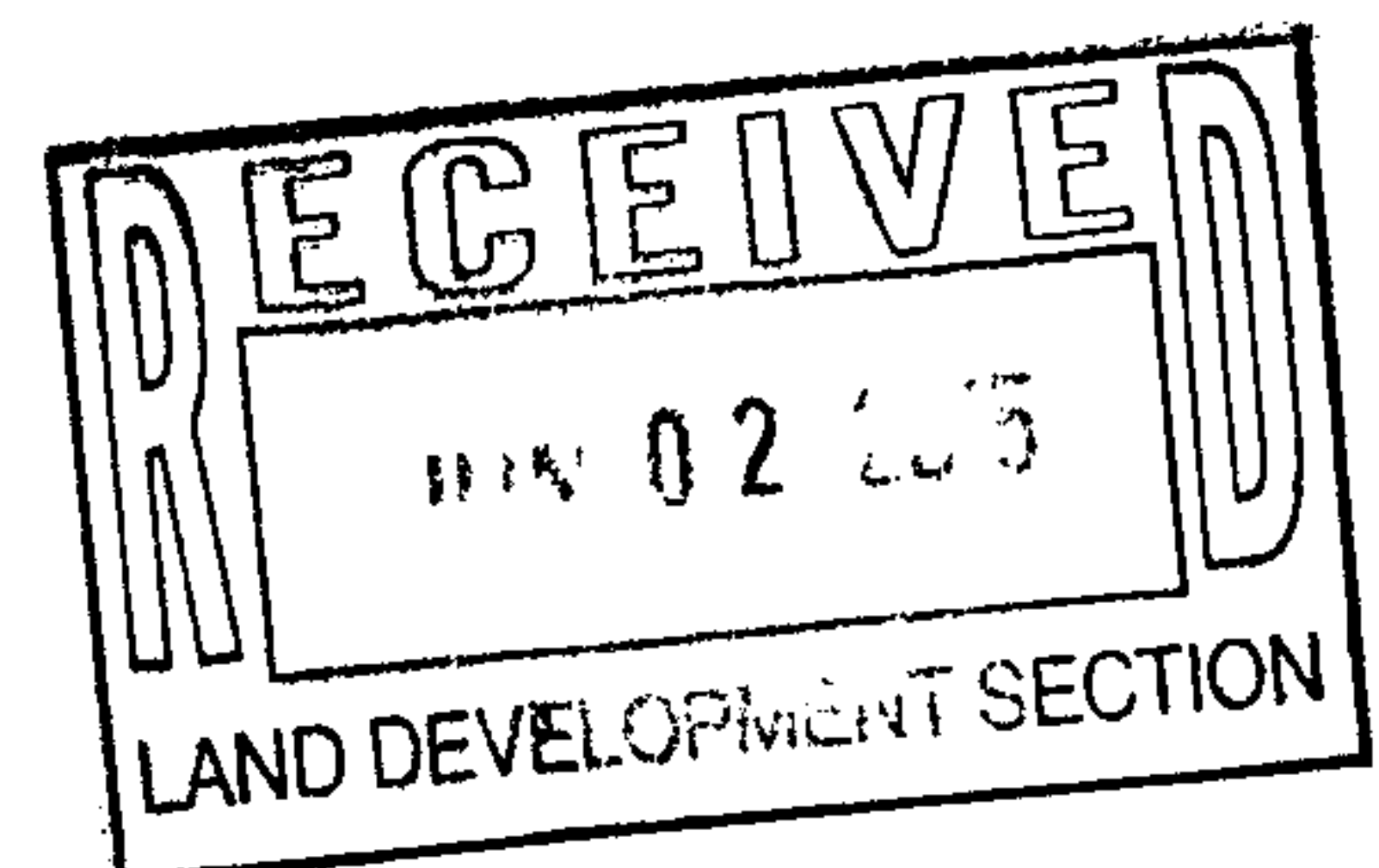

CITY OF ALBUQUERQUE

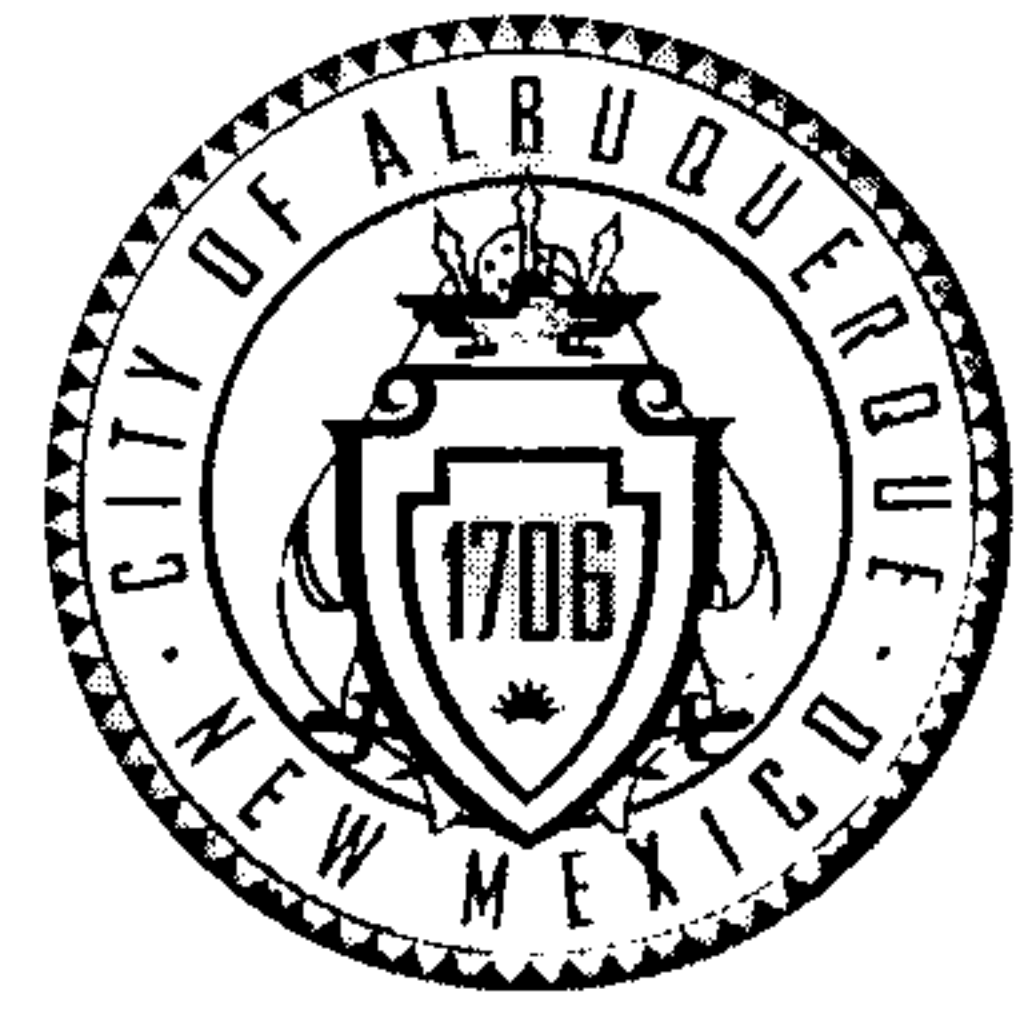

September 18, 2014

Mr. Jeffrey Mortensen
High Mesa Consulting Group
6010-B Midway Park Blvd NE
Albuquerque, NM 87109

**Re: Reginald Chavez Elementary Portables
Grading and Drainage Plan
Engineer's Stamp Date 8-4-14 (J12D009)**

Dear Mr. Mortensen,

Based upon the information provided in your submittal received August 28, 2014, the above referenced plan is approved for Foundation Permit, Grading Permit, and Building Permit. Please attach a copy of this approved plan to the construction sets prior to sign-off by Hydrology.

Prior to Certificate of Occupancy release, Engineer Certification per the DPM checklist will be required. When you provide your certification, please include the following on your plans:

1. Provide a FIRM Map on sheet 1 of 1 that has a legible description which is not cut off.

If you have any questions, you can contact me at 924-3994.

Sincerely,

Amy L. D. Niese, P.E.
Senior Engineer, Hydrology
Planning Department

C: e-mail

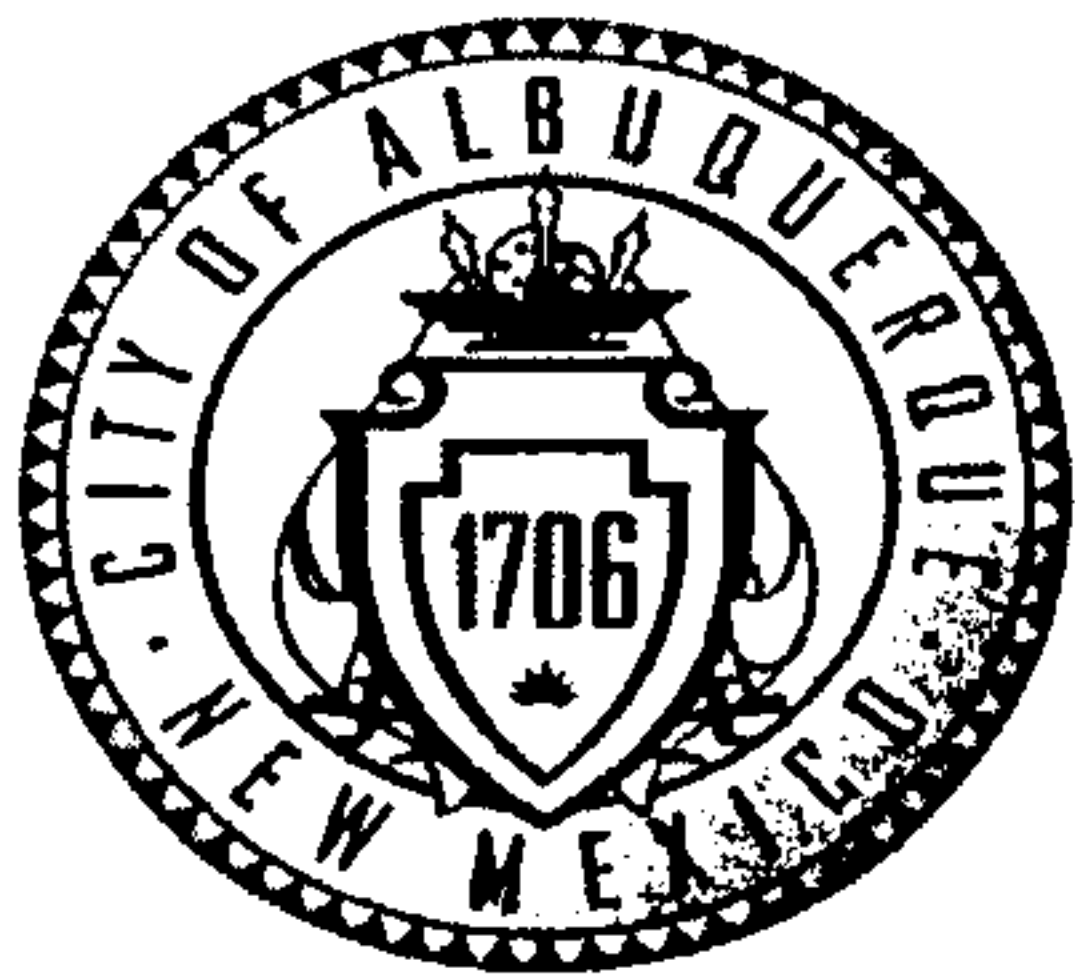

City of Albuquerque

Planning Department

Development & Building Services Division

DRAINAGE AND TRANSPORTATION INFORMATION SHEET

(REV 02/2013)

Project Title: REGINALD CHAVEZ ES PORTABLES Building Permit #: _____ City Drainage #: J12/D009

DRB#: _____ EPC#: _____ Work Order#: _____

Legal Description: UNPLATTED LANDS OF APS KNOWN AS REGINALD CHAVEZ ELEM SCHOOL

City Address: 2700 MOUNTAIN ROAD NW

Engineering Firm: High Mesa Consulting Group Contact: Jeffrey Mortensen #8547

Address: 6010-B Midway Park Blvd NE, Albuquerque NM 87109

Phone#: 505-345-4250 Fax#: 505-345-4254 E-mail: jmortensen@highmesacg.com

Owner: ALBUQUERQUE PUBLIC SCHOOLS Contact: SAL WAR

Address: 915 OAK STREET SE, 87106

Phone#: 975-5965 Fax#: _____ E-mail: war@aps.edu

Architect: n/a Contact: _____

Address: _____

Phone#: _____ Fax#: _____ E-mail: _____

Surveyor: High Mesa Consulting Group Contact: Chuck Cala NMPS#11184

Address: 6010-B Midway Park Blvd NE, Albuquerque NM 87109

Phone#: 505-345-4250 Fax#: 505-345-4254 E-mail: ccala@highmesacg.com

Contractor: APS ON-CALL CONTRACTORS Contact: _____

Address: _____

Phone#: _____ Fax#: _____ E-mail: _____

TYPE OF SUBMITTAL:

- ☐ DRAINAGE REPORT (DMP)
☒ DRAINAGE PLAN 1st SUBMITTAL
☐ DRAINAGE PLAN RESUBMITTAL
☐ CONCEPTUAL G & D PLAN
☒ GRADING PLAN
☐ EROSION & SEDIMENT CONTROL PLAN (ESC)
☐ ENGINEER'S CERT (HYDROLOGY)
☐ CLOMR/LOMR
☐ TRAFFIC CIRCULATION LAYOUT (TCL)
☐ ENGINEER'S CERT (TCL)
☐ ENGINEER'S CERT (DRB SITE PLAN)
☐ ENGINEER'S CERT (ESC)
☐ SO-19
☐ OTHER (SPECIFY)

CHECK TYPE OF APPROVAL/ACCEPTANCE SOUGHT:

- ☐ SIA/FINANCIAL GUARANTEE RELEASE
☐ PRELIMINARY PLAT APPROVAL
☐ S. DEV. PLAN FOR SUB'D APPROVAL
☐ S. DEV. FOR BLDG. PERMIT APPROVAL
☐ SECTOR PLAN APPROVAL
☐ FINAL PLAT APPROVAL
☐ CERTIFICATE OF OCCUPANCY (PERM)
☐ CERTIFICATE OF OCCUPANCY (TCL TEMP)
☒ FOUNDATION PERMIT APPROVAL
☒ BUILDING PERMIT APPROVAL
☒ GRADING PERMIT APPROVAL
☐ PAVING PERMIT APPROVAL
☐ WORK ORDER APPROVAL
☐ GRADING CERTIFICATION
☐ SO-19 APPROVAL
☐ ESC PERMIT APPROVAL
☐ ESC CERT. ACCEPTANCE
☐ OTHER (DMP)

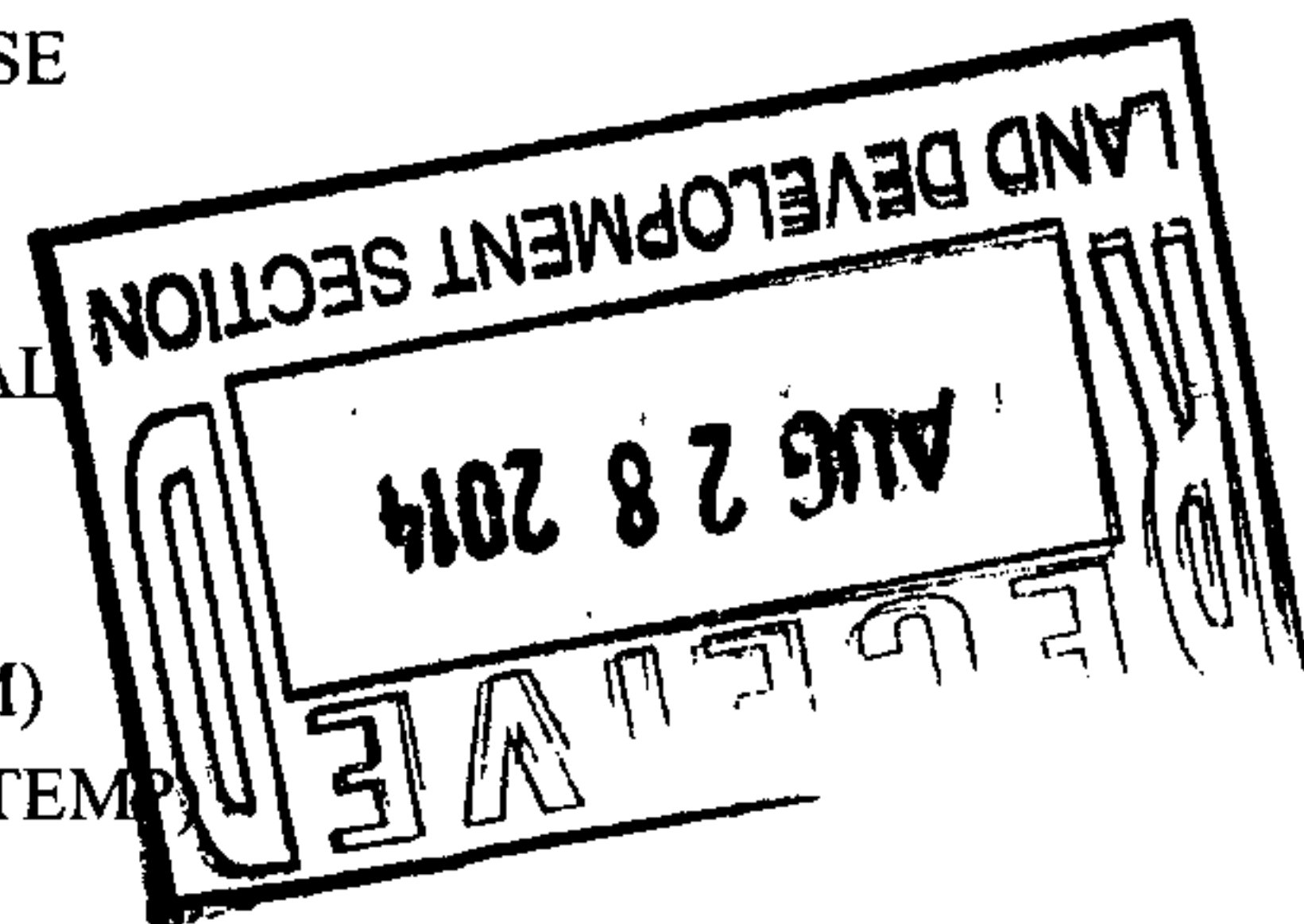

WAS A PRE-DESIGN CONFERENCE ATTENDED: ☒ Yes ☐ No ☒ Copy Provided

DATE SUBMITTED: 08-18-2014 By: Jeff Mortensen (HMCG 2013.184.8)

Requests for approvals of Site Development Plans and/or Subdivision Plats shall be accompanied by a drainage submittal. The particular nature, location, and scope to the proposed development defines the degree of drainage detail. One or more of the following levels of submittal may be required based on the following:

1. **Conceptual Grading and Drainage Plan:** Required for approval of Site Development Plans greater than five (5) acres and Sector Plans
2. **Drainage Plans:** Required for building permits, grading permits, paving permits and site plans less than five (5) acres
3. **Drainage Report:** Required for subdivision containing more than ten (10) lots or constituting five (5) acres or more
4. **Erosion and Sediment Control Plan:** Required for any new development and redevelopment site with 1-acre or more of land disturbing area, including project less than 1-acre than are part of a larger common plan of development

RETEN AD BASIN B = 1.90 AC

CITY OF ALBUQUERQUE
DEVELOPMENT & BUILDING SERVICES CENTER
PLANNING DEPARTMENT/HYDROLOGY & TRANSPORTATION SECTIONS & ABCWUA

CONFERENCE RECAP

DRAINAGE FILE/ZONE ATLAS PAGE NUMBER: J12/D009 DATE: 02-13-2014
CROSS REFERENCE NUMBERS: EPC _____ DRB _____ DRC _____
SUBJECT: CLASSROOM ADDITION, REGINALD CHAVEZ ELEMENTARY SCHOOL
STREET ADDRESS: 2700 MOUNTAIN ROAD NW
SUBDIVISION NAME: UNPLATTED MRGCD TRACTS PLUS PORTION OF PUBLIC RIGHT-OF-WAY

TYPE OF APPROVAL

<u> </u> PRELIMINARY PLAT	<u> </u> FINAL PLAT
<u> </u> SITE DEVELOPMENT PLAN	<u> X </u> BUILDING PERMIT
<u> X </u> OTHER – <u>WORK ORDER</u>	<u> </u> ROUGH GRADING

<u>ATTENDEE:</u>	<u>ORGANIZATION:</u>	<u>PHONE:</u>
CURTIS CHERNE	HYDROLOGY	924-3986
ALLAN PORTER	ABCWUA	924-3989
BRYAN WOLFE	CITY ENGINEER	924-3999
JEFF MORTENSEN	HMCG	345-4250

<u>OTHER:</u>		
KRISTAL METRO	TRANSPORTATION	924-3991

FINDINGS:

A. ABCWUA

- a. CITY WORK ORDER REQUIRED FOR NEW FIRE HYDRANT ON WEST SIDE OF NEW BUILDING
- b. REMOVAL OF EXISTING PRIVATE FIRE HYDRANT INTERNAL TO SITE ACCEPTABLE AS IT WILL BE REPLACED BY NEW PUBLIC FIRE HYDRANT REFERENCED ABOVE.
- c. CONVERSION OF PRIVATE FIRE HYDRANT UNMETERED FIRE PROTECTION LINE TO LINE FOR BUILDING SPRINKLERS ACCEPTABLE. EXISTING ACCOUNT TO REMAIN -- NO CHANGES REQUIRED.
- d. NEW PUBLIC FIRE HYDRANT REQUIRES A PUBLIC WATER LINE EASEMENT.
- e. DEDICATION OF RIGHT-OF-WAY OR GRANTING OF EASEMENTS NOT REQUIRED FOR EXISTING ABCWUA FACILITIES WITHIN THE APPARENT ROADWAY, BUT NOT WITHIN DEDICATED RIGHT-OF-WAY
- f. NEW SAS SERVICE REQUIRED FOR NEW BUILDING; INCLUDE AS PART OF CITY WORK ORDER TO PROPERTY LINE IN LIEU OF SEPARATE TAPPING PERMIT
- g. IF YDI HEAD START PORTABLE BUILDING REQUIRES A SEPARATE METERED WATER SERVICE, INCLUDE AS PART OF CITY WORK ORDER

B. TRANSPORTATION

- a. TCL REQUIRED FOR BUILDING PERMIT APPROVAL???????????????????? (See note "d." below)
- b. NEW DRIVEPADS ON MONTOYA ROAD ~~MUST~~ MAY BE PART OF CITY WORK ORDER REFERENCED ABOVE AS OPPOSED TO SEPARATE PERMIT PROCESS
- c. DEDICATION OF RIGHT-OF-WAY OR GRANTING OF EASEMENTS NOT REQUIRED FOR EXISTING CITY STREET IMPROVEMENTS WITHIN THE APPARENT ROADWAY, BUT NOT WITHIN DEDICATED RIGHT-OF-WAY
- d. *Follow the requirements for Council Bill Number O-13-61, which amended Chapter 6, Article 5, Part 4 Section 3 ROA 1994. The new ordinance requires a Neighbor Impact Analysis, Traffic Site Assessment or Traffic Impact Study.*
- e. *The City Engineer will help set-up the meeting with the transportation and planning staff. The planning staff will help with the requirements for the Neighborhood Impact Analysis. The transportation staff will determine the traffic analysis requirements.*

C. HYDROLOGY

- a. GRADING AND DRAINAGE (G&D) PLAN REQUIRED FOR BUILDING PERMIT APPROVAL
- b. G&D SHALL CONFORM TO MASTER DRAINAGE PLAN (MDP) DATED 09-28-2007
- c. BASIN A ALLOWED FREE DISCHARGE TO PUBLIC RIGHT-OF-WAY AS DESCRIBED IN THE MDP
- d. RETENTION PONDING IN BASIN B ALLOWED AS DESCRIBED IN THE MDP
- e. MODIFICATIONS TO THE BASIN B POND SHALL MAINTAIN EXISTING VOLUME PLUS ANY INCREASE IN RUNOFF ASSOCIATED WITH THE PROPOSED BUILDING PERMIT IMPROVEMENTS
- f. G&D MUST ADDRESS REQUIREMENTS OR NEED FOR FENCING OF RETENTION POND
- g. DESIGN SHOULD CONSIDER GRAVEL INFILTRATION GALLERY TO PROMOTE POND INFILTRATION
- h. IF THE PROJECT DISTURBS GREATER THAN ONE ACRE OF LAND, AN EROSION AND SEDIMENT CONTROL PLAN (ESCP) IS REQUIRED FOR AS A CONDITION FOR BUILDING PERMIT APPROVAL. THIS IS A SEPARATE SUBMITTAL IN ADDITION TO THE GRADING AND DRAINAGE PLAN SUBMITTAL FOR BUILDING PERMIT.

THE UNDERSIGNED AGREE THAT THE ABOVE FINDINGS ARE SUMMARIZED ACCURATELY AND ARE ONLY SUBJECT TO CHANGE IF FURTHER INVESTIGATION REVEALS THAT THE FINDINGS ARE NOT REASONABLE OR THAT THEY ARE BASED UPON INACCURATE INFORMATION.

SIGNED: Ante Chen
TITLE: HYDROLOGY (COA)
DATE: _____

SIGNED: [Signature]
TITLE: TRANSPORTATION (COA)
DATE: 3/4/2014
(Notes in Bold & Italics)

SIGNED: [Signature]
TITLE: CONSULTANT
DATE: 03-04-2014

SIGNED: [Signature]
TITLE: ABCWUA
DATE: 03/04/14

NOTE: PROVIDE A COPY OF THIS RECAP WITH DRAINAGE, TCL AND WORK ORDER SUBMITTALS

B. TRANSPORTATION

- a. TCL REQUIRED FOR BUILDING PERMIT APPROVAL???????????????????? (See note "d." below)
- b. NEW DRIVEPADS ON MONTOYA ROAD ~~MUST~~ MAY BE PART OF CITY WORK ORDER REFERENCED ABOVE AS OPPOSED TO SEPARATE PERMIT PROCESS
- c. DEDICATION OF RIGHT-OF-WAY OR GRANTING OF EASEMENTS NOT REQUIRED FOR EXISTING CITY STREET IMPROVEMENTS WITHIN THE APPARENT ROADWAY, BUT NOT WITHIN DEDICATED RIGHT-OF-WAY
- d. *Follow the requirements for Council Bill Number O-13-61, which amended Chapter 6, Article 5, Part 4 Section 3 ROA 1994. The new ordinance requires a Neighbor Impact Analysis, Traffic Site Assessment or Traffic Impact Study.*
- e. *The City Engineer will help set-up the meeting with the transportation and planning staff. The planning staff will help with the requirements for the Neighborhood Impact Analysis. The transportation staff will determine the traffic analysis requirements.*

C. HYDROLOGY

- a. GRADING AND DRAINAGE (G&D) PLAN REQUIRED FOR BUILDING PERMIT APPROVAL
- b. G&D SHALL CONFORM TO MASTER DRAINAGE PLAN (MDP) DATED 09-28-2007
- c. BASIN A ALLOWED FREE DISCHARGE TO PUBLIC RIGHT-OF-WAY AS DESCRIBED IN THE MDP
- d. RETENTION PONDING IN BASIN B ALLOWED AS DESCRIBED IN THE MDP
- e. MODIFICATIONS TO THE BASIN B POND SHALL MAINTAIN EXISTING VOLUME PLUS ANY INCREASE IN RUNOFF ASSOCIATED WITH THE PROPOSED BUILDING PERMIT IMPROVEMENTS
- f. G&D MUST ADDRESS REQUIREMENTS OR NEED FOR FENCING OF RETENTION POND
- g. DESIGN SHOULD CONSIDER GRAVEL INFILTRATION GALLERY TO PROMOTE POND INFILTRATION
- h. IF THE PROJECT DISTURBS GREATER THAN ONE ACRE OF LAND, AN EROSION AND SEDIMENT CONTROL PLAN (ESCP) IS REQUIRED FOR AS A CONDITION FOR BUILDING PERMIT APPROVAL. THIS IS A SEPARATE SUBMITTAL IN ADDITION TO THE GRADING AND DRAINAGE PLAN SUBMITTAL FOR BUILDING PERMIT.

THE UNDERSIGNED AGREE THAT THE ABOVE FINDINGS ARE SUMMARIZED ACCURATELY AND ARE ONLY SUBJECT TO CHANGE IF FURTHER INVESTIGATION REVEALS THAT THE FINDINGS ARE NOT REASONABLE OR THAT THEY ARE BASED UPON INACCURATE INFORMATION.

SIGNED: Ante c Chen
TITLE: HYDROLOGY (COA)
DATE: _____

SIGNED: [Signature]
TITLE: TRANSPORTATION (COA)
DATE: 3/4/2014
(Notes in Bold & Italics)

SIGNED: [Signature]
TITLE: CONSULTANT
DATE: 03.04.2014
SIGNED: [Signature]
TITLE: ABCWUA
DATE: 03/04/14

NOTE: PROVIDE A COPY OF THIS RECAP WITH DRAINAGE, TCL AND WORK ORDER SUBMITTALS

CITY OF ALBUQUERQUE
DEVELOPMENT & BUILDING SERVICES CENTER
PLANNING DEPARTMENT/HYDROLOGY & TRANSPORTATION SECTIONS & ABCWUA

CONFERENCE RECAP

DRAINAGE FILE/ZONE ATLAS PAGE NUMBER: J12/D009 DATE: 02-13-2014
CROSS REFERENCE NUMBERS: EPC _____ DRB _____ DRC _____
SUBJECT: CLASSROOM ADDITION, REGINALD CHAVEZ ELEMENTARY SCHOOL
STREET ADDRESS: 2700 MOUNTAIN ROAD NW
SUBDIVISION NAME: UNPLATTED MRGCD TRACTS PLUS PORTION OF PUBLIC RIGHT-OF-WAY

TYPE OF APPROVAL

<u> </u> PRELIMINARY PLAT <u> </u> SITE DEVELOPMENT PLAN <u> X </u> OTHER – <u>WORK ORDER</u>	<u> </u> FINAL PLAT <u> X </u> BUILDING PERMIT <u> </u> ROUGH GRADING
---	---

<u>ATTENDEE:</u>	<u>ORGANIZATION:</u>	<u>PHONE:</u>
CURTIS CHERNE	HYDROLOGY	924-3986
ALLAN PORTER	ABCWUA	924-3989
BRYAN WOLFE	CITY ENGINEER	924-3999
JEFF MORTENSEN	HMCG	345-4250

<u>OTHER:</u>		
KRISTAL METRO	TRANSPORTATION	924-3991

FINDINGS:

A. ABCWUA

- a. CITY WORK ORDER REQUIRED FOR NEW FIRE HYDRANT ON WEST SIDE OF NEW BUILDING
- b. REMOVAL OF EXISTING PRIVATE FIRE HYDRANT INTERNAL TO SITE ACCEPTABLE AS IT WILL BE REPLACED BY NEW PUBLIC FIRE HYDRANT REFERENCED ABOVE.
- c. CONVERSION OF PRIVATE FIRE HYDRANT UNMETERED FIRE PROTECTION LINE TO LINE FOR BUILDING SPRINKLERS ACCEPTABLE. EXISTING ACCOUNT TO REMAIN – NO CHANGES REQUIRED.
- d. NEW PUBLIC FIRE HYDRANT REQUIRES A PUBLIC WATER LINE EASEMENT.
- e. DEDICATION OF RIGHT-OF-WAY OR GRANTING OF EASEMENTS NOT REQUIRED FOR EXISTING ABCWUA FACILITIES WITHIN THE APPARENT ROADWAY, BUT NOT WITHIN DEDICATED RIGHT-OF-WAY
- f. NEW SAS SERVICE REQUIRED FOR NEW BUILDING; INCLUDE AS PART OF CITY WORK ORDER TO PROPERTY LINE IN LIEU OF SEPARATE TAPPING PERMIT
- g. IF YDI HEAD START PORTABLE BUILDING REQUIRES A SEPARATE METERED WATER SERVICE, INCLUDE AS PART OF CITY WORK ORDER

CITY OF ALBUQUERQUE



November 14, 2014

Mr. Jeffrey Mortensen
High Mesa Consulting Group
6010-B Midway Park Blvd NE
Albuquerque, NM 87109

**Re: Reginald Chavez Elementary Portables
Grading and Drainage Plan
Engineer's Stamp Date 11-5-14 (J12D009)**

Dear Mr. Mortensen,

Based upon the information provided in your submittal received November 6, 2014, the above referenced plan is approved for Building Permit. Please attach a copy of this approved plan to the construction sets prior to sign-off by Hydrology.

Prior to Certificate of Occupancy release, Engineer Certification per the DPM checklist will be required. Note the following:

PO Box 1293

1. On Sheet C-103, the end section, gravel infiltration, and chain link fence are described as being done by separate permit. These items will need to be completed with the earlier phase approved plans dated 8-4-14 or with this set of plans.

Albuquerque

If you have any questions, you can contact me at 924-3994.

New Mexico 87103

Sincerely,

Amy L. D. Niese, P.E.
Senior Engineer, Hydrology
Planning Department

www.cabq.gov

C: e-mail

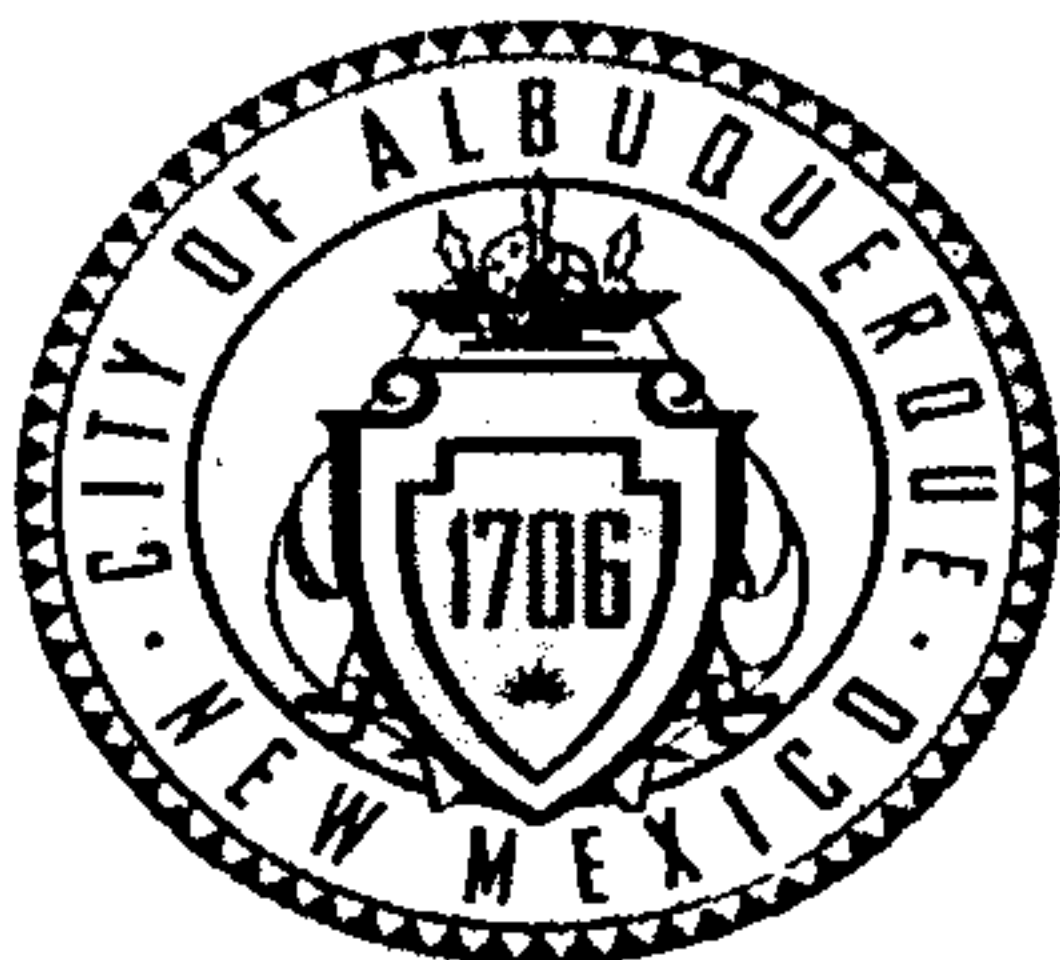

JUSTIN
City of Albuquerque

Planning Department
Development & Building Services Division
DRAINAGE AND TRANSPORTATION INFORMATION SHEET
(REV 02/2013)

Project Title: REGINALD CHAVEZ ELEM. SCHOOL Building Permit #: _____ City Drainage #: J12/D009
DRB#: _____ EPC#: _____ Work Order#: _____
Legal Description: UNPLATTED LANDS OF APS KNOWN AS REGINALD CHAVEZ ELEM SCHOOL
City Address: 2700 MOUNTAIN ROAD NW

Engineering Firm: High Mesa Consulting Group Contact: Jeffrey Mortensen #8547
Address: 6010-B Midway Park Blvd NE, Albuquerque NM 87109
Phone#: 505-345-4250 Fax#: 505-345-4254 E-mail: jmortensen@highmesacg.com

Owner: Albuquerque Public Schools Contact: Myron Johnson
Address: 915 Oak Street SE, 87106
Phone#: 848-8811 Fax#: _____ E-mail: johnson_my@aps.edu

Architect: Cherry See Reames Architects Contact: Tina Reames
Address: 220-A Gold Ave SW, Albuquerque NM 87102
Phone#: 842-1278 Fax#: _____ E-mail: tmreames@cherryseereames.com

Surveyor: High Mesa Consulting Group Contact: Chuck Cala NMPS#11184
Address: 6010-B Midway Park Blvd NE, Albuquerque NM 87109
Phone#: 505-345-4250 Fax#: 505-345-4254 E-mail: ccala@highmesacg.com

Contractor: TO BE SELECTED Contact: _____
Address: _____
Phone#: _____ Fax#: _____ E-mail: _____

TYPE OF SUBMITTAL:

- ☐ DRAINAGE REPORT (DMP)
☒ DRAINAGE PLAN 1st SUBMITTAL
☐ DRAINAGE PLAN RESUBMITTAL
☐ CONCEPTUAL G & D PLAN
☒ GRADING PLAN
☐ EROSION & SEDIMENT CONTROL PLAN (ESC)
☐ ENGINEER'S CERT (HYDROLOGY)
☐ CLOMR/LOMR
☐ TRAFFIC CIRCULATION LAYOUT (TCL)
☐ ENGINEER'S CERT (TCL)
☐ ENGINEER'S CERT (DRB SITE PLAN)
☐ ENGINEER'S CERT (ESC)
☐ SO-19
☐ OTHER (SPECIFY)

CHECK TYPE OF APPROVAL/ACCEPTANCE SOUGHT:

- ☐ SIA/FINANCIAL GUARANTEE RELEASE
☐ PRELIMINARY PLAT APPROVAL
☐ S. DEV. PLAN FOR SUB'D APPROVAL
☐ S. DEV. FOR BLDG. PERMIT APPROVAL
☐ SECTOR PLAN APPROVAL
☐ FINAL PLAT APPROVAL
☐ CERTIFICATE OF OCCUPANCY PERM
☐ CERTIFICATE OF OCCUPANCY (TCL TEMP)
☐ FOUNDATION PERMIT APPROVAL
☒ BUILDING PERMIT APPROVAL
☐ GRADING PERMIT APPROVAL
☐ PAVING PERMIT APPROVAL
☐ WORK ORDER APPROVAL
☐ GRADING CERTIFICATION
☐ SO-19 APPROVAL
☐ ESC PERMIT APPROVAL
☐ ESC CERT. ACCEPTANCE
☐ OTHER (DMP)

WAS A PRE-DESIGN CONFERENCE ATTENDED: ☒ Yes ☐ No ☒ Copy Provided

DATE SUBMITTED: 11-5-2014 By: Jeff Mortensen (HMCg 2013.061.1)

Requests for approvals of Site Development Plans and/or Subdivision Plats shall be accompanied by a drainage submittal. The particular nature, location, and scope to the proposed development defines the degree of drainage detail. One or more of the following levels of submittal may be required based on the following

1. **Conceptual Grading and Drainage Plan:** Required for approval of Site Development Plans greater than five (5) acres and Sector Plans
2. **Drainage Plans:** Required for building permits, grading permits, paving permits and site plans less than five (5) acres
3. **Drainage Report:** Required for subdivision containing more than ten (10) lots or constituting five (5) acres or more
4. **Erosion and Sediment Control Plan:** Required for any new development and redevelopment site with 1-acre or more of land disturbing area, including project less than 1-acre than are part of a larger common plan of development

$A_D = 4.41 \text{ AC}$ $Q = 10.6 \text{ CFS} + \text{RET}$

CITY OF ALBUQUERQUE
DEVELOPMENT & BUILDING SERVICES CENTER
PLANNING DEPARTMENT/HYDROLOGY & TRANSPORTATION SECTIONS & ABCWUA

CONFERENCE RECAP

DRAINAGE FILE/ZONE ATLAS PAGE NUMBER: J12/D009 DATE: 02-13-2014
CROSS REFERENCE NUMBERS: EPC _____ DRB _____ DRC _____
SUBJECT: CLASSROOM ADDITION, REGINALD CHAVEZ ELEMENTARY SCHOOL
STREET ADDRESS: 2700 MOUNTAIN ROAD NW
SUBDIVISION NAME: UNPLATTED MRGCD TRACTS PLUS PORTION OF PUBLIC RIGHT-OF-WAY

TYPE OF APPROVAL

<u> </u> PRELIMINARY PLAT <u> </u> SITE DEVELOPMENT PLAN <u> X </u> OTHER - <u>WORK ORDER</u>	<u> </u> FINAL PLAT <u> X </u> BUILDING PERMIT <u> </u> ROUGH GRADING
---	---

<u>ATTENDEE:</u>	<u>ORGANIZATION:</u>	<u>PHONE:</u>
CURTIS CHERNE	HYDROLOGY	924-3986
ALLAN PORTER	ABCWUA	924-3989
BRYAN WOLFE	CITY ENGINEER	924-3999
JEFF MORTENSEN	HMCG	345-4250

<u>OTHER:</u>		
KRISTAL METRO	TRANSPORTATION	924-3991

FINDINGS:

A. ABCWUA

- a. CITY WORK ORDER REQUIRED FOR NEW FIRE HYDRANT ON WEST SIDE OF NEW BUILDING
- b. REMOVAL OF EXISTING PRIVATE FIRE HYDRANT INTERNAL TO SITE ACCEPTABLE AS IT WILL BE REPLACED BY NEW PUBLIC FIRE HYDRANT REFERENCED ABOVE.
- c. CONVERSION OF PRIVATE FIRE HYDRANT UNMETERED FIRE PROTECTION LINE TO LINE FOR BUILDING SPRINKLERS ACCEPTABLE. EXISTING ACCOUNT TO REMAIN - NO CHANGES REQUIRED.
- d. NEW PUBLIC FIRE HYDRANT REQUIRES A PUBLIC WATER LINE EASEMENT.
- e. DEDICATION OF RIGHT-OF-WAY OR GRANTING OF EASEMENTS NOT REQUIRED FOR EXISTING ABCWUA FACILITIES WITHIN THE APPARENT ROADWAY, BUT NOT WITHIN DEDICATED RIGHT-OF-WAY
- f. NEW SAS SERVICE REQUIRED FOR NEW BUILDING; INCLUDE AS PART OF CITY WORK ORDER TO PROPERTY LINE IN LIEU OF SEPARATE TAPPING PERMIT
- g. IF YDI HEAD START PORTABLE BUILDING REQUIRES A SEPARATE METERED WATER SERVICE, INCLUDE AS PART OF CITY WORK ORDER

2013.061.1

B. TRANSPORTATION

- a. TCL REQUIRED FOR BUILDING PERMIT APPROVAL???????????????????? (See note "d." below)
- b. NEW DRIVEPADS ON MONTOYA ROAD ~~MUST~~ MAY BE PART OF CITY WORK ORDER REFERENCED ABOVE AS OPPOSED TO SEPARATE PERMIT PROCESS
- c. DEDICATION OF RIGHT-OF-WAY OR GRANTING OF EASEMENTS NOT REQUIRED FOR EXISTING CITY STREET IMPROVEMENTS WITHIN THE APPARENT ROADWAY, BUT NOT WITHIN DEDICATED RIGHT-OF-WAY
- d. *Follow the requirements for Council Bill Number O-13-61, which amended Chapter 6, Article 5, Part 4 Section 3 ROA 1994. The new ordinance requires a Neighbor Impact Analysis, Traffic Site Assessment or Traffic Impact Study.*
- e. *The City Engineer will help set-up the meeting with the transportation and planning staff. The planning staff will help with the requirements for the Neighborhood Impact Analysis. The transportation staff will determine the traffic analysis requirements.*

C. HYDROLOGY

- a. GRADING AND DRAINAGE (G&D) PLAN REQUIRED FOR BUILDING PERMIT APPROVAL
- b. G&D SHALL CONFORM TO MASTER DRAINAGE PLAN (MDP) DATED 09-28-2007
- c. BASIN A ALLOWED FREE DISCHARGE TO PUBLIC RIGHT-OF-WAY AS DESCRIBED IN THE MDP
- d. RETENTION PONDING IN BASIN B ALLOWED AS DESCRIBED IN THE MDP
- e. MODIFICATIONS TO THE BASIN B POND SHALL MAINTAIN EXISTING VOLUME PLUS ANY INCREASE IN RUNOFF ASSOCIATED WITH THE PROPOSED BUILDING PERMIT IMPROVEMENTS
- f. G&D MUST ADDRESS REQUIREMENTS OR NEED FOR FENCING OF RETENTION POND
- g. DESIGN SHOULD CONSIDER GRAVEL INFILTRATION GALLERY TO PROMOTE POND INFILTRATION
- h. IF THE PROJECT DISTURBS GREATER THAN ONE ACRE OF LAND, AN EROSION AND SEDIMENT CONTROL PLAN (ESCP) IS REQUIRED FOR AS A CONDITION FOR BUILDING PERMIT APPROVAL. THIS IS A SEPARATE SUBMITTAL IN ADDITION TO THE GRADING AND DRAINAGE PLAN SUBMITTAL FOR BUILDING PERMIT.

THE UNDERSIGNED AGREE THAT THE ABOVE FINDINGS ARE SUMMARIZED ACCURATELY AND ARE ONLY SUBJECT TO CHANGE IF FURTHER INVESTIGATION REVEALS THAT THE FINDINGS ARE NOT REASONABLE OR THAT THEY ARE BASED UPON INACCURATE INFORMATION.

SIGNED: Ante c. Chen
TITLE: HYDROLOGY (COA)
DATE: _____

SIGNED: [Signature]
TITLE: TRANSPORTATION (COA)
DATE: 3/4/2014

(Notes in Bold & Italic)

SIGNED: [Signature]
TITLE: CONSULTANT
DATE: 03.04.2014

SIGNED: [Signature]
TITLE: ABCWUA
DATE: 03/09/14

NOTE: PROVIDE A COPY OF THIS RECAP WITH DRAINAGE, TCL AND WORK ORDER SUBMITTALS

11/12/2014 8:57 AM

M:\PROJECTS\Design\StudioSouthWest_Portables\ReginaldChavezElementary\ReginaldChavez.dwg

ROBERT BOOKWALTER

11/17/17 BP - Either submit 3 Phase I+II approval plans by High Mesa or submit to Hydrology a new STD for portables + emergency drive that is in compliance of those plans.

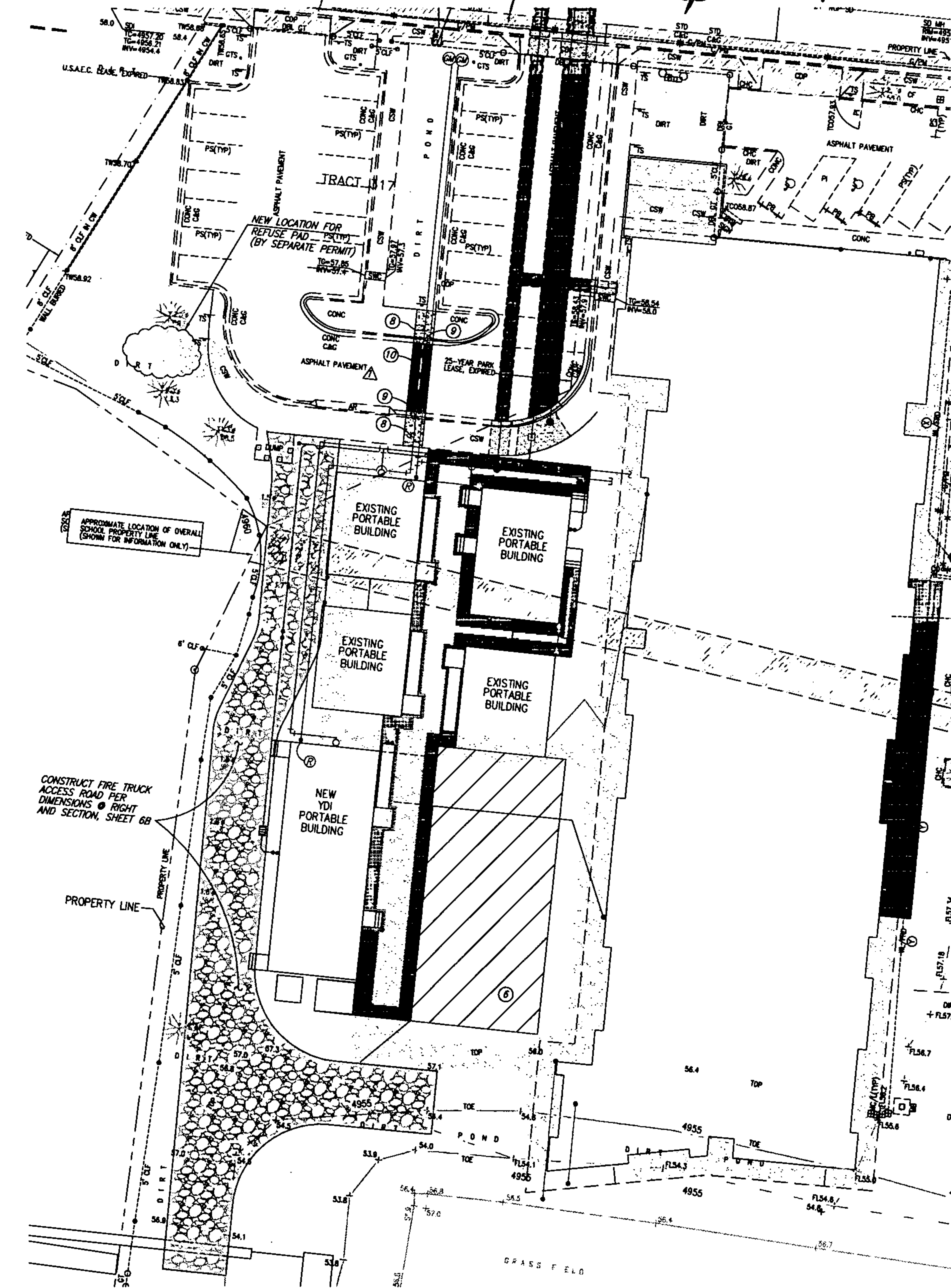

REGINALD CHAVEZ ELEMENTARY SCHOOL - PARTIAL SITE PLAN

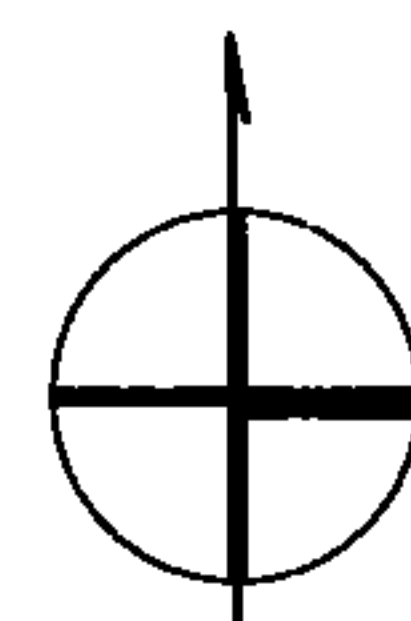

GENERAL NOTES

1. A PARTIAL SITE PLAN IS SHOWN.
2. THE FINISH FLOOR ELEVATION OF THE NEW PORTABLE BUILDINGS SHALL BE ESTABLISHED BY THE ARCHITECT. REFER TO ARCHITECTURAL FOR FINISH FLOOR ELEVATION.
3. THE FINISH GRADE SHALL SLOPE AWAY FROM THE NEW PORTABLE BUILDING FOUNDATION PADS TO ESTABLISH POSITIVE FLOW AWAY FROM THE BUILDING.
4. LOCATION OF NATURAL GAS, POTABLE WATER AND SANITARY SEWER CONNECTIONS SHOWN IN THE SITE PLAN ARE FOR REFERENCE AND BIDDING PURPOSES ONLY. THE CONTRACTOR MAY ADJUST THE TRENCH LOCATIONS FOR EACH SERVICE CONNECTION BASED UPON THE EXISTING BUILDING SERVICE CONNECTION POINTS AND THE ACTUAL BURIED SERVICE LINE LOCATIONS. IF THE CONNECTION ALIGNMENTS PROPOSED BY THE CONTRACTOR DIFFER SIGNIFICANTLY FROM THOSE SHOWN ON THE PLANS, THE ENGINEER SHALL BE NOTIFIED TO DETERMINE AN ALTERNATE ALIGNMENT.
5. WORK CONSISTS OF SUPPLYING GAS AND WATER TO THE 28' X 72' PORTABLE BUILDING.
6. ROAD AND PAVING WORK BY OTHER PERMIT. SEE DRAINAGE FILE J12/D009.

KEY NOTES

1. NEW 28' X 72' PORTABLE BUILDING.
2. EXISTING BUILDINGS TO REMAIN.
3. EXISTING 1" HPG LINE. CONTRACTOR TO CONFIRM IN FIELD. INSTALL NEW GAS CONNECTION.
4. EXISTING 1" WATER SERVICE LINE. INSTALL NEW 1" SERVICE CONNECTION.
5. EXISTING SANITARY SEWER LINE. CONTRACTOR TO CONFIRM IN FIELD.
6. EXISTING OVERHEAD POWER LINE.
7. EXISTING 4" WYE AND DOUBLE CLEAN OUT.
8. EXISTING GREASE TRAP.

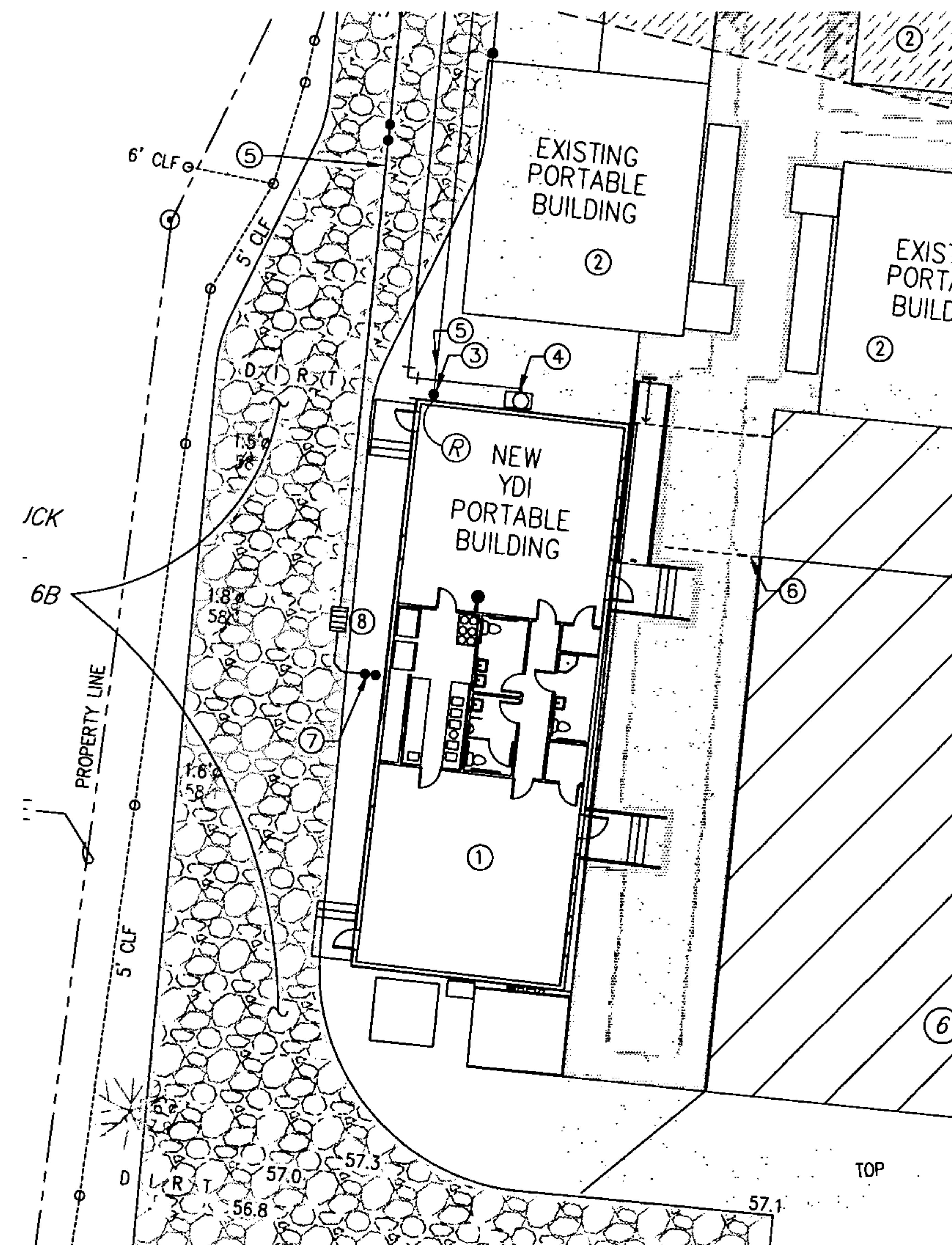

RELOCATED PORTABLE SITE PLAN

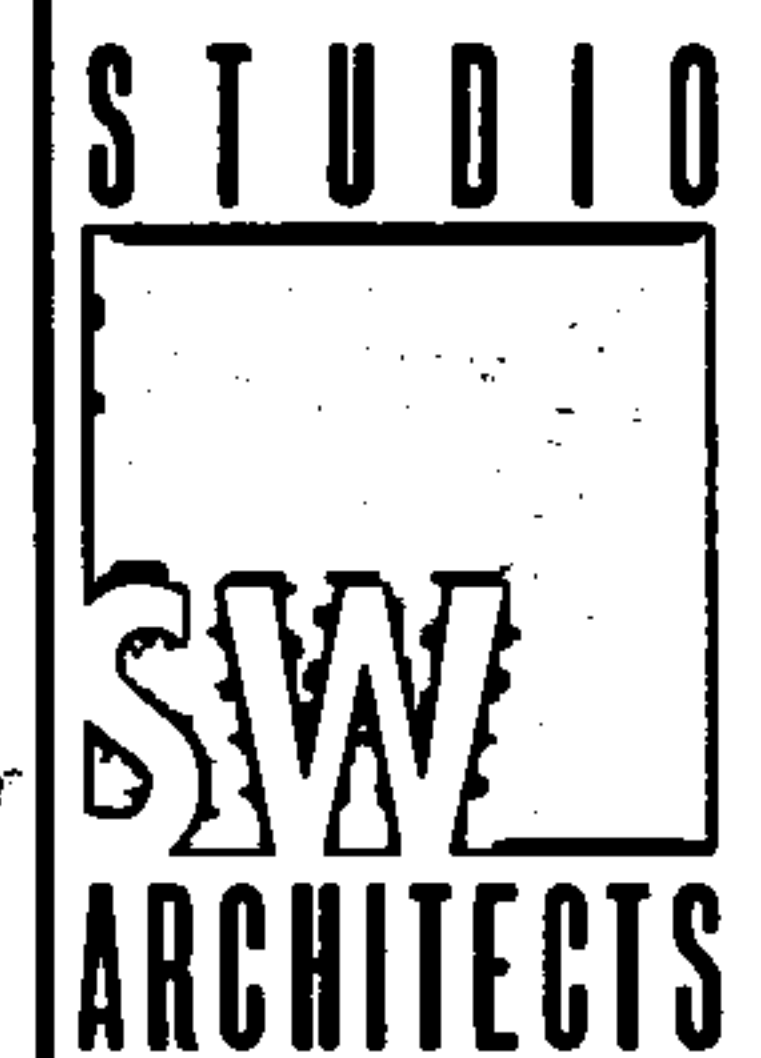

STUDIO SOUTHWEST ARCHITECTS, INC.
2101 Mountain Rd. NW, Albuquerque, NM 87104
505.843.9839 fax: 505.843.9883
Web Site: www.studiosewarch.com
E-Mail: mail@studiosewarch.com

CONSULTANTS



Architect

Engineer

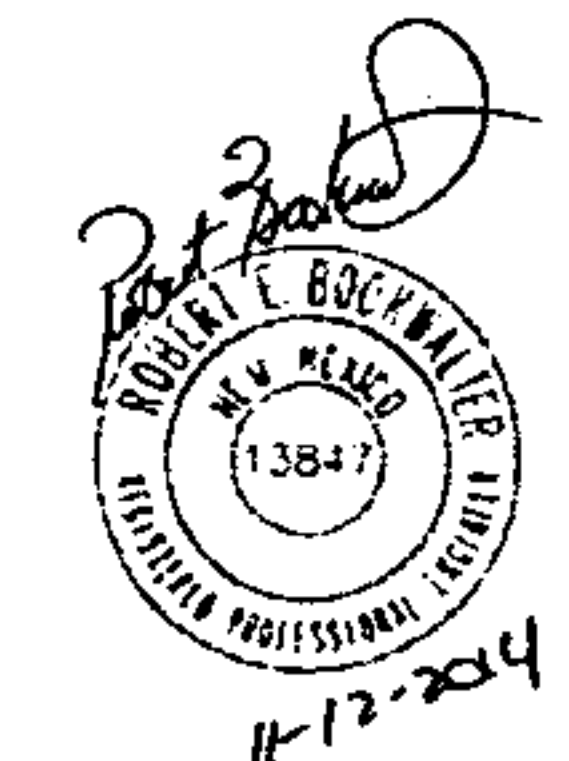

Albuquerque Public Schools -
REGINALD CHAVEZ
ELEMENTARY
PORTABLE
RELOCATION
2700 Mountain Rd. NW
Albuquerque, NM 87104

Key Plan

NTS

MARK	DATE	DESCRIPTION
ISSUE:		PERMIT DOCUMENTS
PROJECT NO:		
CAD DWG FILE:		
DRAWN BY:		AHB/REB
CHECKED BY:		REB
DATE:		11/12/2014

MARK	DATE	DESCRIPTION
ISSUE:		PERMIT DOCUMENTS
PROJECT NO:		
CAD DWG FILE:		
DRAWN BY:		AHB/REB
CHECKED BY:		REB
DATE:		11/12/2014

SHEET TITLE

SITE & GRADING
PLAN

C-101



A3 SITE PLAN
11-2014



STUDIO

SW

ARCHITECTS

STUDIO SOUTHWEST ARCHITECTS, INC.
2715 Mountain Road NW
Albuquerque, NM 87104
Tel: 505.243.1444
Web Site: www.studioswarchitects.com
Email: mail@studioswarchitects.com

© 2014, Studio Southwest Architects, Inc.
All rights reserved. This drawing is the property of Studio Southwest Architects, Inc. and is not to be reproduced or used in any manner without the written consent of Studio Southwest Architects, Inc. A portion of this drawing may be used for informational purposes only. The use of this drawing for any other purpose without the written consent of Studio Southwest Architects, Inc. is strictly prohibited. For complete terms see the Studio Southwest Agreement.

CONSULTANTS

Architect

Kim
Hooker

REGISTERED ARCHITECT
STATE OF NEW MEXICO
NO. 1448
EXPIRATION DATE 12/31/2015

Engineer

Reg Chavez Elem YDI
Portable

2700 Mountain Road NW
Albuquerque, NM 87104

No.

Date

Description

Revision Schedule

ISSUE:

CON DOCS

PROJECT NUMBER:

144

FILE:

144AS-111.RVT

DRAWN BY:

AKW

CHECKED BY:

Checker

DATE:

NOVEMBER 5, 2014

SHEET TITLE

OVERALL SITE PLAN

AS-101

C 249-8604

J12 0009 REGINALD CHAVEZ PORTABLES 9/19/14
From map notes cut off

Dirt underneath portables?

1.63' = 1'8" BUT TOP ^{POSTING} ~~FEET~~ + PORTABLE ~~IS~~ - YES

$$58.25 \text{ TOF} - 57.85 = .4$$

$$57.85 \text{ TOF} + 1.65 = 59.5$$

Will do another submitted for BP of building + increase pond
YES

Reducing size of pond

WSE 55.5

EXIST RET POND $V_{REQ} = 0.97$ $V_{NATC} = 3.33$ AC-FT

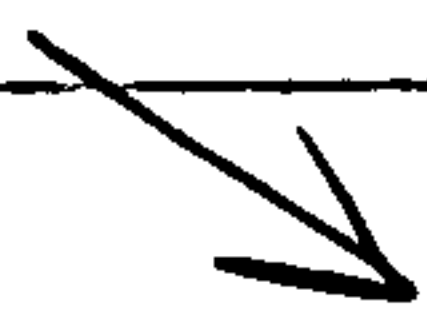

Per Jeff,

Coming in on a couple of who w/
BP for main one. Adding gravel
drive for fire access to back.
Will address ret pond.

CITY OF ALBUQUERQUE



March 28, 2008

Jeffrey G. Mortensen, P.E.
High Mesa Consulting Group
6010-B Midway Park Blvd. NE
Albuquerque, NM 87109

Re: Reginald Chavez Elementary School Parent Drop-Off, 2700 Mountain Rd. NW, Paving, Grading/Drainage Plan, & SO-19, Engineer's Stamp, 9/27/07, (J-12/D009)

Mr. Mortensen:

Thank you for providing an Engineer Certification for Paving and Grading/Drainage of the above referenced plan. It will be placed in the project file

If you have any questions, you can contact me at 924-3982.

Sincerely,

Timothy E. Sims
Plan Checker, Planning Dept.-Hydrology
Development and Building Services

C. file

DRAINAGE AND TRANSPORTATION INFORMATION SHEET

(REV. 1/28/2003rd)

PROJECT TITLE:	Reginald Chavez Elementary School Parent Drop-off and Parking Lot Improvements		ZONE ATLAS/DRNG. FILE #:	J-12/D9
DRB #:	EPC #:	WORK ORDER #:		
LEGAL DESCRIPTION:	A Portion of Tracts 317, 318, 319, 320A and 321, M.R.G.C.D Property Map No. 38, also known as Reginald Chavez Elementary School.			
CITY ADDRESS:	2700 Mountain Road NW, Albuquerque NM 87104			
ENGINEERING FIRM:	High Mesa Consulting Group	CONTACT:	Jeff Mortensen, PE 8547	
ADDRESS:	6010-B Midway Park Blvd. NE	PHONE:	(505) 345-4250	
CITY, STATE:	Albuquerque, NM	ZIP CODE:	87109	
OWNER:	Albuquerque Public Schools, Facilities Design and Construction	CONTACT:	Pamela Gow	
ADDRESS:	915 Oak Street SE	PHONE:	362-3184	
CITY, STATE:	Albuquerque, NM	ZIP CODE:	87106	
ARCHITECT:	N/A	CONTACT:		
ADDRESS:		PHONE:		
CITY, STATE:		ZIP CODE:		
SURVEYOR:	High Mesa Consulting Group	CONTACT:	Charles Cala, NMPS 11184	
ADDRESS:	6010-B Midway Park Blvd. NE	PHONE:	(505) 345-4250	
CITY, STATE:	Albuquerque, NM	ZIP CODE:	87109	
CONTRACTOR:	Albuquerque Asphalt	CONTACT:	Dan Fisher	
ADDRESS:	P.O. Box 66450	PHONE:	831-7311	
CITY, STATE:	Albuquerque, NM	ZIP CODE:	87193	

TYPE OF SUBMITTAL:

- ☐ DRAINAGE REPORT
☐ DRAINAGE PLAN 1st SUBMITTAL, *REQUIRES TCL or equal*
☐ DRAINAGE PLAN RESUBMITTAL
☐ CONCEPTUAL GRADING & DRAINAGE PLAN
☐ GRADING PLAN
☐ EROSION CONTROL PLAN
☐ ENGINEER'S CERTIFICATION (HYDROLOGY)
☐ CLOMR/LOMR
☐ TRAFFIC CIRCULATION LAYOUT (TCL)
☒ ENGINEER'S CERTIFICATION
☐ ENGINEER'S CERTIFICATION (DRB APPR. SITE PLAN)
☐ OTHER

CHECK TYPE OF APPROVAL SOUGHT:

- ☐ SIA/FINANCIAL GUARANTEE RELEASE
☐ PRELIMINARY PLAT APPROVAL
☐ S. DEV. PLAN FOR SUB'D APPROVAL
☐ S. DEV. PLAN FOR BLDG. PERMIT APPROVAL
☐ SECTOR PLAN APPROVAL
☐ FINAL PLAT APPROVAL
☐ FOUNDATION PERMIT APPROVAL
☐ BUILDING PERMIT APPROVAL
☐ CERTIFICATE OF OCCUPANCY (PERM.)
☐ CERTIFICATE OF OCCUPANCY (TEMP.)
☐ GRADING PERMIT APPROVAL
☐ PAVING PERMIT APPROVAL
☐ WORK ORDER APPROVAL
☒ OTHER (SPECIFY) - Update Records

WAS A PRE-DESIGN CONFERENCE ATTENDED:

- ☒ YES
☐ NO
☐ COPY PROVIDED

DATE SUBMITTED: 3/27/08 BY: Justin Schara, E.I.

Requests for approvals of Site Development Plans and/or Subdivision Plats shall be accompanied by a drainage submittal. The particular nature, location and scope of the proposed development defines the degree of drainage detail. One or more of the following levels of submittal may be required based upon the following:

1. **Conceptual Grading and Drainage Plan:** Required for approval of Site Development Plans greater than five (5) acres and Sector Plans.
2. **Drainage Plans:** Required for building permits, grading permits, paving permits and site plans less than five (5) acres.
3. **Drainage Report:** Required for subdivisions containing more than ten (10) lots or constituting five (5) acres or more.

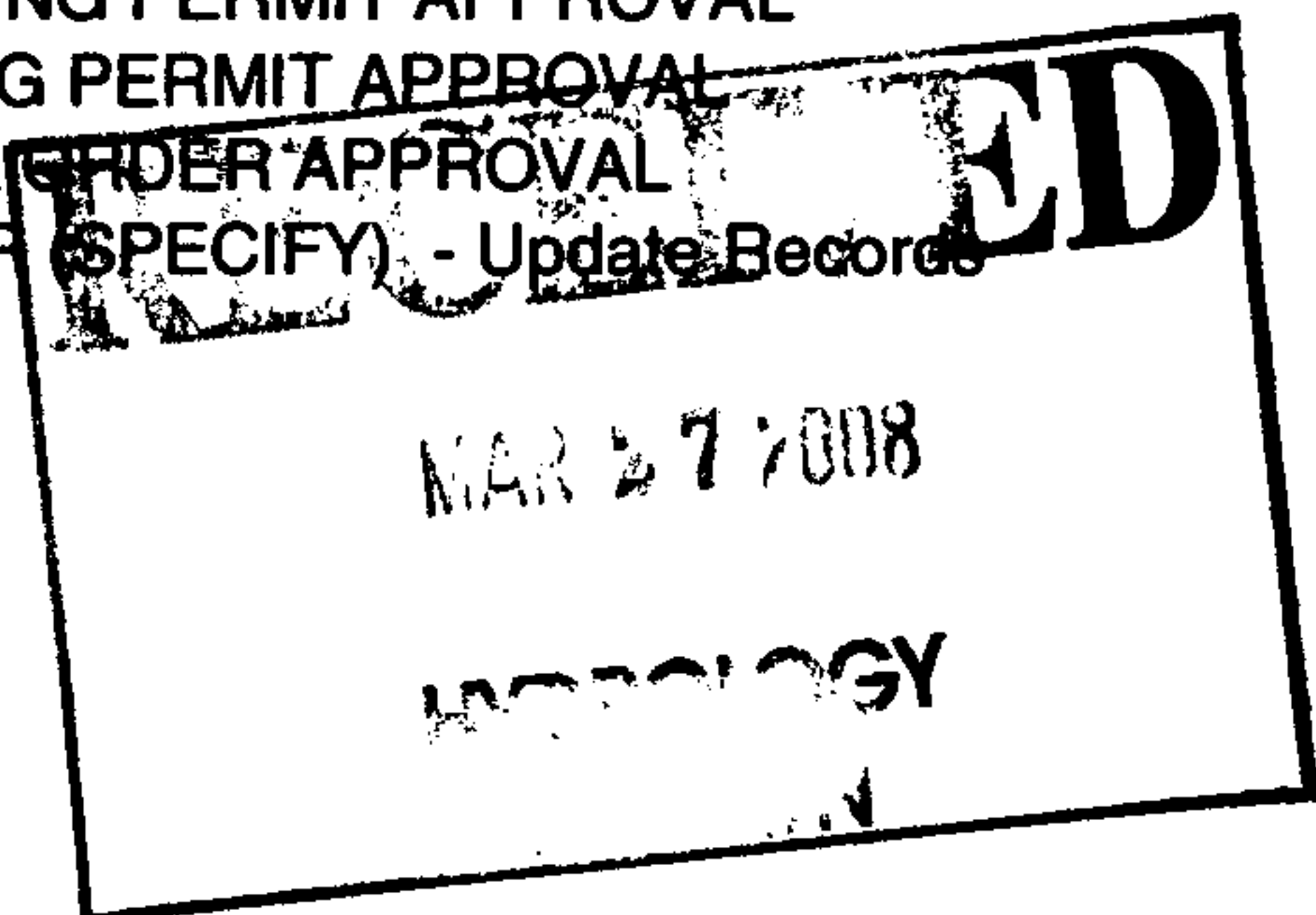

CITY OF ALBUQUERQUE



October 8, 2007

Jeffrey G. Mortensen, P.E.
Jeff Mortensen & Assoc., Inc.
6010-B Midway Park Blvd. NE
Albuquerque, NM 87109

**Re: Reginald Chavez Elementary School Master Drainage Plan
Engineer's Stamp dated 9-28-07 (J12/D9)**

Dear Mr. Mortensen,

Based upon the information provided in your submittal dated 9-28-07, the above referenced plan is approved to be the Master Drainage Plan.

If you have any questions, you can contact me at 924-3695.

P.O. Box 1293

Albuquerque

New Mexico 87103

www.cabq.gov

Sincerely,

Curtis A. Cherne, P.E.
Engineering Associate, Planning Dept.
Development and Building Services

C: file

KEYED NOTES (DEVELOPED CONDITIONS):

- ③⑦ EXISTING RR TIE WALL TO BE REMOVED
- ③⑧ EXISTING CONCRETE WALL AND ADJACENT STUMPS TO BE REMOVED
- ③⑨ MATCH EXISTING ASPHALT PAVEMENT GRADE
- ③⑩ MATCH EXISTING CONCRETE SIDEWALK GRADE
- ③⑪ NEW CONCRETE HEADER CURB
- ③⑫ NEW CONCRETE WALL PLANTERS, TYP
- ③⑬ CONSTRUCT 4' CONCRETE VALLEY GUTTER PER SECTION C1, SHEET 9
- ③⑭ CONSTRUCT AREA DRAIN STORM INLET PER DETAIL A2, SHEET 9
- ③⑮ INSTALL 6" PVC (SDR-35) STORM DRAIN ● S=0.0050
- ③⑯ INSTALL 1 - 6" 45 DEG ELL
- ③⑰ INSTALL 1 - 6" 22 1/2 DEG ELL
- ③⑱ NEW CONCRETE CONTAINMENT WALL
- ④① NEW CONCRETE SIDEWALK RAMP WITH HEADER CURBS PER SECTIONS C4 & D5, SHEET 9
- ④② NEW 4" CONCRETE PAVEMENT/SIDEWALK PER SECTION D3, SHEET 9
- ④③ NEW 3" ASPHALT CONCRETE PER SECTION D1, SHEET 9
- ④④ NEW SIDEWALK CULVERT BY SEPARATE PROJECT (SO#19 REQ'D IN R.O.W.)
- ④⑤ INSTALL SALVAGED PAVERS FROM COURTYARD
- ④⑥ EXISTING RR TIE WALL TO REMAIN
- ④⑦ NEW 1 1/2" ASPHALT PAVING OVERLAY
- ④⑧ NEW 3" ASPHALT CONCRETE BY SEPARATE PROJECT
- ④⑨ NEW 4" CONCRETE PAVEMENT/SIDEWALK BY SEPARATE PROJECT
- ④⑩ NEW 6" CURB & GUTTER BY SEPARATE PROJECT
- ④⑪ NEW 4" SD FROM BLDG. ROOF DRAIN TO NEW STORM INLET

UHIH

DRAINAGE AND TRANSPORTATION INFORMATION SHEET

(REV. 1/28/2003rd)

J-12/D9

PROJECT TITLE:	Reginald Chavez Elementary School Master Drainage Plan	ZONE ATLAS/DRNG. FILE #:	J-12/D9
DRB #:	EPC #:	WORK ORDER #:	
LEGAL DESCRIPTION:	A Portion of Tracts 317, 318, 319, 320A and 321, M.R.G.C.D Property Map No. 38, also known as Reginald Chavez Elementary School.		
CITY ADDRESS:	2700 Mountain Road NW, Albuquerque NM 87104		
ENGINEERING FIRM:	High Mesa Consulting Group	CONTACT:	Jeff Mortensen, PE 8547
ADDRESS:	6010-B Midway Park Blvd. NE	PHONE:	(505) 345-4250
CITY, STATE:	Albuquerque, NM	ZIP CODE:	87109
OWNER:	Albuquerque Public Schools, Facilities Design and Construction	CONTACT:	Pamela Gow
ADDRESS:	915 Oak Street SE	PHONE:	362-3184
CITY, STATE:	Albuquerque, NM	ZIP CODE:	87106
ARCHITECT:	N/A	CONTACT:	
ADDRESS:		PHONE:	
CITY, STATE:		ZIP CODE:	
SURVEYOR:	High Mesa Consulting Group	CONTACT:	Charles Cala, NMPS 11184
ADDRESS:	6010-B Midway Park Blvd. NE	PHONE:	(505) 345-4250
CITY, STATE:	Albuquerque, NM	ZIP CODE:	87109
CONTRACTOR:	N/A	CONTACT:	
ADDRESS:		PHONE:	
CITY, STATE:		ZIP CODE:	

TYPE OF SUBMITTAL:

- ☒ DRAINAGE REPORT
☐ DRAINAGE PLAN 1st SUBMITTAL, *REQUIRES TCL or equal*
☐ DRAINAGE PLAN RESUBMITTAL
☐ CONCEPTUAL GRADING & DRAINAGE PLAN
☐ GRADING PLAN
☐ EROSION CONTROL PLAN
☐ ENGINEER'S CERTIFICATION (HYDROLOGY)
☐ CLOMR/LOMR
☐ TRAFFIC CIRCULATION LAYOUT (TCL)
☐ ENGINEER'S CERTIFICATION (TCL)
☐ ENGINEER'S CERTIFICATION (DRB APPR. SITE PLAN)
☒ OTHER (MDP)

CHECK TYPE OF APPROVAL SOUGHT:

- ☐ SIA/FINANCIAL GUARANTEE RELEASE
☐ PRELIMINARY PLAT APPROVAL
☐ S. DEV. PLAN FOR SUB'D APPROVAL
☐ S. DEV. PLAN FOR BLDG. PERMIT APPROVAL
☐ SECTOR PLAN APPROVAL
☐ FINAL PLAT APPROVAL
☐ FOUNDATION PERMIT APPROVAL
☐ BUILDING PERMIT APPROVAL
☐ CERTIFICATE OF OCCUPANCY (PERM.)
☐ CERTIFICATE OF OCCUPANCY (TEMP.)
☐ GRADING PERMIT APPROVAL
☐ PAVING PERMIT APPROVAL
☐ WORK ORDER APPROVAL
☒ OTHER (SPECIFY) - Master Drainage Plan

WAS A PRE-DESIGN CONFERENCE ATTENDED:

- ☒ YES
☐ NO
☒ COPY PROVIDED

DATE SUBMITTED: 9/27/07

BY: Justin Schara, E.I.

Requests for approvals of Site Development Plans and/or Subdivision Plats shall be accompanied by a drainage submittal. The particular nature, location and scope of the proposed development defines the degree of drainage detail. One or more of the following levels of submittal may be required based upon the following:

- Conceptual Grading and Drainage Plan:** Required for approval of Site Development Plans greater than five (5) acres and Sector Plans.
- Drainage Plans:** Required for building permits, grading permits, paving permits and site plans less than five (5) acres.
- Drainage Report:** Required for subdivisions containing more than ten (10) lots or constituting five (5) acres or more.

CITY OF ALBUQUERQUE
DEVELOPMENT & BUILDING SERVICES CENTER
PLANNING DEPARTMENT/HYDROLOGY SECTION

CONFERENCE RECAP (JMA 2005.184.1)

DRAINAGE FILE/ZONE ATLAS PAGE NUMBER: J12/D9 DATE: 05-19-2006
CROSS REFERENCE NUMBERS: EPC DRB DRC
SUBJECT: REGINALD CHAVEZ ELEMENTARY SCHOOL
STREET ADDRESS: 2700 MOUNTAIN ROAD NW
SUBDIVISION NAME: TRACTS 317, 318, 319, 320A, AND 321, MRGCD MAP 38

TYPE OF APPROVAL

<input type="checkbox"/> PRELIMINARY PLAT	<input type="checkbox"/> FINAL PLAT
<input type="checkbox"/> SITE DEVELOPMENT PLAN	<input type="checkbox"/> BUILDING PERMIT
<input checked="" type="checkbox"/> OTHER GRADING & PAVING	<input type="checkbox"/> ROUGH GRADING

<u>ATTENDEE:</u>	<u>ORGANIZATION:</u>	<u>PHONE:</u>
BRAD BINGHAM	CITY HYDROLOGY	924-3986
JEFF MORTENSEN	JMA	345-4250

FINDINGS:

1. SITE IS NOT IN A DESIGNATED FLOOD HAZARD ZONE
2. THE LAST PLAN OF RECORD IS DATED 1985, ONLY SHOWS A PORTION OF THE SITE, AND DOES NOT PROVIDE A COMPREHENSIVE TREATMENT/EVALUATION OF SITE DRAINAGE (J12/D9)
3. A COMPREHENSIVE DRAINAGE REPORT (MASTER DRAINAGE PLAN – MDP) IS REQUIRED TO IDENTIFY THE FOLLOWING:
 - EXISTING CONDITIONS OF THE ENTIRE SITE AS DEPICTED BY CURRENT TOPOGRAPHY
 - ONSITE DRAINAGE BASINS AND ASSOCIATED OUTFALLS
 - OFFSITE FLOWS
 - AVAILABLE DOWNSTREAM CAPACITY (DISCUSS QUALITATIVELY OR QUANTITATIVELY AS APPROPRIATE)
 - ONSITE CAPACITY TO CONTAIN ONSITE RUNOFF
 - APPLICABILITY OF FLAT GRADING SCHEME (PLAYGROUND AREAS ONLY)
 - PROPOSED PROJECTS/SITE DEVELOPMENT AND PHASING (IF AVAILABLE)
4. MOUNTAIN ROAD APPEARS TO BE A SUITABLE OUTFALL FOR THOSE PORTIONS OF THE SITE DRAINING IN THAT DIRECTION (PROVIDE QUALITATIVE ANALYSIS AT A MINIMUM)

5. PLAYGROUND DRAINAGE AND PAVING IMPROVEMENTS ARE PROPOSED AT THIS TIME TO IMPROVE EXISTING PAVEMENT CONDITION AND DRAINAGE AS WELL AS TO PROVIDE BETTER ACCESS THROUGHOUT THE PLAYGROUND PORTIONS OF THE CAMPUS. SITE SPECIFIC PLAN REQUIRED FOR GRADING & PAVING PERMITS/APPROVALS FOR THIS SCOPE OF WORK.
6. NO BUILDINGS PROPOSED AT THIS TIME.

THE UNDERSIGNED AGREE THAT THE ABOVE FINDINGS ARE SUMMARIZED ACCURATELY AND ARE ONLY SUBJECT TO CHANGE IF FURTHER INVESTIGATION REVEALS THAT THE FINDINGS ARE NOT REASONABLE OR THAT THEY ARE BASED UPON INACCURATE INFORMATION.

SIGNED: Bradley L. Bjork
TITLE: CITY HYDROLOGIST
DATE: 6/26/06

SIGNED: [Signature]
TITLE: CONSULTANT
DATE: 06/26/2006

NOTE: PROVIDE A COPY OF THIS RECAP WITH DRAINAGE SUBMITTAL

CITY OF ALBUQUERQUE



April 27, 2009

Jeffery G. Mortensen, P.E.
High Mesa Consulting Group
6010-B Midway Park Blvd. NE
Albuquerque, NM 87109

**Re: Reginald Chavez Elementary School Playground, 2700 Mountain NW,
Grading/Drainage Plan, (J-12/D009)**

Engineer's Stamp Date: 09/10/2008

Certification Date: 04-24-09

Dear Mr. Mortensen,

PO Box 1293

Thank you for providing an Engineer Certification for the Grading/Drainage Plan, received on 4-27-09, for the above referenced plan. This information will be placed in the project file.

Albuquerque

If you have any questions, I can be contacted at 924-3982.

NM 87103

Sincerely,

www.cabq.gov

Timothy E. Sims
Plan Checker, Planning Dept.-Hydrology
Development and Building Services

C: file

DRAINAGE AND TRANSPORTATION INFORMATION SHEET

(REV. 1/28/2003rd)

PROJECT TITLE: REGINALD CHAVEZ ES PLAYGROUND ZONE ATLAS/DRNG. FILE #: J12 D009
 DRB #: _____ EPC #: _____ WORK ORDER #: _____

LEGAL DESCRIPTION: UNPLATTED PORTIONS OF MRGCD TRACTS
 CITY ADDRESS: 2700 MOUNTAIN ROAD NW 87104

ENGINEERING FIRM: HIGH MESA CONSULTING GROUP. CONTACT: JEFF MORTENSEN
 ADDRESS: 6010-B MIDWAY PARK BLVD. NE PHONE: (505) 345-4250
 CITY, STATE: ALBUQUERQUE, NM ZIP CODE: 87109

OWNER: ALBUQUERQUE PUBLIC SCHOOLS CONTACT: FRANK SHAW, JR.
 ADDRESS: 915 OAK STREET SE PHONE: 975-6248
 CITY, STATE: ALBUQUERQUE, NM ZIP CODE: 87106

ARCHITECT: N/A CONTACT: _____
 ADDRESS: _____ PHONE: _____
 CITY, STATE: _____ ZIP CODE: _____

SURVEYOR: HIGH MESA CONSULTING GROUP (NMPS 11184) CONTACT: CHARLES G. CALA, JR
 ADDRESS: 6010-B MIDWAY PARK BLVD. NE PHONE: (505) 345-4250
 CITY, STATE: ALBUQUERQUE, NM ZIP CODE: 87109

CONTRACTOR: ALBUQUERQUE ASPHALT CONTACT: DAN FISHER
 ADDRESS: _____ PHONE: 831-7311
 CITY, STATE: _____ ZIP CODE: _____

TYPE OF SUBMITTAL:

- ☐ DRAINAGE REPORT
☐ DRAINAGE PLAN 1st SUBMITTAL, **REQUIRES TCL or equal**
☐ DRAINAGE PLAN RESUBMITTAL
☐ CONCEPTUAL GRADING & DRAINAGE PLAN
☐ GRADING PLAN
☐ EROSION CONTROL PLAN
☒ ENGINEER'S CERTIFICATION (HYDROLOGY)
☐ CLOMR/LOMR
☐ TRAFFIC CIRCULATION LAYOUT (TCL)
☐ ENGINEER'S CERTIFICATION (TCL)
☐ ENGINEER'S CERTIFICATION (DRB APPR. SITE PLAN)
☐ OTHER - SO #19

CHECK TYPE OF APPROVAL SOUGHT:

- ☐ SIA/FINANCIAL GUARANTEE RELEASE
☐ PRELIMINARY PLAT APPROVAL
☐ S. DEV. PLAN FOR SUB'D APPROVAL
☐ S. DEV. PLAN FOR BLDG. PERMIT APPROVAL
☐ SECTOR PLAN APPROVAL
☐ FINAL PLAT APPROVAL
☐ FOUNDATION PERMIT APPROVAL
☐ BUILDING PERMIT APPROVAL
☐ CERTIFICATE OF OCCUPANCY (PERM.)
☐ CERTIFICATE OF OCCUPANCY (TEMP.)
☐ GRADING PERMIT APPROVAL
☐ PAVING PERMIT APPROVAL
☐ WORK ORDER APPROVAL
☒ OTHER (SPECIFY DRAINAGE REQUIREMENTS)

WAS A PRE-DESIGN CONFERENCE ATTENDED:

- ☐ YES
☐ NO
☐ COPY PROVIDED

DATE SUBMITTED: 04/27/2009 BY: JEFFREY G. MORTENSEN
 XC: KC TITSWORTH; FRANK SHAW

Requests for approvals of Site Development Plans and/or Subdivision Plats shall be accompanied by a drainage submittal. The particular nature, location and scope of the proposed development defines the degree of drainage detail. One or more of the following levels of submittal may be required based upon the following:

1. **Conceptual Grading and Drainage Plan:** Required for approval of Site Development Plans greater than five (5) acres and Sector Plans.
2. **Drainage Plans:** Required for building permits, grading permits, paving permits and site plans less than five (5) acres.
3. **Drainage Report:** Required for subdivisions containing more than ten (10) lots or constituting five (5) acres or more.

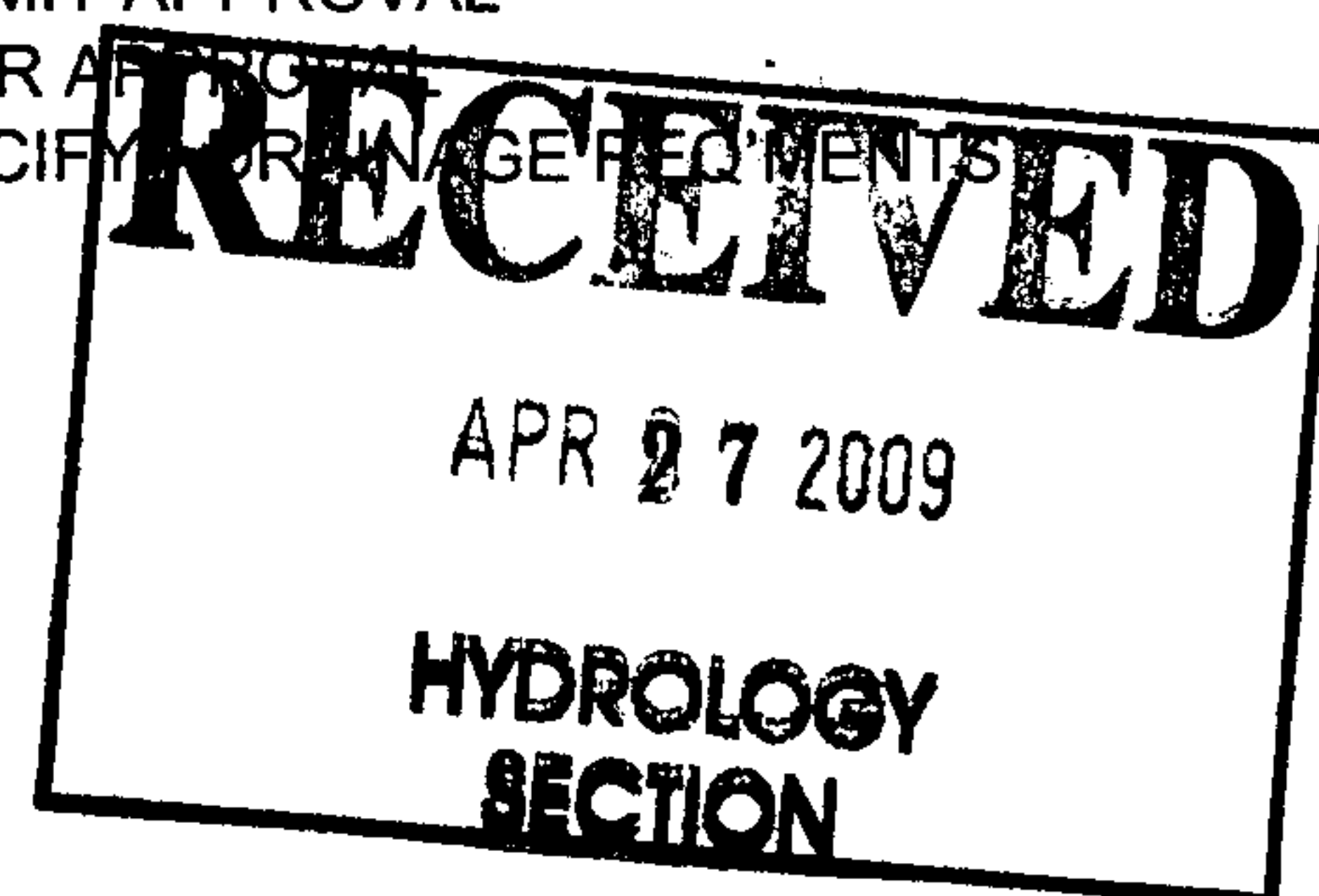

CITY OF ALBUQUERQUE

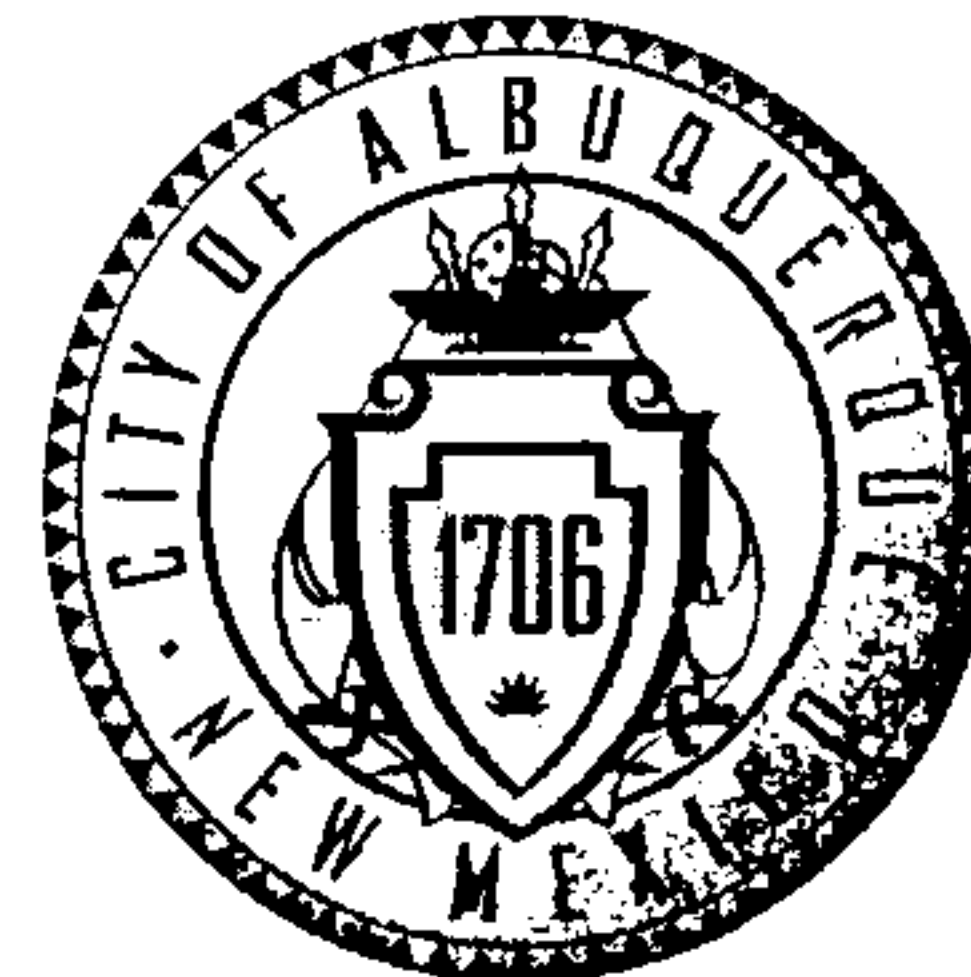

October 2, 2008

Jeffrey G. Mortensen, P.E.
High Mesa Consulting Group
6010-B Midway Park Blvd, NE
Albuquerque, NM 87109

Re: Reginald Chaveaz Elementary School (Playground & Drainage Modification)
2700 Mountain Road NW, Grading Plan
Engineer's Stamp dated 09-10-08 (J12/D009)

Dear Mr. Mortensen,

Based upon the information provided in your submittal received 09-11-08, the above referenced plan for Playground and Drainage Modification, TASK 1,2, & 3 are approved for Grading and Paving Permit. Upon completion, please attach an Engineer Certification for our files.

If you have any questions, you can contact me at 924-3630.

Sincerely,

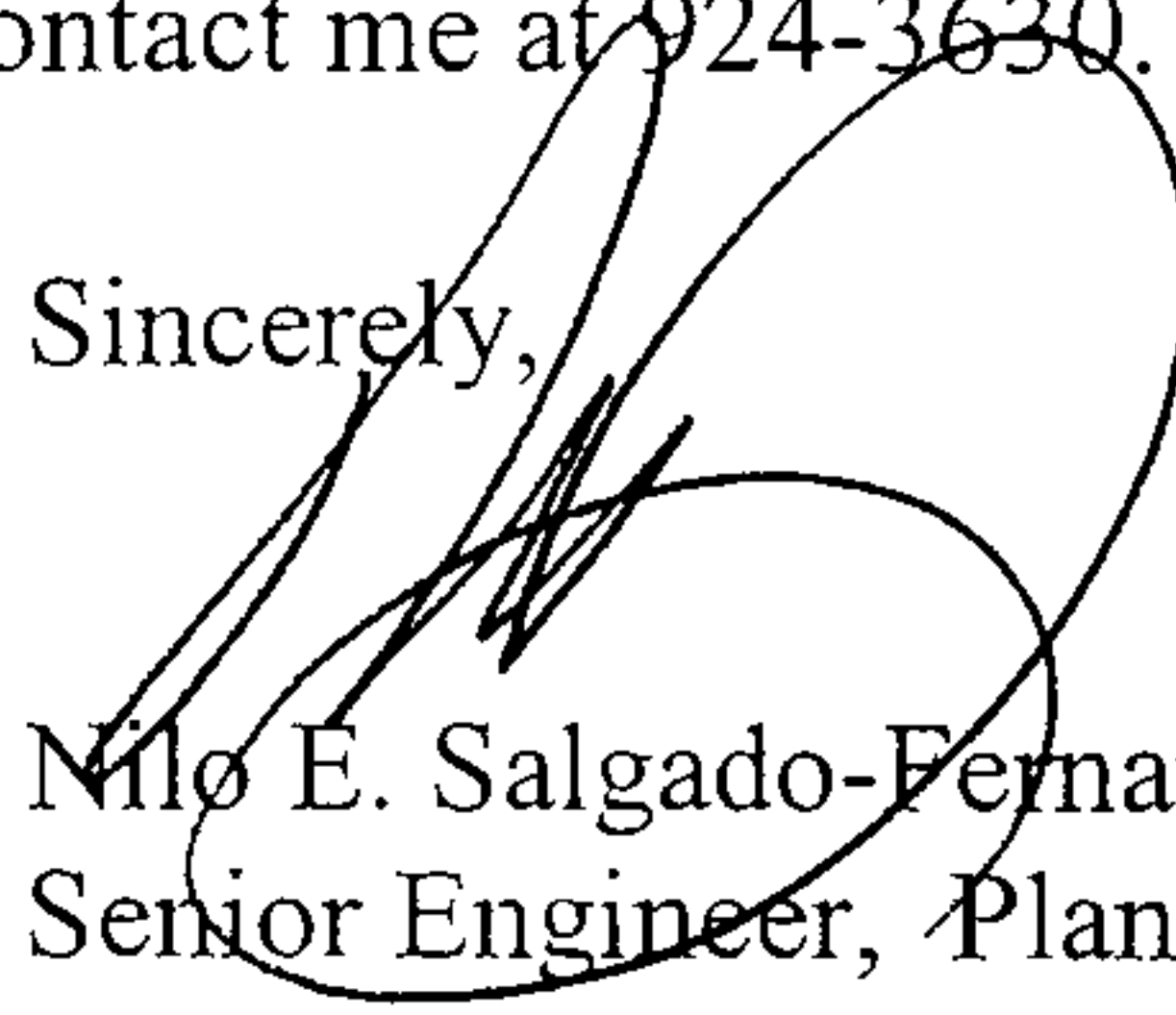
Nilo E. Salgado-Fernandez, P.E.
Senior Engineer, Planning Dept.
Development and Building Services

PO Box 1293

Albuquerque

NM 87103

C: File

www.cabq.gov

DRAINAGE AND TRANSPORTATION INFORMATION SHEET

(REV. 1/28/2003rd)

PROJECT TITLE:	Reginald Chavez Elementary School Playground & Drainage Improvements	ZONE ATLAS/DRNG. FILE #:	J-12/D9
DRB #:	EPC #:	WORK ORDER #:	
LEGAL DESCRIPTION:	A Portion of Tracts 317, 318, 319, 320A and 321, M.R.G.C.D Property Map No. 38, also known as Reginald Chavez Elementary School.		
CITY ADDRESS:	2700 Mountain Road NW, Albuquerque NM 87104		
ENGINEERING FIRM:	High Mesa Consulting Group	CONTACT:	Jeff Mortensen, PE 8547
ADDRESS:	6010-B Midway Park Blvd. NE	PHONE:	(505) 345-4250
CITY, STATE:	Albuquerque, NM	ZIP CODE:	87109
OWNER:	Albuquerque Public Schools, Facilities Design and Construction	CONTACT:	Keith (KC) Titsworth
ADDRESS:	915 Oak Street SE	PHONE:	848-8823
CITY, STATE:	Albuquerque, NM	ZIP CODE:	87106
ARCHITECT:	N/A	CONTACT:	
ADDRESS:		PHONE:	
CITY, STATE:		ZIP CODE:	
SURVEYOR:	High Mesa Consulting Group	CONTACT:	Charles Cala, NMPS 11184
ADDRESS:	6010-B Midway Park Blvd. NE	PHONE:	(505) 345-4250
CITY, STATE:	Albuquerque, NM	ZIP CODE:	87109
CONTRACTOR:	Albuquerque Asphalt	CONTACT:	Dan Fisher
ADDRESS:	PO Box 66450	PHONE:	831-7311
CITY, STATE:	Albuquerque, NM	ZIP CODE:	87193

TYPE OF SUBMITTAL:

- ☐ DRAINAGE REPORT
☒ DRAINAGE PLAN 1st SUBMITTAL, *REQUIRES TCL or equal*
☐ DRAINAGE PLAN RESUBMITTAL
☐ CONCEPTUAL GRADING & DRAINAGE PLAN
☒ GRADING PLAN
☐ EROSION CONTROL PLAN
☐ ENGINEER'S CERTIFICATION (HYDROLOGY)
☐ CLOMR/LOMR
☐ TRAFFIC CIRCULATION LAYOUT (TCL)
☐ ENGINEER'S CERTIFICATION (TCL)
☐ ENGINEER'S CERTIFICATION (DRB APPR. SITE PLAN)
☐ OTHER (MDP)

CHECK TYPE OF APPROVAL SOUGHT:

- ☐ SIA/FINANCIAL GUARANTEE RELEASE
☐ PRELIMINARY PLAT APPROVAL
☐ S. DEV. PLAN FOR SUB'D APPROVAL
☐ S. DEV. PLAN FOR BLDG. PERMIT APPROVAL
☐ SECTOR PLAN APPROVAL
☐ FINAL PLAT APPROVAL
☐ FOUNDATION PERMIT APPROVAL
☐ BUILDING PERMIT APPROVAL
☐ CERTIFICATE OF OCCUPANCY (PERM.)
☐ CERTIFICATE OF OCCUPANCY (TEMP.)
☒ GRADING PERMIT APPROVAL
☒ PAVING PERMIT APPROVAL
☐ WORK ORDER APPROVAL
☐ OTHER (SPECIFY)

WAS A PRE-DESIGN CONFERENCE ATTENDED:

- ☒ YES
☐ NO
☒ COPY PROVIDED

DATE SUBMITTED: 9/10/08 BY: Justin Schara, E.I.

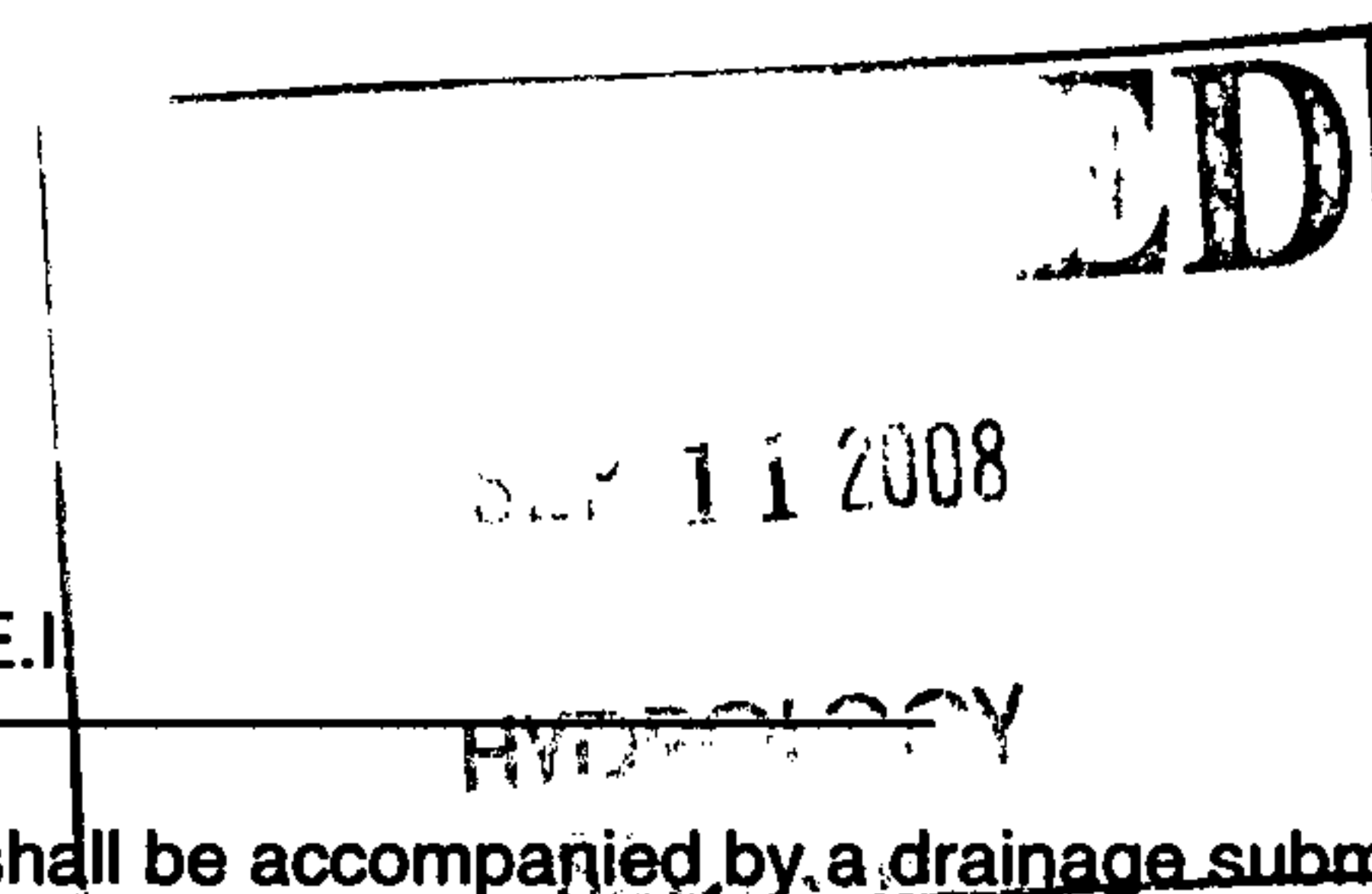

Requests for approvals of Site Development Plans and/or Subdivision Plats shall be accompanied by a drainage submittal. The particular nature, location and scope of the proposed development defines the degree of drainage detail. One or more of the following levels of submittal may be required based upon the following:

1. **Conceptual Grading and Drainage Plan:** Required for approval of Site Development Plans greater than five (5) acres and Sector Plans.
2. **Drainage Plans:** Required for building permits, grading permits, paving permits and site plans less than five (5) acres.
3. **Drainage Report:** Required for subdivisions containing more than ten (10) lots or constituting five (5) acres or more.

CITY OF ALBUQUERQUE
DEVELOPMENT & BUILDING SERVICES CENTER
PLANNING DEPARTMENT/HYDROLOGY SECTION

CONFERENCE RECAP (JMA 2005.184.1)

DRAINAGE FILE/ZONE ATLAS PAGE NUMBER: J12/D9____ DATE: 05-19-2006
CROSS REFERENCE NUMBERS: EPC____ DRB____ DRC____
SUBJECT: REGINALD CHAVEZ ELEMENTARY SCHOOL____
STREET ADDRESS: 2700 MOUNTAIN ROAD NW____
SUBDIVISION NAME: TRACTS 317, 318, 319, 320A, AND 321, MRGCD MAP 38

TYPE OF APPROVAL

____ PRELIMINARY PLAT	____ FINAL PLAT
____ SITE DEVELOPMENT PLAN	____ BUILDING PERMIT
<u>X</u> OTHER GRADING & PAVING	____ ROUGH GRADING

<u>ATTENDEE:</u>	<u>ORGANIZATION:</u>	<u>PHONE:</u>
BRAD BINGHAM____	CITY HYDROLOGY____	924-3986____
JEFF MORTENSEN____	JMA____	345-4250____

FINDINGS:

1. SITE IS NOT IN A DESIGNATED FLOOD HAZARD ZONE
2. THE LAST PLAN OF RECORD IS DATED 1985, ONLY SHOWS A PORTION OF THE SITE, AND DOES NOT PROVIDE A COMPREHENSIVE TREATMENT/EVALUATION OF SITE DRAINAGE (J12/D9)
3. A COMPREHENSIVE DRAINAGE REPORT (MASTER DRAINAGE PLAN – MDP) IS REQUIRED TO IDENTIFY THE FOLLOWING:
 - EXISTING CONDITIONS OF THE ENTIRE SITE AS DEPICTED BY CURRENT TOPOGRAPHY
 - ONSITE DRAINAGE BASINS AND ASSOCIATED OUTFALLS
 - OFFSITE FLOWS
 - AVAILABLE DOWNSTREAM CAPACITY (DISCUSS QUALITATIVELY OR QUANTITATIVELY AS APPROPRIATE)
 - ONSITE CAPACITY TO CONTAIN ONSITE RUNOFF
 - APPLICABILITY OF FLAT GRADING SCHEME (PLAYGROUND AREAS ONLY)
 - PROPOSED PROJECTS/SITE DEVELOPMENT AND PHASING (IF AVAILABLE)
4. MOUNTAIN ROAD APPEARS TO BE A SUITABLE OUTFALL FOR THOSE PORTIONS OF THE SITE DRAINING IN THAT DIRECTION (PROVIDE QUALITATIVE ANALYSIS AT A MINIMUM)

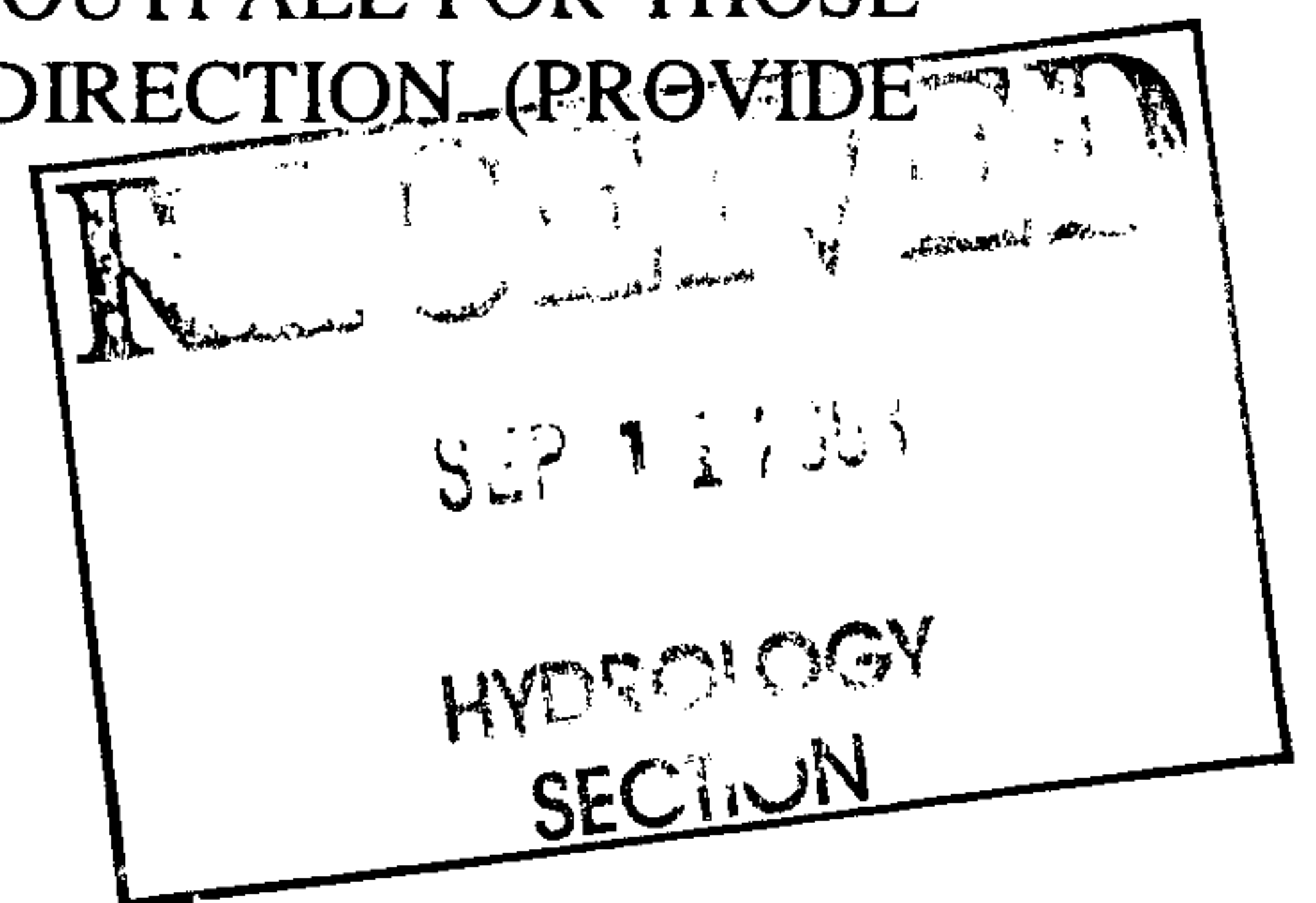

5. PLAYGROUND DRAINAGE AND PAVING IMPROVEMENTS ARE PROPOSED AT THIS TIME TO IMPROVE EXISTING PAVEMENT CONDITION AND DRAINAGE AS WELL AS TO PROVIDE BETTER ACCESS THROUGHOUT THE PLAYGROUND PORTIONS OF THE CAMPUS. SITE SPECIFIC PLAN REQUIRED FOR GRADING & PAVING PERMITS/APPROVALS FOR THIS SCOPE OF WORK.
6. NO BUILDINGS PROPOSED AT THIS TIME.

THE UNDERSIGNED AGREE THAT THE ABOVE FINDINGS ARE SUMMARIZED ACCURATELY AND ARE ONLY SUBJECT TO CHANGE IF FURTHER INVESTIGATION REVEALS THAT THE FINDINGS ARE NOT REASONABLE OR THAT THEY ARE BASED UPON INACCURATE INFORMATION.

SIGNED: _____	SIGNED: _____
TITLE: CITY HYDROLOGIST _____	TITLE: CONSULTANT _____
DATE: _____	DATE: _____

NOTE: PROVIDE A COPY OF THIS RECAP WITH DRAINAGE SUBMITTAL

DRAINAGE AND TRANSPORTATION INFORMATION SHEET

(REV. 1/28/2003rd)

J-12/D009

PROJECT TITLE:	Reginald Chavez Elementary School Parent Drop-off and Parking Lot Improvements	ZONE ATLAS/DRNG. FILE #:	J-12/D9
DRB #:	EPC #:	WORK ORDER #:	
LEGAL DESCRIPTION:	A Portion of Tracts 317, 318, 319, 320A and 321, M.R.G.C.D Property Map No. 38, also known as Reginald Chavez Elementary School.		
CITY ADDRESS:	2700 Mountain Road NW, Albuquerque NM 87104		
ENGINEERING FIRM:	High Mesa Consulting Group	CONTACT:	Jeff Mortensen, PE 8547
ADDRESS:	6010-B Midway Park Blvd. NE	PHONE:	(505) 345-4250
CITY, STATE:	Albuquerque, NM	ZIP CODE:	87109
VNER:	Albuquerque Public Schools, Facilities Design and Construction	CONTACT:	Pamela Gow
ADDRESS:	915 Oak Street SE	PHONE:	362-3184
CITY, STATE:	Albuquerque, NM	ZIP CODE:	87106
ARCHITECT:	N/A	CONTACT:	
ADDRESS:		PHONE:	
CITY, STATE:		ZIP CODE:	
SURVEYOR:	High Mesa Consulting Group	CONTACT:	Charles Cala, NMPS 11184
ADDRESS:	6010-B Midway Park Blvd. NE	PHONE:	(505) 345-4250
CITY, STATE:	Albuquerque, NM	ZIP CODE:	87109
CONTRACTOR:	Albuquerque Asphalt	CONTACT:	Dan Fisher
ADDRESS:	P.O. Box 66450	PHONE:	831-7311
CITY, STATE:	Albuquerque, NM	ZIP CODE:	87193

TYPE OF SUBMITTAL:

☐ DRAINAGE REPORT

☒ DRAINAGE PLAN 1st SUBMITTAL, *REQUIRES TCL or equal*

☐ DRAINAGE PLAN RESUBMITTAL

☐ CONCEPTUAL GRADING & DRAINAGE PLAN

☒ GRADING PLAN

☐ EROSION CONTROL PLAN

☐ ENGINEER'S CERTIFICATION (HYDROLOGY)

☐ CLOMR/LOMR

☐ TRAFFIC CIRCULATION LAYOUT (TCL)

☐ ENGINEER'S CERTIFICATION (TCL)

☐ ENGINEER'S CERTIFICATION (DRB APPR. SITE PLAN)

☐ OTHER

CHECK TYPE OF APPROVAL SOUGHT:

☐ SIA/FINANCIAL GUARANTEE RELEASE

☐ PRELIMINARY PLAT APPROVAL

☐ S. DEV. PLAN FOR SUB'D APPROVAL

☐ S. DEV. PLAN FOR BLDG. PERMIT APPROVAL

☐ SECTOR PLAN APPROVAL

☐ FINAL PLAT APPROVAL

☐ FOUNDATION PERMIT APPROVAL

☐ BUILDING PERMIT APPROVAL

☐ CERTIFICATE OF OCCUPANCY (PERM.)

☐ CERTIFICATE OF OCCUPANCY (TEMP.)

☒ GRADING PERMIT APPROVAL

☒ PAVING PERMIT APPROVAL

☐ WORK ORDER APPROVAL

☒ OTHER (SPECIFY) - SO #19

WAS A PRE-DESIGN CONFERENCE ATTENDED:

☒ YES

☐ NO

☒ COPY PROVIDED

DATE SUBMITTED: 9/27/07

BY: Justin Schara, E.I.

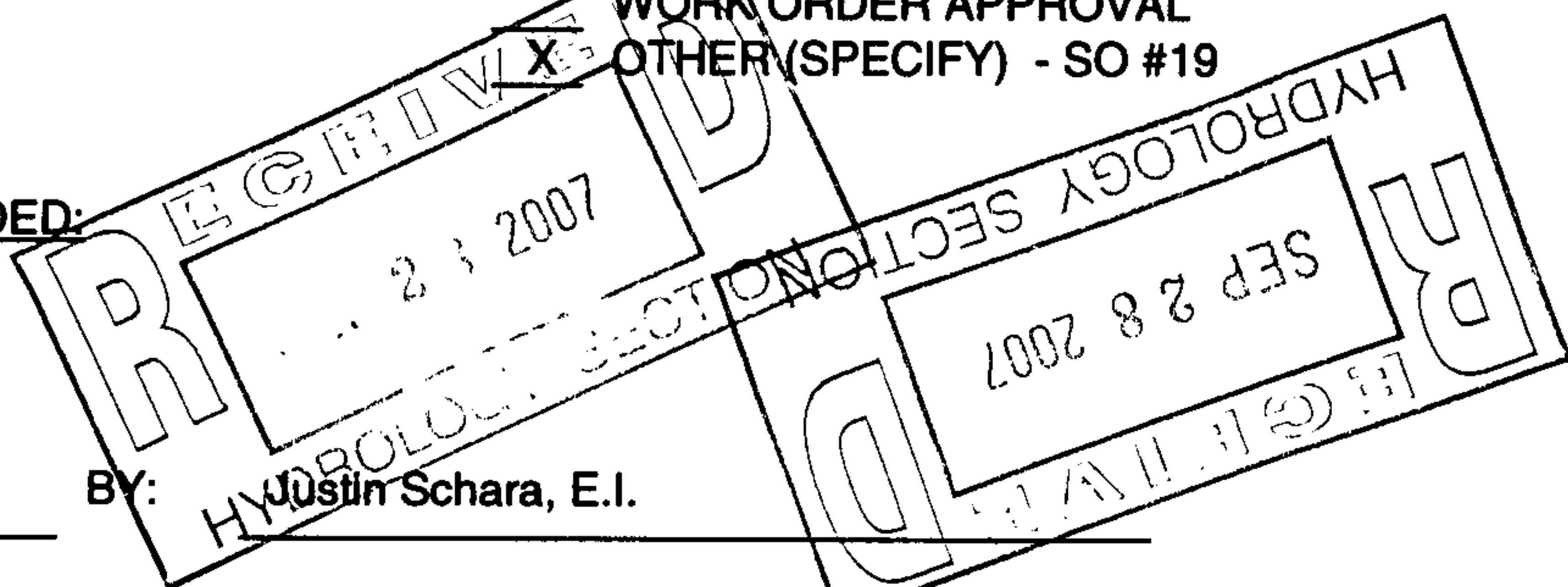

Requests for approvals of Site Development Plans and/or Subdivision Plats shall be accompanied by a drainage submittal. The particular nature, location and scope of the proposed development defines the degree of drainage detail. One or more of the following levels of submittal may be required based upon the following:

1. **Conceptual Grading and Drainage Plan:** Required for approval of Site Development Plans greater than five (5) acres and Sector Plans.
2. **Drainage Plans:** Required for building permits, grading permits, paving permits and site plans less than five (5) acres.
3. **Drainage Report:** Required for subdivisions containing more than ten (10) lots or constituting five (5) acres or more.

CITY OF ALBUQUERQUE



Post-it® Fax Note 7671		Date 2/21	# of pages 1
To Justin Schraga		From TIM SIMS	
Co./Dept.		Co.	
Phone #		Phone # 924-3982	
Fax #		Fax #	

October 8, 2007

Jeffrey G. Mortensen, P.E.
Jeff Mortensen & Assoc., Inc.
6010-B Midway Park Blvd. NE
Albuquerque, NM 87109

Re: Reginald Chavez Elementary School Parent Drop-Off and Parking Lot Improvements Grading Plan

Engineer's Stamp dated 9-27-07 (J12/D009)

Dear Mr. Mortensen,

Based upon the information provided in your submittal dated 9-28-07, the above referenced plan is approved for Grading Permit, Paving Permit, and SO 19 Permit.

P.O. Box 1293

A separate permit is required for construction within City ROW. A copy of this approval letter must be on hand when applying for the excavation permit.

Albuquerque

Upon completion of the project, please provide an Engineer Certification for our files.

New Mexico 87103

If you have any questions, you can contact me at 924-3695.

Sincerely,

www.cabq.gov

Curtis A. Cherne, P.E.
Engineering Associate, Planning Dept.
Development and Building Services

C: file
Antoinette Baldonado, Excavation and Barricading
Duane Schmitz, Street/Storm Drain Maintenance

CITY OF ALBUQUERQUE
DEVELOPMENT & BUILDING SERVICES CENTER
PLANNING DEPARTMENT/HYDROLOGY SECTION

CONFERENCE RECAP (JMA 2005.184.1)

DRAINAGE FILE/ZONE ATLAS PAGE NUMBER: J12/D9 _____ DATE: 05-19-2006
CROSS REFERENCE NUMBERS: EPC _____ DRB _____ DRC _____
SUBJECT: **REGINALD CHAVEZ ELEMENTARY SCHOOL** _____
STREET ADDRESS: **2700 MOUNTAIN ROAD NW** _____
SUBDIVISION NAME: **TRACTS 317, 318, 319, 320A, AND 321, MRGCD MAP 38**

TYPE OF APPROVAL

<input type="checkbox"/> PRELIMINARY PLAT	<input type="checkbox"/> FINAL PLAT
<input type="checkbox"/> SITE DEVELOPMENT PLAN	<input type="checkbox"/> BUILDING PERMIT
<input checked="" type="checkbox"/> OTHER GRADING & PAVING	<input type="checkbox"/> ROUGH GRADING

<u>ATTENDEE:</u>	<u>ORGANIZATION:</u>	<u>PHONE:</u>
BRAD BINGHAM _____	CITY HYDROLOGY _____	924-3986 _____
JEFF MORTENSEN _____	JMA _____	345-4250 _____

FINDINGS:

1. SITE IS NOT IN A DESIGNATED FLOOD HAZARD ZONE
2. THE LAST PLAN OF RECORD IS DATED 1985, ONLY SHOWS A PORTION OF THE SITE, AND DOES NOT PROVIDE A COMPREHENSIVE TREATMENT/EVALUATION OF SITE DRAINAGE (J12/D9)
3. A COMPREHENSIVE DRAINAGE REPORT (MASTER DRAINAGE PLAN – MDP) IS REQUIRED TO IDENTIFY THE FOLLOWING:
 - EXISTING CONDITIONS OF THE ENTIRE SITE AS DEPICTED BY CURRENT TOPOGRAPHY
 - ONSITE DRAINAGE BASINS AND ASSOCIATED OUTFALLS
 - OFFSITE FLOWS
 - AVAILABLE DOWNSTREAM CAPACITY (DISCUSS QUALITATIVELY OR QUANTITATIVELY AS APPROPRIATE)
 - ONSITE CAPACITY TO CONTAIN ONSITE RUNOFF
 - APPLICABILITY OF FLAT GRADING SCHEME (PLAYGROUND AREAS ONLY)
 - PROPOSED PROJECTS/SITE DEVELOPMENT AND PHASING (IF AVAILABLE)
4. MOUNTAIN ROAD APPEARS TO BE A SUITABLE OUTFALL FOR THOSE PORTIONS OF THE SITE DRAINING IN THAT DIRECTION (PROVIDE QUALITATIVE ANALYSIS AT A MINIMUM)

5. PLAYGROUND DRAINAGE AND PAVING IMPROVEMENTS ARE PROPOSED AT THIS TIME TO IMPROVE EXISTING PAVEMENT CONDITION AND DRAINAGE AS WELL AS TO PROVIDE BETTER ACCESS THROUGHOUT THE PLAYGROUND PORTIONS OF THE CAMPUS. SITE SPECIFIC PLAN REQUIRED FOR GRADING & PAVING PERMITS/APPROVALS FOR THIS SCOPE OF WORK.
6. NO BUILDINGS PROPOSED AT THIS TIME.

THE UNDERSIGNED AGREE THAT THE ABOVE FINDINGS ARE SUMMARIZED ACCURATELY AND ARE ONLY SUBJECT TO CHANGE IF FURTHER INVESTIGATION REVEALS THAT THE FINDINGS ARE NOT REASONABLE OR THAT THEY ARE BASED UPON INACCURATE INFORMATION.

SIGNED: Bradley L. Bigh
TITLE: CITY HYDROLOGIST
DATE: 6/26/06

SIGNED: [Signature]
TITLE: CONSULTANT
DATE: 106/26/2006

NOTE: PROVIDE A COPY OF THIS RECAP WITH DRAINAGE SUBMITTAL

J-12/D9

File

CITY OF ALBUQUERQUE
DEVELOPMENT & BUILDING SERVICES CENTER
PLANNING DEPARTMENT/HYDROLOGY SECTION

CONFERENCE RECAP (JMA 2005.184.1)

DRAINAGE FILE/ZONE ATLAS PAGE NUMBER: J12/D9 DATE: 05-19-2006
CROSS REFERENCE NUMBERS: EPC DRB DRC
SUBJECT: REGINALD CHAVEZ ELEMENTARY SCHOOL
STREET ADDRESS: 2700 MOUNTAIN ROAD NW
SUBDIVISION NAME: TRACTS 317, 318, 319, 320A, AND 321, MRGCD MAP 38

TYPE OF APPROVAL

PRELIMINARY PLAT FINAL PLAT
SITE DEVELOPMENT PLAN BUILDING PERMIT
X OTHER GRADING & PAVING ROUGH GRADING

ATTENDEE: ORGANIZATION: PHONE:
BRAD BINGHAM CITY HYDROLOGY 924-3986
JEFF MORTENSEN JMA 345-4250

FINDINGS:

1. SITE IS NOT IN A DESIGNATED FLOOD HAZARD ZONE
2. THE LAST PLAN OF RECORD IS DATED 1985, ONLY SHOWS A PORTION OF THE SITE, AND DOES NOT PROVIDE A COMPREHENSIVE TREATMENT/EVALUATION OF SITE DRAINAGE (J12/D9)
3. A COMPREHENSIVE DRAINAGE REPORT (MASTER DRAINAGE PLAN – MDP) IS REQUIRED TO IDENTIFY THE FOLLOWING:
 - EXISTING CONDITIONS OF THE ENTIRE SITE AS DEPICTED BY CURRENT TOPOGRAPHY
 - ONSITE DRAINAGE BASINS AND ASSOCIATED OUTFALLS
 - OFFSITE FLOWS
 - AVAILABLE DOWNSTREAM CAPACITY (DISCUSS QUALITATIVELY OR QUANTITATIVELY AS APPROPRIATE)
 - ONSITE CAPACITY TO CONTAIN ONSITE RUNOFF
 - APPLICABILITY OF FLAT GRADING SCHEME (PLAYGROUND AREAS ONLY)
 - PROPOSED PROJECTS/SITE DEVELOPMENT AND PHASING (IF AVAILABLE)
4. MOUNTAIN ROAD APPEARS TO BE A SUITABLE OUTFALL FOR THOSE PORTIONS OF THE SITE DRAINING IN THAT DIRECTION (PROVIDE QUALITATIVE ANALYSIS AT A MINIMUM)

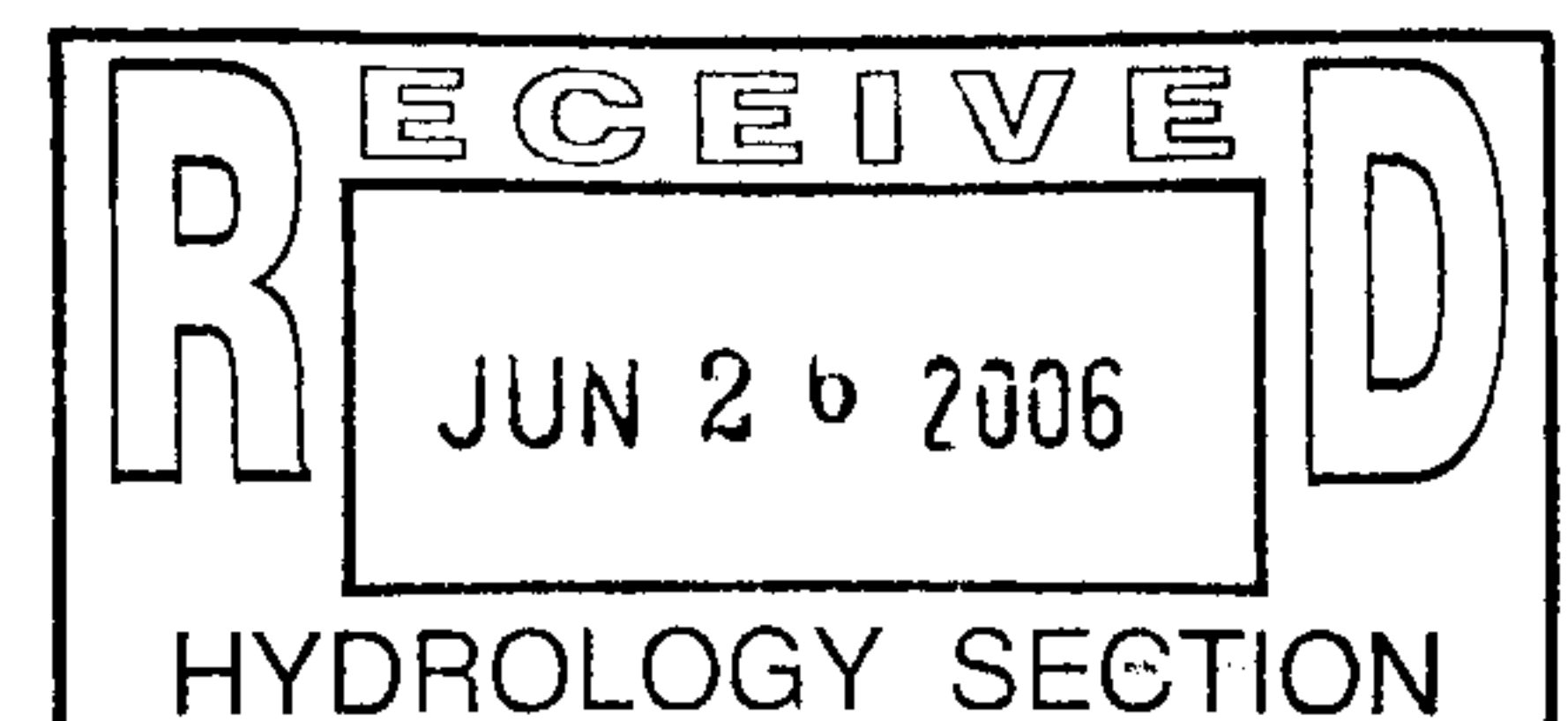

5. PLAYGROUND DRAINAGE AND PAVING IMPROVEMENTS ARE PROPOSED AT THIS TIME TO IMPROVE EXISTING PAVEMENT CONDITION AND DRAINAGE AS WELL AS TO PROVIDE BETTER ACCESS THROUGHOUT THE PLAYGROUND PORTIONS OF THE CAMPUS. SITE SPECIFIC PLAN REQUIRED FOR GRADING & PAVING PERMITS/APPROVALS FOR THIS SCOPE OF WORK.
6. NO BUILDINGS PROPOSED AT THIS TIME.

THE UNDERSIGNED AGREE THAT THE ABOVE FINDINGS ARE SUMMARIZED ACCURATELY AND ARE ONLY SUBJECT TO CHANGE IF FURTHER INVESTIGATION REVEALS THAT THE FINDINGS ARE NOT REASONABLE OR THAT THEY ARE BASED UPON INACCURATE INFORMATION.

SIGNED: Bradley L. Bihn
 TITLE: CITY HYDROLOGIST
 DATE: 6/26/06

SIGNED: [Signature]
 TITLE: CONSULTANT
 DATE: 106/26/2006

NOTE: PROVIDE A COPY OF THIS RECAP WITH DRAINAGE SUBMITTAL