

6" STANDARD C & G

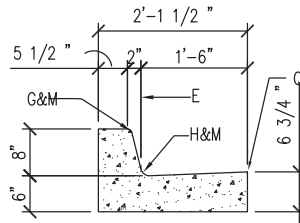

8" STANDARD C & G

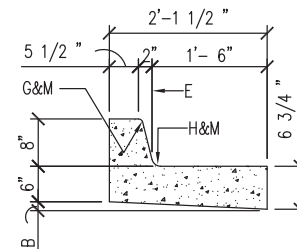

8" DEPRESSED
GUTTER

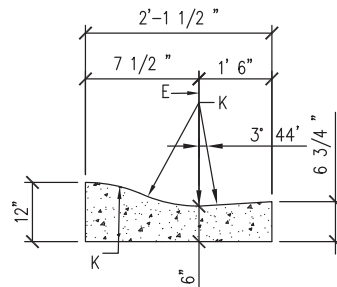

ROLL CURB

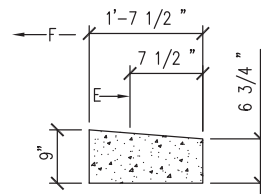

ESTATE CURB

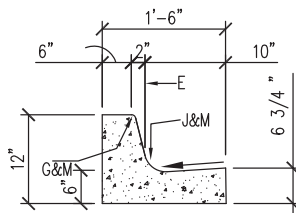

6" MEDIAN C & G

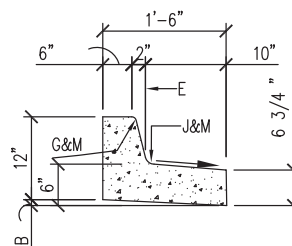

6" DEPRESSED
MEDIAN C & G

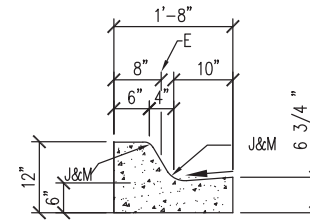

MOUNTABLE
MEDIAN CURB

GENERAL NOTES

1. CURB, GUTTER AND CUT-OFF WALL WILL BE CONSTRUCTED OF PORTLAND CEMENT CONCRETE (PCC).
2. FOR STANDARD AND MEDIAN C & G ADJACENT TO ASPHALT CONCRETE (AC) PAVEMENT, PROVIDE CONTRACTION JOINTS AT 12' MAX. SPACING, CONTRACTION JOINTS SHALL BE EITHER SAWED OR TOOLED A MINIMUM OF 1" DEEP AT FINISHED FACES. 1/2" EXPANSION JOINTS TO BE INSTALLED AT CURB RETURNS AND AT A MAXIMUM SPACING OF 200' BETWEEN CURB RETURNS AND SEPARATELY CONSTRUCTED DRIVEWAYS.
3. FOR ALL OTHER C & G AND CUT-OFF WALL PROVIDE CONTRACTION JOINTS AT 10' MAX SPACING, 1/2" EXPANSION JOINTS AT CURB RETURNS & AT A MAXIMUM SPACING OF 100' BETWEEN CURB RETURNS & EACH SIDE OF SEPARATELY CONSTRUCTED DRIVEWAYS. CONTRACTION JOINTS SHALL BE EITHER SAWED OR TOOLED A MINIMUM OF 1" DEEP AT ALL FINISHED FACES. REINFORCEMENT SHALL NOT BE USED IN CUT-OFF WALLS.
4. FOR C & G CONSTRUCTED WITH PCC PAVEMENT, CONTRACTION JOINTS AND EXPANSION JOINTS SHALL BE THE SAME AS THE PAVEMENT JOINTS.
5. ALL EDGES SHALL BE EDGED WITH A 3/8" RADIUS EDGING TOOL.
6. REMOVE & REPLACE PAVEMENT 1' WIDE ADJACENT TO LIP OF GUTTER WHEN CONSTRUCTING C & G ADJACENT TO EXISTING AC PAVEMENT.
7. 1/4" ISOLATION JOINT SHALL BE PLACED BETWEEN SIDEWALK AND C & G WHEN CAST ADJACENT TO EACH OTHER.
8. ADA = AMERICANS WITH DISABILITY ACT.

CONSTRUCTION NOTES

SEE COA DRAWING 2415B

REVISIONS	CITY OF ALBUQUERQUE
	PAVING
	CURB AND GUTTER DETAILS
	DWG. 2415A JUNE 2019