

CITY OF ALBUQUERQUE



August 28, 2014

Jeffrey G. Mortensen, P.E.
High Mesa Consulting Group
6010-B Midway Park Blvd NE
Albuquerque, NM 87109

Re: APS CEC Portables, 807 Mountain Rd NE
Request for C.O. –Accepted
Engineer's Stamp dated: 6-27-14, (J15/D001)
Certification dated: 8-27-14

Dear Mr. Mortensen,

Based upon the information provided in the Certification received 8-27-14, the above referenced Certification is acceptable for a release of a Permanent Certificate of Occupancy by Hydrology.

The sediment pond was not graded since a building is to be constructed in the near future. A silt fence was installed to prevent sediment from entering Mountain Rd.

The sediment pond would have required very little maintenance. Please inform the property owner that preventing sediment from entering Mountain Rd would be appreciated so that it does not clog downstream storm drains.

If you have any questions, you can contact me at 924-3986.

Sincerely,

Curtis A. Cherne, P.E.
Principal Engineer, Hydrology
Planning Dept.

C: CO Clerk
File

BENCHMARKS

PROJECT BENCHMARK

CITY OF ALBUQUERQUE SURVEY CONTROL 3 1/4" ALUMINUM DISK STAMPED "9-115 1990", RIVETED TO AN ALUMINUM TUBE PROJECTING 0.25" ABOVE GRADE ON THE NORTH SIDE OF LOMAS BLVD. N.E. APPROXIMATELY 244' WEST OF THE INTERSECTION WITH LEGION ROAD N.E.
ELEVATION = 5093.057 FEET (NAVD 88)

TEMPORARY BENCHMARK #2 (T.B.M.)

A #5 REBAR WITH CONTROL CAP STAMPED "HMC CONTROL NMPS 11184", IN THE NORTHWESTERN PORTION OF THE SITE, AS SHOWN ON THIS SHEET.
ELEVATION = 5026.87 FEET (NAVD 88)

GRADING LEGEND

INV	INVERT
TA	TOP OF ASPHALT PAVEMENT
TC	TOP OF CURB
TG	TOP OF GRATE
+ 20.05	EXISTING SPOT ELEVATION
14.00	PROPOSED SPOT ELEVATION
4920	EXISTING FLOWLINE
20	PROPOSED FLOWLINE
	EXISTING CONTOUR
	PROPOSED CONTOUR
	EXISTING DIRECTION OF FLOW
	PROPOSED DIRECTION OF FLOW
	RIGHT OF WAY LINE
	PUBLIC EASEMENT LINE
	HIGH POINT / DIVIDE
	EXISTING FENCE
	PROPOSED SILT FENCE
	SILT FENCE
	PROPOSED CONCRETE
	PROPOSED ASPHALT PAVING

CONSTRUCTION NOTES:

- TWO (2) WORKING DAYS PRIOR TO ANY EXCAVATION, CONTRACTOR MUST CONTACT NEW MEXICO ONE CALL SYSTEM 260-1990 FOR DESIGNATION (LINE-SPOTTING) OF EXISTING PUBLIC UTILITIES AND EXISTING UTILITIES OWNED AND OPERATED BY ALBUQUERQUE PUBLIC SCHOOLS.
- PRIOR TO CONSTRUCTION, THE CONTRACTOR SHALL EXCAVATE AND VERIFY THE HORIZONTAL AND VERTICAL LOCATION OF ALL POTENTIAL OBSTRUCTIONS. SHOULD A CONFLICT EXIST, THE CONTRACTOR SHALL NOTIFY THE ENGINEER IN WRITING SO THAT THE CONFLICT CAN BE RESOLVED WITH A MINIMUM AMOUNT OF DELAY. THE CONTRACTOR SHALL BE RESPONSIBLE FOR ALL INTERPRETATIONS IT MAKES WITHOUT FIRST CONTACTING THE ENGINEER AS REQUIRED ABOVE.
- ALL WORK ON THIS PROJECT SHALL BE PERFORMED IN ACCORDANCE WITH APPLICABLE FEDERAL, STATE AND LOCAL LAWS, RULES AND REGULATIONS CONCERNING CONSTRUCTION SAFETY AND HEALTH.
- ALL CONSTRUCTION WITHIN PUBLIC RIGHT-OF-WAY SHALL BE PERFORMED IN ACCORDANCE WITH APPLICABLE CITY OF ALBUQUERQUE STANDARDS AND PROCEDURES.
- IF ANY UTILITY LINES, PIPELINES, OR UNDERGROUND UTILITY LINES ARE SHOWN ON THESE DRAWINGS, THEY ARE SHOWN IN AN APPROXIMATE MANNER ONLY. THE CONTRACTOR SHALL PROMPTLY CLEAN UP ANY MATERIAL EXCAVATED WITHIN THE PUBLIC RIGHT-OF-WAY SO THAT THE EXCAVATED MATERIAL IS NOT SUSCEPTIBLE TO BEING WASHED DOWN THE STREET.
- WHEN APPLICABLE, CONTRACTOR SHALL SECURE "TOPSOIL DISTURBANCE PERMIT" FROM THE CITY AND/OR FILE A NOTICE OF INTENT (N.O.I.) WITH THE EPA PRIOR TO BEGINNING CONSTRUCTION.

EROSION CONTROL MEASURES:

- THE CONTRACTOR SHALL ENSURE THAT NO SOIL ERODES FROM THE SITE INTO PUBLIC RIGHT-OF-WAY OR ONTO PRIVATE PROPERTY.
- THE CONTRACTOR SHALL PROMPTLY CLEAN UP ANY MATERIAL EXCAVATED WITHIN THE PUBLIC RIGHT-OF-WAY SO THAT THE EXCAVATED MATERIAL IS NOT SUSCEPTIBLE TO BEING WASHED DOWN THE STREET.
- WHEN APPLICABLE, CONTRACTOR SHALL SECURE "TOPSOIL DISTURBANCE PERMIT" FROM THE CITY AND/OR FILE A NOTICE OF INTENT (N.O.I.) WITH THE EPA PRIOR TO BEGINNING CONSTRUCTION.

SURVEY NOTE:

THIS IS NOT A BOUNDARY SURVEY; DATA IS SHOWN FOR ORIENTATION ONLY. THE BOUNDARY INFORMATION DEPICTED BY THIS PLAN IS BASED UPON A PREVIOUS PRELIMINARY, UNCERTIFIED SURVEY, PREPARED BY HIGH MESA CONSULTING GROUP, NMPS 11184, DATED 2009. THE TOPOGRAPHIC INFORMATION DEPICTED HEREON IS BASED UPON THE TOPOGRAPHIC AND UTILITY SURVEY PREPARED BY HIGH MESA CONSULTING GROUP, NMPS NO. 11184, DATED 05-26-2003 (2003.8864).

HIGH MESA Consulting Group

6010-8 MIDWAY PARK BLVD. NE • ALBUQUERQUE, NEW MEXICO 87109
PHONE: 505.345.4250 • FAX: 505.345.4254 • www.highmesacg.com

GRADING PLAN - SOUTH PORTABLE CLASSROOM RELOCATIONS CAREER ENRICHMENT CENTER 807 MOUNTAIN ROAD N.E.

RECORD DRAWING FOR CERTIFICATION, SEE SHEET 1 of 1

DESIGNED BY	DATE	BY	REVISIONS	JOB NO.
J.G.M.	08/14	J.G.M.	RECORD DRAWING & DRAINAGE CERTIFICATION	2013.184.2
DRAWN BY	DATE	BY	REVISIONS	DATE
J.Y.R.				06-2014
APPROVED BY	DATE	BY	REVISIONS	SHEET
J.G.M.				7 OF 14

08-27-2014
JEFFREY G. MONTENEGRO
NEW MEXICO
8547
PROFESSIONAL ENGINEER
06-27-2014

BENCHMARKS

PROJECT BENCHMARK

CITY OF ALBUQUERQUE SURVEY CONTROL 3 1/4" ALUMINUM DISK STAMPED "9-115 1990", RIVETED TO AN ALUMINUM TUBE PROJECTING 0.25' ABOVE GRADE ON THE NORTH SIDE OF LOMAS BLVD. N.E. APPROXIMATELY 244' WEST OF THE INTERSECTION WITH LEGION ROAD N.E.
ELEVATION = 5093.057 FEET (NAVD 88)

TEMPORARY BENCHMARK #2 (T.B.M.)

A #5 REBAR WITH CONTROL CAP STAMPED "HMC CONTROL NMPS 11184", IN THE NORTHWESTERN PORTION OF THE SITE, AS SHOWN ON THIS SHEET.
ELEVATION = 5026.87 FEET (NAVD 88)

GRADING LEGEND

INV	INVERT
TA	TOP OF ASPHALT PAVEMENT
TC	TOP OF CURB
TG	TOP OF GRATE
+ 20.05	EXISTING SPOT ELEVATION
14.00	PROPOSED SPOT ELEVATION
4920	EXISTING FLOWLINE
20	PROPOSED FLOWLINE
	EXISTING CONTOUR
	PROPOSED CONTOUR
	EXISTING DIRECTION OF FLOW
	PROPOSED DIRECTION OF FLOW
	RIGHT OF WAY LINE
	PUBLIC EASEMENT LINE
	HIGH POINT / DIVIDE
	EXISTING FENCE
	PROPOSED SILT FENCE
	PROPOSED WADDELS
	PROPOSED CONCRETE
	PROPOSED ASPHALT PAVING

LIMITS OF HYDROLOGIC ANALYSIS (125'x300')

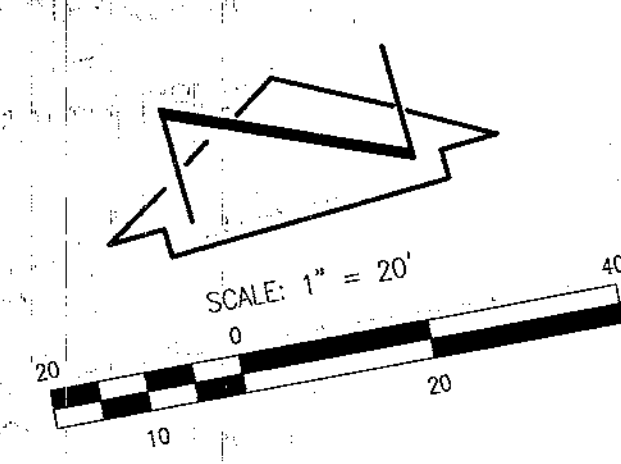
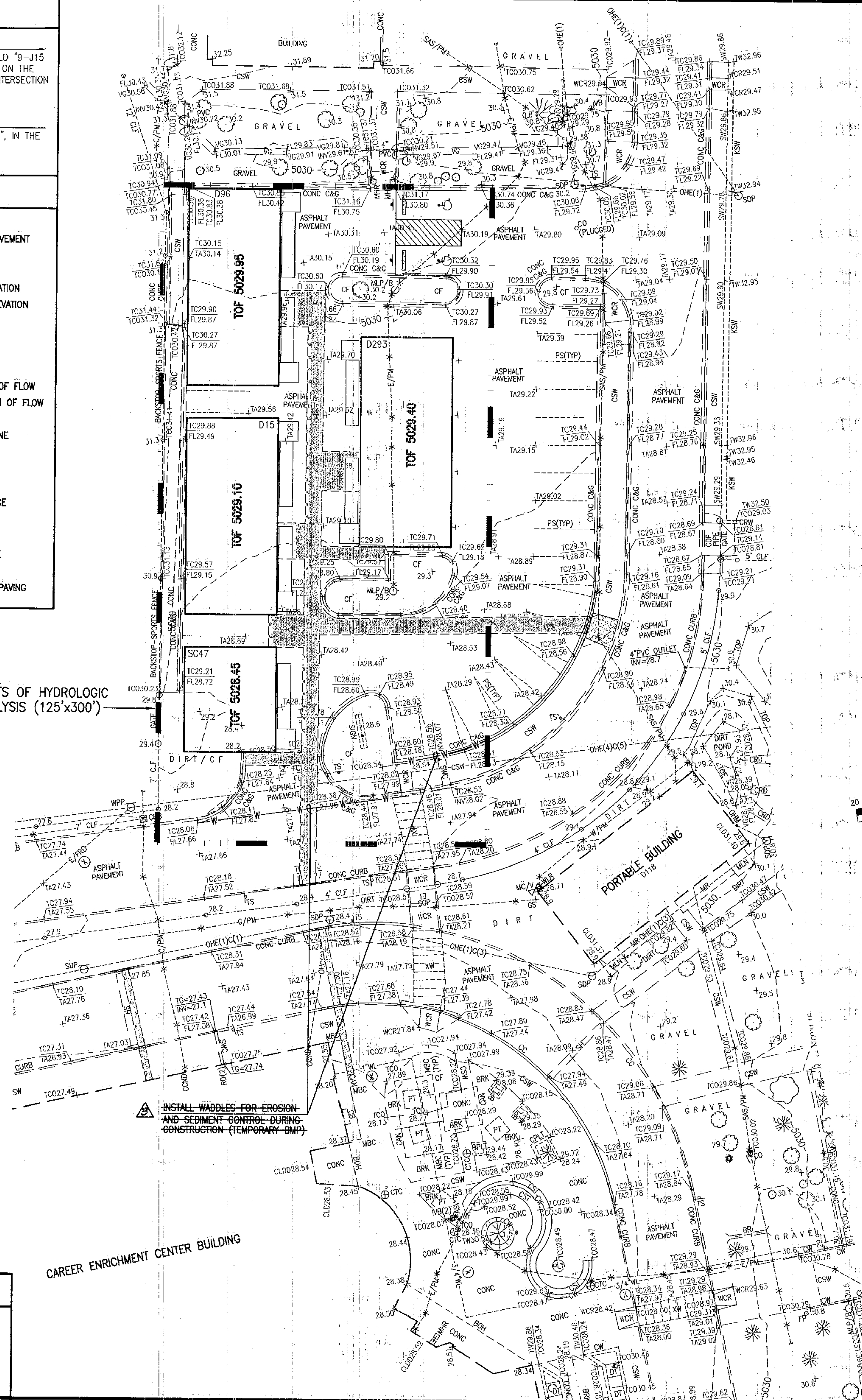

CONSTRUCTION NOTES:

- TWO (2) WORKING DAYS PRIOR TO ANY EXCAVATION, CONTRACTOR MUST CONTACT NEW MEXICO ONE CALL SYSTEM 260-1990 FOR DESIGNATION (LINE-SPOTTING) OF EXISTING PUBLIC UTILITIES AND EXISTING UTILITIES OWNED AND OPERATED BY ALBUQUERQUE PUBLIC SCHOOLS.
- PRIOR TO CONSTRUCTION, THE CONTRACTOR SHALL EXCAVATE AND VERIFY THE HORIZONTAL AND VERTICAL LOCATION OF ALL POTENTIAL OBSTRUCTIONS. SHOULD A CONFLICT EXIST, THE CONTRACTOR SHALL NOTIFY THE ENGINEER IN WRITING. SO THAT THE CONFLICT CAN BE RESOLVED WITH A MINIMUM AMOUNT OF DELAY. THE CONTRACTOR SHALL BE RESPONSIBLE FOR ALL INTERPRETATIONS IT MAKES WITHOUT FIRST CONTACTING THE ENGINEER AS REQUIRED ABOVE.
- ALL WORK ON THIS PROJECT SHALL BE PERFORMED IN ACCORDANCE WITH APPLICABLE FEDERAL, STATE AND LOCAL LAWS, RULES AND REGULATIONS CONCERNING CONSTRUCTION SAFETY AND HEALTH.
- ALL CONSTRUCTION WITHIN PUBLIC RIGHT-OF-WAY SHALL BE PERFORMED IN ACCORDANCE WITH APPLICABLE CITY OF ALBUQUERQUE STANDARDS AND PROCEDURES.
- IF ANY UTILITY LINES, PIPELINES, OR UNDERGROUND UTILITY LINES ARE SHOWN ON THESE DRAWINGS, THEY ARE SHOWN IN AN APPROXIMATE MANNER ONLY. AND SUCH LINES MAY EXIST WHERE NONE ARE SHOWN. IF ANY SUCH EXISTING LINES ARE SHOWN, THE LOCATION IS BASED UPON INFORMATION PROVIDED BY THE OWNER OF SAID UTILITY, AND THE INFORMATION MAY BE INCOMPLETE, OR MAY BE OBSOLETE BY THE TIME CONSTRUCTION COMMENCES. THE ENGINEER HAS CONDUCTED ONLY PRELIMINARY INVESTIGATION OF THE LOCATION, DEPTH, SIZE, OR TYPE OF EXISTING UTILITY LINES, PIPELINES, OR UNDERGROUND UTILITY LINES. THIS INVESTIGATION IS NOT CONCLUSIVE, AND MAY NOT BE COMPLETE. THEREFORE, MAKES NO REPRESENTATION PERTAINING THERETO, AND ASSUMES NO RESPONSIBILITY OR LIABILITY THEREFOR. THE CONTRACTOR SHALL INFORM ITSELF OF THE LOCATION OF ANY UTILITY LINE, PIPELINE, OR UNDERGROUND UTILITY LINE IN OR NEAR THE AREA OF THE WORK IN ADVANCE OF AND DURING EXCAVATION WORK. THE CONTRACTOR IS FULLY RESPONSIBLE FOR ANY AND ALL DAMAGE CAUSED BY ITS FAILURE TO LOCATE, IDENTIFY AND PRESERVE ANY AND ALL EXISTING UTILITIES, PIPELINES, AND UNDERGROUND UTILITY LINES. IN PLANNING AND CONDUCTING EXCAVATION, THE CONTRACTOR SHALL COMPLY WITH STATE STATUTES, MUNICIPAL AND LOCAL ORDINANCES, RULES AND REGULATIONS, IF ANY, PERTAINING TO THE LOCATION OF THESE LINES AND FACILITIES.

EROSION CONTROL MEASURES:

- THE CONTRACTOR SHALL ENSURE THAT NO SOIL ERODES FROM THE SITE INTO PUBLIC RIGHT-OF-WAY OR ONTO PRIVATE PROPERTY.
- THE CONTRACTOR SHALL PROMPTLY CLEAN UP ANY MATERIAL EXCAVATED WITHIN THE PUBLIC RIGHT-OF-WAY SO THAT THE EXCAVATED MATERIAL IS NOT SUSCEPTIBLE TO BEING WASHED DOWN THE STREET.
- WHEN APPLICABLE, CONTRACTOR SHALL SECURE "TOPSOIL DISTURBANCE PERMIT" FROM THE CITY AND/OR FILE A NOTICE OF INTENT (N.O.I.) WITH THE EPA PRIOR TO BEGINNING CONSTRUCTION.

NOTE:
FOR AS-CONSTRUCTED PIER ELEVATIONS, SEE SHEET 13 OF 14

SURVEY NOTE:

THIS IS NOT A BOUNDARY SURVEY; DATA IS SHOWN FOR ORIENTATION ONLY. THE BOUNDARY INFORMATION DEPICTED BY THIS PLAN IS BASED UPON A PREVIOUS PRELIMINARY, UNCERTIFIED SURVEY, PREPARED BY HIGH MESA CONSULTING GROUP, NMPS 11184, DATED 2009. THE TOPOGRAPHIC INFORMATION DEPICTED HEREON IS BASED UPON THE TOPOGRAPHIC AND UTILITY SURVEY PREPARED BY HIGH MESA CONSULTING GROUP, NMPS NO. 11184, DATED 05-26-2003 (2003.08.04).

HIGH MESA Consulting Group
6010-B MIDWAY PARK BLVD. N.E. • ALBUQUERQUE, NEW MEXICO 87109
PHONE: 505.345.4250 • FAX: 505.345.4254 • www.highmesacg.com

GRADING PLAN - NORTH
PORTABLE CLASSROOM RELOCATIONS
CAREER ENRICHMENT CENTER
807 MOUNTAIN ROAD N.E.

RECORD DRAWING
FOR CERTIFICATION, SEE SHEET 1 of 1

DESIGNED BY	DATE	BY	REVISIONS	JOB NO.
J.G.M.	08/14	J.G.M.	RECORD DRAWINGS & DRAINAGE CERTIFICATION	2013.184.2
DRAWN BY	DATE	BY		
J.Y.R.				06-2014
APPROVED BY	DATE	BY		
J.G.M.				8 OF 14