



Stormwater Quality Plan Information Sheet and Inspection Fee Schedule

Project Name: _____

Project Location: (address or major cross streets/arroyo) _____

Plan Preparer Information:

Company: _____

Contact: _____

Address: _____

Phone Number: (O) _____ (Cell (optional)) _____

e-Mail: _____

Owner Information:

Company: _____

Contact: _____

Address: _____

Phone: _____

e-Mail: _____

I am submitting the ESC plan to obtain approval for:

___ Grading ___ Building Permit ___ Work Order Construction Plans

Note: More than one item can be checked for a submittal

Stormwater Quality Inspection fee: (based on development type and disturbed area)

Commercial	< 2 acres \$300 <input type="checkbox"/>	2 to 5 acres \$500 <input type="checkbox"/>	>5 acres \$800 <input type="checkbox"/>
Land/Infrastructure	< 5 acres \$300 <input type="checkbox"/>	5 to 40 acres \$500 <input type="checkbox"/>	>40 acres \$800 <input type="checkbox"/>
Multi - family	< 5 acres \$500 <input type="checkbox"/>	≥5 acres \$800 <input type="checkbox"/>	
Single Family Residential	<5 acres \$500 <input type="checkbox"/>	5 to 40 acres \$1000 <input type="checkbox"/>	> 40 acres \$1500 <input type="checkbox"/>

Plan Review fee is \$105 for the first submittal ☐ and \$75.00 for a resubmittal ☐

Total due equals the plan review fee plus the Stormwater Quality Inspection fee.

Total Due \$ _____

If you have questions, please contact Curtis Cherne, Stormwater Quality 924-3420, ccherne@cabq.gov

Rev May 2019



City of Albuquerque

Planning Department

Stormwater Control Permit for Erosion and Sediment Control

Project Title _____

Project Location (Major Cross Streets/Arroyo
or address) _____

Property Owner: (Note: If applying for a Building Permit, the “Company” or “Owner” name on this form must match the “Owner” name on the Building Permit.)

Company Name or Owner Name: _____

Responsible Person: (Note: Name below may be the same as Owner Name above if there is no Company Name)
Name: _____

Phone Number: _____

E-mail: _____

Site Contact: (if different than Property Owner info above.)

Name: _____

Phone: _____

e-mail: _____

For City personnel use only:

City Personnel Signature: _____ Date _____

(Rev June 2017)

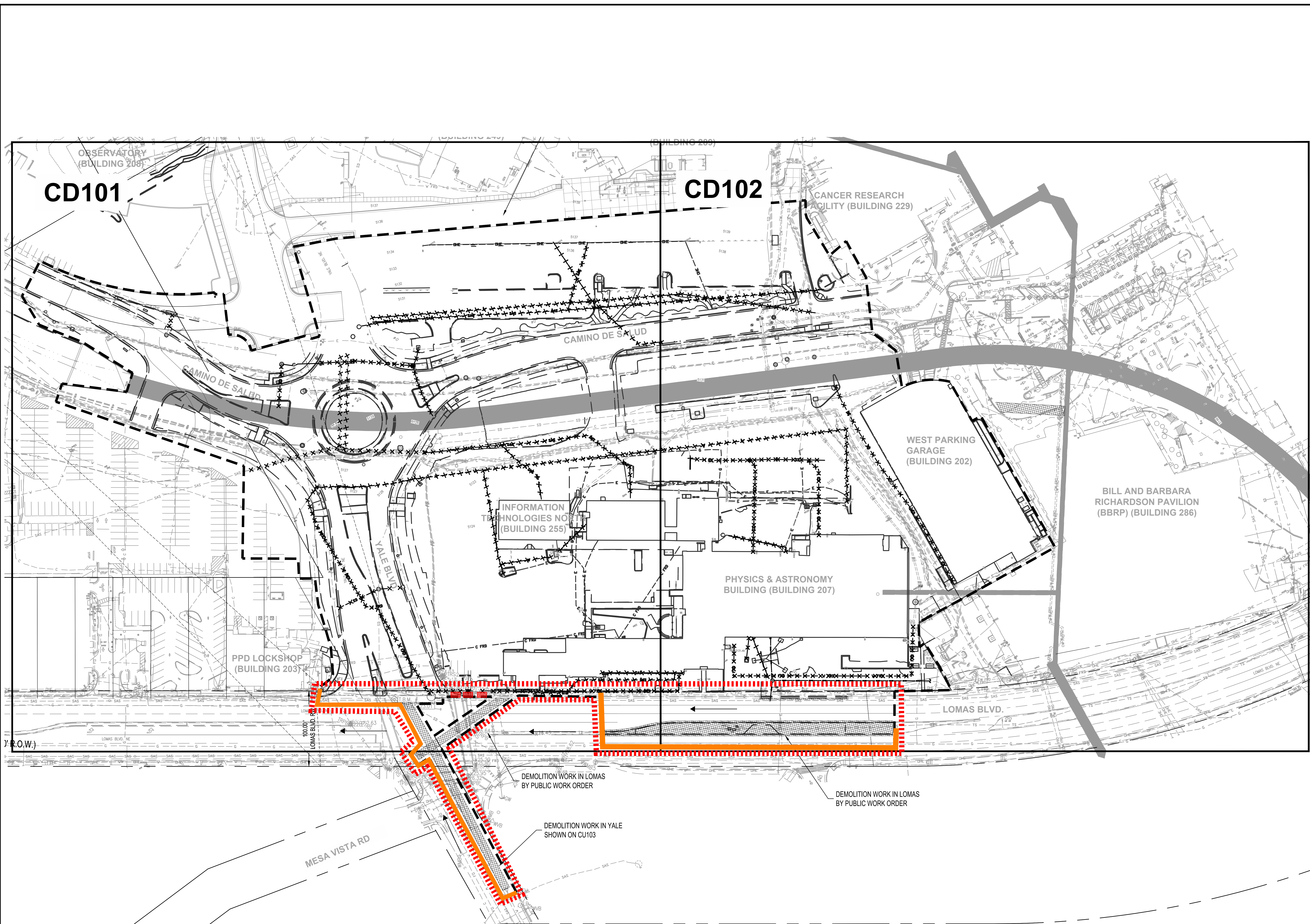

BMP MAP LEGEND

- LIMITS OF DISTURBANCE
- PERIMETER BMP
MULCH FILTER SOCK
- INLET PROTECTION
- FLOW DIRECTION



TOTAL SITE AREA: 0.94 ACRES
TOTAL DISTURBED AREA: 0.94 ACRES
SEE SHEET 10 FOR PHASING

REFER TO THE ESC BMP DETAILS
(ESC-2) FOR INSTALLATION,
INSPECTION AND MAINTENANCE
REQUIREMENTS.

****GRADING PLAN BY OTHERS****

**UNMH - NEW HOSPITAL PHASE 2
(LOMAS & YALE WORK AREAS)**

**TEMPORARY EROSION AND
SEDIMENT CONTROL PLAN**

Drawn By:
M. VALLEJOS, CPESC, CISEC

01/27/2021

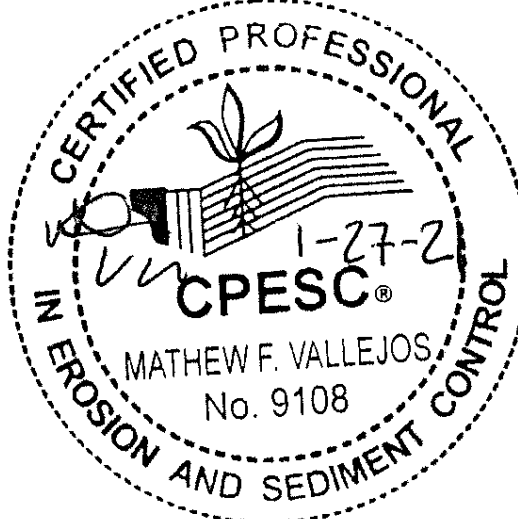

ESC-1

Silt Sock

EROSION CONTROL PRODUCTS

www.siltsock.net
Phone: 608-438-7625

8" Ultra

Construction	Tubular Knit		
Chemical Reaction	Inert to most soil chemicals including Alkaline, weak acids and salt		
Properties	Fiber Material	Multi-Filament Polypropylene	
	Color	Black	
	Melting Point	166°C	330°F
	UV Protection	Photodegradable/ UV Stabilized	
	UV Resistance ASTM G-155	100% at 1000 hr.	
	Approx. Life Expectancy*	2 - 4 years	
Roll Properties (Approx.)	Mesh Opening	1/8"	
	Roll Weight	11.8 kg	26 lbs.
	Roll Length - Relaxed	174 m	540 ft.
Applied Roll Length (Approx.)	8" Diameter	146 m	475 ft.
Strength Properties	ASTM 6241 & ASTM 5035	222 psi	
Packaging	Package Type	Roll	

SILT SOCK INSTALLATION GUIDELINES

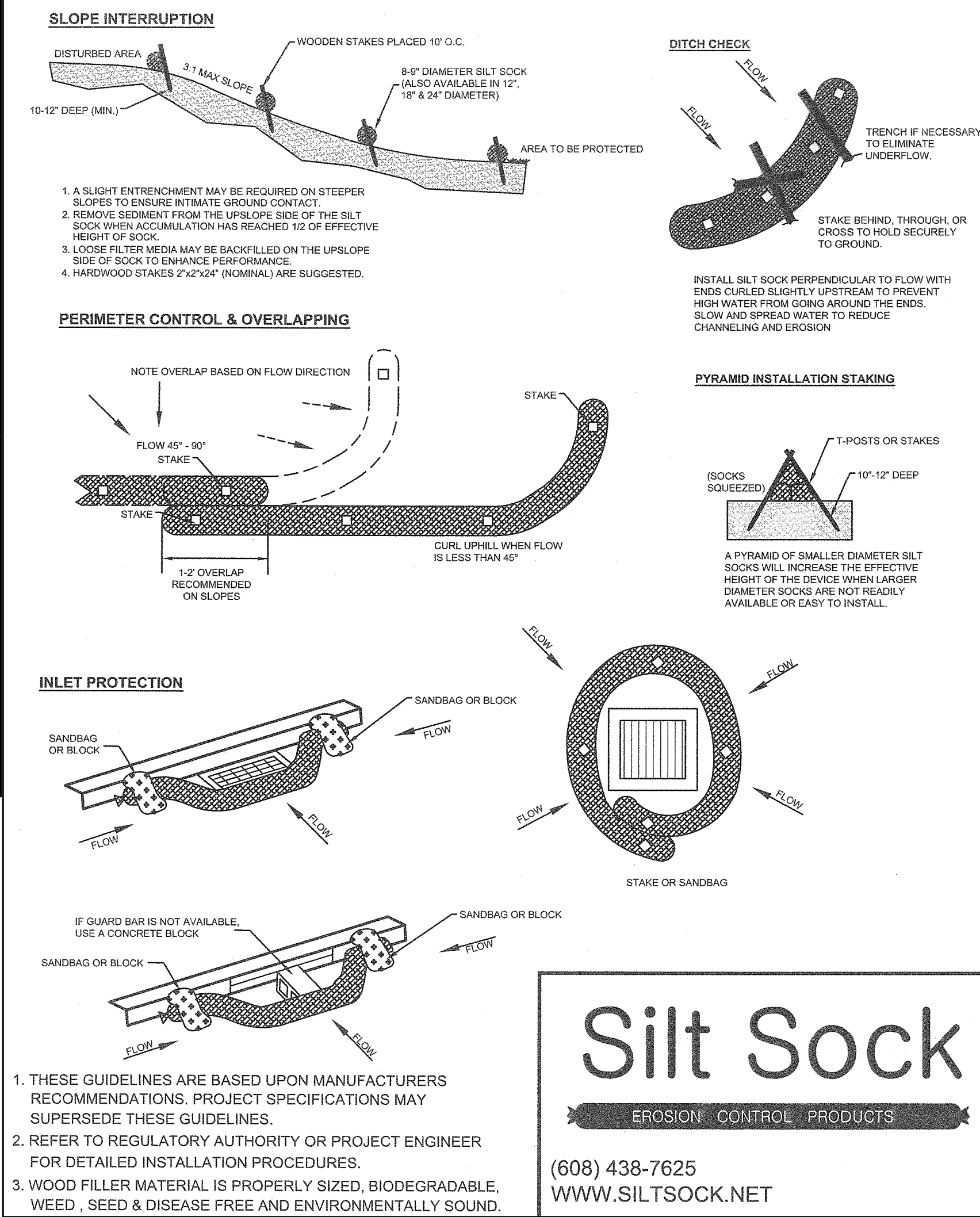

Coir Mat Inlet Protection



UV Resistance (ASTM D 4355 – 500 hour exposure) Tensile Properties (ASTM D 5035/ECTC) (4 inch wide strip specimen)

Baseline Properties		500 Hour Exposed Properties	
MD – Maximum Load (ppi)	14.6	MD – Maximum Load (ppi)	10.2
TD – Maximum Load (ppi)	18.7	TD – Maximum Load (ppi)	13.8
MD – Elongation @ Max Load (%)	19.3	MD – Elongation @ Max Load (%)	16.9
TD – Elongation @ Max Load (%)	27.7	TD – Elongation @ Max Load (%)	16.6

Light Penetration (ECTC Guidelines)		Resiliency (ASTM D 6524)	
Baseline Reading	125	Pre-loading thickness (mils)	1943
Reading with sample	10	Post-loading thickness (mils)	326
% Light Penetration	<8	% change	-83

Swell (ECTC)		Mass/Unit Area (ASTM D 6565)	
Dry thickness (mils)	1984	Mass/unit area (oz/sq. yd)	50.89
Thickness after soak (mils)	2098	Mass/unit area (g/sq. meter)	1725
% change	6		

Water Absorption (ASTM D 1117/ECTC)		Smolder Resistance (ECTC)	
Pre-soak Weight (grams)	69	Maximum Burn Distance (in)	.29
Post-Soak (grams)	152		
Weight change (grams)	82		
% Weight Change	119		

Sediment Control (ASTM D 5141)	
Test material:	Sand sieved thru No. 10 sieve
Filtering Efficiency (%)	40.8
Flow Rate (liter/minute)	150

ESC Plan Standard Notes (2020-07-16)

- All Erosion and Sediment Control (ESC) work on these plans, except as otherwise stated or provided hereon shall be permitted, constructed, inspected, and maintained in accordance with:
 - The City Ordinance § 14-5-2-11, the ESC Ordinance,
 - The EPA's 2017 Construction General Permit (CGP), and
 - The City Of Albuquerque Construction BMP Manual.
- All BMP's must be installed prior to beginning any earth moving activities except as specified hereon in the Phasing Plan. Construction of earthen BMP's such as sediment traps, sediment basins, and diversion berms shall be completed and inspected prior to any other construction or earthwork. Self-inspection is required after installation of the BMPs and prior to beginning construction.
- Self-inspections - At a minimum a routine compliance self-inspection is required to review the project for compliance with the Construction General Permit once every 14 days and after any precipitation event of 1/4 inch or greater until the site construction has been completed and the site determined as stabilized by the city. Reports of these inspections shall be kept by the person or entity authorized to direct the construction activities on the site.
- BMPs shall be inspected and maintained until all disturbed areas are stabilized in accordance with the Final Stabilization Criteria (CGP 2.2.14.b). Generally, all disturbed areas, other than structures, must have uniform perennial vegetation that provides 70 percent or more of the cover provided by native vegetation or seed the disturbed area and provide non-vegetative mulch that provides cover for at least three years without active maintenance. Final stabilization must be documented on self-inspection reports and approved by the City of Albuquerque prior to removal of BMPs and discontinuation of inspections.



TOTAL SITE AREA: 0.94 ACRES
TOTAL DISTURBED AREA: 0.94 ACRES
SEE SHEET 10 FOR PHASING.

REFER TO THE ESC BMP DETAILS (ESC-2)
FOR INSTALLATION, INSPECTION AND
MAINTENANCE REQUIREMENTS.

UNMH - NEW HOSPITAL PHASE 2
(LOMAS & YALE WORK AREAS)

TEMPORARY EROSION AND SEDIMENT
CONTROL PLAN

Drawn By:
M. VALLEJOS, CPESC, CISEC

01/27/21



ESC-2

South Yale & Garage Site Capture Phase 2: 1-13-21 to 4-23-21



Legend

- Fencing w/ Directional Signage
- SWPP Rumble Strips
- Phase 1A Work Complete
- Lomas Lane Closure
- Dumpster & Connex Yard
- Site Retaining Walls
- Public Route to Existing Hospital Complex and P&A Buildings
- Temporary Entrances
- South Yale Area of Work
- Existing AMFCA Channel
- Temporary Toilets at Gates
- Garage Footprint
- Future Project Work
- Traffic Control Area
- Site Trailer Complex

UNIVERSITY OF NEW MEXICO HOSPITALS
New Hospital Tower
Parking Structure
2211 LOMAS BLVD. NE
ALBUQUERQUE, NM 87106

PLACE HOLDER FOR CLIENT LOGO (IF ANY)
ADD LOGO OR DELETE TEXT BY EDITING TITLEBLOCK
FAMILY AND SAVING IT TO YOUR PROJECT LIBRARY

Project Number
Original Issue

Project Number
03/18/20

Sheet Name
Site Logistics Plan

Sheet Number
10



Submission of this Notice of Intent (NOI) constitutes notice that the operator identified in Section III of this form requests authorization to discharge pursuant to the NPDES Construction General Permit (CGP) permit number identified in Section II of this form. Submission of this NOI also constitutes notice that the operator identified in Section III of this form meets the eligibility requirements of Part 1.1 CGP for the project identified in Section IV of this form. Permit coverage is required prior to commencement of construction activity until you are eligible to terminate coverage as detailed in Part 8 of the CGP. To obtain authorization, you must submit a complete and accurate NOI form. Discharges are not authorized if your NOI is incomplete or inaccurate or if you were never eligible for permit coverage. Refer to the instructions at the end of this form.

Permit Information

NPDES ID: NMR10032NState where your construction site is located: NM

Is your construction site located on Indian Country Lands? No

Are you requesting coverage under this NOI as a "Federal Operator" as defined in Appendix A (https://www.epa.gov/sites/production/files/2019-05/documents/final_2017_cgp_appendix_a_-_definitions.pdf)?

No

Have stormwater discharges from your current construction site been covered previously under an NPDES permit? No

Will you use polymers, flocculants, or other treatment chemicals at your construction site? No

Has a Stormwater Pollution Prevention Plan (SWPPP) been prepared in advance of filling this NOI, as required? Yes

Are you able to demonstrate that you meet one of the criteria listed in Appendix D (https://www.epa.gov/sites/production/files/2017-02/documents/2017_cgp_final_appendix_d_-_endangered_species_reqs_508.pdf) with respect to protection of threatened or endangered species listed under the Endangered Species Act (ESA) and federally designated critical habitat?

Yes

Have you completed the screening process in Appendix E (https://www.epa.gov/sites/production/files/2017-02/documents/2017_cgp_final_appendix_e_-_historic_properties_reqs_508.pdf) relating to the protection of historic properties?

Yes

Indicating "Yes" below, I confirm that I understand that CGP only authorized the allowable stormwater discharges in Part 1.2.1 and the allowable non-stormwater discharges listed in Part 1.2.2. Any discharges not expressly authorized in this permit cannot become authorized or shielded from liability under CWA section 402(k) by disclosure to EPA, state or local authorities after issuance of this permit via any means, including the Notice of Intent (NOI) to be covered by the permit, the Stormwater Pollution Prevention Plan (SWPPP), during an inspection, etc. If any discharges requiring NPDES permit coverage other than the allowable stormwater and non-stormwater discharges listed in Parts 1.2.1 and 1.2.2 will be discharged, they must be covered under another NPDES permit.

Yes

Operator Information

Operator Information

Operator Name: University of New Mexico Hospitals

Operator Mailing Address:

Address Line 1: 2211 Lomas Blvd. NE

Address Line 2:

City: AlbuquerqueZIP/Postal Code: 87106State: NMCounty or Similar Division: BERNALILLO

Operator Point of Contact Information

First Name Middle Initial Last Name: John BlenkTitle: Project ManagerPhone: 505-328-5488 Ext.:Email: jblenk@salud.unm.edu

NOI Preparer Information

☒ This NOI is being prepared by someone other than the certifier.First Name Middle Initial Last Name: Mathew F VallejosOrganization: Green Globe EnvironmentalPhone: (505) 304-8473 Ext.:

Project/Site Information

Project/Site Name: [UNMH New Hospital](#)

Project/Site Address

Address Line 1: [Lomas Blvd. and Yale Blvd.](#)

Address Line 2:

City: [Albuquerque](#)

ZIP/Postal Code: [87106](#)

State: [NM](#)

County or Similar Division: [BERNALILLO](#)

Latitude/Longitude: [35.089623°N, 106.620629°W](#)

Latitude/Longitude Data Source: [Map](#)

Horizontal Reference Datum: [WGS 84](#)

Project Start Date: [06/25/2020](#)

Project End Date: [09/30/2024](#)

Estimated Area to be Disturbed: [15.5](#)

Types of Construction Sites:

- [Commercial](#)

Will there be demolition of any structure built or renovated before January 1, 1980? [Yes](#)

➔ Do any of the structures being demolished have at least 10,000 square feet of floor space? [Yes](#)

Was the pre-development land use used for agriculture? [No](#)

Have earth-disturbing activities commenced on your project/site? [No](#)

Is your project located on a property of religious or cultural significance to an Indian tribe? [No](#)

Discharge Information

Does your project/site discharge stormwater into a Municipal Separate Storm Sewer System (MS4)? [Yes](#)

Are there any waters of the U.S. within 50 feet of your project's earth disturbances? [No](#)

Are any of the waters of the U.S. to which you discharge designated by the state or tribal authority under its antidegradation policy as a Tier 2 (or Tier 2.5) water (water quality exceeds levels necessary to support propagation of fish, shellfish, and wildlife and recreation in and on the water) or as a Tier 3 water (Outstanding National Resource Water)? See Appendix F (https://www.epa.gov/sites/production/files/2017-02/documents/2017_cgp_final_appendix_f_-_tier_3_tier_2_and_tier_2.5_waters_508.pdf)
[Yes](#)

001: North Channel

Latitude/Longitude: [35.090798°N, 106.622788°W](#)

Tier Designation: [N/A](#)

Is this receiving water impaired (on the CWA 303(d) list)? [No](#)

Has a TMDL been completed for this receiving waterbody? [No](#)

002: Rio Grande River

Latitude/Longitude: [35.084152°N, 106.676628°W](#)

Tier Designation: [Tier 2](#)

Is this receiving water impaired (on the CWA 303(d) list)? [Yes](#)

Impaired Pollutants:

- [E. coli](#)
- [Dissolved oxygen](#)

- Temperature

Has a TMDL been completed for this receiving waterbody? Yes

TMDL ID: NM2105 Name: Rio Grande (Tijeras Arroyo to Alameda Bridge)

TMDL Pollutants:

- E. coli
- Dissolved oxygen
- Temperature

Stormwater Pollution Prevention Plan (SWPPP)

First Name Middle Initial Last Name: John Blenk

Organization:

Title: Project Manager

Phone: 505-328-5488 Ext.:

Email: jblenk@salud.unm.edu

Endangered Species Protection

Using the Instructions in Appendix D of the CGP, under which criterion listed in Appendix D are you eligible for coverage under this permit? Criterion A

Provide a brief summary of the basis for criterion selection listed above (the necessary content for a supportive basis statement is provided under the criterion you selected.):

Per USFWS official list of threatened and endangered species, all threatened and endangered species critical habitat are outside the project limits.

Historic Preservation

Are you installing any stormwater controls as described in Appendix E (https://www.epa.gov/sites/production/files/2017-02/documents/2017_cgp_final_appendix_e_-_historic_properties_reqs_508.pdf) that require subsurface earth disturbances? (Appendix E (https://www.epa.gov/sites/production/files/2017-02/documents/2017_cgp_final_appendix_e_-_historic_properties_reqs_508.pdf), Step 1)

Yes

- ➔ Have prior surveys or evaluations conducted on the site already determined historic properties do not exist, or that prior disturbances have precluded the existence of historic properties? (Appendix E (https://www.epa.gov/sites/production/files/2017-02/documents/2017_cgp_final_appendix_e_-_historic_properties_reqs_508.pdf), Step 2):

Yes

Certification Information

I certify under penalty of law that this document and all attachments were prepared under my direction or supervision in accordance with a system designed to assure that qualified personnel properly gathered and evaluated the information submitted. Based on my inquiry of the person or persons who manage the system, or those persons directly responsible for gathering the information, the information submitted is, to the best of my knowledge and belief, true, accurate, and complete. I have no personal knowledge that the information submitted is other than true, accurate, and complete. I am aware that there are significant penalties for submitting false information, including the possibility of fine and imprisonment for knowing violations. Signing an electronic document on behalf of another person is subject to criminal, civil, administrative, or other lawful action.

Certified By: John B. Blenk

Certifier Title: Project Manager-Healthcare

Certifier Email: jblenk@salud.unm.edu

Certified On: 06/17/2020 9:32 AM ET