

CITY OF ALBUQUERQUE



January 13, 2017

Richard J. Berry, Mayor

Scott M. McGee, P.E.
SMMPE, LLC
9700 Tanoan Dr. NE
Albuquerque, NM, 87111

RE: **Jackson Middle School
Grading and Drainage Plan
Engineer's Stamp Date 11-11-16 (File: J21D029)**

Dear Mr. McGee:

Based upon the information provided in your submittal received 12-28-2016, the above referenced plan is approved as noted for Building Permit:

1. The Drainage Approach concludes with flows from the shallow depressed landscaping area being directed northward into a parking area and toward Comanche. No mention of directing flows into the storm drain and southwest towards the detention pond is made. Clarify the last portion of the Drainage Approach to match what is shown on drawings.

The approach as shown on drawings, acceptably conveys flows from the impervious areas through storm drain or overland, to the enlarged detention pond, whose outfall is Blume Street on City Right-of-Way. Additionally, it is recommended that erosion along the existing concrete rundown to the detention pond is corrected as part of this work.

If you have any questions, please contact me at 924-3695 or dpeterson@cabq.gov.

Sincerely,

Dana Peterson, P.E.
Senior Engineer, Planning Dept.
Development Review Services

Orig: Drainage file

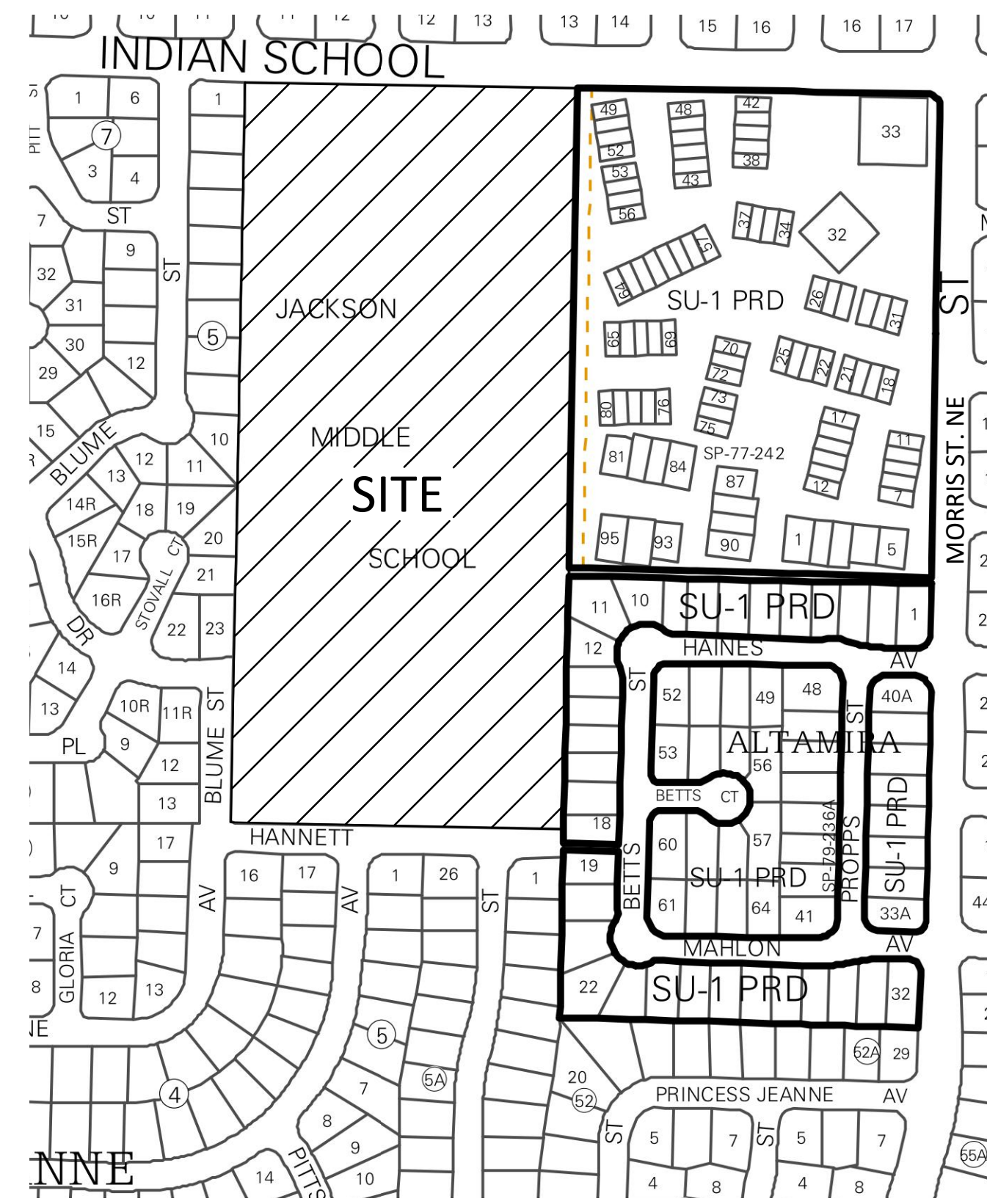
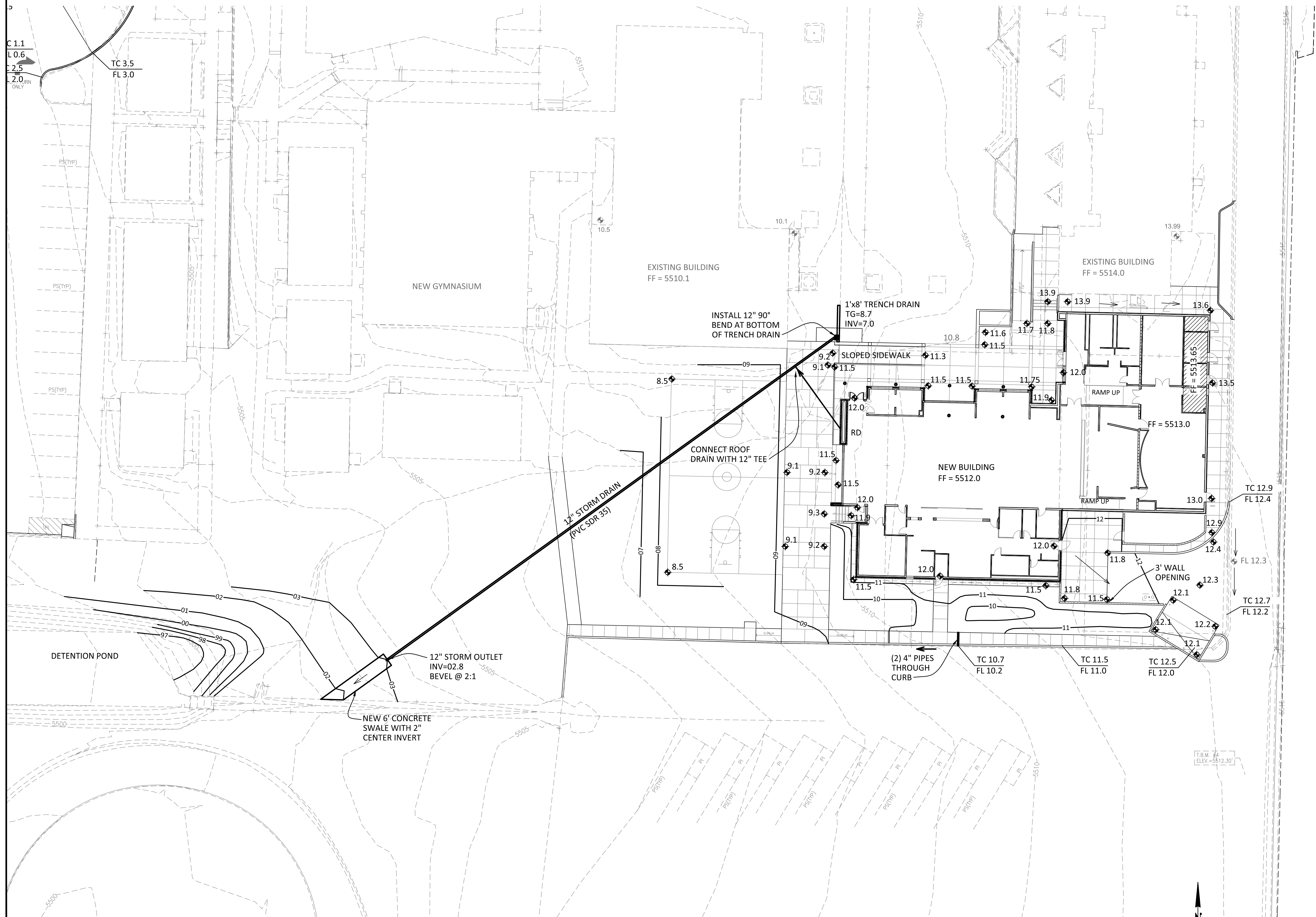
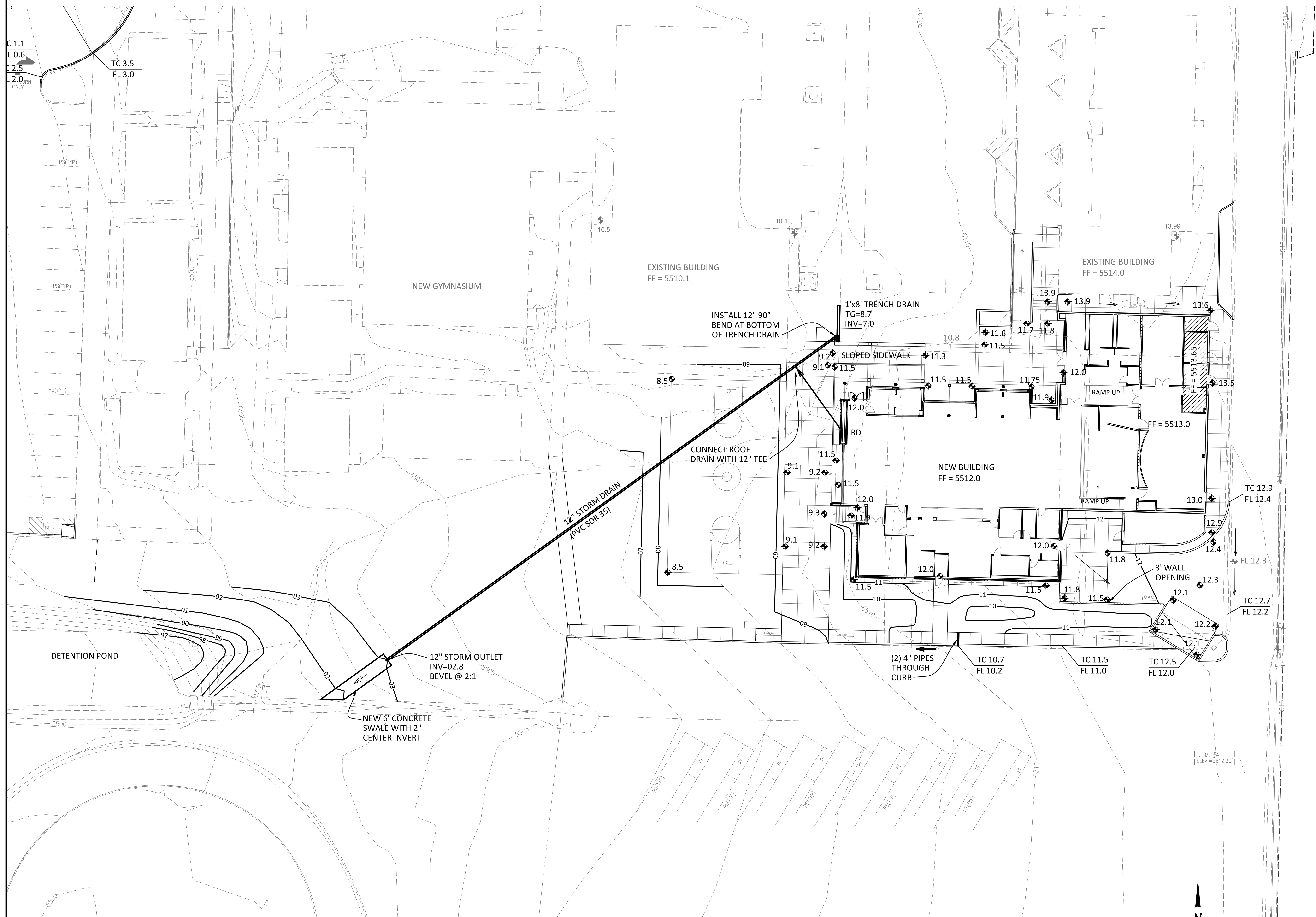

VICINITY MAP J-21

LEGEND	
---	EXISTING CONTOURS AND CONSTRUCTION
---	NEW CONTOURS AND CONSTRUCTION
TC 12.9 FL 12.4	TOP OF CURB ELEV FLOW ELEV
◆ 12.0	SPOT ELEV
FF=5113.65	FINISH FLOOR ELEV
12" STORM DRAIN (PVC SDR 35)	PROPOSED STORM DRAIN

DRAINAGE

LEGAL: UNPLATTED LANDS OF BOARD OF EDUCATION, (aka Jackson Middle School)
AREA: Total site=18.41 acres. This phase is the proposed Cafeteria Building 'A'-- 0.871 acres (37,950 SF)

BENCHMARK: ACS aluminum disk "15-H20 1989" set in Eubank Blvd median curb at the south edge of Snow Heights Blvd NE intersection.
ELEV= 5477.43 (NAVD 1988)

TBM: a #5 rebar with cap stamped HMCg Control NMPs #11184 as shown south of the western parking lot.
ELEV= 5500.93 (NAVD 1988)

SURVEYOR: High Mesa Consulting Group dated May, 2014

FLOOD HAZARD: From FEMA Panel 357 (8/16/2012), the majority of this site is identified as being within Zone 'X' which is outside the 0.2% annual chance floodplain. A small portion in the SW corner of the site (<5% of the site), is shaded Zone 'X' which is noted as within the 0.2% annual chance flood or an area with 1% annual chance flood with average depths of less than 1 foot.

EXISTING CONDITIONS: The site is developed as a public middle school. A northern portion of the site discharges north to Indian School Road through multiple existing driveways. The majority of the site drains to an onsite detention pond which outfalls to the southwest corner of the site to Blume Street NE.

OFFSITE FLOWS: There is an existing block wall along the eastern side of the site. No offsite flow enters this site.

PROPOSED IMPROVEMENTS: The proposed improvements include a 17,500 sf (2-story) 7th grade classroom building located near the southwest corner of the site. The hardscape courtyard increases the impervious percentage of this area.

FIRST FLUSH: $Q=(0.44-0.10)(20,495)/12= 581$ CF
This volume will be provided in the detention pond located at the SW corner of the site with the increased storage volume proposed.

DRAINAGE APPROACH: The proposed drainage plan will follow historic flow paths and the approved Grading Plan. Building roof runoff will primarily discharge to the west side of the building. Site runoff will discharge in two different ways. A small portion will surface flow south and around the building to the west. The proposed courtyard area will surface flow north to a proposed trench drain that conveys water west to a depressed landscape area. Runoff will be carried to a shallow depressed area (landscaping design of this area is currently being done by APS). The flow will then be directed north into the existing asphalt parking lot and toward Comanche.

HYDROLOGY: For precipitation Zone 4 with 62% C & 38% D land treatment
Existing $Q=(0.54)(3.73)+(0.33)(5.25)= 3.7$ CFS

The proposed improvements include the building, impervious courtyard area, walks, and the shallow depressed area northwest of the proposed building.
Proposed $Q=(0.06)(2.92)+(0.27)(3.73)+(0.54)(5.25)= 4.0$ CFS

This minor runoff increase (0.3 CFS) will not have an adverse impact on downstream drainage facilities as runoff will be detained onsite in the enlarged detention pond.

NCA

ARCHITECTS - PLANNERS - AIA

1306 RIO GRANDE BLVD NW
ALBUQUERQUE, NM 87104
505-255-6400 505-268-6954 FAX

WWW.NCA-ARCHITECTS.COM

ARCHITECT



CONSULTANT

PROJECT TITLE

JACKSON
MIDDLE
SCHOOL
CLASSROOM
ADDITION

ALBUQUERQUE
NEW MEXICO



REVISIONS:

NO.	DATE	DESCRIPTION

DATE	DESCRIPTION
DRAWN BY: CB	CHECKED BY: SMM

PROJECT NUMBER:
A1401

DATE:
JULY 14, 2016

SHEET TITLE:

**BUILDING A
~CAFETERIA~
GRADING & DRAINAGE
PLAN**

SHEET NO:

A-C101