

CITY OF ALBUQUERQUE

Planning Department
David Campbell, Director



Mayor Timothy M. Keller

June 14, 2019

Robert Fierro, P.E.
Fierro & Co., LLC.
5508 Costa Uerde Rd NW
Albuquerque, NM 87120

**RE: Calvery Christian Gym
12820 Indian School NE
Request for Certificate of Occupancy – Permanent
Engineer's Certification – Accepted
Grading Plan Stamp Date: 5/31/16
Certification Dated: 6/12/19
Hydrology File: J22D027A**

PO Box 1293

Dear Mr. Fierro:

Albuquerque

Based on submittal received on 6/12/19 the Engineer's Certification approved in support of Certificate of Occupancy (Permanent) by Hydrology.

If you have any questions, please contact me at 924-3695 or dpeterson@cabq.gov.

NM 87103

Sincerely,

www.cabq.gov

Dana M. Peterson
Senior Engineer, Planning Dept.
Development Review Services

C: Email Fox, Debi; Tena, Victoria; Sandoval, Darlene; Costilla, Michelle



City of Albuquerque

Planning Department

Development & Building Services Division

DRAINAGE AND TRANSPORTATION INFORMATION SHEET (REV 11/2018)

Project Title: _____ **Building Permit #:** _____ **Hydrology File #:** _____

DRB#: _____ **EPC#:** _____ **Work Order#:** _____

Legal Description: _____

City Address: _____

Applicant: _____ **Contact:** _____

Address: _____

Phone#: _____ **Fax#:** _____ **E-mail:** _____

Owner: _____ **Contact:** _____

Address: _____

Phone#: _____ **Fax#:** _____ **E-mail:** _____

TYPE OF SUBMITTAL: _____ PLAT (____# OF LOTS) _____ RESIDENCE _____ DRB SITE _____ ADMIN SITE

IS THIS A RESUBMITTAL?: _____ Yes _____ No

DEPARTMENT: _____ TRAFFIC/ TRANSPORTATION _____ HYDROLOGY/ DRAINAGE

Check all that Apply:

TYPE OF SUBMITTAL:

- _____ ENGINEER/ARCHITECT CERTIFICATION
- _____ PAD CERTIFICATION
- _____ CONCEPTUAL G & D PLAN
- _____ GRADING PLAN
- _____ DRAINAGE MASTER PLAN
- _____ DRAINAGE REPORT
- _____ FLOODPLAIN DEVELOPMENT PERMIT APPLIC
- _____ ELEVATION CERTIFICATE
- _____ CLOMR/LOMR
- _____ TRAFFIC CIRCULATION LAYOUT (TCL)
- _____ TRAFFIC IMPACT STUDY (TIS)
- _____ OTHER (SPECIFY) _____
- _____ PRE-DESIGN MEETING?

TYPE OF APPROVAL/ACCEPTANCE SOUGHT:

- _____ BUILDING PERMIT APPROVAL
- _____ CERTIFICATE OF OCCUPANCY
- _____ PRELIMINARY PLAT APPROVAL
- _____ SITE PLAN FOR SUB'D APPROVAL
- _____ SITE PLAN FOR BLDG. PERMIT APPROVAL
- _____ FINAL PLAT APPROVAL
- _____ SIA/ RELEASE OF FINANCIAL GUARANTEE
- _____ FOUNDATION PERMIT APPROVAL
- _____ GRADING PERMIT APPROVAL
- _____ SO-19 APPROVAL
- _____ PAVING PERMIT APPROVAL
- _____ GRADING/ PAD CERTIFICATION
- _____ WORK ORDER APPROVAL
- _____ CLOMR/LOMR
- _____ FLOODPLAIN DEVELOPMENT PERMIT
- _____ OTHER (SPECIFY) _____

DATE SUBMITTED: _____ **By:** _____

COA STAFF:

ELECTRONIC SUBMITTAL RECEIVED: _____

FEE PAID: _____

EXISTING BUILDING
FF = 5776.20

As-Built

GENERAL GRADING NOTES:

- GENERAL GRADING NOTES:**
1. THE CONTRACTOR TO VERIFY LOCATION OF ALL UTILITIES SHOWN AND COORDINATE WITH ALL UTILITY OWNERS PRIOR TO ANY EXCAVATION.
 2. THE CONTRACTOR SHALL LIMIT DISTURBANCE OF NATIVE VEGETATION TO A MINIMUM.
 3. THIS PLAN RECOMMENDS POSITIVE DRAINAGE AWAY FROM ALL STRUCTURES TO PROHIBIT FLOODING OF RUNOFF WHICH MAY CAUSE STRUCTURAL SETTLEMENT. FUTURE ALTERATION OF GRADES ADJACENT TO THE PROPOSED STRUCTURES IS NOT RECOMMENDED.
 4. PERFORM GRADING AND EXCAVATION WORK IN COMPLIANCE WITH APPLICABLE SPECIFICATIONS, REQUIREMENTS, CODES AND ORDINANCES OF BERNALILLO COUNTY, NEW MEXICO.
 5. CONTRACTOR SHALL BE RESPONSIBLE FOR THE DISPOSAL OF OR OBTAINING EXCESS CUT OR FILL MATERIAL REQUIRED FOR FINAL GRADE.
 6. CONTRACTOR SHALL BE RESPONSIBLE FOR CONTACTING AND COORDINATING WITH NEW MEXICO ONE CALL PRIOR EXCAVATION.
 7. CLEAR AND GRUBBING PER NM APWA SECTION 201 SPECIFICATION.
 8. PROPOSED POND VOLUME MEASURED FROM BOTTOM OF POND TO SPILLWAY INVERT.
 9. SPOT ELEVATIONS ARE TO FINISH GRADE UNLESS NOTED OTHERWISE.
 10. PROTECT POND'S SIDE-SLOPE WITH NON-ENCLOSED RIPRAP LINING 4" MIN. ROCK DIA. PLACE OVER NON-WOVEN GEOTEXTILE FILTER FABRIC.

KEYED NOTES:

- 1 CONSTRUCT STANDARD CURB AND GUTTER PER DETAIL G6/C3.
- 2 CONSTRUCT CURB AND GUTTER PER DETAIL E6/C3.
- 3 CONSTRUCT STRAIGHT CURB PER DETAIL A6/C3.
- 4 CONSTRUCT SIDEWALK PER DETAIL C6/C3..
- 5 CONSTRUCT ASPHALT PAVEMENT PER A1/C3.
- 6 CONSTRUCT SPILLWAY PER DETAIL C1/C3.
- 7 BUILD RETENTION POND
TOP = 5771.0'
SPILLWAY INV. = 5770.50'
BOTTOM = 5768.00'
RETAIN MIN. = 0.04 CU.FT.
© ELEV. 5770.50'

LEGEND

---••--- PROPERTY BOUNDARY
 → FLOW PATH
 [dashed with cross-hatching] EXISTING RETAINING WALL
 - - - FLOWLINE
 - - - 9005 EXISTING MAJOR CONTOUR
 - - - 05 EXISTING MINOR CONTOUR
 - - - PROPOSED MAJOR CONTOUR
 - - - PROPOSED MINOR CONTOUR
 • FG26.29
 — FINISHED GRADE
 — FL FLOW LINE
 - - - TBC TOP BACK OF CURB
 - - - TC TOP OF CURB
 - - - TS TOP OF SIDEWALK
 ↙ ROOF FLOW DIRECTION

DRAINAGE CERTIFICATION OF SUBSTANTIAL COMPLIANCE

I, ROBERT J. FIERRO, NMPE 20585, OF FIRM FIERRO & COMPANY, HEREBY CERTIFY THAT THIS PROJECT HAS BEEN GRADED AND WILL DRAIN IN SUBSTANTIAL COMPLIANCE WITH AND IN ACCORDANCE WITH THE DESIGN INTENT OF THE GRADING & DRAINAGE PLAN/REPORT APPROVED ON JULY 8, 2016. THE RECORD INFORMATION EDITED onto the ORIGINAL DESIGN DOCUMENT HAS BEEN OBTAINED BY ME, NMPS 22909. I FURTHER CERTIFY THAT I HAVE PERSONALLY VISITED THE PROJECT SITE ON JUNE 11, 2019 AND HAVE DETERMINED BY VISUAL INSPECTION THAT THE SURVEY DATA PROVIDED IS REPRESENTATIVE OF ACTUAL SITE CONDITIONS AND IS TRUE AND CORRECT TO THE BEST OF MY KNOWLEDGE AND BELIEF. THIS CERTIFICATION IS SUBMITTED IN SUPPORT OF A REQUEST FOR CERTIFICATE OF OCCUPANCY.

THE RECORD INFORMATION PRESENTED HEREON IS NOT NECESSARILY COMPLETE AND INTENDED ONLY TO VERIFY SUBSTANTIAL COMPLIANCE OF THE GRADING AND DRAINAGE WITH THE REQUIREMENTS OF THIS PROJECT. THOSE RELYING ON THE RECORD DOCUMENTS ARE ADVISED TO OBTAIN INDEPENDENT VERIFICATION OF THE ACCURACY BEFORE USING IT FOR ANY PURPOSE.

Robert J. Fierro N.M.P.E. No. 20585

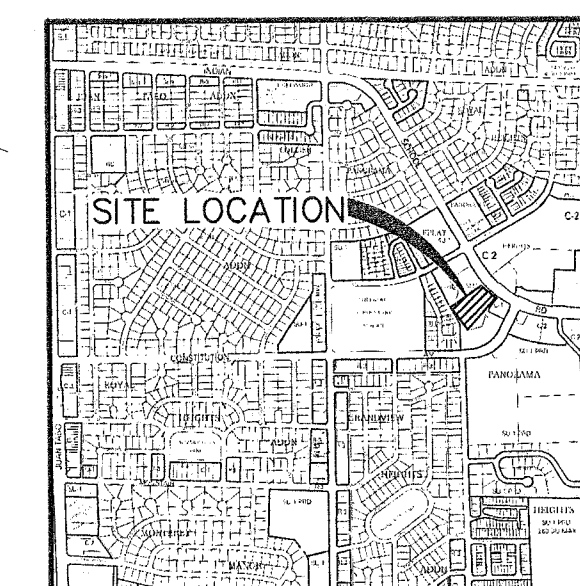
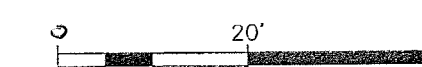

LOCATION
ZONE ATLAS MAP: J-22-Z

CALVARY CHAPEL EAST
GYMNASIUM ADDITION
ALBUQUERQUE, NEW MEXICO

SUBJECT NAME

[illegible]

PROJECT NO:	1620
DESIGNED BY:	R.
DRAWN BY:	R.
CHECKED BY:	R.
DATE:	MAY 20
SHEET TITLE	

GRADING PLAN

SHEET NO:

C1

\\Secstate-4004FD\Public\PROJECTS\SURVEYING\162004\CADD\SHEETS\162004_GD.dwg 5/30/2016 2:48:28 PM

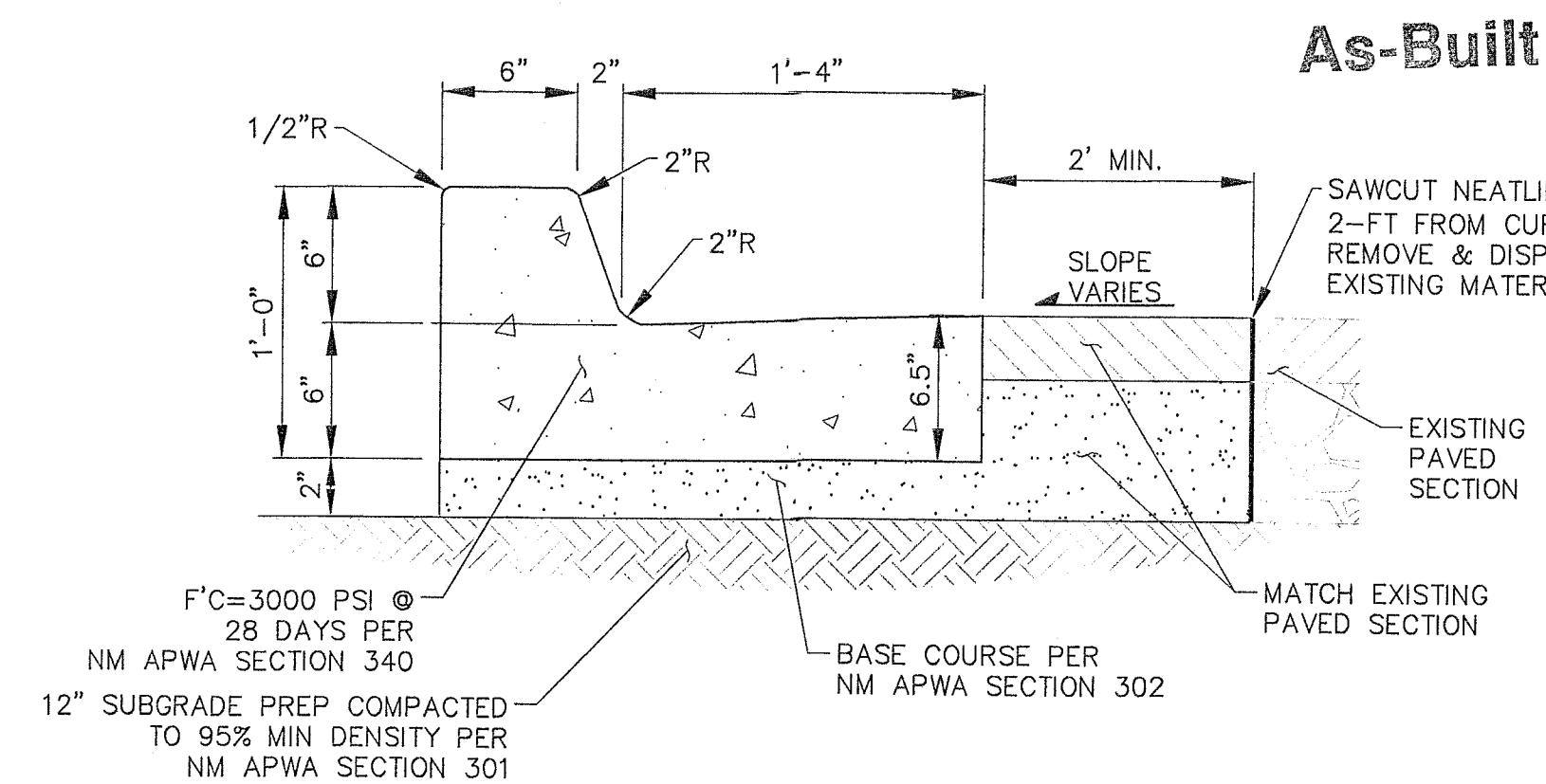

- CURB AND GUTTER GENERAL NOTES

1. ANY DEVIATIONS FROM THESE STANDARDS SHALL BE SUBMITTED TO THE CITY ENGINEER FOR PRIOR APPROVAL
2. ALL WORK IN PUBLIC RIGHT-OF-WAY SHALL BE CONSTRUCTED BY A LICENSED CONTRACTOR AND REQUIRES PERMIT AND APPROVAL BY THE DEPT OF PUBLIC WORKS.
3. SUBGRADE SHALL BE COMPACTED TO 95% ASTM D 1557, MIN.
4. CURB AND GUTTER SHALL BE PORTLAND CEMENT CONCRETE. PORTLAND CEMENT CONCRETE SHALL BE 3000 PSI @ 28 DAYS w/CLASS F FLY ASH AND 7% +/- 2% AIR ENTRAINMENT. (MAX 20% FLY ASH BY WEIGHT).
5. FOR CONCRETE CURB AND GUTTER CONSTRUCT TRANSVERSE JOINTS AS FOLLOWS:
 - TOOLED CONTRACTION JOINTS AT 5' INTERVALS.
 - 1/2" PRE-MOLDED BITUMINOUS EXPANSION JOINTS AT 15' INTERVALS.
 - SEALED EXPANSION JOINTS AT 90' INTERVALS.
6. DIMENSIONS AT ROUNDED CORNERS MEASURED TO INTERSECTION OF STRAIGHT LINES.

G6 STANDARD CURB AND GUTTER
SCALE: NTS

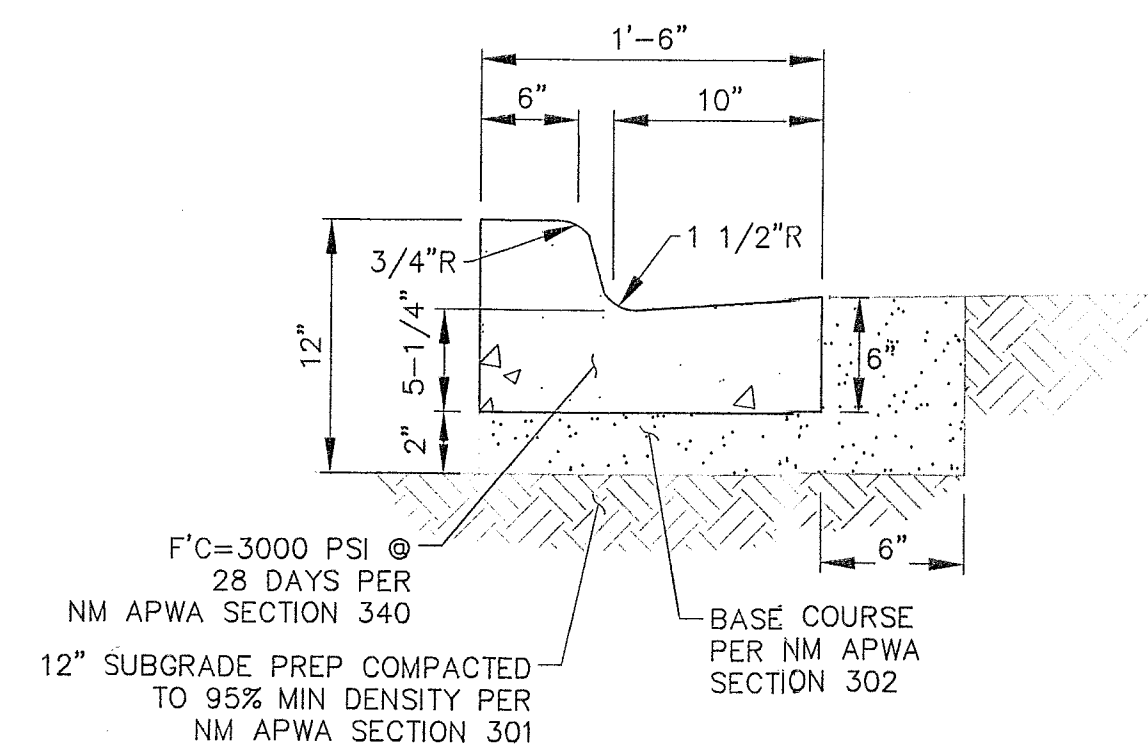

- CURB AND GUTTER GENERAL NOTES

1. ANY DEVIATIONS FROM THESE STANDARDS SHALL BE SUBMITTED TO THE CITY ENGINEER FOR PRIOR APPROVAL.
2. ALL WORK IN PUBLIC RIGHT-OF-WAY SHALL BE CONSTRUCTED BY A LICENSED CONTRACTOR AND REQUIRES PERMIT AND APPROVAL BY THE DEPT OF PUBLIC WORKS.
3. SUBGRADE SHALL BE COMPACTED TO 95% ASTM D 1557, MIN.
4. CURB AND GUTTER SHALL BE PORTLAND CEMENT CONCRETE. PORTLAND CEMENT CONCRETE SHALL BE 3000 PSI @ 28 DAYS w/CLASS F FLY ASH AND 7% +/- 2% AIR ENTRAINMENT. (MAX 20% FLY ASH BY WEIGHT).
5. FOR CONCRETE CURB AND GUTTER CONSTRUCT TRANSVERSE JOINTS AS FOLLOWS:
 - TOOLED CONTRACTION JOINTS AT 5' INTERVALS.
 - 1/2" PRE-MOLDED BITUMINOUS EXPANSION JOINTS AT 15' INTERVALS.
 - SEALED EXPANSION JOINTS AT 90' INTERVALS.
6. DIMENSIONS AT ROUNDED CORNERS MEASURED TO INTERSECTION OF STRAIGHT LINES.

E6 CURB AND GUTTER
SCALE: NTS

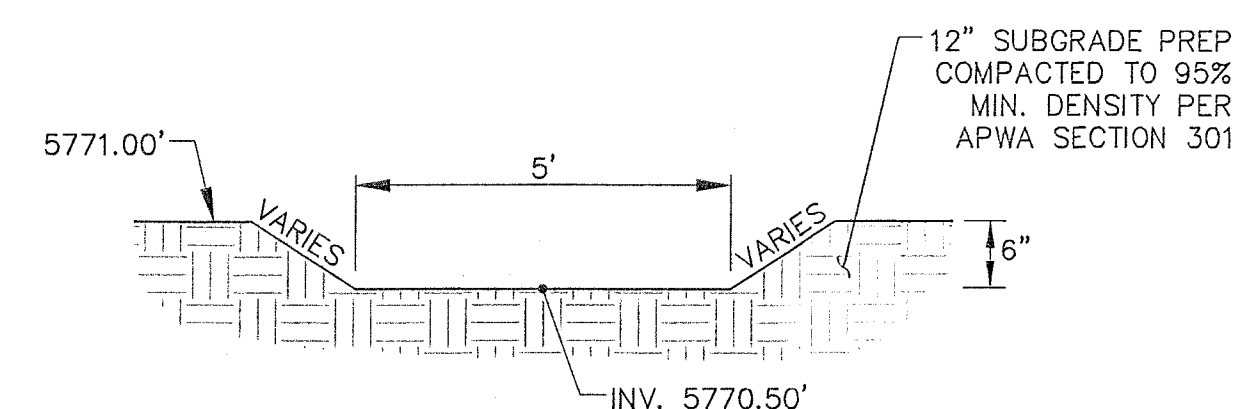

C1 POND OVERFLOW WEIR SECTION
SCALE: NTS

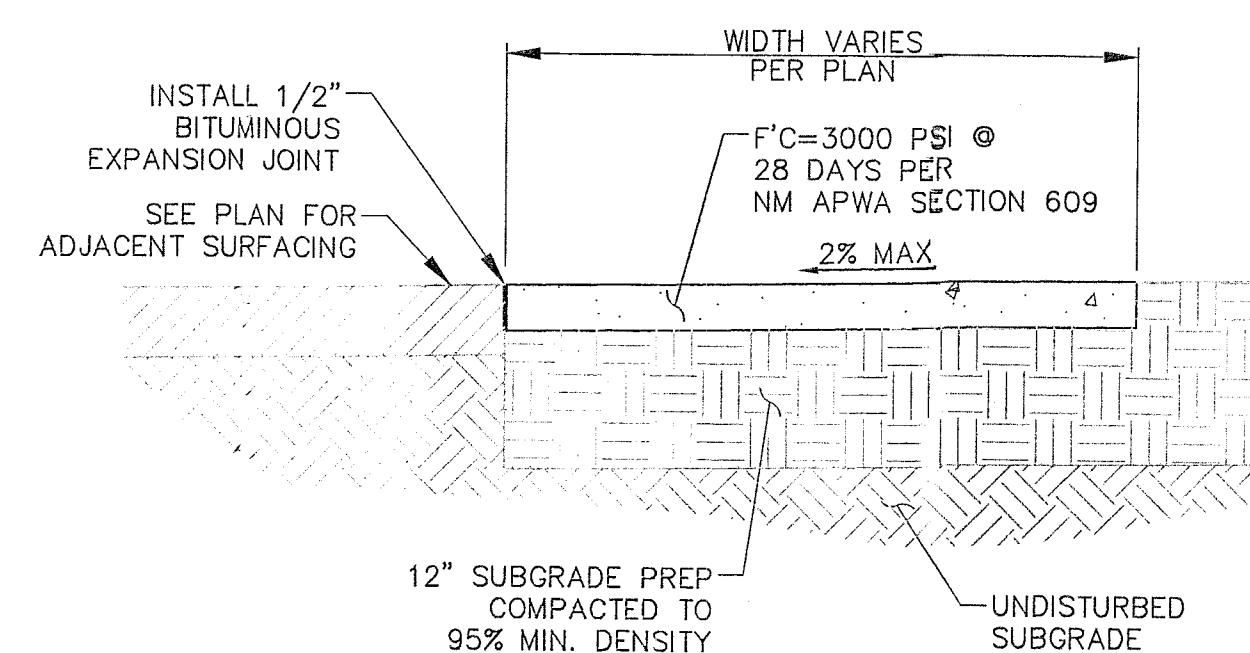

- ### CONSTRUCTION NOTES

1. WHEN ABUTTING TO VERTICAL WALLS, BENCHES, BUILDINGS, OR CURBS. INSTALL 1/2" BITUMINOUS EXPANSION JOINT. RECESS 1/4" VERTICALLY. INSTALL SIKA-FLEX POLYMER SEALANT OR APPROVED EQUAL.
2. INSTALL CONTRACTION JOINTS @ 6'-0" OC.
3. LIGHT BROOM FINISH CONCRETE SURFACE REQUIRED.

(C6) TYPICAL 4" PCC SIDEWALK
SCALE: NTS

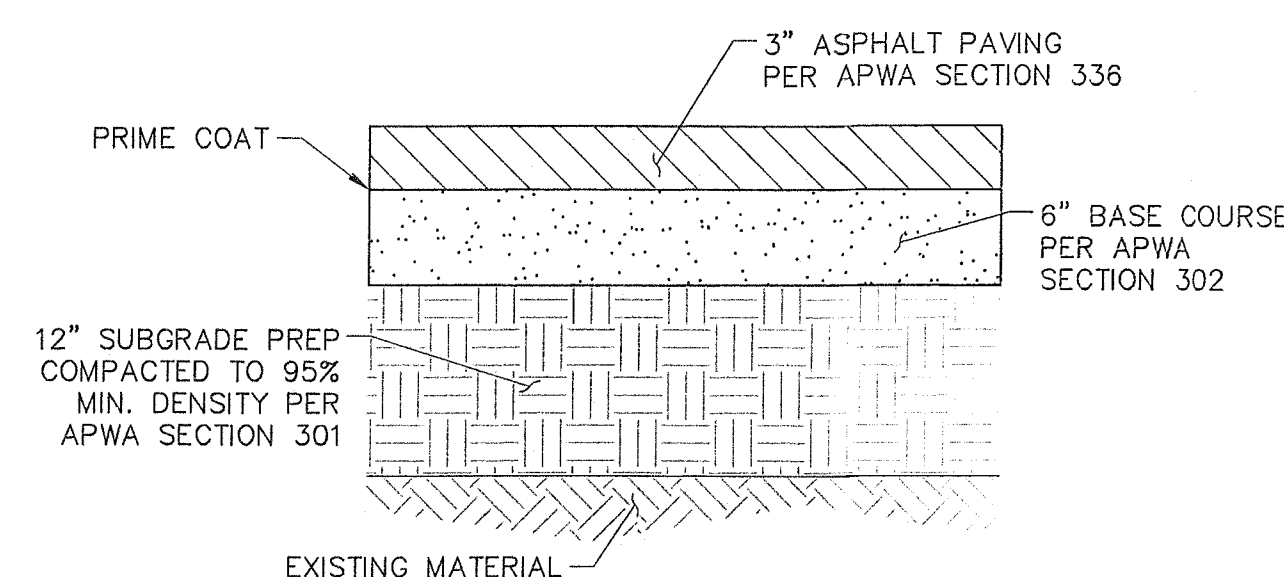

(A1) TYPICAL ASPHALT PAVEMENT SECTION
SCALE: NTS

BID ITEM NOTE:

1. CONTRACTOR TO OBTAIN GEOTECHNICAL REPORT. COST INCIDENTAL. CONTRACTOR AND ENGINEER TO REVIEW GEOTECHNICAL REPORT'S RECOMMENDED PAVEMENT SECTION AND REVISE DETAIL F1/THIS SHEET, IF REQUIRED. CREDIT OWNER IF PAVEMENT SECTION IS LESS THAN 4" ASPHALT AND 6" BASE COURSE. OWNER TO COMPENSATE ADDITIONAL COST IF PAVEMENT SECTION IS THICKER THEN SAID DETAIL F1.

DO NOT CONSTRUCTION PAYMENT SECTION WITHOUT
REVIEWING GEOTECHNICAL REPORT WITH ENGINEER.

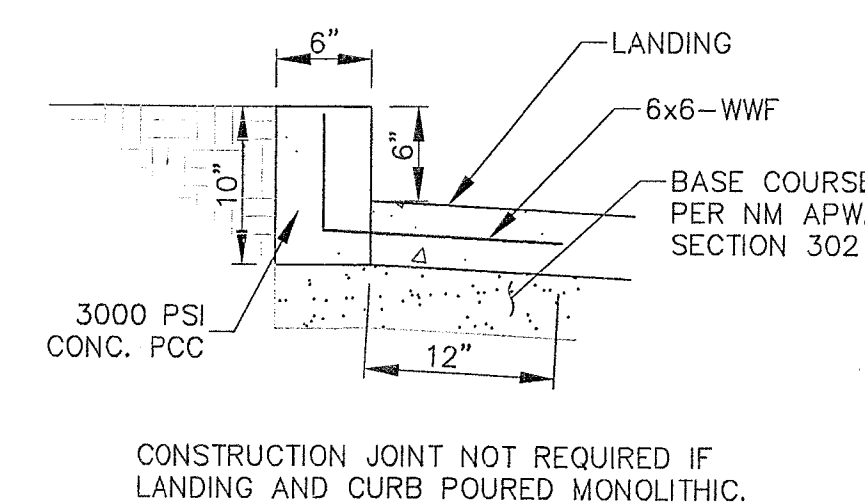

A6 STRAIGHT CURB
SCALE: 1" = 1'

DRAINAGE CERTIFICATION OF SUBSTANTIAL COMPLIANCE

I, ROBERT J. FIERRO, NMPE 20585, OF FIRM FIERRO & COMPANY, HEREBY CERTIFY THAT THIS PROJECT HAS BEEN GRADED AND WILL DRAIN IN SUBSTANTIAL COMPLIANCE WITH AND IN ACCORDANCE WITH THE DESIGN INTENT OF THE GRADING & DRAINAGE PLAN/REPORT APPROVED ON JULY 8, 2016. THE RECORD INFORMATION EDITED onto the ORIGINAL DESIGN DOCUMENT HAS BEEN OBTAINED BY ME, NMPS 22909. I FURTHER CERTIFY THAT I HAVE PERSONALLY VISITED THE PROJECT SITE ON JUNE 11, 2019 AND HAVE DETERMINED BY VISUAL INSPECTION THAT THE SURVEY DATA PROVIDED IS REPRESENTATIVE OF ACTUAL SITE CONDITIONS AND IS TRUE AND CORRECT TO THE BEST OF MY KNOWLEDGE AND BELIEF. THIS CERTIFICATION IS SUBMITTED IN SUPPORT OF A REQUEST FOR CERTIFICATE OF OCCUPANCY.

THE RECORD INFORMATION PRESENTED HEREON IS NOT NECESSARILY COMPLETE AND INTENDED ONLY TO VERIFY SUBSTANTIAL COMPLIANCE OF THE GRADING AND DRAINAGE ASPECTS OF THIS PROJECT. THOSE RELYING ON THE RECORD DOCUMENTS ARE ADVISED TO OBTAIN INDEPENDENT VERIFICATION OF ITS ACCURACY BEFORE USING IT FOR ANY PURPOSE.

Robert J. Fierro

N.M.P.F. No. 20585

FC

Fierro & Company
ENGINEERING | LAND SURVEYING

6300 MONTANO RD. N.W.
SUITE F-3
ALBUQUERQUE, NEW MEXICO 87120
PH (505) 352-8930
www.fierrocompany.com

ENGINEER'S SEAL

CALVARY CHAPEL EAST
GYMNASIUM ADDITION
ALBUQUERQUE, NEW MEXICO

PROJECT NAME

[illegible]

PROJECT NO:	162004
DESIGNED BY:	RJF
DRAWN BY:	RJF
CHECKED BY:	RJF
DATE:	MAY 2016
SHEET TITLE	

DETAILS

SHEET NO:

C3

\\Seagate-4004ED\Public\PROJECTS\SURVEYING\162004\CADD\162004_DP.dwg 5/30/2016 4:14:39 PM

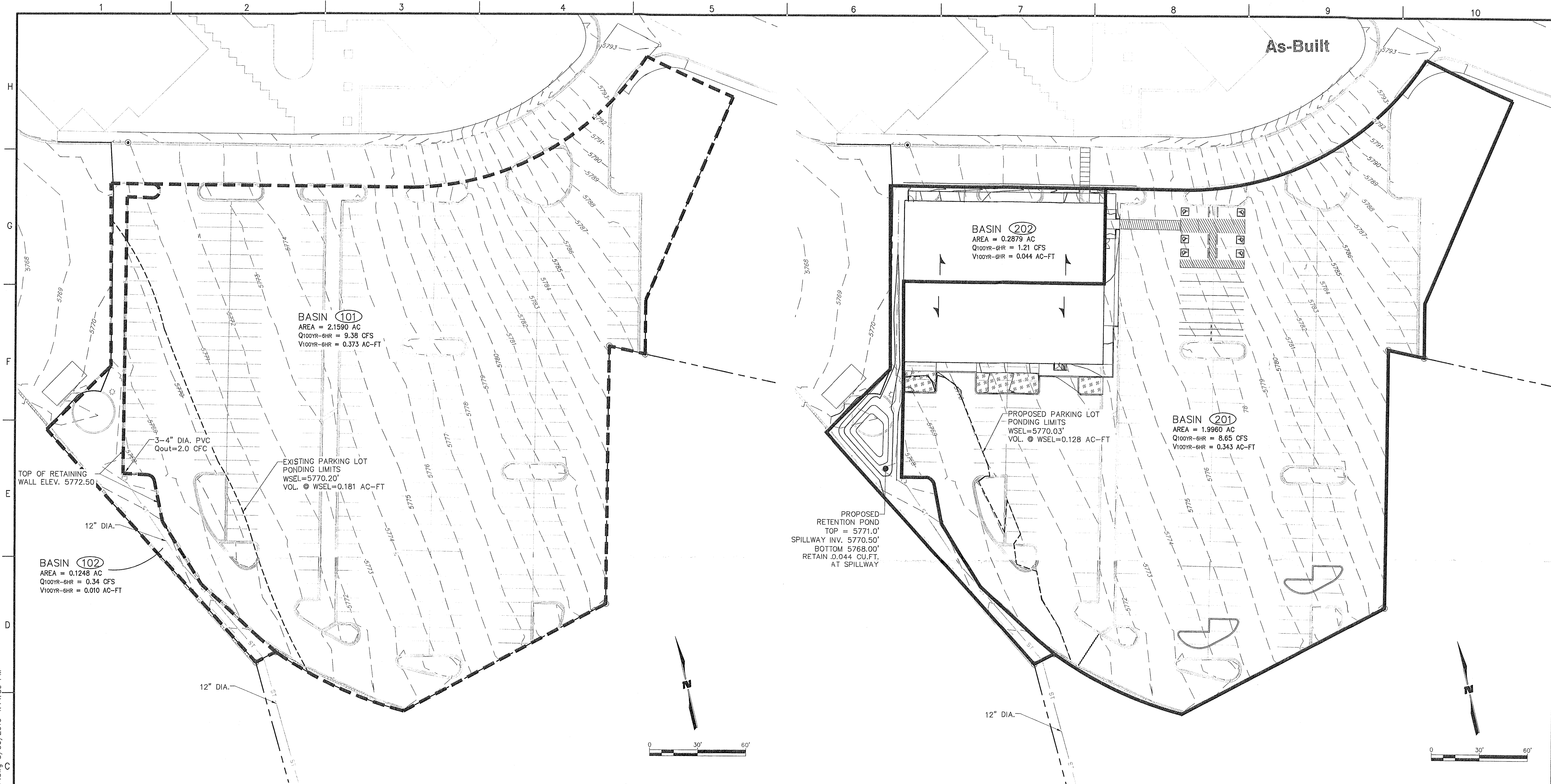

C1 EXISTING BASIN MAP

C6 PROPOSED BASIN MAP

DRAINAGE CERTIFICATION OF SUBSTANTIAL COMPLIANCE

I, ROBERT J. FIERRO, NMPE 20585, OF FIRM FIERRO & COMPANY, HEREBY CERTIFY THAT THIS PROJECT HAS BEEN GRADED AND WILL DRAIN IN SUBSTANTIAL COMPLIANCE WITH AND IN ACCORDANCE WITH THE DESIGN INTENT OF THE GRADING & DRAINAGE PLAN/REPORT APPROVED ON JULY 8, 2016. THE RECORD INFORMATION EDITED ONTO THE ORIGINAL DESIGN DOCUMENT HAS BEEN OBTAINED BY ME, NMPS 22909. I FURTHER CERTIFY THAT I HAVE PERSONALLY VISITED THE PROJECT SITE ON JUNE 11, 2019 AND HAVE DETERMINED BY VISUAL INSPECTION THAT THE SURVEY DATA PROVIDED IS REPRESENTATIVE OF ACTUAL SITE CONDITIONS AND IS TRUE AND CORRECT TO THE BEST OF MY KNOWLEDGE AND BELIEF. THIS CERTIFICATION IS SUBMITTED IN SUPPORT OF A REQUEST FOR CERTIFICATE OF OCCUPANCY.

THE RECORD INFORMATION PRESENTED HEREON IS NOT NECESSARILY COMPLETE AND INTENDED ONLY TO VERIFY SUBSTANTIAL COMPLIANCE OF THE GRADING AND DRAINAGE ASPECTS OF THIS PROJECT. THOSE RELYING ON THE RECORD DOCUMENTS ARE ADVISED TO OBTAIN INDEPENDENT VERIFICATION OF ITS ACCURACY BEFORE USING IT FOR ANY PURPOSE.

Robert J. Fierro 6-12-19
Robert J. Fierro N.M.P.E. No. 20585

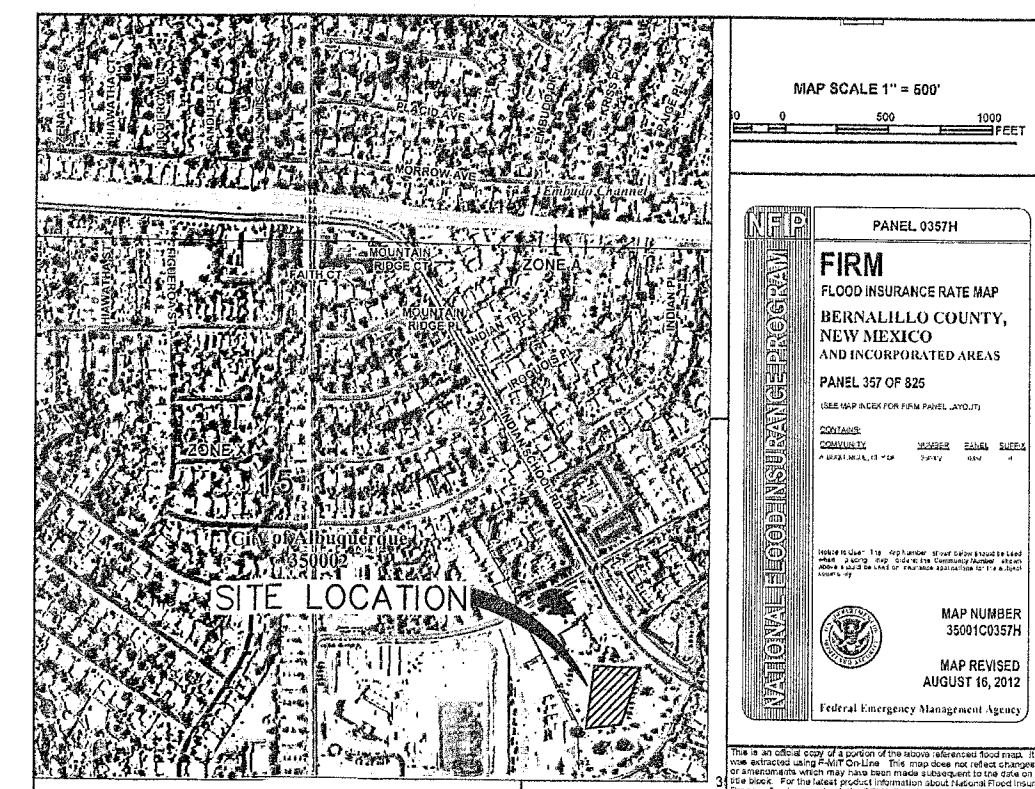
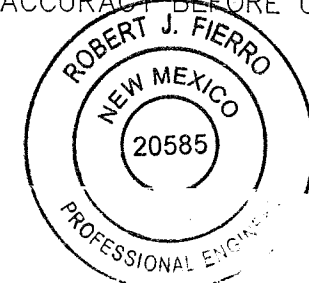

FIRM MAP

LEGEND

- PROPERTY BOUNDARY
- FLOW PATH
- EXISTING MAJOR CONTOUR
- EXISTING MINOR CONTOUR
- PROPOSED MAJOR CONTOUR
- PROPOSED MINOR CONTOUR
- EXISTING BASIN MAP
- PROPOSED BASIN MAP
- ROOF FLOW DIRECTION
- 3" DEPRESSED LANDSCAPING. TOTAL SURFACE AREA = 1280 SQ.FT.

Fierro & Company
ENGINEERING & LAND SURVEYING
6300 MONTANO RD. N.W.
SUITE F-3
ALBUQUERQUE, NEW MEXICO 87120
PH (505) 352-8930
www.fierrocompany.com



CALVARY CHAPEL EAST
GYMNASIUM ADDITION
ALBUQUERQUE, NEW MEXICO

PROJECT NAME

BY	DESCRIPTION	DATE	REV.

PROJECT NO: 162004
DESIGNED BY: RJF
DRAWN BY: RJF
CHECKED BY: RJF
DATE: MAY 2016

SHEET TITLE

GRADING
PLAN

SHEET NO:

C4