

Martin J. Chávez, Mayor

July 24, 1996

R.G. Lee
Lee Engineering
1316 Calle De Refael NE
Albuquerque, NM 87122

**RE: Grading/Paving plan for 1216 Chelwood Park NE (J22-D62) Engineer's stamp
dated 7/22/96**

Dear Mr. Lee:

Based on the information provided on your July 22, 1996 submittal, the above referenced site is approved for Grading/Paving Permit.

If I can be of farther assistance, please feel free to contact me at 768-2667.

Sincerely,



Bernie Montoya, CE
Engineering Associate

BM/cm

c: Andrew Garcia
File

Good for You. Albuquerque!

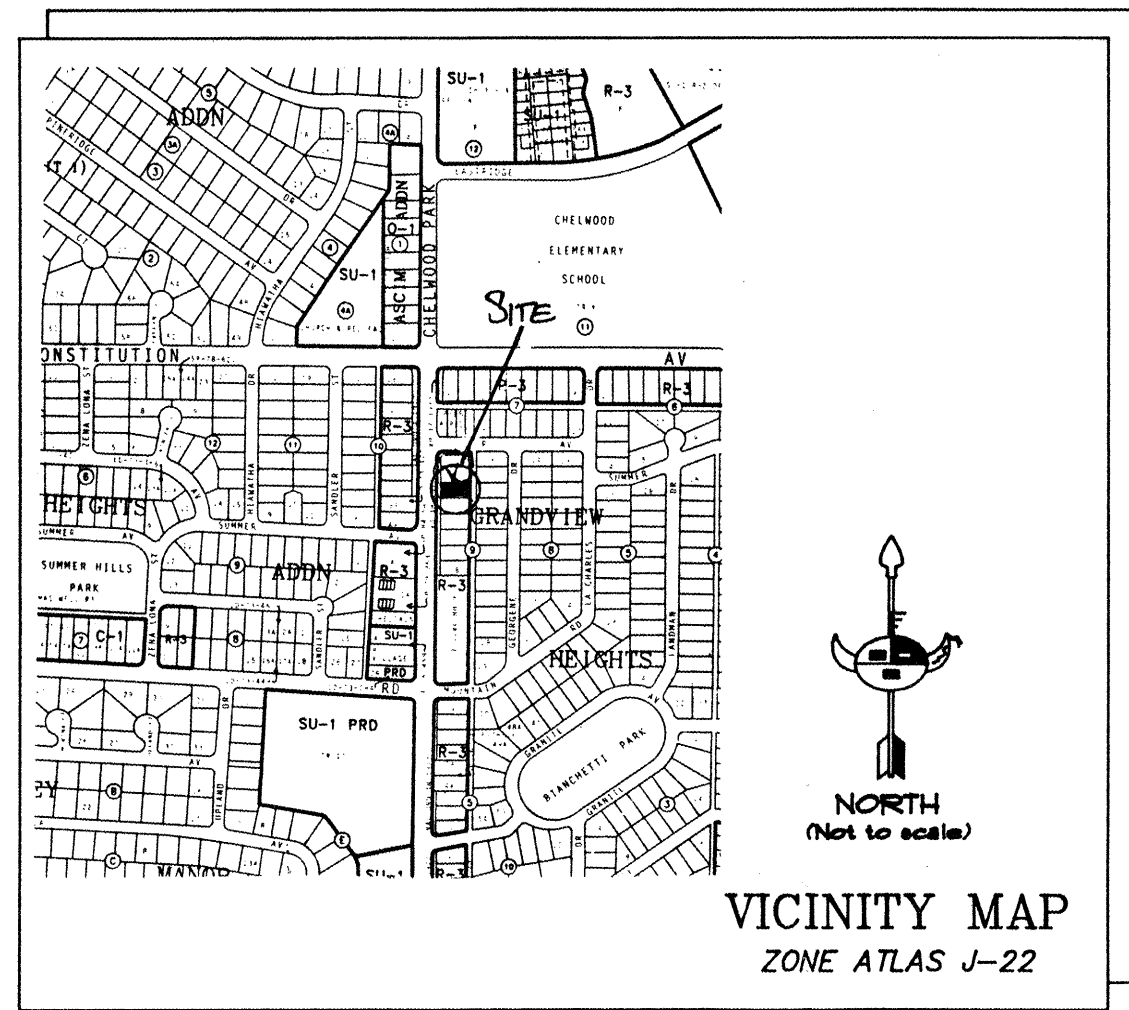



LEGAL DESCRIPTION
LOTS 13, BLOCK 9
GRANDVIEW HEIGHTS ADDITION
ALBUQUERQUE, BERNALILLO COUNTY,
NEW MEXICO.

SYMBOL LEGEND

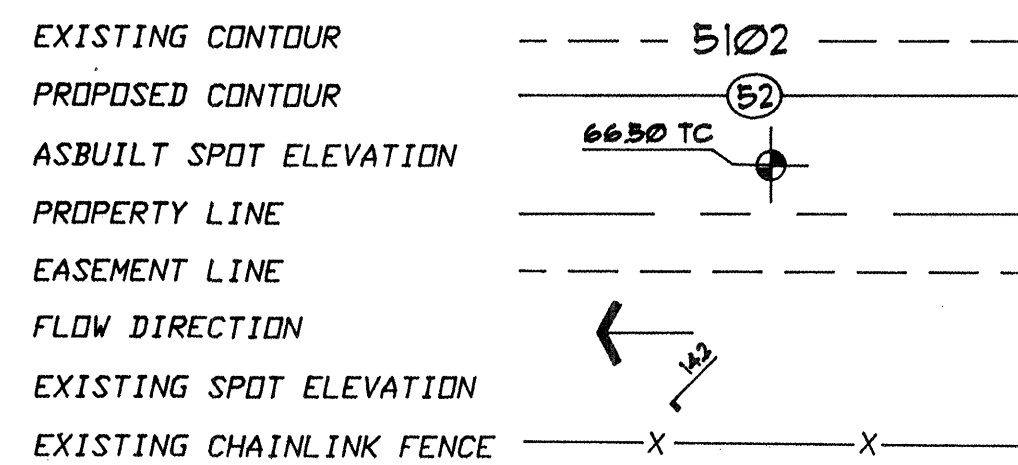

ABBREVIATION LEGEND

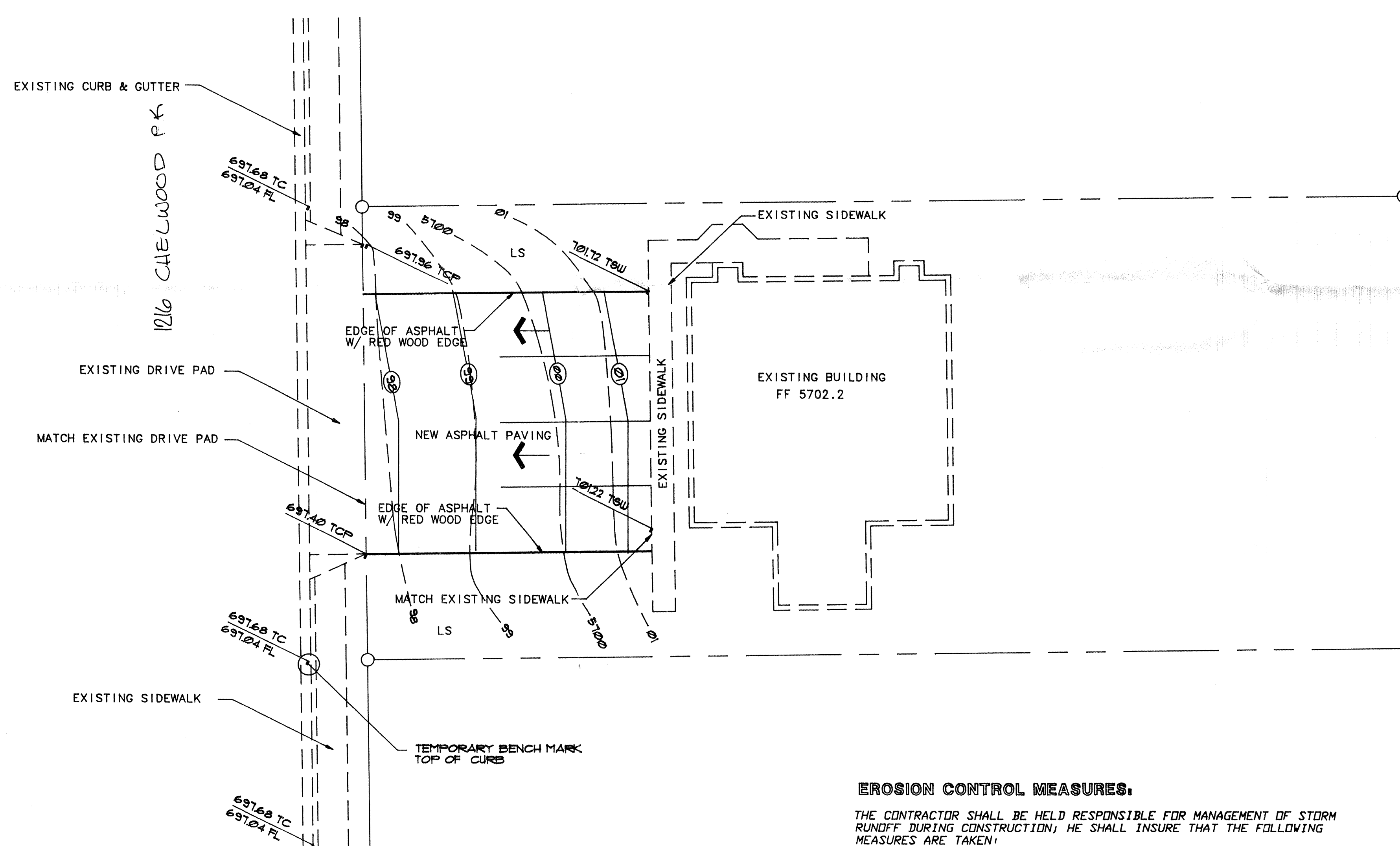
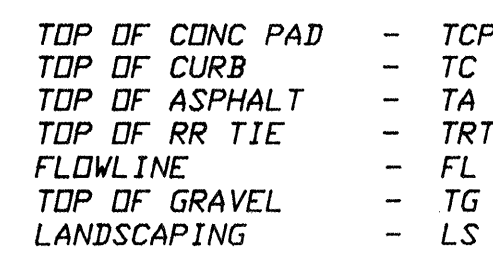

PAVING PLAN

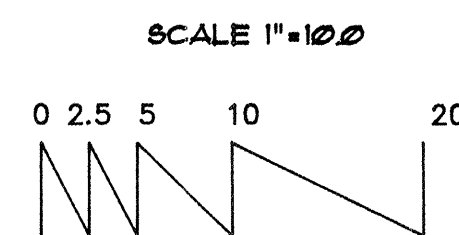
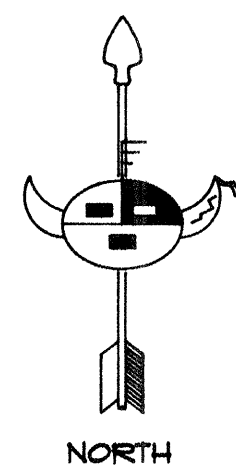

GENERAL NOTES:

1. An excavation/construction permit will be required before beginning any work within the City right-of-way. Approved copy of this plan must be submitted at the time of application for permit.
2. All work detailed in this plan to be performed, except as otherwise stated or provided hereon, shall be constructed in accordance with City of Albuquerque Interim Standard Specification for Public Works Construction 1985.
3. Two working days prior to any excavation, contractor must contact line locating Services at (505) 260-1990 for locating existing utilities.
4. Prior to construction, the contractor shall excavate and verify the horizontal and vertical location of all construction. Should a conflict exist, the contractor shall notify the engineer so that the conflict can be resolved with a minimum amount of delay.
5. Backfill compaction shall be according to residential street use.
6. All work on this project shall be performed in accordance with applicable Federal, State and local laws, rules and regulations concerning construction safety and health.
7. All work on this project shall be performed in accordance with applicable Federal, State and local laws, rules and regulations concerning construction safety and health.

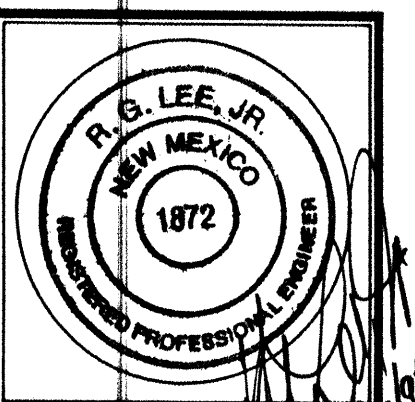

JOB NO:	1520
DATE:	1 MAY 1996
REVISIONS	

Sheet Title	GRADING AND DRAINAGE PLAN
Drawn By: H. Hood	Checked By: R.S. Lee, Jr.

HOOD & COMPANY
DEVELOPMENT CONSULTANTS - GENERAL CONTRACTING
305 TONKIN ST. NE • ALBUQUERQUE, NM • 87102 • 800-266-3377

Project Name	PROPOSED PAVING PLAN 1216 Chelwood Park Blvd NE ALBUQUERQUE, NEW MEXICO
--------------	---

SHEET NO.	1
-----------	---

JUL 22 1996