

# CITY OF ALBUQUERQUE



November 12, 2019

Brian D. Oliver, RA  
SOS Retail Services  
201 Rosa Helm Way  
Franklin, TN 87067

**Re: Delek Store #747**  
**8600 Central Ave SW**  
**30-Day Temporary Certificate of Occupancy**  
**Transportation Development Final Inspection**  
Engineer's/Architect's Stamp dated 6-25-19 K09D021)  
Certification dated XX-XX-XX

Dear Mr. Oliver

Based upon the information provided in your submittal received 11-6-19, Transportation Development has no objection to a 30-day Temporary Certificate of Occupancy based. This letter serves as a "green tag" from Transportation Development for a 30-day Temporary Certificate of Occupancy to be issued by the Building and Safety Division.

Prior to the issuance of a permanent Certificate of Occupancy, the following items must be addressed:

- Please send a copy of the Certification Language (Sample Copy Attached)
- Please add parking bumper to ADA Stall (One Missing)
- The ADA accessible parking sign must have the required language per 66-7-352.4C NMSA 1978 **"Violators Are Subject to a Fine and/or Towing."** Please call out detail and location of HC signs.
- The ADA access aisles shall have the words **"NO PARKING"** in capital letters, each of which shall be at least one foot high and at least two inches wide, placed at the rear of the parking space so as to be close to where an adjacent vehicle's rear tire would be placed. (66-1-4.1.B NMSA 1978)

Once these corrections are complete, email pictures showing the changes to [PLNDRS@cabq.gov](mailto:PLNDRS@cabq.gov) & [epgomez@cabq.gov](mailto:epgomez@cabq.gov) and submit an administrative fee of \$40. for log in and evaluation by Transportation.

# CITY OF ALBUQUERQUE



If you have any questions, please contact me at (505) 924-3981.

Sincerely,

A handwritten signature in blue ink, appearing to read 'Ernie Gomez', is written over a faint, large watermark of the City of Albuquerque seal.

Ernie Gomez,  
Plan Checker, Planning Dept.  
Development Review Services

EG via: email  
C: CO Clerk, File

PO Box 1293

Albuquerque



NM 87103

[www.cabq.gov](http://www.cabq.gov)

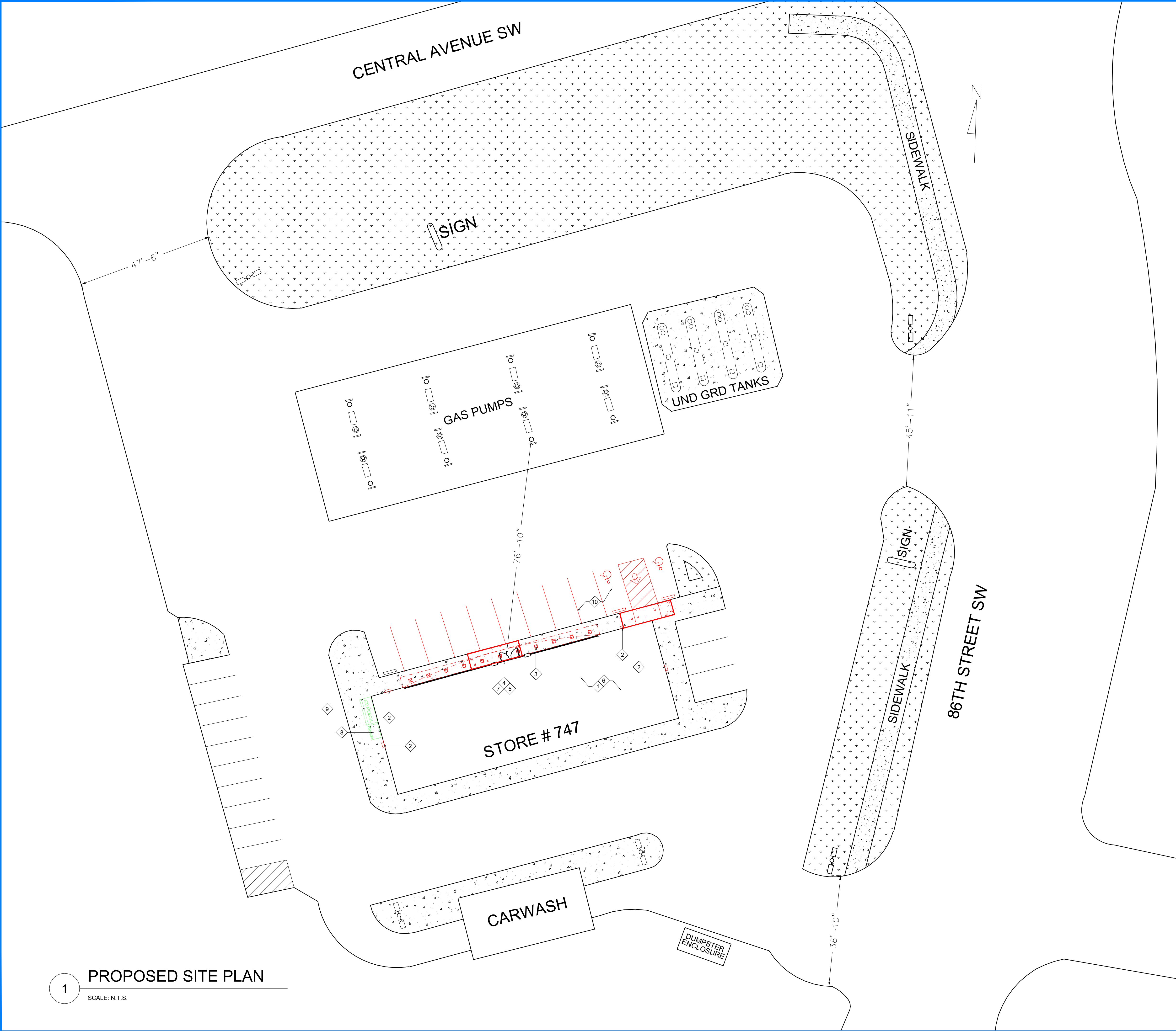



LEGEND	
	NAME: OUTSIDE LIGHT-DBL DESC: OUTSIDE DOUBLE LIGHT POLE
	NAME: OUTSIDE LIGHT-SGL DESC: OUTSIDE SINGLE LIGHT POLE
	NAME: TRAFFIC LIGHT DESC: TRAFFIC LIGHT
	NAME: PWR POLE DESC: OUTSIDE POWER POLE FOR POWER WIRES
	NAME: MAN HOLE COVER DESC: COVER FOR MAN HOLES ON PREMISES
	NAME: VENT RISERS DESC: GAS VENT RISERS FOR VENTILATION OF TANKS
	NAME: STOP SIGN DESC: STOP SIGN
	NAME: TRAFFIC SIGN DESC: TRIANGULAR TRAFFIC SIGN
	NAME: DIRECTION SIGN DESC: RECTANGULAR DIRECTIONAL SIGN
	NAME: FAUCET DESC: OUTSIDE FAUCET FOR STORE
	NAME: FIRE HYDRANT DESC: FIRE HYDRANT
	NAME: GAS SHUT OFF DESC: EMERGENCY GAS SHUT OFF SWITCH
	NAME: HANDICAP PARKING DESC: HANDICAP PARKING SYMBOLS
	NAME: AIR & VAC DESC: OUTSIDE VACUUM AND AIR MODULE
	NAME: VACUUM DESC: OUTSIDE VACUUM
	NAME: TRASH CAN DESC: OUTSIDE TRASH CAN
	NAME: STORE SIGN DESC: OUTSIDE STORE SIGN
	NAME: POLE & HORSESHOE BOLLARD DESC: POLE BOLLARDS
	NAME: PARKING CURB/BLOCK DESC: PARKING CURB/BLOCK
	NAME: DIESEL PUMP DESC: DIESEL PUMP
	NAME: GAS PUMP DESC: GAS PUMP

LUMINARIES SCHEDULE	
SYMBOL	LABEL
	12" x 12" LED SOFFIT CANOPY LIGHT - LSI SCV LED 15L SC UNV DIM 50 BRZ
	LED WALL PACK - LSI WPSLL 6L 50 UNV DIM BZA

- CONSTRUCTION KEY NOTES
- 1 DEMO EXISTING BUILDING LIGHTING
  - 2 ADD LED WALL PACKS TO BUILDING, LEFT SIDE AND RIGHT SIDE
  - 3 INSTALL LED SOFFIT LIGHTING UNDER AWNING
  - 4 DEMO STOREFRONT FASCIA
  - 5 CONSTRUCT NEW STOREFRONT FASCIA
  - 6 PREP AND INSTALL NEW FINISHES PER ELEVATIONS
  - 7 CONSTRUCT NEW AWNING PER PLAN
  - 8 RELOCATE PROPANE TO LEFT SIDE OF BUILDING
  - 9 RELOCATE ICE MERCHANDISER TO RIGHT SIDE OF BUILDING
  - 10 RELOCATE ADA PARKING AND RE-PAINT LINE STRIPING AS SHOWN

LANDSCAPE LEGEND	
	LAWN
	PAVED AREA
	GRAVEL AREA
	TREE
	SHRUB
	FLOWER BED
	MULCH
	SAND
	CONCRETE
	ASPHALT
	BRICK
	COBBLESTONE
	GRASS
	FERTILIZER
	WATER
	DRAINAGE
	STORM DRAIN
	SEWER LINE
	GAS LINE
	ELECTRIC LINE
	TELEPHONE LINE
	CABLE TV LINE
	FIRE HYDRANT
	MAN HOLE COVER
	VENT RISER
	GAS SHUT OFF
	FAUCET
	FIRE HYDRANT
	GAS SHUT OFF
	FAUCET

1	PROPOSED SITE PLAN
SCALE: N.T.S.	

1 A/E REVISION

1 FIELD REVISION

1 CODE REVISION

DATE	REV#	SUMMARY	INITIAL
04-12-2019	4	AWNING REVISIONS	ANM
05-10-2019	5	CONSTRUCTION SET	ANM
05-20-2019	6	ADDRESS REVISED	ANM
05-26-2019	7	PLAN REVIEW REVISIONS	ANM
07-26-2019	8	GONDOLA REVISIONS	ANM
08-12-2019	9	TCL REVISIONS	ANM

STORE # 57747

8600 CENTRAL AVENUE SW

ALBUQUERQUE, NM 87121

DELEK

SOS Retail Services, LLC

201 Rosa Helm Way | Franklin, TN. | 37067

Phone: 615.550.4343 | Fax 615.550.4364

SEAL

Store Number

57747

Scale

N.T.S.

DRAWN BY: JCV

CHECKED BY: EL

Date

03-25-2019

Sheet

2 OF 16

SP



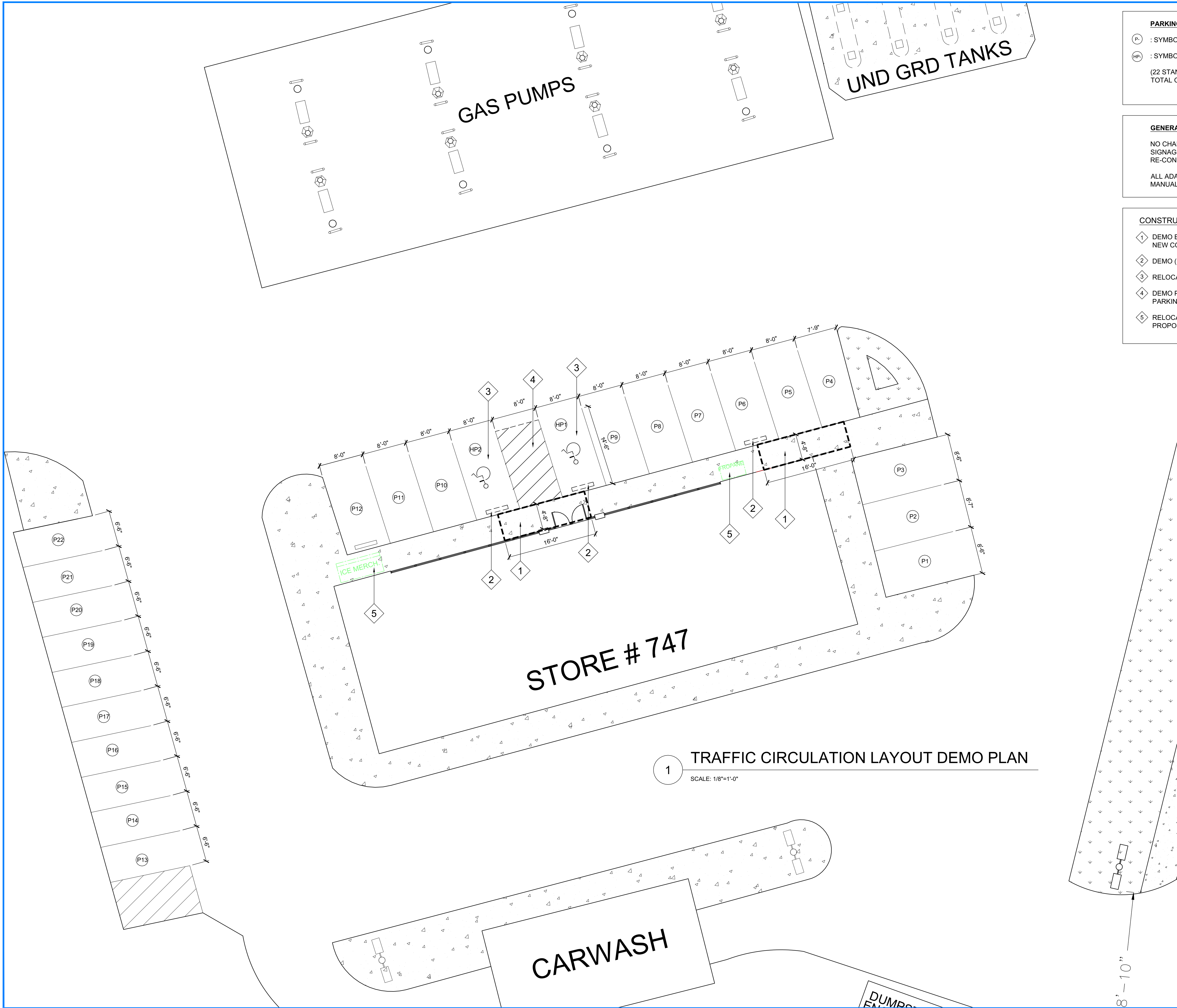

**PARKING SPACE NOTES:**

(P) : SYMBOL SIGNIFIES 12' X 20' STANDARD PARKING SPACES

(HP) : SYMBOL SIGNIFIES 12' X 20' HANDICAP PARKING SPACES

(22 STANDARD SPACES 06-10-2019 12' X 20' HANDICAP PARKING SPACE)

TOTAL OF 24

**GENERAL NOTES:**

NO CHANGE TO THE NUMBER OF PARKING SPACES AND SIGNAGE TO REMAIN AS IS, NO CHANGES OR RE-CONFIGURATION AS PART OF THIS SCOPE OF WORK

ALL ADA ITEMS PER TCL TO MEET CITY DEVELOPMENT PROCESS MANUAL, (CHAPTER 23, VOLUME 1)

**CONSTRUCTION KEY NOTES**

1 DEMO EXISTING CONCRETE; PREPARE FOR INSTALLATION OF NEW CONCRETE

2 DEMO (3) WHEEL STOPS; PREPARE FOR NEW

3 RELOCATE HANDICAP PARKING; SEE TCL1.1 FOR NEW LOCATION

4 DEMO PAINT STRIPS AT THIS LOCATION; PREPARE FOR NEW PARKING SPOT

5 RELOCATE ICE MERCHANDISERS AND PROPANE CAGE; SEE PROPOSED TCL1.1 FOR NEW LOCATION

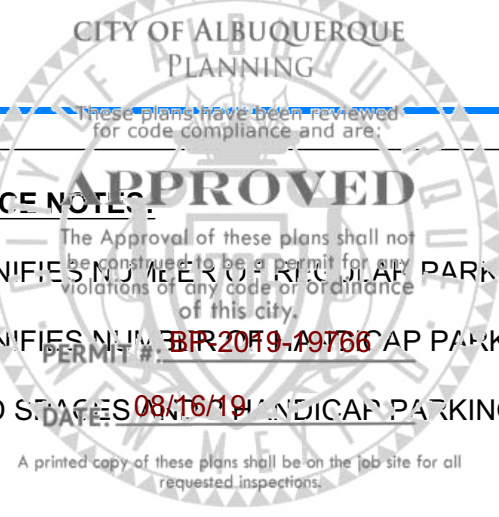

- 1 A/E REVISION
- 1 FIELD REVISION
- 1 CODE REVISION

DATE	REV#	SUMMARY	INITIAL
04-12-2019	4	AWNING REVISIONS	ANM
05-10-2019	5	CONSTRUCTION SET	ANM
05-20-2019	6	ADDRESS REVISED	ANM
05-26-2019	7	PLAN REVIEW REVISED	ANM
07-26-2019	8	GONDOLA REVISIONS	ANM
08-12-2019	9	TCL REVISIONS	ANM

STORE # 57747

8600 CENTRAL AVENUE SW

ALBUQUERQUE, NM 87121

DELEK

SOS Retail Services, LLC

201 Rosa Helm Way | Franklin, TN. | 37067

Phone: 615.550.4343 | Fax 615.550.4364

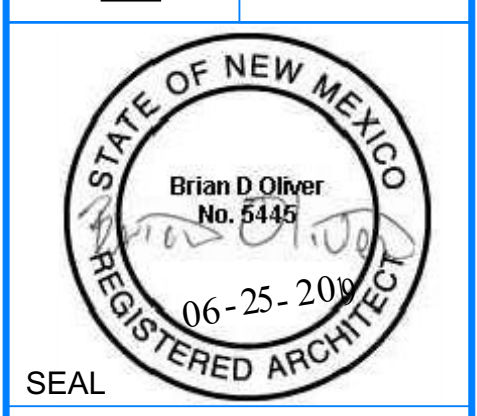

SEAL

**SOS RETAIL SERVICES**

Store Number

**57747**

Scale

**1/8" = 1'-0"**

DRAWN BY: JCV

CHECKED BY: EL

Date

**03-25-2019**

Sheet

**3 OF 16**

**TCL1.0**



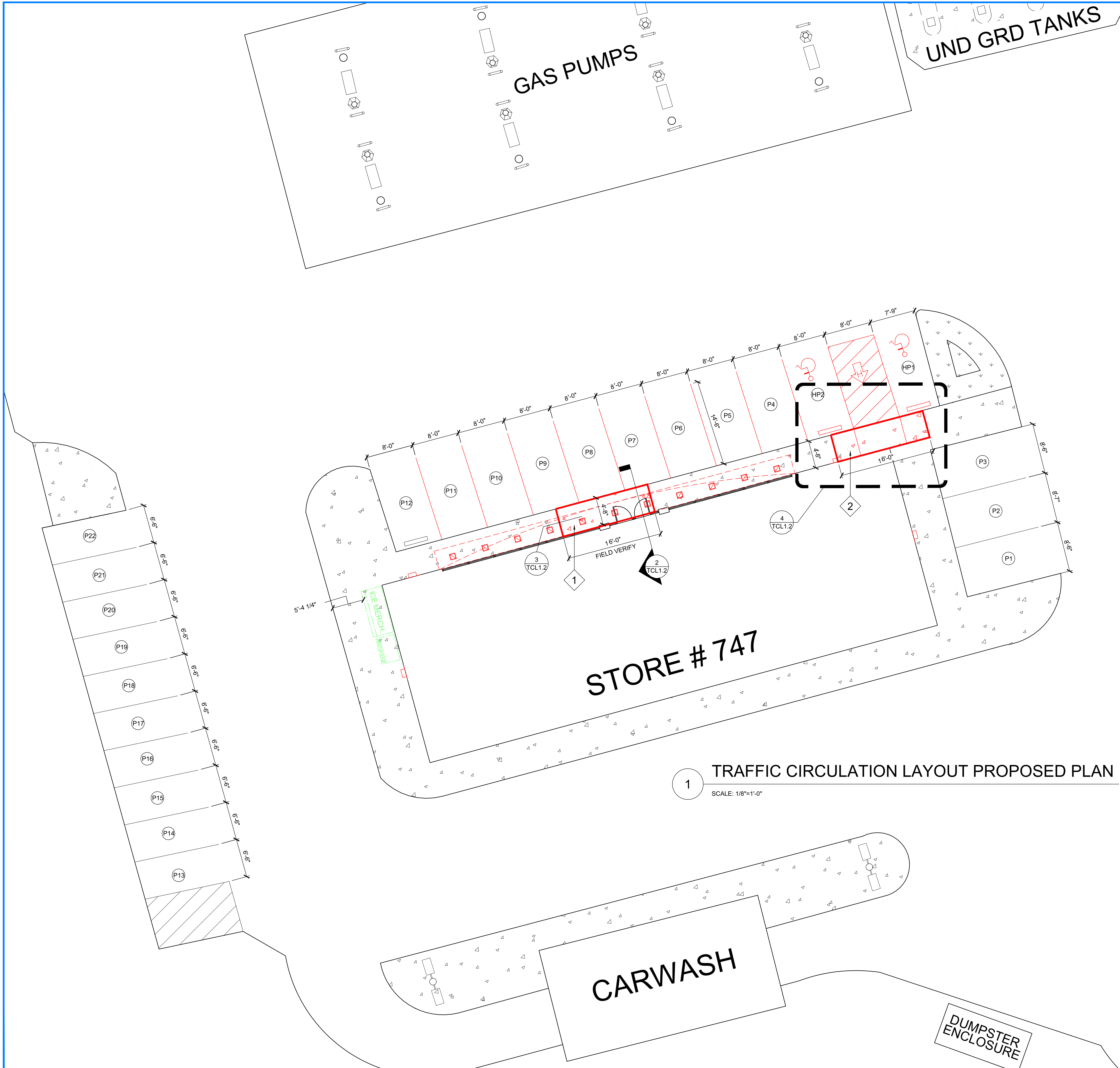

**PARKING SPACE NOTES:**

(P) : SYMBOL SIGNIFIES 12' X 20' STANDARD PARKING SPACES

(HP) : SYMBOL SIGNIFIES 12' X 20' ADA COMPLIANT PARKING SPACES

(22 STANDARD SPACES + 2 ADA COMPLIANT PARKING SPACE)

TOTAL OF 24

**GENERAL NOTES:**

ALL PARKING SPACES AND SIGNAGE TO REMAIN AS IS, NO CHANGES OR RE-CONFIGURATION AS PART OF THIS SCOPE OF WORK

ALL ADA ITEMS PER TCL TO MEET CITY DEVELOPMENT PROCESS MANUAL, (CHAPTER 23, VOLUME 1)

**CONSTRUCTION KEY NOTES**

1 INSTALL NEW CONCRETE SIDEWALK IN THIS LOCATION, SEE DETAILS 2/TCL1.2 AND 3/TCL1.2

2 INSTALL NEW CONCRETE LANDING AND ADA RAMPS; SEE DETAILS 1/TCL1.2 AND 5/TCL1.2

3 RE-PAINT LINE STRIPING AS SHOWN

4 INSTALL (2) NEW WHEEL STOPS

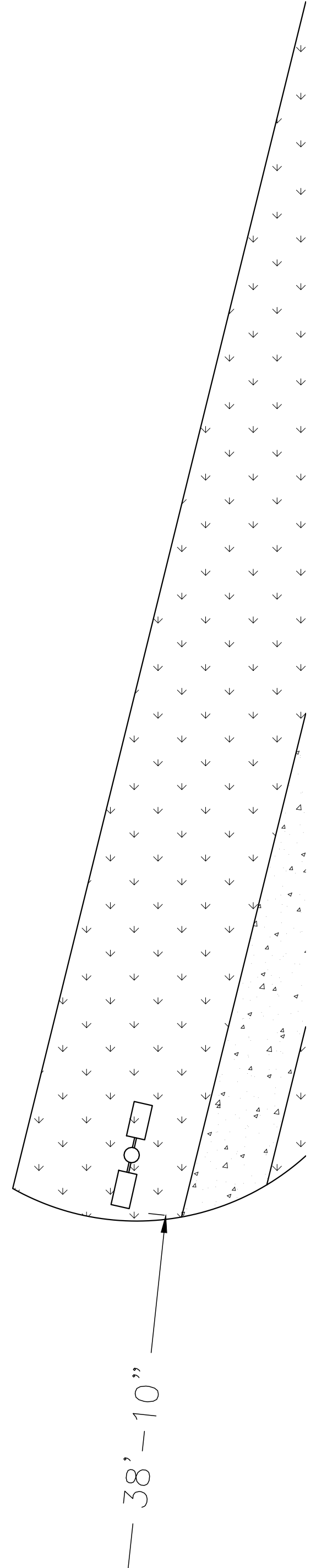

- 1 A/E REVISION
- 1 FIELD REVISION
- 1 CODE REVISION

INITIAL	DATE	REV#	SUMMARY
ANM	04-12-2019	4	AWNING REVISIONS
ANM	05-10-2019	5	CONSTRUCTION SET
ANM	05-20-2019	6	ADDRESS REVISED
ANM	05-26-2019	7	PLAN REVIEW REVISED
ANM	07-26-2019	8	GONDOLA REVISIONS
ANM	08-12-2019	9	TCL REVISIONS

STORE # 57747  
8600 CENTRAL AVENUE SW  
ALBUQUERQUE, NM 87121

**DELEK**

SOS Retail Services, LLC  
201 Rosa Helm Way | Franklin, TN. | 37067  
Phone: 615.550.4343 | Fax 615.550.4364

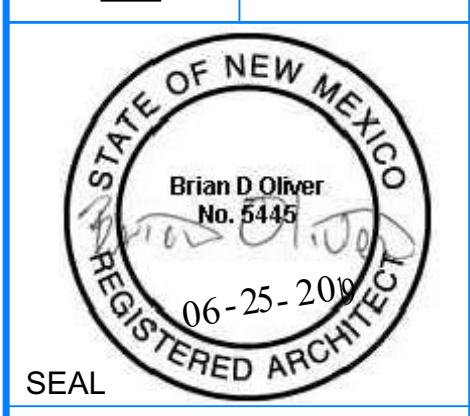

**SOS RETAIL SERVICES**

Store Number  
**57747**

Scale  
**1/8" = 1'-0"**

DRAWN BY: JCV

CHECKED BY: EL

Date  
**03-25-2019**

Sheet  
**4 OF 16**

**TCL1.1**





- ① A/E REVISION  
① FIELD REVISION  
⚠ CODE REVISION

DATE	REV#	SUMMARY	INITIAL
04-12-2019	4	AWNING REVISIONS	ANM
05-10-2019	5	CONSTRUCTION SET	ANM
05-20-2019	6	ADDRESS REVISED	ANM
05-26-2019	7	PLAN REVIEW REVISED	ANM
07-26-2019	8	GONDOLA REVISIONS	ANM
08-12-2019	9	TCL REVISIONS	ANM

STORE # 57747  
8600 CENTRAL AVENUE SW  
ALBUQUERQUE, NM 87121  
**DELEK**  
SOS Retail Services, LLC  
201 Rosa Helm Way | Franklin, TN. | 37067  
Phone: 615.550.4343 | Fax 615.550.4364



Store Number	57747
Scale	N.T.S.
DRAWN BY:	JCV
CHECKED BY:	EL
Date	03-25-2019
Sheet	5 OF 16

TCL1.2

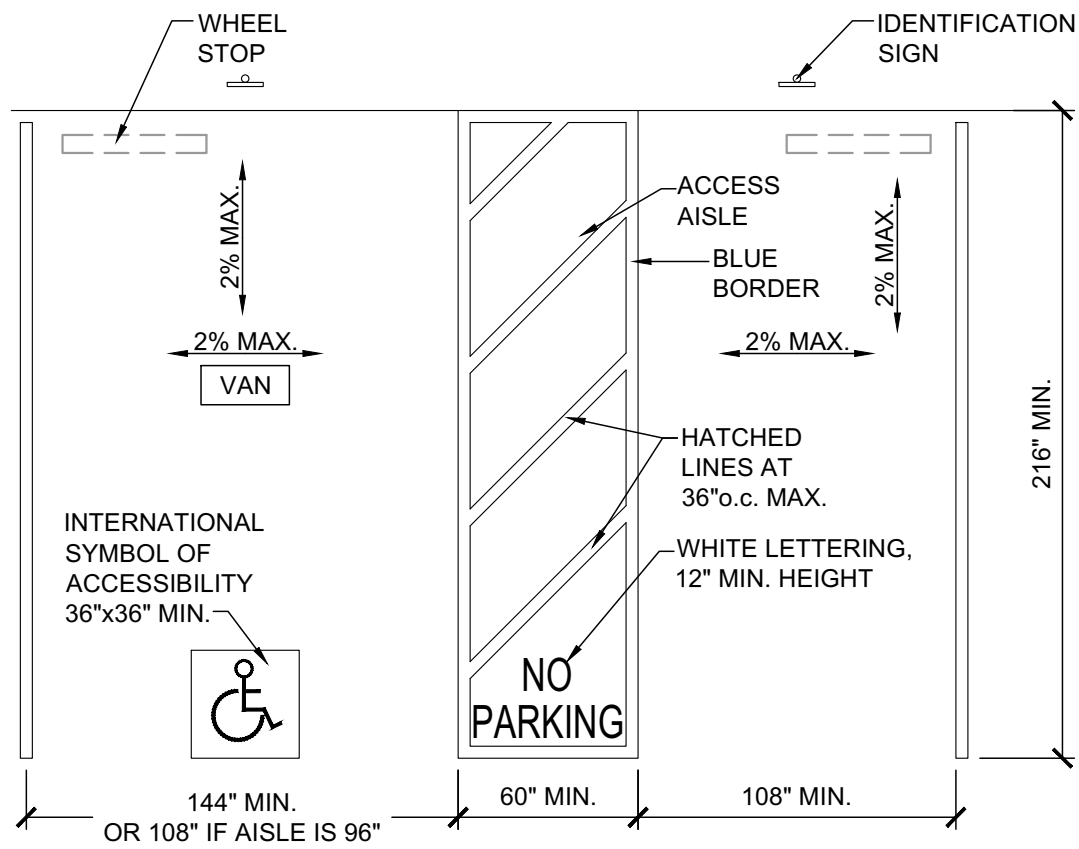

GENERAL NOTES:

**11B-502.2 VEHICLE SPACES:** CAR AND VAN PARKING SPACES SHALL BE 216" LONG MIN. CAR PARKING SPACES SHALL BE 108" WIDE MIN AND VAN PARKING SPACES SHALL BE 144" WIDE MIN., SHALL BE MARKED TO DEFINE THE WIDTH, AND SHALL HAVE AN ADJACENT ACCESS AISLE COMPLYING WITH SECTION 11B-502.3.  
**EXCEPTION:** VAN PARKING SPACES SHALL BE PERMITTED TO BE 108" WIDE MIN. WHERE THE ACCESS AISLE IS 96" WIDE MIN.

**11B-502.3.4 LOCATION:** ACCESS AISLES SHALL NOT OVERLAP THE VEHICULAR WAY. ACCESS AISLES SHALL BE PERMITTED TO BE PLACED ON EITHER SIDE OF THE PARKING SPACE EXCEPT FOR VAN PARKING SPACES WHICH SHALL HAVE ACCESS AISLES LOCATED ON THE PASSENGER SIDE OF THE PARKING SPACES.

**11B-502.4 FLOOR OR GROUND SURFACES:** PARKING SPACES AND ACCESS AISLES SERVING THEM SHALL COMPLY WITH SECTION 11B-302. ACCESS AISLES SHALL BE AT THE SAME LEVEL AS THE PARKING SPACES THEY SERVE. CHANGES IN LEVEL ARE NOT PERMITTED.  
**EXCEPTION:** SLOPES NOT STEEPER THAN 1:48 SHALL BE PERMITTED.

**11B-502.5 VERTICAL CLEARANCE:** PARKING SPACES, ACCESS AISLES AND VEHICULAR ROUTES SERVING THEM SHALL PROVIDE A VERTICAL CLEARANCE OF 98" MIN.

**11B-502.6 IDENTIFICATION:** PARKING SPACE IDENTIFICATION SIGNS SHALL INCLUDE THE INTERNATIONAL SYMBOL OF ACCESSIBILITY COMPLYING WITH SECTION 11B-703.7.2.1. SIGNS IDENTIFYING VAN PARKING SPACES SHALL CONTAIN ADDITIONAL LANGUAGE OR AN ADDITIONAL SIGN WITH THE DESIGNATION "VAN ACCESSIBLE." SIGNS SHALL BE 60" MIN. ABOVE THE FINISH FLOOR OR GROUND SURFACE MEASURED TO THE BOTTOM OF THE SIGN.

**EXCEPTION:** SIGNS LOCATED WITHIN AN ACCESSIBLE ROUTE SHALL BE A MIN. OF 80" ABOVE THE FINISH FLOOR OR GROUND SURFACE MEASURED TO THE BOTTOM OF THE SIGN.

**11B-502.6.1 FINISH AND SIZE:** PARKING IDENTIFICATION SIGNS SHALL BE REFLECTORIZED WITH A MIN. AREA OF 70 SQ. INCHES.

**11B-502.6.2 MINIMUM FINE:** ADDITIONAL LANGUAGE OR AN ADDITIONAL SIGN BELOW THE INTERNATIONAL SYMBOL OF ACCESSIBILITY SHALL STATE "MINIMUM FINE \$250."

**11-502.6.3 MEAN:** A PARKING SPACE IDENTIFICATION SIGN SHALL BE VISIBLE FROM EACH PARKING SPACE. SIGNS SHALL BE PERMANENTLY POSTED EITHER IMMEDIATELY ADJACENT TO THE PARKING SPACE OR WITHIN THE PROJECTED PARKING SPACE WIDTH AT THE HEAD END OF THE PARKING SPACE. SIGNS MAY ALSO BE PERMANENTLY POSTED ON A WALL AT THE INTERIOR END OF THE PARKING SPACE.

**11B-502.7.2 WHEEL STOPS:** A CURB OR WHEEL STOP SHALL BE PROVIDED IF REQUIRED TO PREVENT ENCROACHMENT OF VEHICLES OVER THE REQUIRED CLEAR WIDTH OF ADJACENT ACCESSIBLE ROUTES.

**11B-502.8 ADDITIONAL SIGNAGE:** AN ADDITIONAL SIGN SHALL BE POSTED EITHER: 1) IN A CONSPICUOUS PLACE AT EACH ENTRANCE TO AN OFF-STREET PARKING FACILITY OR 2) IMMEDIATELY ADJACENT TO ON-SITE ACCESSIBLE PARKING AND VISIBLE FROM EACH PARKING SPACE.

**11B-502.8.2 LETTERING:** THE ADDITIONAL SIGN SHALL CLEARLY STATE IN LETTERS WITH A MIN. HEIGHT OF 1" THE FOLLOWING:  
"UNAUTHORIZED" VEHICLES PARKED IN DESIGNATED ACCESSIBLE SPACES NOT DISPLAYING DISTINGUISHING PLACARDS OR SPECIAL LICENSE PLATES ISSUED FOR PERSONS WITH DISABILITIES WILL BE TOWED AWAY AT THE OWNERS EXPENSE. TOWED VEHICLES MAY BE RECLAIMED AT: \_\_\_\_\_ OR BY TELEPHONING \_\_\_\_\_  
BLANK SPACES SHALL BE FILLED IN WITH APPROPRIATE INFORMATION AS A PERMANENT PART OF THE SIGN.

TYP. ADA PARKING DETAIL

SCALE: 3/16"=1'-0"

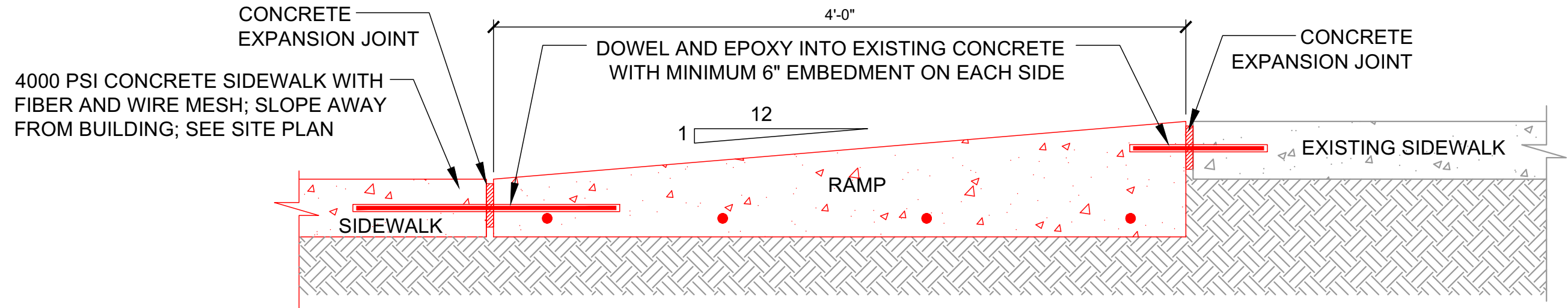

HANDICAP RAMP DETAIL

SCALE: 1-1/2"=1'-0"



ENLARGED PLAN

SCALE: 1/2"=1'-0"

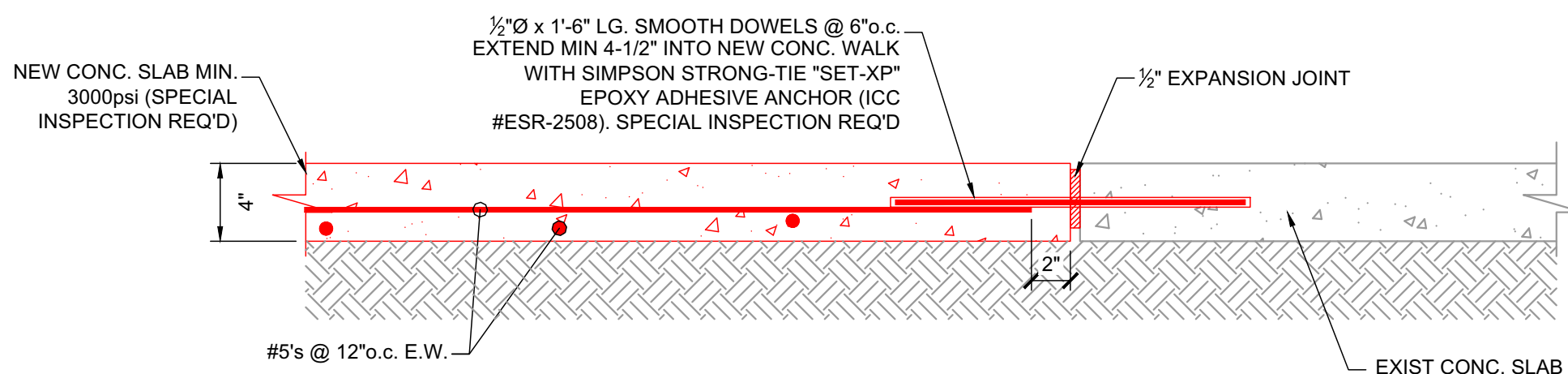

NEW CONC. WALK DETAIL

SCALE: 1-1/2"=1'-0"

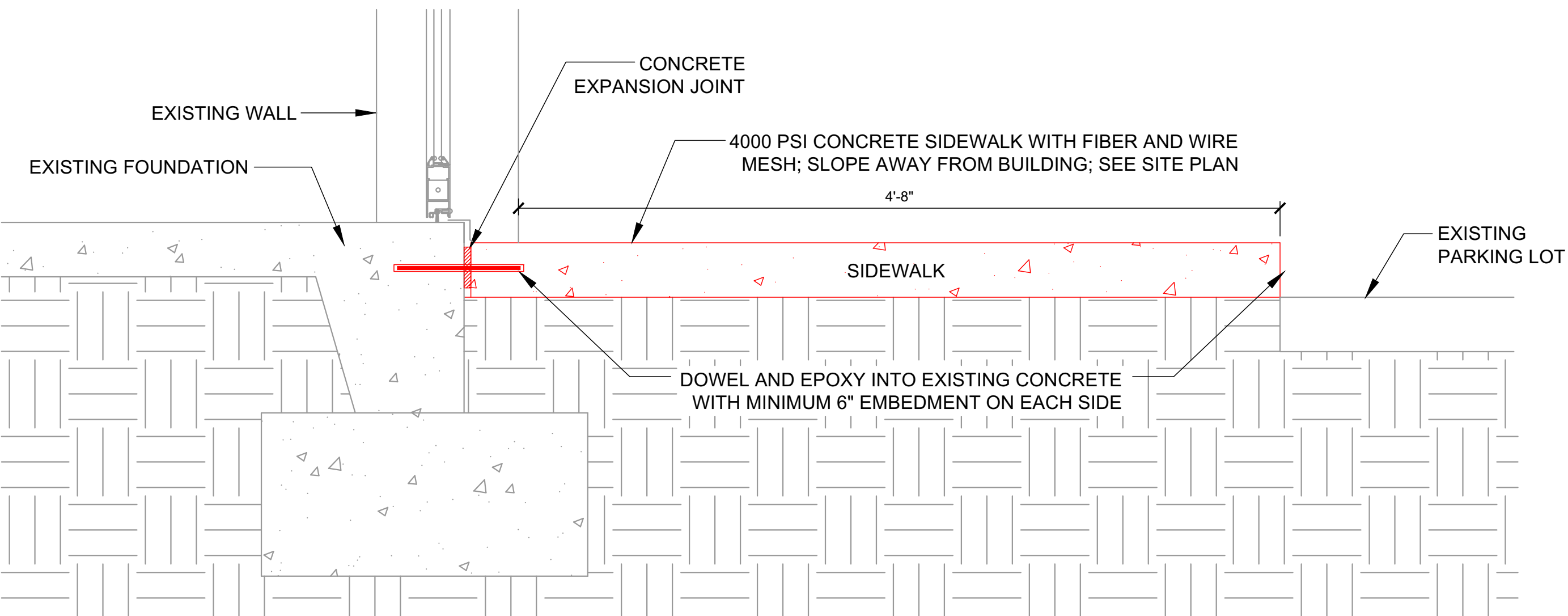

SIDEWALK DETAIL

SCALE: 1-1/2"=1'-0"

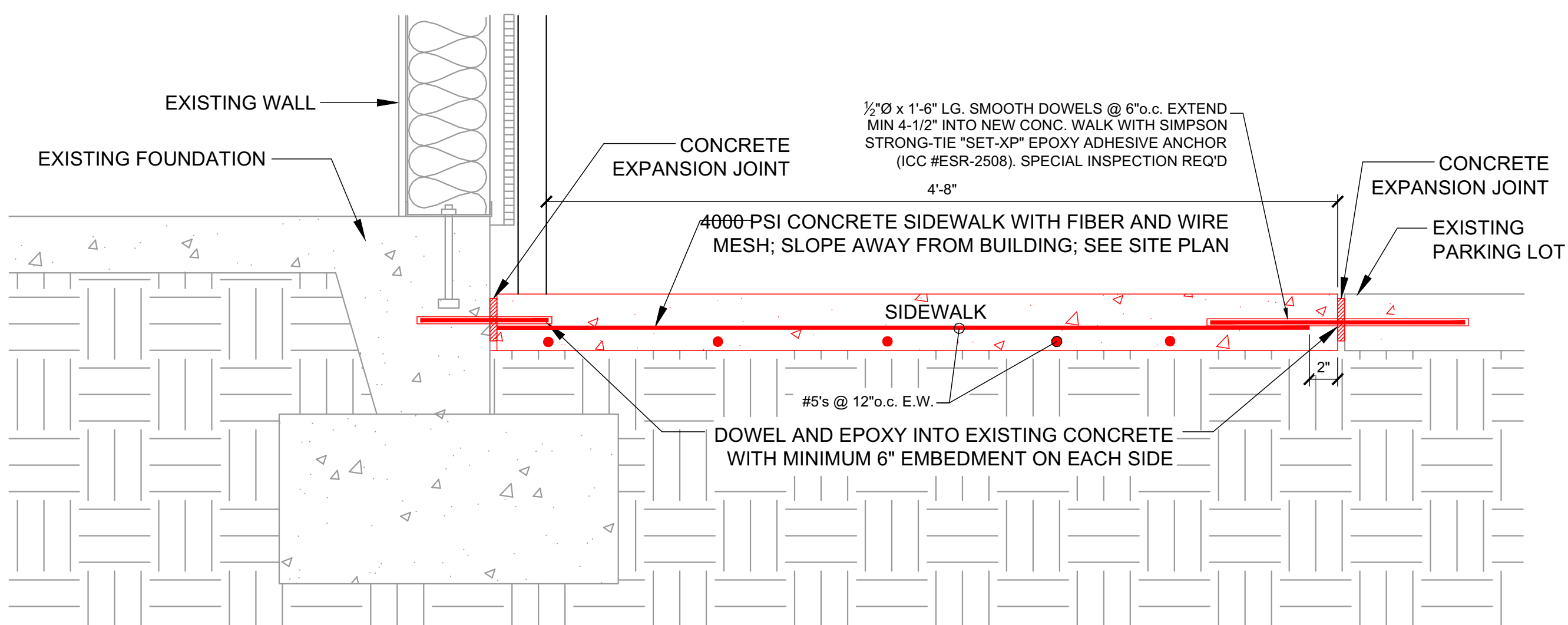

NEW CONCRETE LANDING DETAIL

SCALE: 1-1/2"=1'-0"



## TRAFFIC CERTIFICATION

I, \_\_\_\_\_, NMPE OR NMRA \_\_\_\_\_, OF THE FIRM \_\_\_\_\_, HEREBY CERTIFY THAT THIS PROJECT IS IN SUBSTANTIAL COMPLIANCE WITH AND IN ACCORDANCE WITH THE DESIGN INTENT OF THE APPROVED PLAN DATED \_\_\_\_\_. THE RECORD INFORMATION EDITED ONTO THE ORIGINAL DESIGN DOCUMENT HAS BEEN OBTAINED BY \_\_\_\_\_ OF THE FIRM \_\_\_\_\_. I FURTHER CERTIFY THAT I HAVE PERSONALLY VISITED THE PROJECT SITE ON \_\_\_\_\_ AND HAVE DETERMINED BY VISUAL INSPECTION THAT THE SURVEY DATA PROVIDED IS REPRESENTATIVE OF ACTUAL SITE CONDITIONS AND IS TRUE AND CORRECT TO THE BEST OF MY KNOWLEDGE AND BELIEF. THIS CERTIFICATION IS SUBMITTED IN SUPPORT OF A REQUEST FOR \_\_\_\_\_.

**<LIST EXCEPTIONS, IF ANY>**

THE RECORD INFORMATION PRESENTED HEREON IS NOT NECESSARILY COMPLETE AND INTENDED ONLY TO VERIFY SUBSTANTIAL COMPLIANCE OF THE TRAFFIC ASPECTS OF THIS PROJECT. THOSE RELYING ON THE RECORD DOCUMENT ARE ADVISED TO OBTAIN INDEPENDENT VERIFICATION OF ITS ACCURACY BEFORE USING IT FOR ANY OTHER PURPOSE.

ENGINEER'S OR ARCHITECT'S STAMP

\_\_\_\_\_  
Signature of Engineer or Architect

\_\_\_\_\_  
Date

**THIS CERTIFICATION MUST BE SUBMITTED ON EITHER**

**1) COMPANY LETTERHEAD, WITH AN ORIGINAL STAMP AND SIGNATURE**

**or**

**2) ON THE ORIGINAL APPROVED PLAN WITH EITHER TCL STAMP OR DRB SIGNATURE BLOCK**

## Transportation Submittal Process

### Building Permit Approval

1. Prepare a Traffic Circulation Layout (TCL).\*
2. Fill out a Drainage Transportation Information Sheet (DTIS).
3. Submittal includes the DTIS and two paper copies of the TCL.
4. Send an electronic copy of your submittal to [PLNDRS@cabq.gov](mailto:PLNDRS@cabq.gov).
5. Submit the paper submittal to front counter personnel at the Plaza Del Sol Building on the Ground Floor West. Mailing address: 600 2<sup>nd</sup> St. NW, Suite 201, Albuquerque, NM 87102
6. When approved one copy of the TCL with an "Approved" stamp and signature will be sent to the applicant.
7. Insert a copy of the approved and stamped plan in both paper building permit plan sets or upload to ePlan building permit set.

Please allow 1 week for review and approval of all TCL's.

\*For properties that have an Administrative Amendment or Site Plan for Building Permit a separate submittal is not required. Please make sure the final stamped and signed plan is in the building permit plan sets.

### Certificate of Occupancy

1. Find the approved and stamped TCL, Administrative Amendment, or Site Plan for Building Permit; and draw in red any changes that were made to the site during construction to create the As-Built Drawings.
2. Prepare a Transportation Certification letter using the provided standard language.
3. Fill out a Drainage Transportation Information Sheet (DTIS)
4. Submittal includes one copy of the DTIS, Transportation Certification and As-Built Drawings
5. Send an electronic copy of your submittal to [PLNDRS@cabq.gov](mailto:PLNDRS@cabq.gov).
6. Submit the paper submittal to front counter personnel at the Plaza Del Sol Building on the Ground Floor West. Mailing address: 600 2<sup>nd</sup> St. NW, Suite 201, Albuquerque, NM 87102
7. After your complete submittal is received city staff we will go out to do a field inspection on the project.
8. Please allow 1 week for review and approval of all CO's.
9. When the CO is approved a letter will be sent to the applicant and the building and safety section (CO clerk).

Transportation does not sign the White CO card.