

SOIL EROSION AND SEDIMENT CONTROL PLAN

FOR

ENGINEER



STANTEC CONSULTING SERVICES, INC.
733 MARQUETTE AVE, SUITE 1000
MINNEAPOLIS, MN 55402.
PROJECT MANAGER: JACK AMMERMAN,
(E) - JACK.AMMERMAN@STANTEC.COM
ENGINEER OF RECORD: COLLEEN RUIZ, P.E.
(E) - COLLEEN.RUIZ@STANTEC.COM

LANDSCAPE ARCHITECT



STANTEC CONSULTING SERVICES, INC.
70 NE LOOP 410, SUITE 1116
SAN ANTONIO, TX 78216-5893
(E) - COLT.YOREK@STANTEC.COM
CONTACT: COLT YOREK, PLA, ASLA, ENV SP

CLIENT



OPPIDAN INVESTMENT COMPANY
 400 WATER STREET, SUITE 200
 EXCELSIOR, MN 55331
 (E) - DREW@OPPIDAN.COM
 CONTACT: DREW JOHNSON

ARCHITECT



SALAS O'BRIEN
10202 5TH AVENUE NE, SUITE 300
SEATTLE, WA 98125
(E) - BRENDA.ROSS@SALASOBRIEN.COM
CONTACT: BRENDA ROSS NCARB, AIA, LEED AP

ALBUQUERQUE
10 MW DATA CENTER
DAYTONA RD NW, ALBUQUERQUE, NEW MEXICO
JULY 2024

PROJECT NUMBER - PR-2020-004747
SITE PLAN DFT - SI-2024-00451



PROJECT LOCATION
CITY: ALBUQUERQUE
COUNTY: BERNALILLO COUNTY



SHEET LIST TABLE	
SHEET NUMBER	SHEET TITLE
ESC-001	SOIL AND EROSION CONTROL COVER SHEET
ESC-002	SOIL EROSION AND SEDIMENT CONTROL DETAILS & NOTES
ESC-003	SOIL EROSION AND SEDIMENT CONTROL PRE-CONSTRUCTION PLAN
ESC-004	SOIL EROSION AND SEDIMENT CONTROL POST-CONSTRUCTION PLAN
ESC-005	SOIL EROSION AND SEDIMENT CONTROL DETAILS

SEQUENCE OF CONSTRUCTION

1. INSTALL STABILIZED CONSTRUCTION ENTRANCES
2. POST PUBLIC NOTICE PER DETAILS
3. INSTALL DOWN GRADIENT PERIMETER CONTROLS
4. THE ENTIRE SITE WILL BE GRADED TO DRAIN TO THE PROPOSED PONDS AT ALL TIMES DURING CONSTRUCTION. INSTALL SEDIMENT BASINS PRIOR TO CLEARING REST OF THE SITE. RUNOFF FROM UPLAND BASINS TO THE NORTH AND EAST SHALL BE DIVERTED TO THE EAST AROUND THE SITE.
5. NOTIFY SWPPP COMPLIANCE INSPECTOR OF COMPLETION OF ABOVE.
6. BEGIN SOIL DISTURBING ACTIVITIES
7. PROVIDE TEMPORARY STABILIZATION OF DISTURBED AREAS OR STOCKPILES
8. INSTALL UNDERGROUND UTILITIES
9. START CONSTRUCTION OF BUILDING
10. FINISH GRADING THE SITE
11. PAVE ACCESS DRIVE AISLES AND SIDEWALKS
12. INSTALL LANDSCAPING ON SITE.

GROUND COVER (PRE-CONSTRUCTION)

THE UNDISTURBED AND PRE-CONSTRUCTION GROUND COVER
CONSISTS OF UNCOMPACTED SOIL WITH NATIVE GRASSES, WEEDS,
AND SHRUBS WITH MINIMAL TO NO DISTURBANCES TO GRADING

STORMWATER TEAM MEMBERS:

BMP INSTALLATION, MAINTENANCE AND CORRECTIVE ACTIONS

PHONE: _____

EMAIL: _____

INSPECTIONS NAME:

PHONE: _____

EMAIL: _____

LIST OF OPERATORS:

OPERATOR 1 NAME: _____

PHONE: _____

EMAIL : _____

OPERATOR 2 NAME: _____
PHONE: _____
EMAIL: _____

OPERATOR 3 NAME: _____
PHONE: _____
EMAIL: _____

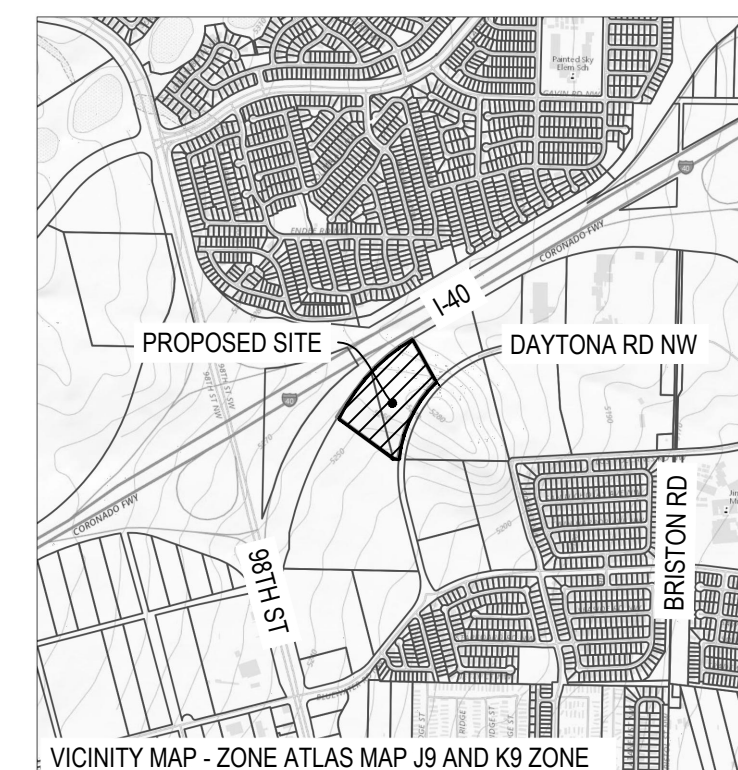

**CALL NM ONE-CALL
SYSTEM SEVEN (7) DAYS
PRIOR TO ANY EXCAVATION**

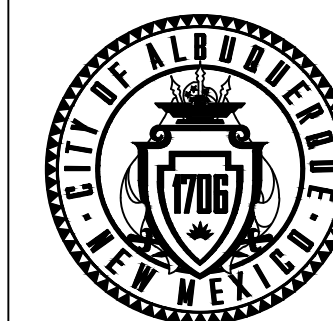

CITY OF ALBUQUERQUE
DEPARTMENT OF MUNICIPAL DEVELOPMENT
ENGINEERING DIVISION

WESTPOINTE DATA CENTER
SOIL EROSION AND SEDIMENT CONTROL
COVER SHEET

DESIGN REVIEW COMMITTEE	CITY ENGINEER APPROVAL	ZONE MAP NO. J-09-Z & K-09-Z
		CITY PROJECT NO. 655779
		SHEET NO. ESC - 001

CONSULTANTS



ACS MONUMENT "7-K9"
RECORD INFORMATION:
NAD 1983 NM SPC CENTRAL ZONE (GRID)
N=1482904.725 (U.S. SURVEY FEET)
E=1496061.706 (U.S. SURVEY FEET)
ELEV=5140.082 (NAVD88, U.S. SURVEY FEET)
G-G=0.999681940
MAPPING ANGLE=-0°16'38.12"



SEAL

[illegible]

DESIGNED BY:	HKK
DRAWN BY:	HKK
CHECKED BY:	JRA
DATE	7/10/2024

NATURE AND EXTENT OF CONSTRUCTION ACTIVITIES

1. **NATURE OF CONSTRUCTION ACTIVITIES:** MASS ROUGH GRADING OF THE SITE, INSTALLATION OF UTILITIES (WATER, SANITARY SEWER, AND STORM) AND PAVING OF INTERNAL DRIVE AISLES ENTRANCES, PARKING AND SIDEWALKS, BUILDING CONSTRUCTION AND LANDSCAPING, AND OFFSITE IMPROVEMENTS.
2. **PROPERTY SIZE:** 10.0 ACRES; **LINEAR ROADWAY CONSTRUCTION:** 0.25 MILES
3. **DISTURBED AREA SIZE:** 9.50 ACRES
4. **MAXIMUM DISTURBED AREA SIZE AT ANY ONE TIME:** 9.50 ACRES
5. **PROJECT SCHEDULE:** SUMMER 2024 - FALL 2025, SEE SEQUENCE OF CONSTRUCTION ON SHEET ESC-001 FOR SCHEDULE TASKS DESCRIPTION.
6. **CONSTRUCTION PHASE:** THE FIRST PHASE OF CONSTRUCTION, CONSISTS OF TRENCHING AND INSTALLING UTILITIES FOR SERVICE AND PAVING ROADWAY AND DRIVEWAY ENTRANCES TO THE PROPERTY.
7. **N.O.T. TERMINATION:** PARCELS ARE EXPECTED TO BE PERMANENTLY STABILIZED PRIOR TO OCCUPANCY.
8. **STABILIZATION MEASURE:** LOCALLY, NON-VEGETATIVE CONTROLS MAY CONSIST OF 2" OR 3" GRAVEL, MULCH MIXED WITH COA WESTSIDE SEED MIX PLACES TO COVER THE PARCEL OR VEGETATIVE CONTROLS MAY BE CRIMP STRAW OR HYDRO-SEED APPLIED WITH THE INTENT OF PROVIDING 70% OR MORE COVERAGE THAT IS PROVIDED BY VEGETATION NATIVE TO LOCAL UNDISTURBED AREAS WITHIN THREE YEARS, TO THE EXTENT NECESSARY TO PREVENT EROSION OF THE SEEDED AREA, NON-VEGETATIVE EROSION CONTROLS HAVE BEEN APPLIED THAT PROVIDE COVER AT LEAST FOR THREE YEARS WITHOUT ACTIVE MAINTENANCES. VEGETATIVE CONTROLS SHOULD BE APPLIED FROM JUNE TO AUGUST TO TAKE ADVANTAGE OF THE AREA'S RAIN SEASON.
9. **CITY WEED REMOVAL ORDINANCE:** PROPERTY OWNERS ARE TO COMPLY WITH THE CITY WEED REMOVAL ORDINANCE.
10. **INSPECTIONS:** SEE ESC PLAN STANDARD NOTE #3, THIS SHEET.

EROSION CONTROL NOTES

1. CONTRACTOR IS RESPONSIBLE FOR OBTAINING A TOPSOIL DISTURBANCE PERMIT FROM THE LOCAL JURISDICTIONAL AUTHORITY PRIOR TO BEGINNING WORK.
2. THE OPERATOR WITH CONTROL OF THE DAILY SITES ACTIVITIES IS RESPONSIBLE FOR MAINTAINING RUN-OFF AND RUN-ON OF THE SITE DURING CONSTRUCTION.
3. THE OPERATOR WITH CONTROL OF THE DAILY SITES ACTIVITIES IS RESPONSIBLE FOR CLEANING ALL SEDIMENT THAT GETS INTO EXISTING RIGHT-OF-WAY. REPAIR OF DAMAGED FACILITIES AND CLEANUP OF SEDIMENT ACCUMULATIONS ON ADJACENT PROPERTIES AND IN PUBLIC FACILITIES IS THE RESPONSIBILITY OF THE CONTRACTOR.
4. ALL EXPOSED EARTH SURFACES MUST HAVE APPROPRIATE CONTROLS TO PROTECT FROM WIND AND WATER EROSION DURING ALL PHASES OF THE PROJECT.
5. STOCKPILES INACTIVE FOR 14 DAYS ARE REQUIRED TO HAVE TEMPORARY STABILIZATION OR APPROPRIATE COVER TO CONTROL WIND AND WATER EROSION.
6. THE OPERATOR WITH CONTROL OF THE DAILY SITES ACTIVITIES IS REQUIRED TO MAINTAIN ALL SITE BMP'S IN GOOD CONDITION FOR THE DURATION OF THE PROJECT UNTIL A NOTICE OF TERMINATION IS ACCEPTED BY THE EPA.
7. IF SITE EARTH DISTURBANCES EXCEED 5 ACRES AT ANY ONE TIME, TEMPORARY AND/OR PERMANENT STABILIZATION MUST BE COMPLETED WITHIN 7 CALENDAR DAYS WHEN AREA BECOMES INACTIVE OR EARTH DISTURBING ACTIVITIES ARE COMPLETE. SITE EARTH DISTURBANCES OF LESS THAN 5 ACRES, HAVE 14 CALENDAR DAYS TO PROVIDE TEMPORARY OR PERMANENT STABILIZATION WHEN AREA BECOMES INACTIVE OR EARTH DISTURBING ACTIVITIES ARE COMPLETE.
8. CONTRACTOR TO COMPLETE VEGETATIVE STABILIZATION IN COMPLIANCE TO THE DEADLINES RELATING TO THE SEASONALLY DRY PERIOD. MONTHS OF JANUARY, FEBRUARY, MAY, JUNE, NOVEMBER, AND DECEMBER ARE CONSIDERED SEASONALLY DRY.
9. SOIL PREPARATION: PREPARE SOIL IN ACCORDANCE WITH NMDOT SPECIFICATIONS.
10. EROSION CONTROL SHALL MEET THE FOLLOWING REQUIREMENTS:
 - A. SILT FENCE: NMDOT SPEC 603 SILT FENCE
 - B. COMPOSTED MULCH SOCK: NMDOT SPEC 603 COMPOSTED MULCH SOCK
 - C. SOIL RETENTION BLANKETS: NMDOT SPEC 603, SOIL RETENTION BLANKET
 - D. PERMANENT SEED: SEE LANDSCAPE PLAN.
 - E. RIPRAP: COA SPEC 109, RIPRAP.
 - F. GEOTEXTILE FOR RIPRAP: NMDOT SPEC 604, GEOTEXTILE FILTER FABRIC CLASS 1

BMP MAINTENANCE

ALL MEASURES STATED IN THIS EROSION AND SEDIMENT CONTROL PLAN SHALL BE MAINTAINED IN FULLY FUNCTIONAL CONDITION UNTIL NO LONGER REQUIRED FOR A COMPLETED PHASE OF WORK OR UNTIL FINAL STABILIZATION OF THE SITE IS ACHIEVED. ALL EROSION AND SEDIMENTATION CONTROL MEASURES SHALL BE INSPECTED AT THE END OF THE WORKDAY BY A QUALIFIED MEMBER OF THE SWPPP COMPLIANCE TEAM. THE OPERATOR WITH CONTROL OF THE SITES DAILY ACTIVITIES IS RESPONSIBLE TO MAINTAIN, CLEAN, AND REPAIR EROSION CONTROLS IN ACCORDANCE WITH THE FOLLOWING:

1. INLET PROTECTION DEVICES AND BARRIERS SHALL BE REPAIRED OR REPLACED, IF THEY SHOW SIGNS OF UNDERMINING OR DETERIORATION. SEDIMENT SHALL BE REMOVED TO ENSURE PROPER FLOWS. INLET PROTECTION TYPES MAY NEED TO BE MODIFIED DURING THE CONSTRUCTION PROGRESS. CLEAN, OR REMOVE AND REPLACE, THE INLET PROTECTION MEASURES AS SEDIMENT ACCUMULATES, THE FILTER BECOMES CLOGGED, AND/OR PERFORMANCE IS COMPROMISED. WHERE THERE IS EVIDENCE OF SEDIMENT ACCUMULATION ADJACENT TO THE INLET PROTECTION MEASURE, REMOVE THE DEPOSITED SEDIMENT BY THE END OF THE SAME BUSINESS DAY IN WHICH IT IS FOUND OR BY THE END OF THE FOLLOWING BUSINESS DAY IF REMOVAL BY THE SAME BUSINESS DAY IS NOT FEASIBLE.
2. ALL SEEDED AREAS SHALL BE CHECKED REGULARLY TO SEE THAT A GOOD STAND OF VEGETATION IS MAINTAINED. AREAS SHOULD BE FERTILIZED, WATERED, AND RE-SEED AS NEEDED.
3. SILT FENCES, WADDLES, OR OTHER PERIMETER CONTROLS SHALL BE REPLACED TO PROPER FUNCTIONING CONDITION, IF DAMAGED. REMOVE SEDIMENT BEFORE IT HAS ACCUMULATED TO ONE-HALF OF THE ABOVE-GROUND HEIGHT OF ANY PERIMETER CONTROL. AFTER A STORM EVENT, IF THERE IS EVIDENCE OF STORMWATER CIRCUMVENTING OR UNDERCUTTING THE PERIMETER CONTROL, EXTEND OR REPAIR UNDERCUT AREAS TO FIX THE PROBLEM.
4. THE CONSTRUCTION EXITS SHALL BE MAINTAINED IN A CONDITION WHICH WILL PREVENT TRACKING OF SEDIMENT INTO PUBLIC OR PRIVATE ROADWAYS. THIS MAY REQUIRE PERIODIC TOP DRESSING, EXTENDING, OR OTHER MODIFICATIONS TO THE CONSTRUCTION EXITS AS CONDITIONS DEMAND. SITE TRAFFIC SHOULD BE LIMITED TO THE CONTROLLED EXITS ONLY. IMPLEMENT ADDITIONAL TRACK-OUT CONTROLS AS NECESSARY TO ENSURE THAT SEDIMENT REMOVAL OCCURS PRIOR TO VEHICLE EXIT. WHERE SEDIMENT HAS BEEN TRACKED-OUT FROM THE SITE ONTO PAVED ROADS, SIDEWALKS, OR OTHER PAVED AREAS OUTSIDE OF THE SITE, REMOVE THE DEPOSITED SEDIMENT BY THE END OF THE SAME BUSINESS DAY IN WHICH THE TRACK-OUT OCCURS OR BY THE END OF THE NEXT BUSINESS DAY IF TRACK-OUT OCCURS ON A NON-BUSINESS DAY. REMOVE THE TRACK-OUT BY SWEEPING, SHOVELING, OR VACUUMING THESE SURFACES, OR BY USING OTHER SIMILARLY EFFECTIVE MEANS OF SEDIMENT REMOVAL. HOSING OR SWEEPING OF ANY TRACKED-OUT SEDIMENT IS PROHIBITED INTO ANY CONSTRUCTED OR NATURAL SITE DRAINAGE FEATURE, STORM DRAIN INLET, OR RECEIVING WATER.
5. SEDIMENTATION BASINS SHALL BE MAINTAINED IN OPERATIONAL CONDITIONS AT ALL TIMES. SEDIMENT SHALL BE REMOVED FROM SEDIMENT BASINS OR TRAPS WHEN THE DESIGN CAPACITY HAS BEEN REDUCED BY 50%.

ESC PLAN STANDARD NOTES

- ALL EROSION AND SEDIMENT CONTROL (ESC WORK) ON THESE PLANS, EXCEPT AS OTHERWISE STATED OR PROVIDED HEREON SHALL BE PERMITTED, CONSTRUCTED, INSPECTED, AND MAINTAINED IN ACCORDANCE WITH:
- 1.1. THE CITY ORDINANCE §14-5-2-11, THE ESC ORDINANCE.
- 1.2. THE EPA'S 2022 CONSTRUCTION GENERAL PERMIT (CGP), AND
- 1.3. THE CITY OF ALBUQUERQUE CONSTRUCTION BMP MANUAL.
2. ALL BMP'S MUST BE INSTALLED PRIOR TO BEGINNING ANY EARTH MOVING ACTIVITIES EXCEPT AS SPECIFIED HEREON IN THE PHASING PLAN. CONSTRUCTION OF EARTHEN BMP'S SUCH AS SEDIMENT TRAPS, SEDIMENT BASINS, AND DIVERSION BERMS SHALL BE COMPLETED AND INSPECTED PRIOR TO ANY OTHER CONSTRUCTION OR EARTHWORK. SELF-INSPECTION IS REQUIRED AFTER INSTALLATION OF THE BMP'S AND PRIOR TO BEGINNING CONSTRUCTION.
3. SELF-INSPECTIONS: IN ACCORDANCE WITH CITY ORDINANCE §14-5-2-11(C)(1), "AT A MINIMUM A ROUTINE COMPLIANCE SELF-INSPECTION IS REQUIRED TO REVIEW THE PROJECT FOR COMPLIANCE WITH THE CONSTRUCTION GENERAL PERMIT ONCE EVERY 14 DAYS AND AFTER ANY PRECIPITATION EVENT OF $\frac{1}{8}$ INCH OR GREATER UNTIL THE SITE CONSTRUCTION HAS BEEN COMPLETED AND THE SITE DETERMINED AS STABILIZATION BY THE CITY. REPORTS OF THESE INSPECTIONS SHALL BE KEPT BY THE PERSON OR ENTITY AUTHORIZED TO DIRECT THE CONSTRUCTION ACTIVITIES ON THE SITE AND MADE AVAILABLE UPON REQUEST."
4. CORRECTIVE ACTION REPORTS MUST BE KEPT BY THE PERSON OR ENTITY AUTHORIZED TO DIRECT THE CONSTRUCTION ACTIVITIES ON THE SITE AND MADE AVAILABLE UPON REQUEST.
5. FINAL STABILIZATION AND NOTICE OF TERMINATION (NOT): IN ACCORDANCE WITH CITY ORDINANCE §14-5-2-11(C)(1), SELF-INSPECTIONS MUST CONTINUE UNTIL THE SITE IS "DETERMINED AS STABILIZED BY THE CITY." THE PROPERTY OWNER/OPERATOR IS RESPONSIBLE FOR DETERMINING WHEN "THE CONDITIONS FOR TERMINATING CGP COVERAGE" PER CGP PART 8.2 ARE SATISFIED AND THEN FOR FILING THEIR NOTICE OF TERMINATION (NOT) WITH THE EPA. EACH OPERATOR MAY TERMINATE CGP COVERAGE ONLY IF ONE OR MORE OF THE CONDITIONS IN PART 8.2.1, 8.2.2, OR 8.2.3 HAS OCCURRED. AFTER FILING THE NOT WITH THE EPA, THE PROPERTY OWNER IS RESPONSIBLE FOR REQUESTING A DETERMINATION OF STABILIZATION FROM THE CITY.
6. WHEN DOING WORK IN THE CITY RIGHT-OF-WAY (E.G. SIDEWALK, DRIVE PADS, UTILITIES, ECT.), PREVENT DIRT FROM GETTING INTO THE STREET. IF DIRT IS PRESENT IN THE STREET, THE STREET SHOULD BE SWEEP DAILY OR PRIOR TO A RAIN EVENT OR CONTRACTOR INDUCED WATER EVENT (E.G. CURB CUT OR WATER TEST).
7. WHEN INSTALLING UTILITIES BEHIND THE CURB, THE EXCAVATED DIRT SHOULD NOT BE PLACED IN THE STREET.
8. WHEN CUTTING THE STREET FOR UTILITIES THE DIRT SHALL BE PLACED ON THE UPHILL SIDE OF THE STREET CUT AND THE AREA SWEEP AFTER THE WORK IS COMPLETE. A WATTLE OR MULCH SOCK MAY BE PLACED AT THE TOE OF THE EXCAVATED DIRT PILE IF SITE CONSTRAINTS DO NOT ALLOW PLACING THE EXCAVATED DIR ON THE UPHILL SIDE OF THE STREET CUT.
9. ESC PLANS MUST SHOW LONGITUDINAL STREET SLOPE AND STREET NAMES. ON STREETS WHERE THE LONGITUDINAL SLOPE IS STEEPER THAN 2.5%, WATTLES/MULCH SOCKS OR J-HOOD SLOTT FENCE SHALL BE SHOWN IN THE FRONT YARD SWALE OR ON THE SIDE OF THE STREET.

GENERAL EROSION NOTES

1. THE OPERATOR IN CONTROL OF DAILY SITE ACTIVITIES SHALL IMPLEMENT BEST MANAGEMENT PRACTICES AS REQUIRED BY THE SWPPP. ADDITIONAL BEST MANAGEMENT PRACTICES SHALL BE IMPLEMENTED AS DICTATED BY CONDITIONS THAT MAY OCCUR AT NO ADDITIONAL COST TO PROJECT OWNER THROUGHOUT ALL PHASES OF CONSTRUCTION.
2. BEST MANAGEMENT PRACTICES (BMP'S) AND CONTROLS SHALL CONFORM TO ALL FEDERAL, STATE, OR LOCAL REQUIREMENTS OR MANUAL OF PRACTICE, AS APPLICABLE. OPERATOR WITH CONTROL OF DAILY SITE ACTIVITIES SHALL IMPLEMENT ADDITIONAL CONTROLS AS DIRECTED BY PERMITTING AGENCY, LOCAL JURISDICTIONAL AUTHORITY, OR SWPPP COMPLIANCE INSPECTOR.
3. THE TEMPORARY EROSION CONTROL AND SEDIMENTATION PLAN IS A WORKING DOCUMENT AND IS REQUIRED TO BE UPDATED WITHIN 24 HOURS OF ANY CHANGES WHEN BMP'S ARE REPAIRED, RELOCATED, OR REMOVED BY NOTING ON THE PLAN THE AREAS AND DATES OF THE REPAIRS, RELOCATIONS, OR REMOVALS. AN ACTIVE COPY OF THE PLAN SHALL BE POSTED IN THE JOB SITE TRAILER ONSITE AND MUST BE MAINTAINED CURRENT AT ALL TIMES.
4. CONTRACTOR SHALL MINIMIZE CLEARING AND EARTH DISTURBANCE TO THE MAXIMUM ACREAGE AS REQUIRED BY THE EPA CONSTRUCTION GENERAL PERMIT.
5. CONTRACTOR SHALL DENOTE ON THIS PLAN, THE LOCATION OF TEMPORARY PARKING, STORAGE, PORTABLE SANITARY FACILITIES, OFFICE TRAILERS, AND ALL SUPPORT AREAS. RELOCATIONS OF EACH SHALL ALSO BE DOCUMENTED AS THEY OCCUR.
6. ALL WASH OUT WATER USED FOR CONCRETE, MASONRY, PAINT AND OTHER MATERIALS SHALL HAVE ADEQUATE SIGNAGE, WITH PROPER CONTAINMENT AND DISPOSED OF PROPERLY WHEN CAPACITY REACHES 50% OR PER VENDOR RECOMMENDATIONS. VENDORS AND TRADESMEN SHALL BE INFORMED OF THE REQUIREMENTS TO USE THE WASH OUT.
7. A SPILL KIT SHALL BE READILY AVAILABLE TO CONTAIN AND CLEAN-UP FUEL OR CHEMICAL SPILLS AND LEAKS. A DISCHARGE OF ANY MATERIAL IN A QUANTITY THAT MAY WITHIN REASONABLE PROBABILITY CAUSE, INJURE, OR BE DETRIMENTAL TO HUMAN HEALTH, ANIMAL, OR PLANT LIFE, OR PROPERTY; OR INTERFERE WITH THE PUBLIC WELFARE MUST BE REPORTED TO THE NEW MEXICO ENVIRONMENTAL DEPARTMENT HOTLINE AT (505) 827-9329 FOR EMERGENCIES OR FOR NON EMERGENCIES AT (866) 428-6535. IF UNSURE IF THE SPILL IS OF A SIGNIFICANT QUANTITY, THE SPILL SHOULD BE REPORTED TO THE HOTLINE AND INFORMATION PROVIDED WITH DETAILS OF THE SPILL FOR FURTHER ACTIONS.
8. DUST DURING CONSTRUCTION OPERATIONS SHALL BE FREQUENTLY CONTROLLED BY WATER SUPPRESSION METHODS ONLY. EARTH DISTURBING OPERATIONS SHALL CEASE IF HIGH WINDS ABOVE 35 MPH ARE PRESENT. THE USE OF MOTOR OILS AND OTHER PETROLEUM BASED OR TOXIC LIQUIDS IS STRICTLY PROHIBITED. OTHER CHEMICALS USED FOR DUST SUPPRESSION MUST BE APPROVED BY THE EPA PRIOR TO THEIR USE.
9. RUBBISH, TRASH, GARBAGE, LITTER, OR OTHER SUCH MATERIALS SHALL BE DEPOSITED INTO SEALED, COVERED, LEAK PROOF CONTAINERS. CONTAINERS SHALL BE DISPOSED OF PROPERLY WHEN CAPACITY IS REACHED. MATERIALS SHALL BE PREVENTED FROM LEAVING THE PREMISES THROUGH THE ACTION OF WIND OR STORMWATER.
10. ALL STORMWATER POLLUTION PREVENTION MEASURES AND CONTROLS PRESENTED ON THIS PLAN SHALL BE INITIATED PER THE SEQUENCE OF CONSTRUCTION AS NOTED.
11. DISTURBED PORTIONS OF THE SITE WHERE CONSTRUCTION ACTIVITY HAS BEEN TEMPORARILY SUSPENDED FOR 14 CALENDAR DAYS SHALL HAVE TEMPORARILY STABILIZATION IN PLACE NO LATER THAN 14 CALENDAR DAYS FROM THE LAST DATE OF CONSTRUCTION ACTIVITY OCCURRING IN THESE AREAS.
12. DISTURBED PORTIONS OF THE SITE WHERE CONSTRUCTION ACTIVITY HAS BEEN PERMANENTLY STOPPED SHALL HAVE PERMANENT CONTROLS IN PLACE NO LATER THAN 14 CALENDAR DAYS AFTER THE LAST CONSTRUCTION ACTIVITY OCCURRING IN THESE AREAS.
13. IF THE ACTION OF VEHICLES OR EQUIPMENTS TRAVELING OVER THE CONSTRUCTION ENTRANCES ARE NOT SUFFICIENT TO REMOVE THE MAJORITY OF DIRT OR MUD FROM LEAVING THE SITE, THEN THE LENGTH OF THE EXIT SHOULD BE EXTENDED TO PROVIDE ADDITIONAL TIRE ROTATIONS, LARGER ROCK MAY BE USED TO CREATE A SUFFICIENT JARRING MOTION OR INSTALL A TIRE WASH OFF WITH A SEDIMENT TRAP BEFORE LEAVING THE SITE.
14. ALL MATERIALS SPILLED, DROPPED, WASHED, OR TRACKED FROM VEHICLES ONTO ROADWAYS OR INTO STORM DRAINS MUST BE REMOVED IMMEDIATELY.
15. THE OPERATOR IN CHARGE OF THE DAILY SITE ACTIVITIES WILL BE RESPONSIBLE FOR REMOVING SEDIMENT OR SOILS ACCUMULATING MORE THAN 50% OF THE DESIGN CAPACITY IN DETENTION PONDS, SILT FENCING, OR OTHER SIMILAR EROSION CONTROLS.
16. ON-SITE & OFF-SITE SOIL STOCKPILE AND BORROW AREAS SHALL BE PROTECTED FROM EROSION AND SEDIMENTATION THROUGH IMPLEMENTATION OF BEST MANAGEMENT PRACTICES, AS REQUIRED PER THE CONSTRUCTION GENERAL PERMIT. STOCKPILE AND BORROW AREA LOCATIONS SHALL BE NOTED ON THE ESC PLAN AND PERMITTED IN ACCORDANCE WITH LOCAL AUTHORITIES HAVING JURISDICTIONAL CONTROL.
17. SLOPES SHALL BE LEFT WITH CROSS SLOPE GRADING PATTERN AND IN A ROUGHENED CONDITION DURING THE GRADING PHASE TO REDUCE RUNOFF VELOCITIES AND EROSION RILLS. EXCESSIVE SLOPES MAY REQUIRE ADDITIONAL INDUSTRY STANDARD CONTROLS TO PREVENT EROSION.
18. DUE TO THE GRADE CHANGES DURING THE DEVELOPMENT OF THE PROJECT, THE OPERATOR IN CONTROL OF THE SITE'S DAILY ACTIVITIES SHALL BE RESPONSIBLE FOR ADJUSTING AND MAINTAINING ALL EROSION CONTROL TO PREVENT EROSION.
19. ALL DISTURBED AREAS SHALL BE SUPPRESSED BY WATER AND ALL CONTROLS LEFT IN GOOD WORKING CONDITION AT THE END OF EACH WORKING DAY, THIS INCLUDES REPLACEMENT OF SILT FENCING AND/OR SURFACE CONTROLS, TRACK OUT SWPT CLEAN, BACKFILL OF OPEN TRENCHES AND ANY OTHER EROSION CONTROLS.



**CALL NM ONE-CALL
SYSTEM SEVEN (7) DAYS
PRIOR TO ANY EXCAVATION**

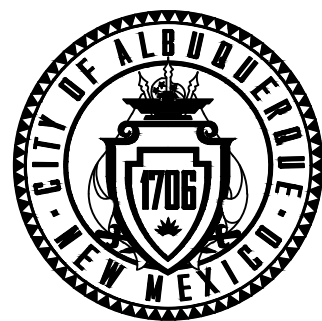

CITY OF ALBUQUERQUE
DEPARTMENT OF MUNICIPAL DEVELOPMENT
ENGINEERING DIVISION

WESTPOINTE DATA CENTER
SOIL AND EROSION SEDIMENT CONTROL
NOTES

DESIGN REVIEW COMMITTEE

CITY ENGINEER APPROVAL

ZONE MAP NO.
J-09-Z & K-09-Z

CITY PROJECT NO.
655779

SHEET NO. ESC - 002

\\US0242-PPFSS01\SHARED_PROJECTS\193806697\5_DESIGN\1_CAD\ROADWAY PLANS\PLANSHEETS\C-202 ESC PLAN.DWG

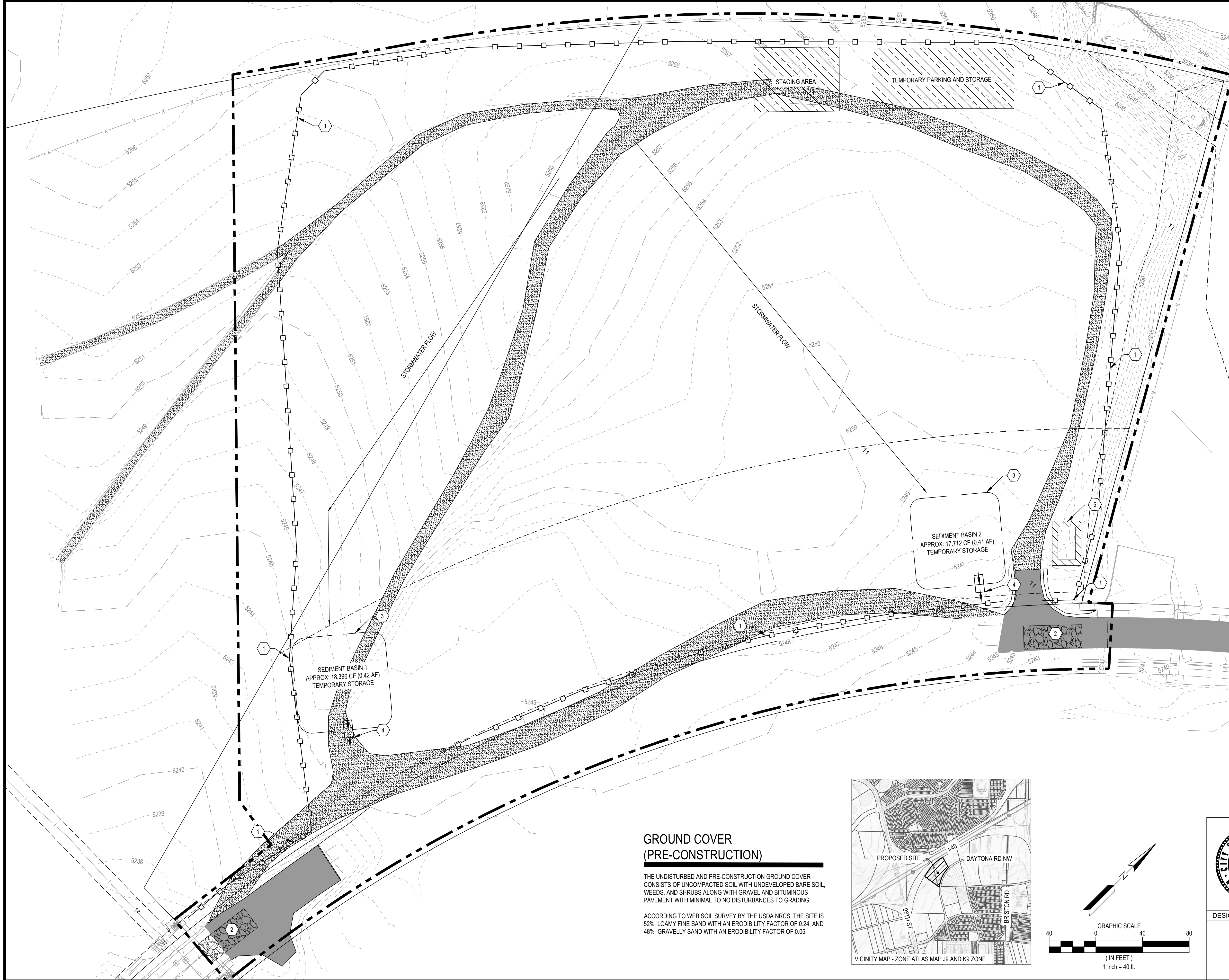

GROUND COVER (PRE-CONSTRUCTION)

THE UNDISTURBED AND PRE-CONSTRUCTION GROUND COVER CONSISTS OF UNCOMPACTED SOIL WITH UNDEVELOPED BARE SOIL, WEEDS, AND SHRUBS ALONG WITH GRAVEL AND BITUMINOUS PAVEMENT WITH MINIMAL TO NO DISTURBANCES TO GRADING.

ACCORDING TO WEB SOIL SURVEY BY THE USDA NRCS, THE SITE IS 52% LOAMY FINE SAND WITH AN ERODIBILITY FACTOR OF 0.24, AND 48% GRAVELLY SAND WITH AN ERODIBILITY FACTOR OF 0.05.

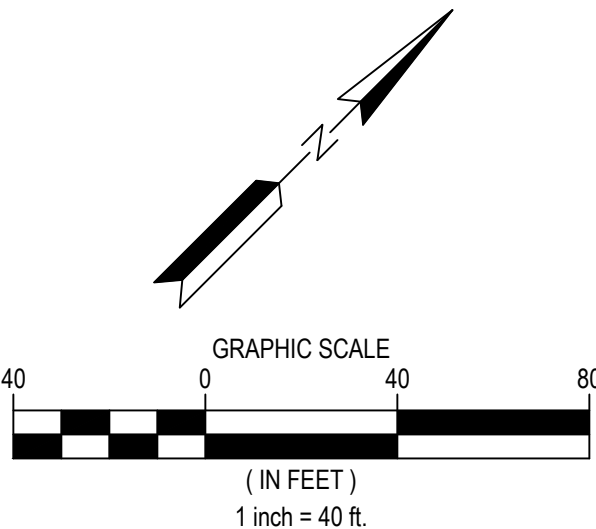
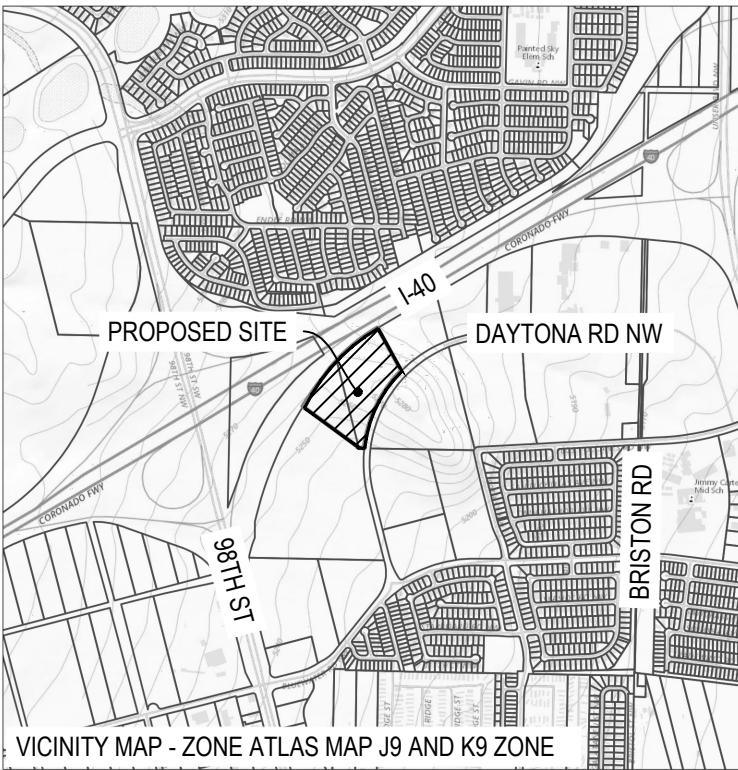

LEGEND

-
- PROPERTY BOUNDARY
- LOT LINE
- EASEMENT LINE
- RIGHT OF WAY LINE
- SECTION LINE
- QUARTER LINE
- 901
- EXISTING MINOR CONTOUR
- 900
- EXISTING MAJOR CONTOUR
- CONSTRUCTION LIMITS
- EXISTING ASPHALT SURFACE
- EXISTING GRAVEL SURFACE
- ROCK CONSTRUCTION EXIT
- SILT FENCE
- TEMPORARY SEDIMENT TRAP DISCHARGE

NOTES

1. SEE SHEET ESC-002 FOR ADDITIONAL PROJECT NOTES.
2. CONSTRUCTION SITE SHALL HAVE STABILIZED ECT AT ALL TIMES THROUGHOUT THE DURATION OF THE PROJECT. CONTRACTOR IS ULTIMATELY RESPONSIBLE TO PROTECT DOWNSTREAM WATERS FROM CONSTRUCTION RUNOFF.
3. UNTRENCHED SILT FENCE OR ORANGE SNOW FENCE MAY BE USED FOR TREE PROTECTION.
4. CONSTRUCTION LIMITS AND SILT FENCE ARE SHOWN OFFSET FROM PROPERTY LINE FOR CLARITY, WHERE APPLICABLE.
5. CLEAR AND GRUB AS NEEDED WITHIN LIMITS OF DISTURBANCE.
6. EXISTING UTILITY SERVICE LINES MAY NOT BE SHOWN IN THEIR ENTIRETY ON PLANS. CONTRACTOR TO VERIFY LOCATIONS OF EXISTING UTILITY SERVICE LINES WITHIN THE LIMITS OF DISTURBANCE AND REMOVE EXISTING INFRASTRUCTURE AS NECESSARY TO INSTALL PROPOSED IMPROVEMENTS.
7. CONTRACTOR SHALL EVALUATE LIMITS OF REMOVAL FOR PROPOSED UTILITY INSTALLATION. IN THE EVENT THAT CURB AND PAVEMENT ARE IMPACTED IN ADDITION TO THE SIDEWALK, CONTRACTOR SHALL REPLACE EXISTING CURB AND PAVEMENT TO MATCH EXISTING CONDITIONS PER CITY STANDARDS AND REQUIREMENTS AT NO ADDITIONAL COST TO THE OWNER.
6. SEDIMENT BASIN SIZING WAS BASED ON 3,600 CF OF LIVE STORAGE PER ACRE OF THE BASINS' DRAINAGE AREA.
 - 6.1. SEDIMENT BASIN 1 SHALL PROVIDE APPROXIMATELY 0.42 AC-FT OF TEMPORARY SEDIMENT STORAGE FOR APPROXIMATELY 5.11 ACRES OF RUNOFF.
 - 6.2. SEDIMENT BASIN 2 SHALL PROVIDE APPROXIMATELY 0.41 AC-FT OF TEMPORARY SEDIMENT STORAGE FOR APPROXIMATELY 4.92 ACRES OF RUNOFF.
 - 6.2. TEMPORARY BASINS SHALL DISCHARGE TO THE EXISTING DRAINAGE DITCH USING OUTLET. SEE DETAILS.
 - 6.3. CONTRACTOR MAY MODIFY LOCATION, SIZE, AND DISCHARGE OF TEMPORARY SEDIMENT BASIN AND DIVERSION DITCHES AS SITE CONDITIONS DICTATE DURING CONSTRUCTION. SEDIMENT BASIN AND DIVERSION DITCHES ARE SHOWN GENERALLY. IT IS THE CONTRACTOR'S RESPONSIBILITY TO ENSURE A QUALIFIED INDIVIDUAL MUST COMPLETE ALL CHANGES TO THE SWPPP AND BASIN / DITCH PLACEMENT AND SIZING. TEMPORARY BMP'S MUST MEET THE REQUIREMENTS OF THE CONSTRUCTION GENERAL PERMIT AT ALL TIMES.
 - 6.4. TEMPORARY SEDIMENT BASINS SHALL HAVE EMERGENCY OVERFLOW RIPRAP. SEE DETAIL.

KEYNOTES

1. SILT FENCE - SEE DETAIL 1/005
2. STABILIZED ROCK CONSTRUCTION EXIT - SEE DETAIL 2/005
3. TEMPORARY SEDIMENT BASIN - SEE DETAIL 4/005
4. TEMPORARY STORM PIPE FOR OVERFLOW OF THE
TEMPORARY SEDIMENT BASIN - SEE DETAIL 4/005
5. CONCRETE WASH OUT PIT



**CALL NM ONE-CALL
SYSTEM SEVEN (7) DAYS
PRIOR TO ANY EXCAVATION**

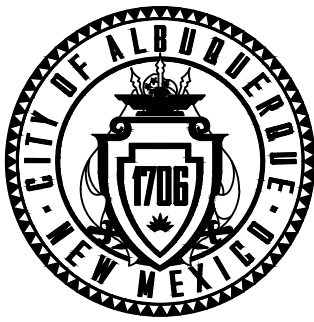

CITY OF ALBUQUERQUE
DEPARTMENT OF MUNICIPAL DEVELOPMENT
ENGINEERING DIVISION

WESTPOINTE DATA CENTER
SOIL EROSION AND SEDIMENT CONTROL
PRE-CONSTRUCTION PLAN

DESIGN REVIEW COMMITTEE

CITY ENGINEER APPROVAL

ZONE MAP NO.
J-09-Z & K-09-Z

CITY PROJECT NO.
655779

SHEET NO. ESC - 003

CONSULTANTS

BENCHMARKS

SEAL

		NO.	DATE	DESCRIPTION	BY
AS-BUILT INFORMATION				CONTRACTOR:	
WORK STAKED BY:					DATE:
INSPECTOR'S ACCEPTANCE BY:					DATE:
FIELD VERIFICATION BY:					DATE:

DESIGNED BY: HKK

DRAWN BY: HKK

CHECKED BY: JRA

DATE 7/10/2024



ACS MONUMENT "7-K9"
 RECORD INFORMATION:
 NAD 1983 NM SPC CENTRAL ZONE (GRID)
 N=1482904.725 (U.S. SURVEY FEET)
 E=1496061.706 (U.S. SURVEY FEET)
 ELEV=5140.082 (NAVD88, U.S. SURVEY FEET)
 G-G=0.999681940
 MAPPING ANGLE=-0°16'38.12"



\\US202-PPF5501\SHARED_PROJECTS\63866697\5_DESIGN\1_CAD\ROADWAY\PLANS\SHEETS\C-092 ESC PLAN.DWG

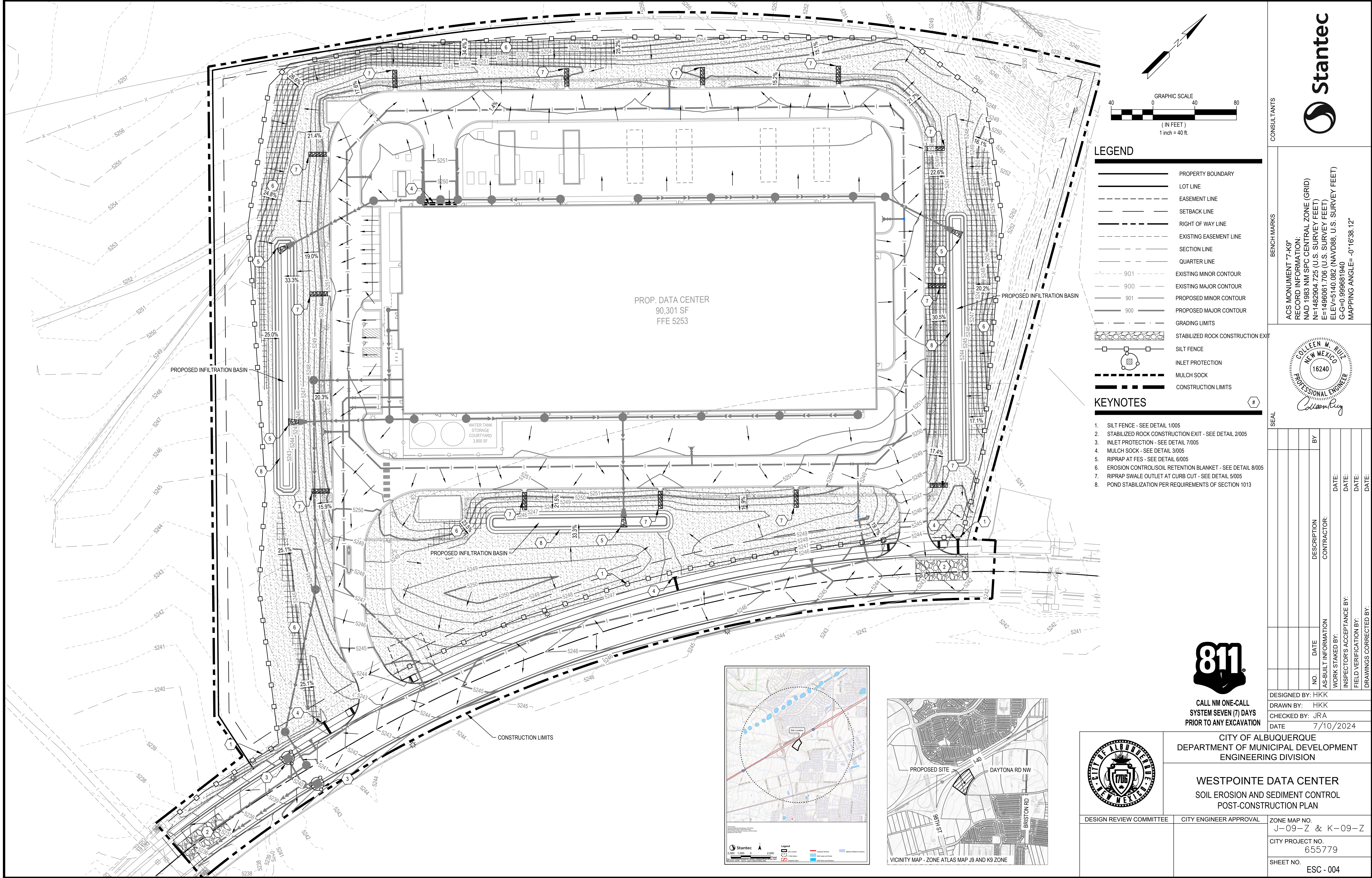



1. FILTER FABRIC SHALL BE PLACED UNDER ROCK TO STOP MUD MIGRATION THROUGH ROCK.
2. ENTRANCE MUST BE MAINTAINED TO PREVENT SEDIMENTATION ON PUBLIC ROADWAYS.
3. FUGITIVE ROCKS SHALL BE REMOVED FROM ADJACENT ROADWAYS DAILY OR MORE FREQUENTLY AS NECESSARY.



NOTE: IF PLACED ON PAVED SURFACE, DO NOT STAKE INTO SURFACE.
CONTRACTOR SHALL ENSURE MULCH SOCK IS PROPERLY FUNCTIONING AT
LEAST DAILY AND AS REQUIRED BY THE SWPPP/NPDES PERMIT, IF
APPLICABLE.



II. SECTION A-A

III. BASIN EMERGENCY OVERFLOW



1. BASIN USED FOR 10 ACRES DRAINAGE AREA OR MORE.
2. DESIGN RUNOFF VOLUME IS FROM A 2-YR, 24-HR STORM PER ACRE DRAINED TO THE BASIN. BASIN VOLUME MUST BE A MIN. OF 3600 CUBIC FEET/ACRE.
3. SEE PLANS/SPECIFICATIONS FOR BASIN DIMENSIONS AND PIPE SIZE AND SLOPE



RIPRAP REQUIREMENTS PER COA SPEC 109	
30" TO 36"	8-10 CUBIC YARDS TYPE 1
42" TO 48"	12-14 CUBIC YARDS TYPE 1
12" TO 18"	16-24 CUBIC YARDS TYPE 1
21" TO 27"	30-38 CUBIC YARDS TYPE 1
54" AND UP	62&UP CUBIC YARDS TYPE 1

(ONE CUBIC YARD IS APPROXIMATELY 2,800 LBS.)



1. FILTER BLANKET REQUIRED UNDER RIPRAP OR 2 LAYERS OF 500X MIRAFI FABRIC OR EQUAL.
2. ONLY GRANITE RIPRAP TO BE USED AT OUTLETS.
3. GRADE A SWALE ADJACENT TO BOTH SIDES OF PIPE TO DIRECT WATER AWAY FROM FES.



WIMCO ROAD DRAIN CG-3067 HIGH FLOW
INLET PROTECTION CURB AND GUTTER
MODEL OR APPROVED EQUAL.

DEFLECTOR PLATE

OVERFLOW IS 1/2 OF THE
CURB BOX HEIGHT

7 INLET PROTECTION CATCH BASIN INSERT
002 NOT TO SCALE

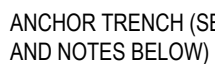

STAPLE DENSITY SHALL BE A MINIMUM OF 3 U-SHAPED 8", 11 GAUGE METAL STAPLES PER SQUARE YARD (THIS MAY VARY AS DIRECTED BY THE CITY)

ISOMETRIC



ANCHOR TRENCH INSTALLATION:

1. DIG 6" X 6" TRENCH
2. LAY BLANKET IN TRENCH
3. STAPLE AT 1.5' INTERVALS
4. BACKFILL WITH NATURAL SOIL AND COMPACT

8 SOIL RETENTION BLANKET INSTALLATION
002 NOT TO SCALE

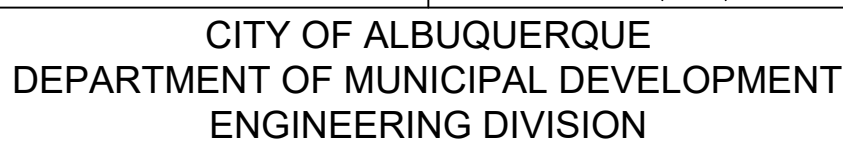
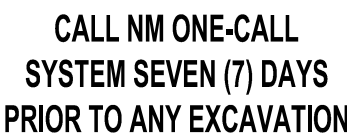

WESTPOINTE DATA CENTER

SOIL AND EROSION SEDIMENT CONTROL DETAILS

DESIGN REVIEW COMMITTEE	CITY ENGINEER APPROVAL	ZONE MAP NO. J-09-Z & K-09-Z
		CITY PROJECT NO. 655779
		SHEET NO. ESC - 005

CONSULTANTS

BENCHMARKS

ACS MONUMENT "7-K9"
RECORD INFORMATION:
NAD 1983 NM SPC CENTRAL ZONE (GRID)

N=1482904.725 (U.S. SURVEY FEET)
E=1496061.706 (U.S. SURVEY FEET)
ELEV=5140.082 (NAVD88, U.S. SURVEY FEET)
G-G=0.999681940
MAPPING ANGLE= -0°16'38.12"



SEAL

[illegible]

DESIGNED BY: HKK

DRAWN BY: HKK

DRAWN BY: HIRK

CHECKED BY: JRA
DATE 7/10/2024