

CITY OF ALBUQUERQUE

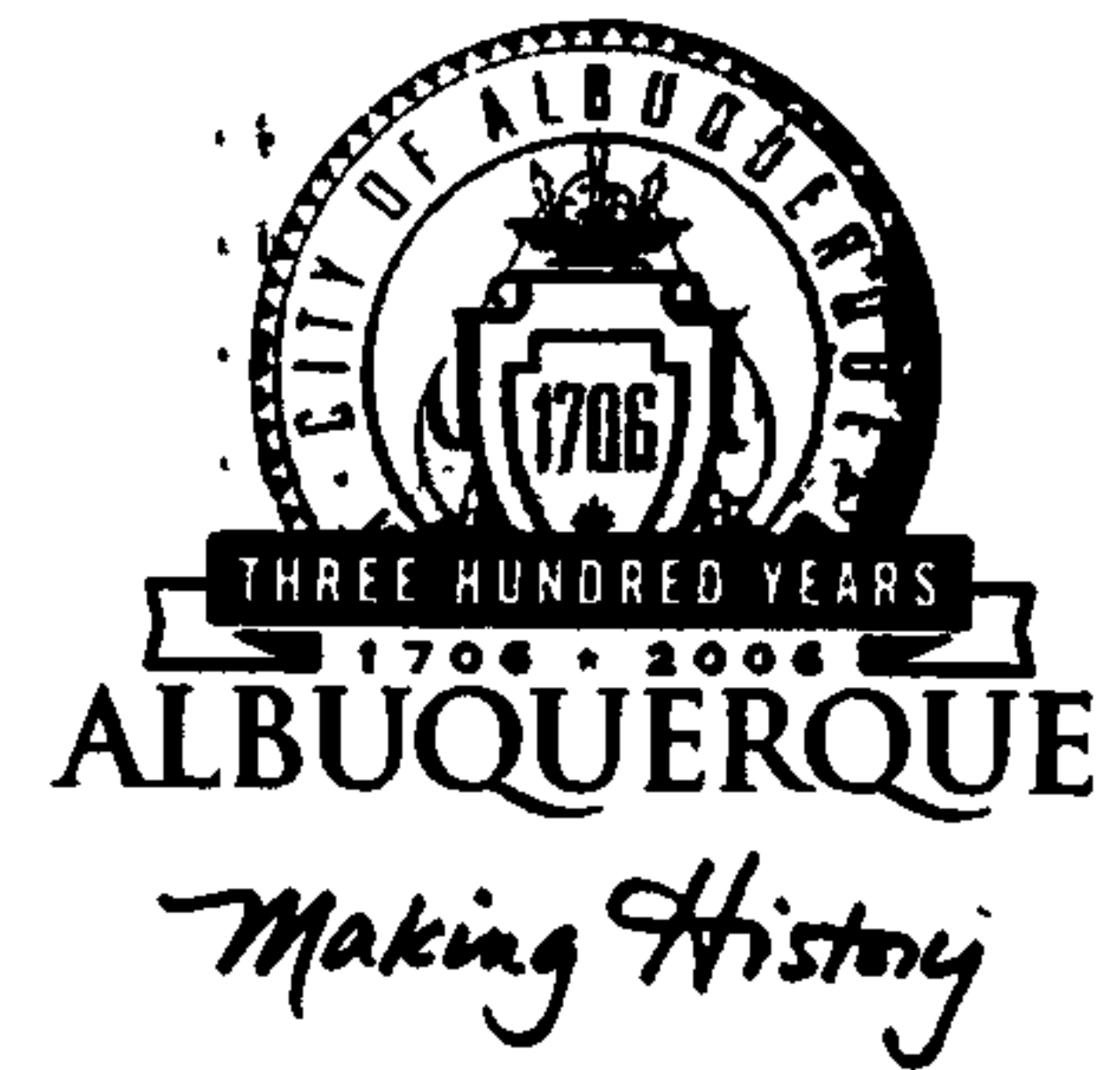

December 2, 2004

Mr. Lyle Losack, PE
QUIK DRAW
P.O. Box 729
Corrales, NM 82048

Re: JEHOVAH'S WITNESS KINGDOM HALL
8600 Los Volcanes Road NE
Approval of Temporary Certificate of Occupancy (C.O.)
Engineer's Stamp dated 09/14/2004 (K-9/D28)
Certification dated 12/02/2004

Dear Lyle,

P.O. Box 1293

Based upon the information provided in your submittal received 12/02/2004, the above referenced certification is approved for release of 30-day Temporary Certificate of Occupancy by Hydrology.

Albuquerque

Upon completion of the listed items in your Engineer's Drainage Certification, please resubmit an updated certification.

New Mexico 87103

If you have any questions, you can contact me at 924-3982.

Sincerely,

Arlene V. Portillo
Plan Checker, Planning Dept. - Hydrology
Development and Building Services

www.cabq.gov

C: Phyllis Villanueva
File

Jehovah's Kingdom Hall
DRAINAGE AND TRANSPORTATION INFORMATION SHEET
(REV. 1/28/2003rd)

PROJECT TITLE: WEST CONGREGATIONAL KINGDOM HALL ZONE MAP/DRG. FILE #: K-9/D28
DRB #: _____ EPC#: _____ WORK ORDER#: _____

LEGAL DESCRIPTION: _____
CITY ADDRESS: 8600 Westside Ln Los Volcanes

ENGINEERING FIRM: _____
ADDRESS: _____
CITY, STATE: _____

CONTACT: _____
PHONE: _____
ZIP CODE: _____

OWNER: TRUSTEE Richard Olgun
ADDRESS: 2231 Pajaro
CITY, STATE: ALB MD

CONTACT: _____
PHONE: _____
ZIP CODE: _____

ARCHITECT: QDC
ADDRESS: PO Box 729
CITY, STATE: Casa de NM 87008

CONTACT: _____
PHONE: _____
ZIP CODE: _____

SURVEYOR: _____
ADDRESS: _____
CITY, STATE: _____

CONTACT: _____
PHONE: _____
ZIP CODE: _____

CONTRACTOR: _____
ADDRESS: _____
CITY, STATE: _____

CONTACT: _____
PHONE: _____
ZIP CODE: _____

CHECK TYPE OF SUBMITTAL:

- _____ DRAINAGE REPORT
- _____ DRAINAGE PLAN 1st SUBMITTAL, *REQUIRES TCL or equal*
- _____ DRAINAGE PLAN RESUBMITTAL
- _____ CONCEPTUAL GRADING & DRAINAGE PLAN
- _____ GRADING PLAN
- _____ EROSION CONTROL PLAN
- ☒ ENGINEER'S CERTIFICATION (HYDROLOGY)
- _____ CLOMR/LOMR
- _____ TRAFFIC CIRCULATION LAYOUT (TCL)
- _____ ENGINEERS CERTIFICATION (TCL)
- _____ ENGINEERS CERTIFICATION (DRB APPR. SITE PLAN)
- _____ OTHER

CHECK TYPE OF APPROVAL SOUGHT:

- _____ SIA / FINANCIAL GUARANTEE RELEASE
- _____ PRELIMINARY PLAT APPROVAL
- _____ S. DEV. PLAN FOR SUB'D. APPROVAL
- _____ S. DEV. PLAN FOR BLDG. PERMIT APPROVAL
- _____ SECTOR PLAN APPROVAL
- _____ FINAL PLAT APPROVAL
- _____ FOUNDATION PERMIT APPROVAL
- _____ BUILDING PERMIT APPROVAL
- _____ CERTIFICATE OF OCCUPANCY (PERM.)
- ☒ CERTIFICATE OF OCCUPANCY (TEMP.)
- _____ GRADING PERMIT APPROVAL
- _____ PAVING PERMIT APPROVAL
- _____ WORK ORDER APPROVAL
- _____ OTHER (SPECIFY)

WAS A PRE-DESIGN CONFERENCE ATTENDED:

- _____ YES
- _____ NO
- _____ COPY PROVIDED

DATE SUBMITTED: 12/2/04 BY: Robert Olgun

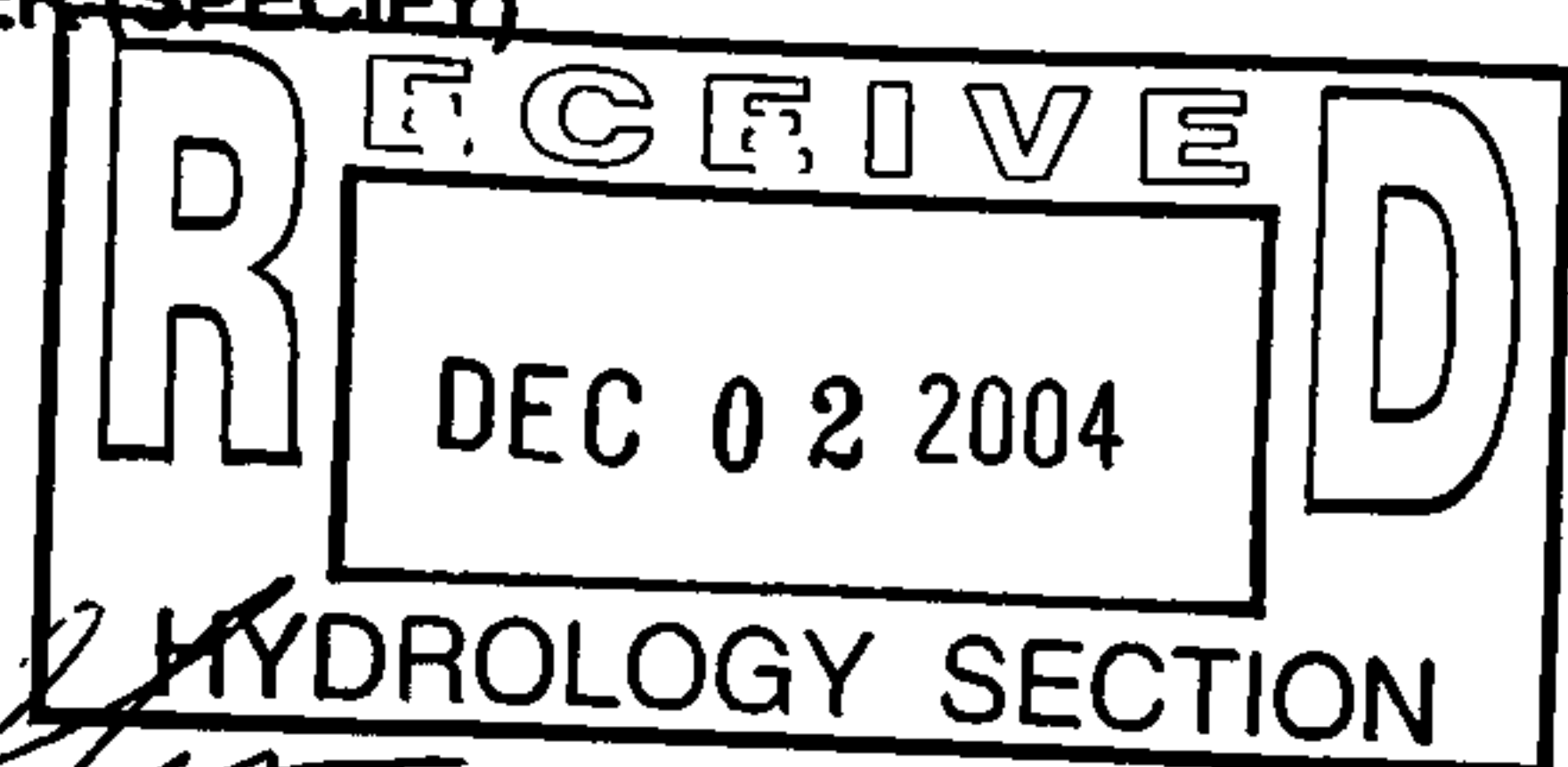

Requests for approvals of Site Development Plans and/or Subdivision Plats shall be accompanied by a drainage submittal. The particular nature, location and scope of the proposed development defines the degree of drainage detail. One or more of the following levels of submittal may be required based on the following:

1. **Conceptual Grading and Drainage Plan:** Required for approval of Site Development Plans greater than five (5) acres and Sector Plans.
2. **Drainage Plans:** Required for building permits, grading permits, paving permits and site plans less than five (5) acres.
3. **Drainage Report:** Required for subdivisions containing more than ten (10) lots or constituting five (5) acres or more.



**QuikDraw
Engineering, L.L.C.**

Post Office Box 729

Corrales, New Mexico 87048

505-898-0389WK 505-

8970389FAX

quikdrawengr@aol.com

cell 604 9419

December 1, 2004

Richard Olguin
Olguin's Custom Homes
2231 Pajarito Road, SW
Albuquerque, NM 87105

(505) 720-7087 Cell
(505) 873-9255 Fax

Re: Construction Acceptance Letter

Jehovah Witness Kingdom Hall located at 8600 Los Volcanos Road NW

I, Lyle C. Losack, P.E., a Registered Engineer in the State of New Mexico, observed the Construction, Grading & Drainage for the Jehovah Witness Kingdom Hall located on Los Volcanos Road NW on December 1, 2004. I found it to be acceptable and recommend that a permanent CO be issued. I also observed the general construction of the building and found it to be in accordance with the applicable Federal, State and local codes.

Please do not hesitate to contact me if you have any questions regarding this matter.

Respectfully submitted,

Lyle C. Losack, P.E.
Owner

C: File

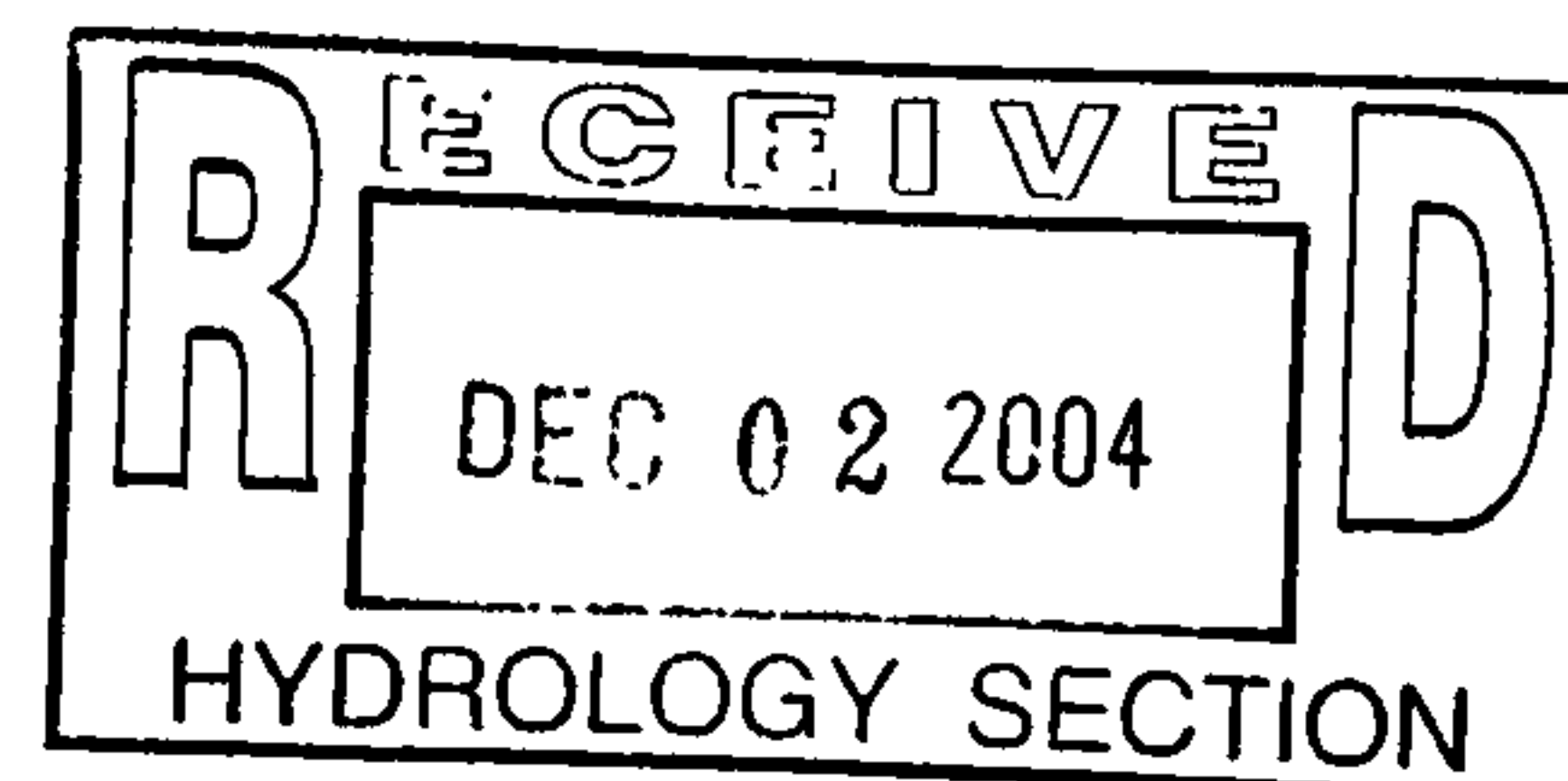

Verbal - issued 30 day Temp C.O.
12/2/04

QuikDraw
Engineering, L.L.C.
Post Office Box 729
Corrales, New Mexico 87048
505-898-0389WK 505-
8970389FAX
quikdrawengr@aol.com

January 4, 2005

City of Albuquerque
Traffic Development Section

Re: Construction Acceptance Letter to obtain FINAL C.O.
Job: Jehovah Witness Kingdom Hall located at 8600 Los Volcanos Road, NW

I, Lyle C. Losack P.E., a Registered Engineer in the State of New Mexico, observed the traffic improvements for the Jehovah Witness Kingdom Hall located on Los Volcanos Road, NW on January 3, 2005. I observed that it is complete. I found the construction to be acceptable and I recommend that a Final C.O. to be issued.

Please do not hesitate to contact me if you have any questions regarding this matter.

Respectfully Submitted,

Lyle C. Losack, P.E.
Owner

C: file

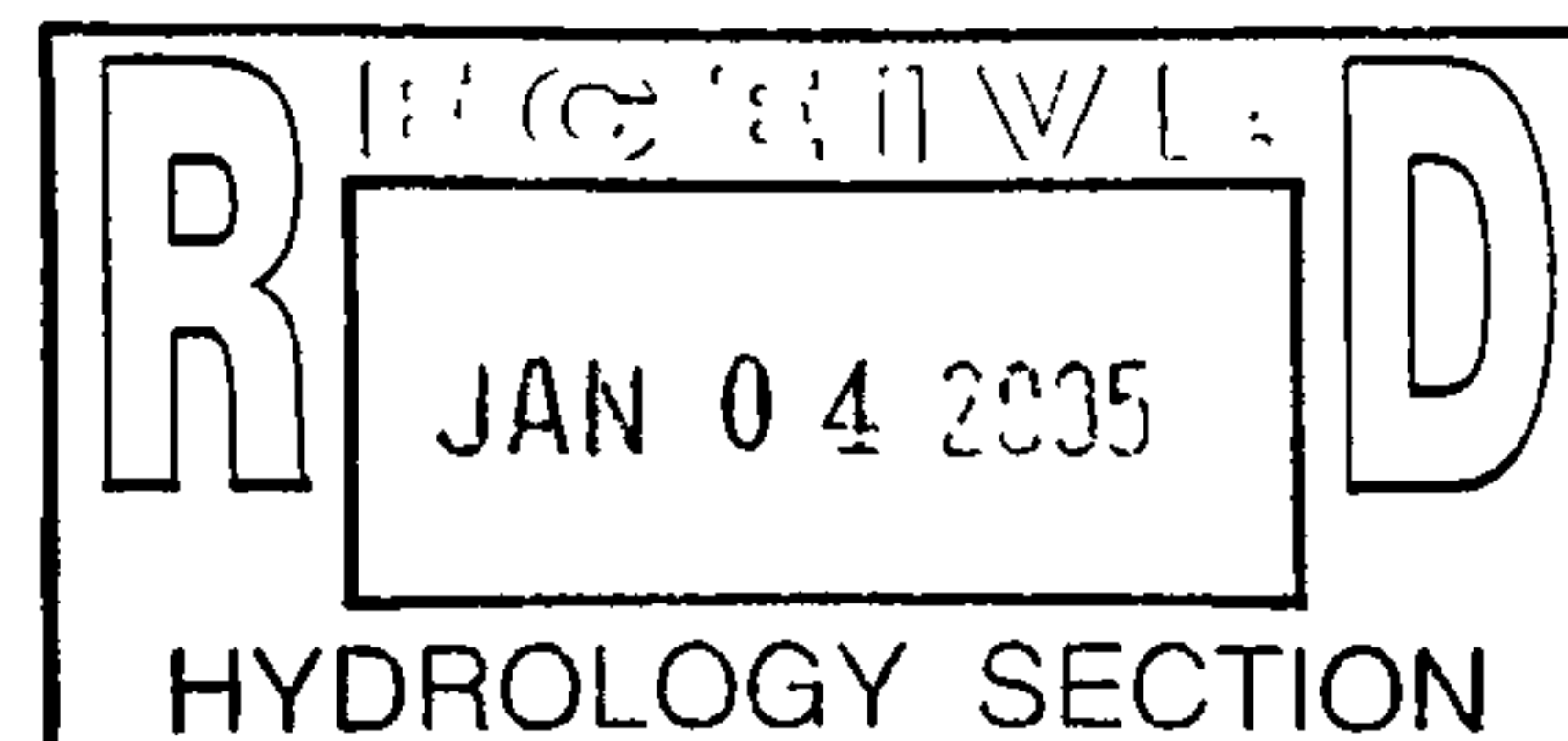

QuikDraw
Engineering, L.L.C.
Post Office Box 729
Corrales, New Mexico 87048
505-898-0389WK 505-
8970389FAX
quikdrawengr@aol.com

January 4, 2005

City of Albuquerque
Hydrology & Transportation Development Section

(505) 924-3630

Re: Construction Acceptance Letter to obtain FINAL C.O.
Jehovah Witness Kingdom Hall located at 8600 Los Volcanos Road NW

I, Lyle C. Losack, P.E., a Registered Engineer in the State of New Mexico, observed the overall Site, Grading & Drainage for the Jehovah Witness Kingdom Hall located on Los Volcanos Road NW on January 4, 2005. I observed that it is complete. I found the construction to be acceptable and I recommend that a FINAL CO to be issued.

Please do not hesitate to contact me if you have any questions regarding this matter.

Respectfully submitted,

Lyle C. Losack, P.E.
Owner

C: File

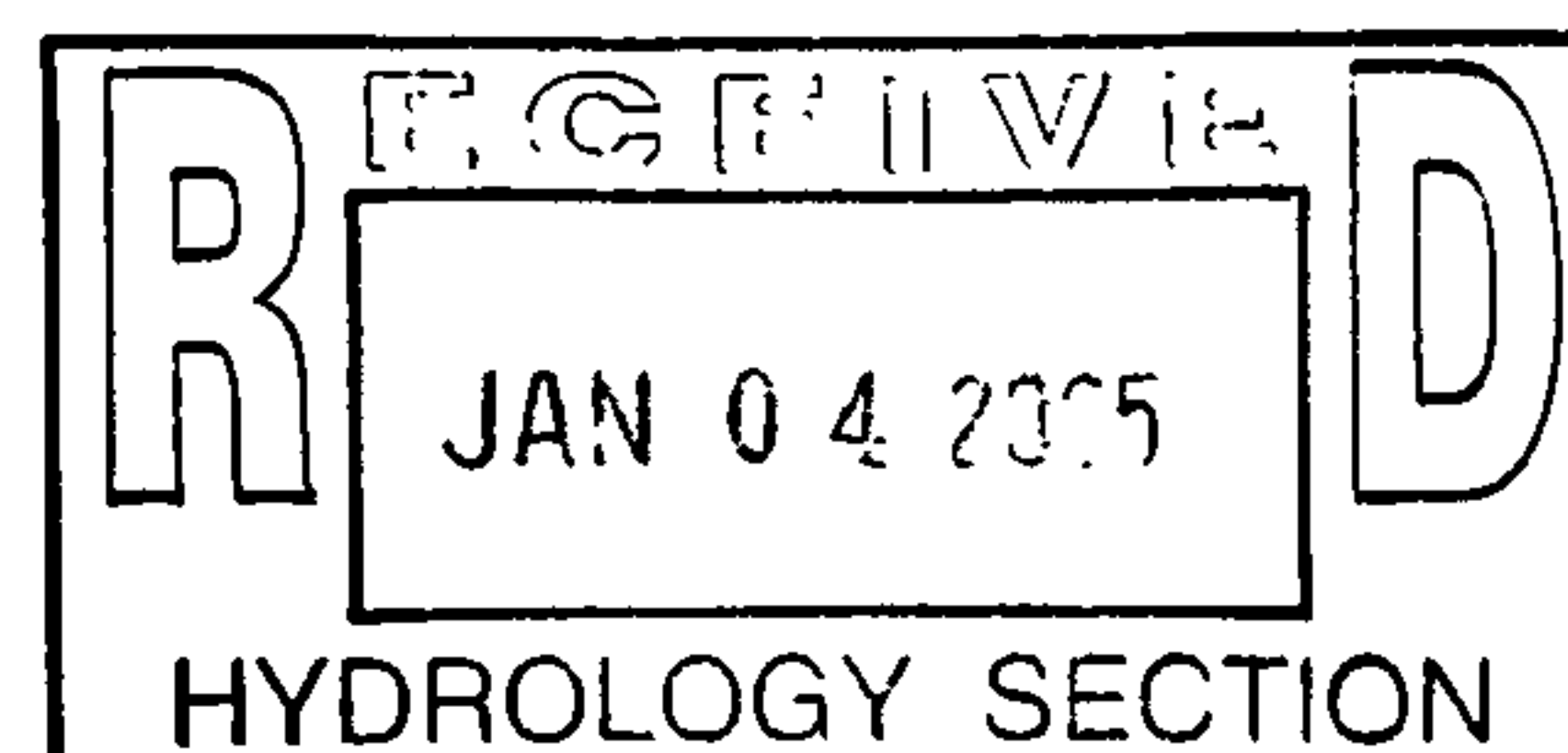

DRAINAGE AND TRANSPORTATION INFORMATION SHEET

(REV. 1/28/2003rd)

PROJECT TITLE: West Congregation Kingdom Hall ZONE MAP/DRG. FILE #: K-9/D28
DRB #: _____ EPC#: _____ WORK ORDER#: _____

LEGAL DESCRIPTION: 8600 Los Volcanes NW
CITY ADDRESS: _____

ENGINEERING FIRM: Quick Draw Engineering LLC
ADDRESS: PO Box 229
CITY, STATE: Cerritos NM

CONTACT: Lyle Losack
PHONE: 898-0389
ZIP CODE: _____

OWNER: Trustee - Richard Ohguri
ADDRESS: 2231 Pajarito
CITY, STATE: Alb NM 87105

CONTACT: Richard Ohguri
PHONE: 720 70870
ZIP CODE: _____

ARCHITECT: _____
ADDRESS: _____
CITY, STATE: _____

CONTACT: _____
PHONE: _____
ZIP CODE: _____

SURVEYOR: _____
ADDRESS: _____
CITY, STATE: _____

CONTACT: _____
PHONE: _____
ZIP CODE: _____

CONTRACTOR: _____
ADDRESS: _____
CITY, STATE: _____

CONTACT: _____
PHONE: _____
ZIP CODE: _____

CHECK TYPE OF SUBMITTAL:

- ☐ DRAINAGE REPORT
- ☐ DRAINAGE PLAN 1st SUBMITTAL, *REQUIRES TCL or equal*
- ☐ DRAINAGE PLAN RESUBMITTAL
- ☒ CONCEPTUAL GRADING & DRAINAGE PLAN
- ☒ GRADING PLAN
- ☐ EROSION CONTROL PLAN
- ☐ ENGINEER'S CERTIFICATION (HYDROLOGY)
- ☐ CLOMR/LOMR
- ☐ TRAFFIC CIRCULATION LAYOUT (TCL)
- ☐ ENGINEERS CERTIFICATION (TCL)
- ☐ ENGINEERS CERTIFICATION (DRB APPR. SITE PLAN)
- ☐ OTHER

CHECK TYPE OF APPROVAL SOUGHT:

- ☐ SIA / FINANCIAL GUARANTEE RELEASE
- ☐ PRELIMINARY PLAT APPROVAL
- ☐ S. DEV. PLAN FOR SUB'D. APPROVAL
- ☐ S. DEV. PLAN FOR BLDG. PERMIT APPROVAL
- ☐ SECTOR PLAN APPROVAL
- ☐ FINAL PLAT APPROVAL
- ☐ FOUNDATION PERMIT APPROVAL
- ☒ BUILDING PERMIT APPROVAL
- ☒ CERTIFICATE OF OCCUPANCY (PERM.)
- ☐ CERTIFICATE OF OCCUPANCY (TEMP.)
- ☐ GRADING PERMIT APPROVAL
- ☐ PAVING PERMIT APPROVAL
- ☐ WORK ORDER APPROVAL
- ☐ OTHER (SPECIFY)

WAS A PRE-DESIGN CONFERENCE ATTENDED:

- ☐ YES
- ☐ NO
- ☐ COPY PROVIDED

DATE SUBMITTED: 1-4-04 BY: Lyle Losack

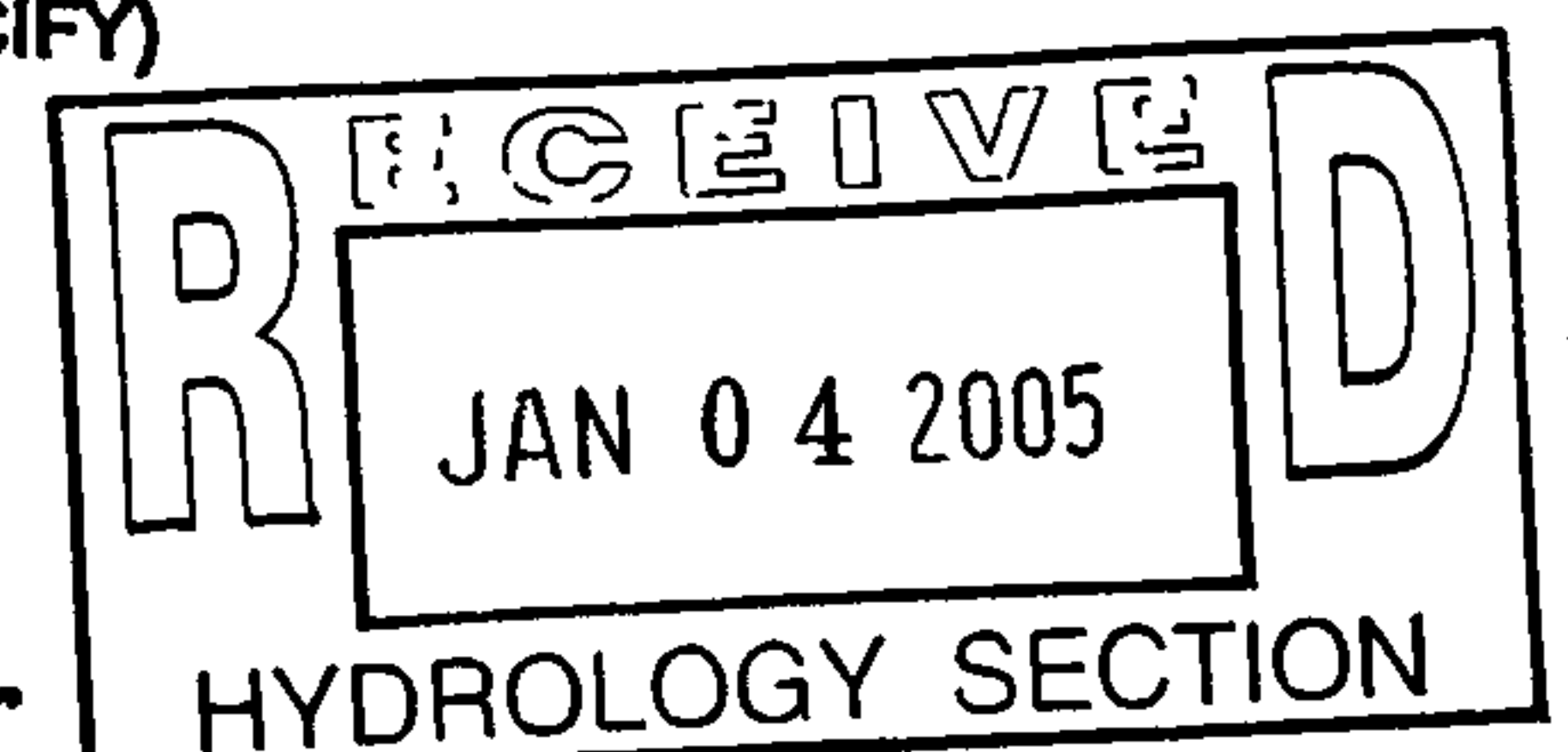

Requests for approvals of Site Development Plans and/or Subdivision Plats shall be accompanied by a drainage submittal. The particular nature, location and scope of the proposed development defines the degree of drainage detail. One or more of the following levels of submittal may be required based on the following:

1. **Conceptual Grading and Drainage Plan:** Required for approval of Site Development Plans greater than five (5) acres and Sector Plans.
2. **Drainage Plans:** Required for building permits, grading permits, paving permits and site plans less than five (5) acres.
3. **Drainage Report:** Required for subdivisions containing more than ten (10) lots or constituting five (5) acres or more.

CITY OF ALBUQUERQUE

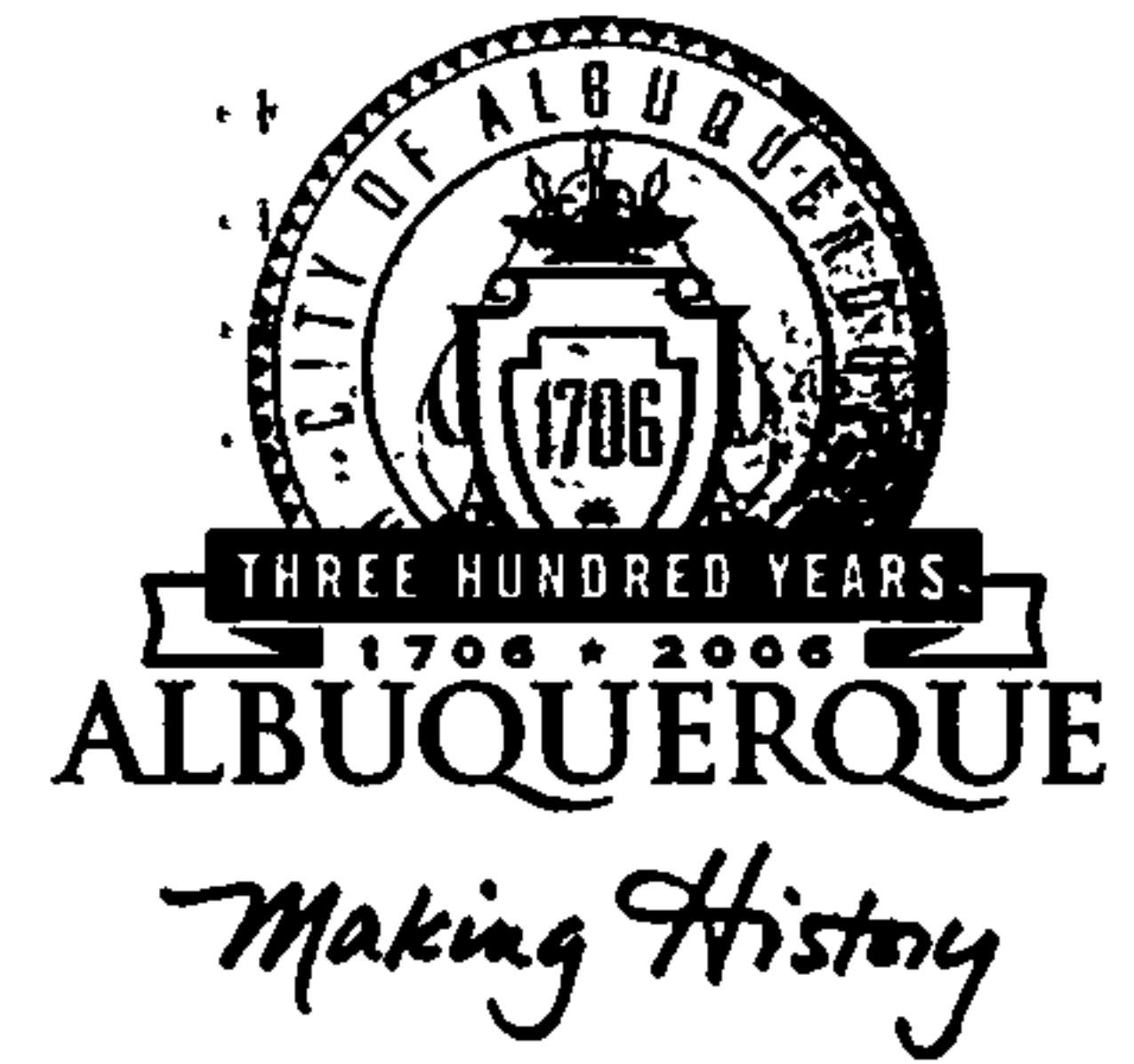

January 4, 2005

Mr. Lyle Losack, PE
QUIK DRAW
P.O. Box 729
Corrales, NM 82048

Re: JEHOVAH'S WITNESS KINGDOM HALL
8600 Los Volcanes Road NE
Approval of Permanent Certificate of Occupancy (C.O.)
Engineer's Stamp dated 09/14/2004 (K-9/D28)
Certification dated 01/04/2005

Dear Lyle,

P.O. Box 1293

Based upon the information provided in your submittal received 01/04/2005, the above referenced certification is approved for release of Permanent Certificate of Occupancy by Hydrology.

Albuquerque

If you have any questions, you can contact me at 924-3982.

New Mexico 87103

Sincerely,

Arlene V. Portillo

Arlene V. Portillo
Plan Checker, Planning Dept. - Hydrology
Development and Building Services

www.cabq.gov

C: Phyllis Villanueva
File

CITY OF ALBUQUERQUE

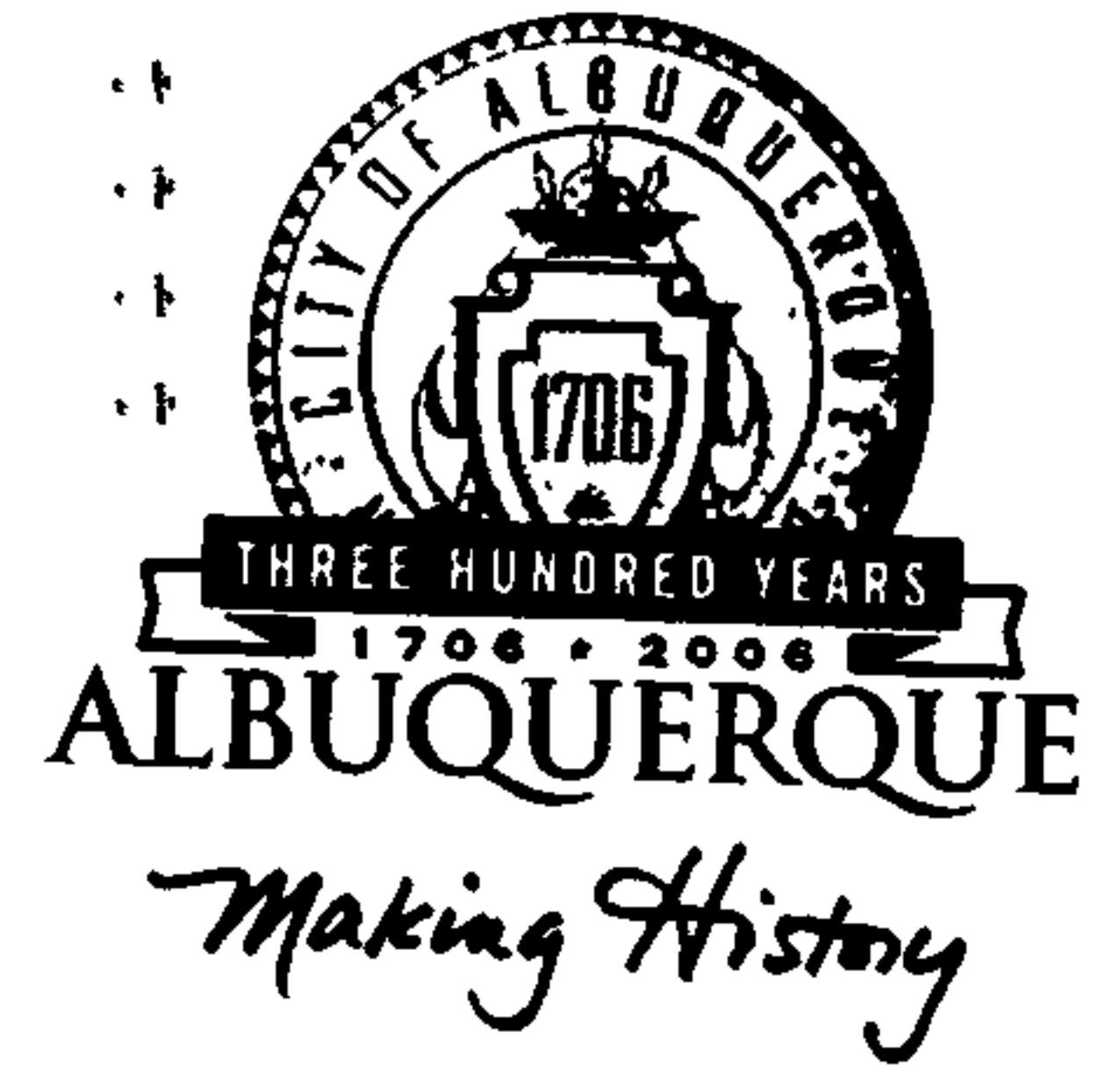

September 24, 2004

Lyle Losack, PE
QuickDraw Engineering
PO Box 729
Corrales, NM 87048

**Re: Jehovah's Witness Kingdom Hall Grading and Drainage Plan
Engineer's Stamp dated 9-14-04, (K9/D28)**

Dear Mr. Losack,

Based upon the information provided in your submittal dated 9-14-04, the above referenced plan is approved for Building Permit. Please attach a copy of this approved plan to the construction sets prior to sign-off by Hydrology.

Prior to Certificate of Occupancy release, Engineer Certification per the DPM checklist will be required.

If you have any questions, you can contact me at 924-3986.

Sincerely,

Bradley L. Bingham, PE
Principal Engineer, Planning Dept.
Development and Building Services

C: file

P.O. Box 1293

Albuquerque

New Mexico 87103

www.cabq.gov

DRAINAGE AND TRANSPORTATION INFORMATION SHEET
(REV. 1/28/2003rd)

1 COPY
DRN PLAN

K-9/028

PROJECT TITLE: JEHOVAH WITNESSES ZONE MAP/DRG. FILE #: K-9
JOB #: _____ EPC#: _____ WORK ORDER#: _____

GAL DESCRIPTION: TRACT A-2-B CHIEF WST BUS. PRK.
PROPERTY ADDRESS: LOT A2B

ENGINEERING FIRM: OUICK DRAW
ADDRESS: PO BOX 329
CITY, STATE: CORRALES, NM

CONTACT: LYLE LOSACK
PHONE: 878-0389
ZIP CODE: 87048

OWNER: WEST CONGREGATION
ADDRESS: 8600 LOS VOLCANES
CITY, STATE: _____

CONTACT: _____
PHONE: _____
ZIP CODE: _____

ARCHITECT: OUICK DRAW
ADDRESS: _____
CITY, STATE: _____

CONTACT: _____
PHONE: _____
ZIP CODE: _____

SURVEYOR: _____
ADDRESS: _____
CITY, STATE: _____

CONTACT: _____
PHONE: _____
ZIP CODE: _____

CONTRACTOR: RWT CONTRACTING
ADDRESS: 38 CORONA RD
CITY, STATE: LOS ALAMOS

CONTACT: RICHARD OLIVINE
PHONE: 280-5235
ZIP CODE: 87031

CHECK TYPE OF SUBMITTAL:

- ☐ DRAINAGE REPORT
- ☒ DRAINAGE PLAN 1st SUBMITTAL, REQUIRES TCL or equal
- ☐ DRAINAGE PLAN RESUBMITTAL
- ☐ CONCEPTUAL GRADING & DRAINAGE PLAN
- ☐ GRADING PLAN
- ☐ EROSION CONTROL PLAN
- ☐ ENGINEER'S CERTIFICATION (HYDROLOGY)
- ☐ CLOMR/LOMR
- ☐ TRAFFIC CIRCULATION LAYOUT (TCL)
- ☐ ENGINEER'S CERTIFICATION (TCL)
- ☐ ENGINEER'S CERTIFICATION (DRB APPL. SITE PLAN)
- ☐ OTHER

CHECK TYPE OF APPROVAL SOUGHT:

- ☐ SIA / FINANCIAL GUARANTEE RELEASE
- ☐ PRELIMINARY PLAT APPROVAL
- ☐ S. DEV. PLAN FOR SUBD. APPROVAL
- ☐ S. DEV. PLAN FOR BLDG. PERMIT APPROVAL
- ☐ SECTOR PLAN APPROVAL
- ☐ FINAL PLAT APPROVAL
- ☐ FOUNDATION PERMIT APPROVAL
- ☒ BUILDING PERMIT APPROVAL
- ☐ CERTIFICATE OF OCCUPANCY (PERM.)
- ☐ CERTIFICATE OF OCCUPANCY (TEMP.)
- ☐ GRADING PERMIT APPROVAL
- ☐ PAVING PERMIT APPROVAL
- ☐ WORK ORDER APPROVAL
- ☐ OTHER (SPECIFY)

WAS A PRE-DESIGN CONFERENCE ATTENDED:

- ☒ YES
- ☐ NO
- ☐ COPY PROVIDED

DATE SUBMITTED: 9/14/04 BY: Lyle Losack

Requests for approvals of Site Development Plans and/or Subdivision Plats shall be accompanied by a drainage submittal. The particular nature, location and scope of the proposed development defines the degree of drainage detail. One or more of the following levels of submittal may be required based on the following:

1. Conceptual Grading and Drainage Plan: Required for approval of Site Development Plans greater than five (5) acres and Sector Plans.
2. Drainage Plans: Required for building permits, grading permits, paving permits and site plans less than five (5) acres.
3. Drainage Report: Required for subdivisions containing more than ten (10) lots or constituting less than five (5) acres.

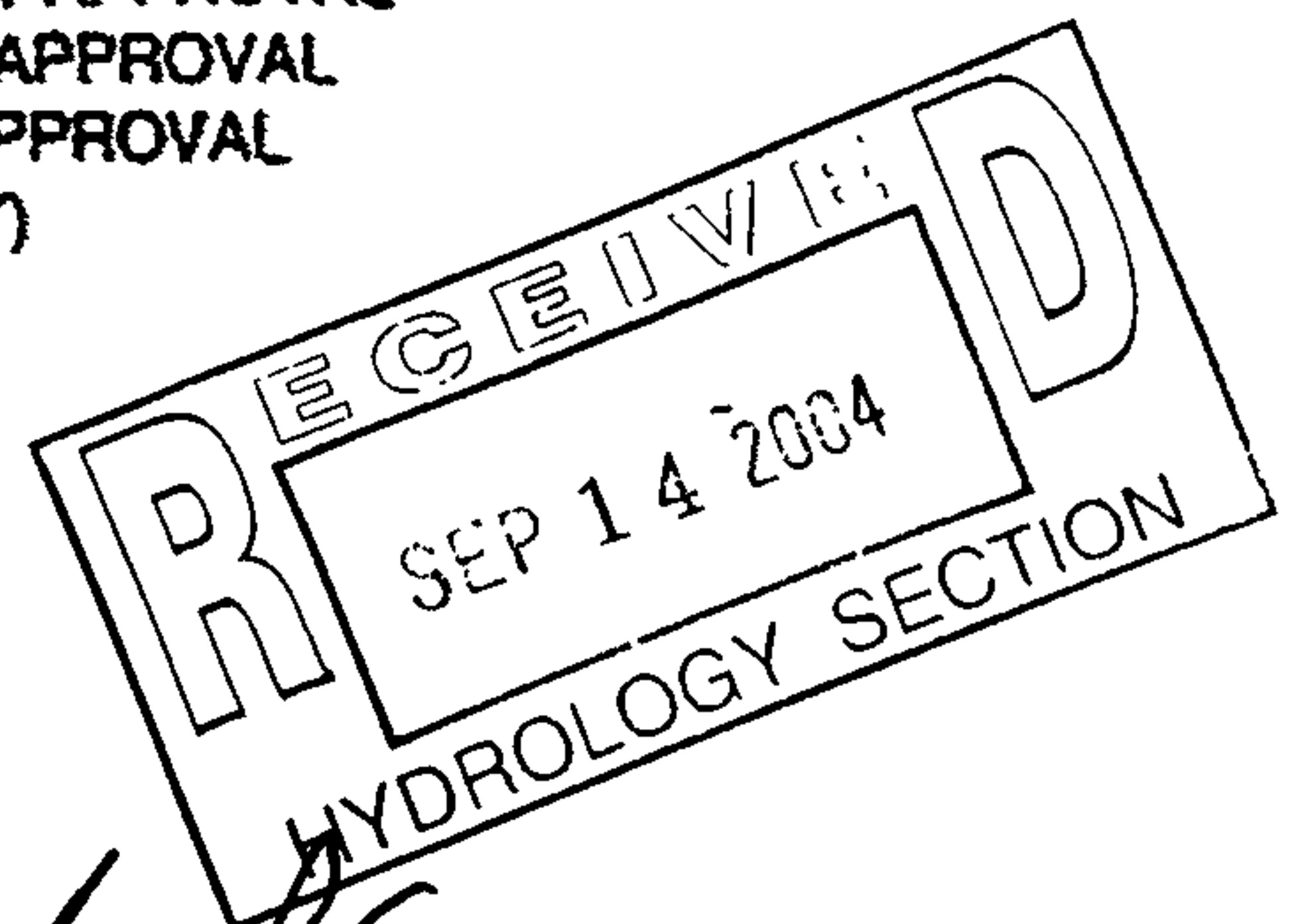

CITY OF ALBUQUERQUE

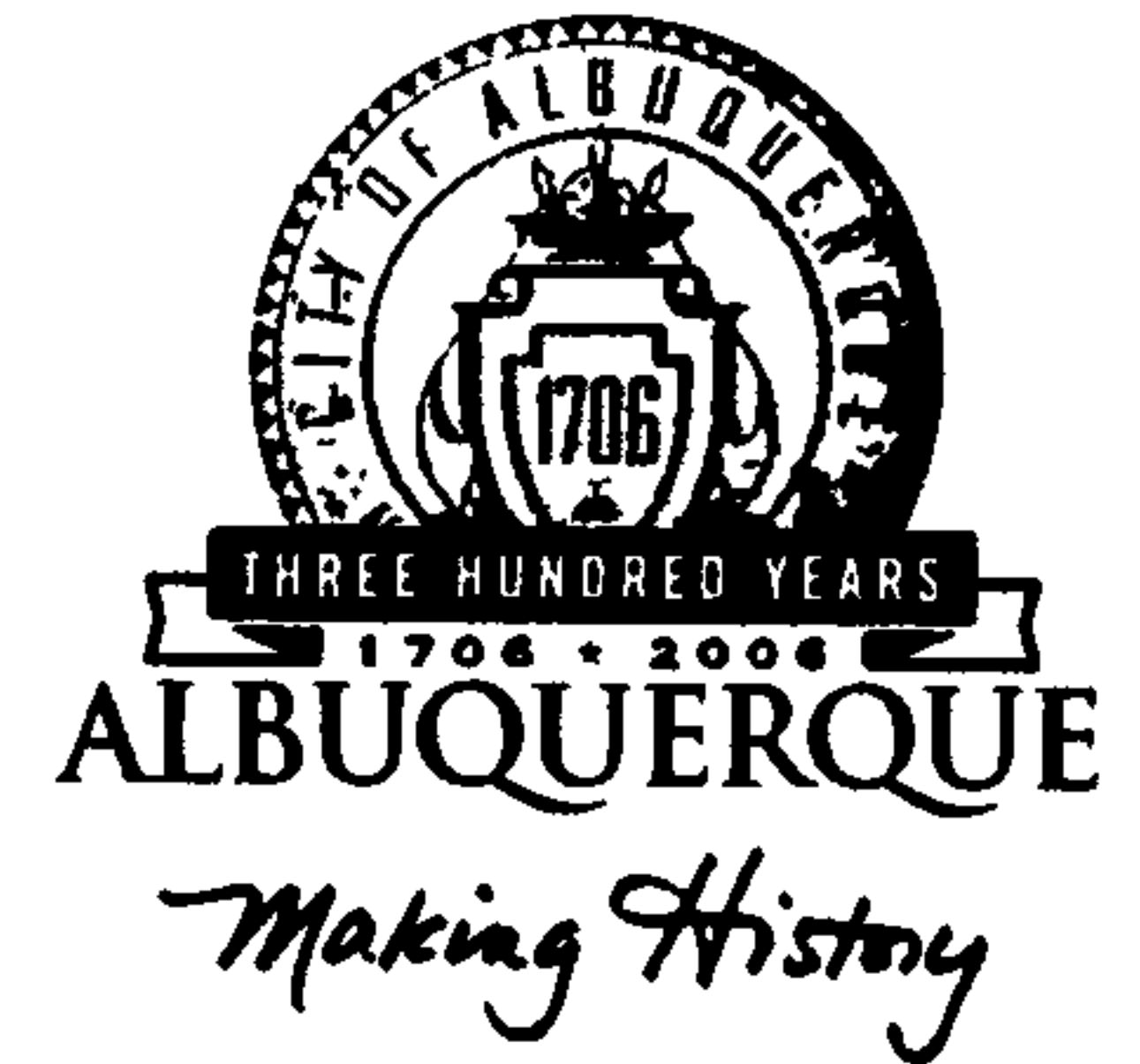

September 20, 2004

Lyle Losack, P.E.
Quik Draw
P.O. Box 729
Corrales, NM 82048

**Re: Jehovah Witness Kingdom Hall, Los Volcanes Road NW, Traffic
Circulation Layout
Engineer's Stamp dated 9-14-04 (K9-D28)**

Dear Mr. Losack,

Based upon the information provided in your submittal received 9-14-04, the above referenced plan cannot be approved for Building Permit until the following comments are addressed:

P.O. Box 1293

Albuquerque

1. Please refer to all applicable city standards.
2. Please list the width and length for all parking spaces.
3. What is the aisle width for the handicapped spaces?

If you have any questions, you can contact me at 924-3991.

New Mexico 87103

www.cabq.gov

Sincerely,

A handwritten signature in black ink, appearing to read "Wilfred A. Gallegos".

Wilfred A. Gallegos, P.E.
Traffic Engineer, Planning Dept.
Development and Building Services

C: file

DRAINAGE AND TRANSPORTATION INFORMATION SHEET
 (REV. 1/28/2003rd)

2 COPIES

SITE PLAN

K-9/D28

K-9

PROJECT TITLE: JEHOVAH WITNESSES ZONE MAP/DRG. FILE #: K-9
 3 #: _____ EPC#: _____ WORK ORDER#: _____

AL DESCRIPTION: TRACT A-7-B CHIEF WST BUS. PARK
 ADDRESS: 10400 A-7-B

ENGINEERING FIRM: QUICK DRAW
 ADDRESS: PO BOX 329
 CITY, STATE: CORRALES, NM

CONTACT: LYLE LOSACK
 PHONE: 878-0389
 ZIP CODE: 87048

OWNER: WEST CONGREGATION
 ADDRESS: 8600 LOS VOLCANES
 CITY, STATE: _____

CONTACT: _____
 PHONE: _____
 ZIP CODE: _____

ARCHITECT: QUICK DRAW
 ADDRESS: _____
 CITY, STATE: _____

CONTACT: _____
 PHONE: _____
 ZIP CODE: _____

VEYOR: _____
 ADDRESS: _____
 CITY, STATE: _____

CONTACT: _____
 PHONE: _____
 ZIP CODE: _____

CONTRACTOR: RWT CONTRACTING
 ADDRESS: 30 CORONA RD
 CITY, STATE: LOS ALAMOS

CONTACT: RICHARD OKUNE
 PHONE: 280-5235
 ZIP CODE: 87031

CHECK TYPE OF SUBMITTAL:

- ☐ DRAINAGE REPORT
- ☐ DRAINAGE PLAN 1" SUBMITTAL, REQUIRES TCL or equal
- ☐ DRAINAGE PLAN RESUBMITTAL
- ☐ CONCEPTUAL GRADING & DRAINAGE PLAN
- ☐ GRADING PLAN
- ☐ EROSION CONTROL PLAN
- ☐ ENGINEER'S CERTIFICATION (HYDROLOGY)
- ☐ CLOMR/LOMR
- ☒ TRAFFIC CIRCULATION LAYOUT (TCL)
- ☐ ENGINEER'S CERTIFICATION (TCL)
- ☐ ENGINEER'S CERTIFICATION (DRB APPR. SITE PLAN)
- ☐ OTHER

CHECK TYPE OF APPROVAL SOUGHT:

- ☐ SIA / FINANCIAL GUARANTEE RELEASE
- ☐ PRELIMINARY PLAT APPROVAL
- ☐ S. DEV. PLAN FOR BLDG. APPROVAL
- ☐ S. DEV. PLAN FOR BLDG. PERMIT APPROVAL
- ☐ SECTOR PLAN APPROVAL
- ☐ FINAL PLAT APPROVAL
- ☐ FOUNDATION PERMIT APPROVAL
- ☒ BUILDING PERMIT APPROVAL
- ☐ CERTIFICATE OF OCCUPANCY (PERM.)
- ☐ CERTIFICATE OF OCCUPANCY (TEMP.)
- ☐ GRADING PERMIT APPROVAL
- ☐ PAVING PERMIT APPROVAL
- ☐ WORK ORDER APPROVAL
- ☐ OTHER (SPECIFY)

S.A. PRE-DESIGN CONFERENCE ATTENDED:

- ☐ YES
- ☐ NO
- ☐ COPY PROVIDED

RE SUBMITTED: 9/14/04 BY: LG C. [Signature]

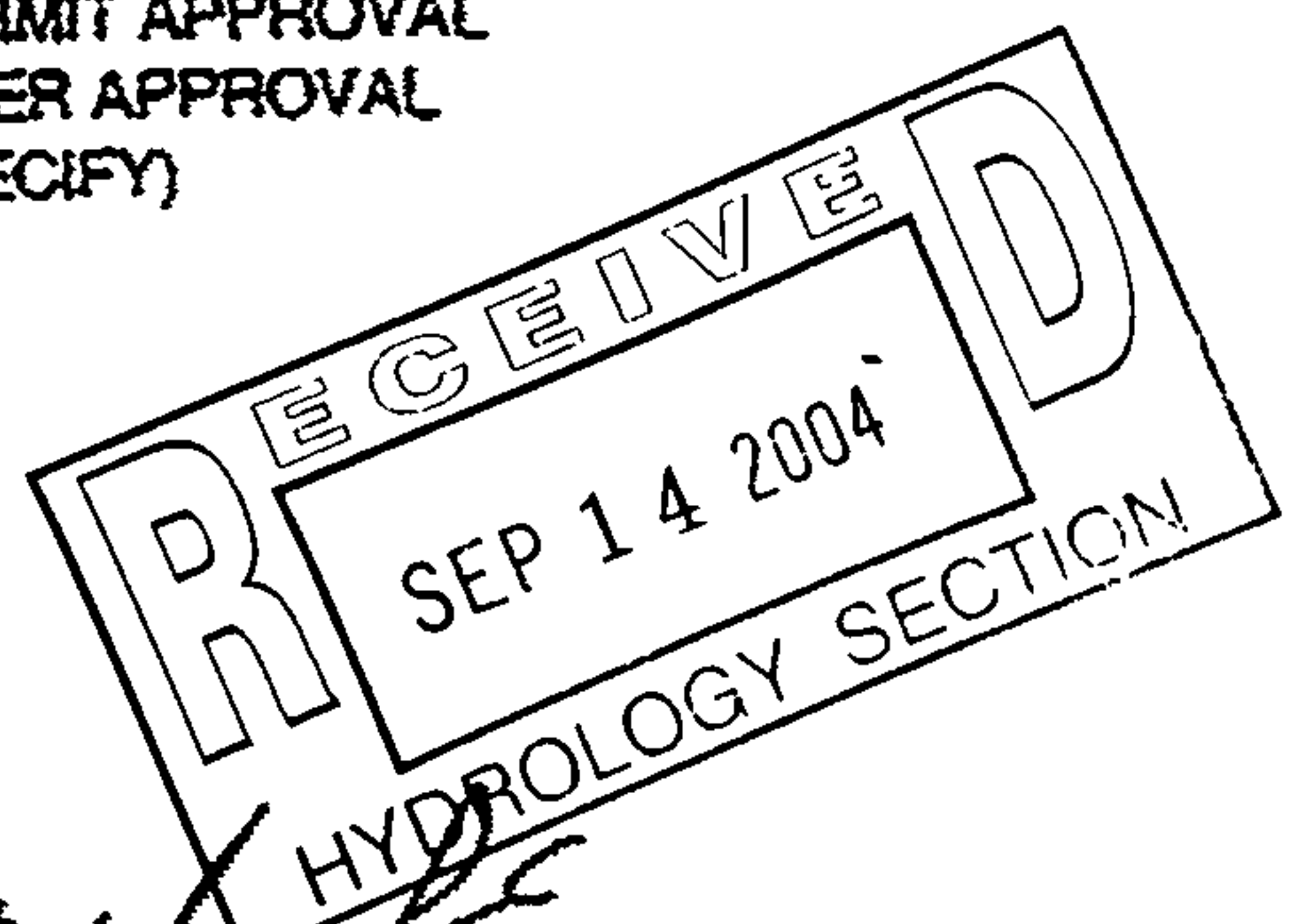

Requests for approvals of Site Development Plans and/or Subdivision Plans shall be accompanied by a drainage submittal. The particular nature, location and scope of the proposed development defines the degree of drainage detail. One or more of the following levels of submittal may be required based on the following:

1. Conceptual Grading and Drainage Plan: Required for approval of Site Development Plans greater than five (5) acres and Sector Plans.
2. Drainage Plans: Required for building permits, grading permits, paving permits and site plans less than five (5) acres.
3. Drainage Report: Required for subdivisions containing more than ten (10) lots or more than five (5) acres.

850/P-X

~~the~~

Widths and lengths of all parking spaces

Aisle widths of HC spaces

Call out City Sidewalks — stds, widths

Hold on to
letter — do not mail



City of Albuquerque

P.O. BOX 1293 ALBUQUERQUE, NEW MEXICO 87103

May 28, 2004

Lyle Losack, PE
QuickDraw Engineering
PO Box 729
Corrales, NM 87048

**Re: Jehovah Witness Kingdom Hall Drainage Report
Engineer's Stamp dated 4-7-04, (K9/D28)**

Dear Mr. Losack,

Based upon the information provided in your submittal dated 4-7-04, the above referenced plan is approved for Grading Permit. Prior to Building Permit approval, please address the following comments:

- Please provide construction build-notes for the proposed inlet.
- Provide calculations, inverts and dimensions for the sidewalk chute.
- Show existing grades of Los Volcanes in order to determine if retaining wall is needed and to determine the waterblock elevation.
- Please provide the benchmark this survey was taken from.
- The "future" 18" SD is under work order. Please provide design plans or as-builts to support your design.

This project requires a National Pollutant Discharge Elimination System (NPDES) permit. Refer to the attachment that is provided with this letter for details. If you have any questions please feel free to call the Municipal Development Department, Hydrology section at 768-3654 (Charles Caruso) or 768-3645 (Bryan Wolfe).

Sincerely,

Bradley L. Bingham, PE
Principal Engineer, Planning Dept.
Development and Building Services

C: file
✓ Chuck Caruso CoA

DRAINAGE AND TRANSPORTATION INFORMATION SHEET

(REV. 1/28/2003rd)

PROJECT TITLE: JEHOVAH'S KINGDOM HALL ZONE MAP/DRG. FILE #: K-9/D028
 DRB #: _____ EPC#: _____ WORK ORDER#: _____

LEGAL DESCRIPTION: TRACT A-2-B
 CITY ADDRESS: _____

ENGINEERING FIRM: QUICKDRAW ENGINEERING LLC CONTACT: hyle hosack PE
 ADDRESS: PO BOX 729 PHONE: 898-0389
 CITY, STATE: CORRALCOS NM ZIP CODE: 87048

OWNER: JEHOVAH'S WEST CONGREGAT, CONTACT: RICHARD OLGUIN
 ADDRESS: 2231 DATARITO RD PHONE: 720-2087
 CITY, STATE: ALBU NM ZIP CODE: 87105

ARCHITECT: QUICKDRAW ENGINEERING LLC CONTACT: SAME AS ABOVE
 ADDRESS: " PHONE: _____
 CITY, STATE: " ZIP CODE: _____

SURVEYOR: _____ CONTACT: _____
 ADDRESS: _____ PHONE: _____
 CITY, STATE: _____ ZIP CODE: _____

CONTRACTOR: OLGUIN'S CUSTOM HOMES CONTACT: RICHARD OLGUIN
 ADDRESS: PO BOX 2231 DATARITO ROAD PHONE: 720-2087
 CITY, STATE: _____ ZIP CODE: 87105

CHECK TYPE OF SUBMITTAL:

- ☒ DRAINAGE REPORT
- ☐ DRAINAGE PLAN 1st SUBMITTAL, *REQUIRES TCL or equal*
- ☐ DRAINAGE PLAN RESUBMITTAL
- ☒ CONCEPTUAL GRADING & DRAINAGE PLAN
- ☐ GRADING PLAN
- ☐ EROSION CONTROL PLAN
- ☐ ENGINEER'S CERTIFICATION (HYDROLOGY)
- ☐ CLOMR/LOMR
- ☐ TRAFFIC CIRCULATION LAYOUT (TCL)
- ☐ ENGINEERS CERTIFICATION (TCL)
- ☐ ENGINEERS CERTIFICATION (DRB /PPR. SITE PLAN)
- ☐ OTHER

CHECK TYPE OF APPROVAL SOUGHT:

- ☐ SIA / FINANCIAL GUARANTEE RELEASE
- ☐ PRELIMINARY PLAT APPROVAL
- ☐ S. DEV. PLAN FOR SUBD. APPROVAL
- ☐ S. DEV. PLAN FOR BLDG. PERMIT APPROVAL
- ☐ SECTOR PLAN APPROVAL
- ☐ FINAL PLAT APPROVAL
- ☐ FOUNDATION PERMIT APPROVAL
- ☐ BUILDING PERMIT APPROVAL
- ☐ CERTIFICATE OF OCCUPANCY (PERM.)
- ☐ CERTIFICATE OF OCCUPANCY (TEMP.)
- ☒ GRADING PERMIT APPROVAL
- ☐ PAVING PERMIT APPROVAL
- ☐ WORK ORDER APPROVAL
- ☐ OTHER (SPECIFY) DRAIN REPORT APPROVAL

WAS A PRE-DESIGN CONFERENCE ATTENDED: _____

- ☒ YES
- ☐ NO
- ☐ COPY PROVIDED

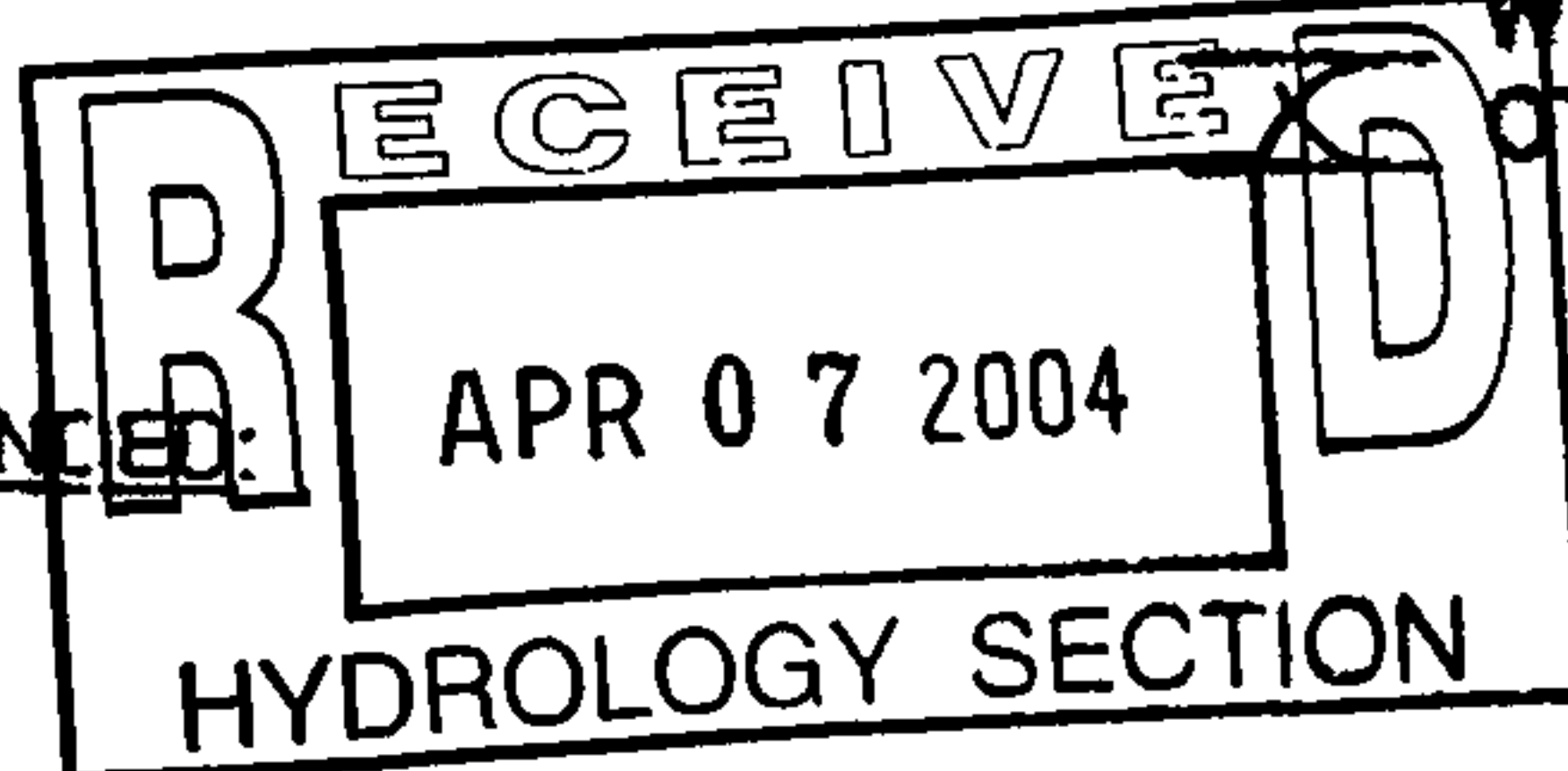

DATE SUBMITTED: 4/7/04 BY: Hyle Hosack PE

Requests for approvals of Site Development Plans and/or Subdivision Plats shall be accompanied by a drainage submittal. The particular nature, location and scope of the proposed development defines the degree of drainage detail. One or more of the following levels of submittal may be required based on the following:

1. Conceptual Grading and Drainage Plan: Required for approval of Site Development Plans greater than five (5) acres and Sector Plans.
2. Drainage Plans: Required for building permits, grading permits, paving permits and site plans less than five (5) acres.

DRAINAGE REPORT

FOR

JEHOVAH WITNESS
KINGDOM HALL

Prepared By:

QuikDraw Engineering, LLC

Post Office Box 729

Corrales, New Mexico 87048

Ph: 505-898-0389

FAX: 505-897-0389 FAX

E-Mail: quikdrawengr@aol.com

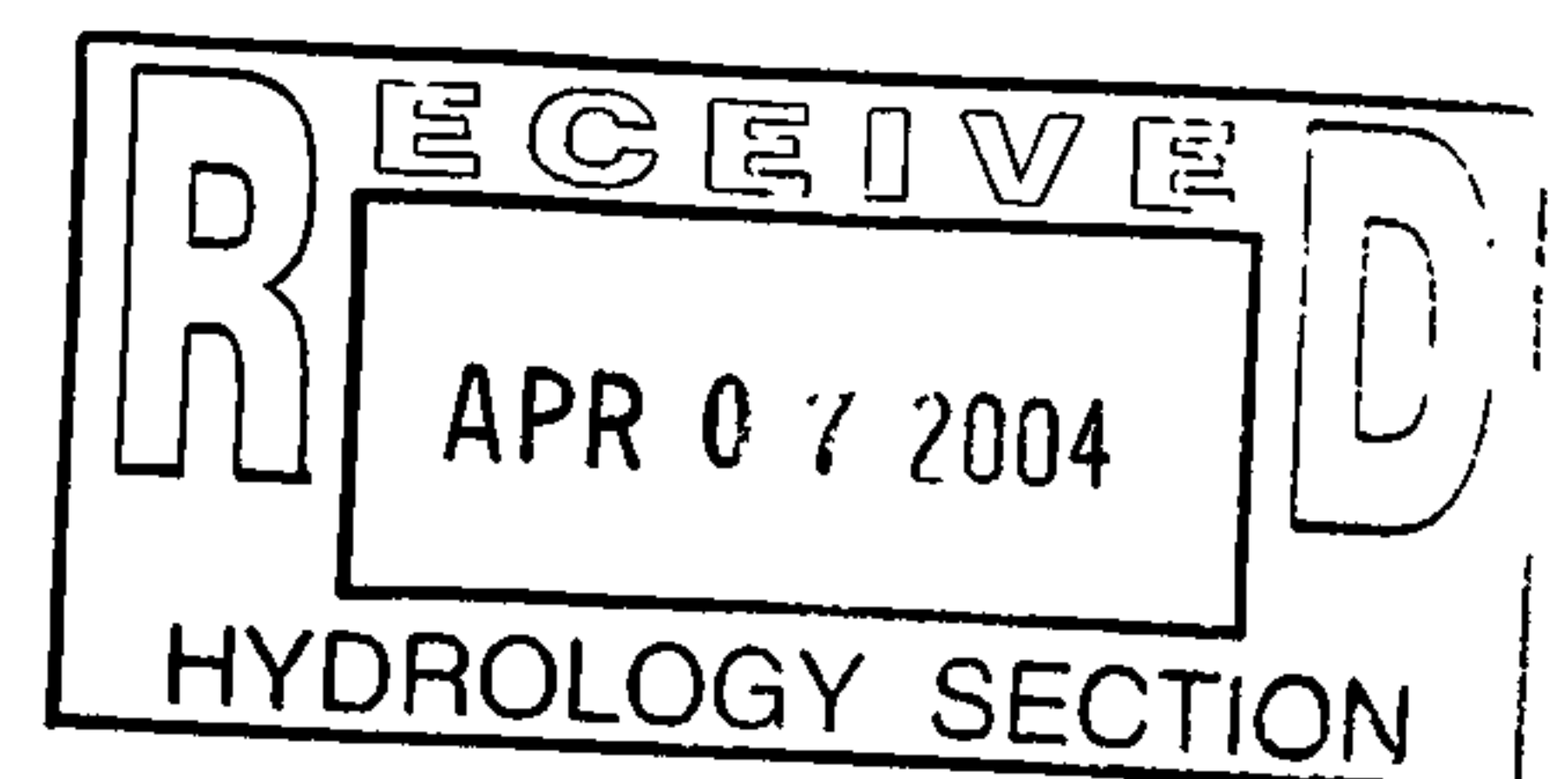

Lyle C. Losack PE
Lyle C. Losack, P.E.
4/7/04

Table of Contents

Vicinity Map I

1. Purpose and Scope 1

2. Site Description/Existing Drainage Conditions 1

3. Design Criteria/Land Treatments 1

4. Drainage Management Plan 2

5. Conclusion 2

Appendix A

Zone Atlas Maps 1

Firm Map 2

Appendix B

Existing Condition Calculations

Developed Condition Calculations

Appendix C

Pond Sizing Calculations

Plates

Grading Plan 2 of 2

1. Purpose and Scope

This parcel is proposed to be developed as a Jehovah Witness Kingdom Hall.

This report presents a drainage management plan for approval by the City of Albuquerque in order that the subsequent development may proceed.

2. Site Description/Existing Drainage Conditions

This site is located West of Unser Blvd. on the South side of Los Volcanoes Road in the Clifford West Business Park area. The topography in this area slopes approximately 2% to the South East.

There are no existing offsite flows that impact this site. Drainage from Los Volcanoes intercepts flows from the North. The West side coverges to a swale along the West side and flows South. Flows to the East and South drain away from the site.

3. Design Criteria/Land Treatments

The drainage plan presented in this report has been prepared in accordance with the City of Albuquerque Drainage Ordinances and Chapter 22 of the Development Process Manual (DPM).

Rainfall intensities per this report are as follows:

Zone	P ₆₀	P ₃₆₀	P ₁₄₄₀
1	1.87	2.20	2.60

Land Treatment (DPM Pg 22-11) Multiple Unit Attached

Treatment Type	A	B	C	D
Existing	90	0	10	0
Developed	0	0	10	90

Total drainage area for the Kingdom Hall is 1.679 acres.

4. Drainage Management Plan

This lot is a re-plat from the drainage report by Goodwin and Associates dated July 1997. Lots 1 & 2 of Unit 2 were a part of a re-plat by Aldrich Surveying in October 2003 to create the Clifford West Business Park. An easement in the SE corner is provided to serve as a Drainage and Utility corridor (see copy of attached plat).

The existing flow of this parcel is 2.43 cfs . The developed flow will be 12.44 cfs. An increase of 10.01 cfs.

It is the intent to retain flows on site in the parking lot until the proposed storm drain system downstream is in place. A double grate inlet and 18" storm drain stub-out to the easement will be provided for future hook-up.

The temporary retention area will be able to hold the 10 day volume requirements of 0.248 ac-ft.. The site will be surrounded by a CMU wall to prevent flows from leaving the site.

5. Conclusion

Per the overall plan, no adverse downstream impact will result from this development. The proposed system will in fact, improve the local drainage situation by reducing the overland flows that leave this site.

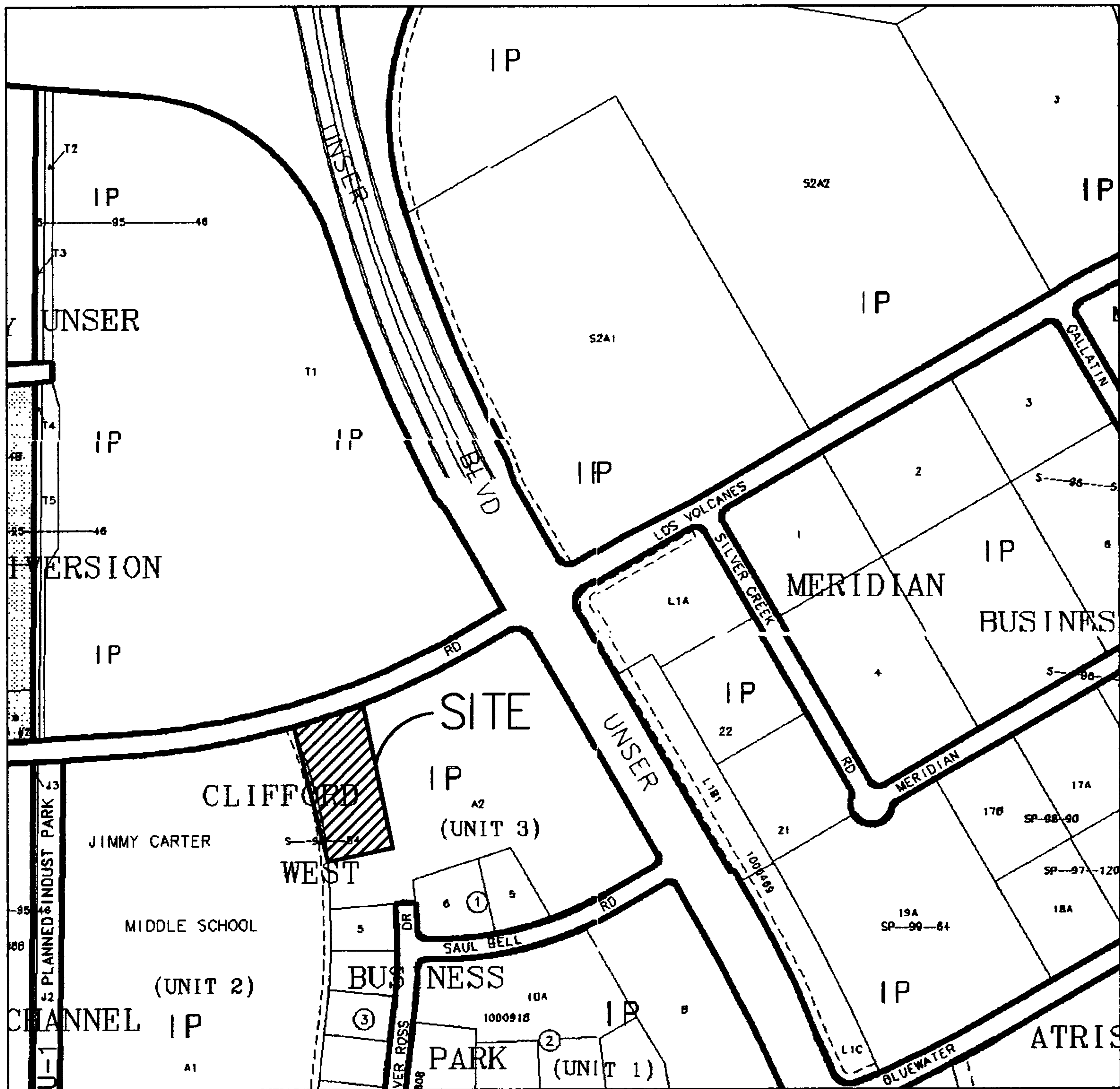

VICINITY MAP
K-9-Z ZONE ATLAS PAGE

FEMA FLOOD MAP

MAP NUMBER 35001C0328E

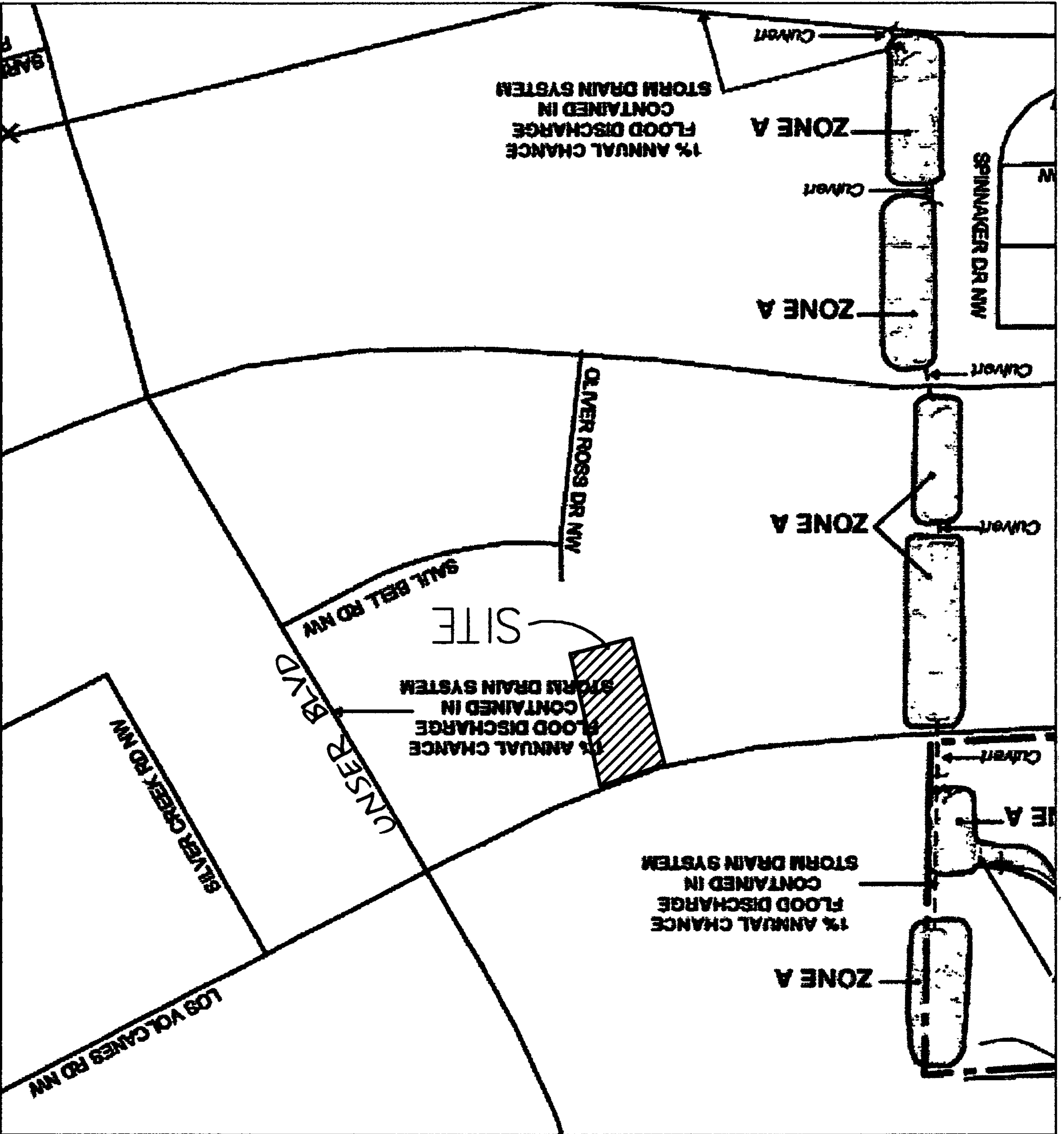

```

*
*
*
*
START
RAINFALL

*
COMPUTE NM HYD

*
PRINT HYD
FINISH

*****
*Jehovah Kingdom Hall
*100 YEAR 6 HOUR EXIST CONDITIONS
*****
TIME=0.0 HR PUNCH CODE=0 PRINT LINES=-6
TYPE=1 RAIN QUARTER=0.0
RAIN ONE=1.87 IN RAIN SIX=2.20 IN
RAIN DAY=2.60 IN DT=0.0333 HRS
*Proposed parcel*
ID=1 HYD NO=D1 DA=0.00265 SQ MI
PER A=90 PER B=0 PER C=10 PER D=0
TP=-0.1333 HR MASS RAIN=-1
*****
*****
ID=1 CODE=1

```

```

*
*
*
*
START
RAINFALL

*
COMPUTE NM HYD

*
*
PRINT HYD
FINISH

*****
*Jehovah Kingdom Hall
*100 YEAR 6 HOUR PROP CONDITIONS
*****
TIME=0.0 HR PUNCH CODE=0 PRINT LINES=-6
TYPE=1 RAIN QUARTER=0.0
RAIN ONE=1.87 IN RAIN SIX=2.20 IN
RAIN DAY=2.60 IN DT=0.0333 HRS
*****
ID=1 HYD NO=D1 DA=0.0046 SQ MI
PER A=0 PER B=0 PER C=10 PER D=90
TP=-0.1333 HR MASS RAIN=-1
*****
*****
ID=1 CODE=1

```

POND CALCS

$$P_{24} = 2.60$$

$$P_{10} = 10 - \left(\frac{24.9}{2.60 \cdot 4} \right) = 3.47$$

$$P_6 = 2.20$$

$$V_{10} = V_6 + A_0 \left(\frac{P_{10} - P_6}{12} \right)$$

$$A_0 = 1.6979 \text{ AC}$$

$$V_6 = 0.068 \text{ AC-FT (SEE A HYMO RUNS)}$$

$$V_{10} = 0.068 + 1.6979 \left(\frac{3.47 - 2.20}{12} \right) = 0.248 \text{ AC-FT}$$

SIZING: (PER FOOT CONTOUR - SEE GRADING PLAN)

$$\text{CONTOUR 46} = 5000 \text{ SF (1' DEEP)} / 2 = 2500 \text{ CUFT} = 0.57 \text{ AC-FT}$$

$$\text{CONTOUR 47} = 13500 \text{ " / " = 6750 " = 0.155 "}$$

$$\text{CONTOUR 48} = 20500 \text{ " / " = 10250 " = 0.235 "}$$

$$\text{REQ'D} = 0.248 < 0.447 \text{ OK}$$

HIGH WTR @ 10 DAY VOLUME APPROX 47.1

CITY OF ALBUQUERQUE

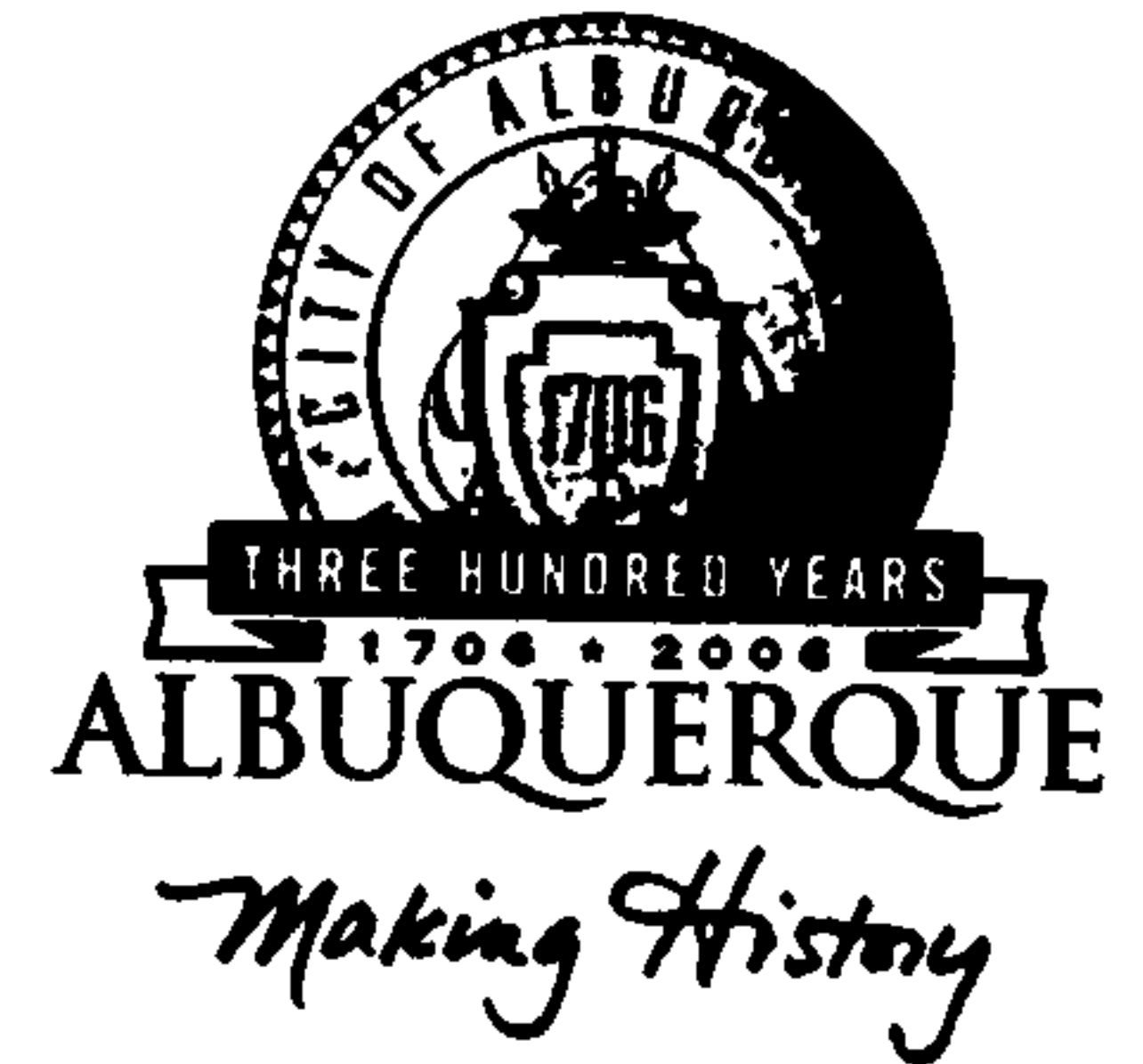

**Planning Department
Transportation Development Services Section**

January 5, 2005

Lyle C. Losack, P.E.
PO Box 729
Corrales, NM 87048

Re: Certification Submittal for Final Building Certificate of Occupancy for
Jehovah Witness Kingdom Hall , [K-9 / D28]
8600 Los Volcanes Road NW
Engineer's Stamp Dated 01/03/05

Dear Mr. Losack:

P.O. Box 1293

The TCL / Letter of Certification submitted on January 4, 2005 is sufficient for acceptance by this office for final Certificate of Occupancy (C.O.). Notification has been made to the Building and Safety Section.

Albuquerque

Sincerely,

New Mexico 87103

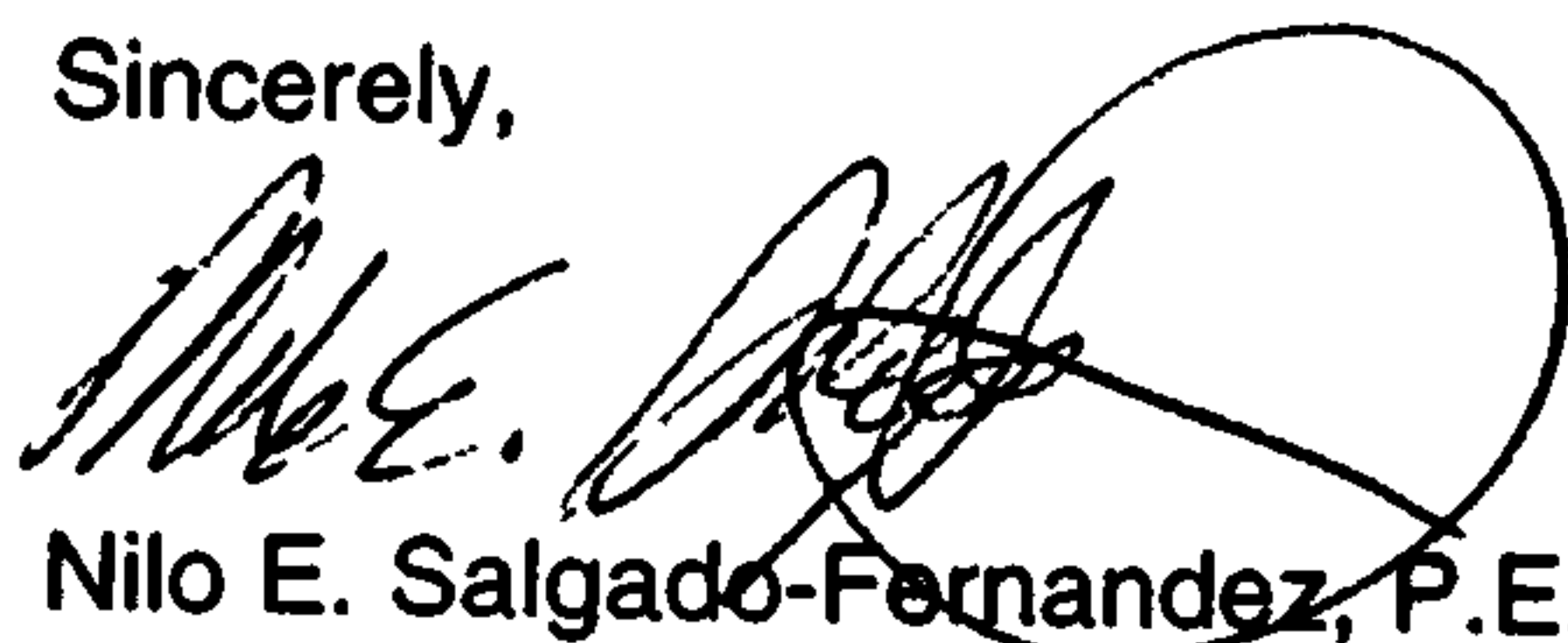
Nilo E. Salgado-Fernandez, P.E.
Senior Traffic Engineer
Development and Building Services
Planning Department

www.cabq.gov

c: Engineer
☒ Hydrology file
CO Clerk

CITY OF ALBUQUERQUE

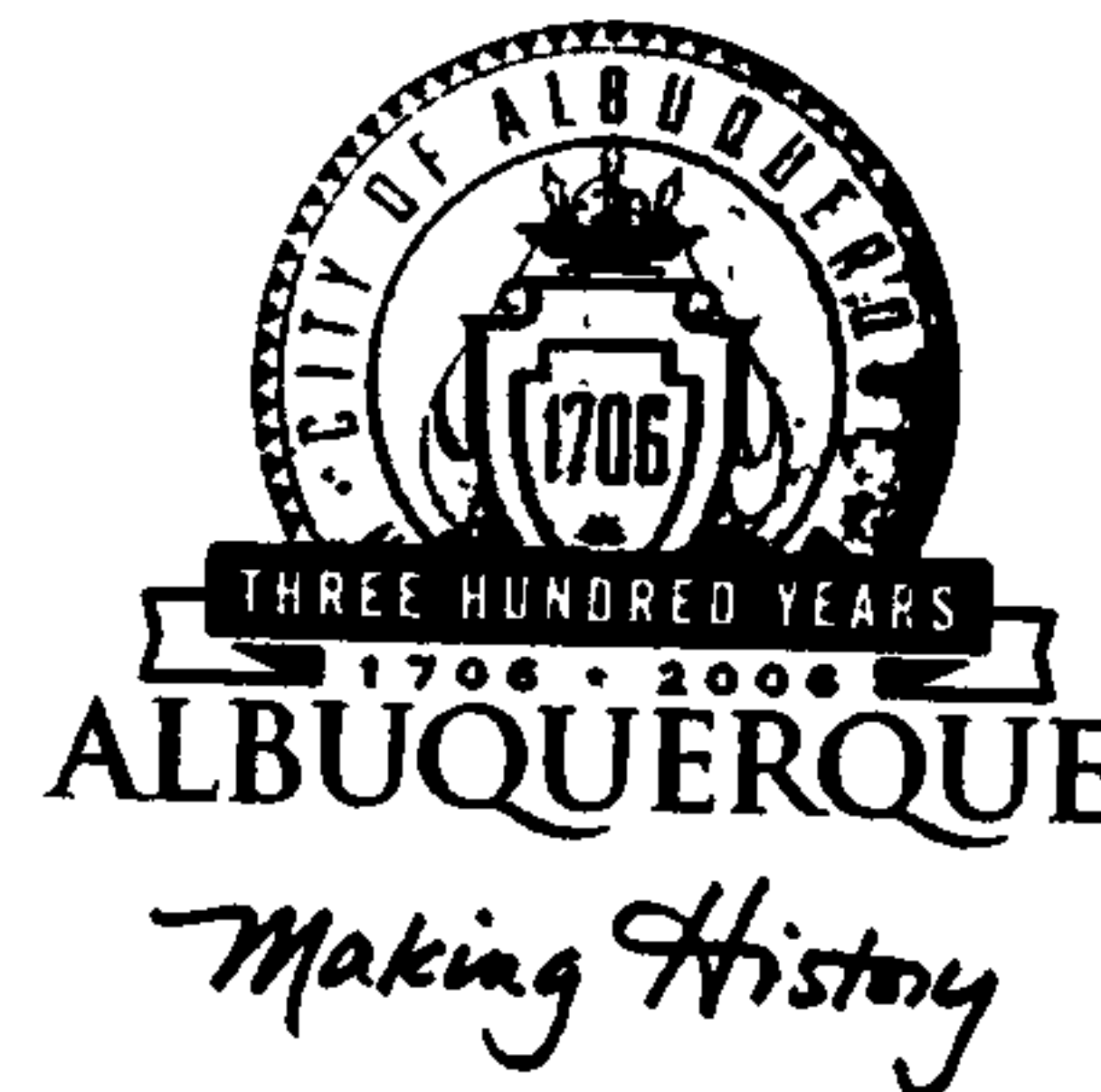

September 27, 2004

Lyle Losack, P.E.
Quik Draw
P.O. Box 729
Corrales, NM 82048

Re: Jehovahs Witness Kingdom Hall, 8600 Los Volcanes Road NW, Traffic Circulation
Layout
Engineer's Stamp dated 9-24-04 (K9-D28)

Dear Mr. Losack,

The TCL submittal received 9-24-04 is approved for Building Permit. The plan is stamped and signed as approved. A copy of this plan will be needed for each of the building permit plans. Please keep the original to be used for certification of the site for final C.O. for Transportation.

If a temporary CO is needed, a copy of the original TCL that was stamped as approved by the City will be needed. This plan must include a statement that identifies the outstanding items that need to be constructed or the items that have not been built in "substantial compliance," as well as the signed and dated stamp of a NM registered architect or engineer. Submit this TCL with a completed Drainage and Transportation Information Sheet to Hydrology at the Development Services Center of Plaza Del Sol Building.

When the site is completed and a final C.O. is requested, use the original City stamped approved TCL for certification. A NM registered architect or engineer must stamp, sign, and date the certification TCL along with indicating that the development was built in "substantial compliance" with the TCL. Submit this certification TCL with a completed Drainage and Transportation Information Sheet to Hydrology at the Development Services Center of Plaza Del Sol Building.

Once verification of certification is completed and approved, notification will be made to Building Safety to issue Final C.O. To confirm that a final C.O. has been issued, call Building Safety at 924-3306.

Sincerely,

Kristal D. Metro
Engineering Associate, Planning Dept.
Development and Building Services

cc: file

P.O. Box 1293

Albuquerque

New Mexico 87103

www.cabq.gov



**QuikDraw
Engineering, L.L.C.**

Post Office Box 729
Corrales, New Mexico 87048
505-898-0389WK 505-
8970389FAX
quikdrawengr@aol.com

December 3, 2004

Nilo Salgado-Fernandez
Sr. Engineer
City of Albuquerque
Transportation Development Section

(505) 924-3630

Re: Construction Acceptance Letter to obtain Temporary C.O.
Jehovah Witness Kingdom Hall located at 8600 Los Volcanos Road NW

I, Lyle C. Losack, P.E., a Registered Engineer in the State of New Mexico, observed the overall Traffic, Site, Grading & Drainage for the Jehovah Witness Kingdom Hall located on Los Volcanos Road NW on December 1, 2004. I observed that it is all complete except SE corner needs to be taped off, and to keep vehicles out during finish work. There are a couple of pieces of curb & gutter missing in the front that need to be finished. I found the construction to be acceptable and I recommend that a temporary CO to be issued until the permanent can be issued.

Please do not hesitate to contact me if you have any questions regarding this matter.

Respectfully submitted,

Lyle C. Losack, P.E.
Owner

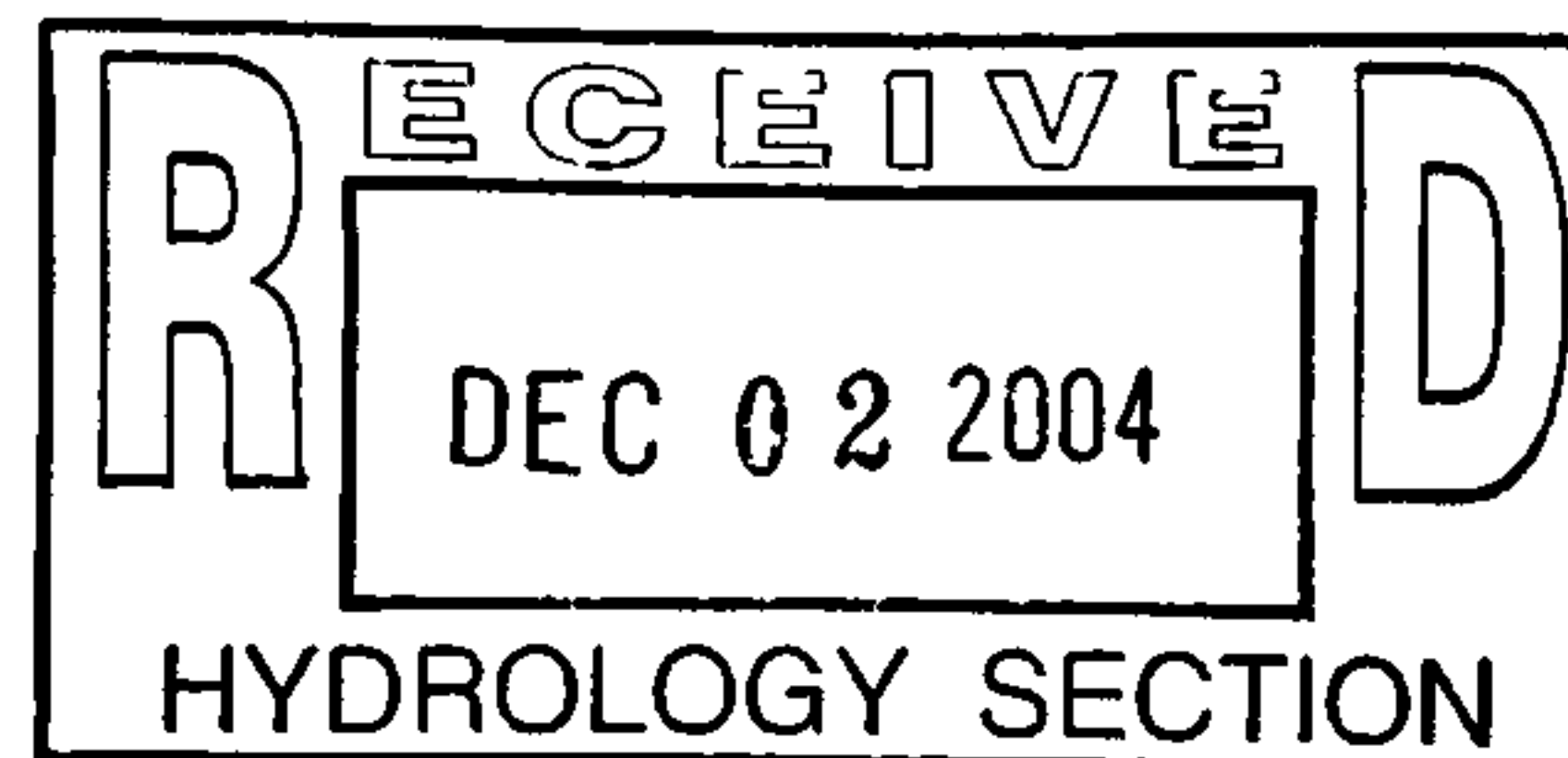

C: File

COMMAND	HYDROGRAPH IDENTIFICATION	FROM ID NO.	TO ID NO.	AREA (SQ MI)	PEAK DISCHARGE (CFS)	RUNOFF VOLUME (AC-FT)	RUNOFF (INCHES)	TIME TO PEAK (HOURS)	CFS PER ACRE	PAGE = 1 NOTATION
START										TIME= .00
RAINFALL TYPE= 1										RAIN6= 2.200
COMPUTE NM HYD	D1	-	1	.00265	2.43	.068	.47913	1.532	1.433	PER IMP= .00
FINISH										

□(s0p10h4099T□&l6D

□(s16.67h8.5v0T□&l8D

AHYMO PROGRAM SUMMARY TABLE (AHYMO_97) -
INPUT FILE = \\Workstation\workc\QDEPRO~4\KINGDO~1\100PRO~1.TXT

Ahymo

- VERSION: 1997.02d

RUN DATE (MON/DAY/YR) =04/06/2004
USER NO.= AHYMO-I-9702c01000X43-AH

COMMAND	HYDROGRAPH IDENTIFICATION	FROM ID NO.	TO ID NO.	AREA (SQ MI)	PEAK DISCHARGE (CFS)	RUNOFF VOLUME (AC-FT)	RUNOFF (INCHES)	TIME TO PEAK (HOURS)	CFS PER ACRE	PAGE = 1 NOTATION
START										TIME= .00
RAINFALL TYPE= 1										RAIN6= 2.200
COMPUTE NM HYD	D1	-	1	.00460	12.44	.458	1.86834	1.499	4.226	PER IMP= 90.00
FINISH										

□(s0p10h4099T□&l6D