

SITE WILL HAVE INLET PROTECTION FOR ALL ACTIVE INLETS WITH EARTH BERMS AND SILT FENCE. TRACK OUT WILL BE MITIGATED BY SWEEPING AS NEEDED. TRACT 11B IS UNDER NMR1002R2 BY OTHER CONTRACTORS. DAYTONA ROAD TO BE COMPLETED BY OTHERS

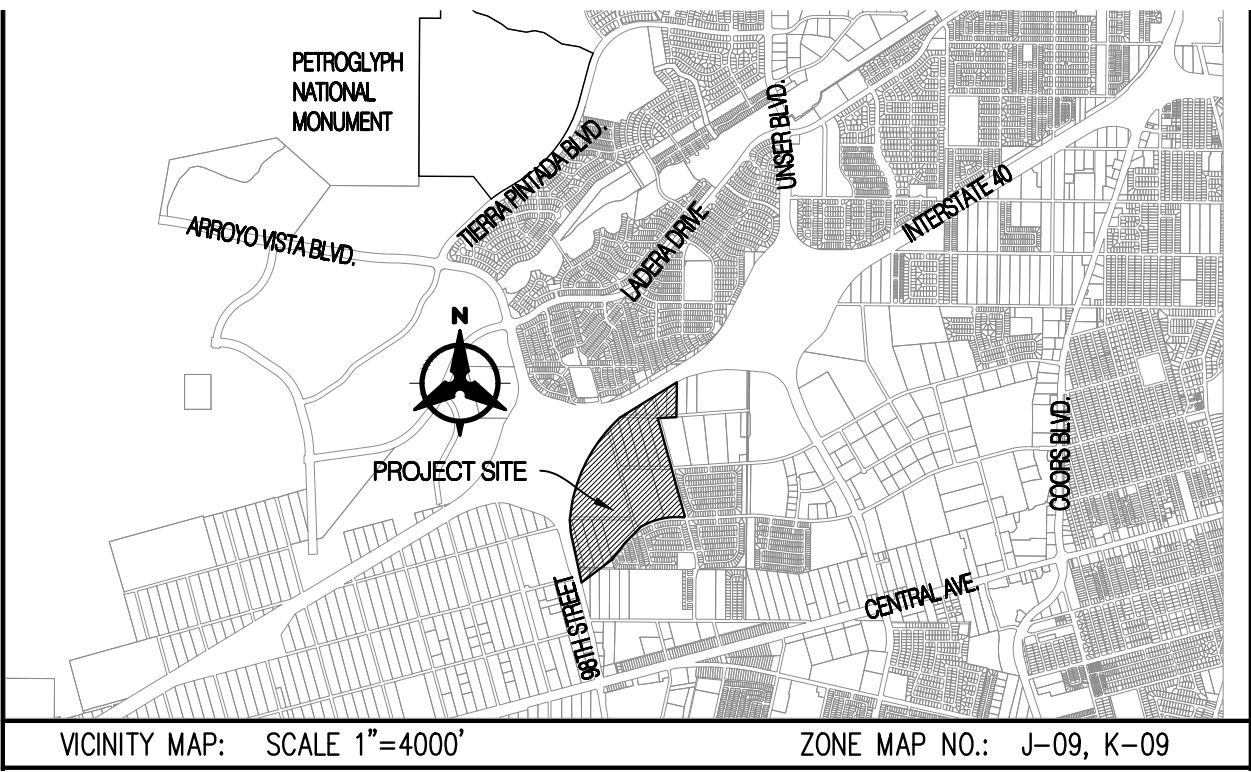

LEGEND	
TEMPORARY EROSION AND SEDIMENT CONTROL PLAN	
	PROJECT PERIMETER & DISTURBED AREA
	SILT FENCE
	EARTH BERM
	FLOW DIRECTION
	STAGING AREA
	AREA OF NO DISTURBANCE
	TRASH RECEPTACLE
	CHEMICAL TOILET
	CONCRETE WASHOUT
	EXISTING POND
	BLOCK WALL
	CHECK DAM
	DROP INLET PROTECTION
	OUTFALL
	POSTING SIGN
	PRESERVED VEGETATION
	STABILIZATION AREA

RECEIVING WATERS: WATER QUALITY PONDS VIA ALBUQUERQUE MS4	
CRITICAL HABITAT: CRITERION "A"; NO CRITICAL HABITATS WITHIN PROJECT AREA	
GPS LOCATION: 35.0797, -106.7418	
98th & BLUEWATER	
PROJECT TITLE	
ALBUQUERQUE, BERNALILLO COUNTY, NM	
CITY, COUNTY, STATE	
06/23/2020	DATE
C. DURKIN	DRAWN BY

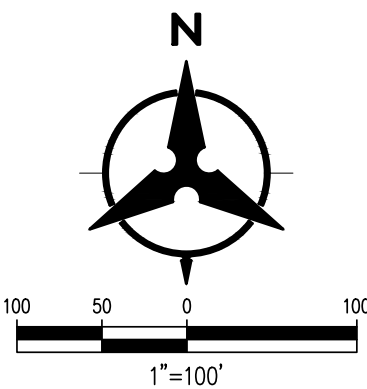

06/23/2020  
CPESC Stamp



INLET PROTECTION

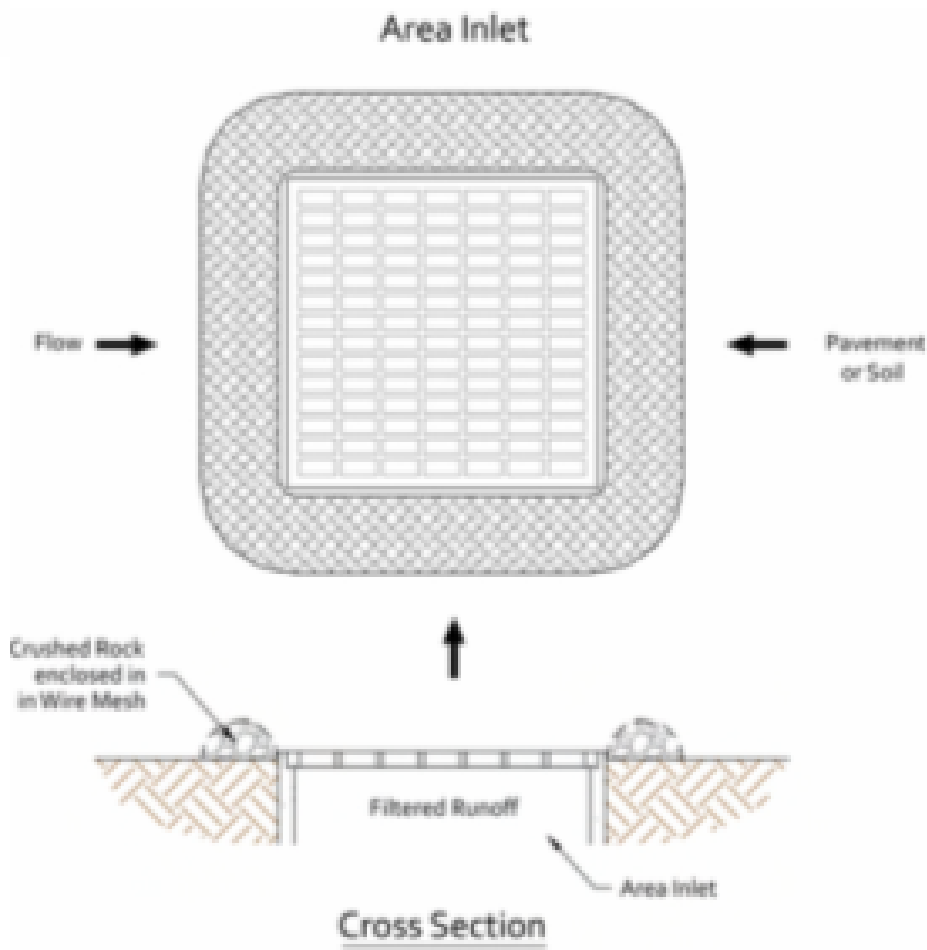

BMP Objectives

- Sediment Control
- Sheet Flow Runoff Control

SILT FENCE



BMP Objectives

- Sediment Control
- Sheet Flow Runoff Control
- Wind Erosion Control

SEDIMENT TRACK OUT CONTROL



BMP Objectives

- Sediment Control

MULCH SOCK/STRAW WATTLE



BMP Objectives

- Sediment Control
- Reduce Runoff Velocity
- Inlet Protection

BERMS AND SWALES



BMP Objectives

- Runoff Control
- Run-on Diversion

EROSION CONTROL NOTES  
ESC Plan Standard Notes (2020-06-03)

1.All Erosion and Sediment Control (ESC) work on these plans, except as otherwise stated or provided hereon shall be permitted, constructed, inspected, and maintained in accordance with:

a.The City Ordinance § 14-5-2-11, the ESC Ordinance,

b.The EPA's 2017 Construction General Permit (CGP), and

c.The City Of Albuquerque Construction BMP Manual.

2.All BMP's must be installed prior to beginning any earth moving activities except as specified hereon in the Phasing Plan. Construction of earthen BMP's such as sediment traps, sediment basins, and diversion berms shall be completed and inspected prior to any other construction or earthwork. Self-inspection is required after installation of the BMPs and prior to beginning construction.

3.Self-inspections - At a minimum a routine compliance self-inspection is required to review the project for compliance with the Construction General Permit once every 14 days and after any precipitation event of 1/4 inch or greater until the site construction has been completed and the site determined as stabilized by the city. Reports of these inspections shall be kept by the person or entity authorized to direct the construction activities on the site.

4.BMPs shall be inspected and maintained until all disturbed areas are stabilized in accordance with the Final Stabilization Criteria (CGP 2.2.14.b). Generally, all disturbed areas, other than structures, must have uniform perennial vegetation that provides 70 percent or more of the cover provided by native vegetation or seed the disturbed area and provide non-vegetative mulch that provides cover for at least three years without active maintenance. Final stabilization must be documented on prior to removal of BMPs and discontinuation of inspections.

RECEIVING WATERS: WATER QUALITY PONDS VIA ALBUQUERQUE MS4

CRITICAL HABITAT: CRITERION "A": NO CRITICAL HABITATS WITHIN PROJECT AREA

GPS LOCATION: 35.0797, -106.7418

98th & BLUEWATER

PROJECT TITLE

ALBUQUERQUE, BERNALILLO COUNTY, NM

CITY, COUNTY, STATE

06/23/2020

DATE

C. DURKIN

DRAWN BY



06/23/2020

CPESC Stamp

