

**Sprinkler System:**  
1) Shop drawings will be submitted to the fire marshal's office for review and approval of any installation or modification to fire sprinkler system, fire alarm system, kitchen suppression system, or any other fire related system.  
2) The fire sprinkler system will be supervised when required by the 2015 International fire code.

Parking and drive aisle for fire apparatus access roads shall have an asphalt, concrete, or other approved driving surface capable of supporting the imposed load of fire apparatus weighing at least 75,000 pounds. Contractor to provide engineer data for approval.

Fire lane shall not exceed 10% in grade

### Fire Flow Requirements

Building  
Construction Type IIb Occupancy na

Square Footage = 17,400 sq.ft. (4,350 sq.ft. per building) Fire Flow = 1,500 GPM - 2 Hr.

1 Hydrants required 250'

Building Single Story

Kox Box - Provided  
PIV - Not required  
FDC - Not required

### SECTION 906: PORTABLE FIRE EXTINGUISHERS

Provide (1)2-A extinguisher all areas:  
1 Extinguisher required per 3,000 sq.ft.  
max travel distance = 75 feet

PROJECT AREA: ALBUQUERQUE FIRE MARSHAL'S DIVISION OFFICE PLANS CHECKING DIVISION

Construct for: **PERMIT**

PROJECT LOCATION: **PERMIT NUMBER:** FP-22-011512 **APPROVED DATE:** 09/23/22

PROJECT: **APPROVED**

9561 / 9551 ALBUQUERQUE FIRE MARSHAL'S DIVISION OFFICE PLANS CHECKING DIVISION

THESE CONSTRUCTION DOCUMENTS WERE REVIEWED AND APPROVED BY THE ALBUQUERQUE FIRE MARSHAL'S DIVISION OFFICE PLANS CHECKING DIVISION IN ACCORDANCE WITH THE CITY OF ALBUQUERQUE, NEW MEXICO, INTERNATIONAL FIRE CODE, AND NFPA STANDARDS. THIS REVIEW IS LIMITED TO 10 DAYS. FINAL INSPECTION IS REQUIRED.

**FIRE FLOW:** Fire Flow 1500 GPM 1 fire hydrant

APPLICABLE CODES

2015 International Building Code  
2015 Uniform Plumbing Code  
2015 Uniform Mechanical Code  
2017 National Electrical Code  
2018 International Energy Conservation Code

### ZONING

NR-BP

### PARKING REQUIREMENTS

Building #1	1/4,495 GSF (Warehouse)	=5
Building #2	1/4,495 GSF (Warehouse)	=5
Building #3	1/4,495 GSF (Warehouse)	=5
Building #4	1/4,495 GSF (Warehouse)	=5
Total Spaces required		=20
Total Spaces required		= 68
ADA		= 4 (1 Van)
Motorcycle		= 6
Bicycle		= 3
Total Spaces Required		= 20
Total Spaces Provided		= 68

### PROJECT AREA

VANILLA SHELL = NA (NON- Sprinkled)

ALLOWABLE AREA = NA

### IBC CHAPTER 9: FIRE PROTECTION

NO AUTOMATIC SPRINKLER SYSTEM

### IBC CHAPTER 10: MEANS OF EGRESS

OCCUPANCY LOAD (na) per table 1004.1.2

AREA NA S.F. OCC. LOAD FACTOR No. OCCUPANTS

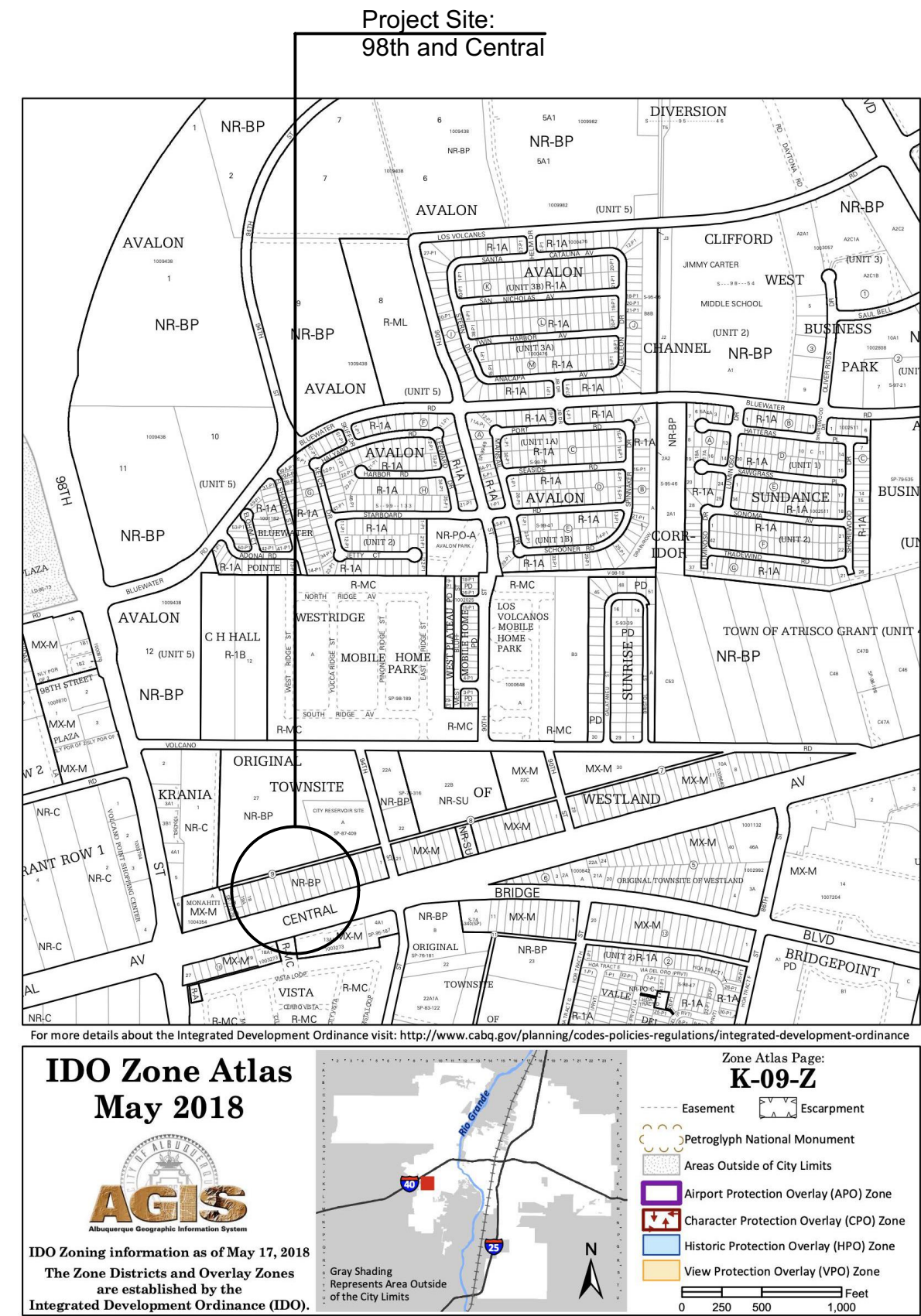

TREVESTON ELLIOTT

ARCHITECT

811 12TH ST. NW  
ALBUQUERQUE, NEW MEXICO  
87102  
C 505.259.4617  
treveston@trevestonarchitect.com  
www.trevestonarchitect.com

98th and Central

CONCEPT STUDY

ALBUQUERQUE, NEW MEXICO

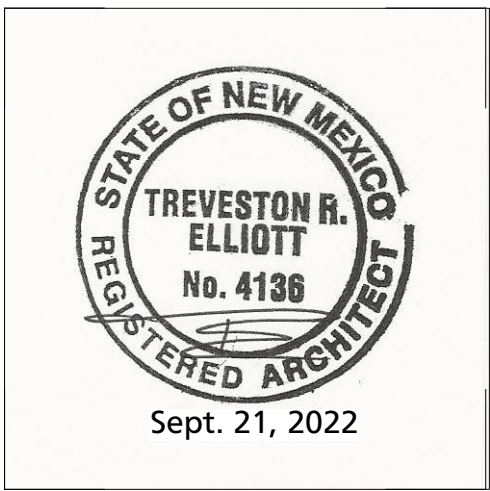

Date: Sept. 21, 2022

Sheet: Fire-1

Fire-1