

CITY OF ALBUQUERQUE

Planning Department
Alan Varela, Director



Mayor Timothy M. Keller

August 15, 2024

Edgar Mata
Jeebs & Zuzu, LLC
5924 Anaheim Ave. NE
Albuquerque, NM 87113

**Re: Casitas Del Camino
60th Street NW
Traffic Circulation Layout**
Engineer's Stamp Dated 3-15-24 (K11D005A)

Dear Mr. Mata,

The TCL submittal received 8-15-2024 is approved for Building Permit by Transportation. A copy of the stamped and signed plan will be needed for each of the building permit plans. Please keep the original to be used for certification of the site for final C.O. for Transportation.

When the site construction is completed and an inspection for Certificate of Occupancy (C.O.) is requested, use the original City stamped approved TCL for certification. Redline any minor changes and adjustments that were made in the field. A NM registered architect or engineer must stamp, sign, and date the certification TCL along with indicating that the development was built in "substantial compliance" with the TCL. Submit this certification, the TCL, and a completed Drainage and Transportation Information Sheet to the PLNDRS@cabq.gov for log in and evaluation by Transportation. **AN APPROVED PLAT IS A CONDITION OF RELEASING FINAL CO.**

Once verification of certification is completed and approved, notification will be made to Building Safety to issue Final C.O. To confirm that a final C.O. has been issued, call Building Safety at 924-3690.

Sincerely,

Sertil A. Kanbar

Sertil Kanbar, PhD, PE, CFM
Sr. Engineer, Planning Dept.
Development Review Services

C: CO Clerk, File



City of Albuquerque

Planning Department
Development & Building Services Division

DRAINAGE AND TRANSPORTATION INFORMATION SHEET (DTIS)

Project Title: _____ Hydrology File # _____

Legal Description: _____

City Address, UPC, OR Parcel: _____

Applicant/Agent: _____ Contact: _____

Address: _____ Phone: _____

Email: _____

Applicant/Owner: _____ Contact: _____

Address: _____ Phone: _____

Email: _____

TYPE OF DEVELOPMENT: Plat (# of lots) _____ Single Family Home
All other Developments

RE-SUBMITTAL: YES NO

DEPARTMENT: TRANSPORTATION HYDROLOGY/DRAINAGE

Check all that apply under Both the Type of Submittal and the Type of Approval Sought:

TYPE OF SUBMITTAL:

Engineering / Architect Certification
Conceptual Grading & Drainage Plan
Grading & Drainage Plan, and/or Drainage Report
Drainage Report (Work Order)
Drainage Master Plan
Conditional Letter of Map Revision (CLOMR)
Letter of Map Revision (LOMR)
Floodplain Development Permit
Traffic Circulation Layout (TCL) – Administrative
Traffic Circulation Layout (TCL) – DFT Approval
Traffic Impact Study (TIS)
Street Light Layout
OTHER (SPECIFY) _____

TYPE OF APPROVAL SOUGHT:

Pad Certification
Building Permit
Grading Permit
Paving Permit
SO-19 Permit
Foundation Permit
Certificate of Occupancy - Temp Perm
Preliminary / Final Plat
Site Plan for Building Permit - DFT
Work Order (DRC)
Release of Financial Guarantee (ROFG)
CLOMR / LOMR
Conceptual TCL - DFT
OTHER (SPECIFY) _____

DATE SUBMITTED: _____

ZONE ATLAS:

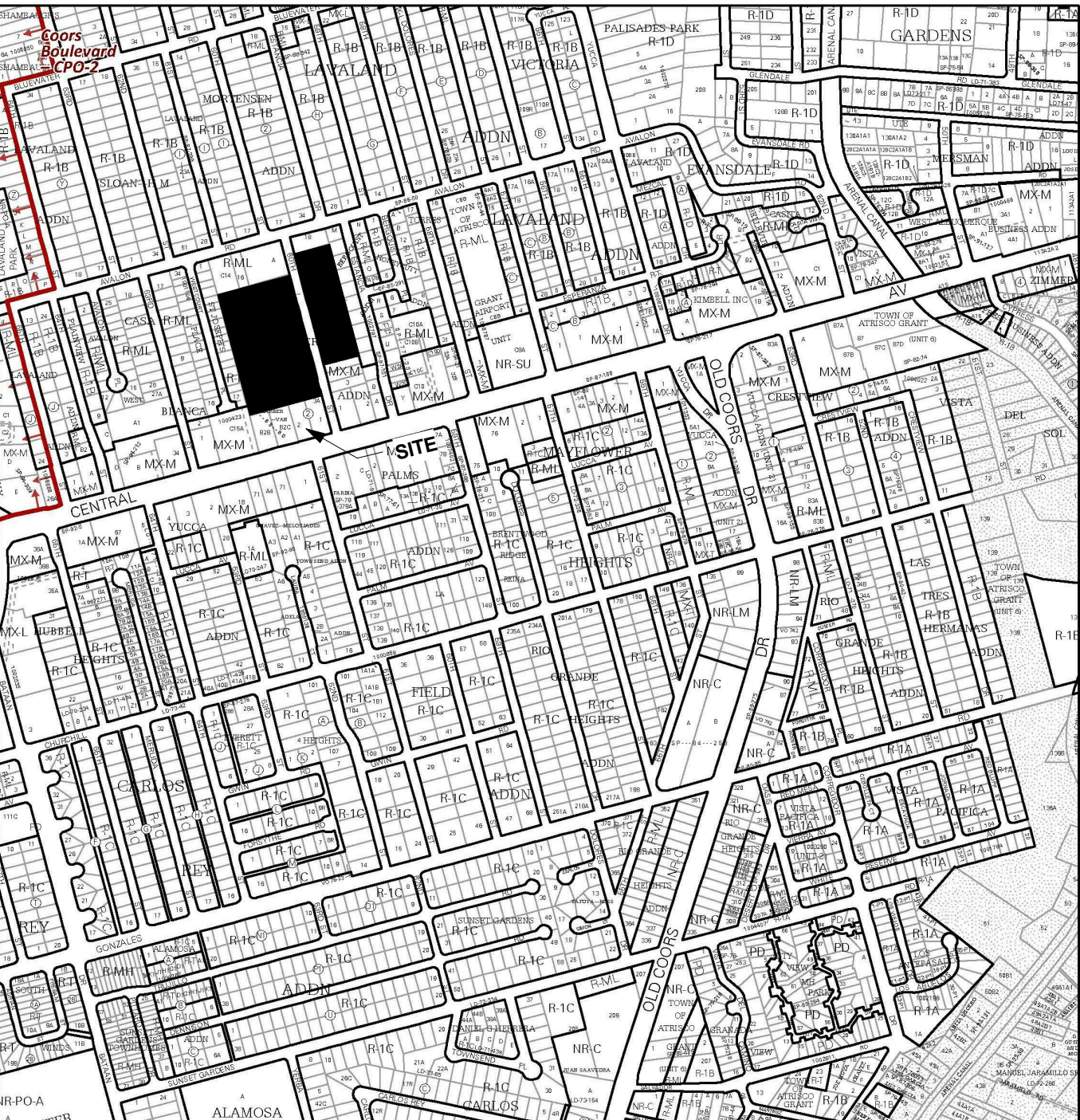

IDO Zone Atlas
May 2018

AGIS
Albuquerque Geographic Information System

IDO Zoning Information as of May 17, 2018
The Zone Districts and Overlay Zones are established by the Integrated Development Ordinance (IDO).

Zone Atlas Page: **K-11-Z**

Legend:
--- Easement
--- Escarpment
Petroglyph National Monument
Areas Outside of City Limits
Airport Protection Overlay (APO) Zone
Character Protection Overlay (CPO) Zone
Historic Protection Overlay (HPO) Zone
View Protection Overlay (VPO) Zone

Gray Shading Represents Area Outside of the City Limits

Scale: 0 250 500 1,000 Feet

PROJECT INFORMATION:

LEGAL DESCRIPTION

LOTS NUMBERED ONE (1) THROUGH FIFTEEN (15), INCLUSIVE, AND LOTS SEVENTEEN (17) THROUGH THIRTY TWO (32), INCLUSIVE, OF THE PATILLY SUBDIVISION, AS THE SAME IS SHOWN AND DESIGNATED ON THE PLAT THEREOF FILED IN THE OFFICE OF THE COUNTY CLERK OF BERNALILLO COUNTY, NEW MEXICO ON MAY 1, 1981 IN MAP BOOK C18, FOLIO 64.

OCCUPANCY TYPE: R2 - 46 UNITS
CONSTRUCTION TYPE: TYPE 5B
AUTOMATIC SPRINKLER SYSTEM: NFPA 13.R
BUILDING HEIGHT: 24' - 0" FEET
NUMBER OF FLOORS: 2 FLOORS
LOT AREA: 142,935 SF | 3.2 ACRES
UNIT MIX REHAB:

THREE BEDROOM	32
FOUR BEDROOM	10
NEW CONSTRUCTION:	
TWO BEDROOM	30
THREE BEDROOM	16
TOTAL UNITS	88

PARKING SPACES:
PARKING REQUIREMENTS PER INTEGRATED DEVELOPMENT ORDINANCE (IDO) SECTION 5/5(B) APPLICABILITY-
UPDATED PARKING REQUIREMENTS PER IDO 1.5 PARKING SPACE PER UNIT
25% OF TOTAL PARKING SPACES MAY BE COMPACT PER IDO STANDARDS
REQUIRED:
PROVIDED:

132 SPACES
45 COMPACT SPACES
132 STANDARD SPACES
9 HANDICAP SPACES
8 ELECTRIC CHARGING STATIONS
194 SPACES PROVIDED

	(gross)	(net)	Subtotal (gross)	Subtotal (net)
NEW CONSTRUCTION UNITS:				
BLDG TYP 1:				
2 Bd Unit (2 per building)	984 sf	904 sf	1,968 sf	1,826 sf
No. Buildings = 3			5,904 sf	5,478 sf
BLDG TYP 2:				
2 Bd Unit (8 per building)	993 sf	907 sf	7,944 sf	7,256 sf
No. Buildings = 3			23,832 sf	21,768 sf
BLDG TYP 3:				
3 Bd Unit (8 per building)	1,250 sf	1,093 sf	10,000 SF	8,744 SF
No. Buildings = 2			20,000 SF	17,488 SF
REHABILITATION UNITS:				
BLDG TYP 4:				
3 Bd Unit (2 per building)	1,097 sf	982 sf	2,194 sf	1,964 sf
No. Buildings = 16			35,104 sf	31,424 sf
BLDG TYP 5:				
4 Bd Unit (1 per building)	1,371 sf	1,227 sf	1,371 sf	1,227 sf
No. Buildings = 10			13,710 sf	12,270 sf

Total New Construction 49,064 sf 44,734 sf
Total Rehab 48,814 sf 43,694 sf
Total Building 98,550 sf 88,428 sf

Community Building 2,052 sf 1,576 sf

Total Project Area 100,602 sf 90,004 sf

- GENERAL NOTES:**
1. ALL CONSTRUCTION SHALL BE IN ACCORDANCE WITH IBC 2015, UMC 2015, UPC 2015, NEC 2017, ANSI A117.1-2009 AND IN ACCORDANCE WITH LOCAL PERMIT REQUIREMENTS. SUBCONTRACTORS SHALL VERIFY LOCAL REQUIREMENTS.
 2. ALL UTILITIES (PRIVATE AND PUBLIC) AND ACCESS CONNECTIONS SHALL BE COORDINATED, FEES PAID AND CONSTRUCTION INSTALLED AS REQUIRED BY GOVERNING AGENCIES OR COMPANY. EACH SUBCONTRACTOR SHALL BE RESPONSIBLE FOR OBTAINING SPECIFIC PERMIT, APPROVALS AND PAYING ALL FEES AND TAXES.
 3. ALL BROKEN AND CRACKED SIDEWALK MUST BE REPLACED WITH SIDEWALK AND CURB AND GUTTER AND PER CITY STANDARD DWG 2430 AND 2415A.
 4. ASPHALT PAVING SECTIONS SHALL BE CONSTRUCTED IN ACCORDANCE WITH RECOMMENDATIONS PROVIDED BY SOILS ENGINEER

**TRAFFIC CIRCULATION
LAYOUT APPROVED**

Sertil A. Kanbar 8/15/24

**AN APPROVED PLAT IS A CONDITION
OF RELEASING FINAL CO.**

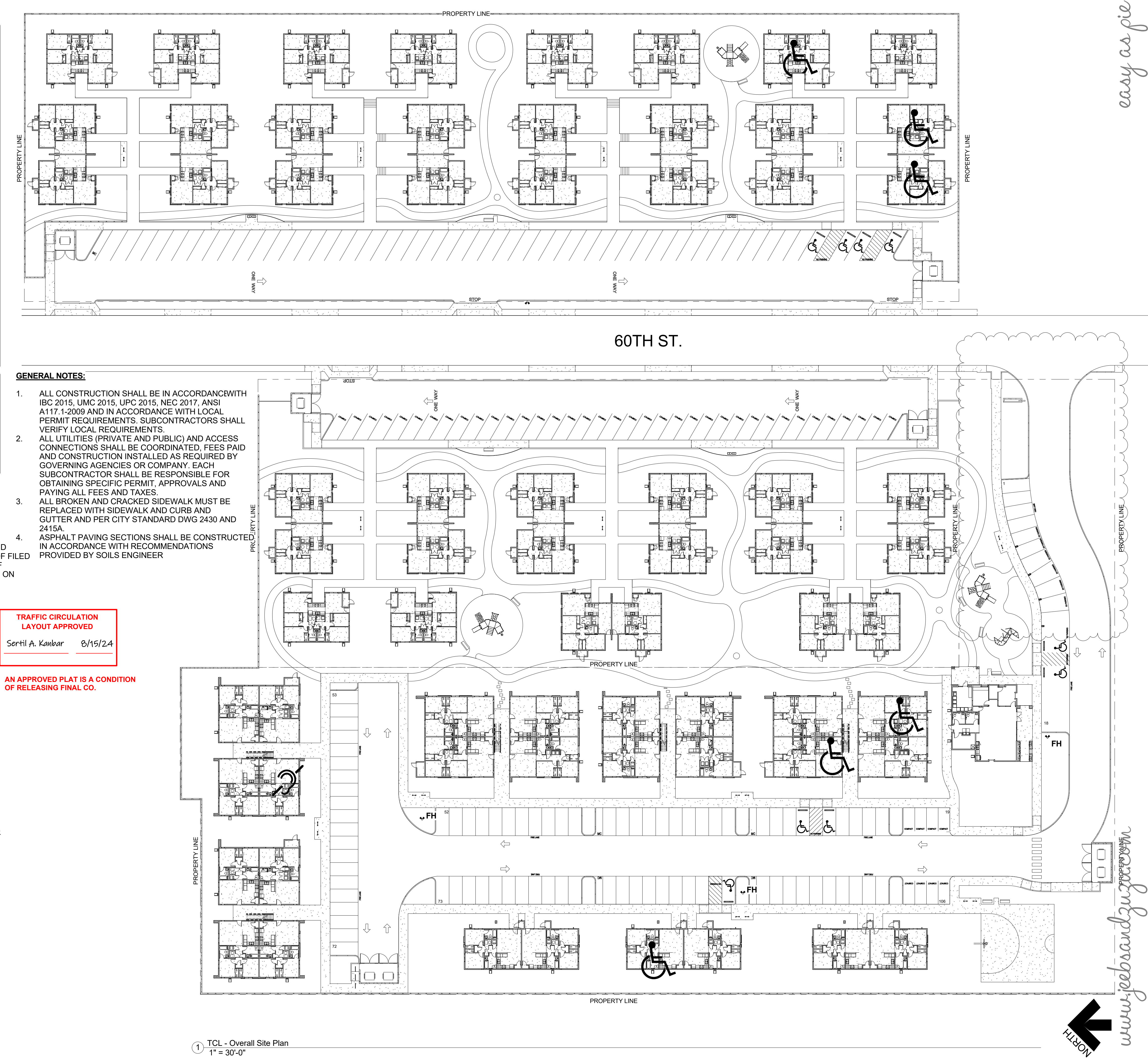

1 TCL - Overall Site Plan
1" = 30'-0"

easy as pie



JEEBS & ZUZU, LLC.

5924 ANAHEIM AVENUE NE SUITE A
ALBUQUERQUE, NM 87113
P: 505-797-1318

**Architecture
Construction
Design-Build**

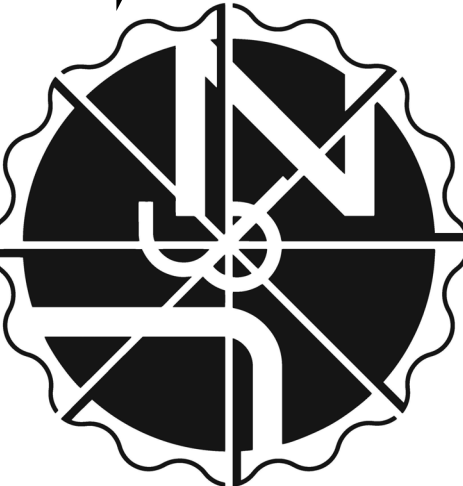

job no: -

drawn: EAM

checked: J&Z

date: Aug. 14, 2024

CASTAS DEL CAMINO

60th Street NW
Albuquerque, NM 87105

sheet no:
TCL1.0

OVERALL SITE PLAN

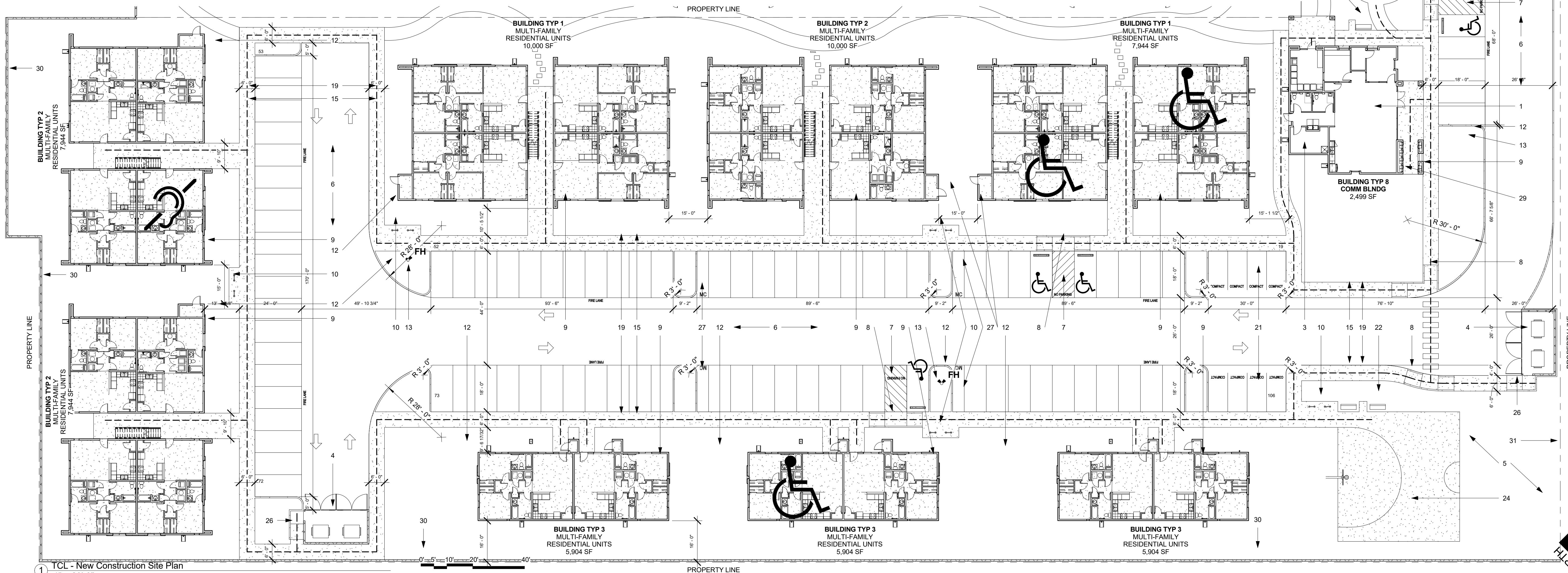

TRAFFIC CIRCULATION
LAYOUT APPROVED

Sertil A. Kanbar 8/15/24

AN APPROVED PLAT IS A CONDITION
OF RELEASING FINAL CO.

SITE PLAN LEGEND:

1. COMMUNITY BUILDING
2. MONUMENT SIGN - SEE DETAIL
3. MAINTENANCE RM
4. GARBAGE ENCLOSURE W/ GATES - SEE DETAILS 1-4/TCL2.0 FOR GARBAGE ENCLOSURE NOTES AND DIMENSIONS
5. DRAINAGE POND
6. ASPHALT DRIVEWAY - DRIVE AISLE: 2.5" ASPHALT PAVEMENT OVER 4" COMPACTED ROADWAY BASECOURSE. DRIVE SHALL BE DESIGNED AND CONSTRUCTED CAPABLE OF SUPPORTING THE IMPOSED LOAD OF FIRE APPRATUS WEIGHING AT LEAST 75,000 POUNDS. - DRIVE SHALL NOT EXCEED 10% GRADE. - SEE DETAIL 12/TCL2.0
7. ADA PARKING W/ PRECAST CONCRETE WHEEL STOPS - PLEASE SEE DETAIL 11 & 14/TCL2.0 FOR ADA PARKING SPACE DIMENSIONS.
8. ADA CURB RAMP - SEE DETAIL 14/TCL2.0 FOR CURB RAMP SLOPES AND DIMENSIONS
9. BUILDING IDENTIFIER SIGN TO BE ILLUMINATED FROM DUSK TO DAWN
10. (12) BICYCLE RACK ARCHES (24 SPACES) PER 7.4.115 OF CITY OF ALBUQUERQUE DPM. SEE DETAILS 6 & 15/TCL2.0
11. SIGHT TRIANGLE PER DPM TABLE 7.5.60 - LANDSCAPING, FENCING AND SIGNING WILL NOT INTERFERE W/ CLEAR SIGHT REQUIREMENTS. THEREFORE, SIGNS, WALLS, TREES, & SHRUBBERY BETWEEN 3 & 8 FEET TALL (AS MEASURED FROM THE GUTTER PAN) WILL NOT BE ACCEPTABLE IN THE CLEAR SIGHT TRIANGLE.
12. POST INDICATOR VALVE
13. FIRE HYDRANT
14. DETECTABLE WARNING STRIP & PUBLIC CURB RAMP. SEE DETAILS ON SHEET TCL2.1
15. ACCESSIBLE ROUTE FROM ADA PARKING TO BUILDING CORRIDOR
16. N/A
17. 16' POLE MOUNTED SITE LED DOWNLIGHT W/ CUTOFF - LIGHTING TO BE DESIGNED BY ELECTRICAL ENGINEER AND SHALL BE COMPLIANT W/ ABQ NIGHT SKY ORDINANCE.
18. NEW STOP SIGNAGE - SEE DETAIL 16/TCL2.0
19. NEW 6" CAST IN PLACE CONCRETE SIDEWALK - CROSS SLOPE NOT TO EXCEED 2%. SEE DETAILS 12 & 13.
20. NEW PUBLIC SIDEWALK TO TIE INTO EXISTING PUBLIC SIDEWALK. COORDINATE SIDEWALK PLACEMENT PER CITY OF ALBUQUERQUE WORK ORDER.
21. COMPACT PARKING - SEE DETAIL 5/TCL2.0 FOR ALL PARKING DIMENSIONS.
22. ALL WEATHER PERMANENT MOUNTED BENCH W/ 30"x48" LEVEL CONCRETE PAD AT ONE SIDE FOR ADA ACCESS. SEE DETAIL 7 / TCL2.0
23. ADA PLAYGROUND AND TOT LOT PER MFA STANDARDS
24. NEW BASKETBALL COURT
25. A MINIMUM OF 10 OF THESE PARKING SPACES TO BE LABELED AS "ELECTRIC VEHICLE PARKING" CHARGING STATIONS ARE TO HAVE A MIN. OF 240 V RATING. SEE DETAIL 5/AS2.1 FOR PARKING STALL DIMENSIONS
26. ADA CURB RAMP AT REFUSE ENCLOSURES
27. MOTORCYCLE PARKING - SEE 5/TCL2.0 FOR TYP. DIMENSIONS
28. REMOVE EXISTING DRIVE PAD AND RECONSTRUCT A NEW SIDEWALK AND CURB AND GUTTER PER CABQ DWG 2415C, 2430, & 2432.
29. MAIL CENTER
30. NEW 6'-0" HIGH CMU WALL AT NORTH AND WEST PROPERTY LINES.
31. NEW 6'-0" HIGH FENCE AT SOUTH PROPERTY LINE.

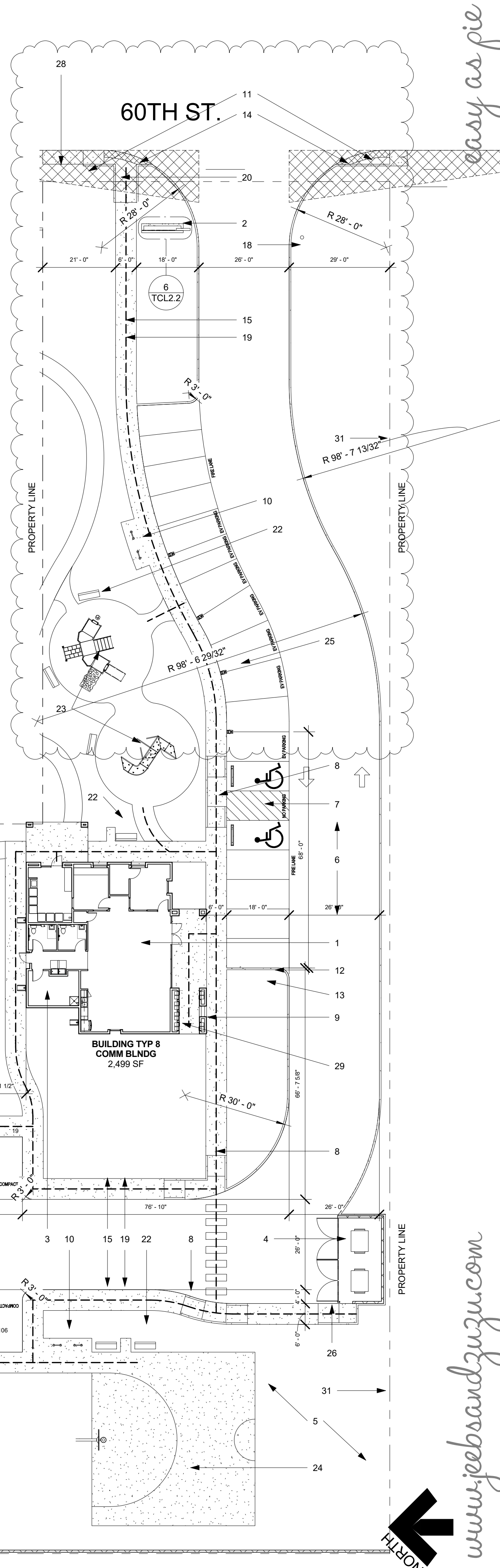

JEEBS & ZUZU, LLC.
*Architecture
Construction
Design-Build*

job no: -

drawn: EAM

checked: J&Z

date: Aug. 14, 2024

NEW CONSTRUCTION SITE PLAN

CASITAS DEL CAMINO

60th Street NW
Albuquerque, NM 87105

sheet no: **TCL1.1**

www.jeebsandzuzu.com

easy as pie

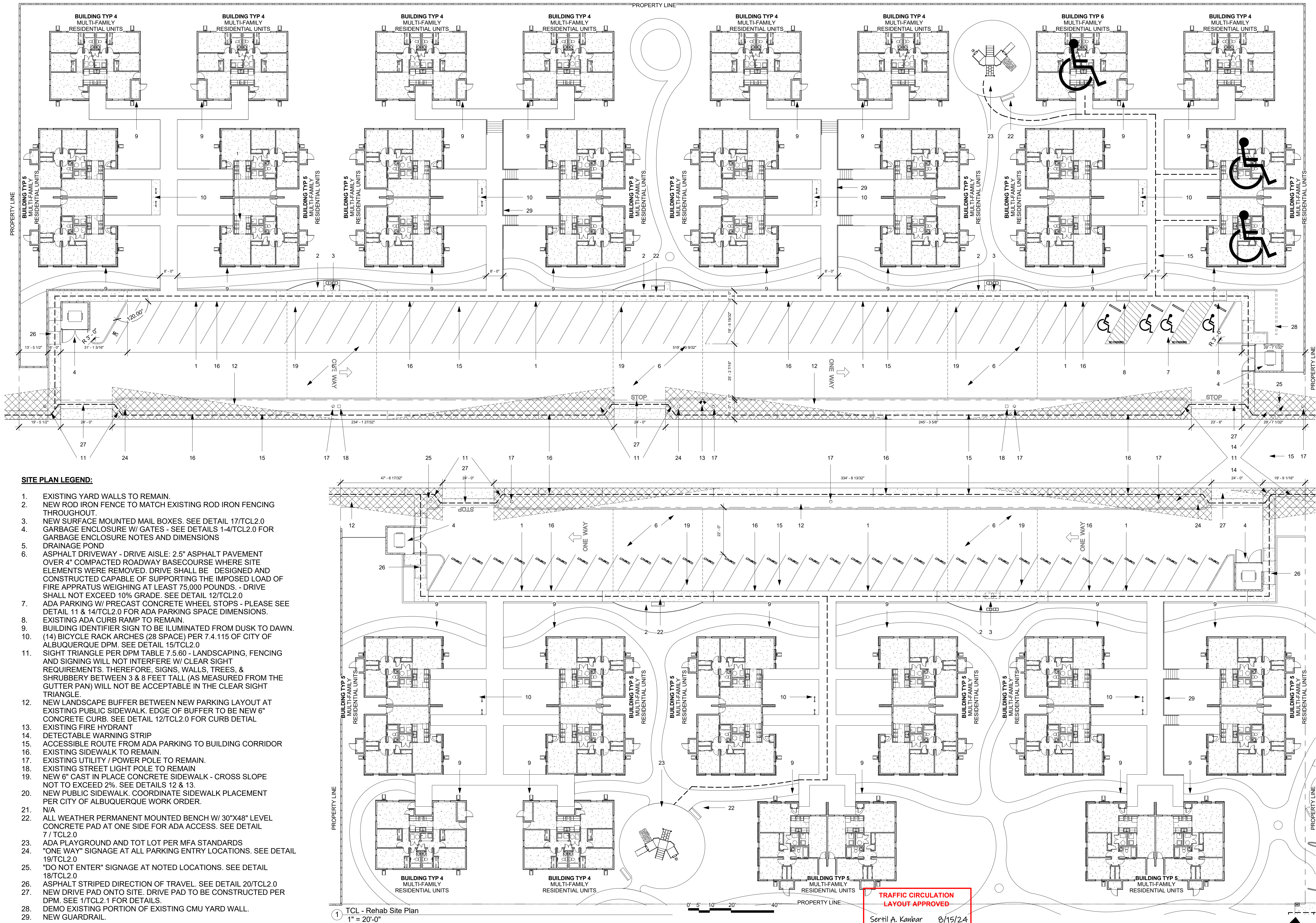

SITE PLAN LEGEND:

- EXISTING YARD WALLS TO REMAIN.
- NEW ROD IRON FENCE TO MATCH EXISTING ROD IRON FENCING THROUGHOUT.
- NEW SURFACE MOUNTED MAIL BOXES. SEE DETAIL 17/TCL2.0
- GARBAGE ENCLOSURE W/ GATES - SEE DETAILS 1-4/TCL2.0 FOR GARBAGE ENCLOSURE NOTES AND DIMENSIONS
- DRAINAGE POND
- ASPHALT DRIVEWAY - DRIVE AISLE: 2.5" ASPHALT PAVEMENT OVER 4" COMPACTED ROADWAY BASECOURSE WHERE SITE ELEMENTS WERE REMOVED. DRIVE SHALL BE DESIGNED AND CONSTRUCTED CAPABLE OF SUPPORTING THE IMPOSED LOAD OF FIRE APPRATUS WEIGHING AT LEAST 75,000 POUNDS. - DRIVE SHALL NOT EXCEED 10% GRADE. SEE DETAIL 12/TCL2.0
- ADA PARKING W/ PRECAST CONCRETE WHEEL STOPS - PLEASE SEE DETAIL 11 & 14/TCL2.0 FOR ADA PARKING SPACE DIMENSIONS. EXISTING ADA CURB RAMP TO REMAIN.
- BUILDING IDENTIFIER SIGN TO BE ILLUMINATED FROM DUSK TO DAWN. (14) BICYCLE RACK ARCHES (28 SPACE) PER 7.4.115 OF CITY OF ALBUQUERQUE DPM. SEE DETAIL 15/TCL2.0
- SIGHT TRIANGLE PER DPM TABLE 7.5.60 - LANDSCAPING, FENCING AND SIGNING WILL NOT INTERFERE W/ CLEAR SIGHT REQUIREMENTS. THEREFORE, SIGNS, WALLS, TREES, & SHRUBBERY BETWEEN 3 & 8 FEET TALL (AS MEASURED FROM THE GUTTER PAN) WILL NOT BE ACCEPTABLE IN THE CLEAR SIGHT TRIANGLE.
- NEW LANDSCAPE BUFFER BETWEEN NEW PARKING LAYOUT AT EXISTING PUBLIC SIDEWALK. EDGE OF BUFFER TO BE NEW 6" CONCRETE CURB. SEE DETAIL 12/TCL2.0 FOR CURB DETAIL
- EXISTING FIRE HYDRANT
- DETECTABLE WARNING STRIP
- ACCESSIBLE ROUTE FROM ADA PARKING TO BUILDING CORRIDOR
- EXISTING SIDEWALK TO REMAIN.
- EXISTING UTILITY / POWER POLE TO REMAIN.
- EXISTING STREET LIGHT POLE TO REMAIN.
- NEW 6" CAST IN PLACE CONCRETE SIDEWALK - CROSS SLOPE NOT TO EXCEED 2%. SEE DETAILS 12 & 13.
- NEW PUBLIC SIDEWALK. COORDINATE SIDEWALK PLACEMENT PER CITY OF ALBUQUERQUE WORK ORDER.
- N/A
- ALL WEATHER PERMANENT MOUNTED BENCH W/ 30"x48" LEVEL CONCRETE PAD AT ONE SIDE FOR ADA ACCESS. SEE DETAIL 7 / TCL2.0
- ADA PLAYGROUND AND TOT LOT PER MFA STANDARDS
- "ONE WAY" SIGNAGE AT ALL PARKING ENTRY LOCATIONS. SEE DETAIL 19/TCL2.0
- "DO NOT ENTER" SIGNAGE AT NOTED LOCATIONS. SEE DETAIL 18/TCL2.0
- ASPHALT STRIPED DIRECTION OF TRAVEL. SEE DETAIL 20/TCL2.0
- NEW DRIVE PAD ONTO SITE. DRIVE PAD TO BE CONSTRUCTED PER DPM. SEE 1/TCL2.1 FOR DETAILS.
- DEMO EXISTING PORTION OF EXISTING CMU YARD WALL.
- NEW GUARDRAIL.

1 TCL - Rehab Site Plan
1" = 20'-0"

TRAFFIC CIRCULATION
LAYOUT APPROVED
Sortil A. Kanbar 8/15/24

AN APPROVED PLAT IS A CONDITION
OF RELEASING FINAL CO.

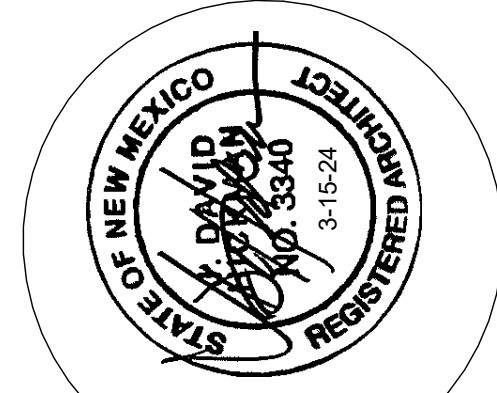

JEEBS & ZUZU, LLC.

5924 ANAHEIM AVENUE NE SUITE A
ALBUQUERQUE, NM 87113
P. 505-797-1318

**Architecture
Construction
Design-Build**

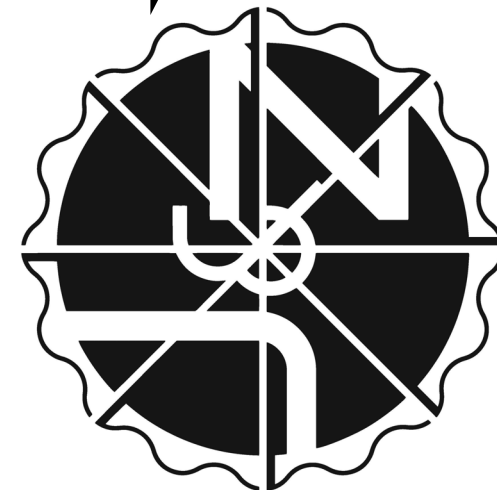

job no: -
drawn: EAM
checked: J&Z
date: Aug. 14, 2024

CASITAS DEL CAMINO

60th Street NW
Albuquerque, NM 87105

sheet no:

TCL1.2

REHAB SITE PLAN

www.jeebsandzuzu.com

easy as pie

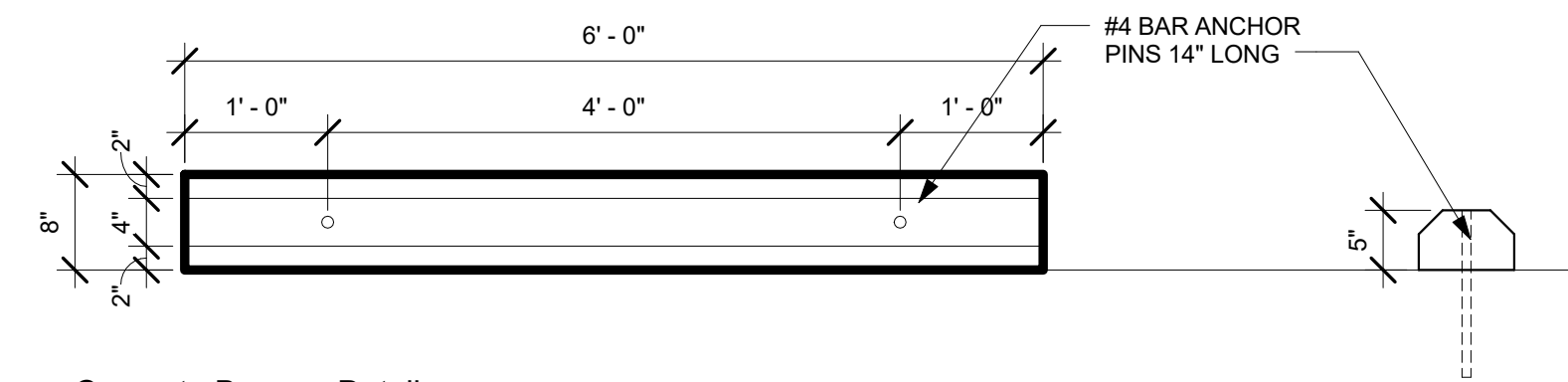

14 Concrete Bumper Detail
3/4" = 1'-0"

GENERAL NOTES:

- CROSS SLOPE NOT TO EXCEED 1:48
- SIDEWALK SLOPE NOT TO EXCEED 1:20

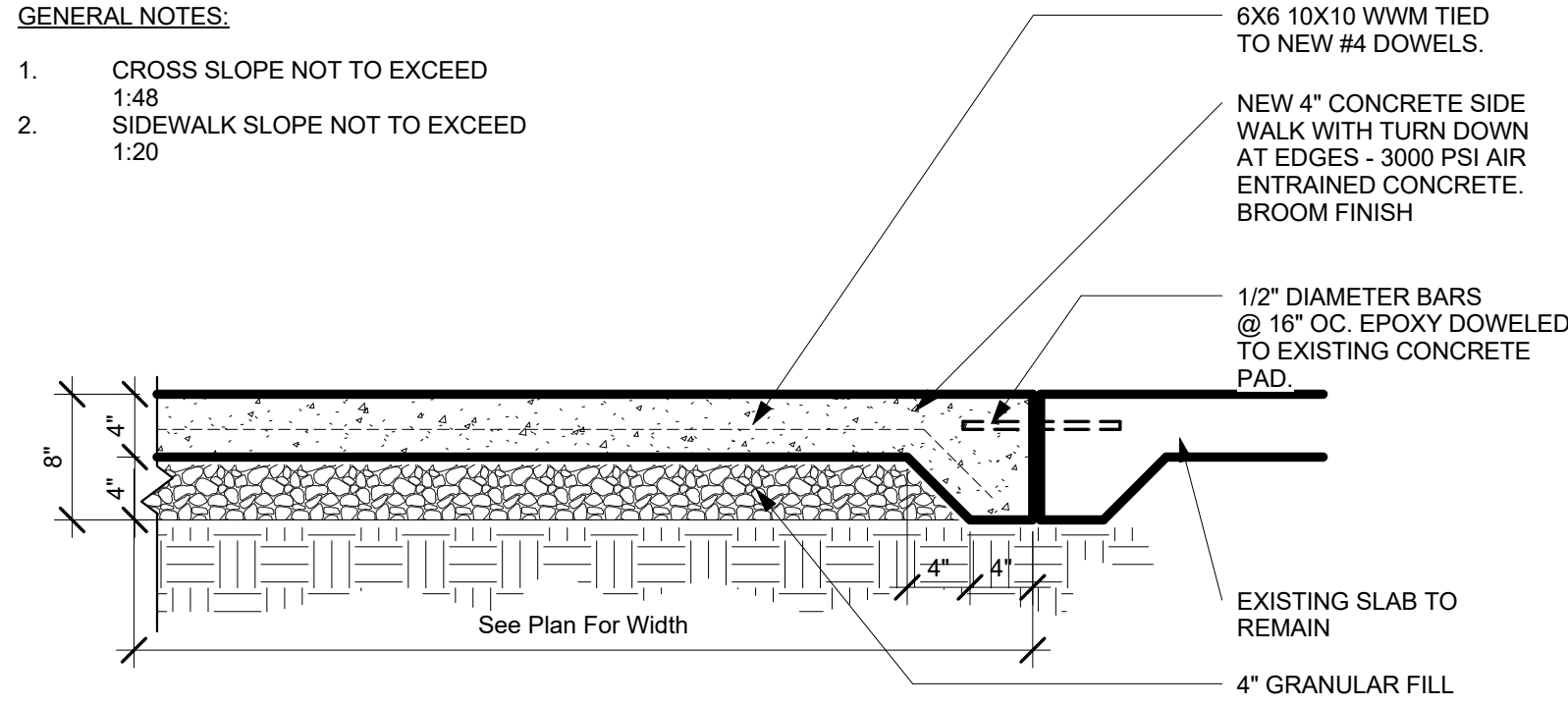

13 Sidewalk Detail
1" = 1'-0"

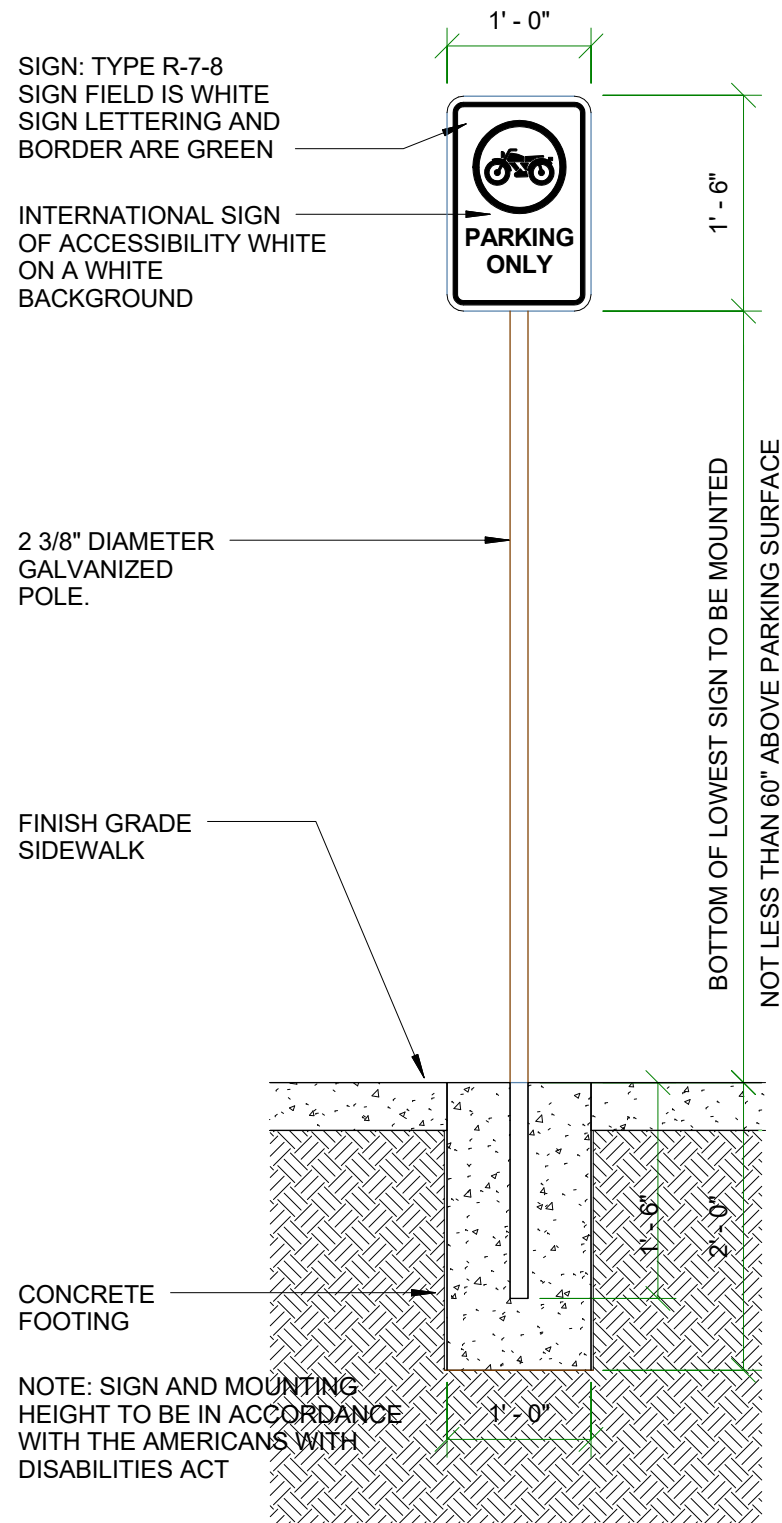

8 Motorcycle Parking Sign
3/4" = 1'-0"

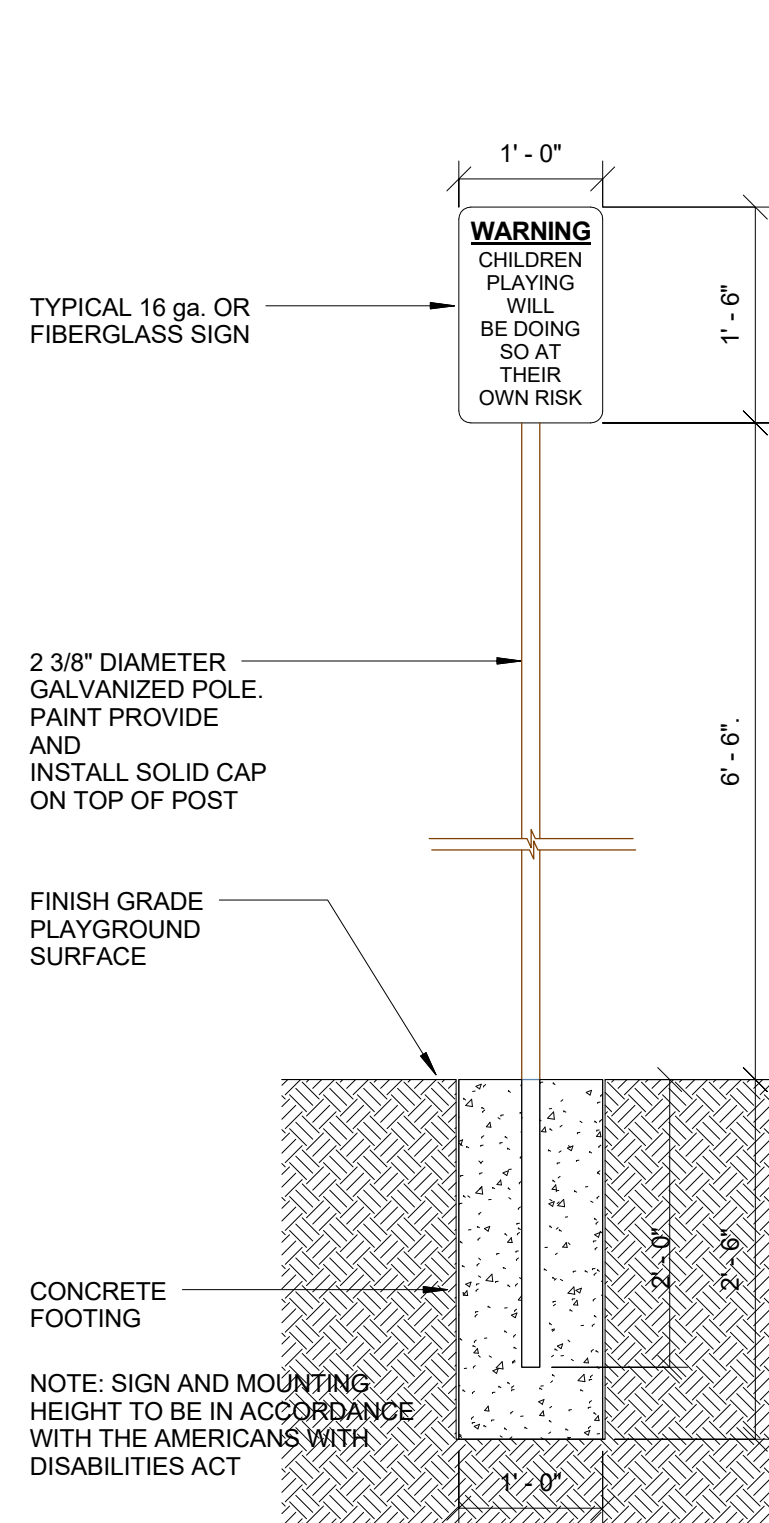

9 Playground Warning Sign
3/4" = 1'-0"

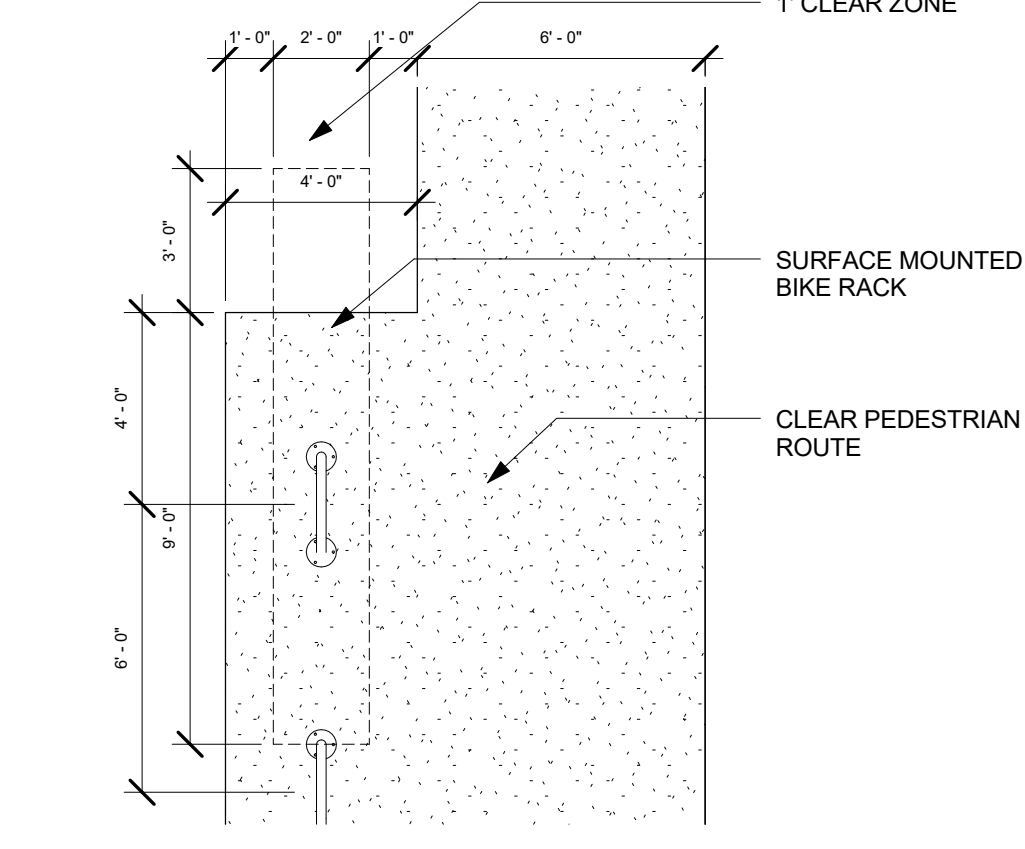

15 Bike Rack Detail
1/4" = 1'-0"

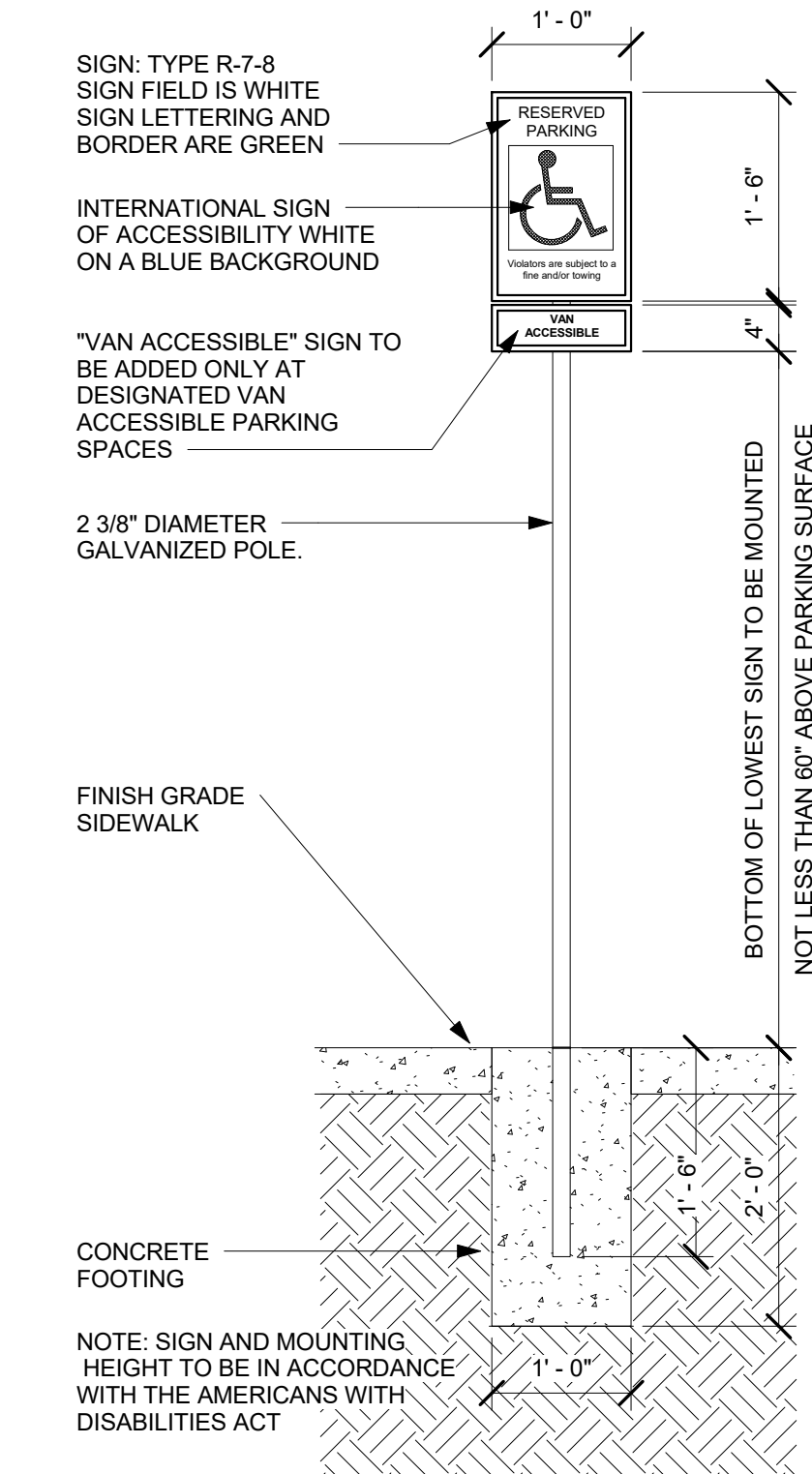

10 Handicap Parking Sign
3/4" = 1'-0"

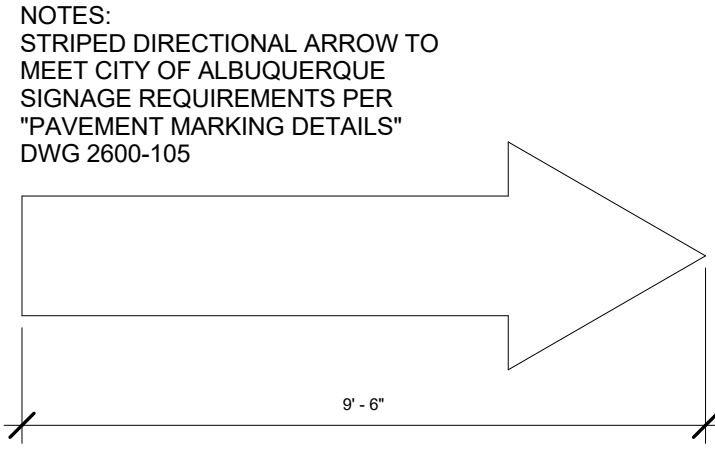

20 Arrow Asphalt Striping
3/8" = 1'-0"

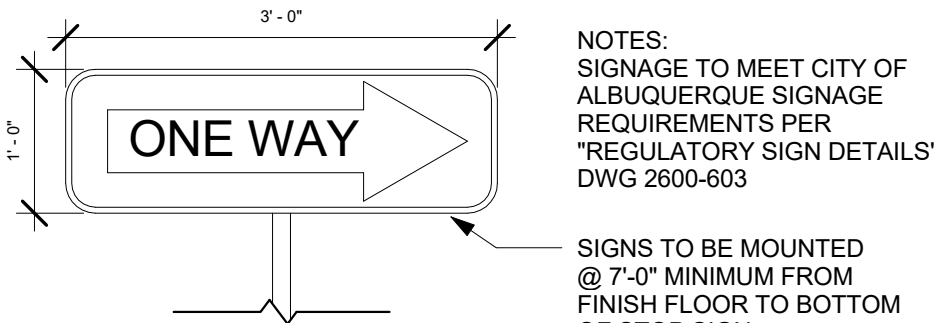

19 ONE WAY Sign Detail
3/4" = 1'-0"

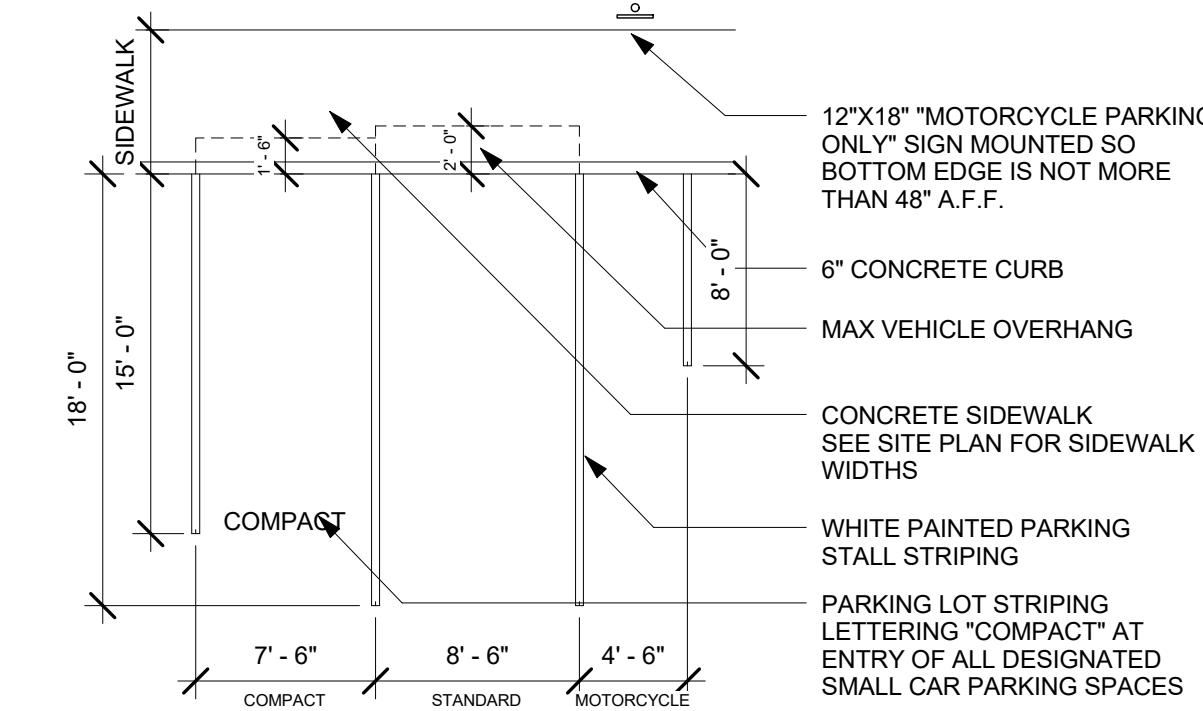

5 Parking Detail
1/8" = 1'-0"

TRAFFIC CIRCULATION
LAYOUT APPROVED
Sertil A. Kanbar 8/15/24

AN APPROVED PLAT IS A CONDITION
OF RELEASING FINAL CO.

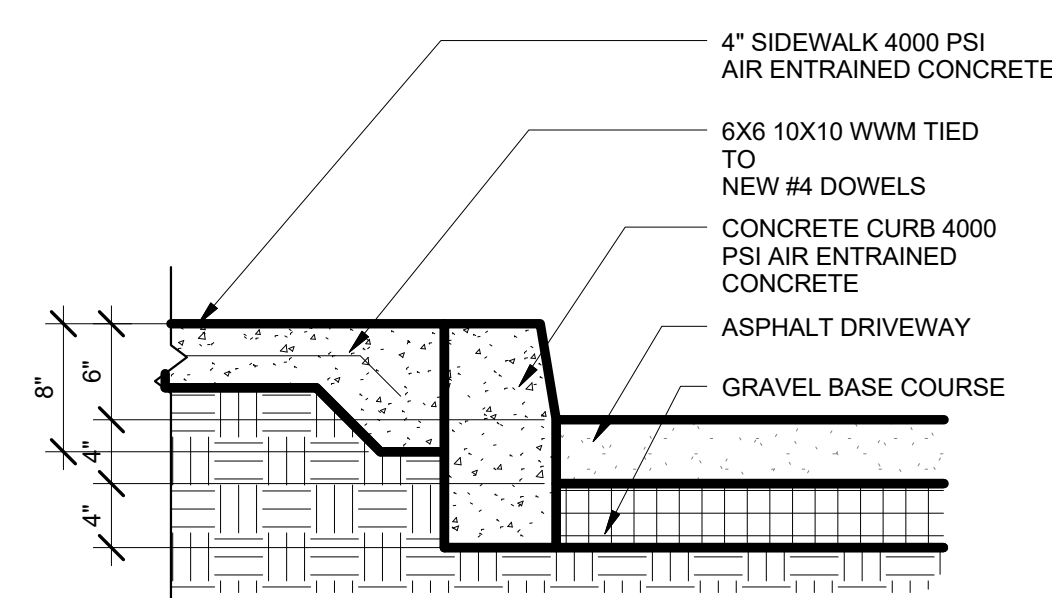

12 Curb Section Detail
1" = 1'-0"

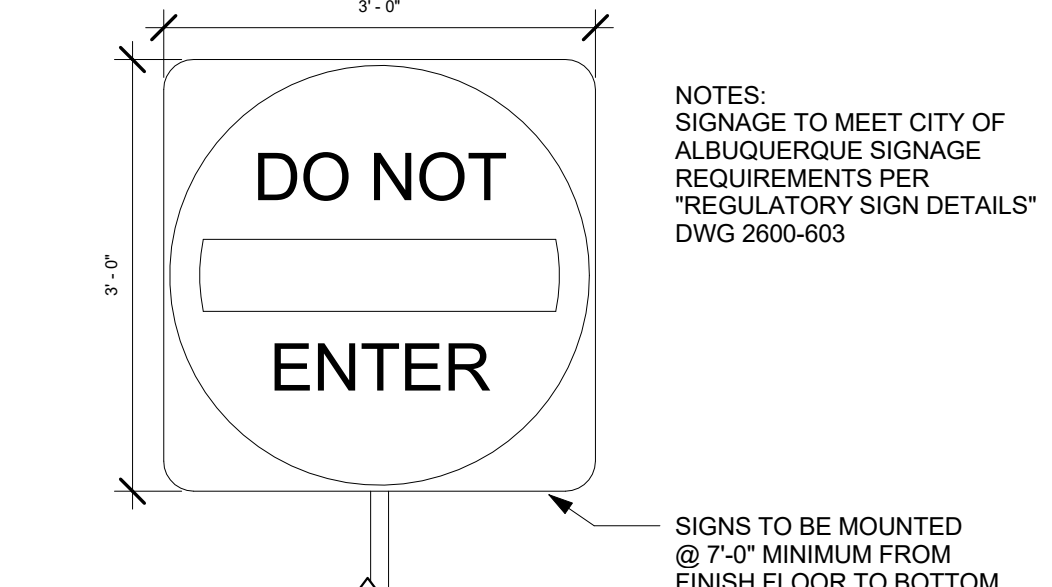

18 DO NOT ENTER Sign Detail
3/4" = 1'-0"

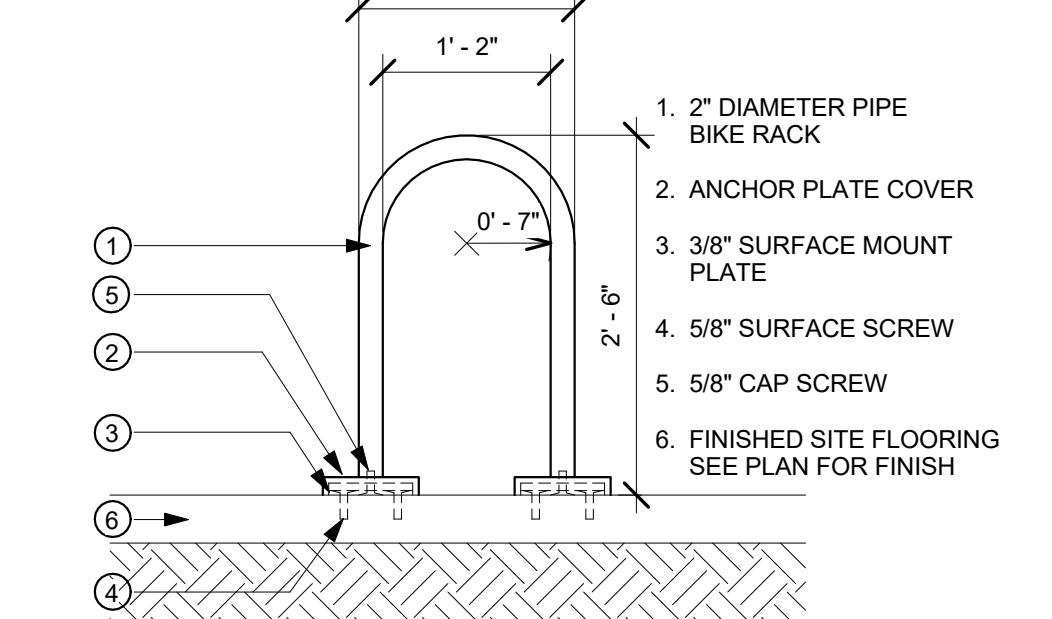

6 Bike Rack Detail
3/4" = 1'-0"

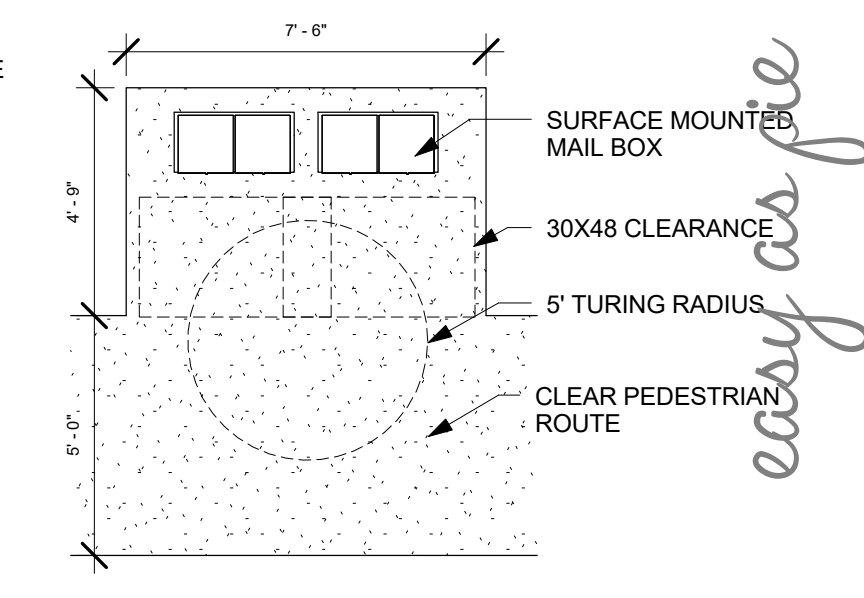

17 Mail Box Plan
1/4" = 1'-0"

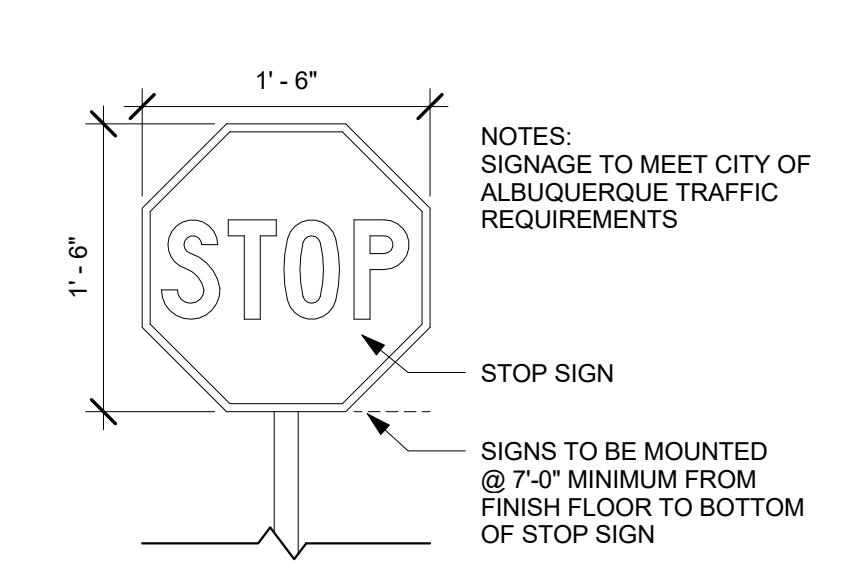

16 Stop Sign Detail
1" = 1'-0"

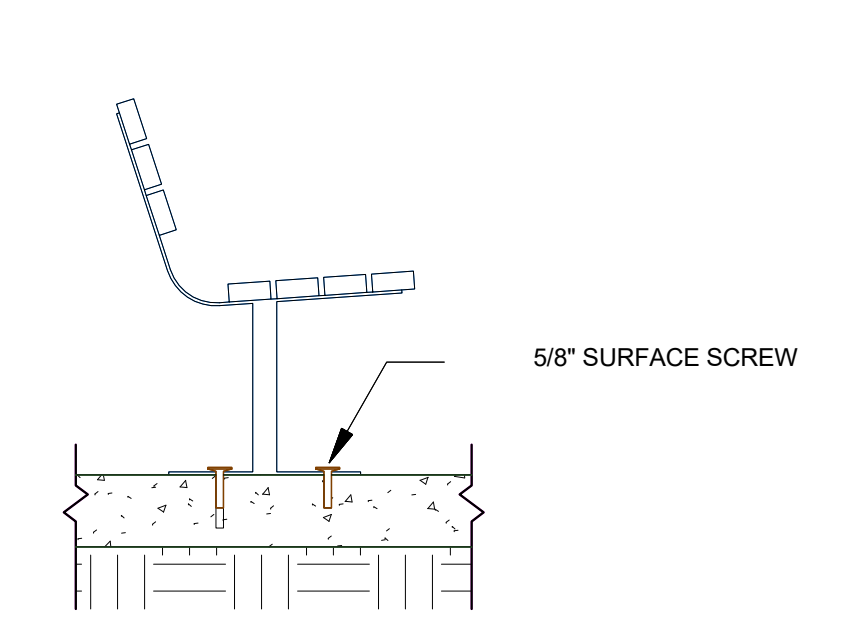

7 Surface Mounted Bench
3/4" = 1'-0"

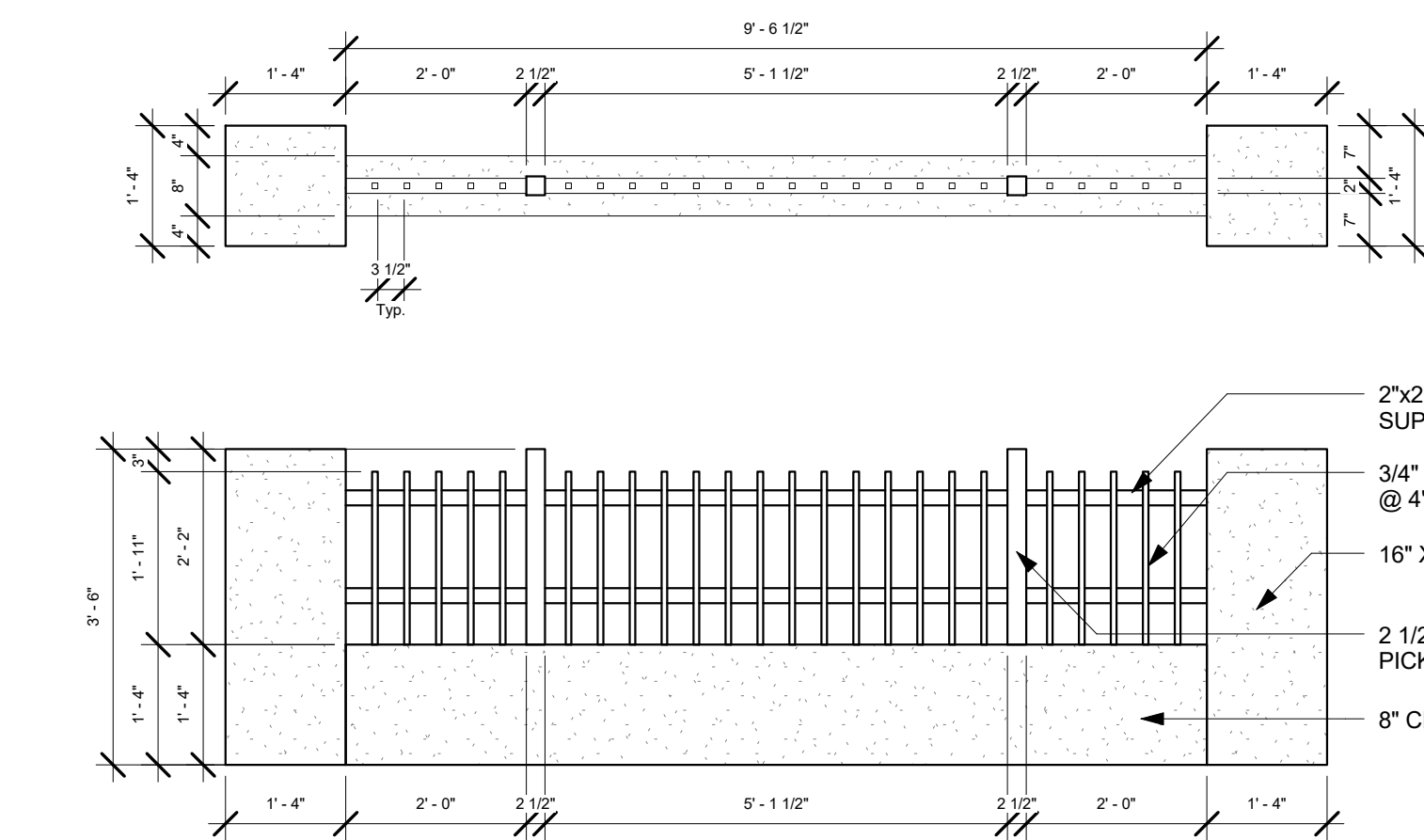

2 CMU / Wrought Iron Fence Detail
1/2" = 1'-0"

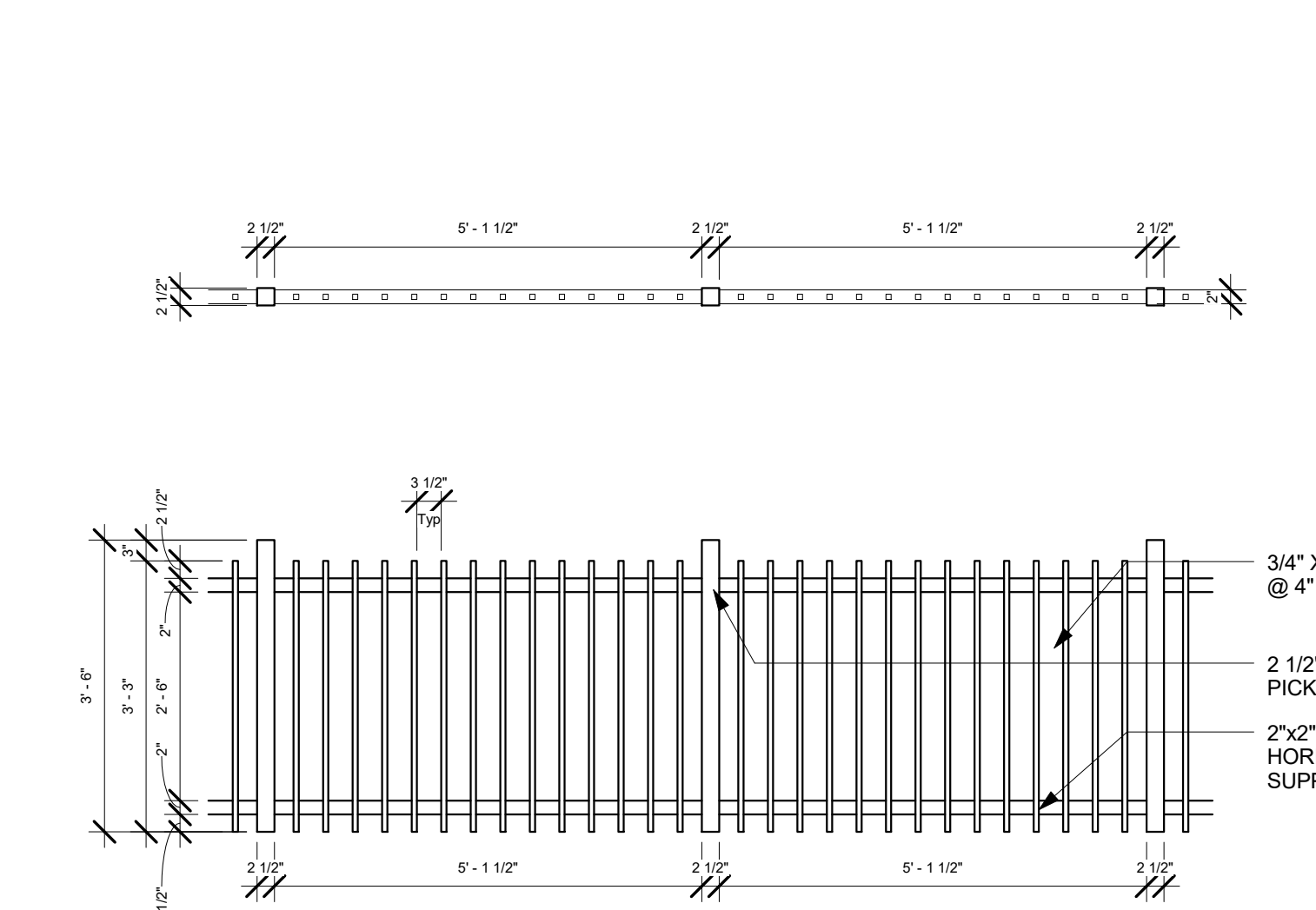

3 Wrought Iron Fence Detail
1/2" = 1'-0"

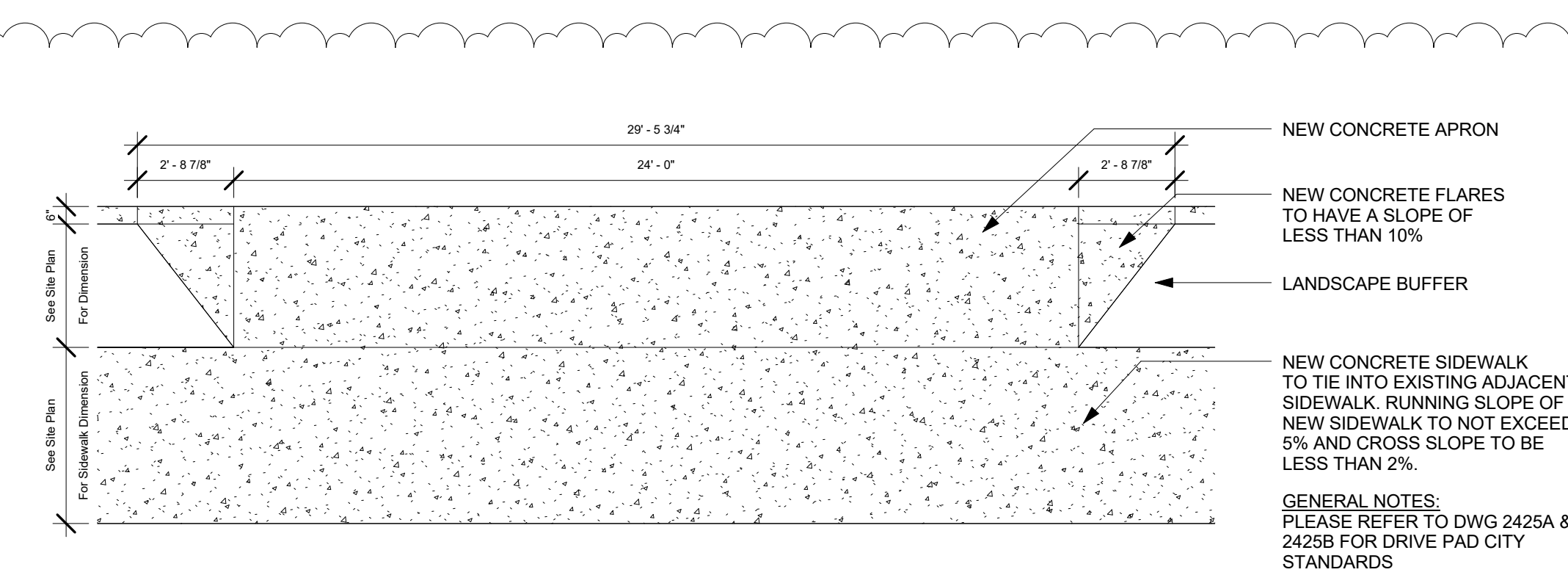

1 Concrete Driving Pad
1/4" = 1'-0"

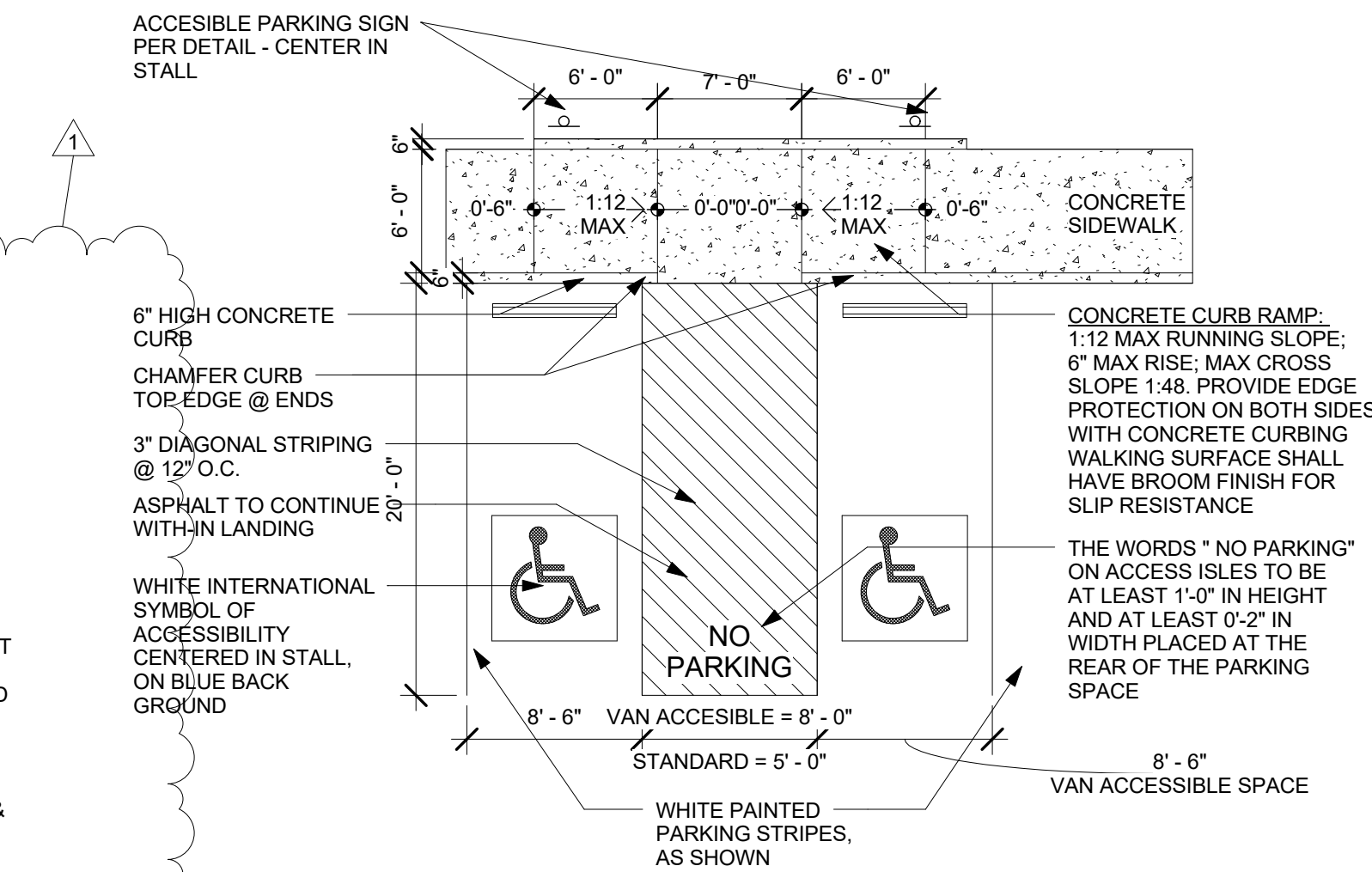

11 ADA Parking Detail
1/8" = 1'-0"



JEEBS & ZUZU, LLC.
Architecture
Construction
Design-Build
5924 ANAHEIM AVENUE NE SUITE A
ALBUQUERQUE, NM 87113
P. 505-797-1318

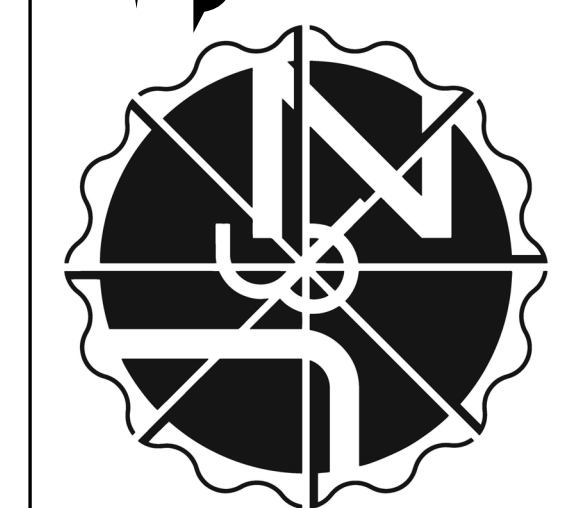

job no: -
drawn: EAM
checked: J&Z
date: Aug. 14, 2024

CASTAS DEL CAMINO
60th Street NW
Albuquerque, NM 87105
sheet no: **TCL2.0**

SITE DETAIL

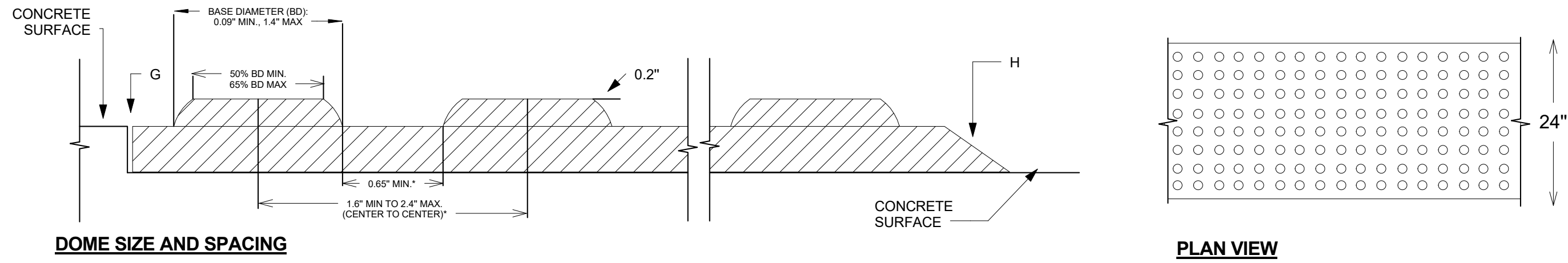

DOME SIZE AND SPACING

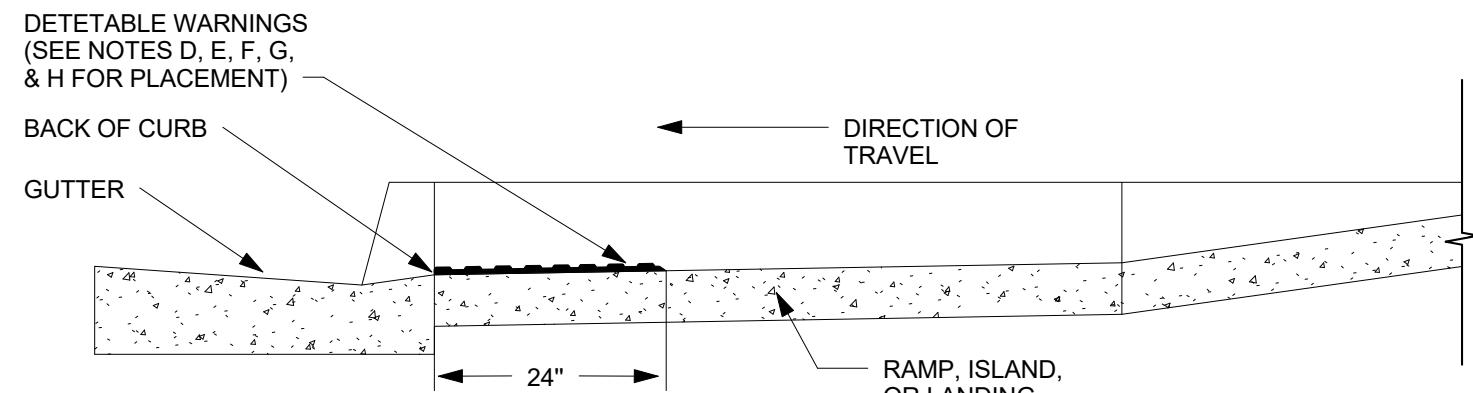

PLACEMENT - PROFILE

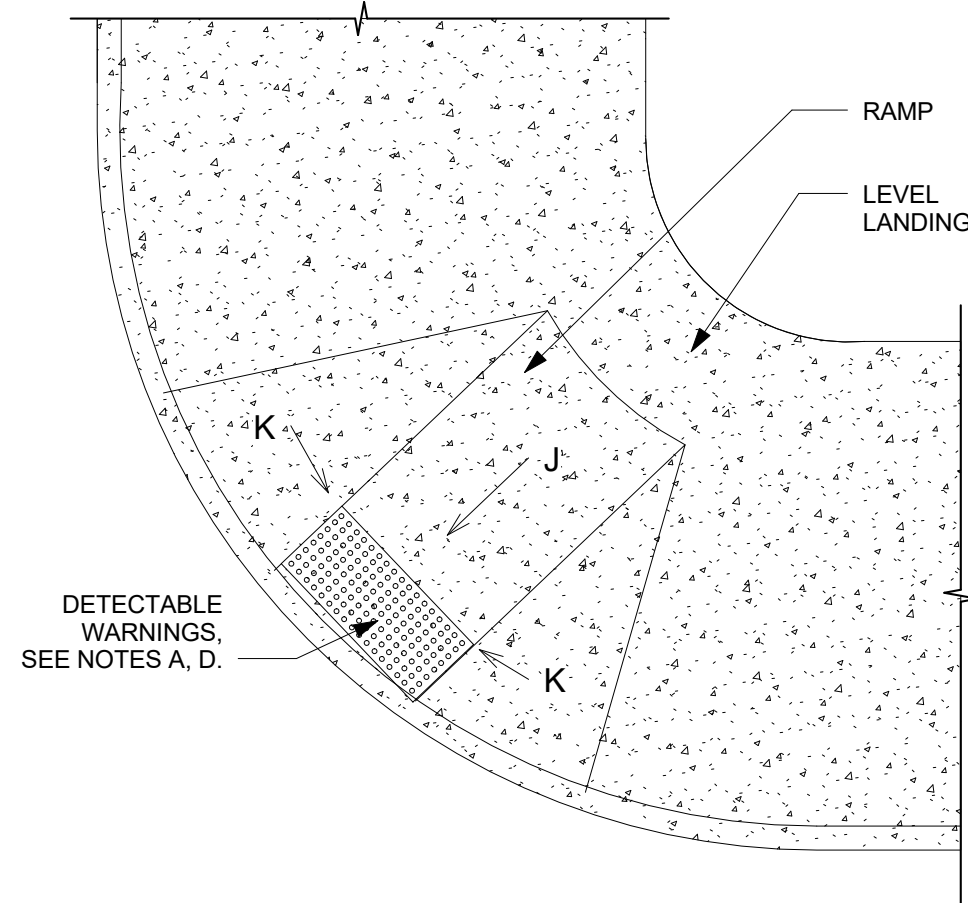
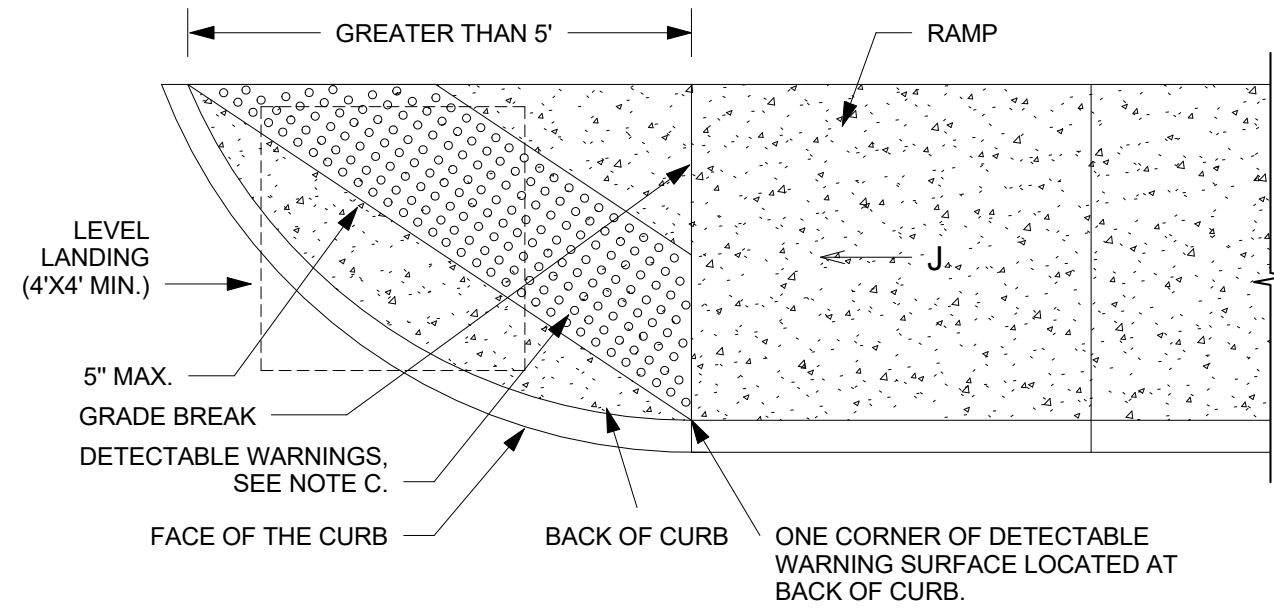

PLACEMENT ON PERPENDICULAR CURB RAMP WITH FLARED SIDED SLOPES

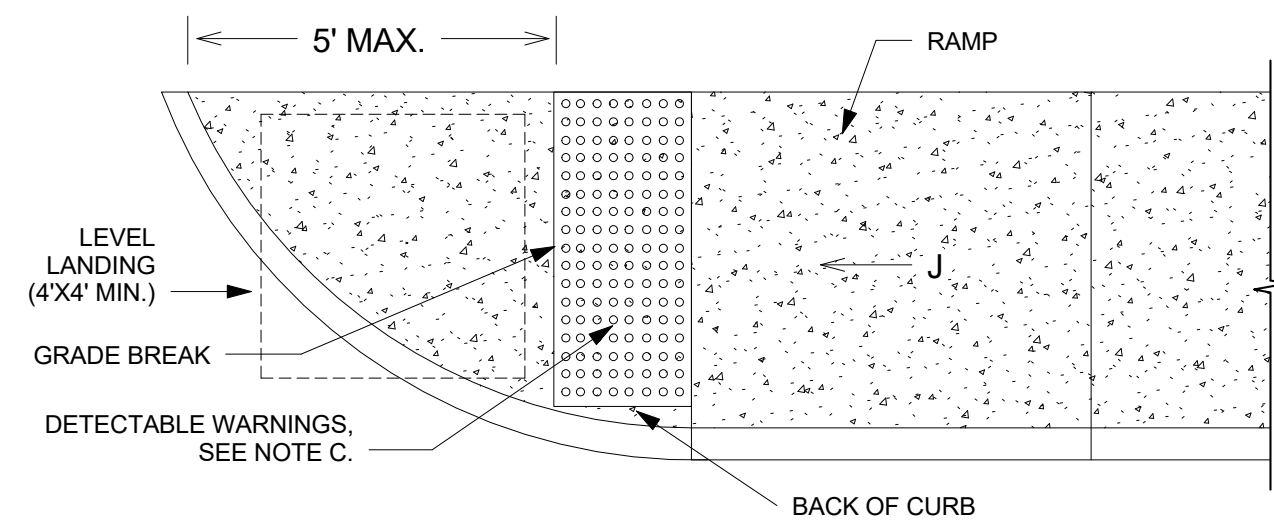

PLACEMENT ON PARALLE CURB RAMP

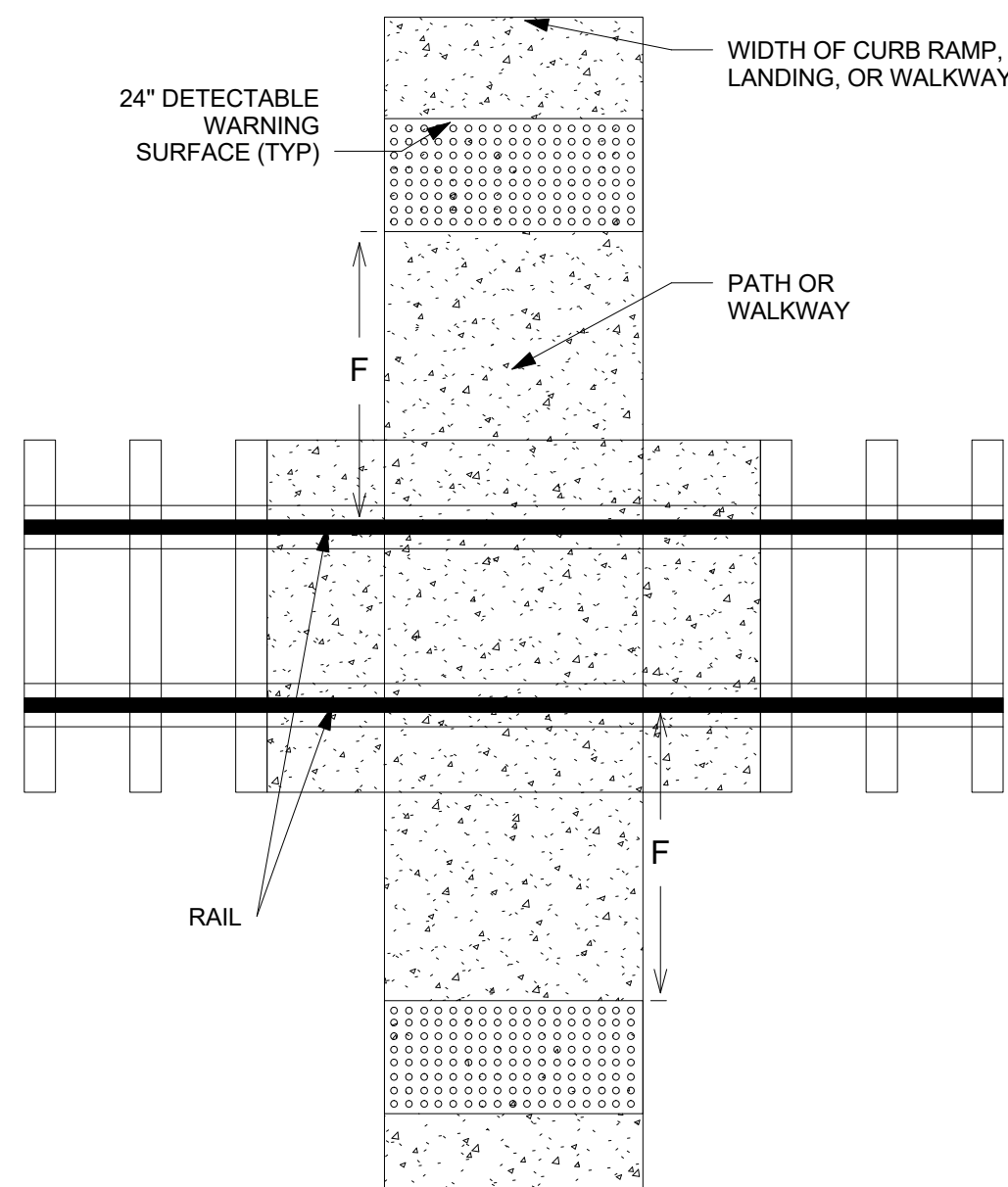
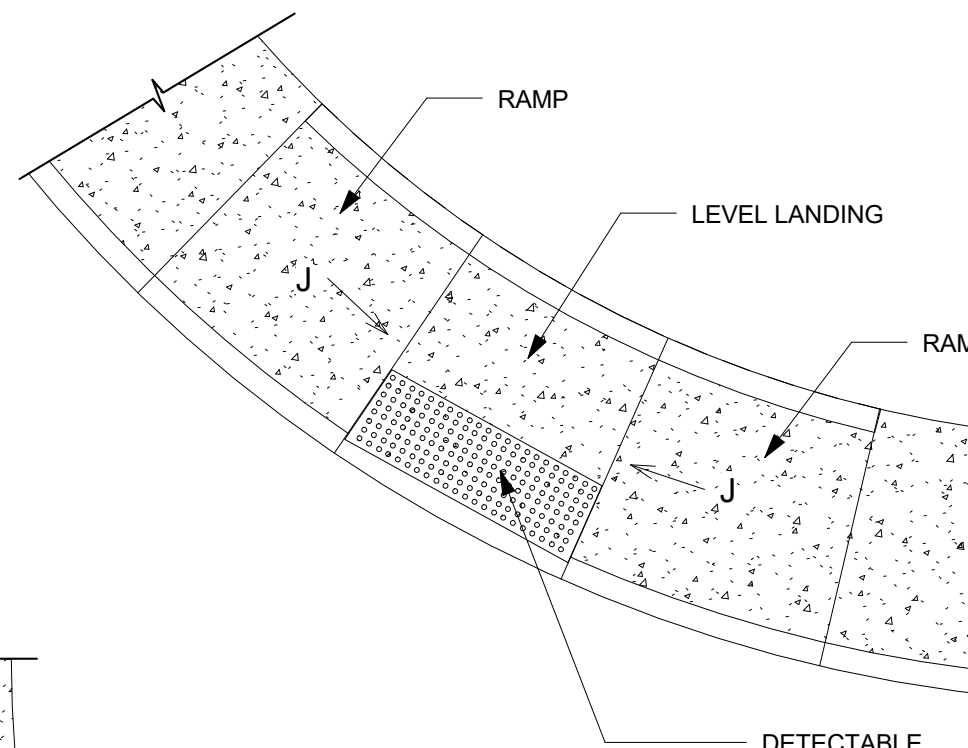

PEDESTRIAN AT-GRADE RAIL CROSSINGS

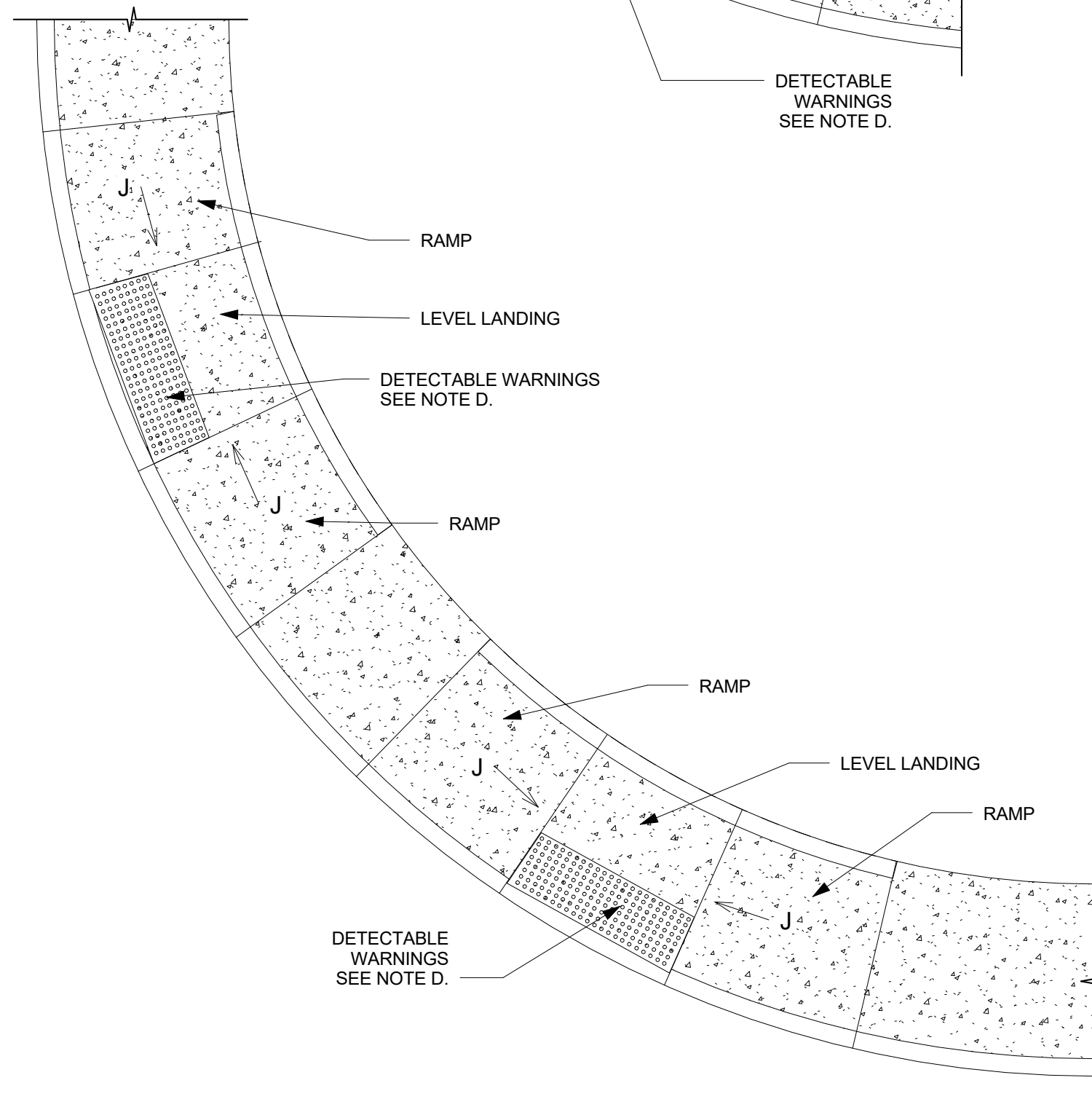

PLACEMENT ON PERPENDICULAR CURB RAMP

GENERAL NOTES FOR DWG 2446:

1. PROVIDE DETECTABLE WARNINGS ON ANY CURB RAMP OR LANDING WHERE THE ACCESSIBLE ROUTE CROSSES A PUBLIC STREET. DETECTABLE WARNINGS ARE NOT REQUIRED AT DRIVEWAYS UNLESS THE DIVEWAY IS PROVIDED WITH TRAFFIC CONTROL DEVICES OR IS PERMITTED TO OPERATE LIKE A PUBLIC STREET AS DETERMINED BY THE CITY ENGINEER.
2. SELECT A DETECTABLE WARNING SURFACE THAN CONTRASTS VISUALLY (LIGHT-ON-DARK OR DARK-ON-LIGHT) WITH ADJACENT SURFACES.
3. IN NEW CONSTRUCTION, INSTALL CAST-IN-PLACE REPLACEABLE DETECTABLE WARNING PLATES, PANELS, TILES, OR PAVERS. IN RETROFITS, INSTALL SURFACE-APPLIED DETECTABLE WARNING PANELS SHALL BE MECHANICALLY ANCHORED.

CONSTRUCTION NOTES:

- A. INSTALL DETECTABLE WARNING SURFACE SO THAT IT EXTENDS 24" IN THE DIRECTION OF TRAVEL FOR THE FULL WIDTH (NOT INCLUDING SIDE FLARES) OF THE RAMP OR LANDING.
- B. PLACE DETACTABLE WARNINGS SO THAT THE ROWS OF TRUNCATED DOMES ARE ALIGNED PERPENDICULAR TO THE GRADE BREAK BETWEEN THE RAMP OR LANDING AND THE ROADWAY
- C. ON PARALLEL CURB RAMPS, PLACE DETECTABLE WARNINGS ON THE RAMP SURFACE AT THE GRADE BREAK IF GRADE BREAK IS WITHING 5' FROM BACK OF CURB. IF THE GRADE BREAK IS GREATER THAN 5' FROM BACK OF CURB, PLACE DETACTABLE WARNINGS AT A DIAGONAL USING A MAXIMUM DISTANCE OF 5' FROM FACE OF CURB.
- D. ON PERPENDICULAR CURB RAMPS, PLACE DETECTABLE WARNINGS AT THE BACK OF CURB,
- E. ON CUT-THROUGH ISLANDS, PLACE DETECTABLE WARNINGS IN LINE WITH THE BACK OF CURB IF DETECTABLE WIRNINGS SUREFACES ON THE ENTRANCE AND EXIT SIDES OF THE ISLAND CAN BE SEPARATED BY 2' MIN. OF WALKWAY. IF NECESSARY TO ACHIEVE 2' MIN. SEPERATION, PLACE DETECTABLE WARNINGS IN LINE WITH THE FACE OF CURB. IF THE ISLAND HAS NO CURB, PLACE DETECTABLE WARNINGS AT THE EDGE OF ROADWAY. SEE COA STD DWG. 2448.
- F. PLACE DETECTABLE WARNINGS AT RAIL CROSSINGS SO THAT THE EDGE NEAREST THE RAIL IS 6' TO 15' FROM THE CENTERLINE OF THE NEAREST RAIL ALIGH ROWS OF TRUNCATED DOMES PARALLEL TO THE DIRECTION OF TRAVEL.
- G. RECESS OR CAST-IN DETECTABLE WARNINGS SO THAT THE SURFACE TO WHICH THE TRUNCATED DOMES ARE ATTACHED IS FLUSH WITH ADJACENT CONCRETE.
- H. IN RETROFITS, DETECTABLE WARNING MAT MAY BE MECHANICALLY ANCHORED TO THE SURFACE OF THE CONCRETE IF THE MAT EDGE IS BEVELED WITH A MAXIMUM SLOPE OF 2H: 1V.
- J. 8.3% MAX SLOPE, 7% PREFERRED SLOPE.

TRAFFIC CIRCULATION
LAYOUT APPROVED
Sertil A. Kanbar 8/15/24

AN APPROVED PLAT IS A CONDITION
OF RELEASING FINAL CO.

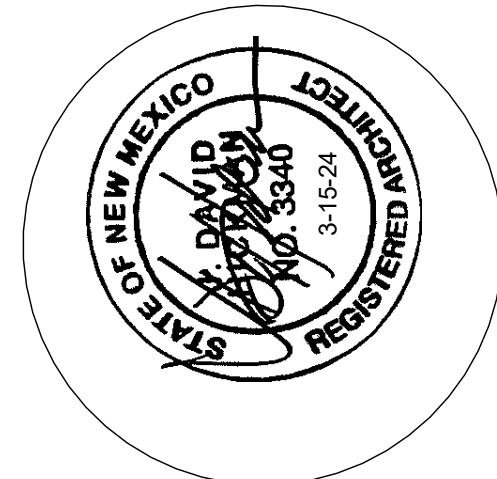

JEEBS & ZUZU, LLC.

Architecture
Construction
Design-Build

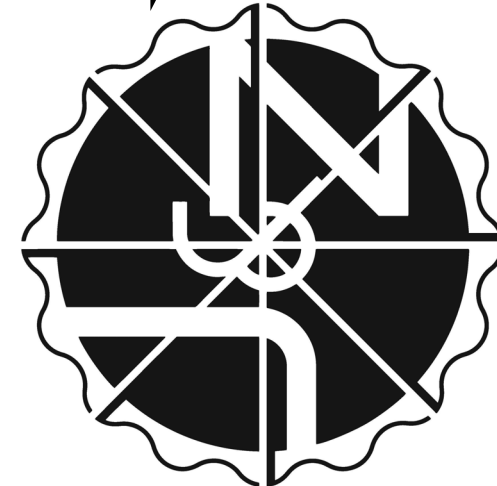

job no: -
drawn: EAM
checked: J&Z
date: Aug. 14, 2024

CASITAS DEL CAMINO

60th Street NW
Albuquerque, NM 87105

sheet no:

TCL2.1

www.jeebsandzuzu.com

3

1 Drafting 2
1/4" = 1'-0"

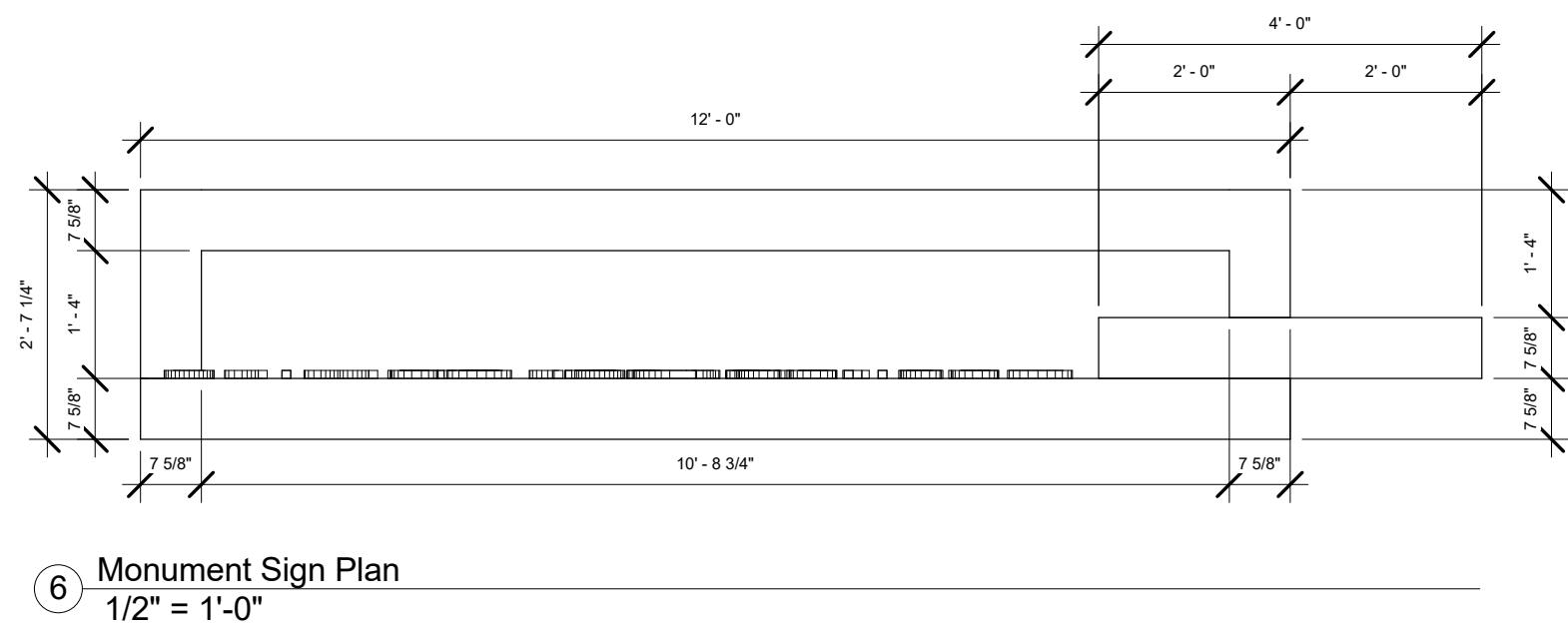
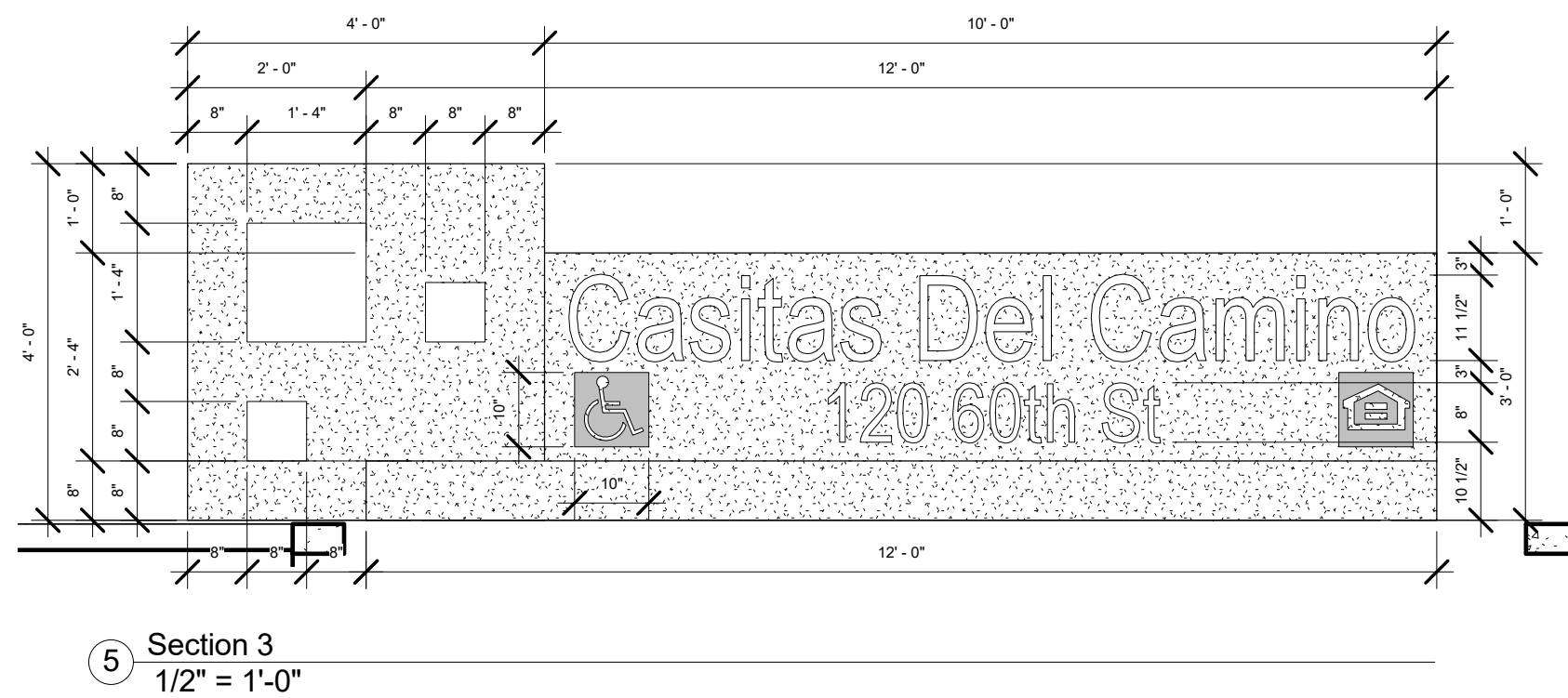
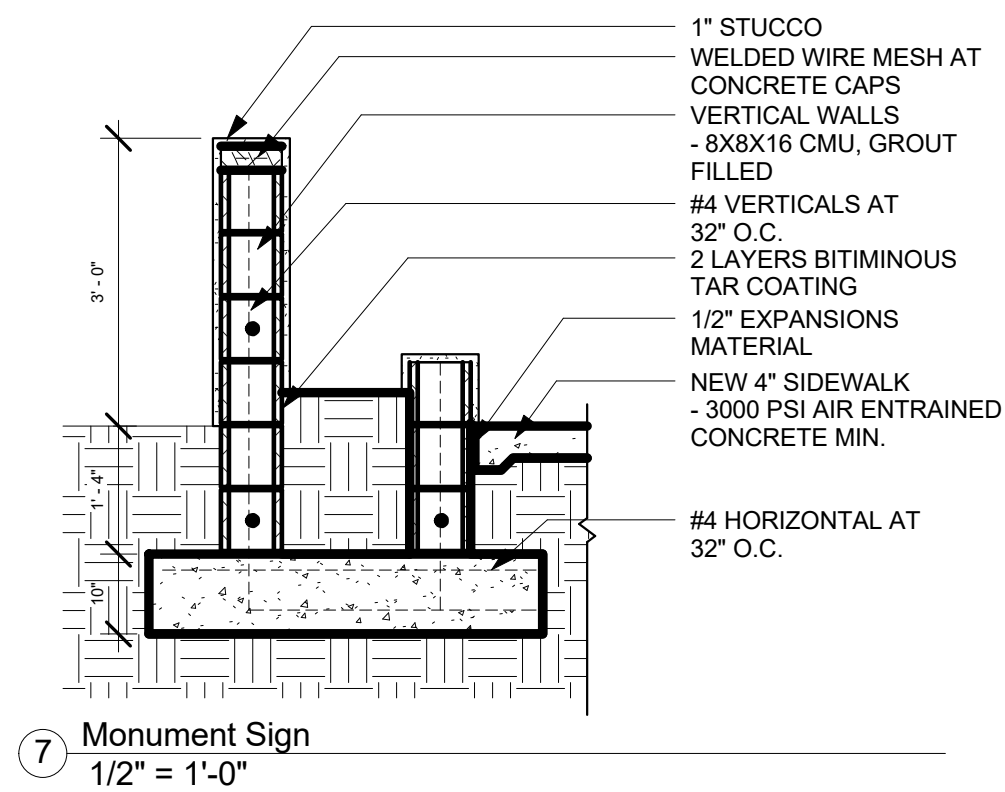

TRAFFIC CIRCULATION
LAYOUT APPROVED

Sertil A. Kanbar 8/15/24

AN APPROVED PLAT IS A CONDITION
OF RELEASING FINAL CO.

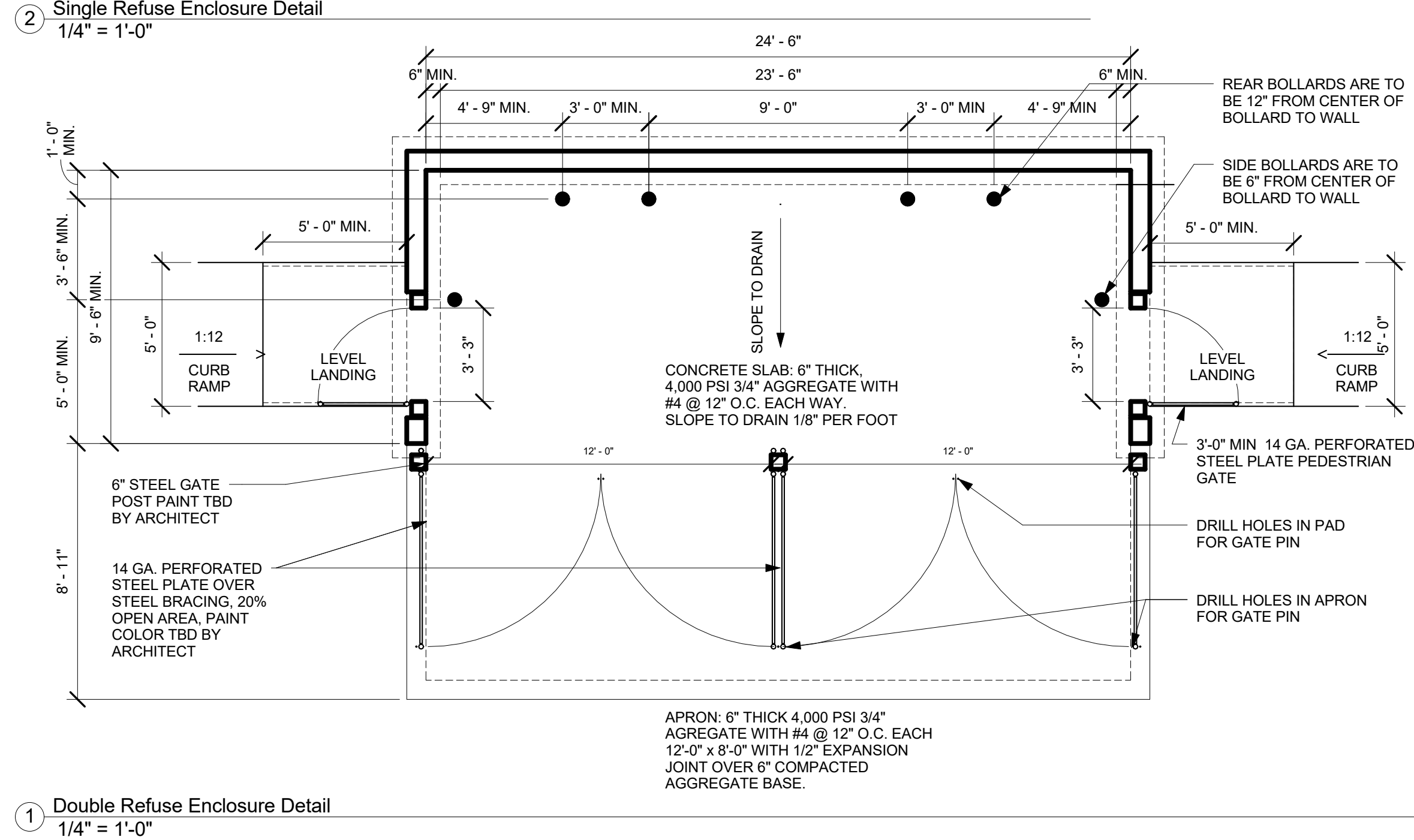
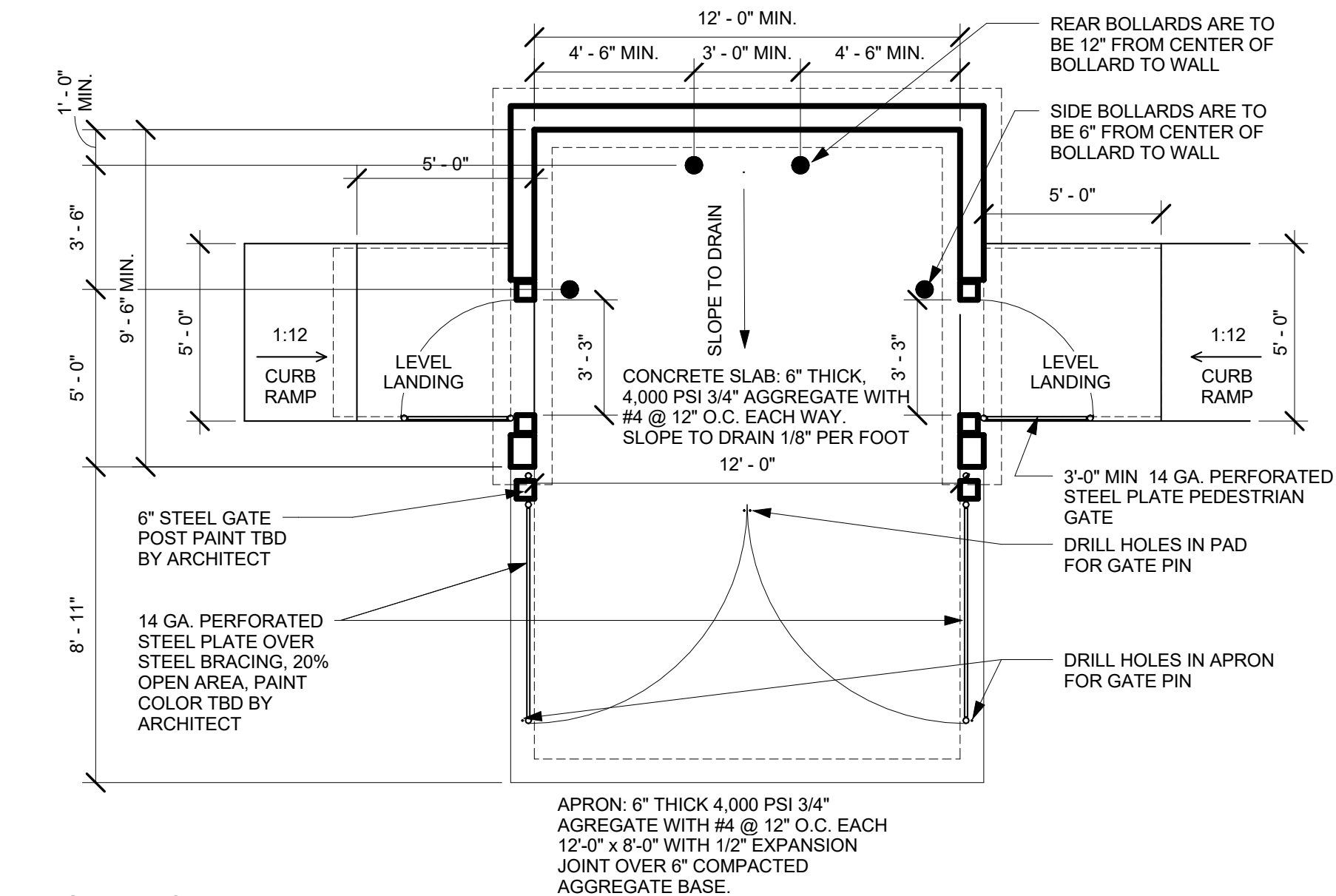
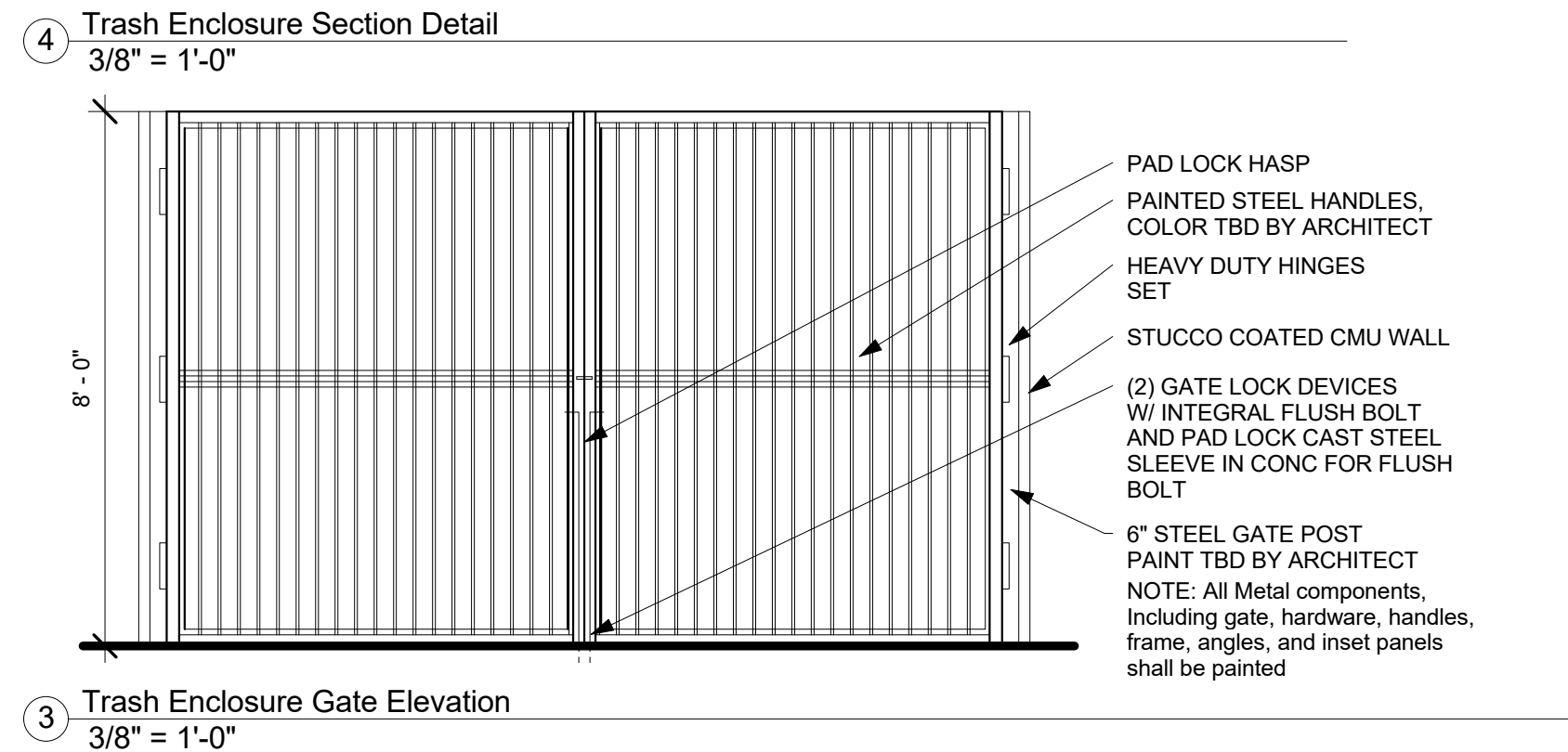
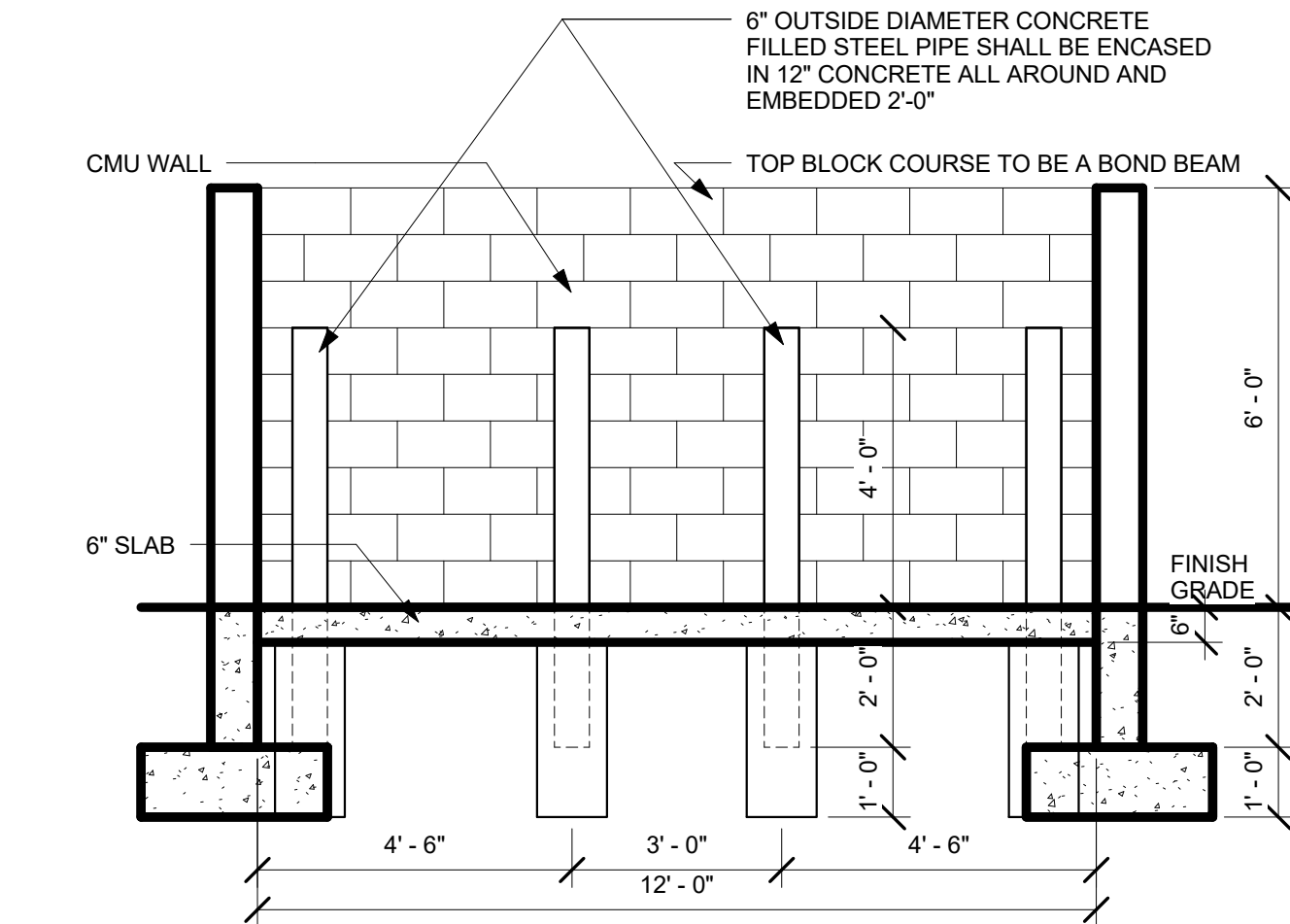

www.jeebsandzuzu.com

easy as pie



JEEBS & ZUZU, LLC.
Architecture
Construction
Design-Build

5924 ANAHEIM AVENUE NE SUITE A
ALBUQUERQUE, NM 87113
P: 505-797-1318

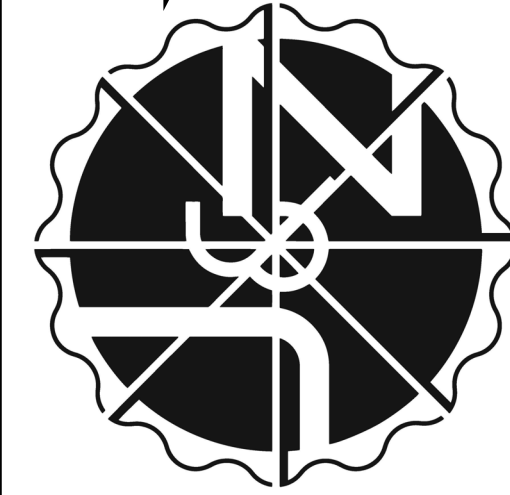

job no: -
drawn: Author
checked: Checker
date: Aug. 14, 2024

SITE DETAIL

CASITAS DEL CAMINO

60th Street NW
Albuquerque, NM 87105

sheet no: **TCL2.2**