

# CITY OF ALBUQUERQUE

Planning Department  
Alan Varela, Director



Mayor Timothy M. Keller

July 8, 2022

Claudia P. Diaz  
Wilson & Company, Inc.  
4401 Masthead St. NE, Suite 150  
Albuquerque, NM 87109

**Re: Metz-Robertson Addition**  
**109 60<sup>th</sup> St. NW**  
**Traffic Circulation Layout**  
Architect's Stamp 06-11-2022 (K11-D093)

Dear Mrs. Diaz,

The TCL submittal received 06-21-2022 is approved for Building Permit with. A copy of the stamped and signed plan will be needed for each of the building permit plans. Please keep the original to be used for certification of the site for final C.O. for Transportation.

When the site construction is completed and an inspection for Certificate of Occupancy (C.O.) is requested, use the original City stamped approved TCL for certification. Redline any minor changes and adjustments that were made in the field. A NM registered architect or engineer must stamp, sign, and date the certification TCL along with indicating that the development was built in "substantial compliance" with the TCL. Submit this certification, the TCL, and a completed Drainage and Transportation Information Sheet to front counter personnel for log in and evaluation by Transportation.

Once verification of certification is completed and approved, notification will be made to Building Safety to issue Final C.O. To confirm that a final C.O. has been issued, call Building Safety at 924-3690.

Sincerely,

Ernest Armijo, P.E.  
Principal Engineer, Planning Dept.  
Development Review Services

C: CO Clerk, File



# City of Albuquerque

Planning Department

Development & Building Services Division

## DRAINAGE AND TRANSPORTATION INFORMATION SHEET (REV 10/2018)

**Project Title:** \_\_\_\_\_ **Building Permit #:** \_\_\_\_\_ **Hydrology File #:** \_\_\_\_\_

**DRB#:** \_\_\_\_\_ **EPC#:** \_\_\_\_\_ **Work Order#:** \_\_\_\_\_

**Legal Description:** \_\_\_\_\_

**City Address:** \_\_\_\_\_

**Applicant:** \_\_\_\_\_ **Contact:** \_\_\_\_\_

**Address:** \_\_\_\_\_

**Phone#:** \_\_\_\_\_ **Fax#:** \_\_\_\_\_ **E-mail:** \_\_\_\_\_

**Other Contact:** \_\_\_\_\_ **Contact:** \_\_\_\_\_

**Address:** \_\_\_\_\_

**Phone#:** \_\_\_\_\_ **Fax#:** \_\_\_\_\_ **E-mail:** \_\_\_\_\_

**TYPE OF DEVELOPMENT:** \_\_\_\_\_ PLAT (# of lots) \_\_\_\_\_ RESIDENCE \_\_\_\_\_ DRB SITE \_\_\_\_\_ ADMIN SITE

IS THIS A RESUBMITTAL? \_\_\_\_\_ Yes \_\_\_\_\_ No

**DEPARTMENT:** \_\_\_\_\_ TRAFFIC/TRANSPORTATION \_\_\_\_\_ HYDROLOGY/DRAINAGE

Check all that Apply:

### TYPE OF SUBMITTAL:

- \_\_\_\_\_ ENGINEER/ARCHITECT CERTIFICATION
- \_\_\_\_\_ PAD CERTIFICATION
- \_\_\_\_\_ CONCEPTUAL G & D PLAN
- \_\_\_\_\_ GRADING PLAN
- \_\_\_\_\_ DRAINAGE MASTER PLAN
- \_\_\_\_\_ DRAINAGE REPORT
- \_\_\_\_\_ FLOODPLAIN DEVELOPMENT PERMIT APPLIC
- \_\_\_\_\_ ELEVATION CERTIFICATE
- \_\_\_\_\_ CLOMR/LOMR
- \_\_\_\_\_ TRAFFIC CIRCULATION LAYOUT (TCL)
- \_\_\_\_\_ TRAFFIC IMPACT STUDY (TIS)
- \_\_\_\_\_ OTHER (SPECIFY) \_\_\_\_\_
- \_\_\_\_\_ PRE-DESIGN MEETING?

### TYPE OF APPROVAL/ACCEPTANCE SOUGHT:

- \_\_\_\_\_ BUILDING PERMIT APPROVAL
- \_\_\_\_\_ CERTIFICATE OF OCCUPANCY
- \_\_\_\_\_ PRELIMINARY PLAT APPROVAL
- \_\_\_\_\_ SITE PLAN FOR SUB'D APPROVAL
- \_\_\_\_\_ SITE PLAN FOR BLDG. PERMIT APPROVAL
- \_\_\_\_\_ FINAL PLAT APPROVAL
- \_\_\_\_\_ SIA/ RELEASE OF FINANCIAL GUARANTEE
- \_\_\_\_\_ FOUNDATION PERMIT APPROVAL
- \_\_\_\_\_ GRADING PERMIT APPROVAL
- \_\_\_\_\_ SO-19 APPROVAL
- \_\_\_\_\_ PAVING PERMIT APPROVAL
- \_\_\_\_\_ GRADING/ PAD CERTIFICATION
- \_\_\_\_\_ WORK ORDER APPROVAL
- \_\_\_\_\_ CLOMR/LOMR
- \_\_\_\_\_ FLOODPLAIN DEVELOPMENT PERMIT
- \_\_\_\_\_ OTHER (SPECIFY) \_\_\_\_\_

**DATE SUBMITTED:** \_\_\_\_\_ **By:** \_\_\_\_\_

COA STAFF:

ELECTRONIC SUBMITTAL RECEIVED: \_\_\_\_\_

FEE PAID: \_\_\_\_\_



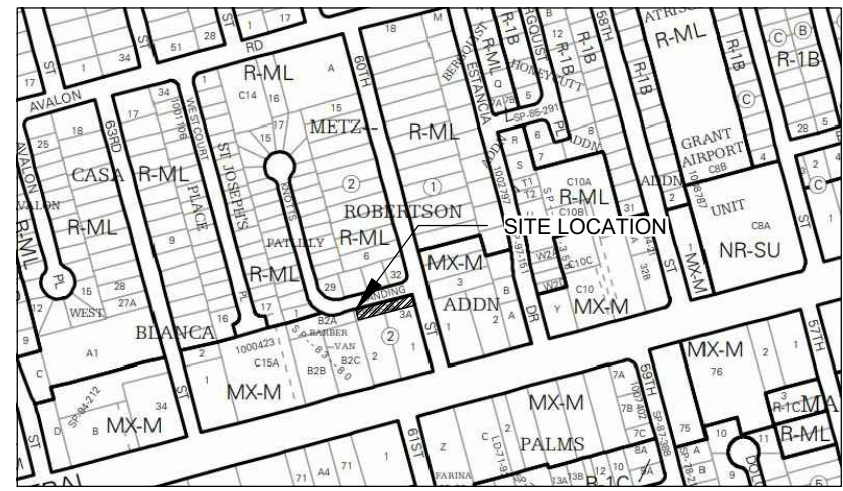

LOCATION MAP  
ZONE ATLAS PAGE: K-11-Z

TRAFFIC CIRCULATION  
LAYOUT APPROVED

Ernest Amigo 7/8/2022  
Signed Date

## GENERAL NOTES

1. PARKING STRIPES WITHIN BASE COURSE AREA ARE FOR ILLUSTRATION ONLY.
2. FIELD VERIFY CONDITION OF EXISTING FENCING, COORDINATE WITH OWNER IF FENCE WILL BE REMOVED AND DISPOSED.
3. FOR PLANTER DETAILS, SEE ARCHITECTURAL & LANDSCAPING PLANS.
4. FOR ADA RAMP AND STAIR DETAILS, SEE ARCHITECTURAL PLANS. FOR ADA HANDRAIL AND BIKE RACK, SEE C-107.
5. PER THE COA GRADING AND DRAINAGE APPROVAL AND FOUNDATION PERMIT, THE ON-SITE PORTABLE WAS PERMITTED. REMAINING SITE IMPROVEMENTS ARE NOW PART OF THIS PROJECT.
6. FOR ALL INTERIOR PORTABLE IMPROVEMENTS SEE ARCHITECTURAL PLANS.

EXISTING 8" SANITARY  
SEWER LINE  
PER ABQ GIS

REMOVE, REPLACE,  
AND/OR CUT AS  
NECESSARY  
EXISTING CURB AND  
GUTTER IN ORDER TO  
CONSTRUCT  
DRIVEPAD WITH  
CURB RAMPS

LANDING 2% MAX IN  
ALL DIRECTIONS

### NOTE:

- PER CID THIS PORTABLE BUILDING ALREADY HAS A CERTIFICATE OF OCCUPANCY.
- TYPE 2B CONSTRUCTION / OCCUPANCY 18
- BUILDING HEIGHT IS 10' - 10'

## KEYED NOTES

1. PAINT ADA PARKING SYMBOL AND ADA STRIPING PER DETAIL A1, SEE SHEET C-107.
2. INSTALL ADA VAN ACCESSIBLE SIGN PER DETAIL A2, SEE SHEET C-107
3. INSTALL NEW HEADER CURB PER COA STD DWG 2415B.
4. INSTALL 2 - BIKE RACKS PER SECTION 7-4(K)(2) OF THE COA DPM. TYPE TO BE U-RACK. SEE SHEET C-107.
5. INSTALL 4' WIDE GATE
6. INSTALL SLIDING GATE. CLOSED AT NIGHT ONLY.
7. INSTALL PARKING BUMPER PER DETAIL C3, SEE SHEET C-107
8. INSTALL PAVED DRIVEPAD WITH SIDEWALK AT BACK OF CURB PER COA STD DWGS 2425A AND 2425B.
9. INSTALL MOTORCYCLE PARKING ONLY SIGN PER DETAIL C2, SEE SHEET C-107.
10. CONSTRUCT CUT CURB PER DETAIL B2, SEE SHEET C-107.
11. CONSTRUCT HEADER CURB PER DETAIL B4, SEE SHEET C-107.
12. 3' x 6' DESIGNATED AREA FOR RECYCLE AND TRASH BINS
13. TRANSITION CURB HEIGHT TO MATCH HEADER CURB HEIGHT
14. CONSTRUCT CUT-OFF WALL PER COA STD DWG 2415B.
15. VAN ACCESS AISLE DETAIL A1, SEE SHEET C-108.
16. LANDSCAPING, SIGNAGE, WALLS, FENCES, TREES, AND SHRUBBERY BETWEEN 3 FEET AND 8 FEET TALL (AS MEASURED FROM THE GUTTER PAN) ARE NOT ALLOWED WITHIN THE CLEAR SIGHT TRIANGLE.
17. PAINT THE LETTERS "MC". MUST BE CAPITALIZED AND AT LEAST 1 FT HIGH AND LETTERING 2 INCHES WIDE. COLOR SHALL BE WHITE.

## LEGEND

- MINI CLEAR SITE TRIANGLE AREA PER FIGURE 7.4.94 OF COA DPM
- ASPHALT PAVEMENT PER DETAIL A5, SEE SHEET C-107.
- 6" THICK PCC PER COA STD DWG 2425A
- 4" THICK PCC PER COA STD DWG 2430
- 6" BASE COURSE PER DETAIL A4, SEE SHEET C-107

- SITE FENCING
- SITE - CONTROL POINT
- POLE - POWER
- POLE - LIGHT
- MANHOLE - SANITARY
- MANHOLE - STORM
- JUNCTION BOX - ELECTRIC
- FIRE HYDRANT
- METER - WATER
- SPRINKLER BOX - WATER
- SIGN - SINGLE POST
- GAS LINE
- OVERHEAD POWER
- SANITARY SEWER LINE
- WATER LINE
- FENCE - CHAIN LINK
- OVERHEAD TELEVISION LINE



PARKING REQUIREMENTS PER IDO (MX-M ZONING)			
USE	IDO PARKING SPACE REQUIREMENTS	SITE BLDG AREA	SITE PARKING SPACE REQUIREMENTS
OFFICE	2.5 Spaces / 1,000 sq ft GFA	896 sq ft	2 + 1 Motorcycle Space

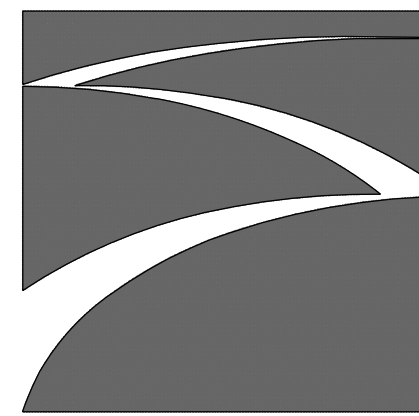

SITES  
SOUTHWEST

1700 CENTRAL SW, SUITE B  
ALBUQUERQUE, NM 87104  
PHONE: 505-822-8200  
FAX: 505-822-8282  
E-MAIL: mail@sites-sw.com  
WEB: www.sites-sw.com

### CONSULTANTS

**WILSON  
& COMPANY**

4401 MASTHEAD STREET NE, SUITE 150  
ALBUQUERQUE, NM 87109  
PHONE: 505-348-4000  
FAX: 505-348-4055  
www.wilsonco.com



PROJECT  
LOT 3A BLOCK 2  
METZ-ROBERTSON  
ADDITION  
ADDRESS  
109 60TH ST. NW  
ALBUQUERQUE NM 87105

REVIEW SET  
NOT FOR CONSTRUCTION

MARK	DATE	DESCRIPTION
-	05/22	100% CONSTRUCTION
ISSUE DATE:	XXXXXX, 201X	
PROJECT NO:	19-600-068-00	
CAD DWG FILE:	19683_TCO1.DWG	
DRAWN BY:	DTH	
CHK'D BY:	CPD	
COPYRIGHT:	Sites Southwest	

### SHEET TITLE

TRAFFIC  
CIRCULATION PLAN

C-106

SHEET XX OF XX



M:\MSD\19-500-066-00\2\_Disciplines\Sheets\2\_Sheets - civil\19683\_DT01.dwg 6-21-22 04:05:17 PM TCSpencer

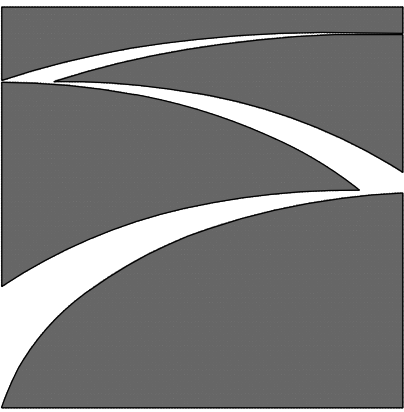

SITES  
SOUTHWEST

1700 CENTRAL SW, SUITE B  
ALBUQUERQUE, NM 87104  
PHONE: 505-822-8200  
FAX: 505-822-8282  
E-MAIL: mail@sites-sw.com  
WEB: www.sites-sw.com

CONSULTANTS

**WILSON  
& COMPANY**

4401 MASTHEAD STREET NE, SUITE 150  
ALBUQUERQUE, NM 87109  
PHONE: 505-348-4000  
FAX: 505-348-4055  
www.wilsonco.com



PROJECT  
LOT 3A BLOCK 2  
METZ-ROBERTSON  
ADDITION  
ADDRESS  
109 60TH ST. NW  
ALBUQUERQUE NM 87105

REVIEW SET  
NOT FOR CONSTRUCTION

MARK	DATE	DESCRIPTION
-	05/22	100% CONSTRUCTION
ISSUE DATE:	XXXXXX, 201X	
PROJECT NO:	19-600-066-00	
CAD DWG FILE:	19683_DT01.DWG	
DRAWN BY:	DTH	
CHK'D BY:	CPD	
COPYRIGHT:	Sites Southwest	

SHEET TITLE

MISCELLANEOUS  
DETAILS

C-107

SHEET XX OF XX

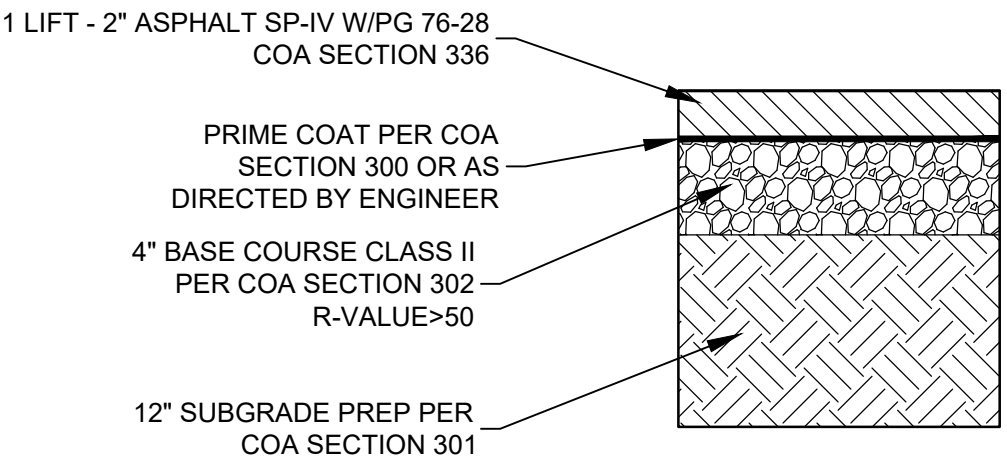
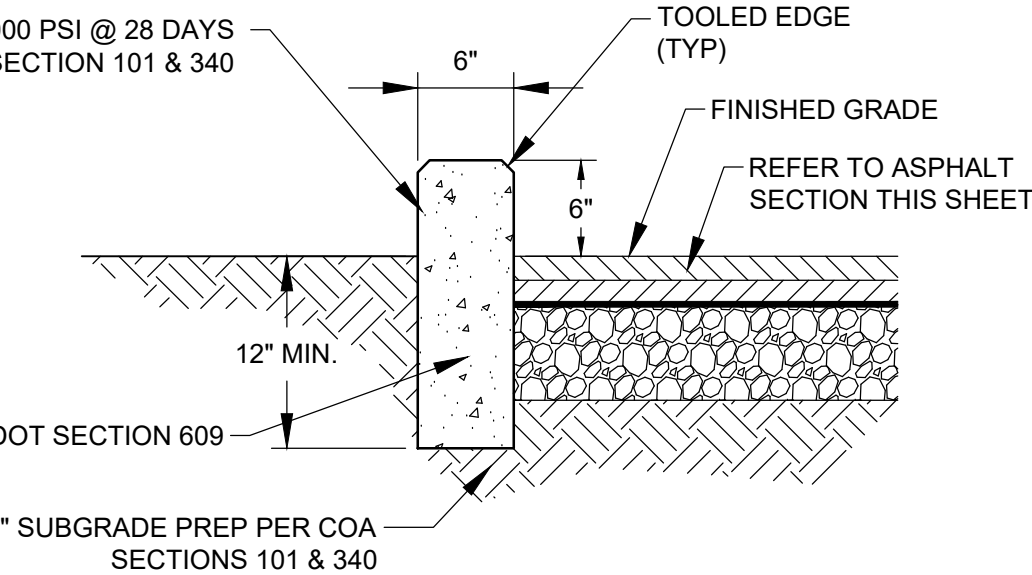
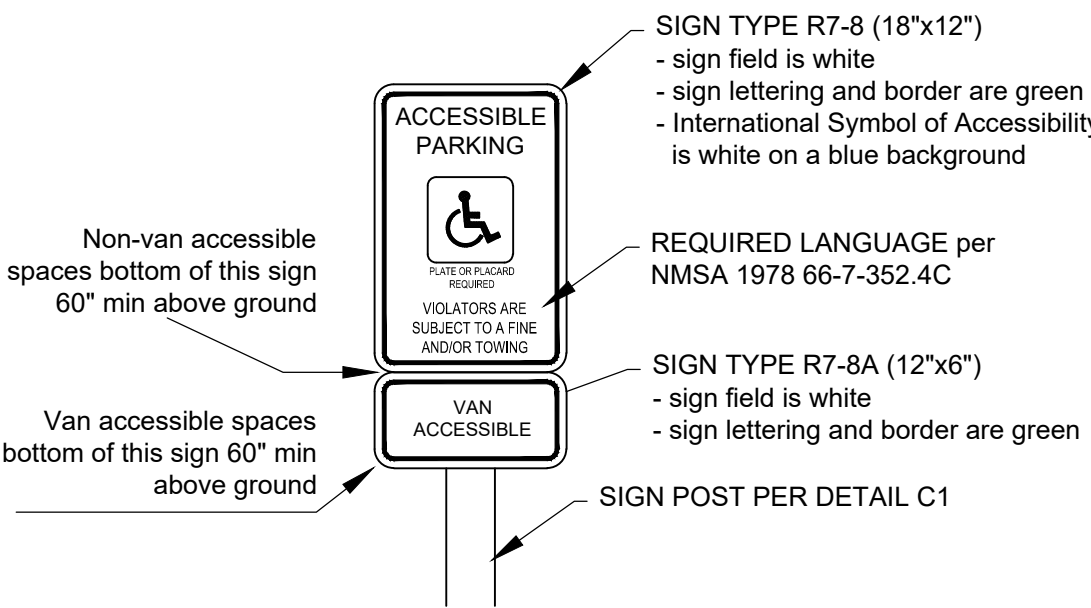
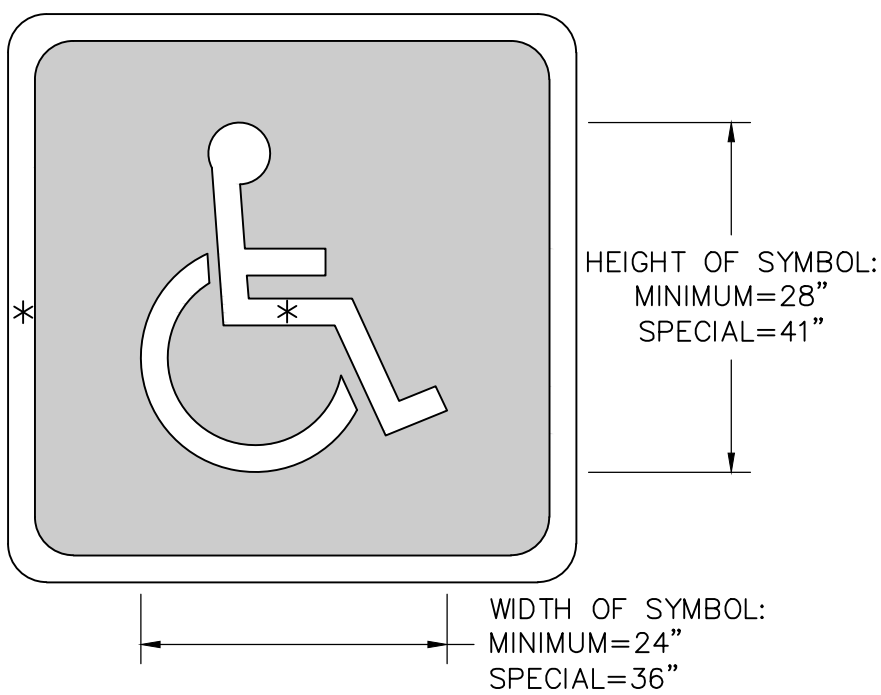
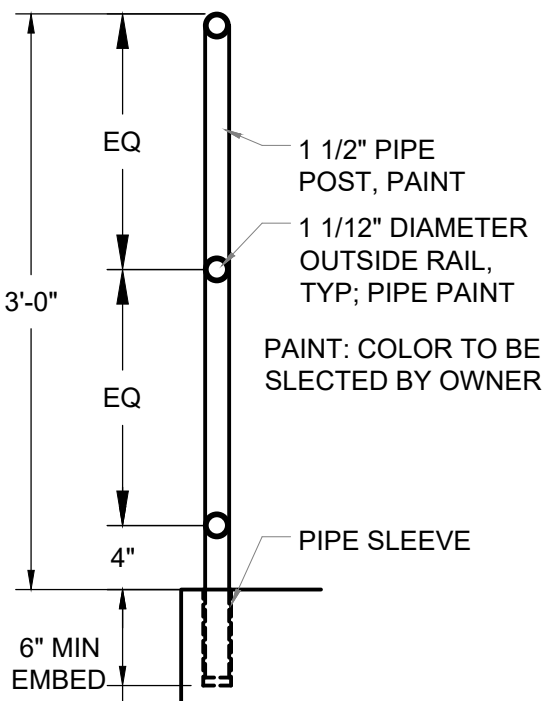
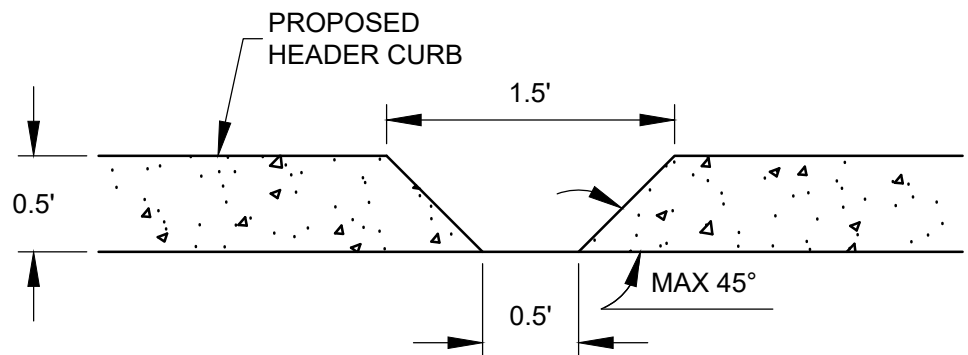
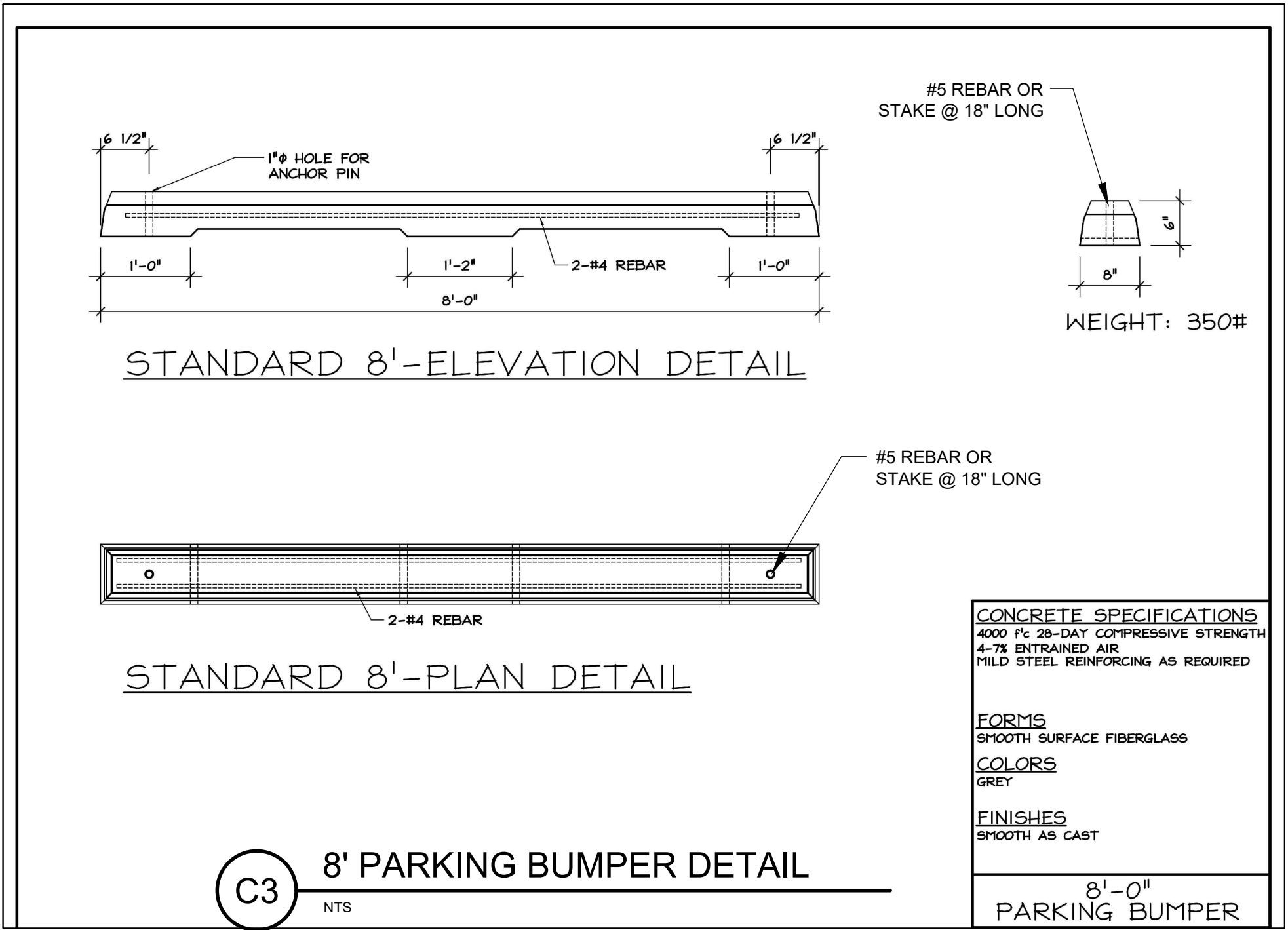
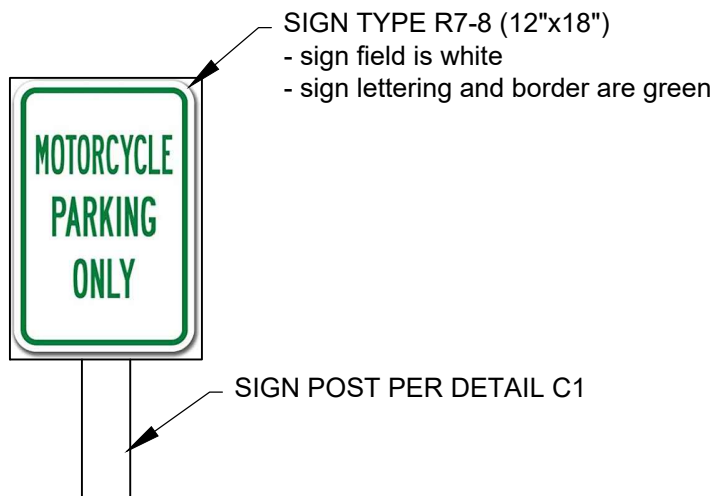
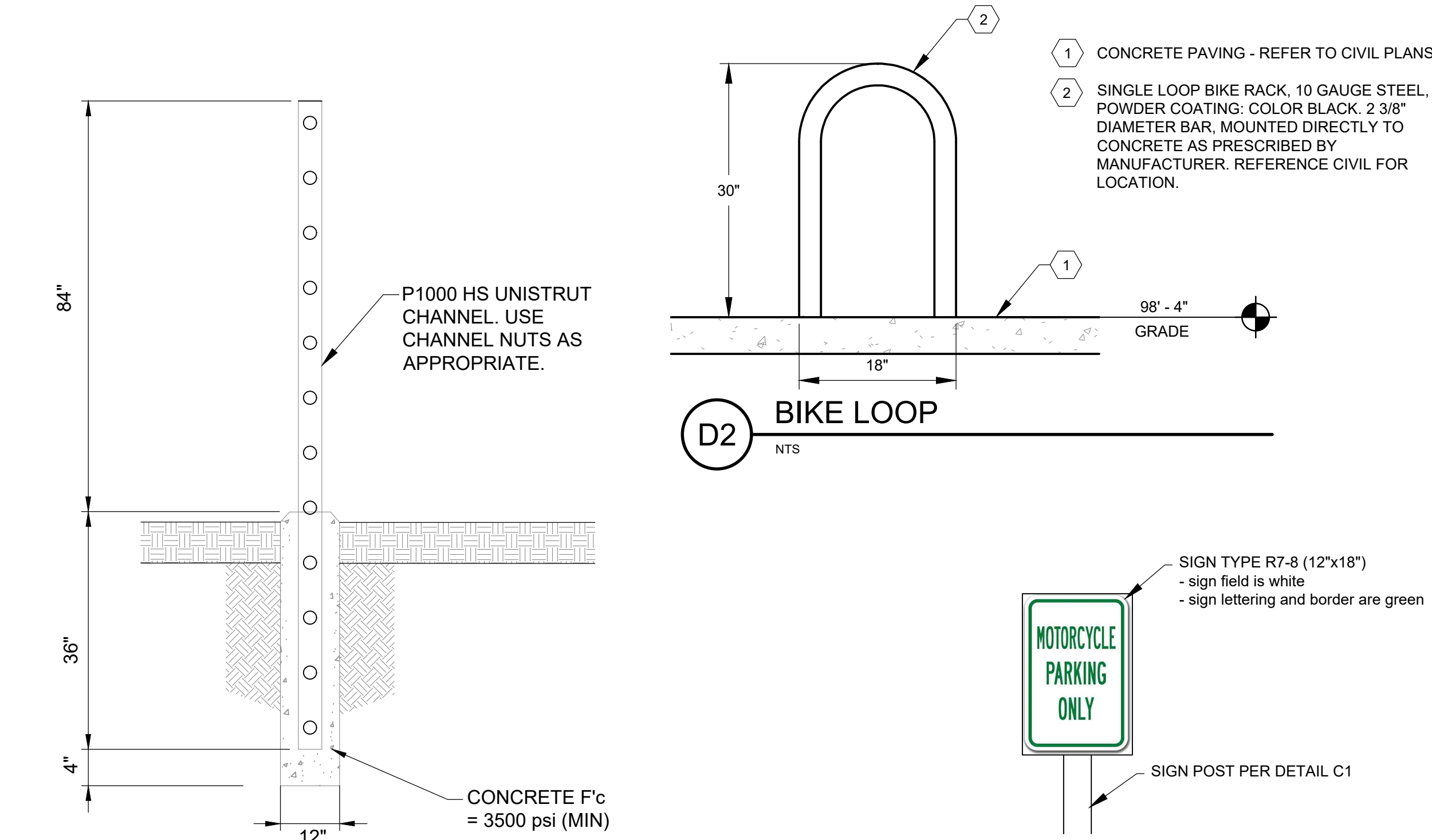

**A1 INTERNATIONAL SYMBOL OF ACCESSIBILITY**  
NTS

**A2 HANDICAP PARKING SIGN**  
NTS

**A4 6" BASE COURSE DETAIL**  
SCALE: NTS

**A5 ASPHALT PAVEMENT SECTION**