

CITY OF ALBUQUERQUE

March 22, 2015



Frank Corral, P.E.
CEA Group
4712 Woodrow Bean Suite F
El Paso, TX 79924

**RE: Albuquerque Biopark Zoo - Carousel Area
COA Zoo 903 10th St SW
Request Permanent C. O. - Accepted
Engineers Stamp Date 4/10/15 (K13D034E)
Certification date: 3-18-16**

Dear Mr. Corral,

Based upon the information provided in your submittal received 3/21/2016, the above referenced Certification received is acceptable for the release of Certificate of Occupancy by Hydrology.

If you have any questions, you can contact me at 924-3695 or Totten Elliott at 924-3982.

PO Box 1293

Sincerely,

Albuquerque

Abiel Carrillo, P.E.
Principal Engineer, Planning Department
Development and Review Services

New Mexico 87103

www.cabq.gov

TE/AC

C: e-mail,

Cordova, Camille C.; Connor, Miranda, Rachel; Sandoval, Darlene M.; Blocker, Lois



City of Albuquerque

Planning Department

Development & Building Services Division DRAINAGE AND TRANSPORTATION INFORMATION SHEET (REV 02/2013)

Project Title: ALBUQUERQUE BIOPARK CAROUSEL AREA Building Permit #: T201591071 City Drainage #: K13.D034E
 DRB#: _____ EPC#: _____ Work Order#: _____

Legal Description: _____

City Address: 903 10TH STREET SW, ALBUQUERQUE, NM 87102

Engineering Firm: CEA GROUP Contact: FRANK CORRAL

Address: 4712 WOODROW BEAN, STE. F, EL PASO, TX 79924

Phone#: 915-544-5232 Fax#: 915-544-5233 E-mail: fcorra@ceagroup.net

Owner: NEW MEXICO BIOPARK SOCIETY Contact: JULIE RUGG

Address: 903 10TH STREET SW, ALBUQUERQUE, NM 87102

Phone#: 505-764-6280 Fax#: 505-764-6226 E-mail: director@bioparksociety.org

Architect: TIAGA INTERNATIONAL Contact: STEVEN M. CECCHALA

Address: 751 CORNELL AVE., DREXEL HILL, PA 19026

Phone#: 610-955-3306 Fax#: _____ E-mail: scerhvala@tiaga-international.org

Surveyor: SURV-TEK, INC. Contact: RUSS HUGG

Address: 9384 VALLEY VIEW DR NW, ALBUQUERQUE, NM 87114

Phone#: 505-897-3366 Fax#: 505-897-3377 E-mail: russhugg@survtek.com

Contractor: ANCHOR BUILT, INC. Contact: MICHAEL FRANCO

Address: 304 INDIANA STREET SE, ALBUQUERQUE, NM 87108

Phone#: 505-342-2452 Fax#: 505-344-2542 E-mail: mfranco@anchorbuilt.com

TYPE OF SUBMITTAL:

- ☐ DRAINAGE REPORT
☐ DRAINAGE PLAN 1st SUBMITTAL
☐ DRAINAGE PLAN RESUBMITTAL
☐ CONCEPTUAL G & D PLAN
☐ GRADING PLAN
☐ EROSION & SEDIMENT CONTROL PLAN (ESC)
☒ ENGINEER'S CERT (HYDROLOGY)
☐ CLOMR/LOMR
☐ TRAFFIC CIRCULATION LAYOUT (TCL)
☐ ENGINEER'S CERT (TCL)
☐ ENGINEER'S CERT (DRB SITE PLAN)
☐ ENGINEER'S CERT (ESC)
☐ SO-19
☐ OTHER (SPECIFY)

CHECK TYPE OF APPROVAL/ACCEPTANCE SOUGHT:

- ☐ SIA/FINANCIAL GUARANTEE RELEASE
☐ PRELIMINARY PLAT APPROVAL
☐ S. DEV. PLAN FOR SUB'D APPROVAL
☐ S. DEV. FOR BLDG. PERMIT APPROVAL
☐ SECTOR PLAN APPROVAL
☐ FINAL PLAT APPROVAL
☒ CERTIFICATE OF OCCUPANCY (PERM)
☐ CERTIFICATE OF OCCUPANCY (TCL TEMP)
☐ FOUNDATION PERMIT APPROVAL
☐ BUILDING PERMIT APPROVAL
☐ GRADING PERMIT APPROVAL
☐ PAVING PERMIT APPROVAL
☐ WORK ORDER APPROVAL
☐ GRADING CERTIFICATION
☐ SO-19 APPROVAL
☐ ESC PERMIT APPROVAL
☐ ESC CERT. ACCEPTANCE
☐ OTHER (SPECIFY)

WAS A PRE-DESIGN CONFERENCE ATTENDED: ☒ Yes ☐ No ☐ Copy Provided

DATE SUBMITTED: 03/21/16 By: [Signature]

Requests for approvals of Site Development Plans and/or Subdivision Plats shall be accompanied by a drainage submittal. The particular nature, location, an scope to the proposed development defines the degree of drainage detail. One or more of the following levels of submittal may be required based on the followin

1. **Conceptual Grading and Drainage Plan:** Required for approval of Site Development Plans greater than five (5) acres and Sector Plans
2. **Drainage Plans:** Required for building permits, grading permits, paving permits and site plans less than five (5) acres
3. **Drainage Report:** Required for subdivision containing more than ten (10) lots or constituting five (5) acres or more
4. **Erosion and Sediment Control Plan:** Required for any new development and redevelopment site with 1-acre or more of land disturbing area, including project less than 1-acre than are part of a larger common plan of development

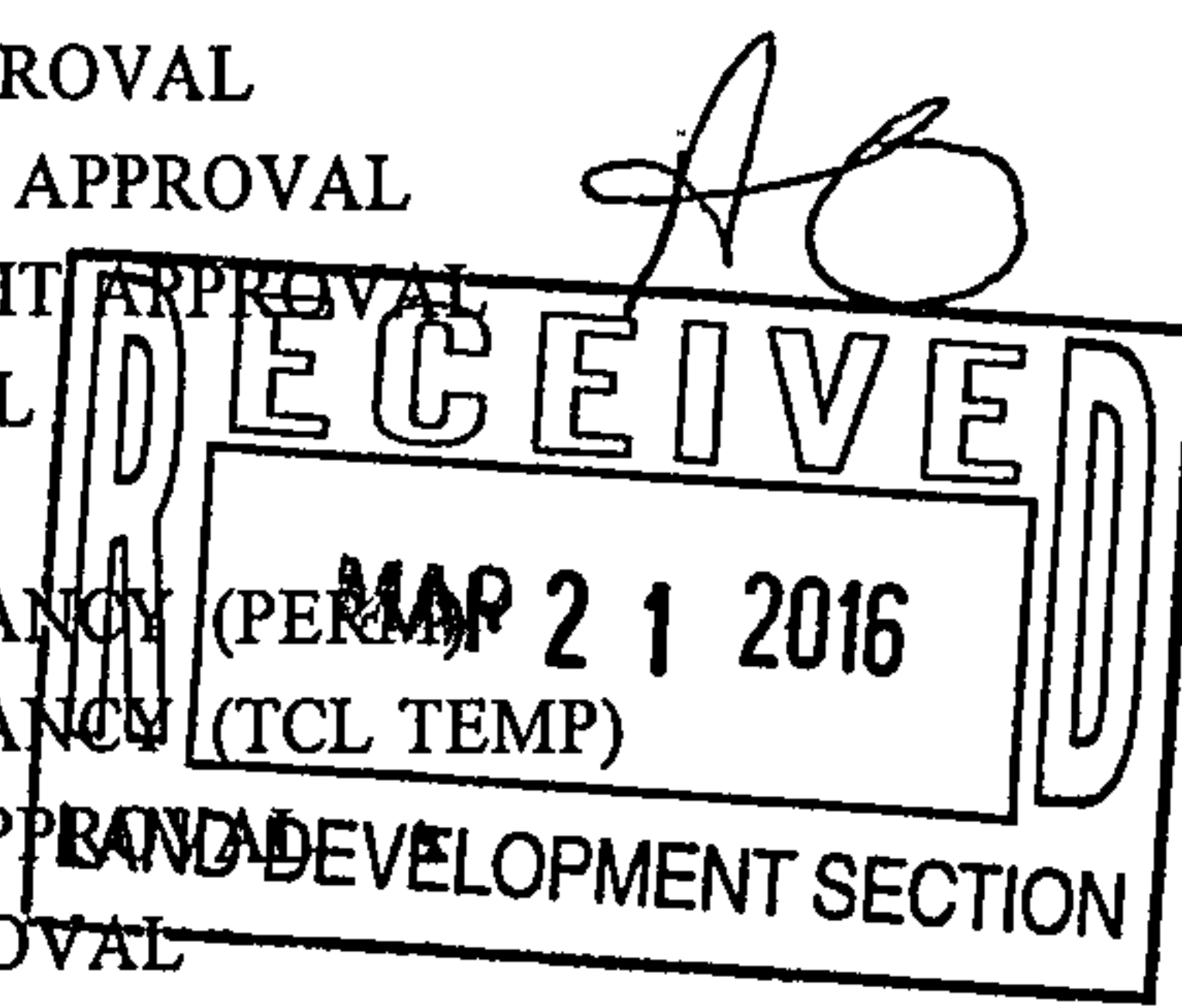

CITY OF ALBUQUERQUE

July 6, 2015

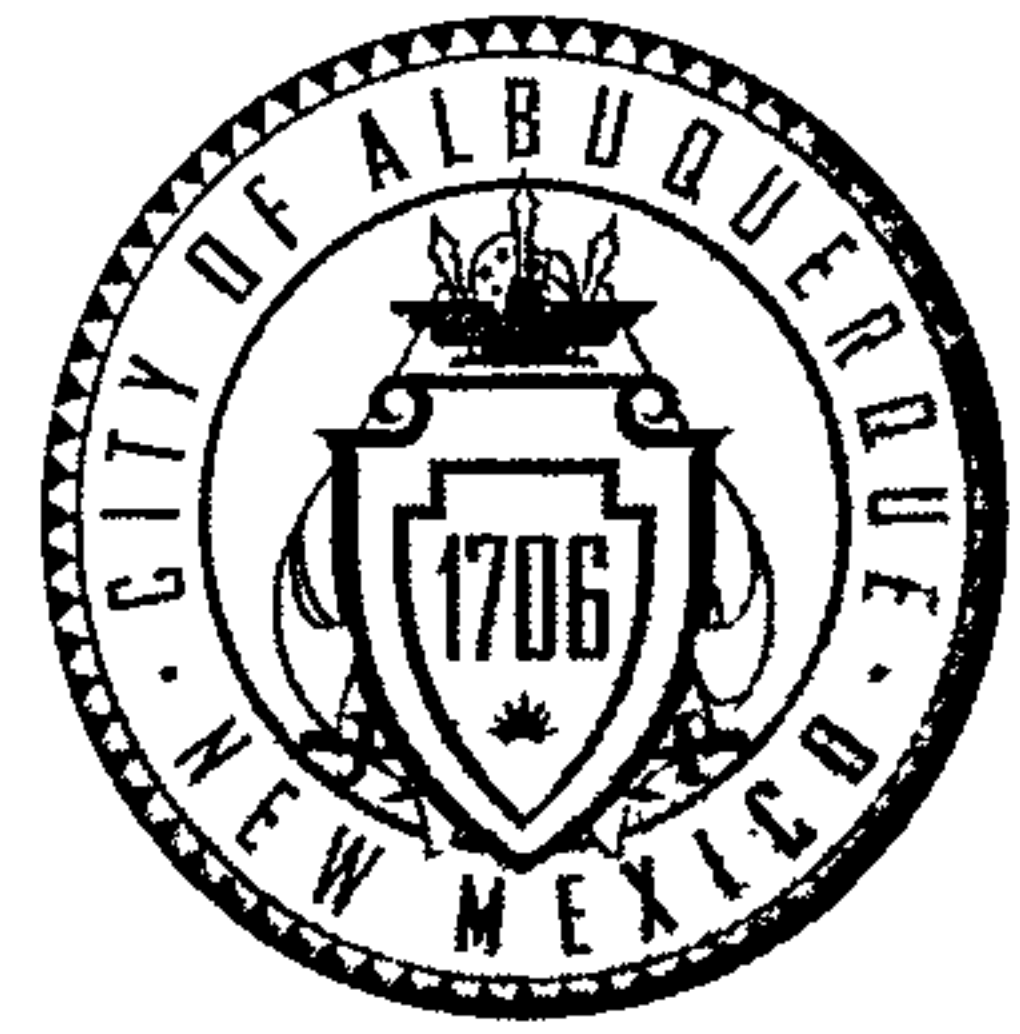

Frank Corral, P.E.
CEA Group
4712 Woodrow Bean Suite F
El Paso, TX 79924

**RE: Biopark- Carousel Area
COA Zoo 903 10th St SW
Grading and Drainage Plan
Engineers Stamp Date 4/10/15 Revision 5/29/15 (K13D034E)**

Dear Mr. Corral,

Based upon the information provided in your submittal received 7/6/2015, the above referenced Grading and Drainage Plan is acceptable for Grading Permit and Building Permit.

Please attach a copy of this approved plan to the construction sets in the permitting process prior to sign-off by Hydrology.

When completed please provide a copy of the as-build for our records.

PO Box 1293

If you have any questions please contact me at 924-3695 or Rudy Rael at 924-3977.

Albuquerque

New Mexico 87103

www.cabq.gov

Sincerely,

Rita Harmon, P.E.
Senior Engineer, Hydrology
Planning Department

RR/RH
C: File

FAST TRACK

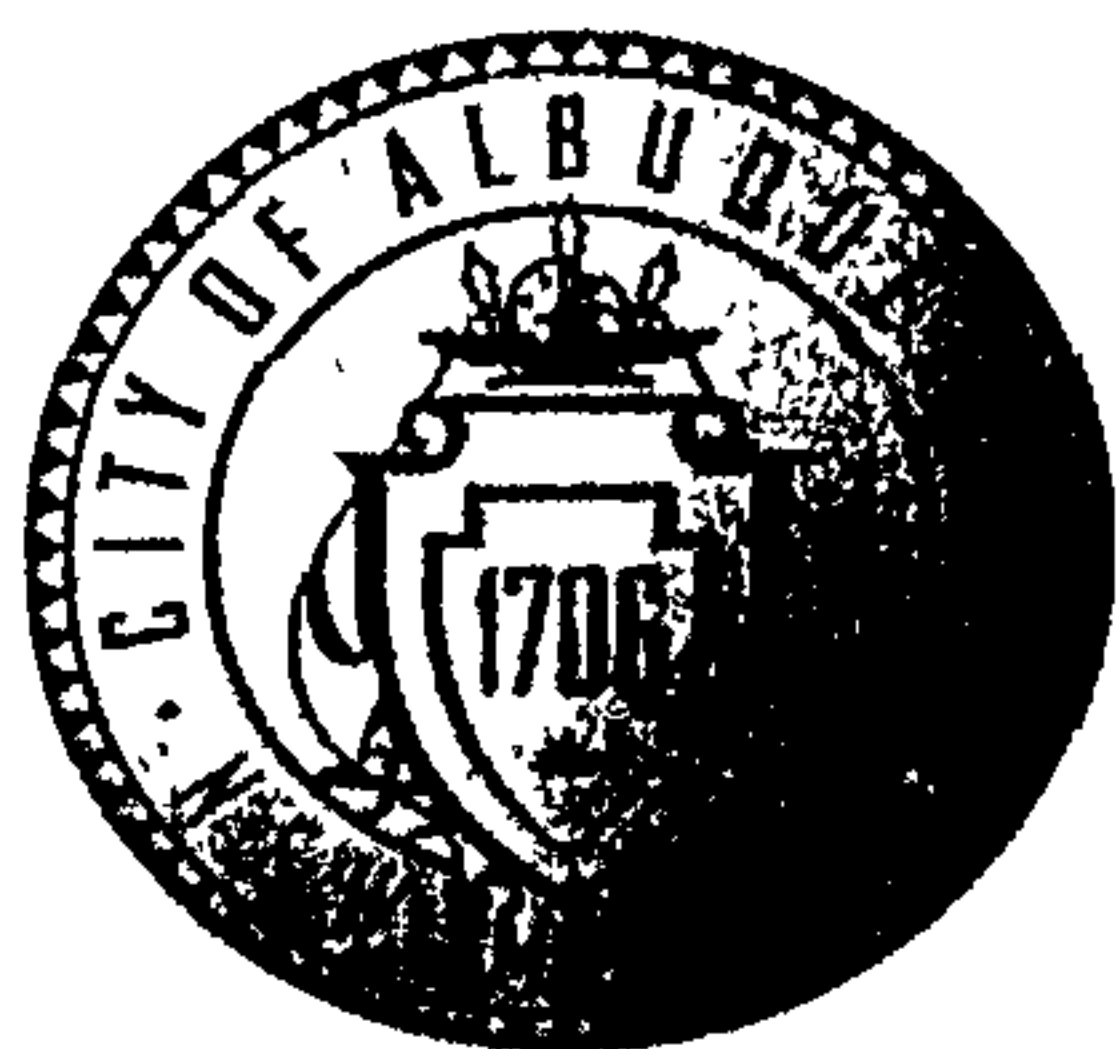

City of Albuquerque

Planning Department

Development & Building Services Division DRAINAGE AND TRANSPORTATION INFORMATION SHEET (REV 02/2013)

Project Title: ALBUQUERQUE BIOPARK CAROUSEL AREA Building Permit #: T201591071 City Drainage #: K3D034E
DRB#: _____ EPC#: _____ Work Order#: _____

Legal Description: _____

City Address: 903 10TH STREET SW, ALBUQUERQUE, NM 87102

Engineering Firm: CEA GROUP

Contact: FRANK CORRAL

Address: 4712 WOODROW BEAN, STE F, EL PASO, TX 79924

Phone#: 915-544-5232

Fax#: 915-544-5233

E-mail: frank@ceagroup.net

Owner: NEW MEXICO BIOPARK SOCIETY

Contact: JULIE RUGG

Address: 903 10TH STREET SW, ALBUQUERQUE, NM 87102

Phone#: 505-764-6280

Fax#: 505-764-6226

E-mail: director@biopark-society.org

Architect: STAZGA INTERNATIONAL

Contact: STEVEN M. CECVALA

Address: 751 CORNELL AVE, DREYEL HILL, PA 19026

Phone#: 610-955-3306

Fax#: _____

E-mail: scecvala@stazga-international.org

Surveyor: SURV-TEK, INC.

Contact: RUSS HUGG

Address: 9384 VALLEY VIEW DR. NW, ALBUQUERQUE, NM 87114

Phone#: 505-897-3366

Fax#: 505-897-3377

E-mail: russhugg@survtek.com

Contractor: ANCHOR BUILT, INC.

Contact: MICHAEL FRANCO

Address: 304 INDIANA STREET SE, ALBUQUERQUE, NM 87108

Phone#: 505-342-2452

Fax#: 505-344-2542

E-mail: mfranco@anchorbuilt.com

TYPE OF SUBMITTAL:

- ☐ DRAINAGE REPORT
☐ DRAINAGE PLAN 1st SUBMITTAL
☒ DRAINAGE PLAN RESUBMITTAL
☐ CONCEPTUAL G & D PLAN
☐ GRADING PLAN
☐ EROSION & SEDIMENT CONTROL PLAN (ESC)
☐ ENGINEER'S CERT (HYDROLOGY)
☐ CLOMR/LOMR
☐ TRAFFIC CIRCULATION LAYOUT (TCL)
☐ ENGINEER'S CERT (TCL)
☐ ENGINEER'S CERT (DRB SITE PLAN)
☐ ENGINEER'S CERT (ESC)
☐ SO-19
☐ OTHER (SPECIFY) _____

CHECK TYPE OF APPROVAL/ACCEPTANCE SOUGHT:

- ☐ SIA/FINANCIAL GUARANTEE RELEASE
☐ PRELIMINARY PLAT APPROVAL
☐ S. DEV. PLAN FOR SUB'D APPROVAL
☐ S. DEV. FOR BLDG. PERMIT APPROVAL
☐ SECTOR PLAN APPROVAL
☐ FINAL PLAT APPROVAL
☐ CERTIFICATE OF OCCUPANCY (PERM)
☐ CERTIFICATE OF OCCUPANCY (TCL TEMP)
☐ FOUNDATION PERMIT APPROVAL
☒ BUILDING PERMIT APPROVAL
☐ GRADING PERMIT APPROVAL
☐ PAVING PERMIT APPROVAL
☐ WORK ORDER APPROVAL
☐ GRADING CERTIFICATION
☐ SO-19 APPROVAL
☐ ESC PERMIT APPROVAL
☐ ESC CERT. ACCEPTANCE
☐ OTHER (SPECIFY) _____

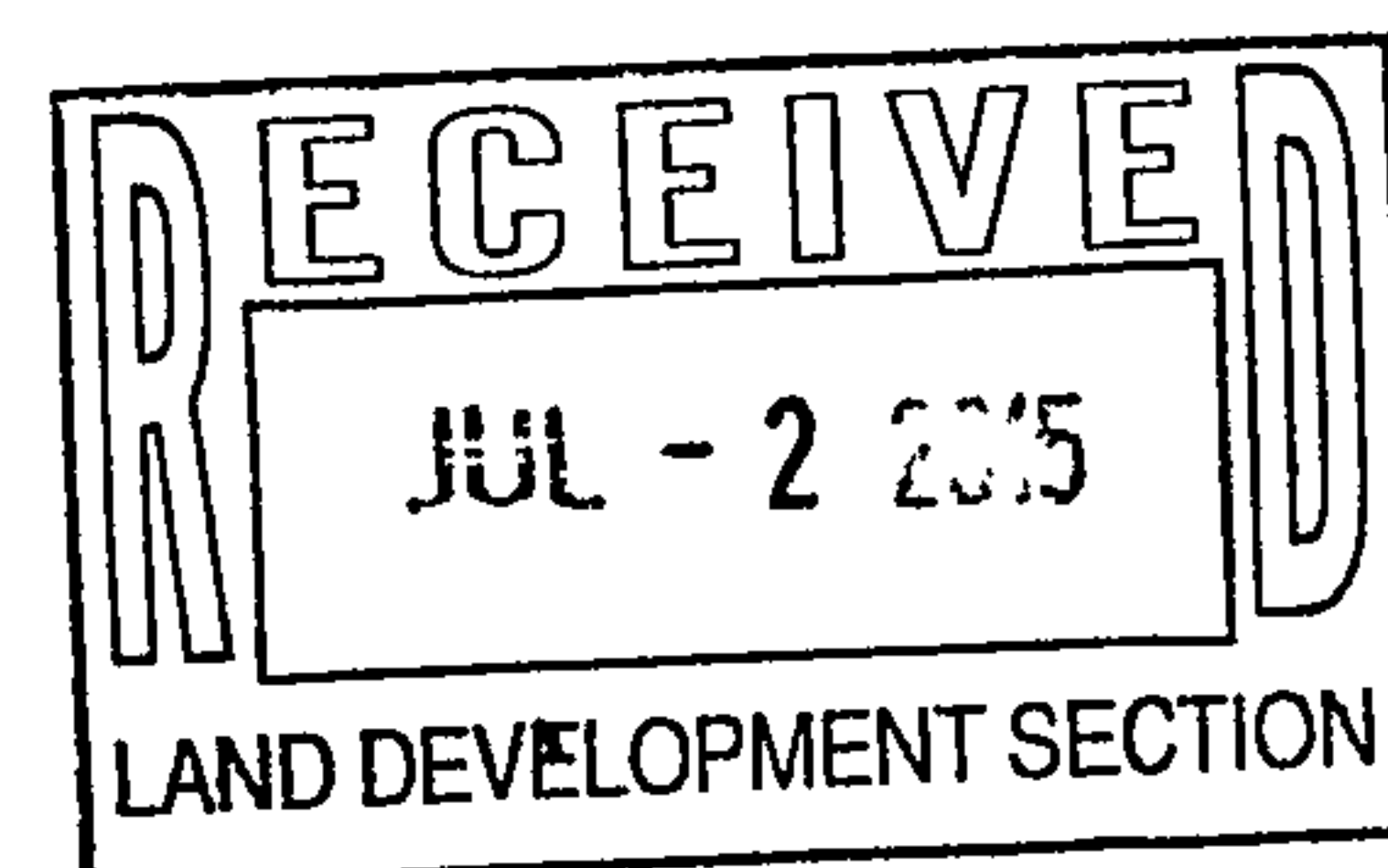

WAS A PRE-DESIGN CONFERENCE ATTENDED: _____

Yes ☒ No ☐ Copy Provided ☐

DATE SUBMITTED: 07/01/15











By: [Signature]

Requests for approvals of Site Development Plans and/or Subdivision Plans shall be accompanied by a drainage submittal. The particular nature, location, an scope to the proposed development defines the degree of drainage detail. One or more of the following levels of submittal may be required based on the followin

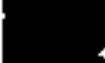
1. **Conceptual Grading and Drainage Plan:** Required for approval of Site Development Plans greater than five (5) acres and Sector Plans
2. **Drainage Plans:** Required for building permits, grading permits, paving permits and site plans less than five (5) acres
3. **Drainage Report:** Required for subdivision containing more than ten (10) lots or constituting five (5) acres or more
4. **Erosion and Sediment Control Plan:** Required for any new development and redevelopment site with 1-acre or more of land disturbing area, including project less than 1-acre than are part of a larger common plan of development



Legend

- Bernalillo County Parcels**
-  **Primary Streets**
 -  **Urban Principal Arterial**
 -  **BN and SF Railroad**
 -  **Freeway**
 -  **Urban Minor Arterial**
 - Other Streets**
 - Municipal Limits**
 -  **Corrales**
 -  **Edgewood**
 -  **Los Ranchos**
 -  **Rio Rancho**
 -  **Tijeras**
 -  **UNINCORPORATED**
- World Street Map**

Notes

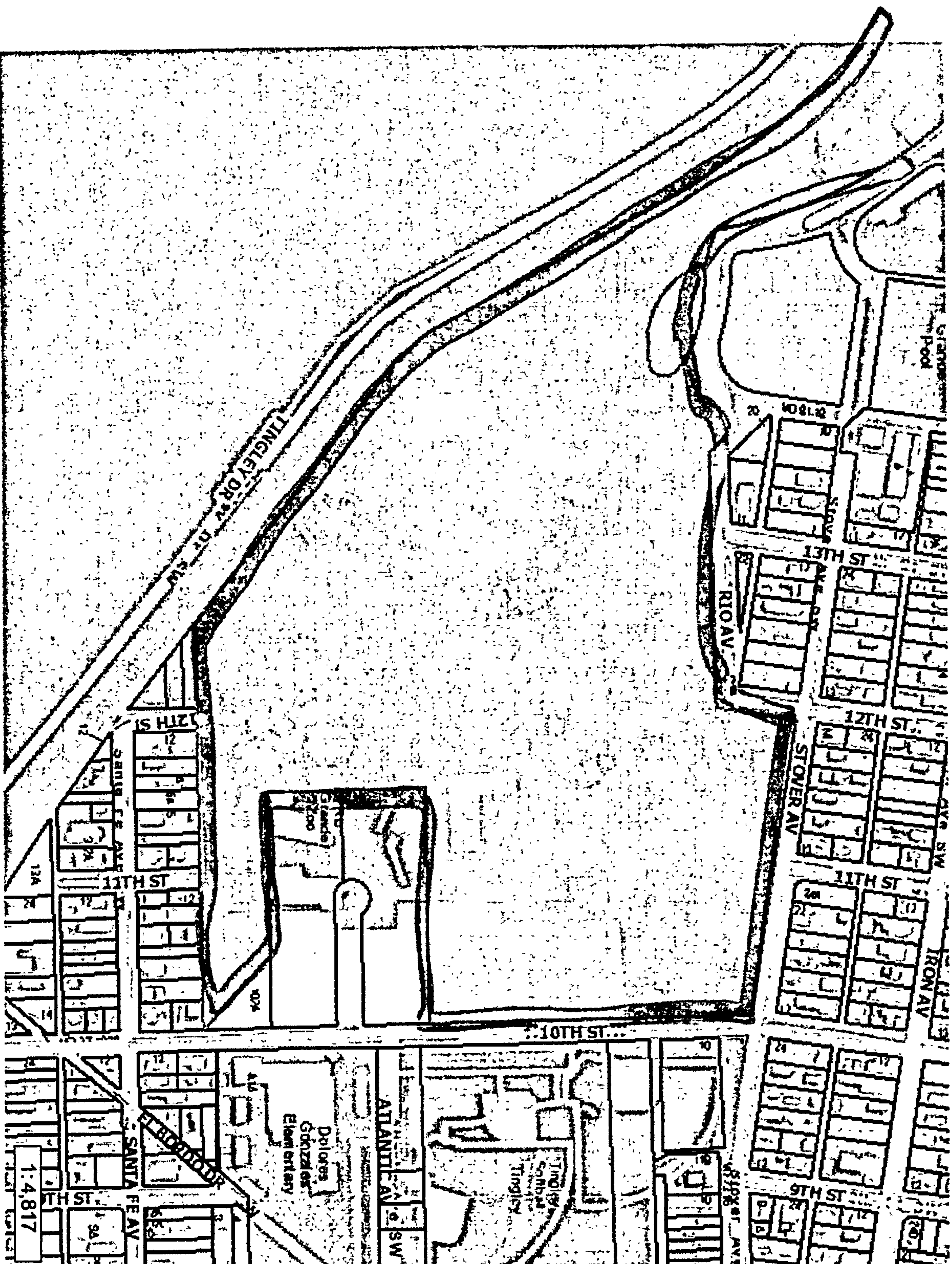

	0	0.05	0.1 Miles
0.1			

WGS_1984_Web_Mercator_Auxiliary_Sphere
6/1/2015 City of Albuquerque

This map is a user generated static output from www.cabq.gov/gis and is for reference only. Data layers that appear on this map may or may not be

THIS MAP IS NOT TO BE USED FOR LEGAL PURPOSES

Layer List

Administrative
Buildings
Contours and Soils
Cultural Services
Facilities
FEMA
Hydrology
Map Indexes
Miscellaneous
Orthoimagery
Parcels
Assessor Parcels
Boundary Surveys Book/Page
Platted Parcels
Platted Parcels Addresses
Platted Parcels Book/Page
Platted Parcels Easements
Permits
Political Districts
Public Safety
Road Maintenance
Sandia National Labs
Schools
Transportation
Zoning and Planning

Hide Legend

Selection

No features are currently selected. You can select features from one or more layers using the selection tools.

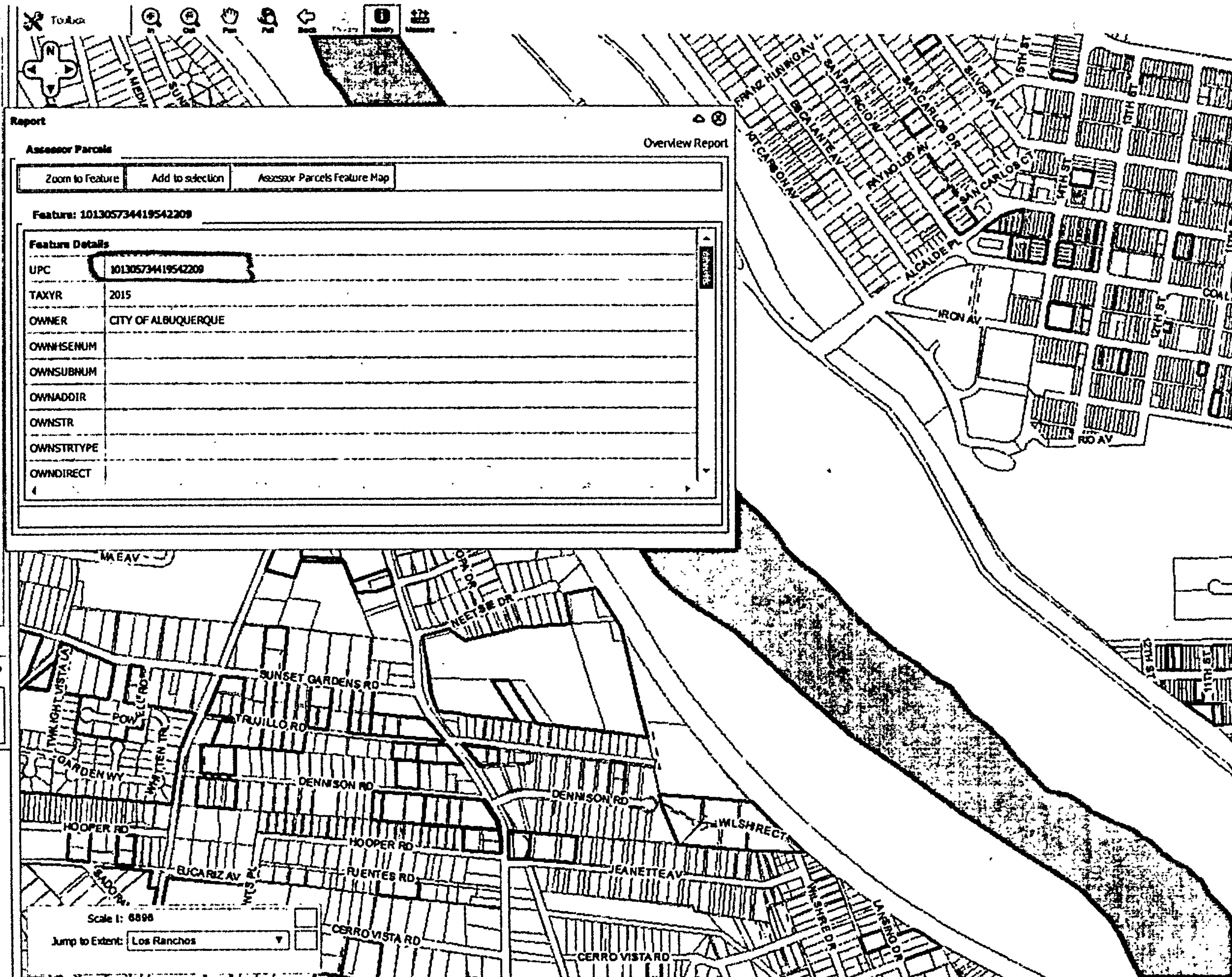

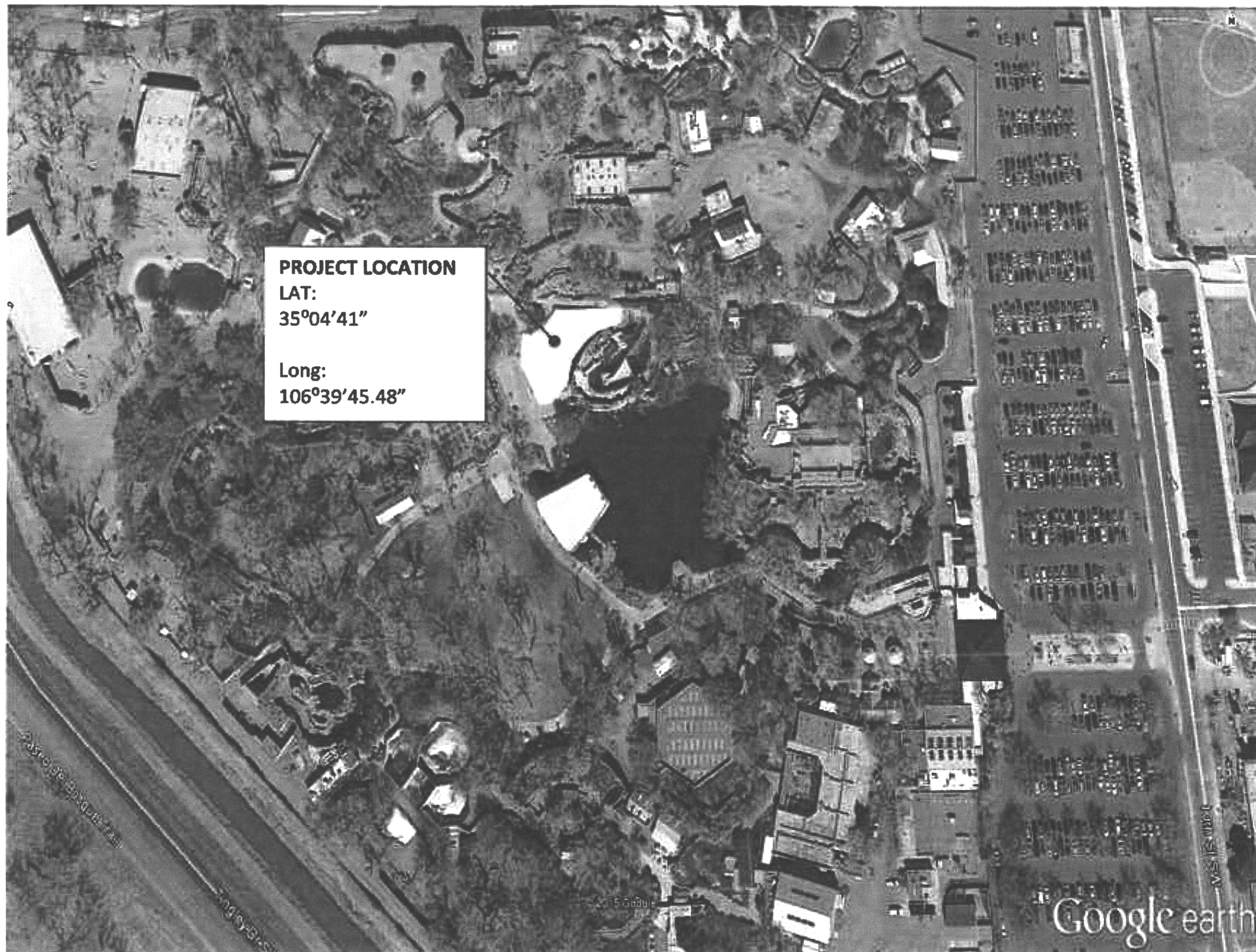

PROJECT LOCATION
LAT:
35°04'41"

Long:
106°39'45.48"

Google earth

CITY OF ALBUQUERQUE

May 27, 2015

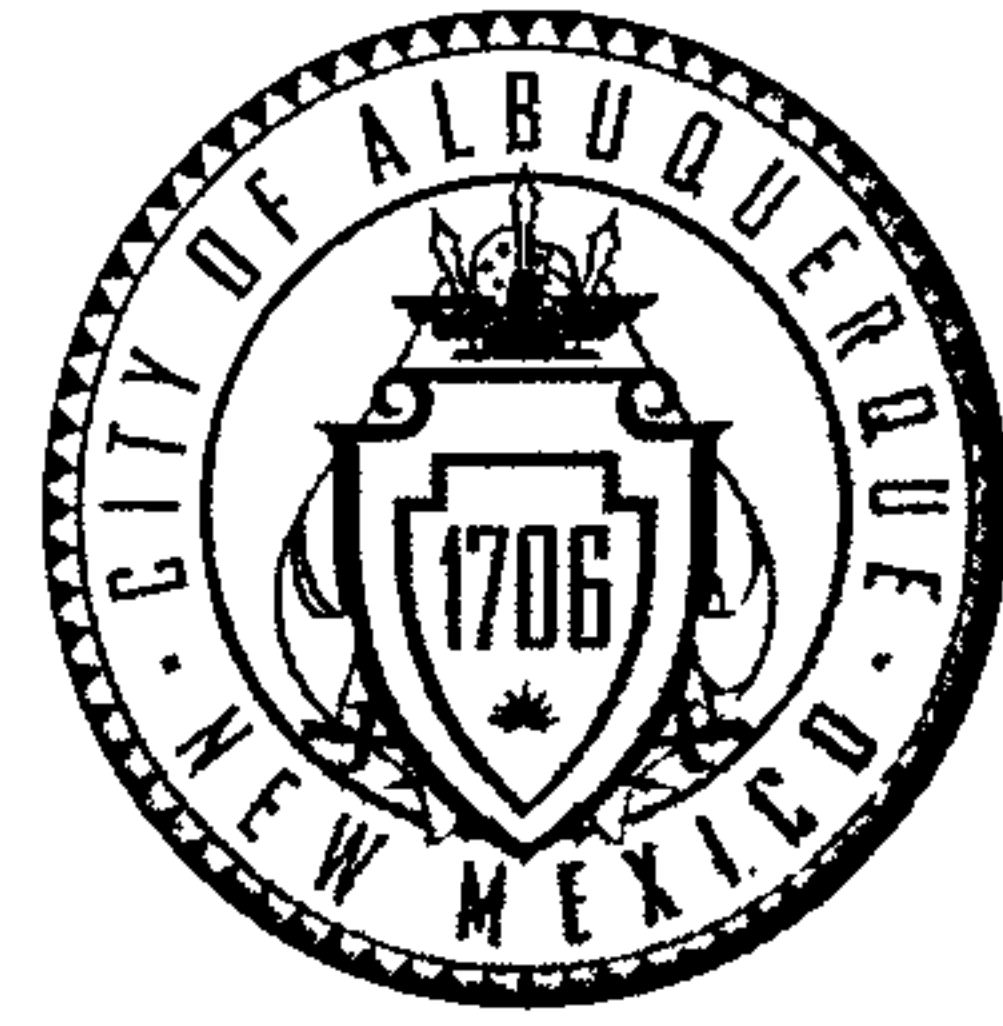

Frank Corral, P.E.
CEA Group
4712 Woodrow Bean Suite F
El Paso, TX 79924

RE: **Biopark- Carousel Area**
COA Zoo
Grading and Drainage Plan
Engineers Stamp Date 4/10/15 (K13D034E)

Dear Mr. Corral,

Based upon the information provided in your submittal received 5/20/2015, the above referenced Grading and Drainage Plan cannot be approved for Grading Permit or Building Permit until the following comments are addressed.

- Provide a site plan and FIRMette of this location.
- Provide a table of calculations for land treatments, percentages, existing and proposed flows.
- Provide a legal description of this site.
- Show or mention the location of the bench mark.
- Provide how flows will leave this area.

PO Box 1293

Albuquerque

If you have any questions please contact me at 924-3695 or Rudy Rael at 924-3977.

New Mexico 87103

www.cabq.gov

Sincerely,

Rita Harmon, P.E.
Senior Engineer, Hydrology
Planning Department

RR/RH
C: File



City of Albuquerque

Planning Department

Development & Building Services Division DRAINAGE AND TRANSPORTATION INFORMATION SHEET (REV 02/2013)

Project Title: BIOPARK - CAROUSEL AREA Building Permit #: T201591071 City Drainage #: K13DD034E
DRB#: _____ EPC#: _____ Work Order#: _____
Legal Description: _____
City Address: 903 10TH STREET SW, ALBUQUERQUE, NM 87102
Engineering Firm: CEA GROUP Contact: FRANK CORRAL
Address: 4712 WOODROW BEAN STE F, EL PASO, TX 79924
Phone#: 915-544-5232 Fax#: 915-544-5233 E-mail: fcorral@ceagroup.net
Owner: NEW MEXICO BIOPARK SOCIETY Contact: JULIE ROGG
Address: 903 10TH STREET, ALBUQUERQUE, NM 87102
Phone#: 505-764-6280 Fax#: 505-764-6226 E-mail: director@bioparksociety.org
Architect: STEVE M. CECCHVALA - TAIGA INTERNATIONAL Contact: STEVEN CECCHVALA
Address: 751 CORNWELL AVE., DREXEL HILL, PA 19026
Phone#: 610-955-3306 Fax#: _____ E-mail: cecchvala@taiga-international.org
Surveyor: SURV-TEK, INC. Contact: ROSS HUGG
Address: 9384 VALLEY VIEW DR, NW, ALBUQUERQUE, NM 87114
Phone#: 505-897-3366 Fax#: 505-897-3377 E-mail: russhugg@survtek.com
Contractor: ANCHOR BUILT, INC. Contact: MICHAEL FRANCES
Address: 304 INDIANA ST, ALBUQUERQUE, NM 87108
Phone#: 505-342-2452 Fax#: 505-344-2542 E-mail: mfrances@anchorbuilt.com

TYPE OF SUBMITTAL:

- ☐ DRAINAGE REPORT
☒ DRAINAGE PLAN 1st SUBMITTAL
☐ DRAINAGE PLAN RESUBMITTAL
☐ CONCEPTUAL G & D PLAN
☒ GRADING PLAN
☐ EROSION & SEDIMENT CONTROL PLAN (ESC)
☐ ENGINEER'S CERT (HYDROLOGY)
☐ CLOMR/LOMR
☐ TRAFFIC CIRCULATION LAYOUT (TCL)
☐ ENGINEER'S CERT (TCL)
☐ ENGINEER'S CERT (DRB SITE PLAN)
☐ ENGINEER'S CERT (ESC)
☐ SO-19
☐ OTHER (SPECIFY) _____

CHECK TYPE OF APPROVAL/ACCEPTANCE SOUGHT:

- ☐ SIA/FINANCIAL GUARANTEE RELEASE
☐ PRELIMINARY PLAT APPROVAL
☐ S. DEV. PLAN FOR SUB'D APPROVAL
☐ S. DEV. FOR BLDG. PERMIT APPROVAL
☐ SECTOR PLAN APPROVAL
☐ FINAL PLAT APPROVAL
☐ CERTIFICATE OF OCCUPANCY (PERM)
☐ CERTIFICATE OF OCCUPANCY (TCL TEMP)
☐ FOUNDATION PERMIT APPROVAL
☒ BUILDING PERMIT APPROVAL
☒ GRADING PERMIT APPROVAL
☐ PAVING PERMIT APPROVAL
☐ WORK ORDER APPROVAL
☐ GRADING CERTIFICATION
☐ SO-19 APPROVAL
☐ ESC PERMIT APPROVAL
☐ ESC CERT. ACCEPTANCE
☐ OTHER (SPECIFY) _____

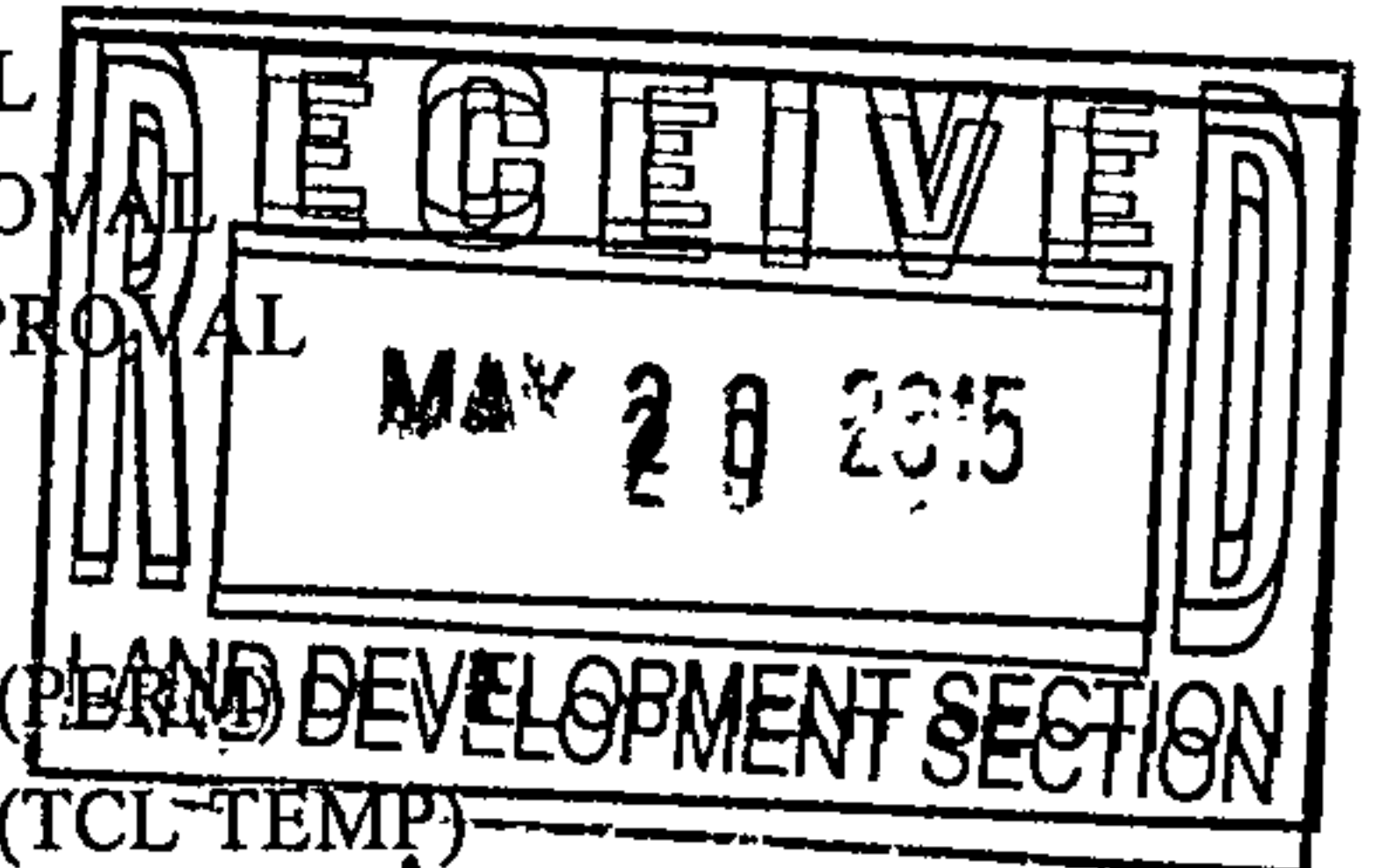

As Paid \$50.00 ✓

WAS A PRE-DESIGN CONFERENCE ATTENDED: _____ Yes ☒ No _____ Copy Provided _____

DATE SUBMITTED: _____ By: _____

Requests for approvals of Site Development Plans and/or Subdivision Plats shall be accompanied by a drainage submittal. The particular nature, location, an scope to the proposed development defines the degree of drainage detail. One or more of the following levels of submittal may be required based on the followin

1. **Conceptual Grading and Drainage Plan:** Required for approval of Site Development Plans greater than five (5) acres and Sector Plans
2. **Drainage Plans:** Required for building permits, grading permits, paving permits and site plans less than five (5) acres
3. **Drainage Report:** Required for subdivision containing more than ten (10) lots or constituting five (5) acres or more
4. **Erosion and Sediment Control Plan:** Required for any new development and redevelopment site with 1-acre or more of land disturbing area, including project less than 1-acre than are part of a larger common plan of development