

# CITY OF ALBUQUERQUE

Planning Department  
David Campbell, Director



Mayor Timothy M. Keller

July 31, 2018

Rick Beltramo, P.E.  
Respec  
5971 Jefferson St. NE  
Albuquerque, NM, 8710

**RE: Hotel & Parking Structure  
222 Central Avenue SE  
Grading and Drainage Plan  
Engineer's Stamp Date: 07/27/18  
Hydrology File: K14D017**

Dear Mr. Beltramo:

PO Box 1293

Based upon the information provided in your resubmittal received 07/26/2018, the Grading and Drainage Plan is approved for Building Permit and SO-19 Permit.

Albuquerque

Please attach a copy of this approved plan in the construction sets for Building Permit processing along with a copy of this letter.

NM 87103

Prior to approval in support of Permanent Release of Occupancy by Hydrology, Engineer Certification per the DPM checklist will be required and a formal Elevation Certificate needs to be submitted to Hydrology.

www.cabq.gov

If you have any questions, please contact me at 924-3995 or [rbrissette@cabq.gov](mailto:rbrissette@cabq.gov).

Sincerely,

*Renée C. Brissette*

Renée C. Brissette, P.E. CFM  
Senior Engineer, Hydrology  
Planning Department



# City of Albuquerque

Planning Department

Development & Building Services Division

## DRAINAGE AND TRANSPORTATION INFORMATION SHEET (REV 3/2018)

**Project Title:** \_\_\_\_\_ **Building Permit #:** \_\_\_\_\_ **Hydrology File #:** \_\_\_\_\_

**DRB#:** \_\_\_\_\_ **EPC#:** \_\_\_\_\_ **Work Order#:** \_\_\_\_\_

**Legal Description:** \_\_\_\_\_

**City Address:** \_\_\_\_\_

**Applicant:** \_\_\_\_\_ **Contact:** \_\_\_\_\_

**Address:** \_\_\_\_\_

**Phone#:** \_\_\_\_\_ **Fax#:** \_\_\_\_\_ **E-mail:** \_\_\_\_\_

**Other Contact:** \_\_\_\_\_ **Contact:** \_\_\_\_\_

**Address:** \_\_\_\_\_

**Phone#:** \_\_\_\_\_ **Fax#:** \_\_\_\_\_ **E-mail:** \_\_\_\_\_

Check all that Apply:

IS THIS A RESUBMITTAL?: \_\_\_\_ Yes \_\_\_\_ No

**DEPARTMENT:**

- \_\_\_\_ HYDROLOGY/ DRAINAGE  
\_\_\_\_ TRAFFIC/ TRANSPORTATION

**TYPE OF SUBMITTAL:**

- \_\_\_\_ ENGINEER/ARCHITECT CERTIFICATION  
\_\_\_\_ PAD CERTIFICATION  
\_\_\_\_ CONCEPTUAL G & D PLAN  
\_\_\_\_ GRADING PLAN  
\_\_\_\_ DRAINAGE MASTER PLAN  
\_\_\_\_ DRAINAGE REPORT  
\_\_\_\_ FLOODPLAIN DEVELOPMENT PERMIT APPLIC  
\_\_\_\_ ELEVATION CERTIFICATE  
\_\_\_\_ CLOMR/LOMR  
  
\_\_\_\_ TRAFFIC CIRCULATION LAYOUT (TCL)  
\_\_\_\_ TRAFFIC IMPACT STUDY (TIS)  
  
\_\_\_\_ OTHER (SPECIFY) \_\_\_\_\_  
\_\_\_\_ PRE-DESIGN MEETING?

**TYPE OF APPROVAL/ACCEPTANCE SOUGHT:**

- \_\_\_\_ BUILDING PERMIT APPROVAL  
\_\_\_\_ CERTIFICATE OF OCCUPANCY  
  
\_\_\_\_ PRELIMINARY PLAT APPROVAL  
\_\_\_\_ SITE PLAN FOR SUB'D APPROVAL  
\_\_\_\_ SITE PLAN FOR BLDG. PERMIT APPROVAL  
\_\_\_\_ FINAL PLAT APPROVAL  
  
\_\_\_\_ SIA/ RELEASE OF FINANCIAL GUARANTEE  
\_\_\_\_ FOUNDATION PERMIT APPROVAL  
\_\_\_\_ GRADING PERMIT APPROVAL  
\_\_\_\_ SO-19 APPROVAL  
\_\_\_\_ PAVING PERMIT APPROVAL  
\_\_\_\_ GRADING/ PAD CERTIFICATION  
\_\_\_\_ WORK ORDER APPROVAL  
\_\_\_\_ CLOMR/LOMR  
\_\_\_\_ FLOODPLAIN DEVELOPMENT PERMIT  
\_\_\_\_ OTHER (SPECIFY) \_\_\_\_\_

**DATE SUBMITTED:** \_\_\_\_\_ **By:** \_\_\_\_\_

COA STAFF:

ELECTRONIC SUBMITTAL RECEIVED: \_\_\_\_\_

FEE PAID: \_\_\_\_\_



1. An excavation permit will be required before beginning any work within City Right-Of-Way.
2. All work on this project shall be performed in accordance with applicable federal, state and local laws, rules and regulations concerning construction safety and health.
3. Two working days prior to any excavation, the contractor must contact **New Albany** by **727.230.1174** [or (505) 260-1990] for the location of existing utilities.
4. Prior to construction, the contractor shall excavate and verify the locations of all obstructions. Should a conflict exist, the contractor shall notify the engineer so that the conflict can be resolved with a minimum amount of delay.
5. Briefed compaction shall be according to traffic/street use.
6. Maintenance of the facility shall be the responsibility of the owner of the property being served.
7. Work on arterial streets may be required on a 24-hour basis.
8. The contractor shall contact Jason Rodriguez at 235-8016 and Construction Coordinator at 924-3416 to schedule an inspection.

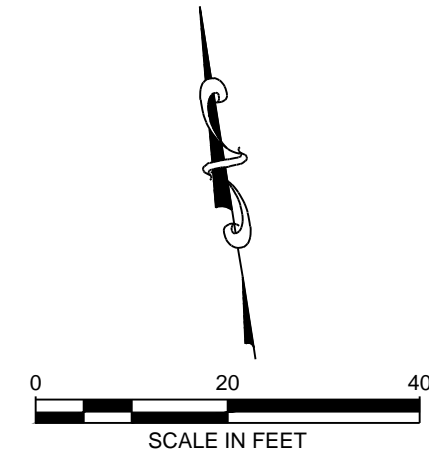
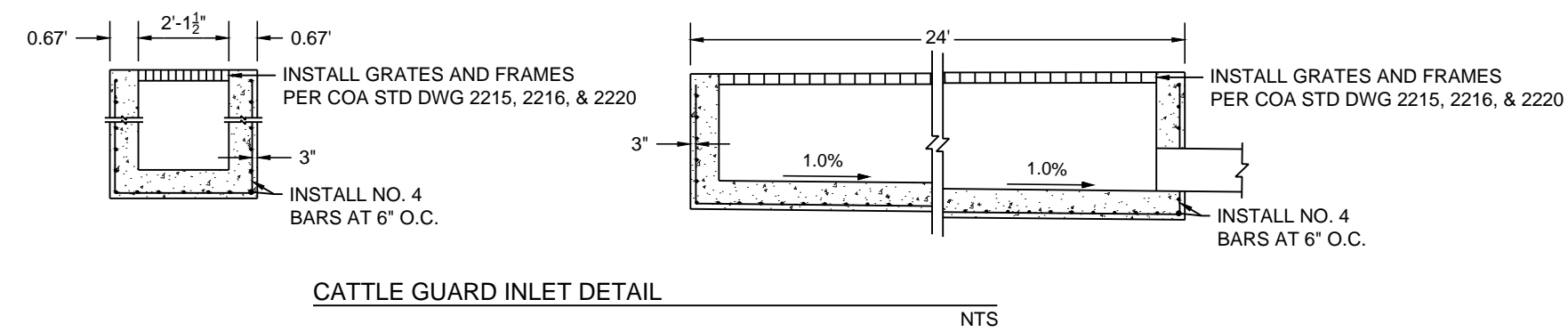
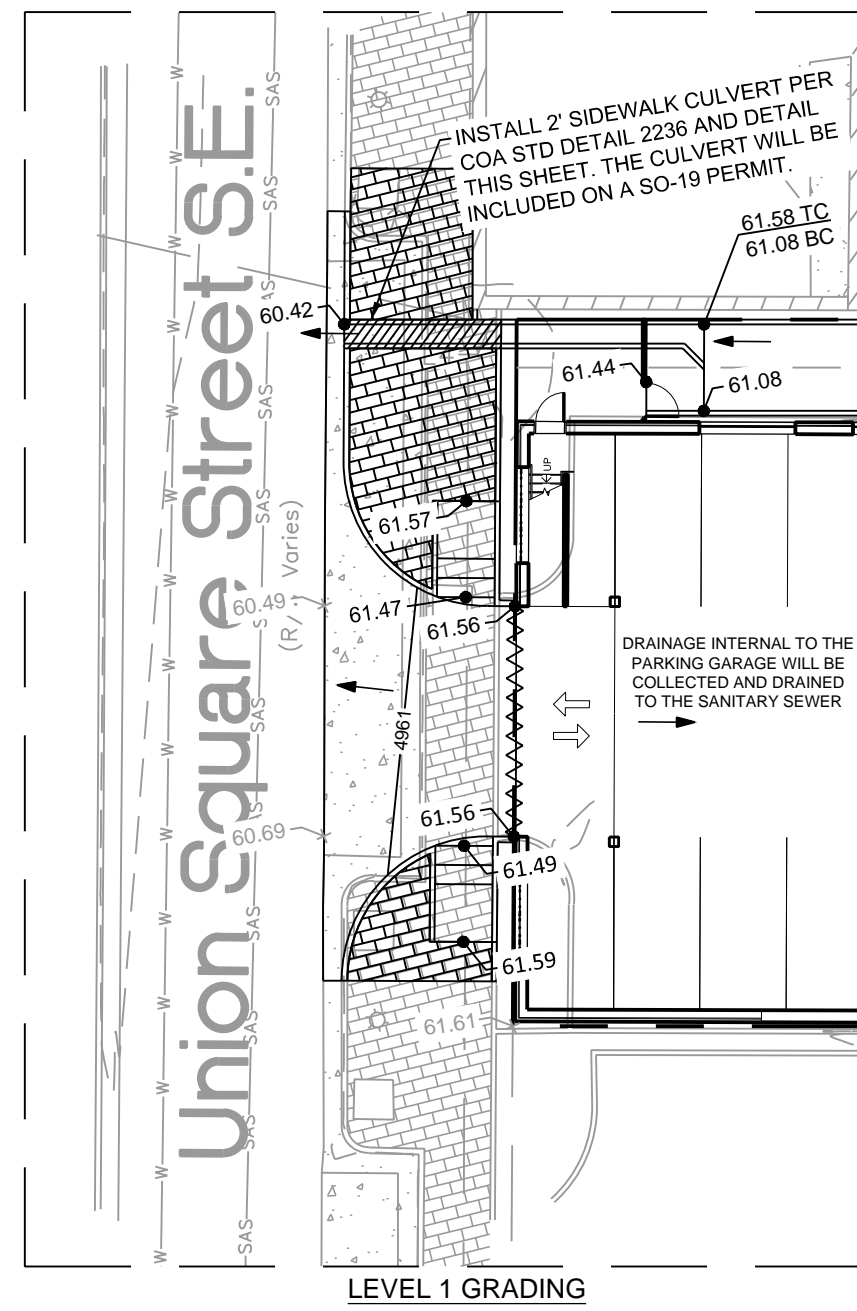

- 
- 6" MIN.  
3" 6" 24"
- 6" "V" INVERT
- 3" LIP
- 3" 2"
- BOTTOM OF C & G FLOWLINE ELEV.
- CONSTRUCTION JOINT OPTIONAL, IF USED, SPACE DOWELS AT 18" O.C. MAX., 1/2" MINIMUM FROM FACE OF CONCRETE.
- MATCH NEAREST CONTROL JOINT  
INSTALL 1/2" EXPANSION JOINT.
- NOTE: FOR MORE INFORMATION,  
REFERENCE COA STD DETAIL 2236

SIDEWALK CULVERT DETAIL NTS

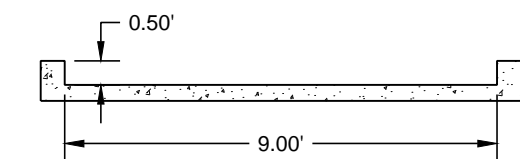

## CHANNEL DETAIL

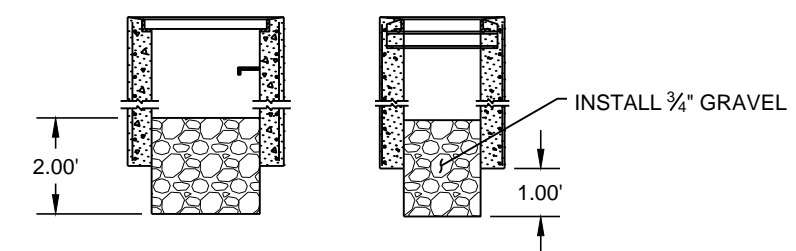

MODIFIED TYPE "D" INLET DETAIL

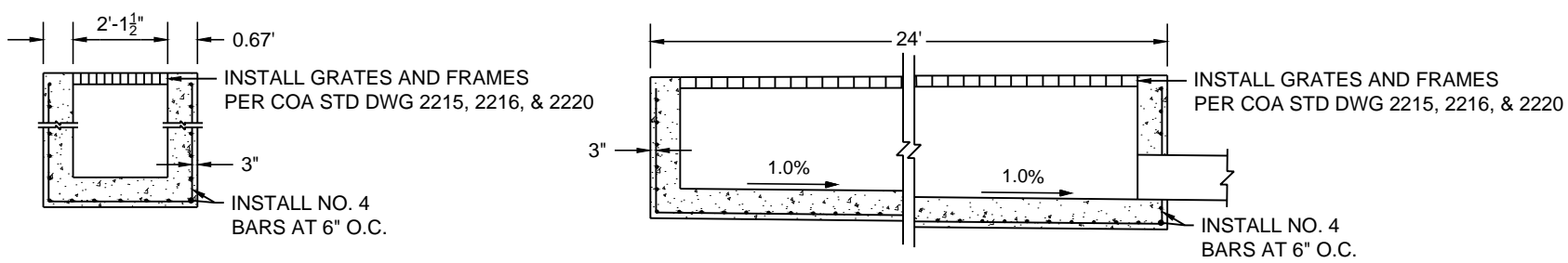

CATTLE GUARD INLET DETAIL

NTS

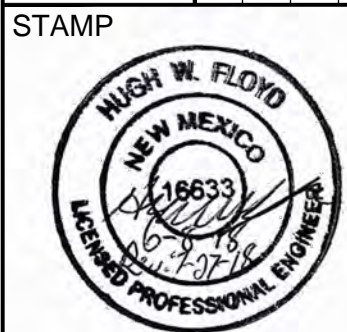

**nm811**

**Know what's below.  
Call before you dig.**

PROJECT NAME: HOTEL & PARKING STRUCTURE  
222 CENTRAL AVENUE SE  
ALBUQUERQUE, NM 87102

TITLE: GRADING PLAN

OUR: BUILDING PERMIT

SHEET NUMBER:  
**C-2**

REVISION	