

October 22, 1996

Martin J. Chávez, Mayor

Adam Wright
Red Mountain Engineers
4600-C Montgomery Blvd. NE
Albuquerque, NM 87109

**RE: ENGINEER CERTIFICATION FOR PHASE I & PHASING PLAN FOR
FAITH TEMPLE (K14-D58) CERTIFICATION STATEMENT DATED
10/16/96.**

Dear Mr. Wright:

Based on the information provided on your October 16, 1996 submittal, Engineer Certification for Phase I is acceptable.

Phase II paving will need to be revised to indicate asphalt paving within the public alley area. Please keep in mind that any work done within public Right-of-Way needs to be coordinated through D.R.C. In this instance, the alley improvements are not that lengthy, therefore may be handled through Hydrology. Prior to Phase II construction, please provide an updated submittal for review and approval.

If I can be of further assistance, please feel free to contact me at 768-2667.

Sincerely,

Bernie J. Montoya, CE
Engineering Associate

BJM/dl

c: Andrew Garcia
File

Good for You, Albuquerque!



DRAINAGE INFORMATION SHEET

PROJECT TITLE: FAITH TEMPLE ZONE ATLAS/DRNG. FILE #: K14-D58
 DRB #: _____ EPC #: _____ WORK ORDER #: _____
 LEGAL DESCRIPTION: LOTS 1, 7 AND 8, BLOCK 16 OF EASTERN ADDITION
 CITY ADDRESS: 1004 BROADWAY SE
 ENGINEERING FIRM: RED MOUNTAIN ENGINEERS CONTACT: ADAM WRIGHT
 ADDRESS: 4600-C MONTGOMERY NE, STE 101 PHONE: (505) 889-3004
 OWNER: _____ CONTACT: _____
 ADDRESS: _____ PHONE: _____
 ARCHITECT: _____ CONTACT: _____
 ADDRESS: _____ PHONE: _____
 SURVEYOR: _____ CONTACT: _____
 ADDRESS: _____ PHONE: _____
 CONTRACTOR: _____ CONTACT: _____
 ADDRESS: _____ PHONE: _____

TYPE OF SUBMITTAL:

____ DRAINAGE REPORT
☒ DRAINAGE PLAN
 ____ CONCEPTUAL GRADING & DRAINAGE PLAN
☒ GRADING PLAN
 ____ EROSION CONTROL PLAN
 ____ ENGINEER'S CERTIFICATION
 ____ OTHER _____

PRE-DESIGN MEETING:

____ YES
 ____ NO
 ____ COPY PROVIDED

CHECK TYPE OF APPROVAL SOUGHT:

____ SKETCH PLAT APPROVAL
 ____ PRELIMINARY PLAT APPROVAL
 ____ S. DEV. PLAN FOR SUB'D. APPROVAL
 ____ S. DEV. PLAN FOR BLDG. PERMIT APPROVAL
 ____ SECTOR PLAN APPROVAL
 ____ FINAL PLAT APPROVAL
 ____ FOUNDATION PERMIT APPROVAL
☒ BUILDING PERMIT APPROVAL
 ____ CERTIFICATE OF OCCUPANCY APPROVAL
☒ GRADING PERMIT APPROVAL
 ____ PAVING PERMIT APPROVAL
 ____ S.A.D. DRAINAGE REPORT
 ____ DRAINAGE REQUIREMENTS
 ____ SUBDIVISION CERTIFICATION
 ____ OTHER _____ (SPECIFY)

DATE SUBMITTED: 24 JAN 96
 BY: ADAM WRIGHT

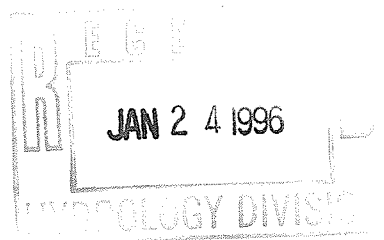

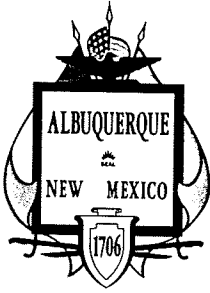

City of Albuquerque

P.O. BOX 1293 ALBUQUERQUE, NEW MEXICO 87103

January 30, 1996

Adam Wright
Red Mountain Engineer's Inc.
4600-C Montgomery NE
Suite 101
Albuquerque, NM 87109

**RE: FAITH TEMPLE (K14-D58) GRADING AND DRAINAGE PLAN FOR
BUILDING PERMIT AND GRADING PERMIT APPROVAL. ENGINEER'S
STAMP DATED 1-23-96.**

Dear Mr. Wright:

Based on the information provided on your January 24, 1996
submittal, the above referenced project is approved for Building
and Grading Permits.

Prior to Certificate of Occupancy approval, an Engineer's
Certification will be required.

If I can be of further assistance, please feel free to contact me
at 768-3622.

Sincerely

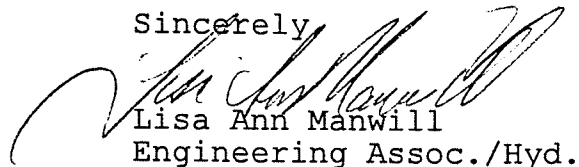

Lisa Ann Manwill
Engineering Assoc./Hyd.

c: Andrew Garcia
File



LEGEND

<u>59.33 TC</u>	PROPOSED ELEVATION
<u>(59.33) TC</u>	EXISTING ELEVATION
○ MH	MANHOLE
□ DI	DRAIN INLET
○ WV	WATER VALVE
○ —○	POWER POLE W/LIGHT
9999.00	SPOT ELEVATION AT TOP BACK OF C & G OR TOP OF ASPHALT
9999.9	SPOT ELEVATION ON NATURAL GROUND
○ PP	POWER POLE
—OH—	OVERHEAD POWER LINE
—SAS—	SANITARY SEWER LINE
—SD—	STORM DRAIN LINE
—W—	WATER LINE
—G—	GAS LINE
—R/W—	RIGHT-OF-WAY LINE
—O—	CHAIN LINK FENCE
—	ROCK CURB
—	EDGE OF BUILDING
○ —○	FIRE HYDRANT

3" ASPHALT CONCRETE

TACK COAT

12" SUBGRADE SOIL: R-VALUE>50,
95% COMPACTION

8" SUBGRADE PREPARATION
COMPACT TO 90% MAX. DENSITY

AC PAVEMENT SECTION
NO SCALE

GRAVEL SURFACING

IMPACT TO 95% MAX. DENSITY

GRAVEL SURFACING SECTION

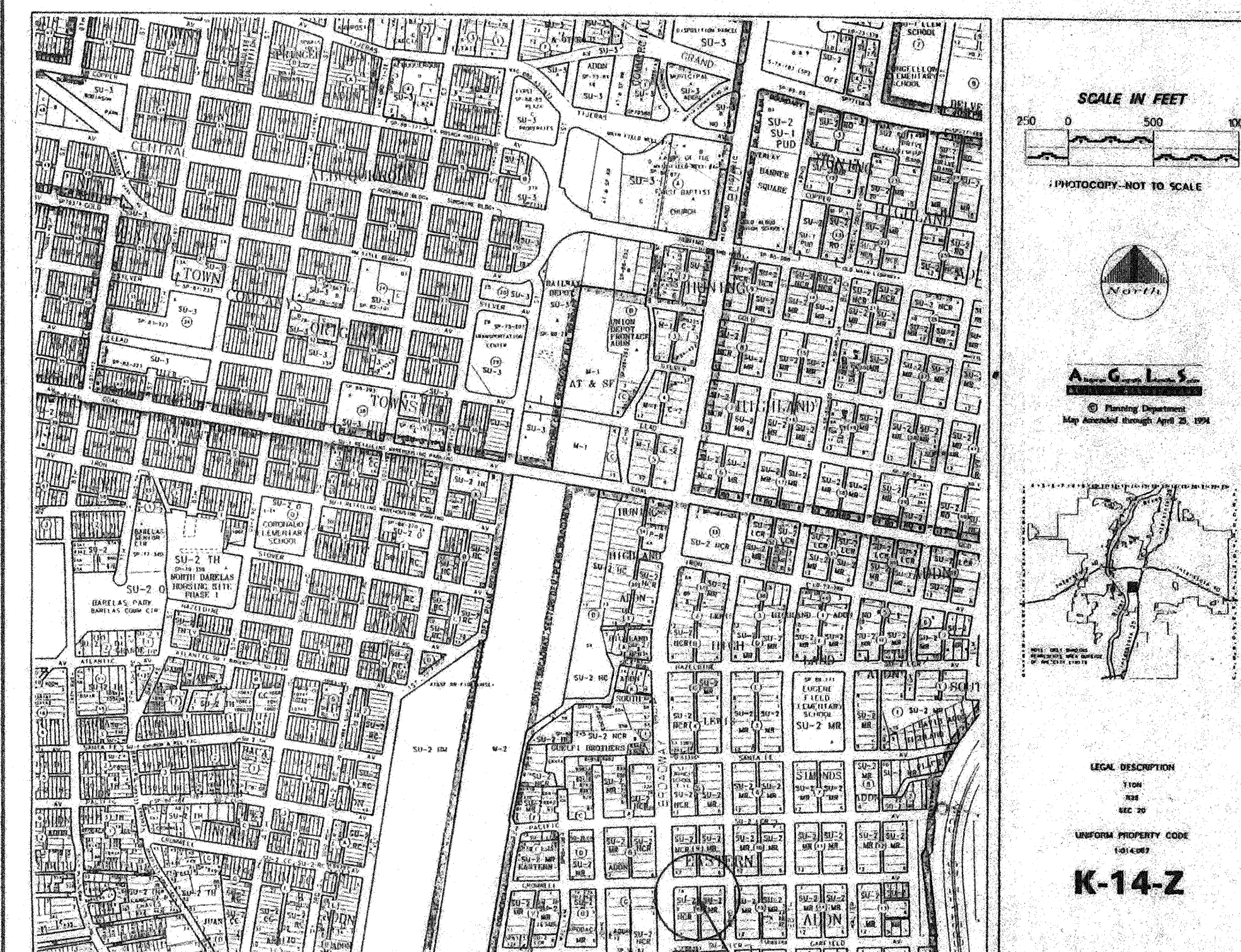

RUNOFF CALCULATIONS

1 PROJECT DESCRIPTION

THE EXISTING SITE INCLUDES A CHURCH BUILDING, AN ASPHALT PARKING AREA, AND UNPAVED (DIRT) PARKING AREA AND LANDSCAPED AREAS. THE PROPOSED IMPROVEMENTS INCLUDE A ROOM ADDITION TO THE CHURCH, A CONCRETE SIDEWALK AND A PAVED PARKING AREA.

ALL RUN OFF GENERATED ON SITE IS DISCHARGED INTO THE BROADWAY BOULEVARD AND CROMWELL STREET RIGHTS-OF-WAY AND FLOWS IN THE GUTTERS OF THOSE STREETS TO THE CATCH BASIN AT THEIR INTERSECTION. THE RUNOFF THEN FLOWS NORTH IN BROADWAY TO SANTA FE AVENUE THEN WEST IN SANTA FE TO THE SOUTH BROADWAY DETENTION BASIN.

THIS SITE DOES NOT CONTRIBUTE TO A DESIGNATED 100 YEAR FLOOD PLAIN AND
WILL HAVE NO SIGNIFICANT IMPACT ON DOWNSTREAM CONDITIONS.

2 LEGAL DESCRIPTION

A TRACT OF LAND LOCATED WITHIN THE CORPORATE LIMITS OF CITY OF ALBUQUERQUE, COMPRISING ALL OF LOTS 7 AND 8 IN BLOCK 16 OF THE EASTERN ADDITION AS SHOWN ON THE PLAT FILED IN THE OFFICE OF THE COUNTY CLERK OF BERNALILLO COUNTY, NEW MEXICO ON MAY 21, 1932 IN BOOK C1, FOLIO 171, AND BEING MORE PARTICULARLY DESCRIBED AS FOLLOWS:

BEGINNING AT THE NORTHWEST CORNER WHICH IS COMMON WITH THE NORTHWEST CORNER OF LOT 7, THENCE, EAST ALONG THE SOUTH RIGHT-OF-WAY OF CROMWELL AVENUE A DISTANCE OF 142.00 FEET; THENCE, SOUTH A DISTANCE OF 100.00 FEET, THENCE, WEST A DISTANCE OF 142.00 FEET; THENCE NORTH ALONG THE EAST RIGHT-OF-WAY OF BROADWAY BOULEVARD A DISTANCE OF 100.00 FEET TO THE POINT OF BEGINNING AND CONTAINING 0.3260 ACRES MORE OR LESS; AND

LOT NUMBERED ONE (1) IN BLOCK NUMBERED SIXTEEN (16) OF THE EASTERN ADDITION TO THE COTU OF ALBUQUERQUE, NEW MEXICO, AS THE SAME IS SHOWN AND DESIGNATED ON THE MAP OF SAID ADDITION, FILED IN THE OFFICE OF THE PROBATE CLERK AND EX-OFFICIO RECORDER OF BERNALILLO COUNTY, NEW MEXICO, ON MAY 31ST, 1882.

ARCHITECTS • PLANNERS • INTERIOR DESIGNERS
115 AMHERST DRIVE SE., ALBUQUERQUE, NEW MEXICO 87106
TELE. (505) 255-8668 FAX (505) 268-6665



SMPC
ARCHITECT

FAITH TEMPLE, 1004 BROADWAY SE, ALBUQUERQUE, NM

GRADING & DRAINAGE PLAN

REV. #	DATE	PROJECT #: 95XXX
--------	------	------------------

△ AS BUILT	10/16/96	DWN BY: AW
		CHG BY:

DATE: 18 OCT 95

C101

CIVIL

Of _____

PHASE 1
"AS BUILT"

RECEIVED
OCT 1 1964
HYDROLOGY