

ARNO STREET S.E.

GOLD AVENUE S.E.

EDITH BLVD. S.E.

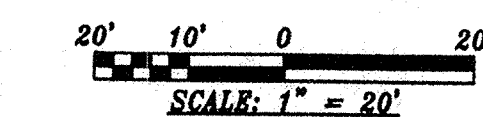
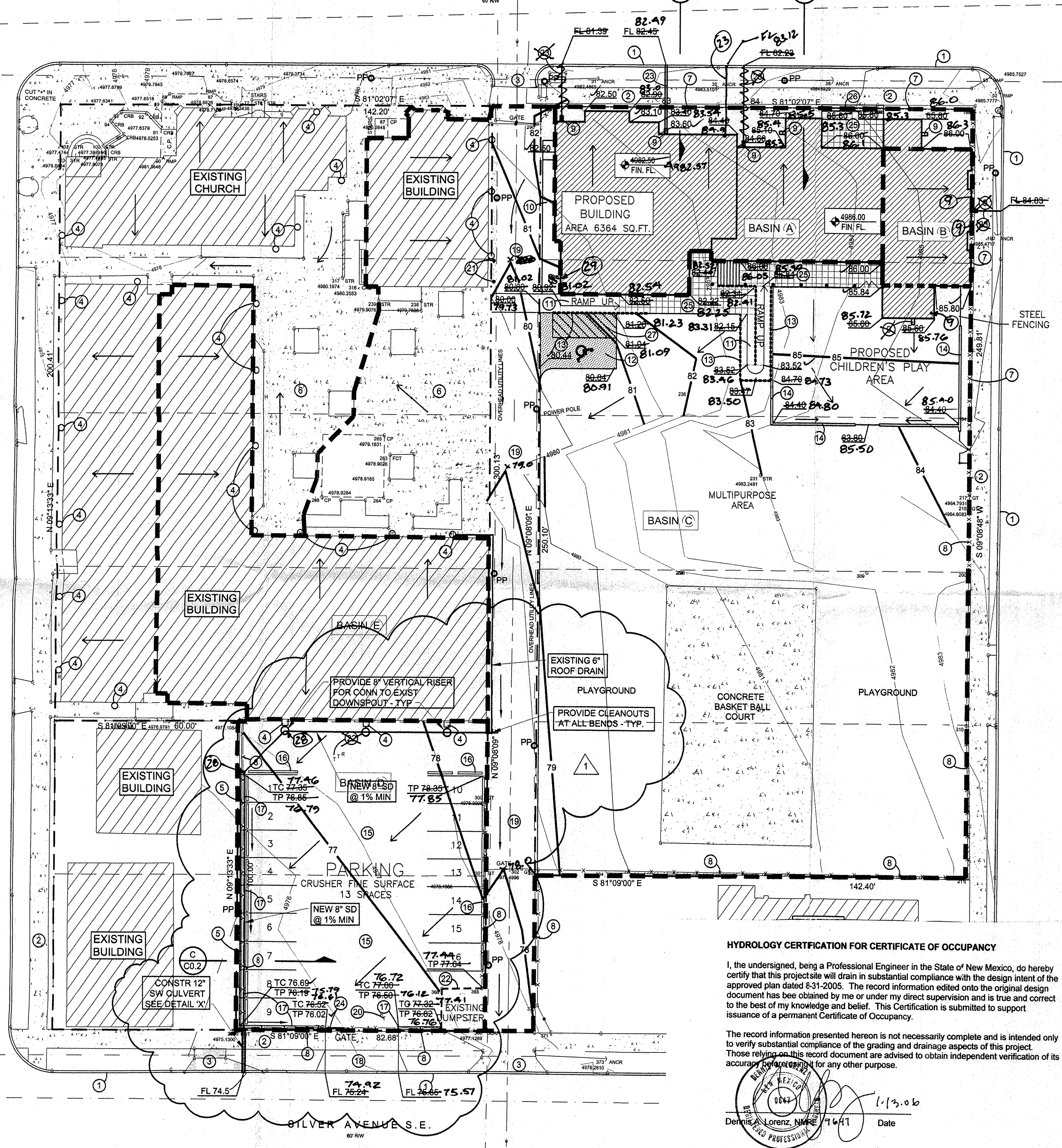

LEGEND

- 6001 EXISTING CONTOUR ELEVATION
- 02.5 X EXISTING SPOT ELEVATION
- 01 PROPOSED CONTOUR ELEVATION
- 01.5 PROPOSED SPOT ELEVATION
- DIRECTION OF FLOW
- DRAINAGE SWALE
- DRAINAGE BASIN DIVIDE
- PPO EXISTING POWER POLE
- NEW ASPHALT PAVING
- NEW RETAINING WALL

PROPERTY ADDRESS

300 Gold Avenue SE

LEGAL DESCRIPTION

Lots 1 Thru 5 and Lots 7 thru 10 and easterly 82 feet of Lots 11 and 12 Block 15, Hunning Highland Addition

PROJECT BENCHMARK

ACS Benchmark "6-K14 (R)"
Aluminum Cap
Elevation= 4968.765 Feet

SURVEY

Topographic and Field Measurements by
Harris Surveying Co., Inc.
Dated January 2002

KEYED NOTES

- EXISTING STANDARD CURB & GUTTER
- EXISTING 6" SIDEWALK
- EXISTING DRIVEPAD
- EXISTING DOWNSPOUT
- EXISTING CMU WALL TO REMAIN
- EXISTING CONCRETE COMMON AREA
- EXISTING CHAINLINK FENCE TO BE REMOVED
- EXISTING CHAINLINK FENCE TO REMAIN
- NEW ROOF DRAIN SCUPPER (TYP)
- NEW CONCRETE SIDEWALK
- NEW HANDICAP ACCESS RAMP
- SEE SHEET C002
- NEW ASPHALT HANDICAP ACCESSIBLE PARKING - SEE SECTION E/C0.2
- NEW CONCRETE RETAINING WALL SEE STRUCTURAL DESIGN
- NEW CMU PATIO WALL
- NEW CRUSHER FINES PARKING LOT - SEE SECTION D/C0.2
- NEW CONCRETE OR RECYCLED PLASTIC TIRE STOP - YELLOW OR GRAY STANDARD 6" LONG
- NEW CONCRETE HEADER CURB - TYP SEE SHEET C002
- NEW 24" CONCRETE DRIVEPAD PER CITY OF ALBUQUERQUE STD DWG 2425
- VACATED ALLEY
- REMOVED / ABANDON EXISTING IRRIGATION SPIGOTS AND VALVES
- EXISTING STATIONARY BOLLARDS TO REMAIN
- EXISTING WOOD FENCE TO REMAIN
- 4" PVC ROOF DRAIN PENETRATION THROUGH EXISTING CURB PER CITY OF ABO. STD DWG 2235
- CUT EXISTING C.L. FENCE. INSTALL 24" GATE.
- NEW PATTERNED CONCRETE SIDEWALK. SEE DETAIL SHEET C0.2
- PROVIDE 25"X12" STEP
- PROVIDE STRIPING AT ACCESSIBLE ISLE PER CODE

28. CLEAN-OUT DRAINAGE FACILITIES WITHIN CITY RIGHT-OF-WAY
29. 2'-3 1/2" DRAINAGE FACILITIES WITHIN CITY RIGHT-OF-WAY

- AN EXCAVATION/CONSTRUCTION PERMIT WILL BE REQUIRED BEFORE BEGINNING ANY WORK WITHIN A CITY RIGHT OF WAY.
- ALL WORK DETAILED ON THESE PLANS TO BE PERFORMED, EXCEPT AS OTHERWISE STATED OR PROVIDED HEREON, SHALL BE CONSTRUCTED IN ACCORDANCE WITH THE "CITY OF ALBUQUERQUE STANDARD SPECIFICATIONS FOR PUBLIC WORKS CONSTRUCTION", UPDATE NO. 7, 2003
- TWO WORKING DAYS PRIOR TO ANY EXCAVATION, THE CONTRACTOR MUST CONTACT LINE LOCATING SERVICE, 765-1234, FOR LOCATION OF EXISTING UTILITIES.
- PRIOR TO CONSTRUCTION, THE CONTRACTOR SHALL EXCAVATE AND VERIFY THE HORIZONTAL AND VERTICAL LOCATIONS OF ALL CONSTRUCTION. SHOULD A CONFLICT EXIST, THE CONTRACTOR SHALL NOTIFY THE ENGINEER SO THAT THE CONFLICT CAN BE RESOLVED WITH A MINIMUM AMOUNT OF DELAY.
- BACKFILL COMPACTION SHALL BE ACCORDING TO TRAFFIC/STREET USE.
- MAINTENANCE OF THE FACILITY SHALL BE THE RESPONSIBILITY OF THE OWNER OF THE PROPERTY BEING SERVED.
- WORK ON ARTERIAL STREETS SHALL BE PERFORMED ON A 24-HOUR BASIS.
- ALL FACILITIES CONSTRUCTED WITHIN CITY RIGHT-OF-WAY MUST BE INSPECTED AND ACCEPTED PRIOR TO CERTIFICATE OF OCCUPANCY APPROVAL.

HYDROLOGY CERTIFICATION FOR CERTIFICATE OF OCCUPANCY

I, the undersigned, being a Professional Engineer in the State of New Mexico, do hereby certify that this project site will drain in substantial compliance with the design intent of the approved plan dated 8-31-2005. The record information edited onto the original design document has been obtained by me or under my direct supervision and is true and correct to the best of my knowledge and belief. This Certification is submitted to support issuance of a permanent Certificate of Occupancy.

The record information presented hereon is not necessarily complete and is intended only to verify substantial compliance of the grading and drainage aspects of this project. Those relying on this record document are advised to obtain independent verification of its accuracy before relying on it for any other purpose.

Dennis A. Lorenz, N.M.E.
1/3/06
Date

GRADING & DRAINAGE PLAN

SCALE: 1"=20'-0"

ADDED SD FOR ROOF DRAINAGE DAL 8-31-2005

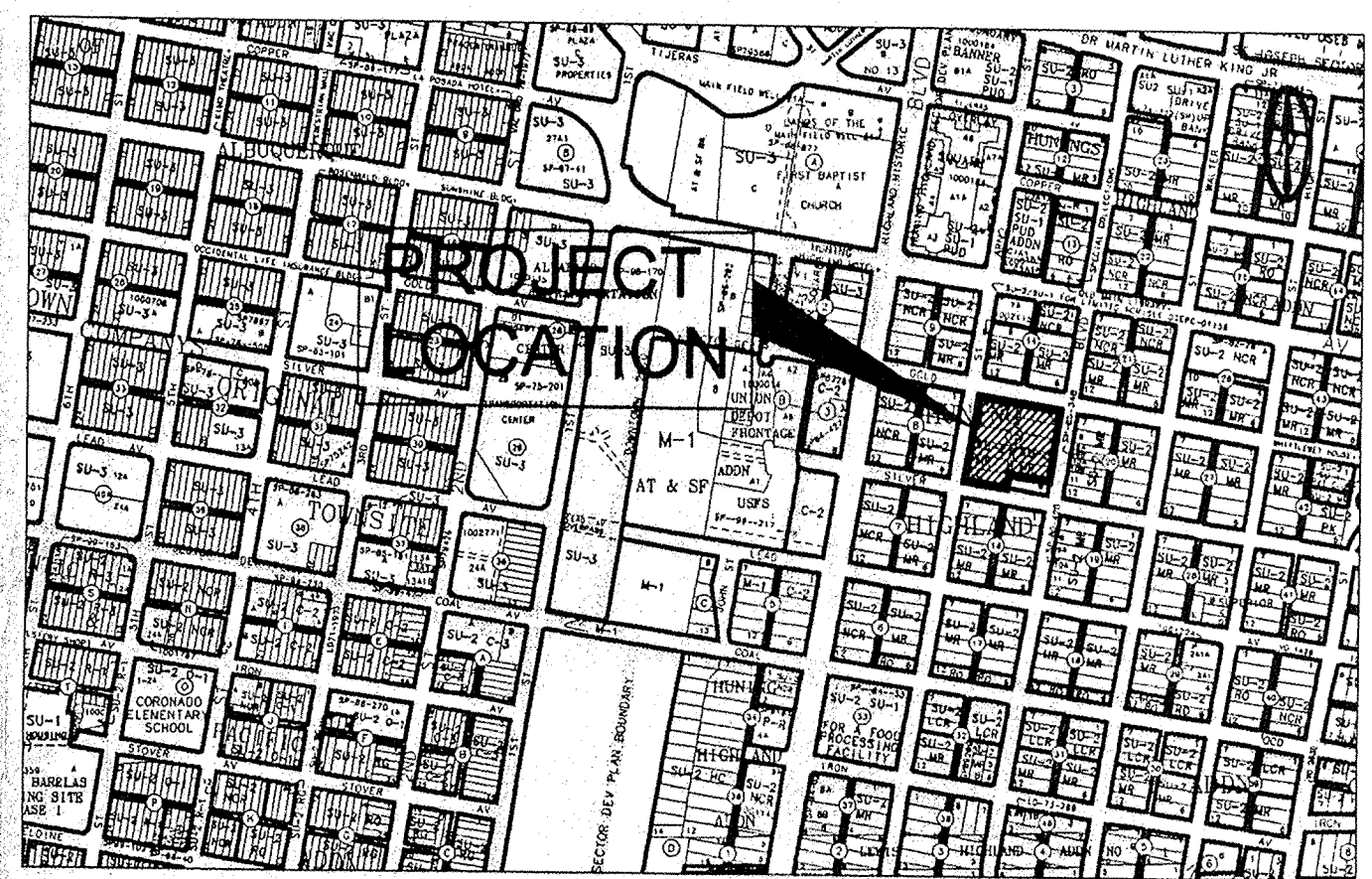

LOCATION MAP K-14

NTS

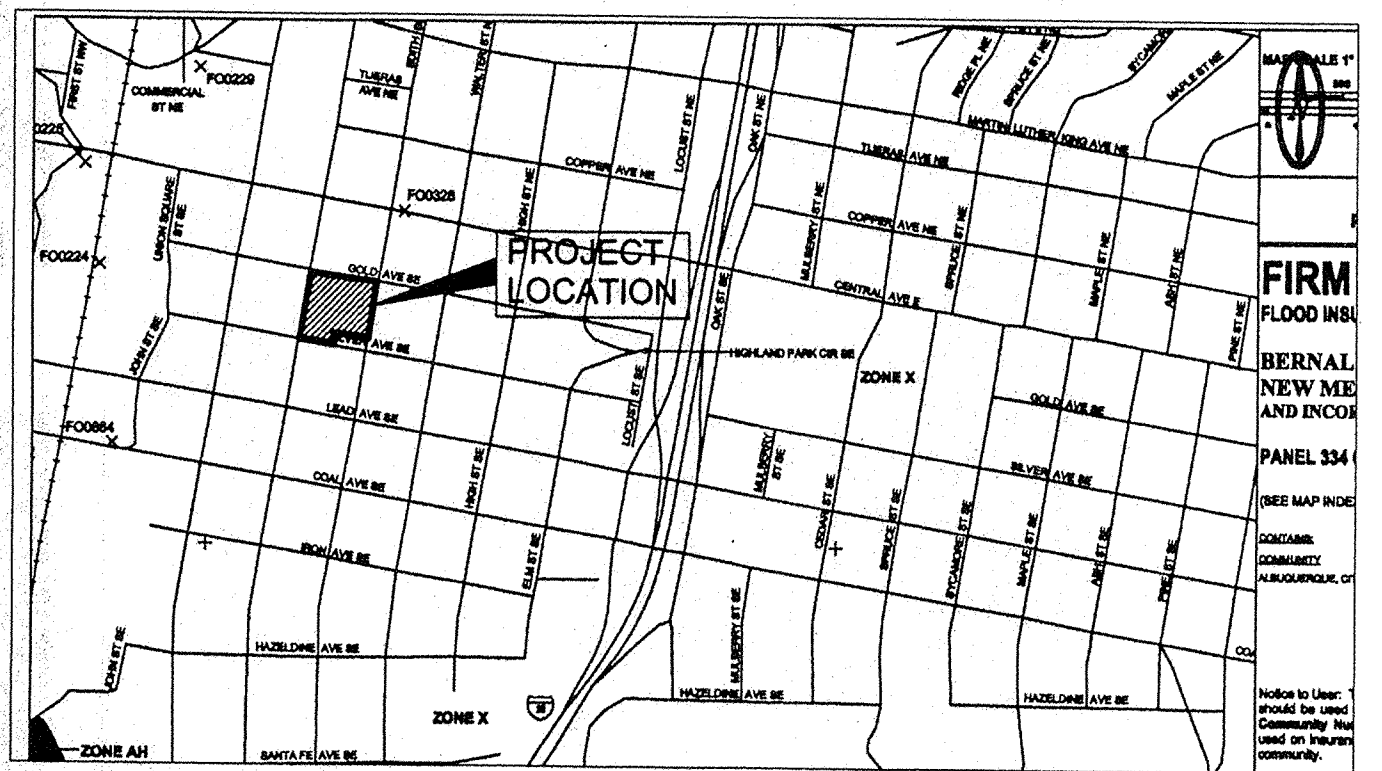

FIRM PANEL 35001C0334E

NTS

DRAINAGE PLAN NOTES

- BLI recommends that the Owner obtain a Geotechnical Evaluation of the on-site soils prior to foundation/structural design.
- This Plan recommends positive drainage away from all structures to prohibit ponding of runoff which may cause structural settlement. Future alteration of grades adjacent to the proposed structures is not recommended.
- Irrigation within 10 feet of any proposed structure is not recommended. Introduction of irrigation water into subsurface soils adjacent to the structure could cause settlement.
- This Plan is prepared to establish on-site drainage and grading criteria only. BLI assumes no responsibility for subsurface analysis, foundation/structural design, or utility design.
- Local codes may require all footings to be placed in natural undisturbed soil. If the Contractor plans to place footings on engineered fill, a certification by a registered Professional Engineer will be required. If the contractor wishes BLI to prepare the Certification, we must be notified PRIOR to placement of the fill.
- BLI recommends that the Owner obtain the services of a Geotechnical Engineer to test and inspect all earthwork aspects of the project.
- The property boundary shown on this Plan is given for information only to describe the project limits. Property boundary information shown hereon does not constitute a boundary survey. A boundary survey performed by a licensed New Mexico Registered Professional Surveyor is recommended prior to construction.

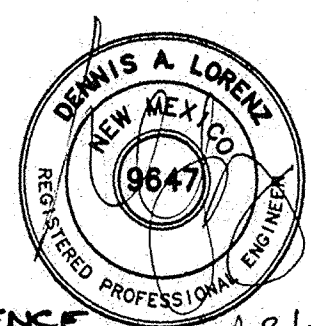

BRASHER & LORENZ
CONSULTING ENGINEERS
2201 San Pedro NE Building 1 Suite 1200
Albuquerque, New Mexico 87110
Ph: 505-988-9088 Fax: 505-988-6188

THE DESIGN GROUP
ARCHITECT • PLANNER • INTERIOR DESIGN
202 CENTRAL AVENUE SE SUITE 200
ALBUQUERQUE, NEW MEXICO 87102
PHONE: 505-242-6860 FAX: 505-242-6881

PROJECT NAME:
IMMANUEL LUTHERAN CHURCH
AND SCHOOL ADDITION
ALBUQUERQUE, NEW MEXICO

REVISIONS

NO.	DATE	DESCRIPTION

SHEET TITLE:
GRADING & DRAINAGE PLAN

DESIGNED: SCALE:
CHECKED: JOB NO: 03555
DATE: 05-25-2004 COMP. FILE:

C0.1

JAN 13 2006

HYDROLOGY SECTION

03555