

CITY OF ALBUQUERQUE

Planning Department
Alan Varela, Interim Director



Mayor Timothy M. Keller

October 15, 2021

Glenn Broughton
Bohannon Huston, Inc.
7500 Jefferson St. NE
Albuquerque, NM 87109

**RE: Presbyterian Parking Garage
1300 Central Ave. SE
Temporary CO – Accepted
Grading Certification Stamp Date: 10/11/21
Grading and Drainage Plan Stamp Date: 1/28/20
Hydrology File: K15D005G**

Dear Mr. Broughton:

PO Box 1293

Based on the submittal received on 10/12/21 and site visit on 10/15/21, this certification is approved in support of Temporary Release of Occupancy by Hydrology.

Albuquerque

If you have any questions, please contact me at 924-3986 or earmijo@cabq.gov.

NM 87103

Sincerely,

www.cabq.gov

Ernest Armijo, P.E.
Principal Engineer, Planning Dept.
Development Review Services



City of Albuquerque

Planning Department

Development & Building Services Division

DRAINAGE AND TRANSPORTATION INFORMATION SHEET (REV 6/2018)

Project Title: _____ Building Permit #: _____ Hydrology File #: _____

DRB#: _____ EPC#: _____ Work Order#: _____

Legal Description: _____

City Address: _____

Applicant: _____ Contact: _____

Address: _____

Phone#: _____ Fax#: _____ E-mail: _____

Other Contact: _____ Contact: _____

Address: _____

Phone#: _____ Fax#: _____ E-mail: _____

TYPE OF DEVELOPMENT: PLAT RESIDENCE DRB SITE ADMIN SITE

Check all that Apply:

DEPARTMENT:

- HYDROLOGY/ DRAINAGE
- TRAFFIC/ TRANSPORTATION

TYPE OF APPROVAL/ACCEPTANCE SOUGHT:

- BUILDING PERMIT APPROVAL
- CERTIFICATE OF OCCUPANCY
- PRELIMINARY PLAT APPROVAL
- SITE PLAN FOR SUB'D APPROVAL
- SITE PLAN FOR BLDG. PERMIT APPROVAL
- FINAL PLAT APPROVAL
- SIA/ RELEASE OF FINANCIAL GUARANTEE
- FOUNDATION PERMIT APPROVAL
- GRADING PERMIT APPROVAL
- SO-19 APPROVAL
- PAVING PERMIT APPROVAL
- GRADING/ PAD CERTIFICATION
- WORK ORDER APPROVAL
- CLOMR/LOMR
- FLOODPLAIN DEVELOPMENT PERMIT
- OTHER (SPECIFY) _____

TYPE OF SUBMITTAL:

- ENGINEER/ARCHITECT CERTIFICATION
- PAD CERTIFICATION
- CONCEPTUAL G & D PLAN
- GRADING PLAN
- DRAINAGE REPORT
- DRAINAGE MASTER PLAN
- FLOODPLAIN DEVELOPMENT PERMIT APPLIC
- ELEVATION CERTIFICATE
- CLOMR/LOMR
- TRAFFIC CIRCULATION LAYOUT (TCL)
- TRAFFIC IMPACT STUDY (TIS)
- STREET LIGHT LAYOUT
- OTHER (SPECIFY) _____
- PRE-DESIGN MEETING?

IS THIS A RESUBMITTAL?: Yes No

DATE SUBMITTED: _____ By: _____

COA STAFF: _____

ELECTRONIC SUBMITTAL RECEIVED: _____

FEE PAID: _____

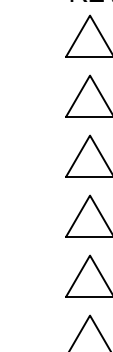

DRAWN BY	BO
REVIEWED BY	GSB
DATE	01/17/2020
PROJECT NO.	19-0006.001
DRAWING NAME	

GENERAL NOTES

1. ALL WORK DETAILED ON THESE PLANS AND PERFORMED UNDER THIS CONTRACT SHALL BE CONSTRUCTED IN ACCORDANCE WITH THE PROJECT SPECIFICATIONS AND THE PROJECT GEOTECHNICAL REPORT. WHERE APPLICABLE, CITY OF ALBUQUERQUE PUBLIC WORKS STANDARDS SHALL APPLY.
2. THE CONTRACTOR SHALL ABIDE BY ALL LOCAL, STATE, AND FEDERAL LAWS, RULES AND REGULATIONS WHICH APPLY TO THE CONSTRUCTION OF THESE IMPROVEMENTS, INCLUDING EPA REQUIREMENTS WITH RESPECT TO STORM WATER DISCHARGE.
3. PRIOR TO CONSTRUCTION, THE CONTRACTOR SHALL FIELD VERIFY THE HORIZONTAL AND VERTICAL LOCATIONS OF ALL POTENTIAL OBSTRUCTIONS INCLUDING ALL UNDERGROUND UTILITIES. SHOULD A CONFLICT EXIST, THE CONTRACTOR SHALL NOTIFY THE CONSTRUCTION OBSERVER OR ENGINEER SO THAT THE CONFLICT CAN BE RESOLVED WITH A MINIMUM AMOUNT OF DELAY.
4. TWO (2) WORKING DAYS PRIOR TO ANY EXCAVATION, THE CONTRACTOR SHALL CONTACT LINE LOCATING SERVICE FOR LOCATION OF EXISTING UTILITIES.
5. ALL ELECTRICAL, TELEPHONE, CABLE TV, GAS AND OTHER UTILITY LINES, CABLES AND APPURTENANCES ENCOUNTERED DURING CONSTRUCTION THAT REQUIRE RELOCATION, SHALL BE COORDINATED WITH THAT UTILITY. THE CONTRACTOR SHALL BE RESPONSIBLE FOR COORDINATION OF ALL NECESSARY UTILITY ADJUSTMENTS. NO ADDITIONAL COMPENSATION WILL BE ALLOWED FOR DELAYS OR INCONVENIENCES CAUSED BY UTILITY COMPANY WORK CREWS. THE CONTRACTOR MAY BE REQUIRED TO RESCHEDULE HIS ACTIVITIES TO ALLOW UTILITY CREWS TO PERFORM THEIR REQUIRED WORK.
6. THE CONTRACTOR IS RESPONSIBLE FOR PROTECTING ALL EXISTING UTILITY LINES WITHIN THE CONSTRUCTION AREA. ANY DAMAGE TO EXISTING FACILITIES CAUSED BY CONSTRUCTION ACTIVITY SHALL BE REPAIRED OR REPLACED AT THE CONTRACTOR'S EXPENSE AND APPROVED BY THE CONSTRUCTION OBSERVER.
7. CONSTRUCTION ACTIVITY SHALL BE LIMITED TO THE PROPERTY AND/OR PROJECT LIMITS. ANY DAMAGE TO ADJACENT PROPERTIES RESULTING FROM THE CONSTRUCTION PROCESS SHALL BE REPAIRED OR REPLACED AT THE CONTRACTOR'S EXPENSE.
8. OVERNIGHT PARKING OF CONSTRUCTION EQUIPMENT SHALL NOT OBSTRUCT DRIVEWAYS OR DESIGNATED TRAFFIC LANES. THE CONTRACTOR SHALL NOT STORE ANY EQUIPMENT OR MATERIAL WITHIN THE PUBLIC RIGHT-OF-WAY.
9. THE CONTRACTOR SHALL OBTAIN ALL THE NECESSARY PERMITS FOR THE PROJECT PRIOR TO COMMENCING CONSTRUCTION (I.E. BARRICADING, TOPSOIL DISTURBANCE, EXCAVATION PERMITS, EPA STORM WATER PERMITS, ETC.).
10. ALL PROPERTY CORNERS DESTROYED DURING CONSTRUCTION SHALL BE REPLACED AT THE CONTRACTOR'S EXPENSE. ALL PROPERTY CORNERS MUST BE RESET BY A REGISTERED LAND SURVEYOR.
11. THE CONTRACTOR SHALL PREPARE A CONSTRUCTION TRAFFIC CONTROL AND SIGNING PLAN AND OBTAIN APPROVAL OF SUCH PLAN FROM THE CITY OF ALBUQUERQUE, TRAFFIC ENGINEERING DEPARTMENT, PRIOR TO BEGINNING ANY CONSTRUCTION WORK ON OR ADJACENT TO EXISTING STREETS.
12. ALL BARRICADES AND CONSTRUCTION SIGNING SHALL CONFORM TO APPLICABLE SECTIONS OF THE "MANUAL ON UNIFORM TRAFFIC CONTROL DEVICES" (MUTCD), US DEPARTMENT OF TRANSPORTATION, LATEST EDITION.
13. THE CONTRACTOR SHALL MAINTAIN ALL CONSTRUCTION BARRICADES AND SIGNING AT ALL TIMES.
14. THE CONTRACTOR SHALL TAKE ALL STEPS NECESSARY TO CONFORM WITH EPA REQUIREMENTS, INCLUDING COMPLIANCE WITH NPDES PHASE 2 REQUIREMENTS.

GRADING NOTES

1. EXCEPT AS PROVIDED HEREIN, GRADING SHALL BE PERFORMED AT THE ELEVATIONS AND IN ACCORDANCE WITH THE DETAILS SHOWN ON THIS PLAN.
2. THE COST FOR REQUIRED CONSTRUCTION DUST AND EROSION CONTROL MEASURES SHALL BE INCIDENTAL TO THE PROJECT COST.
3. ALL WORK RELATIVE TO FOUNDATION CONSTRUCTION, SITE PREPARATION, AND PAVEMENT INSTALLATION, AS SHOWN ON THIS PLAN, SHALL BE CONSTRUCTED IN ACCORDANCE WITH THE "GEOTECHNICAL INVESTIGATION". ALL OTHER WORK SHALL, UNLESS OTHERWISE STATED OR PROVIDED FOR HEREON, BE CONSTRUCTED IN ACCORDANCE WITH THE PROJECT, (FIRST PRIORITY) SPECIFICATIONS, AND/OR THE CITY OF ALBUQUERQUE (COA) STANDARD SPECIFICATIONS FOR PUBLIC WORKS (SECOND PRIORITY).
4. EARTH SLOPES SHALL NOT EXCEED 3 HORIZONTAL TO 1 VERTICAL UNLESS SHOWN OTHERWISE.
5. IT IS THE INTENT OF THESE PLANS THAT THIS CONTRACTOR SHALL NOT PERFORM ANY WORK OUTSIDE OF THE PROPERTY BOUNDARIES EXCEPT AS REQUIRED BY THIS PLAN.
6. THE CONTRACTOR IS TO ENSURE THAT NO SOIL ERODES FROM THE SITE ONTO ADJACENT PROPERTY OR PUBLIC RIGHT-OF-WAY.
7. A DISPOSAL SITE FOR ANY & ALL EXCESS EXCAVATION MATERIAL, AND UNSUITABLE MATERIAL AND/OR A BORROW SITE CONTAINING ACCEPTABLE FILL MATERIAL SHALL BE OBTAINED BY THE CONTRACTOR IN COMPLIANCE WITH APPLICABLE ENVIRONMENTAL REGULATIONS AND APPROVED BY THE OBSERVER. ALL COSTS INCURRED IN OBTAINING A DISPOSAL OR BORROW SITE AND HAUL TO OR FROM SHALL BE CONSIDERED INCIDENTAL TO THE PROJECT AND NO SEPARATE MEASUREMENT OR PAYMENT SHALL BE MADE.
8. PAVING AND ROADWAY GRADES SHALL BE +/- 0.1' FROM PLAN ELEVATIONS. PAD ELEVATION SHALL BE +/- 0.05' FROM BUILDING PLAN ELEVATION.
9. VERIFY ALL ELEVATIONS SHOWN ON PLAN FROM BASIS OF ELEVATION CONTROL STATION PRIOR TO BEGINNING CONSTRUCTION.

PROJECT BENCH MARK

ALBUQUERQUE GEODETIC REFERENCE STATION 9, K158R RESET 1982
GEOGRAPHIC POSITION (NAD 1983)
NM STATE PLANE COORDINATES
(CENTRAL ZONE, US SURVEY FOOT)
N= 1485713.773 USR, E= 1523788.861 USR
GROUND-TO-GRID FACTOR = 0.999679809
DELTA ALPHA = +00°13'26.78"
NAVD 1988 ELEVATION= 5010.823 USR

DRAINAGE CERTIFICATION

I, GLENN S. BROUGHTON, NMPE 14171, OF THE FIRM BOHANNAN HUSTON INC., HEREBY CERTIFY THAT THIS PROJECT HAS BEEN GRADED AND WILL DRAIN IN SUBSTANTIAL COMPLIANCE TO AND IN ACCORDANCE WITH THE DESIGN INTENT OF THE APPROVED PLAN DATED 01/28/2020. THE RECORD INFORMATION EDITED ONTO THE ORIGINAL DESIGN DOCUMENT HAS BEEN OBTAINED BY BRIAN J. MARTINEZ, NMPS 18374, OF THE FIRM CARTESIAN SURVEY'S INC. I FURTHER CERTIFY THAT I HAVE PERSONALLY VISITED THE PROJECT SITE ON 10/11/2021 AND HAVE DETERMINED BY VISUAL INSPECTION THAT THE SURVEY DATA PROVIDED IS REPRESENTATIVE OF ACTUAL SITE CONDITIONS AND IS TRUE AND CORRECT TO THE BEST OF MY KNOWLEDGE AND BELIEF. THIS CERTIFICATION IS SUBMITTED IN SUPPORT OF A REQUEST FOR A TEMPORARY CERTIFICATE OF OCCUPANCY.

THE FOLLOWING ITEMS MUST BE COMPLETED PRIOR TO PERMANENT CERTIFICATE OF OCCUPANCY:

1. COMPLETE IMPROVEMENTS AT SOUTHEAST CORNER OF SPRUCE AND SILVER.
2. COMPLETE SIDEWALK CULVERT DIAMOND PLATE INSTALLATION.
3. REPLACE OR REPAIR DIAMOND PLATE ON EXISTING SIDEWALK CULVERT AT NORTHEAST CORNER OF SITE.
4. COMPLETE LANDSCAPE GROUND COVER.

THE RECORD INFORMATION PRESENTED HEREON IS NOT NECESSARILY COMPLETE AND INTENDED ONLY TO VERIFY SUBSTANTIAL COMPLIANCE OF THE GRADING AND DRAINAGE ASPECTS OF THIS PROJECT. THOSE RELYING ON THIS RECORD DOCUMENT ARE ADVISED TO OBTAIN INDEPENDENT VERIFICATION OF ITS ACCURACY BEFORE USING IT FOR ANY OTHER PURPOSE.

GLENN S. BROUGHTON, NMPE 14171
10/11/2021

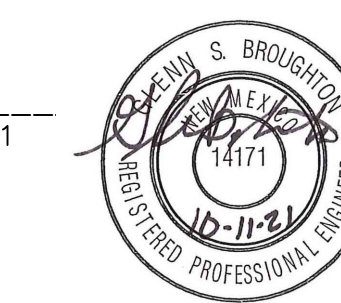

LEGEND

- FL70.22 DESIGN GRADE
- FL70.25 AS-BUILT GRADE

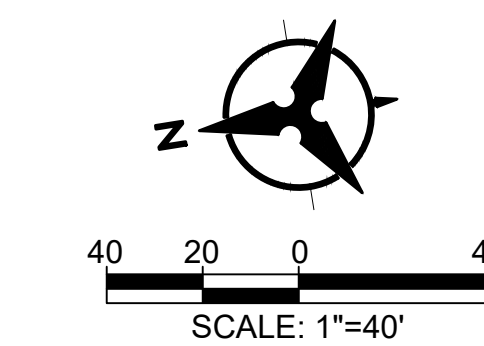
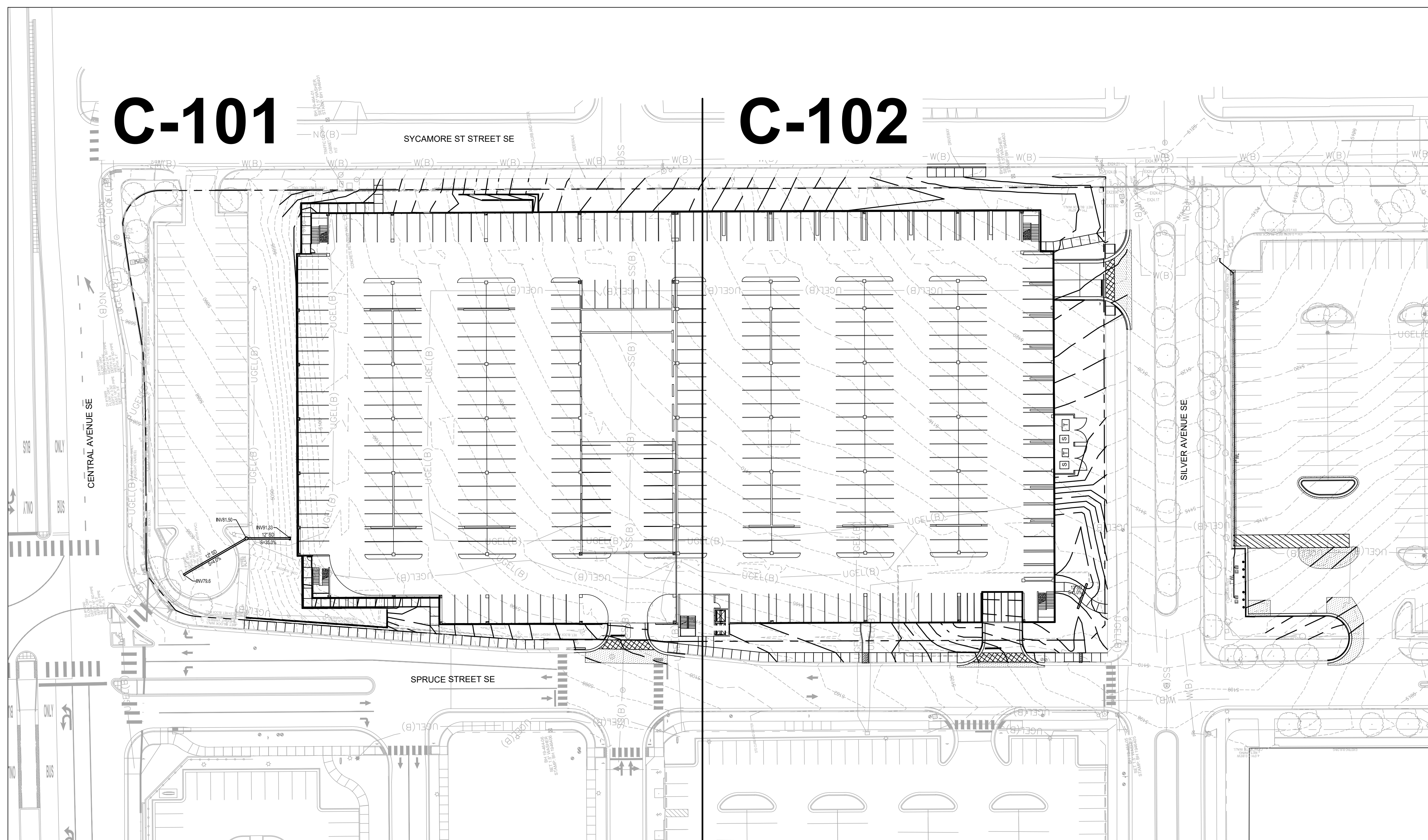

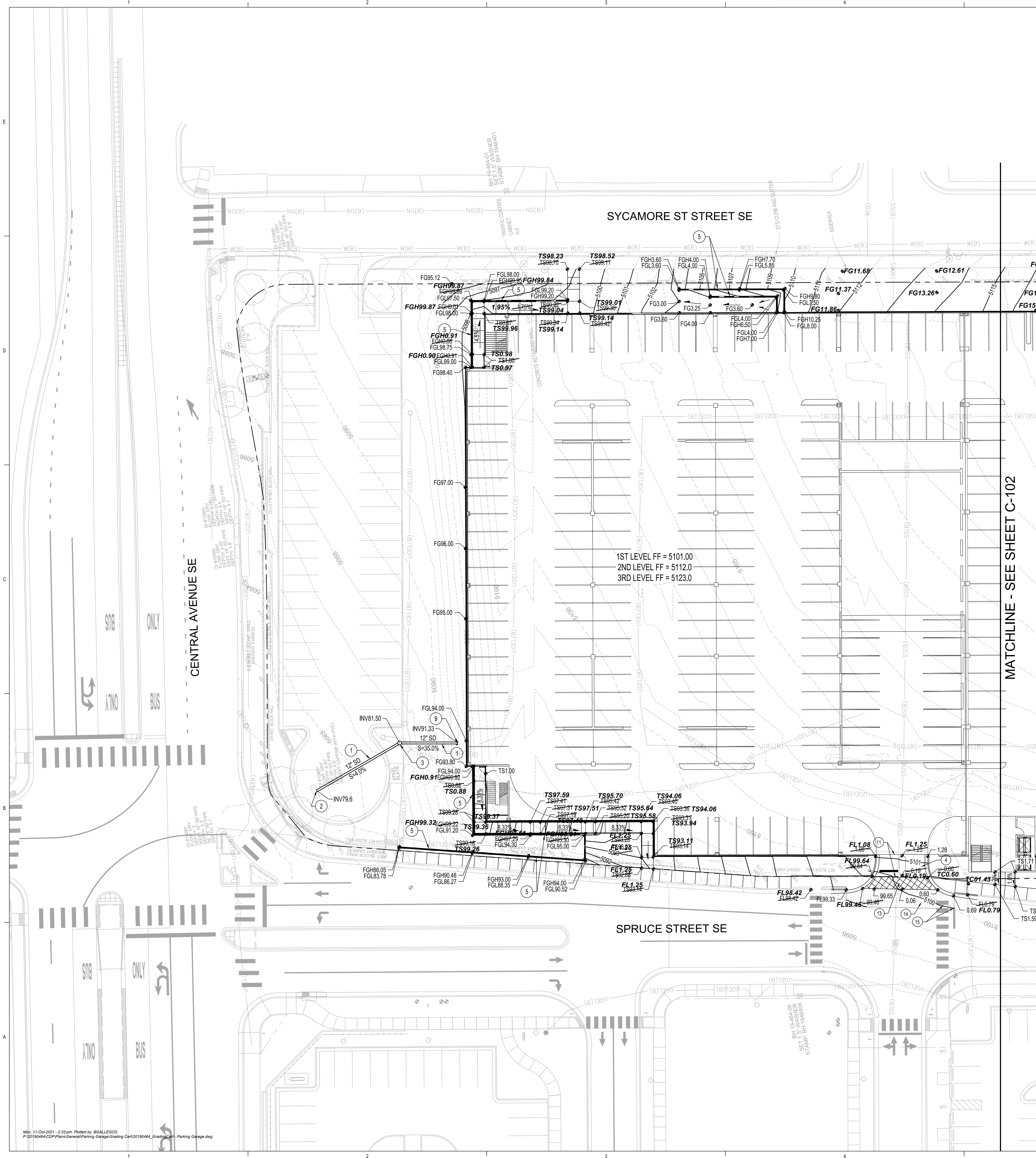
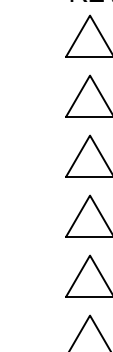

KEYED NOTES

- INSTALL STORM DRAIN PIPE. SEE PLAN FOR SIZE & SLOPE.
- CORE DRILL AND CONNECT TO EXISTING PRIVATE STORM DRAIN INLET. GROUT ANNULAR SPACE.
- INSTALL 24" NYLOPLAST DRAIN BASIN WITH SOLID COVER.
- INSTALL CONCRETE PAVEMENT SECTION PER 2/C-102.
- PROPOSED RETAINING WALL. SEE ARCHITECTURAL / STRUCTURAL PLANS FOR DETAILS.
- CONSTRUCT CONCRETE RIBBON CHANNEL. SEE DETAIL THIS SHEET.
- CONSTRUCT 12" WIDE SIDEWALK CULVERT PER COA STD DWG 2236.
- CONSTRUCT 2 - 18" WIDE SIDEWALK CULVERTS PER COA STD DWG 2236.
- EXTEND STORM DRAIN TO WITHIN 5' OF BUILDING. SEE PLUMBING PLANS FOR CONTINUATION.
- INSTALL CONCRETE CONTROL JOINTS.
- CONSTRUCT THICKENED EDGE ADJACENT TO PARKING STRUCTURE AND CONCRETE CROSSWALK STREET PER 1/C-101.
- INSTALL ASPHALT PAVEMENT PER 1/C-103.
- MAINTAIN 2% MAXIMUM CROSS SLOPE AT ACCESSIBLE CROSSWALK.
- ASPHALT PAVEMENT REPLACEMENT PER COA STD DWG 2465.
- REPLACE EXISTING STRIPING AS NEEDED.

NOTE: NOT ALL KEYED NOTES MAY APPLY TO THIS SHEET.

GRADING LEGEND

- DIRECTION OF FLOW
- 23.00 PROPOSED SPOT ELEVATION
- 5095 PROPOSED INDEX CONTOUR
- 5094 PROPOSED INTERMEDIATE CONTOUR

1ST LEVEL FF = 5101.00
2ND LEVEL FF = 5112.0
3RD LEVEL FF = 5123.0

DRAINAGE CERTIFICATION

I, GLENN S. BROUGHTON, NMPE 14171, OF THE FIRM BOHANNAN HUSTON INC. HEREBY CERTIFY THAT THIS PROJECT HAS BEEN GRADED AND WILL DRAIN IN SUBSTANTIAL COMPLIANCE TO AND IN ACCORDANCE WITH THE DESIGN INTENT OF THE APPROVED PLAN DATED 01/28/2020. THE RECORD INFORMATION EDITED ONTO THE ORIGINAL DESIGN DOCUMENT HAS BEEN OBTAINED BY BRIAN J. MARTINEZ, NMPRS 18374, OF THE FIRM CARTESIAN SURVEY'S INC. I FURTHER CERTIFY THAT I HAVE PERSONALLY VISITED THE PROJECT SITE ON 10/11/2021 AND HAVE DETERMINED BY VISUAL INSPECTION THAT THE SURVEY DATA PROVIDED IS REPRESENTATIVE OF ACTUAL SITE CONDITIONS AND IS TRUE AND CORRECT TO THE BEST OF MY KNOWLEDGE AND BELIEF. THIS CERTIFICATION IS SUBMITTED IN SUPPORT OF A REQUEST FOR A TEMPORARY CERTIFICATE OF OCCUPANCY.

THE FOLLOWING ITEMS MUST BE COMPLETED PRIOR TO PERMANENT CERTIFICATE OF OCCUPANCY:

- COMPLETE IMPROVEMENTS AT SOUTHEAST CORNER OF SPRUCE AND SILVER.
- COMPLETE SIDEWALK CULVERT DIAMOND PLATE INSTALLATION.
- REPLACE OR REPAIR DIAMOND PLATE ON EXISTING SIDEWALK CULVERT AT NORTHWEST CORNER OF SITE.
- COMPLETE LANDSCAPE GROUND COVER.

THE RECORD INFORMATION PRESENTED HEREON IS NOT NECESSARILY COMPLETE AND INTENDED ONLY TO VERIFY SUBSTANTIAL COMPLIANCE OF THE GRADING AND DRAINAGE ASPECTS OF THIS PROJECT. THOSE RELYING ON THIS RECORD DOCUMENT ARE ADVISED TO OBTAIN INDEPENDENT VERIFICATION OF ITS ACCURACY BEFORE USING IT FOR ANY OTHER PURPOSE.

GLENN S. BROUGHTON, NMPE 14171
10/11/2021

LEGEND

- FL0.22 DESIGN GRADE
- FL0.25 AS-BUILT GRADE

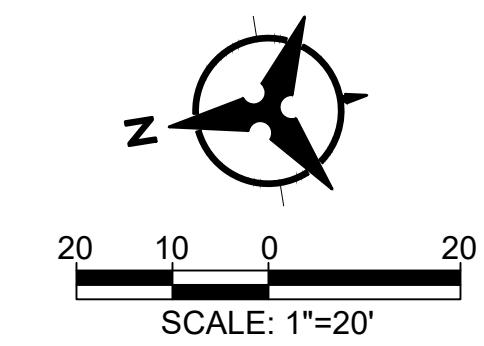

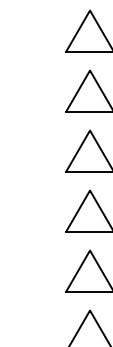

KEYED NOTES

- INSTALL STORM DRAIN PIPE. SEE PLAN FOR SIZE & SLOPE.
- CORE DRILL AND CONNECT TO EXISTING PRIVATE STORM DRAIN INLET. GROUT ANNULAR SPACE.
- INSTALL 24" NYLOPLAST DRAIN BASIN WITH SOLID COVER.
- INSTALL CONCRETE PAVEMENT SECTION PER 2/C-102.
- PROPOSED RETAINING WALL. SEE ARCHITECTURAL / STRUCTURAL PLANS FOR DETAILS.
- CONSTRUCT CONCRETE RIBBON CHANNEL. SEE DETAIL THIS SHEET.
- CONSTRUCT 12" WIDE SIDEWALK CULVERT PER COA STD DWG 2236.
- CONSTRUCT 2 - 18" WIDE SIDEWALK CULVERTS PER COA STD DWG 2236.
- EXTEND STORM DRAIN TO WITHIN 5' OF BUILDING. SEE PLUMBING PLANS FOR CONTINUATION.
- INSTALL CONCRETE CONTROL JOINTS.
- CONSTRUCT THICKENED EDGE ADJACENT TO PARKING STRUCTURE AND CONCRETE CROSSWALK STREET PER 1/C-101.
- INSTALL ASPHALT PAVEMENT PER 1/C-103.
- MAINTAIN 2% MAXIMUM CROSS SLOPE AT ACCESSIBLE CROSSWALK.
- ASPHALT PAVEMENT REPLACEMENT PER COA STD DWG 2465.
- REPLACE EXISTING STRIPING AS NEEDED.

NOTE: NOT ALL KEYED NOTES MAY APPLY TO THIS SHEET.

GRADING LEGEND

- DIRECTION OF FLOW
- 23.00 PROPOSED SPOT ELEVATION
- 5095 PROPOSED INDEX CONTOUR
- 5094 PROPOSED INTERMEDIATE CONTOUR

DRAINAGE CERTIFICATION

I, GLENN S. BROUGHTON, NMPE 14171, OF THE FIRM BOHANNAN HUSTON INC. HEREBY CERTIFY THAT THIS PROJECT HAS BEEN GRADED AND WILL DRAIN IN SUBSTANTIAL COMPLIANCE TO AND IN ACCORDANCE WITH THE DESIGN INTENT OF THE APPROVED PLAN DATED 01/28/2020. THE RECORD INFORMATION EDITED ONTO THE ORIGINAL DESIGN DOCUMENT HAS BEEN OBTAINED BY BRIAN J. MARTINEZ, NMPRS 18374, OF THE FIRM CARTESIAN SURVEY'S INC. I FURTHER CERTIFY THAT I HAVE PERSONALLY VISITED THE PROJECT SITE ON 10/11/2021 AND HAVE DETERMINED BY VISUAL INSPECTION THAT THE SURVEY DATA PROVIDED IS REPRESENTATIVE OF ACTUAL SITE CONDITIONS AND IS TRUE AND CORRECT TO THE BEST OF MY KNOWLEDGE AND BELIEF. THIS CERTIFICATION IS SUBMITTED IN SUPPORT OF A REQUEST FOR A TEMPORARY CERTIFICATE OF OCCUPANCY.

THE FOLLOWING ITEMS MUST BE COMPLETED PRIOR TO PERMANENT CERTIFICATE OF OCCUPANCY:

- COMPLETE IMPROVEMENTS AT SOUTHEAST CORNER OF SPRUCE AND SILVER.
- COMPLETE SIDEWALK CULVERT DIAMOND PLATE INSTALLATION.
- REPLACE OR REPAIR DIAMOND PLATE ON EXISTING SIDEWALK CULVERT AT NORTHWEST CORNER OF SITE.
- COMPLETE LANDSCAPE GROUND COVER.

THE RECORD INFORMATION PRESENTED HEREON IS NOT NECESSARILY COMPLETE AND INTENDED ONLY TO VERIFY SUBSTANTIAL COMPLIANCE OF THE GRADING AND DRAINAGE ASPECTS OF THIS PROJECT. THOSE RELYING ON THIS RECORD DOCUMENT ARE ADVISED TO OBTAIN INDEPENDENT VERIFICATION OF ITS ACCURACY BEFORE USING IT FOR ANY OTHER PURPOSE.

GLENN S. BROUGHTON, NMPE 14171
10/11/2021

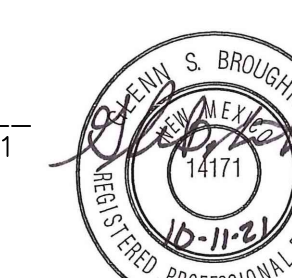

LEGEND

- FL70.22 DESIGN GRADE
- FL70.25 AS-BUILT GRADE

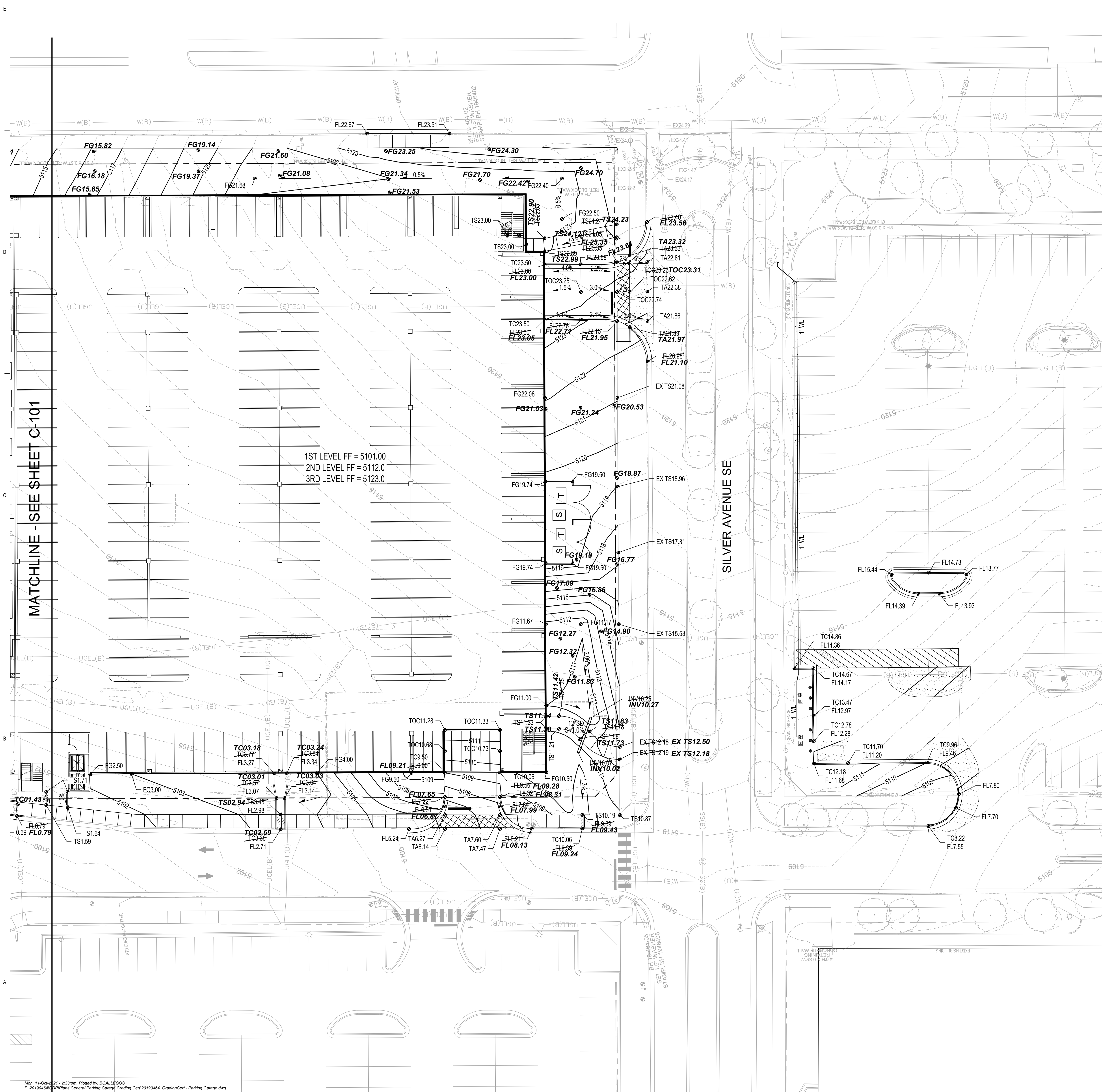
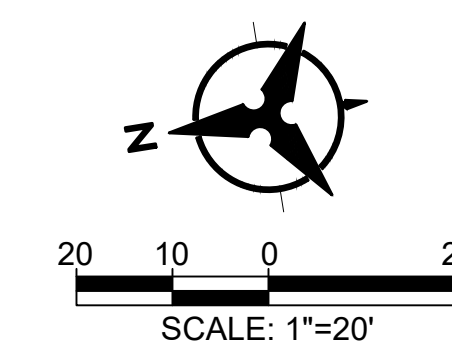

1ST LEVEL FF = 5101.00
2ND LEVEL FF = 5112.0
3RD LEVEL FF = 5123.0

MATCHLINE - SEE SHEET C-101