

Martin J. Chávez, Mayor

Robert E. Gurulé, Director

Jeff Mortensen, P.E.
Jeff Mortensen & Assoc
6010-B Midway Park NE
Albuquerque, NM 87109

**RE: TVI PLAZUELA (K15-D53A). GRADING AND DRAINAGE PLAN FOR GRADING
AND PAVING PERMIT APPROVAL. ENGINEER'S STAMP DATE JUNE 11, 1997.**

Dear Mr. Mortensen:

Based on the information provided on your June 17, 1997 submittal, the
above referenced project is approved for Grading and Paving Permit.

An Engineer's Certification will be required prior to Certificate of
Occupancy.

If I can be of further assistance, please feel free to contact me at
924-3984.

Sincerely,

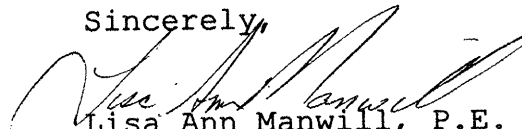

Lisa Ann Manwill, P.E.
Engineering Assoc./Hyd.

c: Andrew Garcia
File

Good for You, Albuquerque!

P.O. Box 1293, Albuquerque, New Mexico 87103



DRAINAGE INFORMATION SHEET

PROJECT TITLE: TVI Plazuela ZONE ATLAS/DRNG. FILE #: K-15/053A
DRB #: _____ EPC #: _____ WORK ORDER #: _____
LEGAL DESCRIPTION: Lands of T-VI and Lands of the Board of Education
CITY ADDRESS: 525 Buena Vista SE, Abq. 87109
ENGINEERING FIRM: Jeff Mortensen & Assoc. CONTACT: Kevin Christy
ADDRESS: 6010-B Midway Park Blvd. NE, Abq. 87109 PHONE: 345-4250
OWNER: Albuquerque T-VI CONTACT: Lyle Brown
ADDRESS: 525 Buena Vista SE, Abq. 87106 PHONE: 224-4590
ARCHITECT: Greer Stafford/SJCF CONTACT: Anson
ADDRESS: 6020 Academy NE, Suite 205, Abq. 87109 PHONE: 821-0235
SURVEYOR: Aldrich Land Surveying CONTACT: _____
ADDRESS: P.O. Box 30701, Abq. 87190 PHONE: 884-1990
CONTRACTOR: Not Selected CONTACT: _____
ADDRESS: _____ PHONE: _____

TYPE OF SUBMITTAL:

- ☐ DRAINAGE REPORT
☒ DRAINAGE PLAN
☐ CONCEPTUAL GRADING & DRAINAGE PLAN
☒ GRADING PLAN
☐ EROSION CONTROL PLAN
☐ ENGINEER'S CERTIFICATION
☐ OTHER

PRE-DESIGN MEETING:

- ☐ YES
☒ NO
☐ COPY PROVIDED

CHECK TYPE OF APPROVAL SOUGHT:

- ☐ SKETCH PLAT APPROVAL
☐ PRELIMINARY PLAT APPROVAL
☐ S. DEV. PLAN FOR SUB'D. APPROVAL
☐ S. DEV. PLAN FOR BLDG. PERMIT APPROVAL
☐ SECTOR PLAN APPROVAL
☐ FINAL PLAT APPROVAL
☐ FOUNDATION PERMIT APPROVAL
☐ BUILDING PERMIT APPROVAL
☐ CERTIFICATE OF OCCUPANCY APPROVAL
☒ GRADING PERMIT APPROVAL
☒ PAVING PERMIT APPROVAL
☐ S.A.D. DRAINAGE REPORT
☐ DRAINAGE REQUIREMENTS
☐ OTHER _____ (SPECIFY)

DATE SUBMITTED: 6-11-97BY: Kevin Christy



JEANETTE STROMBERG
HALL

GREER
SICF

ARCHITECTURE
ENGINEERING
PLANNING
INTERIOR DESIGN

6020 ACADEMY NE, SUITE 205
ALBUQUERQUE, NM 87109-3315
505.821.0235 FAX 505.821.0348

3005 NORTHRIDGE DR., SUITE C
FARMINGTON, NM 87402-2085
505.325.7475 FAX 505.325.6464

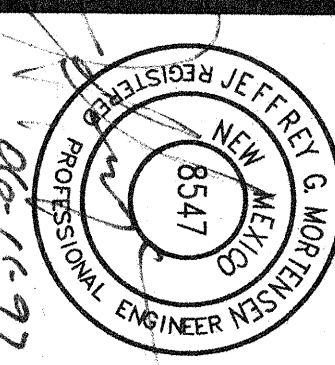

THIS DRAWING IS INCOMPLETE AND NOT TO BE USED FOR CONSTRUCTION UNLESS IT IS STAMPED, SIGNED, AND DATED ABOVE.

©1995 GREER/SOFC, INC.
ALL RIGHTS RESERVED

GRADING-PLAN

DIVISION

1

JUNE 12, 1997

PROJECT NO.

AWING SHEET

C1.1

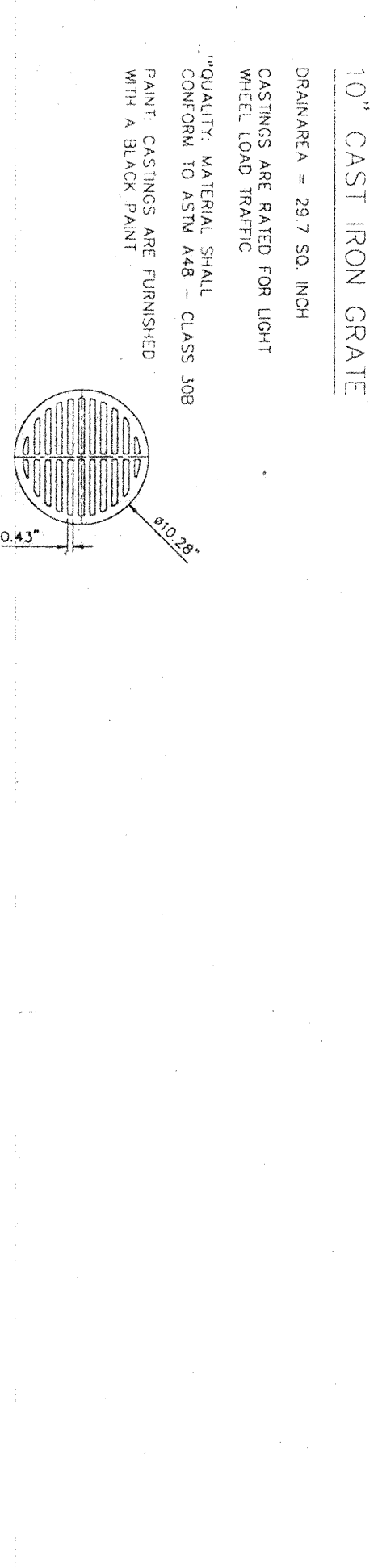
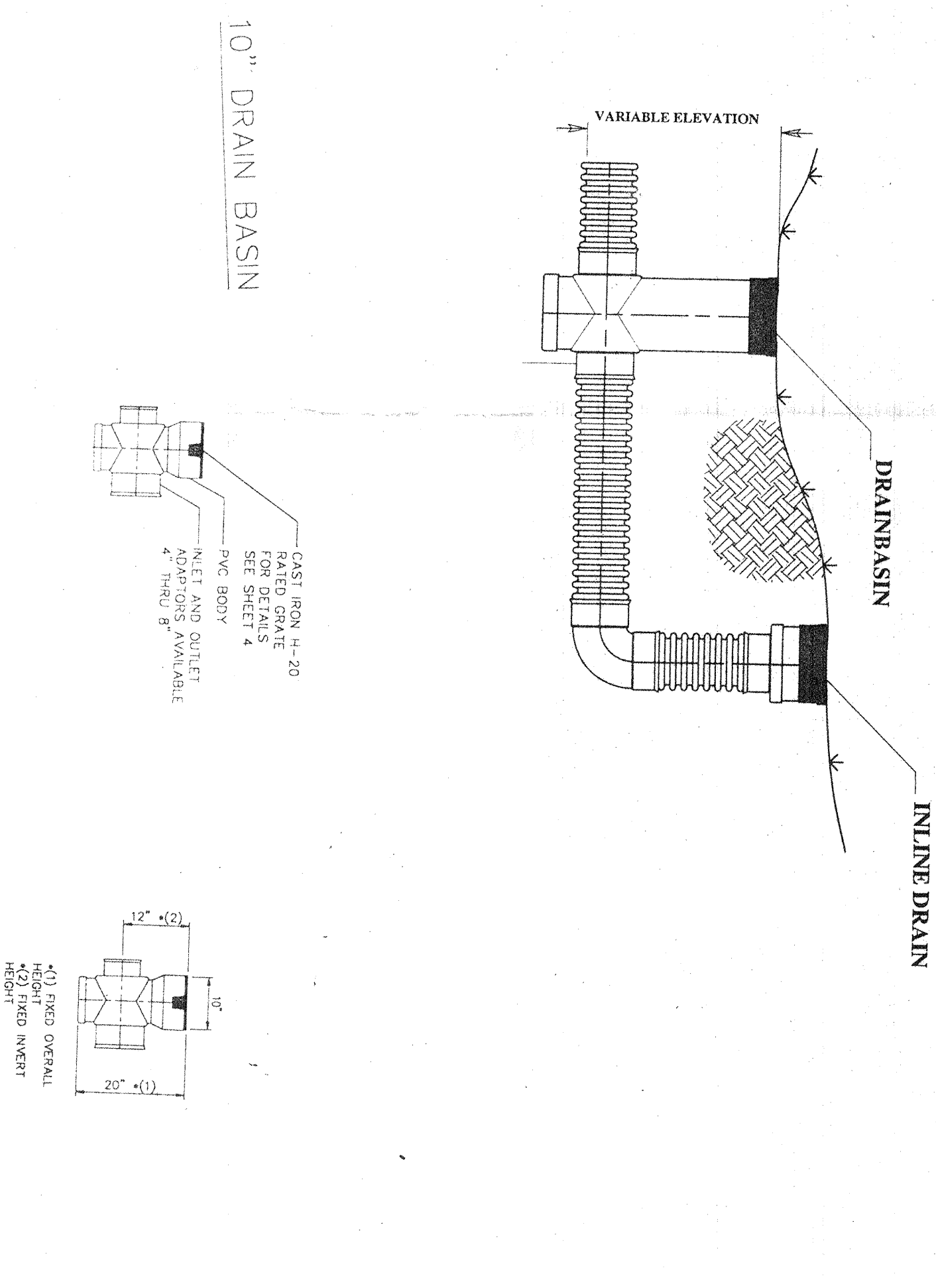
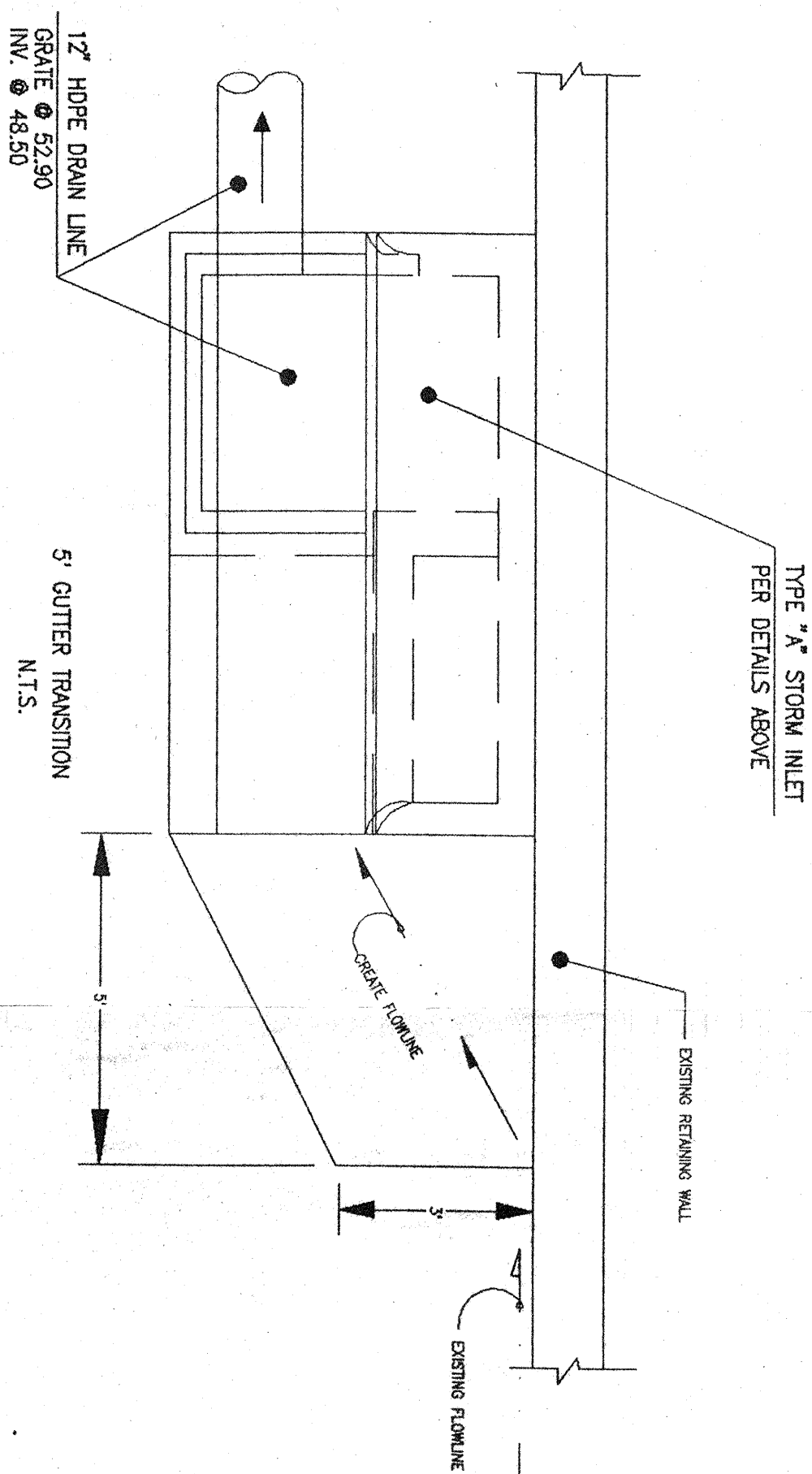
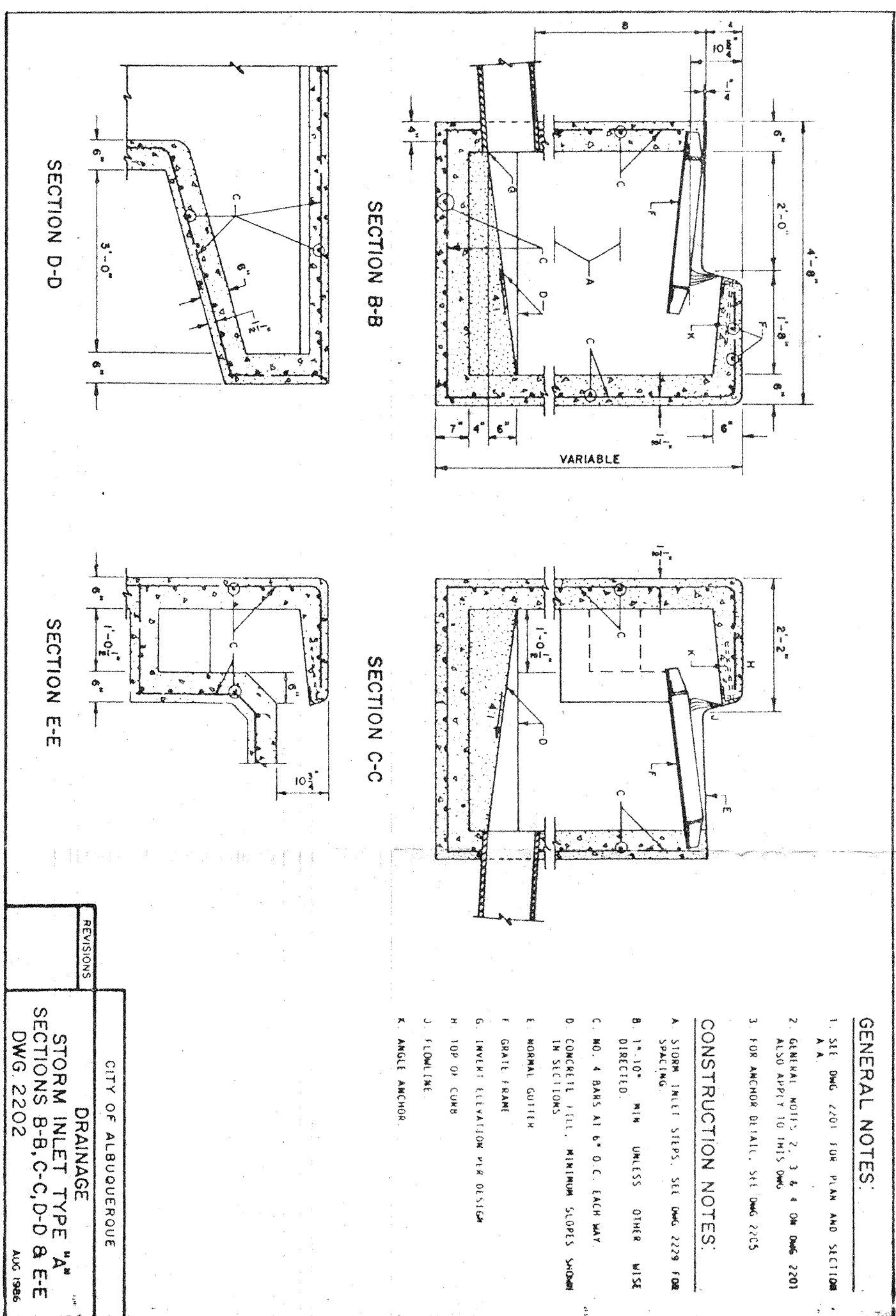
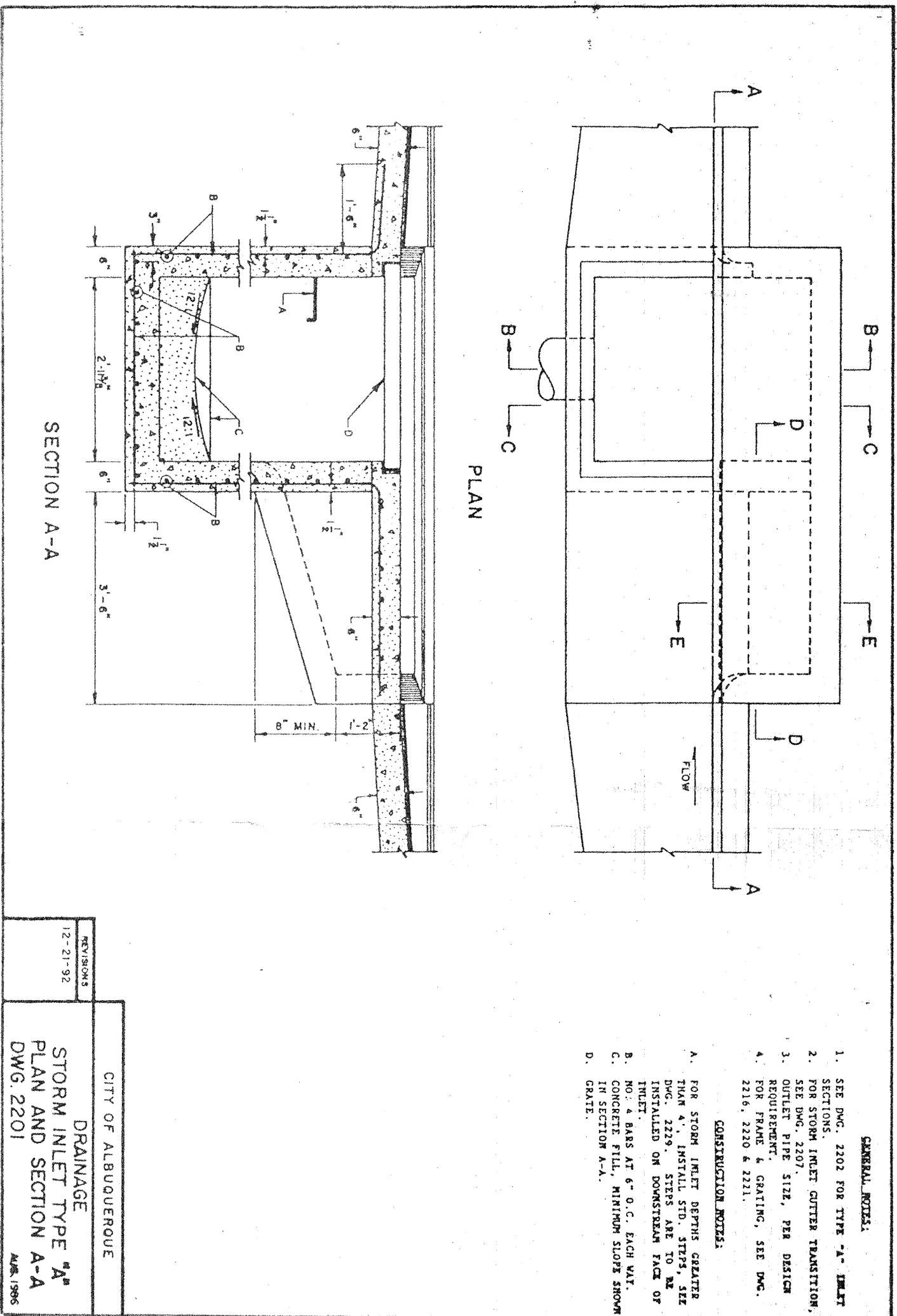

1. GENERAL NOTES: ON THESE PLANS TO BE PREPARED UNDER CONTRACT SHALL, EXCEPT AS OTHERWISE STATED OR PROVIDED HEREON, BE CONSTRUCTED IN ACCORDANCE WITH THE SPECIFICATIONS FOR PUBLIC WORKS CONSTRUCTION - 1987, PUBLISHED BY THE NEW MEXICO CHAPTER AMERICAN PUBLIC WORKS ASSOCIATION.
2. TWO (2) WORKING DAYS PRIOR TO ANY EXCAVATION, CONTRACTOR MUST CONTACT NEW MEXICO ONE CALL SYSTEM, 240-1990, FOR LOCATION OF EXISTING UTILITIES.
3. IF ANY UTILITIES, PIPELINES, OR UNDERGROUND UTILITY LINES ARE SHOWN ON THESE DRAWINGS, THEY ARE SHOWN IN AN APPROXIMATE MANNER ONLY, AND SUCH LINES MAY EXIST WHERE NONE ARE SHOWN IF ANY SUCH EXISTING LINES ARE SHOWN. THE LOCATION IS BASED UPON INFORMATION PROVIDED BY THE OWNER OF SUCH UTILITIES, PIPELINES, OR UNDERGROUND UTILITY LINES. THE CONTRACTOR SHALL BE RESPONSIBLE FOR LOCATING, IDENTIFYING, AND PRESERVING ANY SUCH EXISTING UTILITIES, PIPELINES, OR UNDERGROUND UTILITY LINES. THIS INFORMATION IS NOT CONCLUSIVE, AND MAY NOT BE COMPLETE, THEREFORE, MAKES NO REPRESENTATION NEAR THE AREA OF THE WORK IN ADVANCE CAUSED BY ITS FAILURE TO LOCATE, IDENTIFY AND PRESERVE ANY SUCH EXISTING UTILITIES, PIPELINES, OR UNDERGROUND UTILITY LINES. THE CONTRACTOR IS FULLY RESPONSIBLE FOR ANY AND ALL DAMAGE CAUSED BY ITS FAILURE TO LOCATE, IDENTIFY AND PRESERVE ANY SUCH EXISTING UTILITIES, PIPELINES, OR UNDERGROUND UTILITY LINES. THE CONTRACTOR SHALL COMPLY WITH STATE STATUTES, MUNICIPAL AND LOCAL ORDINANCES, RULES AND REGULATIONS, IF ANY, PERTAINING TO THE LOCATION OF THESE LINES AND FACILITIES.
4. SHOULD A CONFLICT EXIST BETWEEN THESE PLANS AND ACTUAL FIELD CONDITIONS, THE CONTRACTOR SHALL PROMPTLY NOTIFY THE ENGINEER IN WRITING SO THAT THE CONFLICT CAN BE RESOLVED WITH A MINIMUM AMOUNT OF DELAY FOR ALL PARTIES.
5. THE CONTRACTOR SHALL MAINTAIN ACCESS TO ADJACENT PROPERTIES DURING CONSTRUCTION.
6. ALL WORK ON THIS PROJECT SHALL BE PERFORMED IN ACCORDANCE WITH APPLICABLE FEDERAL, STATE AND LOCAL LAWS, RULES AND REGULATIONS CONCERNING SAFETY AND HEALTH.
7. THE CONTRACTOR SHALL INSURE THAT NO SOIL ERODES FROM THE SITE INTO PUBLIC RIGHT-OF-WAY OR ONTO PRIVATE PROPERTY. THIS CAN BE ACHIEVED BY CONSTRUCTING AND MAINTAINING TEMPORARY BARRIERS AT THE PROPERTY LINES AND WEETING THE SOIL TO KEEP IT FROM ERODING.
8. THE CONTRACTOR SHALL PROMPTLY CLEAN UP ANY MATERIAL EXCAVATED WITHIN THE PUBLIC RIGHT-OF-WAY SO THAT THE EXCAVATED MATERIAL IS NOT SUSCEPTIBLE TO BEING WASHED DOWN DRAINAGE DITCHES.
9. CONTRACTOR SHALL NOTIFY THE ENGINEER NOT LESS THAN SEVEN (7) DAYS PRIOR TO STARTING WORK ORDER THAT THE ENGINEER MAY TAKE NECESSARY MEASURES TO ENSURE THE PRESERVATION OF STREET DIMENSIONS. CONTRACTOR SHALL NOT DISTURB PERMANENT SURVEY MONUMENTS WITHIN THE CONSENT OF THE ENGINEER. CONTRACTOR SHALL BE RESPONSIBLE FOR THE PROTECTION AND PRESERVATION OF ALL SUCH MONUMENTS. WITHOUT PERMISSION REPLACEMENT SHALL BE AT THE CONTRACTOR'S EXPENSE. IF ANY MONUMENT IS MADE IN THE FINISHED ELEVATION OF THE PAVEMENT OF ANY ROADWAY IN WHICH A PERMANENT SURVEY MONUMENT IS LOCATED, CONTRACTOR SHALL, AT HIS OWN EXPENSE, ADJUST THE MONUMENT COVER TO THE NEW GRADE UNLESS OTHERWISE SPECIFIED.
10. ALL PAVEMENT MARKINGS AND TRAFFIC SIGNS SHALL COMPLY WITH THE MANUAL OF UNIFORM TRAFFIC CONTROL DEVICES (MUTCD) PUBLISHED BY THE U.S. DEPARTMENT OF TRANSPORTATION FEDERAL HIGHWAY ADMINISTRATION, LATEST EDITION.
11. IF THE REMOVAL OF EXISTING CURB AND GUTTER, SIDEWALK, AND/OR PAVING IS REQUIRED, THE CONTRACTOR SHALL DEMOLISH AND/OR REMOVE TO THE NEAREST LOT, WHEN ADDING NEW PAVEMENT TO EXISTING, THE EXISTING SIDEWALK, CURB AND GUTTER, AND/OR PAVEMENT SHOWN AS EXISTING AND NOT TO BE REMOVED UNDER THIS CONTRACT AND WHICH IS DAMAGED OR DISPLACED BY THE CONTRACTOR SHALL BE REMOVED AND REPLACED BY THE CONTRACTOR AT THE CONTRACTOR'S EXPENSE.
12. A DISPOSAL SITE FOR ALL EXCESS EXCAVATION MATERIAL (CONTAMINATED OR OTHERWISE), ASPHALTIC PAVING, CONCRETE PAVING, ETC., SHALL BE OBTAINED BY THE CONTRACTOR IN COMPLIANCE WITH APPLICABLE STATE AND FEDERAL REGULATIONS. THERE SHALL BE NO DISCHARGE THEREOF INTO ANY WATERWAY OR CONSIDERED INCIDENTAL TO CONSTRUCTION. THEREFORE, NO SEPARATE PAYMENT SHALL BE MADE.
13. A BORROW SITE FOR INFILTRATION MATERIAL SHALL BE OBTAINED BY THE CONTRACTOR IN COMPLIANCE WITH APPLICABLE REGULATIONS. THERE SHALL BE NO DISCHARGE THEREOF INTO ANY WATERWAY OR CONSIDERED INCIDENTAL TO CONSTRUCTION. THEREFORE, NO SEPARATE PAYMENT SHALL BE MADE.
14. THE CONTRACTOR SHALL BE RESPONSIBLE FOR SAFELY SECURING THE REQUIRED CONSTRUCTION. THE CONTRACTOR SHALL SELECT AND USE METHODS WHICH SHALL NOT BE HAZARDOUS OR DANGEROUS TO THE EXISTING FACILITIES AND STRUCTURES WHICH SURROUND THE WORK AREAS.
15. THE CONTRACTOR SHALL CONFINE HIS WORK WITHIN THE CONSTRUCTION LIMITS IN ORDER TO PRESENT THE EXISTING IMPROVEMENTS AND SO AS NOT TO INTERFERE WITH THE OPERATIONS OF THE EXISTING FACILITIES.
16. ALL DIMENSIONS AND RADIUS OF CURB, CURB RETURN, AND WALLS ARE SHOWN TO THE FACE OF CURB AND/OR WALL.
17. THE CONTRACTOR SHALL NOTIFY THE OWNER 48 HOURS PRIOR TO STRIPPING SO THAT LAYOUT CAN BE VERIFIED.
18. PRIOR TO CONSTRUCTION, THE CONTRACTOR SHALL EXCAVATE AND VERIFY THE HORIZONTAL AND VERTICAL LOCATION OF ALL POTENTIAL OBSTRUCTIONS. SHOULD A CONFLICT EXIST, THE CONTRACTOR SHALL NOTIFY THE ENGINEER IN WRITING SO THAT THE CONFLICT CAN BE RESOLVED WITH A MINIMUM AMOUNT OF DELAY.
19. CONTRACTOR SHALL SECURE "TOSCOIL DISTURBANCE PERMIT" PRIOR TO BEGINNING CONSTRUCTION.
20. ALL FILL SHALL BE FREE FROM VEGETATION, DEBRIS, AND OTHER DELETERIOUS MATERIALS.
21. ALL FILL SHALL BE COMPACTED TO A MINIMUM OF 95% ASTM D-1557 UNLESS A GREATER COMPACTION REQUIREMENT IS OTHERWISE SPECIFIED.
22. CAUTION: THESE DRAWINGS DO NOT INCLUDE NECESSARY COMPONENTS FOR CONSTRUCTION SAFETY WHICH SHALL REMAIN THE RESPONSIBILITY OF THE CONTRACTOR.

