

October 7, 1996

Martin J. Chávez, Mayor

Jeff Mortensen
Jeff Mortensen & Associates
6010-B Midway Park Blvd. NE
Albuquerque, NM 87109

**RE: ENGINEER CERTIFICATION FOR U.N.M. BAPTIST STUDENT UNION
(K15-D58) CERTIFICATION STATEMENT DATED 9/11/96.**

Dear Mr. Mortensen:

Based on the information provided on your September 11, 1996 submittal, Engineer Certification for the above referenced site is acceptable.

If I can of further assistance, please feel free to contact me at 768-2667.

Sincerely,

Bernie J. Montoya, CE
Engineering Associate

BJM/dl

c: Andrew Garcia
File

1635 Dr Luther Hwy NE

Good for You, Albuquerque!



950325

PROJECT TITLE: U.N.M. Baptist Student Union ZONE ATLAS/DRNG. FILE #: K15/D58
DRB #: _____ EPC #: _____ WORK ORDER #: _____
LEGAL DESCRIPTION: Tract 4, Lot 6, Block 6, Country Club A
CITY ADDRESS: _____
ENGINEERING FIRM: Jeff Mortensen & Assoc Inc. CONTACT: Michele (Mike) F. DeLilla
ADDRESS: 6010-B Midway Park Blvd NE. PHONE: 345-4250
OWNER: (See Architect) CONTACT: _____
ADDRESS: _____ PHONE: _____
ARCHITECT: Banes Southwest CONTACT: Tom
ADDRESS: 100 Iron Ave. S.E. PHONE: 344-3461
SURVEYOR: Jeff Mortensen & Assoc. Inc. CONTACT: Chuck Cala
ADDRESS: 6010-B Midway Park Blvd NE. PHONE: 345-4250
CONTRACTOR: Banes Southwest CONTACT: _____
ADDRESS: (SEE Architect) PHONE: _____

TYPE OF SUBMITTAL:

- ☐ DRAINAGE REPORT
☐ DRAINAGE PLAN
☐ CONCEPTUAL GRADING & DRAINAGE PLAN
☐ GRADING PLAN
☐ EROSION CONTROL PLAN
☒ ENGINEER'S CERTIFICATION
☐ OTHER

PRE-DESIGN MEETING:

- ☐ YES
☒ NO
☐ COPY PROVIDED

CHECK TYPE OF APPROVAL SOUGHT:

- ☐ SKETCH PLAT APPROVAL
☐ PRELIMINARY PLAT APPROVAL
☐ S. DEV. PLAN FOR SUB'D. APPROVAL
☐ S. DEV. PLAN FOR BLDG. PERMIT APPROVAL
☐ SECTOR PLAN APPROVAL
☐ FINAL PLAT APPROVAL
☐ FOUNDATION PERMIT APPROVAL
☐ BUILDING PERMIT APPROVAL
☒ CERTIFICATE OF OCCUPANCY APPROVAL
☐ GRADING PERMIT APPROVAL
☐ PAVING PERMIT APPROVAL
☐ S.A.D. DRAINAGE REPORT
☐ DRAINAGE REQUIREMENTS

(SPECIFY)

DATE SUBMITTED:

9/11/96

BY:

Michele (Mike) F. DeLilla

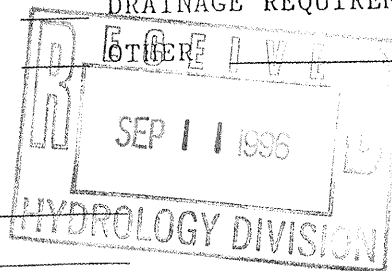

Drainage Certification

As indicated by the as-built information shown herein, the University of New Mexico Baptist Student Union has been approved in substantial compliance with the information shown herein and drainage from the following qualifications:

- The roof drainage for the south portion of the new building freely discharges onto Dr. Martin Luther King Jr. Avenue. As shown by the as-built drainage calculations, this will not have an adverse effect because the as-built discharge rate is still less than the Existing Conditions.
- The curb height for the concrete rundown located near the southwest corner of the site is lower than the design. As shown by the hydraulic calculations, the rundown has sufficient capacity for the as built and design flows.

It is based upon this evaluation that issuance of a Permanent Certificate of Occupancy is hereby recommended. The information shown herein has been obtained by me or under my supervision and is true and correct to the best of my knowledge and belief.

Jeffrey G. Montoya, NMLE 8547
Professional Engineer
Date: 09-11-96

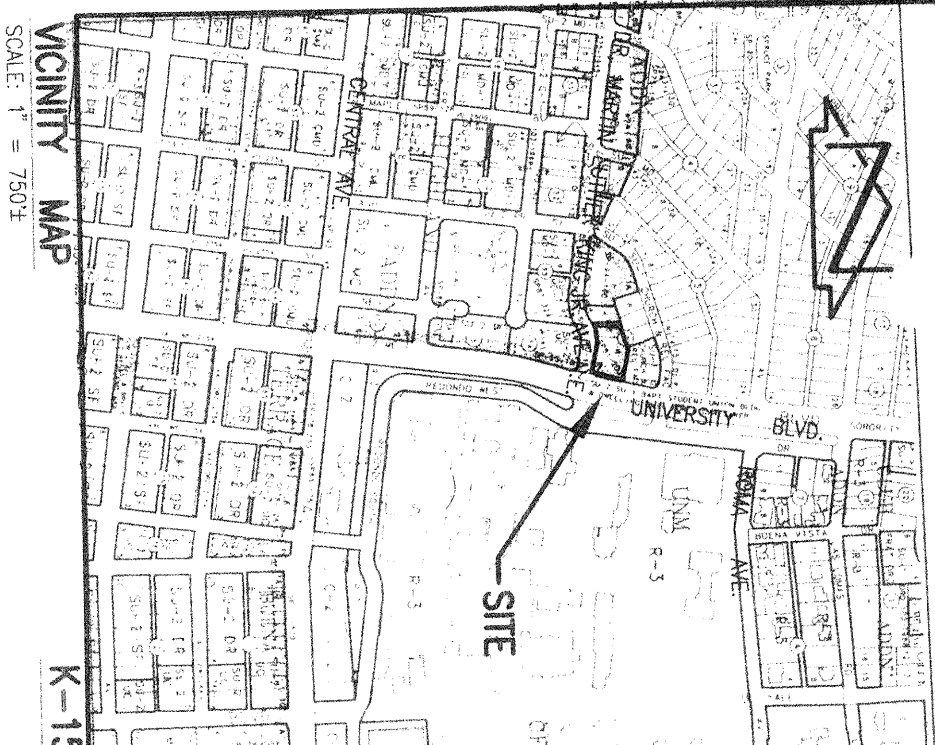
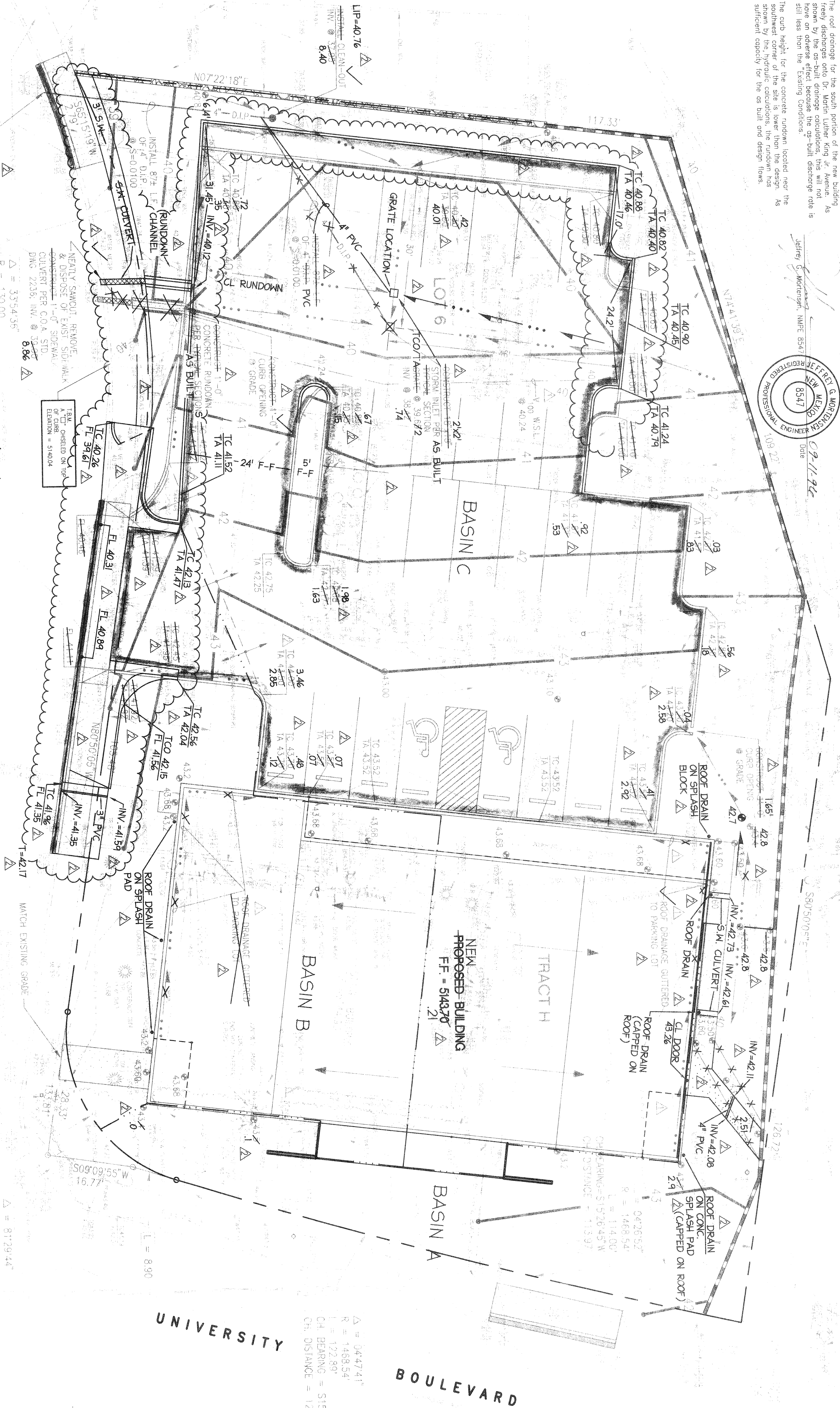
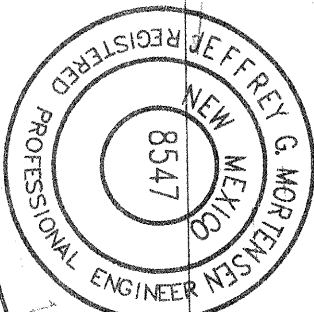

Grading and Drainage Plan

Scale: 1" = 10'

DR. MARTIN LUTHER KING JR. AVE. N.E.

NOTE: BOUNDARY INFORMATION SHOWN ON THIS PLAN IS PRELIMINARY IN NATURE AND IS SUBJECT TO APPROVAL OF A VACATION AND RELATING ACTION.

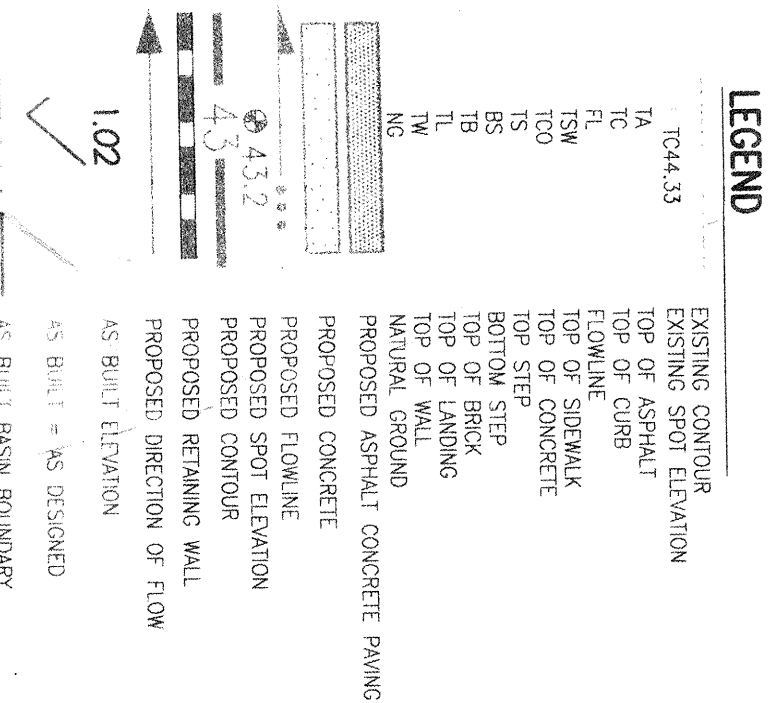

PROJECT BENCHMARK
AN A.C.S. 1 3/4" ALUMINUM DISK STAMPED "A.C.S. B.M. 9-419" SET IN THE TOP OF THE CURB AT THE S.W. CORNER OF THE INTERSECTION OF UNIVERSITY BLVD. AND 16TH ST. N.E. (ELEVATION = 5146.81 FEET (W.S.L.D.))

Δ = 8179.44'
R = 30.00'
L = 42.67'
CH BEARING = S58°25'05"W
CH DISTANCE = 39.16'

Δ = 0447.41'
R = 1468.54'
L = 122.83'
CH BEARING = S15°37'09"W
CH DISTANCE = 122.86'

- Erosion Control Measures
The contractor shall ensure that no soil erodes from the site into public right-of-way or onto private property.
- The contractor shall promptly clean up any material excavated or excavated material is not susceptible to being washed down the street.
- The contractor shall secure "Trespass" Disturbance Permit prior to beginning construction.

- Backfill compaction shall be according to AASHTO.
- Maintenance of these facilities shall be the responsibility of the owner of the property served.
- The design of planters and landscaped areas is not part of this plan. The contractor shall provide not posted areas adjacent to the building(s) to avoid any pooling of water or debris.
- Any excavation/Construction Permit will be required for any excavation work within City right-of-way. An approved copy of these plans must be submitted at the time of application for this permit.
- Any excavation/Construction Permit will be required for any excavation work within City right-of-way. An approved copy of these plans must be submitted at the time of application for this permit.

APPROVALS	NAME	DATE
ACE/DESIGN		
INSPECTOR		
ACE/FIELD		

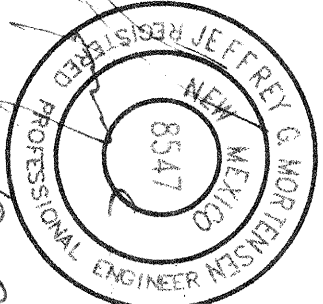

JEFF MONTAYA & ASSOCIATES, INC.
600 N. 10TH ST. SUITE 100
ALBUQUERQUE, NM 87102
950325

1 of 2

A NEW FACILITY FOR THE BAPTIST CONVENTION OF NEW MEXICO
BAPTIST STUDENT UNION • UNM
ALBUQUERQUE, NEW MEXICO

BANES SOUTHWEST
100 IRON AVE., SE ALBUQUERQUE, NEW MEXICO 87108
PHONE (505) 344-3461 FAX 764-8198

REVISION
V-00 W.S.L.
ROOF DRAINAGE
AND CURB

