

February 2, 1998

Jim Torres  
Torres Surveying  
P.O. Box 478  
Tijeras, New Mexico 87059

RE: AS-BUILT INFORMATION FOR TVI PARKING LOT GRADING/PAVING (K15-D16)  
SURVEYORS STAMP DATED 1/27/98

Dear Mr. Torres:

Based on the information provided on your January 27, 1998 submittal, as-built information provided for the above referenced site is acceptable.

If I can be of further assistance, please feel free to contact me at 924-3986.

C: Andrew Garcia  
File

Sincerely

  
Bernie J. Montoya CE  
Associate Engineer



PROJECT TITLE: TVI PARKING LOT ZONE ATLAS/DRNG. FILE #: K-15-2/D016

DRB #: \_\_\_\_\_ EPC #: \_\_\_\_\_ WORK ORDER #: \_\_\_\_\_

LEGAL DESCRIPTION: PORTION OF TVI COMMUNITY COLLEGE CAMPUS

CITY ADDRESS: COAL AVE. S.E. AND BUENA VISTA DRIVE S.E.

ENGINEERING FIRM: N/A CONTACT: \_\_\_\_\_

ADDRESS: \_\_\_\_\_ PHONE: \_\_\_\_\_

OWNER: ALBUQ. T.V.I. COMMUNITY COLLEGE CONTACT: \_\_\_\_\_

ADDRESS: \_\_\_\_\_ PHONE: \_\_\_\_\_

ARCHITECT: N/A CONTACT: \_\_\_\_\_

ADDRESS: \_\_\_\_\_ PHONE: \_\_\_\_\_

SURVEYOR: TORRES SURVEYING COMPANY CONTACT: MR. JIM TORRES

ADDRESS: P.O. BOX 478, TIBERAS, N.M. 87059 PHONE: 220-9213

CONTRACTOR: FACILITY CARE CONTACT: DAN GAY

ADDRESS: 5904 FLORENCE AVE. N.E. 87113 PHONE: 450-8541

TYPE OF SUBMITTAL:

- DRAINAGE REPORT
- DRAINAGE PLAN
- CONCEPTUAL GRADING & DRAINAGE PLAN
- GRADING PLAN
- EROSION CONTROL PLAN
- ~~ENGINEER'S~~ SURVEYOR'S CERTIFICATION
- OTHER \_\_\_\_\_

CHECK TYPE OF APPROVAL SOUGHT:

- SKETCH PLAT APPROVAL
- PRELIMINARY PLAT APPROVAL
- S. DEV. PLAN FOR SUB'D. APPROVAL
- S. DEV. PLAN FOR BLDG. PERMIT APPROVAL
- SECTOR PLAN APPROVAL
- FINAL PLAT APPROVAL
- FOUNDATION PERMIT APPROVAL
- BUILDING PERMIT APPROVAL
- CERTIFICATE OF OCCUPANCY APPROVAL
- GRADING PERMIT APPROVAL
- PAVING PERMIT APPROVAL
- S.A.D. DRAINAGE REPORT
- DRAINAGE REQUIREMENTS
- SUBDIVISION CERTIFICATION
- OTHER FINAL CERTIFICATION (SPECIFY)

PRE-DESIGN MEETING:

- YES
- NO
- COPY PROVIDED

DATE SUBMITTED: JAN. 27, 1998  
BY: JIM TORRES

**R** E C E I V E **D**  
JAN 27 1998  
HYDROLOGY SECTION

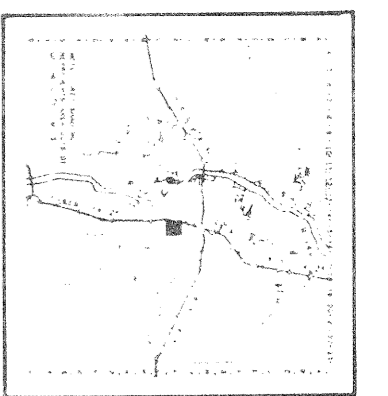
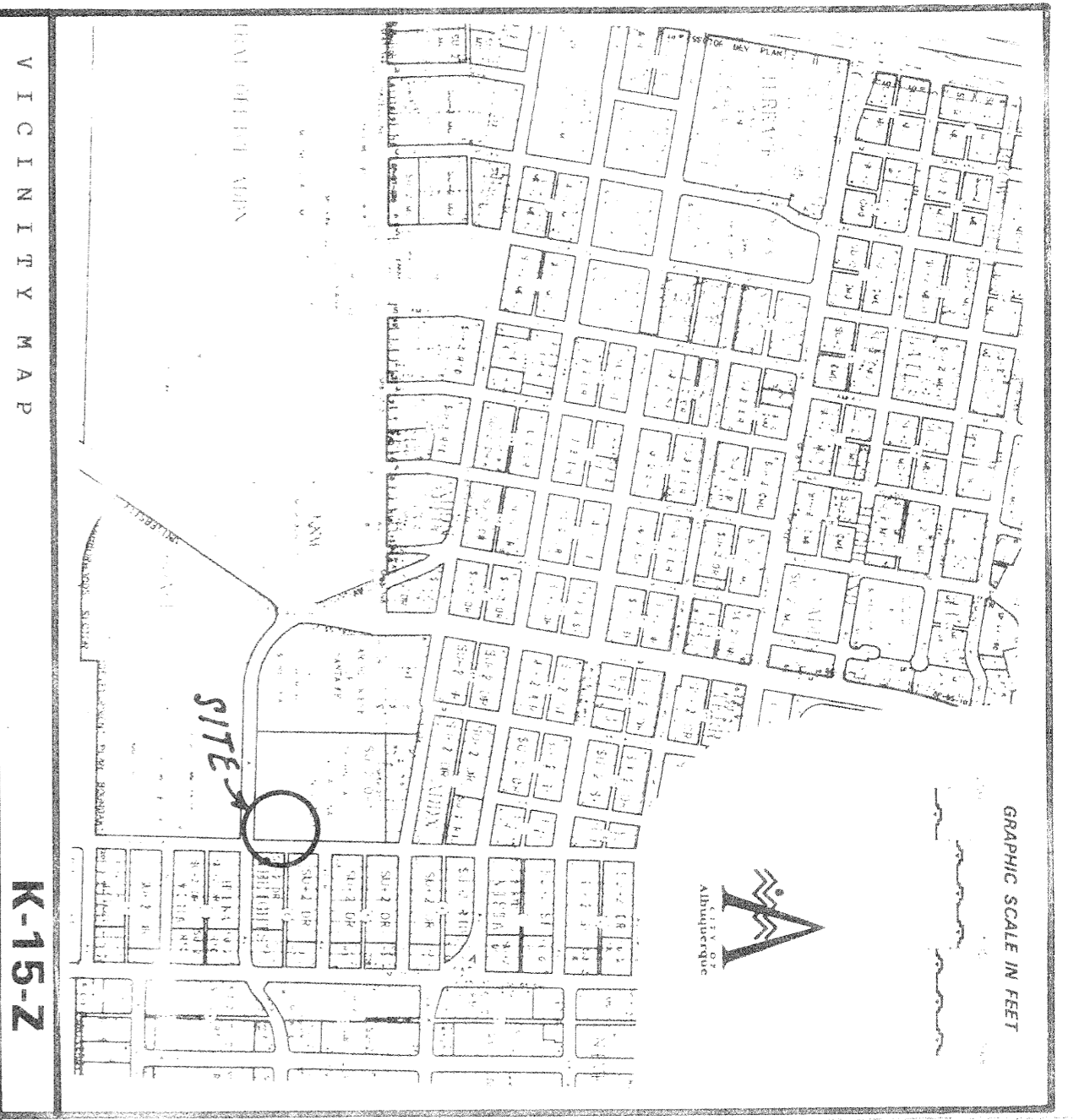

**COMMENTS:**  
 AS SHOWN ON THE VICINITY MAP HEREON, THE SUBJECT SITE IS LOCATED WITHIN THE EXISTING PAVED PARKING AREA OF THE NORTHWEST CORNER OF THE INTERSECTION OF COAL AVENUE S.E. AND BUENA VISTA STREET S.E., IN THE CITY OF ALBUQUERQUE, BERNALILLO COUNTY, NEW MEXICO.  
 THE PURPOSE OF THIS "AS-BUILT" TOPOGRAPHY SURVEY AND MAP IS TO SHOW THAT THE ASPHALT PAVED PORTION OF THE PARKING AREA THAT WAS FENCED, BARRICADED, CONPAVED AND RE-PAVED WAS NOT ALTERED IN GRADE FROM ITS ORIGINAL PAVED GRADE; THIS ALSO SHOWS THAT THERE IS NO INCREASE OF SANDS CREATED BY THIS RE-PAVING.

NORTH  
 SCALE: 1"=10'

**REGENIE D**  
 JUN 27 1998  
 HYDROLOGY SECTION

**COAL AVENUE S.E.**

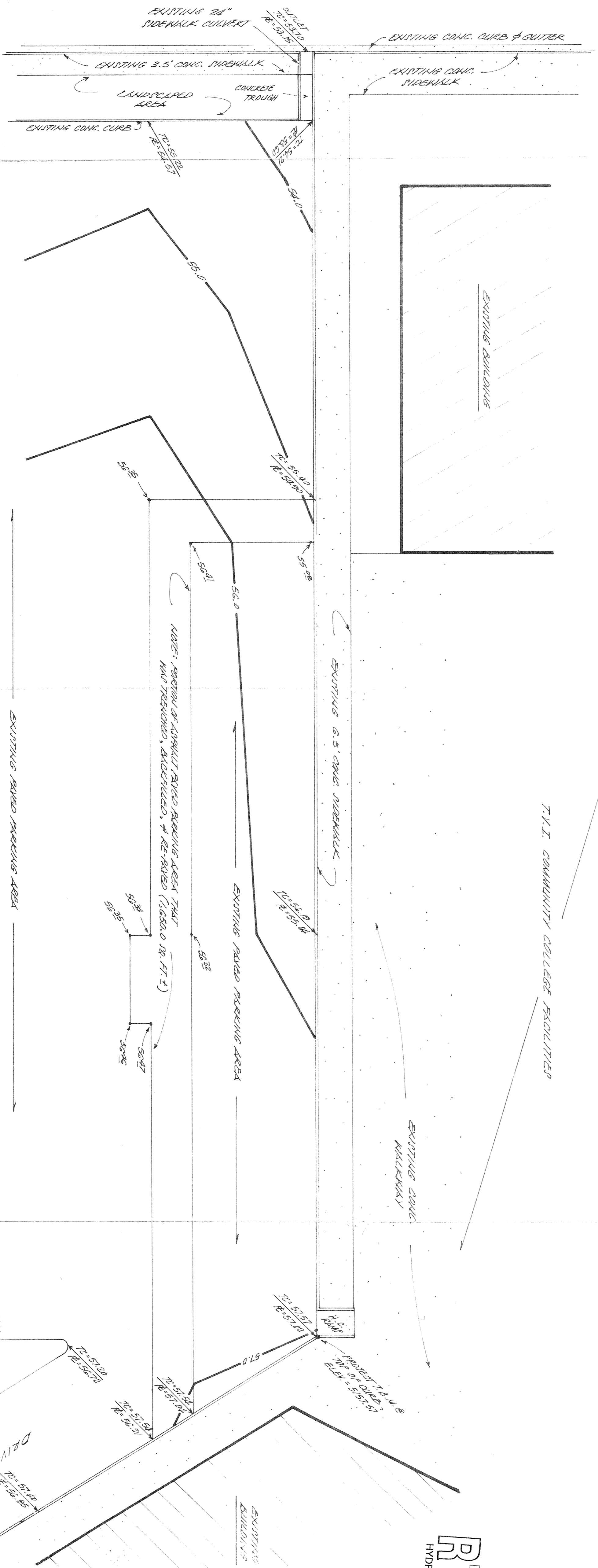

**LEGEND:**  
 TOP OF CURB ELEVATION = 70+55.40  
 CURB FROM LINE ELEVATION = E-661.80  
 EXISTING CONCRETE SURFACE = 57+55.40  
 EXISTING SPOT ELEVATION = 56.01  
 EXISTING CONTOUR ELEVATION = 56.0

**LEGAL DESCRIPTION:**

PORTION OF THE ALBUQUERQUE TECHNICAL LOCATION COMMUNITY COLLEGE CAMPUS, (T11), ALBUQUERQUE, BERNALILLO COUNTY, NEW MEXICO.

**BRANCH REFERENCE:**

ACS STATION "HY-115", ELEVATION OF 5156.00, LOCATED AT THE NORTHWEST CORNER OF THE INTERSECTION OF COAL PLAGE S.E. AND BUENA VISTA DRIVE S.E., IN THE CITY OF ALBUQUERQUE, NEW MEXICO, (PROJECT T.B.N. AS SHOWN ON THE PLAN HEREON).

**SURVEYORS' CERTIFICATION:**

I, JOHN B. TORRES, NEW MEXICO REGISTERED PROFESSIONAL LAND SURVEYOR NO. 3221, LICENSED AND REGISTERED UNDER THE LAWS OF THE STATE OF NEW MEXICO, DO HEREBY STATE THAT THE SURVEY AND MAP SHOWN HEREON WAS PREPARED BY ME OR UNDER MY SUPERVISION AND DIRECTIONS, AND THAT THE SAME IS TRUE AND CORRECT TO THE BEST OF MY KNOWLEDGE AND BELIEF.

JOHN B. TORRES, N.M.R.P.L.S. - NO. 3221  
 DATE: 01-01-98

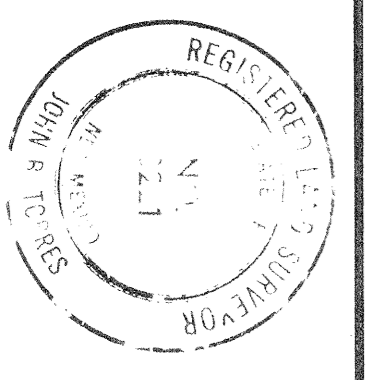

"AS-BUILT" TOPOGRAPHY SURVEY MAP  
 OF PORTION OF  
 EXISTING PAVED PARKING AREA  
 ALBUQUERQUE TECHNICAL LOCATION COMMUNITY COLLEGE  
 ALBUQUERQUE, NEW MEXICO  
 JANUARY, 1998