

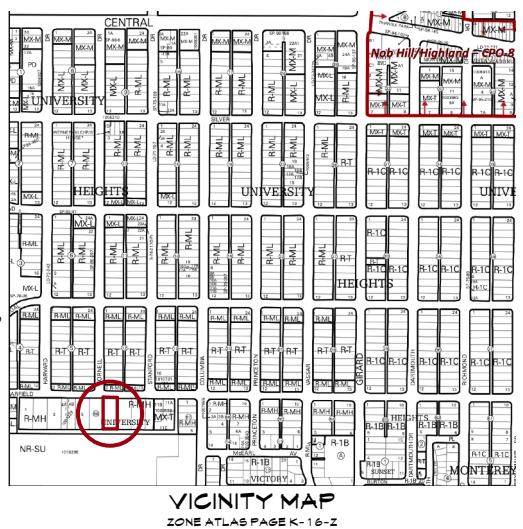

**KING**  
**ENGINEERING**  
& DESIGN [www.kingengineer.com](http://www.kingengineer.com)

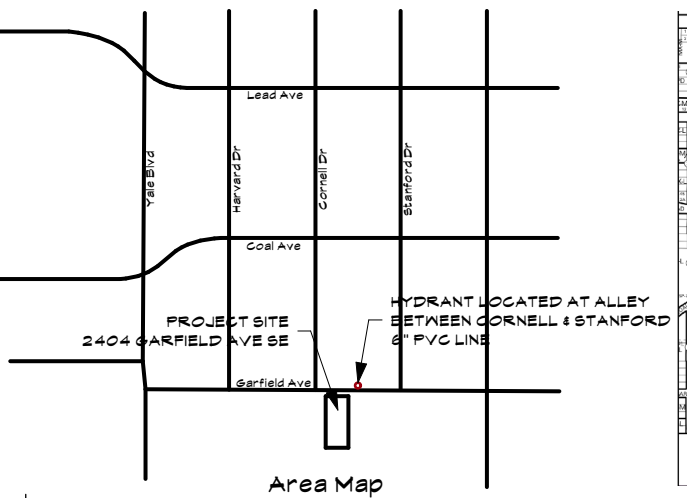

Approved for access by the Solid Waste Department.  
All containers must be made accessible for pick up  
between the hours of 5AM and 8PM.  
Reviewer: *Herman Gallegos*  
Date: **05-21-24**  
**\*\*This site must pay gate  
service due to gates opening  
in the alley. 16 units.\*\***

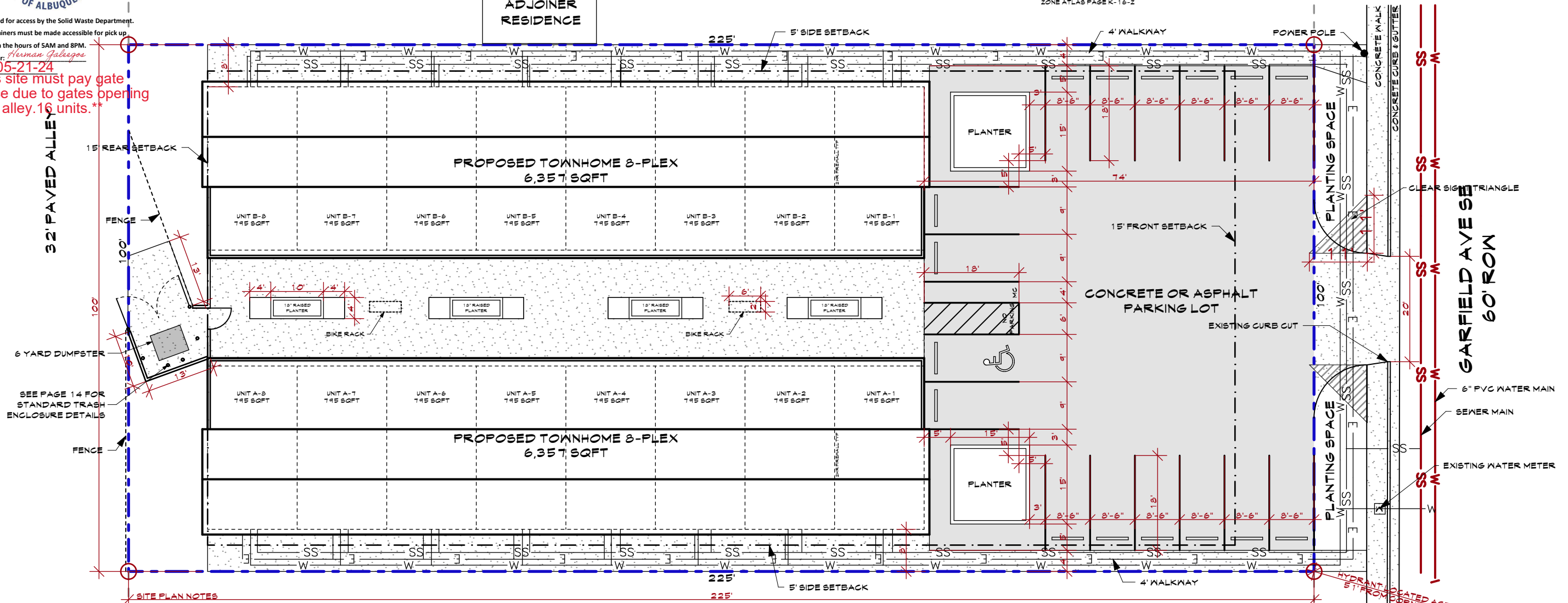

- SITE PLAN NOTES**
1. REFER TO GRADING AND DRAINAGE PLAN FOR FINISHED FLOOR AND LANDSCAPING GRADES
  2. 1 OFF STREET PARKING SPACE PER DWELLING UNIT REQUIRED PER TABLE 5-5-1 OF THE IDO. TOTAL REQUIRED PARKING = 16 SPACES
  3. LANDSCAPING AND SIGNAGE WILL NOT INTERFERE WITH CLEAR SIGHT REQUIREMENTS. THEREFORE SIGNS, WALLS, TREES AND SHRUBBERY BETWEEN 3 AND 8 FEET TALL (AS MEASURED FROM THE GUTTER PAN) WILL NOT BE ACCEPTABLE IN THE CLEAR SIGHT TRIANGLE.
  4. ALL BROKEN OR CRACKED SIDEWALK MUST BE REPLACED WITH THE SIDEWALK AND CURB & GUTTER. REFER TO THE CITY STANDARD DRAWINGS 2430 (SIDEWALK) 2415 (CURB & GUTTER).
  5. PROVIDE ADA PARKING SPACES WITH SIGN PER 66-7-352.4C NMSA 1978 WHICH STATES "VIOLATORS ARE SUBJECT TO A FINE AND/OR TOWING" PROVIDE ADA ACCESSIBLES WITH THE WORDS "NO PARKING" IN CAPITAL LETTERS. EACH OF WHICH SHALL BE AT LEAST ONE FOOT HIGH AND AT LEAST TWO INCHES WIDE. PLACED AT THE REAR OF THE PARKING SPACE SO AS TO BE CLOSEST TO WHERE THE ADJACENT VEHICLE'S REAR TIRE WOULD BE PLACED (66-1-4.1.B NMSA 1978). MOTORCYCLE PARKING SPACE SHALL BE DESIGNATED BY ITS OWN CONSPICUOUSLY POSTED UPRIGHT SIGN, EITHER FREE STANDING OR WALL MOUNTED PER ZONING CODE
  6. ALL IMPROVEMENTS LOCATED IN THE RIGHT OF WAY MUST BE INCLUDED ON THE WORK ORDER.
  7. BUILDINGS TO BE UNSPRINKLED, 2HR FIRE WALL BETWEEN UNITS
  8. TOTAL BUILDING HEIGHT = 22'-4"
  9. UNUSED CURB CUTS TO BE REPLACED WITH CURB & GUTTER PER CITY STANDARD 2415A & 2430
  10. LANDSCAPING AND SIGNAGE WILL NOT INTERFERE WITH CLEAR SIGHT REQUIREMENTS. THEREFORE, SIGNS, WALLS, TREES, & SHRUBBERY BETWEEN 3 & 8 FEET TALL (AS MEASURED FROM THE GUTTER PAN) WILL NOT BE ACCEPTABLE IN THE CLEAR SIGHT TRIANGLE
  11. ALL BROKEN OR CRACKED SIDEWALKS MUST BE REPLACED WITH SIDEWALK AND CURB & GUTTER PER CITY STANDARDS

**ADDRESS:**  
2404 GARFIELD AVE SE, 87106

**LEGAL DESCRIPTION:**  
LOT SEVEN (7), BLOCK SIXTY-EIGHT (68) OF THE UNIVERSITY HEIGHTS

**ZONING:**  
-REQUIRED PARKING SPACES PER IDO = 16  
SPACES PROVIDED = 16  
-REQUIRED MOTORCYCLE PARKING SPACES PER IDO = 1  
SPACES PROVIDED = 1  
-REQUIRED BICYCLE PARKING SPACES PER IDO = 2  
SPACES PROVIDED = 2

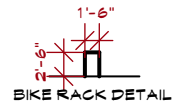

**HEATED FLOOR AREA:**  
TOTAL 16-PLEX FLOOR AREA = 12,714 SQ.FT.  
INDIVIDUAL UNIT = 795 SQ. FT.

**SOLID WASTE SITE PLAN**

SCALE: 1" = 20'

